



# USER'S GUIDE

SLINGSHOT  
7" DISPLAY POWERED BY  
RIDE COMMAND

**SLINGSHOT.**



## WARNING

Read, understand, and follow all of the instructions and safety precautions in this manual and on all product labels.

Failure to follow the safety precautions could result in serious injury or death.



## WARNING

Operating, servicing, and maintaining a passenger vehicle or off-road vehicle can expose you to chemicals including engine exhaust, carbon monoxide, phthalates, and lead, which are known to the State of California to cause cancer and birth defects or other reproductive harm. To minimize exposure, avoid breathing exhaust, do not idle the engine except as necessary, service your vehicle in a well-ventilated area and wear gloves or wash your hands frequently when servicing your vehicle.

For more information go to [www.P65Warnings.ca.gov/passenger-vehicle](http://www.P65Warnings.ca.gov/passenger-vehicle).



*For videos and more information  
about a safe riding experience with  
your Polaris vehicle, scan this QR  
Code® with your smartphone.*



**Slingshot User Guide for  
7" Display Powered by  
RIDE COMMAND**

Unless noted, trademarks are the property of Polaris Industries Inc.

Bluetooth® is a registered trademark of Bluetooth SIG, Inc. iPhone®, Apple®, iPod®, and CARPLAY® are registered trademarks of Apple Inc. iOS® is a registered trademark of Cisco Systems, Inc. Android® is a registered trademark of Google LLC. Kingston® is a registered trademark of Kingston Technology Corporation. Sandisk® is a registered trademark of SanDisk LLC.

Copyright 2024 Polaris Industries Inc. All information contained within this publication is based on the latest product information at the time of publication. Due to constant improvements in the design and quality of production components, some minor discrepancies may result between the actual vehicle and the information presented in this publication. Depictions and/or procedures in this publication are intended for reference use only. No liability can be accepted for omissions or inaccuracies. Any reprinting or reuse of the depictions and/or procedures contained within, whether whole or in part, is expressly prohibited.

The original instructions for this vehicle are in English. Other languages are provided as translations of the original instructions.

Printed in U.S.A.

RIDE COMMAND User Guide

9930830 R03



Welcome to RIDE COMMAND for Slingshot. This intuitive display gives you access to a variety of interactive features and access to your vehicle's custom information.

For a safe and enjoyable riding experience with your new display, please read your vehicle's owner's manual and this user's guide. If you need additional assistance with display operation or software updates, please see your authorized POLARIS dealer or visit <https://ridecommand.slingshot.polaris.com/en-us/>.

For the latest information about your Slingshot display powered by RIDE COMMAND, including software updates, please visit <https://ridecommand.slingshot.polaris.com/en-us/>.

## WARNING

Do not enter information while operating your vehicle. Failure to pay attention to the operation of your vehicle could result in loss of control, injury, or death. You assume all risks associated with using this device. Read your user's guide thoroughly and always drive with the latest maps and road data from <https://ridecommand.slingshot.polaris.com/en-us/>.

## SAFETY SYMBOLS AND SIGNAL WORDS

---

The following signal words and symbols appear throughout this manual and on your vehicle. Your safety is involved when these words and symbols are used. Become familiar with their meanings before reading the manual.

### DANGER

DANGER indicates a hazardous situation which, if not avoided, WILL result in death or serious injury.

### WARNING

WARNING indicates a hazardous situation which, if not avoided, COULD result in death or serious injury.

### CAUTION

CAUTION indicates a hazardous situation which, if not avoided, COULD result in minor to moderate injury.

### NOTICE

NOTICE provides key information by clarifying instructions.

### IMPORTANT

IMPORTANT provides key reminders during disassembly, assembly, and inspection of components.

The Prohibition Safety Sign indicates an action NOT to take in order to avoid a hazard.



The Mandatory Action Sign indicates an action that NEEDS to be taken to avoid a hazard.



## TABLE OF CONTENTS

---

<b>Introduction</b> . . . . .	<b>7</b>
<b>Features and Controls</b> . . . . .	<b>15</b>
<b>Operation</b> . . . . .	<b>39</b>
<b>Maintenance</b> . . . . .	<b>59</b>





# INTRODUCTION

## BEFORE YOU DRIVE

Before driving with your new display, please complete the following:

- Read this manual in its entirety.
- Familiarize yourself with the features and operations of the display while the vehicle is stationary.
- Download the Polaris app from your phone's app store and create your personalized account.
- Check your display to ensure you have the appropriate maps and roads visible for your area. For instructions on updating the maps on your display, see page 63.
- When updating software, be sure you are using a compatible USB flash drive. See page 61 for more information.
- Check <https://www.polaris.com/en-us/owners-manuals> for the latest updates to the owner's manual.
- On the display, log in to your RIDE COMMAND account:
  1. Press the **Settings** button on the display.
  2. Tap **All Settings** in the right corner.
  3. Tap **General** on the left side panel.
  4. Tap **RIDE COMMAND Account**.
  5. Tap **Account ID** and enter your e-mail address.
  6. Tap **Save**.
  7. Enter your password.
  8. Tap **Save**.

### NOTICE

Using the display for an extended period of time while the vehicle's engine is off can drain the battery.

## INTRODUCTION

---

### DEVICE OPERATING REQUIREMENTS

Phone functionality, in pairing with this display, is dependent on the capabilities of your cell phone.

#### NOTICE

Some cell phones or operating systems will not work as shown in this manual.

### DEVICE COMPLIANCE STATEMENTS

This vehicle contains the following radio equipment or components that contain radio equipment:

#### USA RADIO COMPLIANCE

This device complies with part 15 of the FCC Rules. Operation is subject to the following two conditions: (1) This device may not cause harmful interference, and (2) this device must accept any interference received, including interference that may cause undesired operation.

This device complies with FCC RF radiation exposure limits for general population.

This device contains license-exempt transmitter(s)/receiver(s) that comply with Innovation, Science and Economic Development Canada's license-exempt RSS (s). Operation is subject to the following two conditions:

1. This device may not cause interference.
2. This device must accept any interference, including interference that may cause undesired operation of the device.

**⚠ CAUTION**

This equipment complies with part 15 of the Federal Communications Commission (FCC) rules.

These requirements are intended to provide reasonable protection against harmful interference in a residential installation. This equipment generates, uses and can radiate radio frequency energy and, if not installed and used in accordance with the instructions, may cause harmful interference to radio communications. However, there is no guarantee that interference will not occur in a particular installation.

If this equipment does cause harmful interference to radio or television reception, which can be determined by turning the equipment off and on, the user is encouraged to try to correct the interference by one or more of the following measures:

- Reorient or relocate the receiving antenna.
- Increase the separation between the equipment and receiver.
- Connect the equipment into an outlet on a circuit different from that to which the receiver is connected.
- Consult the dealer or an experienced radio/TV technician for help.

Changes or modifications to this equipment not expressly approved by the party responsible for compliance could void the user's authority to operate the equipment.

**CANADA RADIO COMPLIANCE**

This vehicle contains the following radio equipment or components that contain radio equipment:

COMPONENT	COMPONENT ID	MANUFACTURER
Ride Command RC-7 Display	RC-7	Polaris Industries Inc.

This device contains license-exempt transmitter(s)/receive(s) that comply with Innovation, Science and Economic Development Canada's license exempt RSS (s). Operation is subject to the following two conditions:

1. This device may not cause interference.
2. This device must accept any interference, including interference that may cause undesired operation of the device.

## INTRODUCTION

### IMPORTANT

For applications that use vehicle-to-vehicle (V2V) communication, radio transmitter IC 5966A-RC7W has been approved by Innovation, Science and Economic Development Canada (ISED) to operate with Polaris antenna (part number 4019211) with gain of 3 dBi. Any antenna that has a gain greater than 3 dBi is prohibited for use with this device.

## EUROPEAN UNION (EU) RADIO COMPLIANCE

Hereby, Polaris Industries Inc. declares that the above radio equipment is in compliance with Directive 2014/53/EU.

The full text of the EU declaration of conformity is available at the following internet address:

<https://www.polaris.com/en-us/radio-conformity/>

### FREQUENCY BAND (MHZ)

2402 — 2480

## REGULATORY INFORMATION

### Viewing Regulatory Information on the Display:

1. Tap the POLARIS logo at the top of the screen or press the POLARIS North Star button beneath the screen.
2. In the bottom right-hand corner, tap **All Settings**.
3. Tap the **REGULATORY INFORMATION** button.

<p style="text-align: center;"><b>CHINA</b> CMIIT ID: 2023DJ8361</p>	<p style="text-align: center;"><b>MOROCCO</b> <b>AGREE PAR L'ANRT MAROC</b> Numéro d'agrément: MR00035859ANRT2022 Date d'agrément: 16/12/2022</p>
<p style="text-align: center;"><b>SENEGAL</b> Approval Number: 072703/AG/ER Brand and type of Device: Polaris – (type of Device) Système navigation pour véhicule Model Number: RC-7</p>	<p style="text-align: center;"><b>THAILAND</b> “เครื่องโทรคมนาคมและอุปกรณ์นี้มีความสอดคล้องตามมาตรฐานหรือข้อกำหนดทางเทคนิคของกสทช.”  <i>Translation: “This telecommunication equipment conforms to the technical standards or requirements of NBTC.”</i></p>
<p style="text-align: center;"><b>ARGENTINA</b>  R-28599</p>	<p style="text-align: center;"><b>PHILIPPINES</b> <b>NTC</b>  Type Accepted ESD-RCE-2333981</p>
<p style="text-align: center;"><b>SOUTH AFRICA</b>  TA 2023/0093 APPROVED</p>	<p style="text-align: center;"><b>SINGAPORE</b> <div style="border: 2px solid black; padding: 5px; display: inline-block;">Complies with IMDA Standards N2888-23</div></p>

# INTRODUCTION

## UNITED ARAB EMIRATES



ER15563/22  
United Arab Emirates



## PARAGUAY



**CONATEL**

**NR: 2023-05-I-0344**

Manufacturer: Polaris Industries

Brand Name: Polaris

Model Number: RC7

Distributor: Asuncion Motor Sport SA

Address: Mayor Evacio Perincio Merlo 2501, Asunción 001401, Paraguay

Contact Name: Jose de Ayala jose.ayala@amssa.com.py

## MEXICO



IFT: RCPPORC20-1082

“La operación de este equipo está sujeta a las siguientes dos condiciones: (1) es posible que este equipo o dispositivo no cause interferencia perjudicial y (2) este equipo o dispositivo debe aceptar cualquier interferencia, incluyendo la que pueda causar su operación no deseada”

*Translation: Operation of this equipment is subject to the following two conditions: (1) it is possible that this equipment or device may not cause harmful interference and (2) this equipment or device must accept any interference, including interference that may cause undesired operation.*

TAIWAN — NCC



CCAL23LP0460T1

取得審驗證明之低功率射頻器材，非經核准，公司、商號或使用者均不得擅自變更頻率、加大功率或變更原設計之特性及功能。低功率射頻器材之使用不得影響飛航安全及干擾合法通信；經發現有干擾現象時，應立即停用，並改善至無干擾時方得繼續使用。前述合法通信，指依電信管理法規定作業之無線電通信。低功率射頻器材須忍受合法通信或工業、科學及醫療用電波輻射性電機設備之干擾。

*Rough Translation: For low-power radio frequency equipment that has obtained certification, companies, firms or users are not allowed to change the frequency, increase the power, or change the characteristics and functions of the original design without approval. The use of low-power radio-frequency equipment must not affect flight safety and interfere with legal communications; if any interference is found, it should be stopped immediately, and it can only be used after improvement to no interference. The aforementioned legal communication refers to radio communication operated in accordance with the provisions of the Telecommunications Management Act. Low-power radio frequency equipment must endure the interference of legal communication or industrial, scientific and medical radio wave radiation electrical equipment.*

TAIWAN — BSMI



R3F976

RoHS

- 使用過度恐傷害視力。(Rough Translation: Excessive use may damage eyesight.)
- 使用30分鐘請休息10分鐘。(Rough Translation: Please rest for 10 minutes after using for 30 minutes)
- 未滿2歲幼兒不看螢幕，2歲以上每天看螢幕不要超過1小時。(Rough Translation: Children under the age of 2 should not watch the screen, and children over the age of 2 should not watch the screen for more than 1 hour a day.)

設備名稱：3286923  
Equipment name RC-7  
, 型號 (型式) :  
Type Designation (Type)

單元 Unit	限用物質及其化學符號 Restricted substances and its chemical symbols					
	鉛Lead (Pb)	汞Mercury (Hg)	鎘 Cadmium (Cd)	六價鉻 Hexava- lent chromium (Cr <sup>6+</sup> )	多溴聯苯 Polybromi- nated biphenyls (PBB)	多溴二苯 醚 Polybromi- nated diphenyl ethers (PBDE)
Upper Case 上半部分 盒子	○	○	○	○	○	○
Button set	○	○	○	○	○	○

# INTRODUCTION

電鍵						
Display Digital Assembly (contains the PCB, screen, and electrical components) 触控显示 (包含 PCB、屏幕和电气元件)	○	○	○	○	○	○
Cable, Black 導線, 黑	-	○	○	○	○	○
Cable, Blue 導線, 藍	-	○	○	○	○	○
Lower Case 底子盒子	○	○	○	○	○	○
<p>備考1. “超出0.1 wt %” 及 “超出0.01 wt %” 係指限用物質之百分比含量超出百分比含量基準值。            Note 1: “Exceeding 0.1 wt %” and “exceeding 0.01 wt %” indicate that the percentage content of the restricted substance exceeds the reference percentage value of presence condition.</p> <p>備考2. “○” 係指該項限用物質之百分比含量未超出百分比含量基準值。            Note 2: “○” indicates that the percentage content of the restricted substance does not exceed the percentage of reference value of presence.</p> <p>備考3. “-” 係指該項限用物質為排除項目。            Note 3: The “-” indicates that the restricted substance corresponds to the exemption.</p>						



## FEATURES AND CONTROLS

### OVERVIEW

The Ride Command display automatically turns on upon vehicle start up. It will remain active until the vehicle's ignition is switched off.

### ICON BAR

The icon bar at the top of the touchscreen display shows mobile device connectivity, headset connections, cellular signal strength, fuel range, compass, ambient temperature, and clock. Some of these built-in features are functional only with the addition of Polaris accessories. Your Polaris dealer can assist.



- ① Mobile Device Indicator
- ② Headset Indicator
- ③ Cellular Signal Strength

- ④ Fuel Range
- ⑤ Compass
- ⑥ Ambient Temperature
- ⑦ Clock

## FEATURES AND CONTROLS

---

### BADGE PANEL

Select the Badge Panel (Slingshot logo) to access the following tabs:

- Controls
- Notifications
- Open the All Settings menu.

#### NOTICE

Badge Panel will automatically close after 10 seconds of inactivity.

### CONTROLS TAB

The Controls tab gives access to the following:

- Adjust screen brightness using the slider.
- Automate screen brightness.
- Select ride mode.
- Rear camera.



### NOTIFICATIONS TAB

The Notifications tab shows vehicle notifications.









## BUTTONS



- ① Rider Screen Button
- ② Map Button
- ③ Device Manager Button
- ④ Settings Button

- ⑤ Audio Button
- ⑥ Volume Decrease Button
- ⑦ Volume Increase Button

## FEATURES AND CONTROLS

BUTTON	DESCRIPTION	FUNCTION
	Rider Screen Button	Press the Rider Screen button to access the Rider Screens and use split screen views.
	Navigation Button	Press the Navigation button for navigation (if equipped) and to manage your saved routes and destinations.
	Device Manager Button	Press the Device Manager button to sync your display with a Bluetooth-enabled device, such as a smartphone or headset.
	Settings Button	Press and release the Settings button to enter the Settings screen.
	Audio Button	Press the Audio button to access the radio and audio from Bluetooth- and USB-connected devices.
	Volume Decrease Button	Press the Volume Decrease button to lower the volume of audio through the built-in speaker system.
	Volume Increase Button	Press the Volume Increase button to increase the volume of audio through the built-in speaker system.

### DRIVER BUTTON

The Driver Screens display upon vehicle start up. This customizable split-screen view communicates important information.

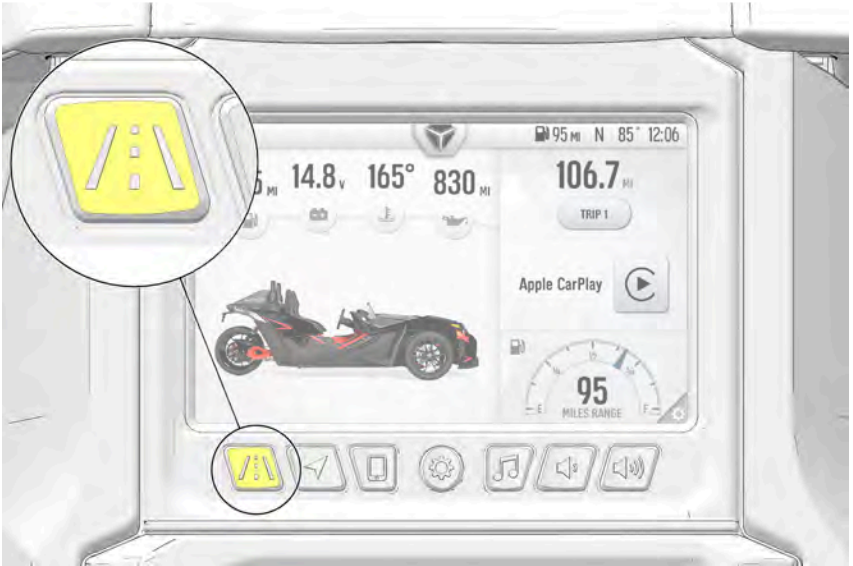

The Driver Screens can be accessed at any time by pressing the Driver button (shown above).

You can page through these views by swiping your finger horizontally across the touchscreen display or by pressing the Driver button once to rotate to the next view.

## FEATURES AND CONTROLS

---

Navigation  
Screen



Vehicle  
Statistics  
Screen



Current Ride  
Screen



## CUSTOMIZE DRIVER SCREEN

The right portion of the Driver Screen can be customized. To customize the widgets on the screen, press the Settings Icon ① in the lower right corner.



From the Settings Screen, swipe up and down to find the widgets you would like to add. Press and drag each widget to the location on the right hand side of the screen in the position that you would like to place it. Press done ② when you have the desired widgets in the order that you wish to save your settings.



## FEATURES AND CONTROLS

---

### NAVIGATION BUTTON

The Navigation Screen utilizes your Slingshot's GPS to provide directions to specific addresses and points-of-interest within your vicinity. The position indicator arrow centers itself based on the location of the GPS.

#### NOTE

In order to use navigation on your Slingshot, an active RIDE COMMAND+ subscription is required. Please see page 64 for more details.

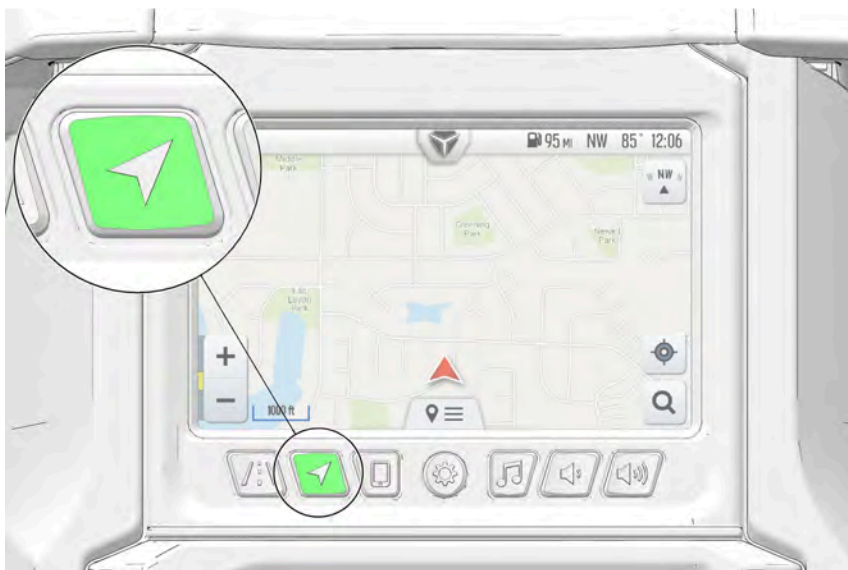



### **ZOOM**

Auto-zoom to the position indicator is always active during navigation. The current zoom level is relative to the maximum and minimum zoom capabilities.

#### **Zoom In**

To zoom in on the position indicator, press the plus button or expand your fingers on the touchscreen.

#### **Zoom Out**

To zoom out, press the minus button or pinch your fingers together on the touchscreen.



## FEATURES AND CONTROLS

### MAP ORIENTATION

The Map Orientation button is located on the upper right side of the screen. This button allows users to change map orientation between three modes: North Up, Course Up, and 3D. Pressing this button will also re-center the map on the position indicator arrow.



MAP ORIENTATION	MAP ICON
North Up view locks the map orientation so North will always point upward, regardless of your Slingshot's position or direction.	
Course Up view rotates the map to match the direction of your Slingshot.	
3D view tilts the map to the horizon and adds additional dimension to the environment.	

### SEARCH

Pressing the search icon will bring up the search screen.



The search screen allows you to search for destinations, find points-of-interest, set a destination as your “home” location, browse saved locations, and view recent searches.



## FEATURES AND CONTROLS

### DEVICE MANAGER BUTTON

The Device Manager screen manages your Bluetooth-paired devices. Pair a smartphone and headset to the Ride Command display to listen to music, make and receive calls and text messages, as well as access your personal contact list, favorites, and call history.

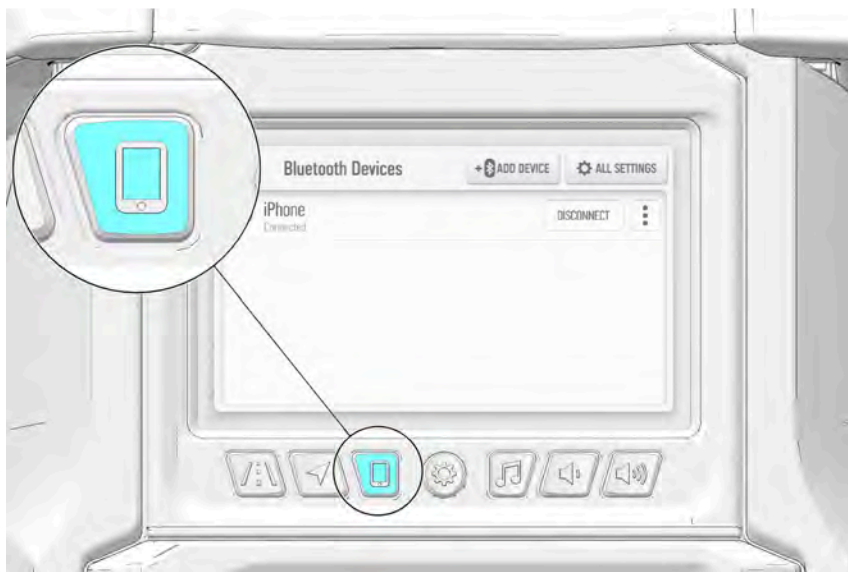

#### NOTICE

The Ride Command display is not equipped with a built-in microphone. Voice audio can only be transmitted through your mobile device or Polaris-approved headset.

#### NOTICE

Dialing and texting options may be unavailable at speeds greater than 3 mph (5 km/h).

#### NOTICE

Subsequent screens, including recent calls, contacts, text messages, and keypad, are unavailable unless the display is connected to a smartphone via Bluetooth®.

## RECENT CALLS

The Recent Calls tab displays all recent calls to and from your smartphone. On this screen, you can do the following:

- View and refresh call history.
- Respond to calls.



## CONTACTS

The Contacts tab connects to your smartphone's contact list. On this screen, you can do the following:

- Search for contacts using the alphabetical menu at the top of the touchscreen.
- View stored information for each contact.



### NOTICE

Your phone must be connected to Bluetooth® to populate your contact list.

## FEATURES AND CONTROLS

### KEYPAD

The Keypad tab allows you to free-dial phone numbers to make calls outside your phone's saved contact list.



### TEXT MESSAGES

The Text tab shows message history sent from the display. From this screen, you can perform the following actions:

- View message history and incoming messages.
- Reply to a message using Quick Reply.
- Customize a text response.



#### NOTICE

Apple® devices do not show historical data. The display will only show text messages received during the current drive cycle.

### **DEVICES**

From the Devices tab you can perform the following actions:

- Connect a device via Bluetooth®.
- View connected devices.

For steps on how to connect a device to the display, please see page 39.



## FEATURES AND CONTROLS

### SETTINGS BUTTON

The Settings Menu allows access to all of the information and settings that control your display.

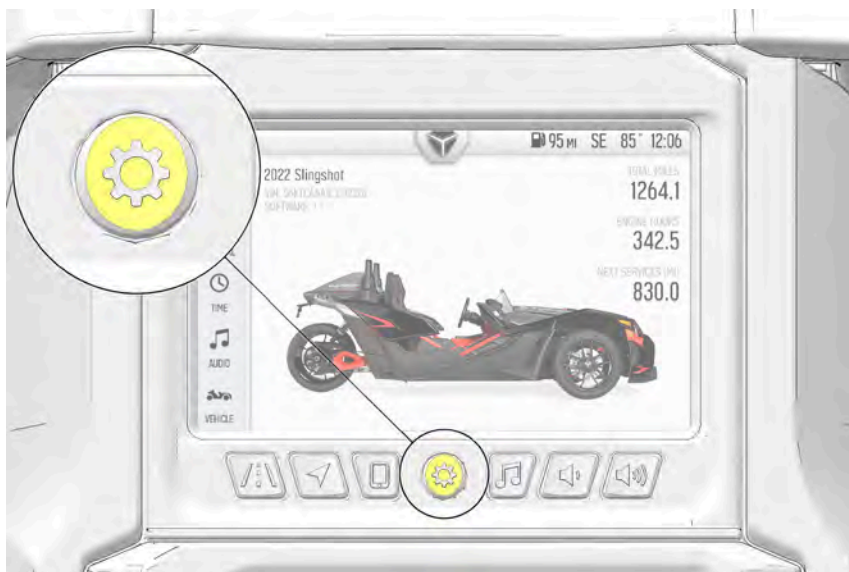

#### NOTICE

The Settings menu can also be accessed by pressing the Badge Panel at the top of the touchscreen display and selecting **All Settings**.

The Settings menu contains the following tabs:

- Info
- General
- Time
- Audio
- Vehicle







## FEATURES AND CONTROLS

### TIME

Select the Time tab to do the following:

- Sync clock with GPS satellite (if equipped).
- View the time zone.
- Choose between a 12- or 24-hour clock format.

Selecting “No” to satellite sync will display the following options:

- **Daylight Savings Time:** On or Off.
- **Set Time:** Adjust clock time.



### AUDIO

Select the Audio tab to do the following:

- Manually adjust equalizer settings.
- Choose from three Automatic Volume Control presets or turn function off.
- Clear radio tuner history by resetting radio presets.
- Set radio tuner region.



#### NOTICE

Selecting the wrong tuner region can affect the ability to pick up local radio stations.

### VEHICLE

The Vehicle tab in the Settings menu displays information regarding the state of your Slingshot vehicle. Select the Vehicle tab to view the following:

#### Passcode Unlock

When the key fob is not present, a passcode can be entered on the display to unlock the vehicle. If you don't know your passcode, contact your POLARIS dealer.

#### Oil Life/Service Reset

The Oil Life/Service Reminder will display when the vehicle is 300, 200, and 100 miles from service. This banner only displays once – after dismissing the banner, it will not show again. If you are overdue for an oil change, this reminder will display every time the vehicle is turned on.

#### GPS Status

Press the arrow icon to see a map of current GPS satellite connectivity.

#### Diagnostics

If, at any time, a blue warning banner appears on the bottom of your touchscreen, you can view the full warning on the Vehicle Diagnostics page.

- Press the arrow icon to open the diagnostics panel.
- To view a specific warning or error message, press the arrow icon within each row.
- For more information on vehicle diagnostic information, see your authorized Polaris Slingshot dealer.



#### Automatic Display Power Down

Disable automatic power down to keep the display on until manually powered off. To avoid draining the battery, ensure the vehicle is plugged into external power.

## FEATURES AND CONTROLS

### AUDIO BUTTON

The Audio Screen utilizes the Slingshot's radio, Bluetooth®, and USB port to provide audio and music through the built-in speaker system or through a Polaris-approved headset.



Your display offers the following audio options:

- FM Radio
- AM Radio
- Weather Radio
- USB/iPod®
- Bluetooth®



### RADIO

The display utilizes frequencies from five radio sources: AM, FM, MW (Medium Wave - Europe), LW (Long Wave - Europe), and WX (Weather). To access one of the available radio frequencies, press the Audio button, followed by the blue Source button to choose from AM, FM or weather radio.



### USB AUDIO

The display utilizes USB technology to play audio through the built-in speaker system or connected headset.

For more information on using USB devices with your display, see page 61.

Plug in audio devices through the USB port in the glove box.

From the USB Audio panel you can do the following:

- View the currently playing song and album.
- Control song selection and pause and play tracks.
- Repeat or shuffle audio tracks.
- Navigate to different folders on the USB device.



## FEATURES AND CONTROLS

---

### **BLUETOOTH AUDIO**

The display utilizes Bluetooth® technology to play audio through the built-in speaker system or any Polaris-approved Bluetooth® headset. For a list of supported devices, visit [ridecommand.slingshot.polaris.com/en-us/supported-devices](http://ridecommand.slingshot.polaris.com/en-us/supported-devices).

For more information on using Bluetooth® devices with your display, see page 50.

Make sure your device is paired to the display, see page 39 for directions.

From the Bluetooth® panel you can do the following:

- View the currently playing song and album.
- Control song selection and pause and play tracks.
- Repeat or shuffle audio tracks.



### VOLUME BUTTONS

The Volume buttons control the volume level of audio and music through the built-in speaker system or through a Polaris-approved headset.

#### Volume Decrease Button



#### Volume Increase Button



#### Volume Controls

- Press and hold volume buttons to rapidly increase or decrease volume.
- Press and release volume buttons to slowly increase or decrease volume.

#### NOTICE

Volume increase and decrease buttons are not compatible on all Bluetooth-enabled headsets. In such cases, audio volume must be controlled manually on headset hardware or through mobile device. For list of Polaris-approved headsets, visit [ridecommand.polaris.com/en-us/supported-devices](http://ridecommand.polaris.com/en-us/supported-devices).

## FEATURES AND CONTROLS

### REVERSE CAMERA (IF EQUIPPED)

#### NOTICE

The reverse camera is not intended to replace standard driving practices of checking your surroundings before operating in reverse. Always check for pedestrians, vehicles and other obstacles before operating in reverse.

View the image on the display screen as needed while operating in reverse. The camera and display screen automatically activate when the transmission is shifted to reverse gear. Do not operate the vehicle until the camera image is clearly shown on the display screen.



#### NOTICE

For Slingshot 2018–2019, the reverse camera is only engaged when the vehicle is in reverse. To use the reverse camera on Slingshot 2020–2023, the software will need to be updated to the April 2023 (SLS7AB.M32304A) update or greater.

To view the reverse camera when in drive:

1. Press the Settings button once to drop down the Badge panel.
2. Tap the Rear Camera symbol.

#### NOTE

If the vehicle is travelling above 8 mph (13), there will be a 10 second countdown until the back-up camera shuts off. If the vehicle is travelling below 8 mph (13), the camera will stay on continuously.



## OPERATION

### PAIRING YOUR DEVICE

The display is Bluetooth®-compatible. You can pair both Bluetooth®-enabled headsets and iOS® and Android® smartphones. Connecting a smartphone via Bluetooth® allows users to make and receive phone calls, send and receive text messages (when supported), browse recent calls, and access contacts from your display.

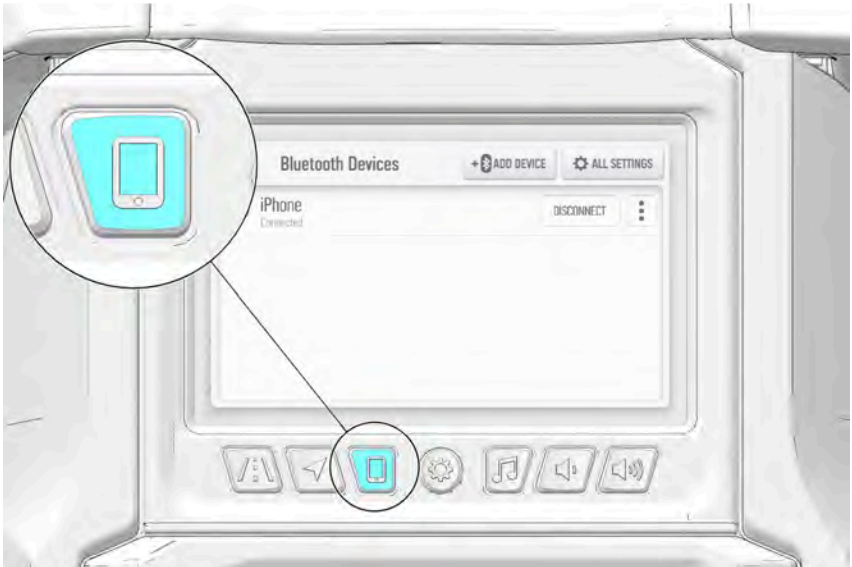

#### NOTICE

The ability to add or remove Bluetooth® devices is disabled while the vehicle is in motion.

## OPERATION

---

### IPHONE®

To pair your iPhone®, complete the following steps:

#### **ON YOUR IPHONE®**

- In your iPhone® settings, turn on Bluetooth®.
- If available, make your phone discoverable to other devices in your phone's Bluetooth® settings.

#### **ON THE DISPLAY**

- Press the **Device Manager** button on the Ride Command display.
- Select **Add Device** on the top of the menu.
- When your phone appears on the display, tap your phone's device name.
- Ensure the confirmation code on the screen and your phone are the same, then press **Pair** on your phone.

#### **ON YOUR IPHONE®**

- A prompt will appear on your iPhone® requesting permission to pair with your phone.
- Ensure the confirmation code on the screen and your phone are the same, then press **Pair** on your phone.
- For optimal experience, enable notifications and sync contacts from your phone's Bluetooth® settings.

#### **ON THE DISPLAY**

- Once the display says connected/paired, your phone is now connected to the display via Bluetooth®.

---

## ANDROID®

To pair your Android® device, complete the following steps:

### **ON YOUR SMARTPHONE**

- In your smartphone settings, turn on Bluetooth®.

#### NOTICE

On some phones, you have to make the phone visible to other devices. If your phone has this feature, it should show up on the Bluetooth® connection screen of your phone. If no option exists to make your phone visible to the display, it is already visible to the display.

- If available, make your phone discoverable to other devices in your Bluetooth® settings.

### **ON THE DISPLAY**

- Press the **Device Manager** button on the Ride Command display.
- Select **Add Device** on the top of the menu.
- When your phone appears on the display, tap your phone's device name.
- Ensure the confirmation code on the screen and your phone are the same, then press **Pair** on your phone.

### **ON YOUR SMARTPHONE**

- A request will appear to pair with "Polaris Slingshot". Ensure the confirmation code matches between the Ride Command display and your phone.
- Press **OK**.
- For an optimal experience, enable notifications and sync contacts from your smartphone's Bluetooth® settings.

### **ON THE DISPLAY**

- Once the display says connected/paired, your phone is now connected to the display via Bluetooth®.

## OPERATION

---

### HEADSETS

Listen to music, receive phone calls, and chat with a passenger by pairing your Ride Command display with any Polaris-approved Bluetooth® headset. For a list of supported devices, visit [ridecommand.slingshot.polaris.com/en-us/supported-devices](http://ridecommand.slingshot.polaris.com/en-us/supported-devices).

To connect your Bluetooth® headset to your display, do the following:

#### **ON YOUR HEADSET**

- Put your device into pairing mode.

#### **ON THE DISPLAY**

- Press the **Device Manager** button on the Ride Command display.
- Select **Add Device** on the top of the menu.
- When your device appears on the display, press the **+** button next to it to pair with your device.

#### NOTICE

For a better riding experience, connect your headset directly to the display, not your mobile device.

Once the headset is connected, the headset icon will appear in the upper left-hand corner of the display screen.



To choose between a headset and the built-in speaker system, return to the Device Manager menu, or press the Badge Panel at the top of the screen.

#### NOTICE

Volume increase and decrease buttons are not compatible on all Bluetooth®-enabled headsets. In such cases, audio volume must be controlled manually on headset hardware.

## MAKING A CALL

To make a call:

1. Press the **Device Manager** button on the display.
2. To return a call, press the **Recent** tab.
3. To make a new call from your contact list, press the **Contacts** tab, scroll to the contact you wish to call and select their name.
4. To dial a number, press the **Keypad** tab to enter a number manually.



## VIEWING TEXT MESSAGES

To view text messages:

1. Press the **Device Manager** button on the display.
2. Select the **Messages** tab to view your message history.
3. Select the name of the sender to view more options.



## OPERATION

---

### PLAY AUDIO

The display plays audio from AM, FM, weather radio bands, USB drives or devices, and Bluetooth®-enabled devices.



### RADIO

The Ride Command display utilizes frequencies from three radio sources:

- AM
- FM
- WX (Weather)

## FM AND AM RADIO

The radio screen displays the current station, song, and artist (if available).

### To change stations:

- Press **tune** ① icons, left or right, to change station frequency incrementally.
- Press **scan** ② arrows, left or right, to find the next available station with a clear signal.
- Press the **scan** ③ button to automatically tune to the next available FM or AM signal.
- Press a **station preset** ④ to jump directly to that station.



## WEATHER RADIO

There are seven weather stations available on the display. Press the tabs on the bottom of the screen to change weather stations.

### NOTICE

Depending on your location, not all stations may be within range.

## OPERATION

---

### ***RADIO SETTINGS***

#### SET STATION PRESETS:

Up to 18 radio stations can be preset on your display. To save your favorite radio stations, complete the following steps:

1. Use the tuner arrows to navigate to a station of your choice.
2. From the scrollable preset menu, hold down the tab labeled **Hold To Set**.
3. The radio station will be automatically saved.
4. Use the arrow buttons to page through presets.

#### OVERWRITE AN EXISTING PRESET:

1. Use the tuner arrows to navigate to a new station of your choice.
2. Press and hold down on the **Preset** button you wish to overwrite.

#### CLEAR STATION PRESETS:

1. Press the **Settings** button and navigate to the **Audio** tab.
2. Beside **Clear Radio Presets**, press the reset button.

#### CHANGE TUNER REGION:

1. Press the **Settings** button and navigate to the **Audio** tab.
2. Press the arrow button beside **Radio Tuner Region**.
3. Choose your region.



## USB AND IPOD® AUDIO

Music from a portable data storage device such as a USB flash drive, Apple iPod®, or other MP3 player, can be played through the display by connecting your device to the vehicle's USB port.



### CONNECT USB

To access USB or iPod® audio, complete the following steps:

- While your vehicle is stationary, connect your device through the USB port in the glove box in front of the passenger seat.
- Press the **Audio** button.
- Select the **USB/IPOD®** source.

#### NOTICE

Only audio content physically present on your data storage device will appear in the queue. For more information about connecting USB hardware to your Slingshot, see page 61.







### AUDIO FEATURES

Available audio features for USB and MP3 devices:

- Song duration and current progress.
- Audio browser by artist, album, song title and playlist, if available.
- Add or remove music from queue.
- Play and pause audio track.
- Play next or previous track.
- Rewind or fast-forward audio track.
- Repeat track or playlist.
- Shuffle tracks.

## OPERATION

### AUDIO CONTROLS

AUDIO FUNCTION	AUDIO ICON
<b>Play</b> To start a track, press the Play button from the bottom control bar of the touchscreen.	
<b>Pause</b> To pause or stop a track, press the Pause button from the bottom control bar of the touchscreen. The pause button will only appear if an audio track is in progress.	
<b>Next Track</b> To skip tracks or play the next song, press the Next Track button from the media control bar at the bottom of the touchscreen.	
<b>Previous Track</b> To restart an audio track, press the Previous Track button once. To play the previous track, press the Previous Track button twice.	
<b>Repeat Track/Playlist</b> To repeat an entire playlist, press the Repeat Track button once. To repeat just one track, press the Repeat Track button twice. A "1" will appear beside icon (shown right).	
<b>Shuffle</b> To shuffle a playlist, press the Shuffle Button from the right-hand control bar of the touchscreen.	
<b>Song Queue</b> To access individual audio files, select the Song Queue button on the media controls at the bottom of the touchscreen.	

### SONG QUEUE

Pressing the Song Queue button (shown above) allows users to browse all available songs from the USB device or create a custom playlist.

## View Playlist

1. Press the **Song Queue** button from the bottom of the audio screen.
2. Remove files from the song queue by pressing “X” next to the title.



## Create Playlist

1. Press the **Song Queue** button from the bottom of the audio screen.
2. Search for the desired audio files by artist, albums, or song.
3. Beside song selection, press the title or options button ①.
4. Add a track to a playlist:
  - a. To start a new playlist, press **Clear and Play**. The present playlist will be deleted and replaced by this track.
  - b. To add to an existing playlist, press **Add To Queue**. The track will be added to the bottom of the song queue.



## OPERATION

### BLUETOOTH® AUDIO

#### NOTICE

To ensure your device is connected, press the **Device Manager** button on the display. Press the **Devices** icon, and confirm your device is listed with “Connected” displayed below it. If “Disconnected” is displayed, select your device while its Bluetooth® is active.

To play audio from a streaming service, do the following:

1. On your Bluetooth® device, open the streaming service app and select desired audio.
2. Press the **Audio** button on your display.
3. Select the **Bluetooth®** source.
4. Use the play and skip buttons to play/pause and go to next/previous song.
5. Use the repeat and shuffle buttons to repeat and shuffle songs from the device.



#### NOTICE

For additional direction on pairing Bluetooth® devices, see page 39.

## NAVIGATION ROUTING

### ROUTING WINDOW

Your navigation routing window displays as follows:

- ① Estimated time of day when you will reach your destination.
- ② Estimated time to your destination.
- ③ Distance to your destination.
- ④ Name of the roadway of your next turn.
- ⑤ Direction of your next turn.
- ⑥ Distance to your next turn.



### MAP CONTROLS

Your navigation controls (if equipped) are as follows:

- ① **X icon:** Pause or end route navigation.
- ② **Menu icon:** Access full route instructions.



#### NOTICE

If there are multiple stops in your route, this button will appear as a waypoint icon. Pressing the waypoint icon will allow you to skip or edit stops along the route.

## OPERATION

### PLAN A TRIP

If equipped, the navigation functionality of your display allows you to input directions to specific addresses and points-of-interest in your area. The display uses read-aloud capability in addition to the on-screen navigation. Read-aloud directions will play through either a headset or built-in speaker system.

#### WARNING

Do not enter information while operating your vehicle. Failure to pay attention to the operation of your vehicle could result in loss of control, injury, or death.

You assume all risks associated with using this device. Read your User's Guide thoroughly and always ride with the latest maps and road data from [ridecommand.slingshot.polaris.com](http://ridecommand.slingshot.polaris.com).

To get started, press the Navigation button (shown below) on your display.

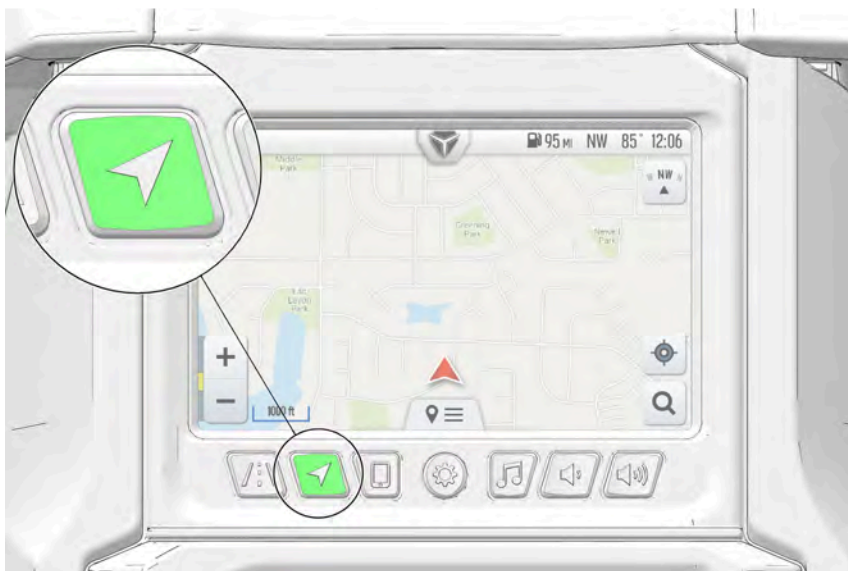

## KEYBOARD

1. Press the **Navigation** button.
2. Select the **Search** icon from the lower right corner of the touchscreen.
3. Touch the **Search Bar** ① from the navigation pop-up menu to bring up the keyboard.



### NOTICE

Pressing the **X** will close out of the navigation search screen and take you back to the map screen.

4. You can enter an address or the name of the place you wish to go to in the search box and press the **Search** ② button in the lower right of the screen to bring up a list of possible destinations.



# OPERATION

## POINTS OF INTEREST (POI)

Points of Interest (POI) ① are specific destinations you may find useful or interesting, such as gas stations and restaurants. Your display includes a searchable list of POIs to assist you when traveling.

The example below explains how to use the Gas Station tab. The other POI buttons operate similarly.

The gas tab displays a list of gas stations near your vehicle's location. To route to a gas station, complete the following steps:

1. Press the **Navigation** button.
2. Select the **Search** icon from the lower right corner of the touchscreen.
3. Press the **Gas Stations** from the navigation pop-up menu.
4. Select a gas station from the list of nearby stations.
5. Press the **Route** ② button to begin navigation.





## HOME

You can set a location as your “home” waypoint. Use this button to navigate to your house quickly.

Select the **Set Home** button to do the following:

- Set a home waypoint.
- Navigate to your home waypoint.



## SAVED ROUTES

The Saved tab stores all your previously saved destinations and routes.

How to access your saved routes:

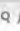
1. Press the **Navigation** button on the display.
2. Press the **Search** icon from the lower right corner of the touchscreen.
3. Press the **Saved**  from the navigation pop-up menu.



## OPERATION

4. Select a destination from the list and confirm route.



### NOTICE

Edit route names by pressing the **Gear** (settings) icon in the upper right-hand side of the screen.

Select the Saved tab to do the following:

- View saved destinations and routes.
- Tap a destination or route to start new navigation.
- Press the **X** button to remove routes and destinations from the Saved tab.
- Edit route names.
- Press the USB button to export favorite routes to an external flash drive.

### NOTICE

If you attempt an export without a flash drive, an error message will appear on-screen.

## RECENT ROUTES

The Recent tab displays a list of previously routed destinations.

To route to a recent destination, complete the following steps:

1. Press the **Navigation** button on the display.
2. Press the **Search** icon from the lower right corner of the touchscreen.
3. Press **Recent** ① from the navigation pop-up menu.
4. Once a destination has been selected, press the **Route** button to begin navigation.



### NOTICE

To save a destination, press the corresponding **Heart** icon.

### **GPS MAPPING**

#### *NOTICE*

The compass is controlled by the global positioning system (GPS), if equipped.  
Calibration is not required.

Use the compass and full-featured GPS when the GPS receiver is installed (includes the display of latitude, longitude, and elevation). Mark and save waypoints and drives.

## MAINTENANCE

### CARE AND MAINTENANCE

To clean the display shell, use a soft cloth with mild soap and water. Do not use harsh or abrasive cleaners. For best results, use a micro-fiber towel to clean the screen. Window cleaner or alcohol may also be used.

#### NOTICE

Immediately clean off any gasoline that splashes on the display.

### SPEED LIMITATIONS

Bluetooth® pairing and use of keyboards are unavailable while Slingshot is in motion.

### CREATE ACCOUNT

You can create a personalized Ride Command account either by computer at <https://ridecommand.slingshot.polaris.com> or in the Slingshot Ride Command app, which can be downloaded to your personal device through your phone's app store.

### ON YOUR COMPUTER

#### Create Account

1. Open your preferred internet browser and navigate to <https://ridecommand.slingshot.polaris.com>.
2. From the top menu bar, click **Create Account**.
3. In the popup, type your email address and password.
4. Accept the Terms of Service agreement.
5. You should receive a confirmation email from Polaris within 24 hours of creation.

#### Add Your Slingshot

6. After signing into your Ride Command account, click on **Garage** from the top menu bar.
7. Type in the vehicle identification number (VIN).
8. Add a vehicle nickname, such as **My Slingshot**.
9. Press the **Add My Vehicle** button.

## MAINTENANCE

---

### ON YOUR DEVICE

#### Create Account

1. Download the Slingshot Ride Command app from your phone's application store.
2. In the app, press the **Sign Up** button.
3. You may be prompted that "Ride Command" wants to share information between the app and website for sign on purposes. Click **Continue**.
4. Type your email address and password.
5. Accept the Terms of Service agreement.
6. You should receive a confirmation email from Polaris within 24 hours of creation.

#### Add Your Slingshot

7. Press the **+** button on the home screen, or select **Add Slingshot** from the options menu.
8. Connect your phone to your vehicle via Bluetooth® or press the **Enter Your VIN** button.
9. Type in your vehicle's VIN.
10. Add a vehicle nickname, such as **My Slingshot**. This is optional.
11. Press **Next** from the top ribbon.

## USB HARDWARE

### NOTICE

POLARIS recommends using this flash drive for all updates and storage with your display.

### NOTICE

Prior to downloading a software or map update to your USB flash drive, ensure that the flash drive is empty of all other files. If other files are present, the Map Toolbox will be unable to read the key from the display.

For software updates, the display requires the use of a USB drive and external computer. The display system functions solely with Tier 1 quality data storage. POLARIS recommends using, at minimum, a Kingston®, SanDisk®, or similar Tier 1 USB flash drive between 8GB and 16GB in available memory, formatted using the FAT32 or exFAT file system depending on the update needed. Drives with higher data capacity are not compatible with the display system. For best results, remove all files from the flash drive before starting the update process.

### IMPORTANT

Due to harsh riding environments, POLARIS recommends using USBs with retention features.

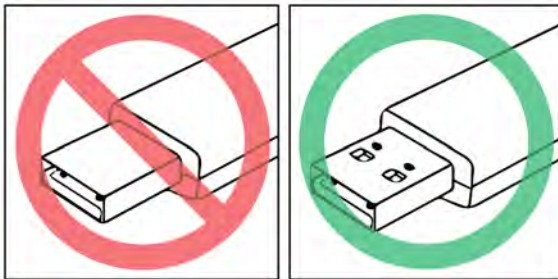

### ⚠ CAUTION

Ensure the ignition is completely off prior to disconnecting the flash drive from USB port. Disconnecting with the vehicle on may cause damage to the flash drive or stored files.

## MAINTENANCE

---

### UPDATE SOFTWARE

Slingshot features Over-the-Air (OTA) update capability. An OTA update pushes new features, improved functions, and bug fixes to the display, and occurs automatically when the vehicle is connected to the cellular network. OTA updates occur seamlessly, without the need to download, refresh, or take any actions to activate an update.

#### NOTICE

Before updating the display, always export your existing drives and waypoints to a secondary USB drive to avoid losing them. Do not save them to the same USB used for installing the software update. You must use an empty USB drive for all software and map updates.

#### Slingshot 2017–2019

	USB Hardware
Software Update	8GB USB formatted to FAT32
Map Update	8GB USB formatted to FAT32

#### Slingshot 2020 or newer

	USB Hardware
Software Update	1GB or larger USB formatted to exFAT®
Map Update	32GB or larger USB formatted to exFAT®

To update the display software, complete the following steps:

### ON YOUR PERSONAL COMPUTER

1. Go to [ridecommand.slingshot.polaris.com/en-us/ridecommand](https://ridecommand.slingshot.polaris.com/en-us/ridecommand).
2. Log in to your account, or create a new account.
3. Using the Vehicle Identification Number (VIN), add your new Polaris Slingshot to your Garage.
4. Locate and download the latest software to a USB flash drive.

#### NOTICE

For optimal download speed and connection stability, it is recommended to have a wired internet connection to your personal computer while downloading updates to your USB flash drive.



## ON YOUR SLINGSHOT

1. Connect the USB flash drive to the port in the glove box and power up your vehicle.
2. On the display, press the Badge Panel button at the top of the screen, followed by the Gear button.
3. Select General Settings, then Update Software.
4. Select the file you wish to load (use the date listed in the file name to determine the most recent file).
5. Select “Yes” to restart the display (restart required).
6. After your display has restarted and you’ve determined the update to be successful, power down your vehicle prior to disconnecting your USB flash drive from the port in the glove box.

## ERROR MESSAGES

If an error occurs while updating your software, perform one or all of the following measures to resolve the issue:

1. Ensure you are using a Tier 1 USB flash drive. Using the Slingshot-branded USB drive included with your Slingshot is recommended. For more information on USB requirements, see page 61.
2. Remove and reconnect the USB flash drive securely.
3. Ensure display files are not inside a folder on the flash drive.
4. Only Slingshot display files should be on the flash drive while performing updates. Remove other files, if necessary.
5. Ensure the capacity of data on the flash drive is not exceeding 16GB.
6. Format the USB drive on your personal computer using the FAT32 or exFAT® formatting system.
7. Try a different USB flash drive.

## UPDATE MAPS

For information on how to update your display’s map data, please visit <https://ridecommand.slingshot.polaris.com/en-us/app/display/> for detailed instructions.

### **RIDE COMMAND+**

Your vehicle may come equipped with RIDE COMMAND+ technology, which gives you access to your vehicle's custom information including Vehicle Health, Vehicle Locator and Issue Diagnostics along with a variety of features via the Indian mobile app. You will need a cellular connection to view these features.

To learn more about RIDE COMMAND+, including equipped or compatible vehicles, specific features, and to access the RIDE COMMAND+ User Guide, visit [ridecommand.slingshot.polaris.com](http://ridecommand.slingshot.polaris.com) or scan the QR code:



*Disclaimer: RIDE COMMAND+ only available in North America.*

---

## FREQUENTLY ASKED QUESTIONS

### 1. How do I know whether my software is up-to-date?

Open Settings from the Badge Panel. Navigate to the General Settings tab. Press **Update Software**. The display will verify whether an update is needed.

### 2. How do I update my display software?

If your software is out-of-date, log in to your Ride Command account on your computer at [ridecommand.slingshot.polaris.com](http://ridecommand.slingshot.polaris.com) to download the latest software data. Transfer the files to a USB flash drive, then connect the USB flash drive to the port in the glove box. For detailed instructions, see page 62.

### 3. How do I update my map on the display?

Map data is only considered valid for up to one year. It is important to keep the map data on your display up-to-date to ensure driver safety and prevent getting lost while driving. Log in to your Ride Command account at [ridecommand.slingshot.polaris.com](http://ridecommand.slingshot.polaris.com) to download the latest map data. Transfer the files to the Display using your Slingshot-provided USB flash drive. For detailed instructions, see page 63.

### 4. Why can't my display acquire a satellite signal?

Drive the vehicle to an area free of overhead obstructions.

The GPS may take several minutes to lock on signal if the vehicle has been sitting cold. Let the system warm up for a few moments before troubleshooting.

### 5. My phone is Bluetooth®-enabled. How do I connect it to my Ride Command display?

Depending on the brand or model of phone, there are varying processes to connect to Bluetooth® on the display. See page 26 for detailed instructions on pairing your mobile device. For specific Bluetooth® functionality related to your smartphone, refer to your device's user manual.

### 6. How do I adjust the screen brightness on my display?

To adjust the brightness of your screen, tap the **Slingshot** logo icon at the top of the display screen. Adjust the slider to the desired brightness.

### 7. How do I set the clock?

Press the Time tab of the Settings menu. Set the time zone for your location. GPS automatically sets the clock when there is a locked GPS signal.

### 8. Why isn't navigation working on my display?

The navigation kit does not come standard on select Slingshot models. To purchase a navigation kit, visit your authorized Polaris dealer or visit [slingshot.polaris.com/en-us/shop/accessories](http://slingshot.polaris.com/en-us/shop/accessories) to get started.



<b>A</b>		<b>G</b>	
Audio Button		GPS Mapping .....	58
Bluetooth® Audio .....	36		
Radio .....	35		
USB Audio .....	35		
<b>B</b>		<b>I</b>	
Badge Panel.....	16	Icon Bar.....	15
Before You Drive .....	7		
Buttons .....	17		
Audio Button.....	34		
Device Manager Button .....	26		
Driver Button .....	19		
Navigation Screen .....	22		
Settings Button .....	30		
Volume Buttons.....	37		
<b>C</b>		<b>M</b>	
Care and Maintenance .....	59	Making a Call.....	43
Copyright Information .....	2	Map Orientation .....	24
Create Account .....	59		
<b>D</b>		<b>N</b>	
Device Compliance Statements .....	8	Navigation Routing .....	51
Device Manager Button		Navigation Zoom.....	23
Contacts.....	27		
Devices .....	29		
Keypad .....	28		
Recent Calls.....	27		
Text Messages.....	28		
Device Operating Requirements .....	8		
Driver Screens			
Customize Driver Screen .....	21		
<b>F</b>		<b>O</b>	
FAQ.....	65	Overview .....	15
		<b>P</b>	
		Pairing Your Device.....	39
		Android® .....	41
		Headsets .....	42
		iPhone® .....	40
		Plan A Trip .....	52
		Home.....	55
		Map Controls .....	51
		Points of Interest (POI) .....	54
		Recent Routes .....	57
		Routing Window .....	51
		Saved Routes .....	55
		Play Audio .....	44
		Bluetooth® Audio .....	50
		Radio .....	44
		USB and iPod® Audio .....	47
		<b>R</b>	
		Radio	

---

FM and AM Radio.....	45
Radio Settings .....	46
Weather Radio.....	45
Regulatory Information .....	11
Reverse Camera .....	38
RIDE COMMAND+ .....	64

## S

Safety Symbols.....	4
Search .....	25
Keyboard.....	53
Settings Button .....	33
Audio .....	32
General .....	31
Info.....	31
Time .....	32
Signal Words.....	4
Slingshot Logo Menu	
Controls Tab.....	16
Notifications Tab.....	16
Speed Limitations.....	59

## U

Update Maps.....	63
Update Software .....	62
USB Hardware.....	61

## V

Vehicle .....	33
Viewing Text Messages .....	43

## W

Warning Symbols .....	4
-----------------------	---





**SLINGSHOT**

For your nearest Polaris dealer,  
call 1-800-POLARIS (765-2747)  
or visit [www.polaris.com](http://www.polaris.com)

Polaris Industries Inc.  
2100 Highway 55  
Medina, MN 55340



Part No. 9930830 Rev 03  
Printed in USA