

BUMPER MOUNT KIT



P/N 2889566

BEFORE YOU BEGIN

Read these instructions and check to be sure all parts and tools are accounted for. Please retain these installation instructions for future reference and parts ordering information.

APPLICATION

Verify accessory fitment at www.polaris.com.

KIT CONTENTS

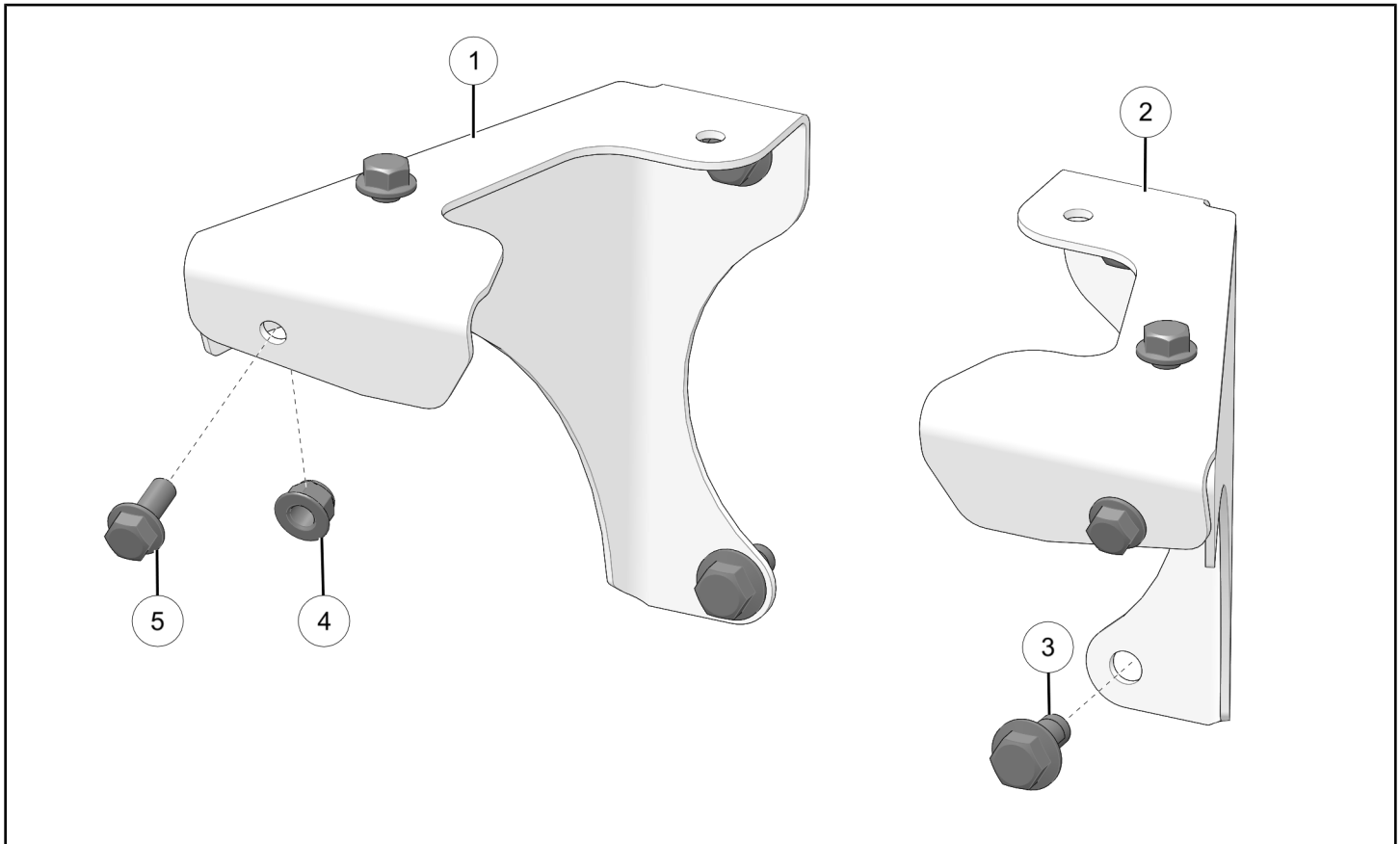

REF	QTY	PART DESCRIPTION	P/N AVAILABLE SEPARATELY
1	1	Bracket-Bumper, Right	5267508
2	1	Bracket-Bumper, Left	5267507
3	4	Screw-Hex Flange, M10 x 1.5 x 20 mm	7518460
4	4	Nut-Flange, M8 x 1.25 mm	7547332
5	4	Screw-Hex Flange, M8 x 1.25 x 20 mm	7518702

TOOLS REQUIRED

- Safety Glasses
- Socket Set, Metric
- Socket Set, Torx® Bit
- Torque Wrench
- Wrench Set, Metric

IMPORTANT

Your Bumper Mount Kit is exclusively designed for your vehicle. Please read the installation instructions thoroughly before beginning. Installation is easier if the vehicle is clean and free of debris. For your safety, and to ensure a satisfactory installation, perform all installation steps correctly in the sequence shown.

INSTALLATION INSTRUCTIONS

VEHICLE PREPARATION

GENERAL

1. Park vehicle on a flat surface.
2. Shift vehicle into PARK.
3. Turn key to OFF position and remove key.

FRONT FASCIA REMOVAL

1. Remove two plugs from front fascia.

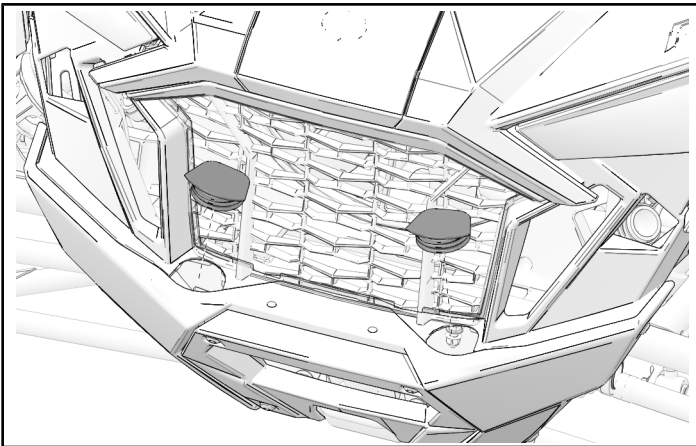

2. Remove two top mounting fasteners (longer) and two bottom mounting fasteners (shorter) to remove front fascia from vehicle.

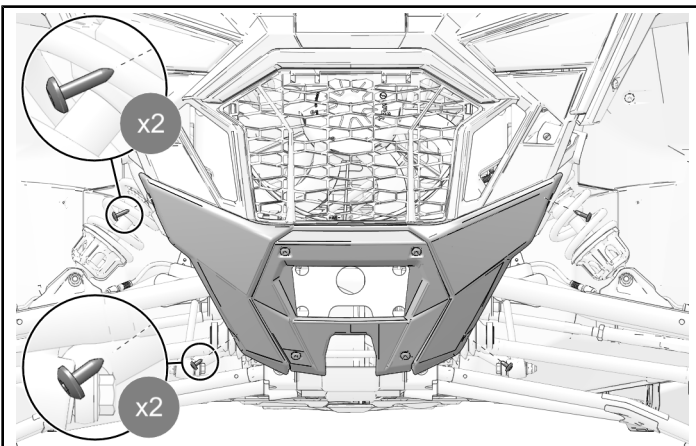

GRILLE REMOVAL

1. Push two tabs down to remove grille.

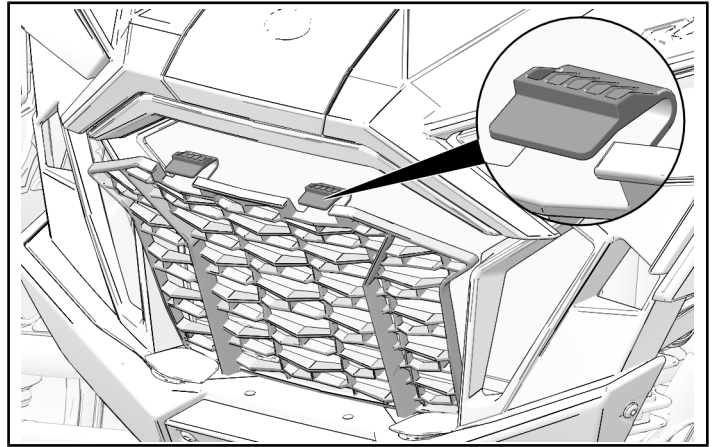

ACCESSORY INSTALLATION

BUMPER MOUNT INSTALLATION

1. Install right bumper mount ① and left bumper mount ② with four screws ③. Torque screws to specification.

TORQUE

Bumper Mount Screws ③:
30 ft-lbs (40 N·m)

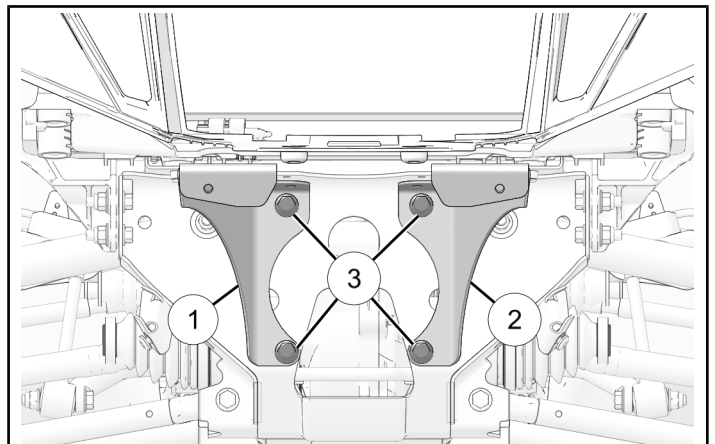

EXAMPLE ACCESSORY BUMPER INSTALLATION

NOTICE

Spare hardware is included in this kit for accessory bumper installation. Torque specifications are provided below. Example bumper shown; others similar. Refer to instructions provided with bumper for complete installation procedures.

1. Install top of bumper with two bolts ⑤ and two nuts ④. Counter-hold nuts and torque two bolts to specification.

TORQUE

Bumper Bolts ⑤:
15 ft-lbs (20 N·m)

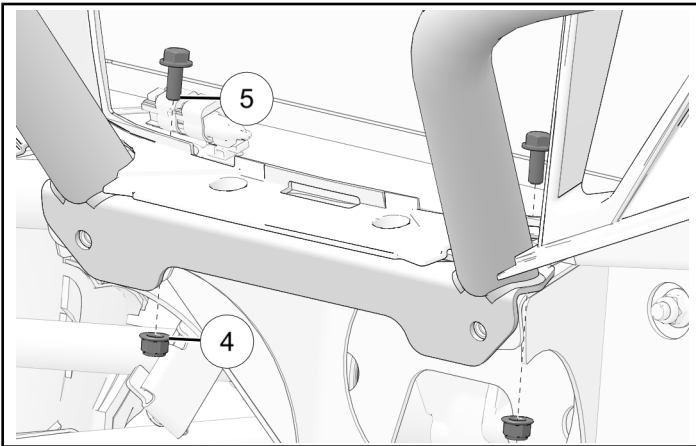

2. Install front of bumper with two bolts ⑤ and two nuts ④. Counter-hold nuts and torque two bolts to specification.

TORQUE

Bumper Bolts ⑤:
15 ft-lbs (20 N·m)

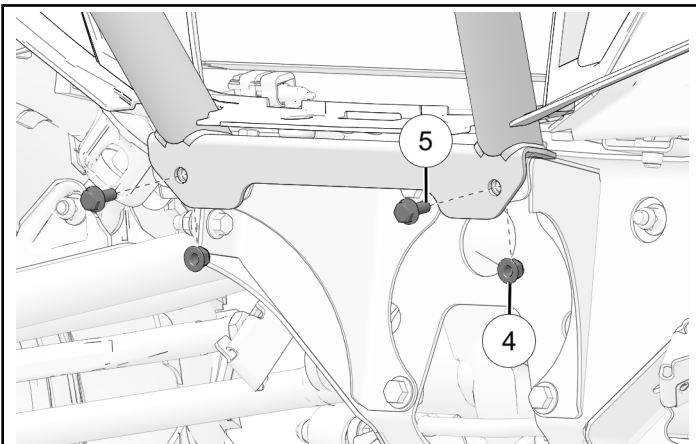

VEHICLE REASSEMBLY

GRILLE INSTALLATION

1. Put bottom of grille in first and push top of grille in until two tabs engage upper front fascia.

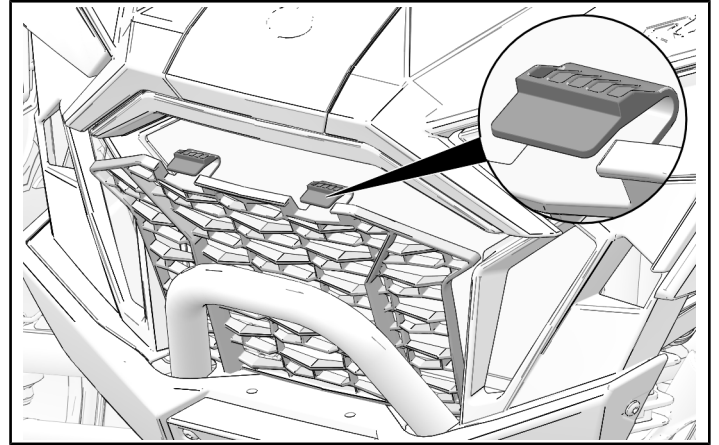

FRONT FASCIA INSTALLATION

1. Reinstall top front fascia with retained fasteners (longer).

TORQUE

Top Fascia Fasteners (longer):
7 ft-lbs (10 N·m)

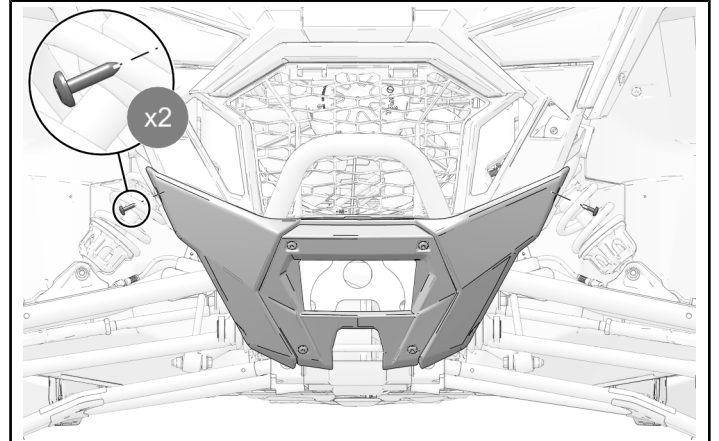

2. Reinstall bottom front fascia with retained fasteners (shorter).

TORQUE

Bottom Fascia Fasteners (shorter):
7 ft-lbs (10 N·m)

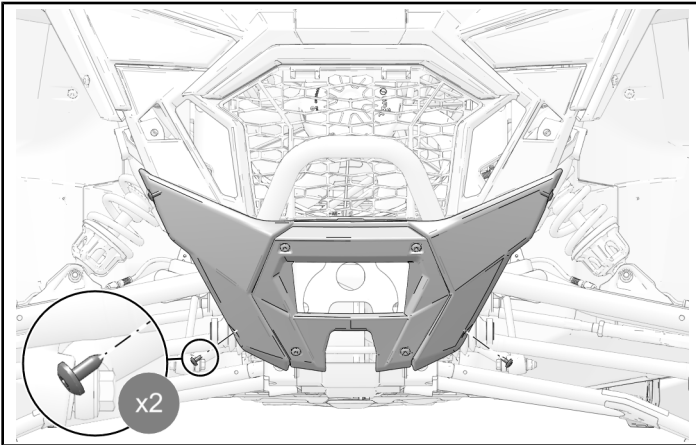

INSTRUCTION FEEDBACK FORM

A feedback form has been created for the installer to provide any comments, questions or concerns about the installation instructions. The form is viewable on mobile devices by scanning the QR code or by clicking [HERE](#) if viewing on a PC.

