

MAXTRAX® TRACTION BOARDS KIT



P/N 2890646

MISSING OR DAMAGED PARTS

Before beginning assembly, inspect the kit and its component(s) to be sure all parts and tools are accounted for and not damaged. If missing parts or parts are damaged, please contact your Selling Dealer for assistance.

If your accessory was purchased online, please contact POLARIS® customer service at **1-800-POLARIS** (US & Canada only).

APPLICATION

Verify accessory fitment at www.polaris.com.

KIT CONTENTS

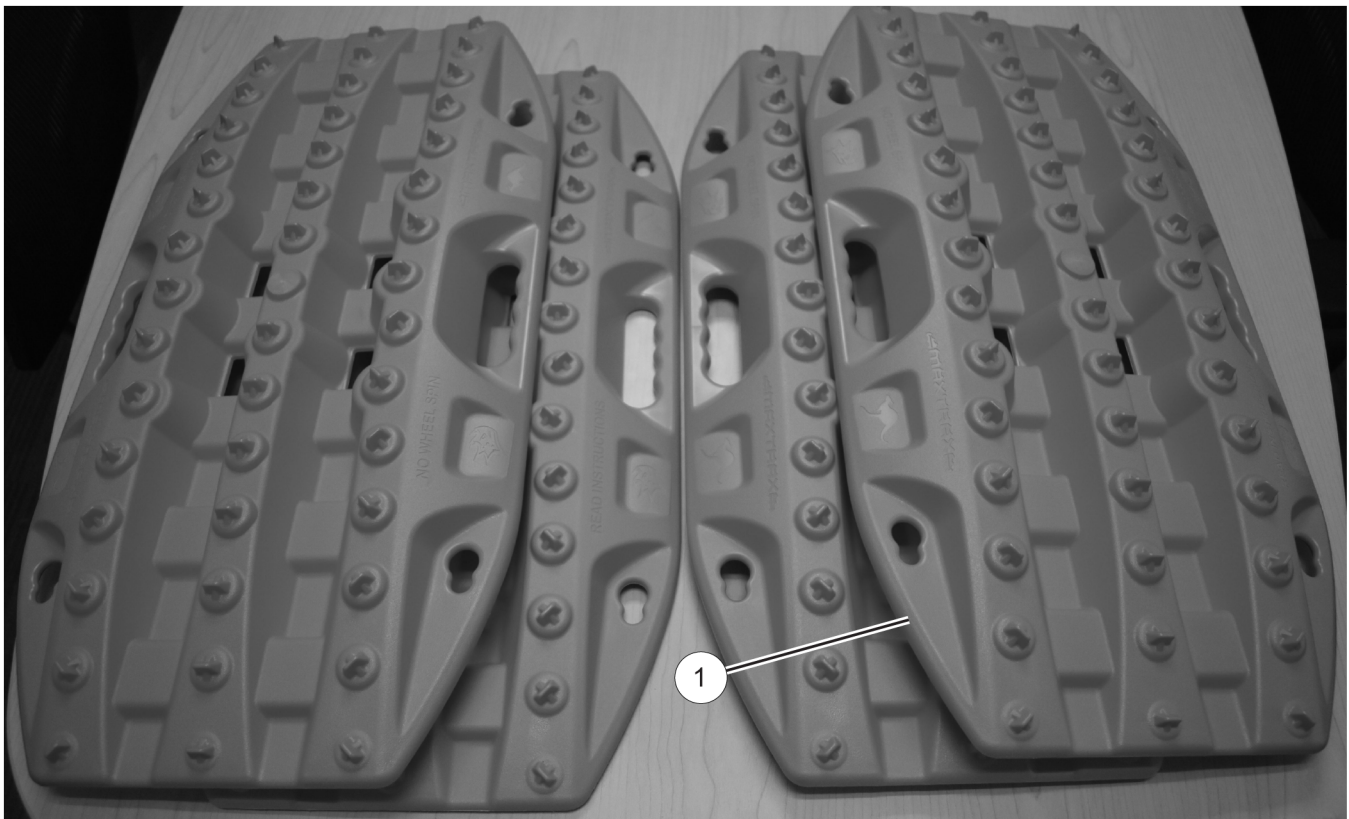

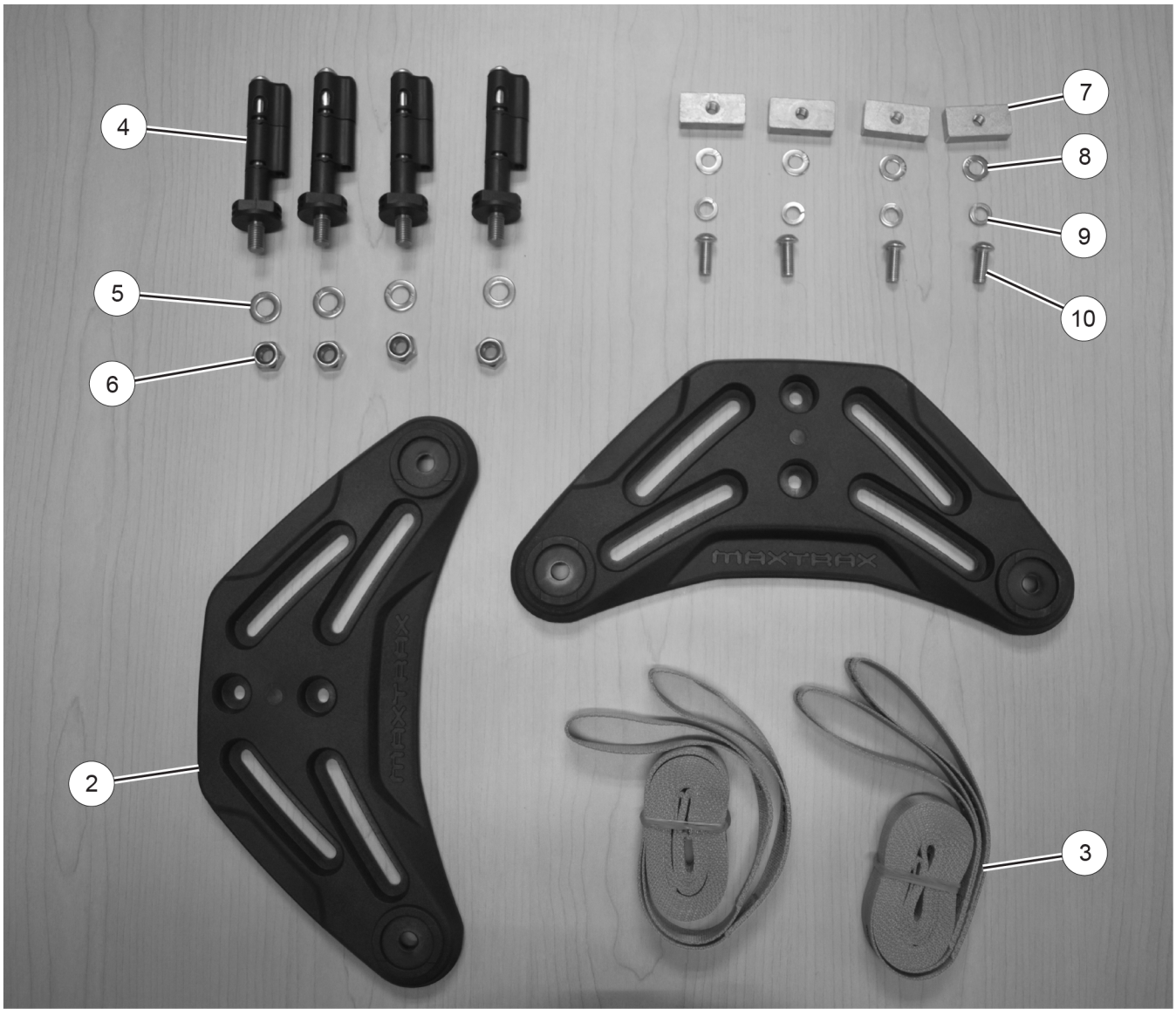

REF	QTY	PART DESCRIPTION	P/N AVAILABLE SEPARATELY
1	4	MAXTRAX® Traction Board	n/a
2	2	Mounting Base	n/a
3	4	Strap	n/a
4	4	Mounting Pin	n/a
5	4	Flat Washer M10 mm	n/a
6	4	Nut, Locking M10 x 1.5 mm	n/a
7	4	T-Nut M8 x 1.25 mm	n/a
8	4	Flat Washer M8 mm	n/a
9	4	Lockwasher M8 mm	n/a
10	4	Screw, Hex Button Head M8 x 1.25 x 20 mm	n/a

TOOLS REQUIRED

- Safety Glasses
- Hex Key Set, Metric
- Socket Set, Hex Bit, Metric
- Torque Wrench
- Wrench Set, Metric

IMPORTANT

Your MAXTRAX® Traction Boards Kit is exclusively designed for your vehicle. Please read the installation instructions thoroughly before beginning. Installation is easier if the vehicle is clean and free of debris. For your safety, and to ensure a satisfactory installation, perform all installation steps correctly in the sequence shown.

INSTALLATION INSTRUCTIONS

VEHICLE PREPARATION

GENERAL

1. Park vehicle on a flat surface.
2. Shift vehicle into PARK.
3. Turn key to OFF position and remove key.

ACCESSORY INSTALLATION

MOUNT ASSEMBLY

1. Assemble two lockwashers ⑨ to two screws ⑩.

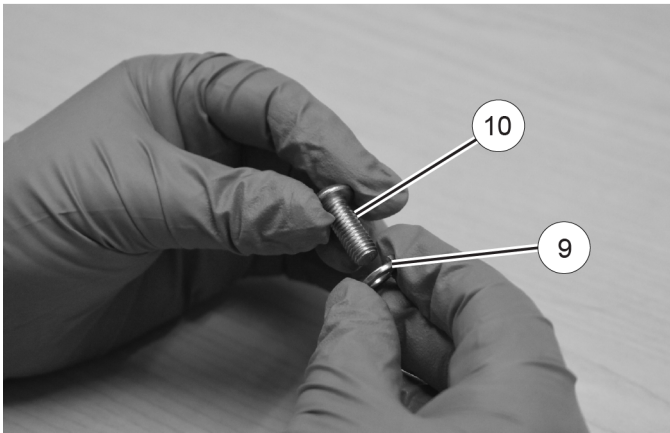

2. Assemble two flat washers ⑧ to two screws ⑩.

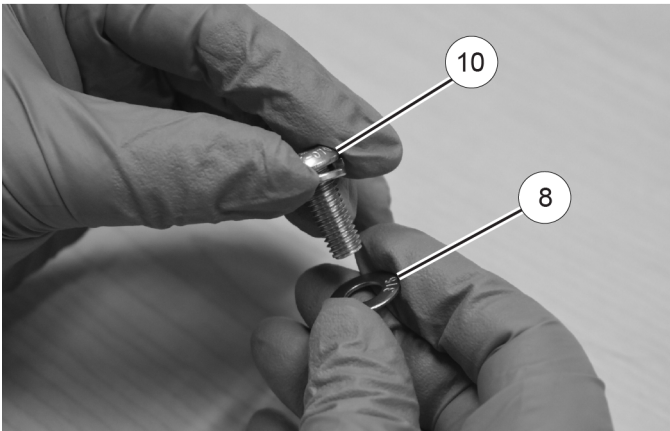

3. Install two screws ⑩ into mounting base ②.

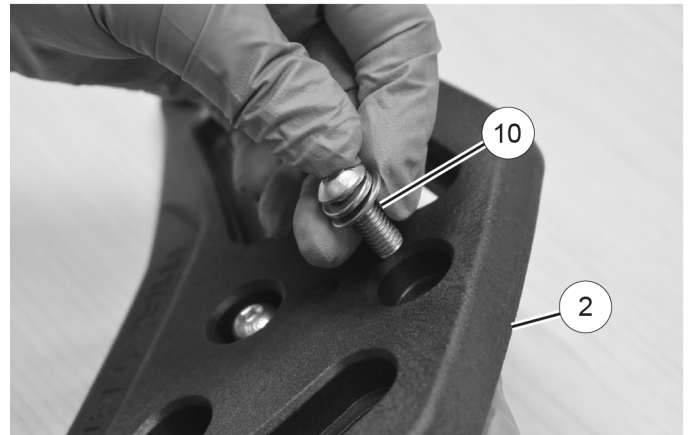

4. Install T-Nut ⑦ onto each screw.

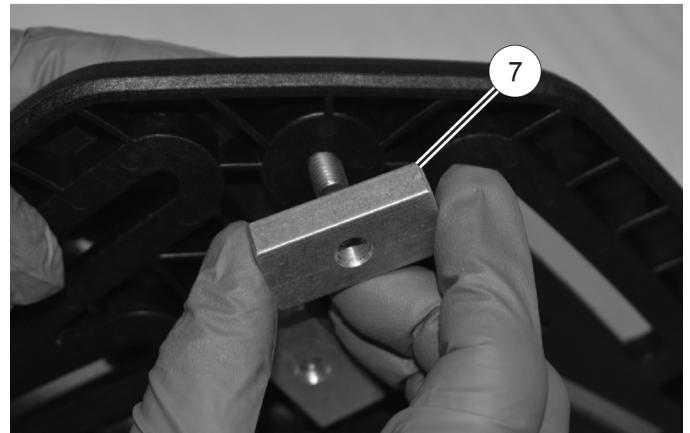

5. Remove locking nut ⑥ from each mounting pin ④. Leave flat washer ⑤ on stud of mounting pin.

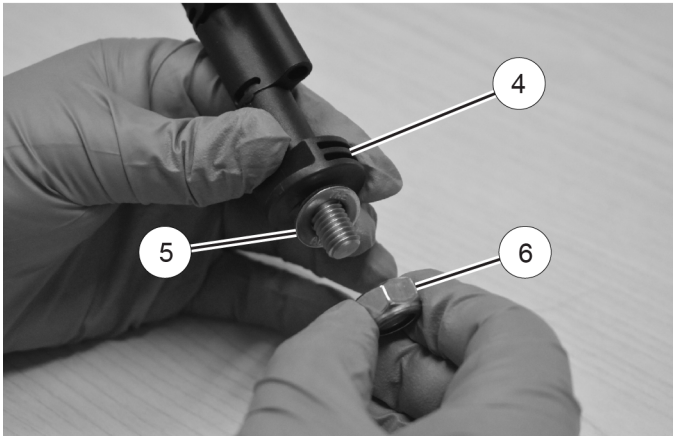

8. Tighten mounting pins ④. Tighten until mounting pin is tight and flats on mounting pin line up with lines on mounting base ②.

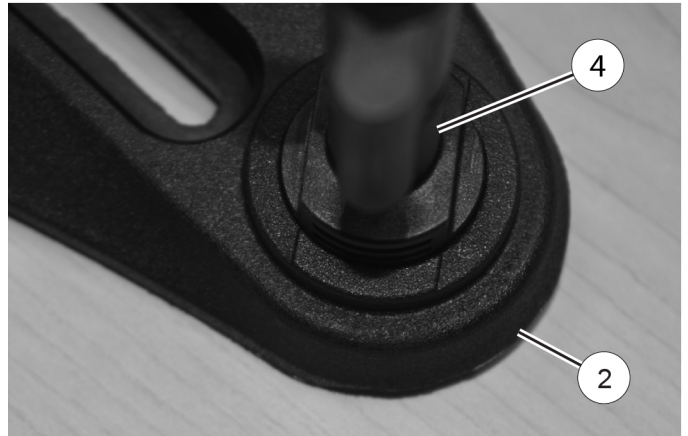

6. Install mounting pins ④ and washers through holes on mounting base ②.

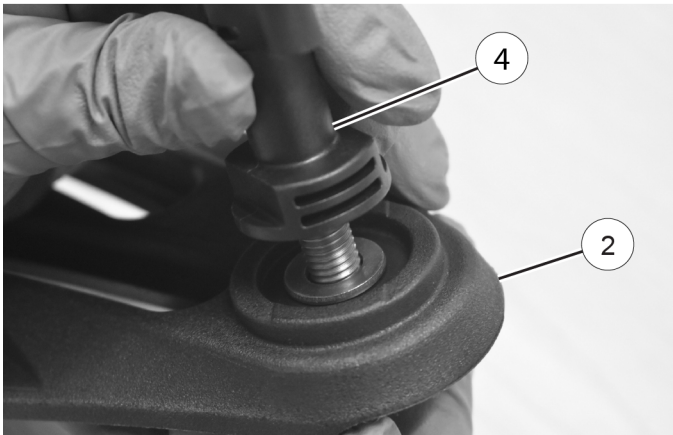

9. Repeat steps to assemble second mounting base ②.



7. Install locking nut ⑥ into opposite side of mounting base ②. Make sure nylon insert in nut faces away from mounting base.

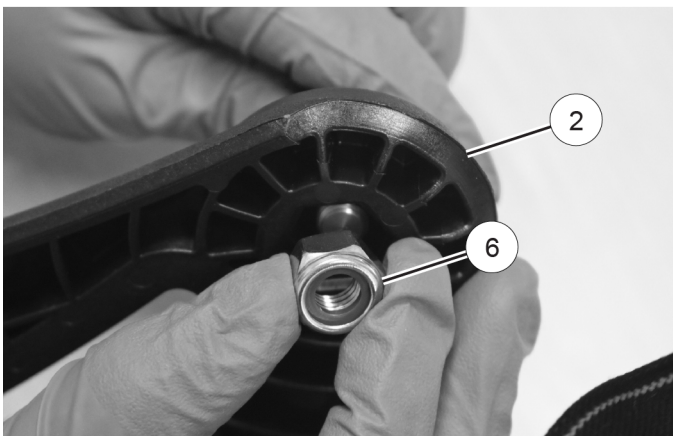

MOUNT INSTALLATION

There are two types of traction boards in this kit. Traction board **A** has extra ribbing on bottom, allowing board to be used as support for a jack or similar use. There is one board of this type in kit. Traction board **B** does not have additional ribbing. There are three boards of this type in kit.

When stacking traction boards, board **A** must be on bottom of stack.

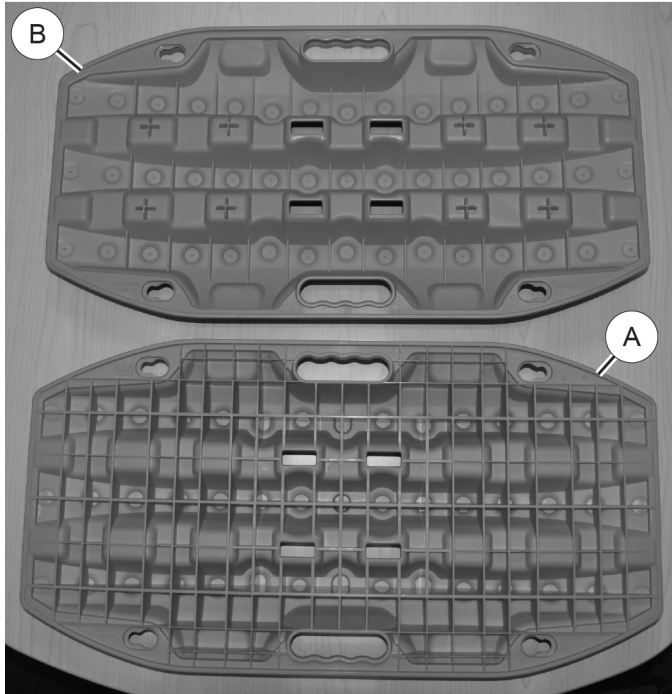

1. Set mounting bases **2** on a flat surface, with the smaller sides facing each other.

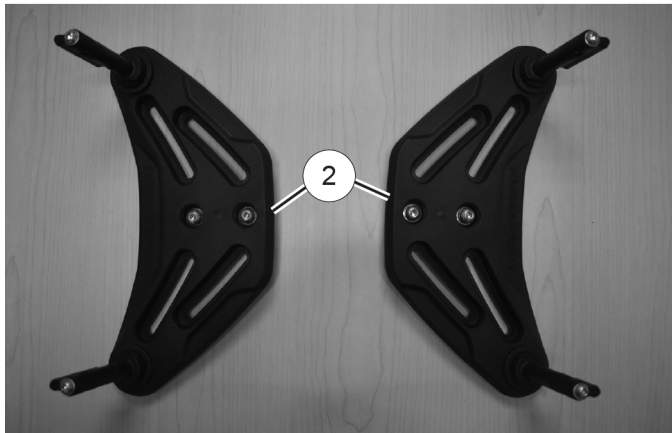

2. Install two traction boards on mounts.



3. Turn tabs on each mounting pin **4** to lock traction boards on mounts.

NOTICE

There are two tabs on each mounting pin. Use lower tabs when stacking two traction boards. Use upper tabs when stacking four traction boards.

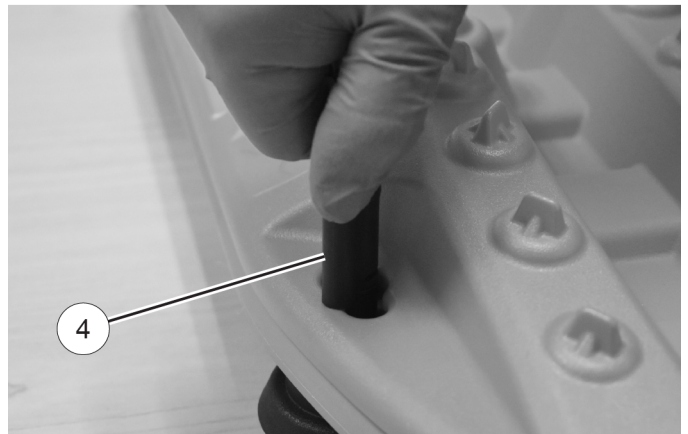

4. Remove rubber bumper from rear of cargo bed rail.

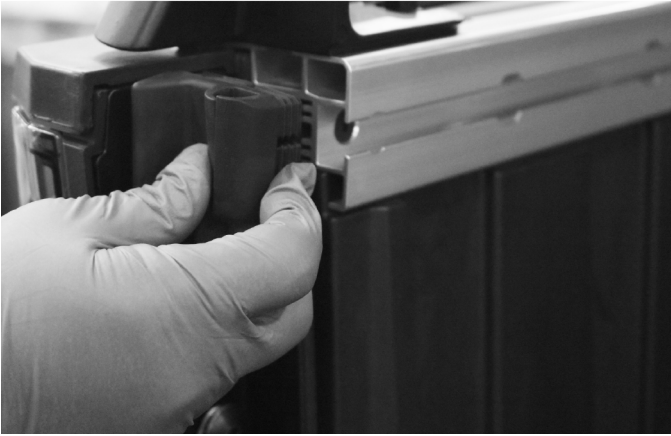

5. Install mounts ② to rail. T-nuts ④ will slide into opening in rail.

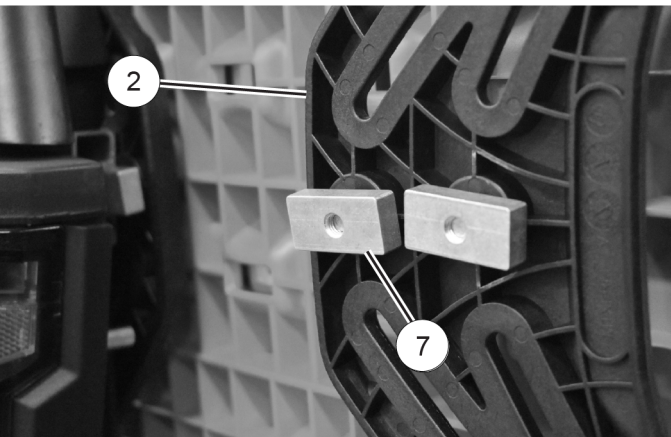

6. Slide mounts to desired position.



7. Carefully remove traction boards from mounts ②. Make sure not to move mounts along rail.

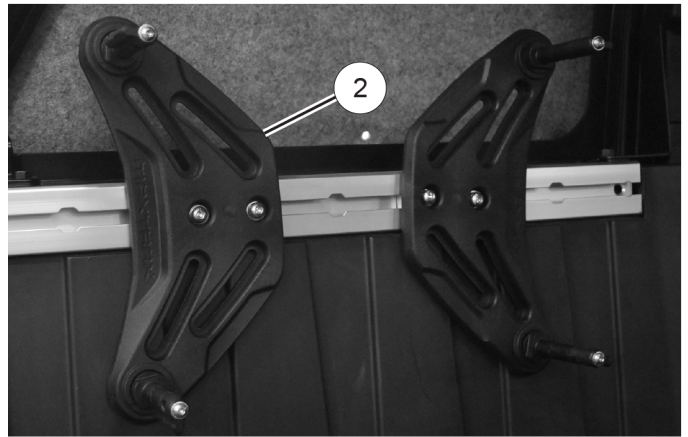

8. Tighten four screws ⑩ to specification.

TORQUE	
Screws ⑩:	18 ft-lbs (24 N·m)



9. Install bumper in rear of rail.

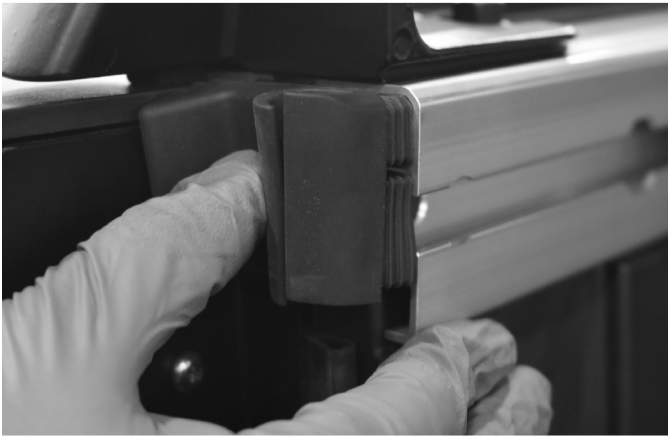

STRAP ATTACHMENT

1. Attach strap ③ to each traction board ① prior to use. Straps will aid in retrieval of traction boards if they become buried or submerged.

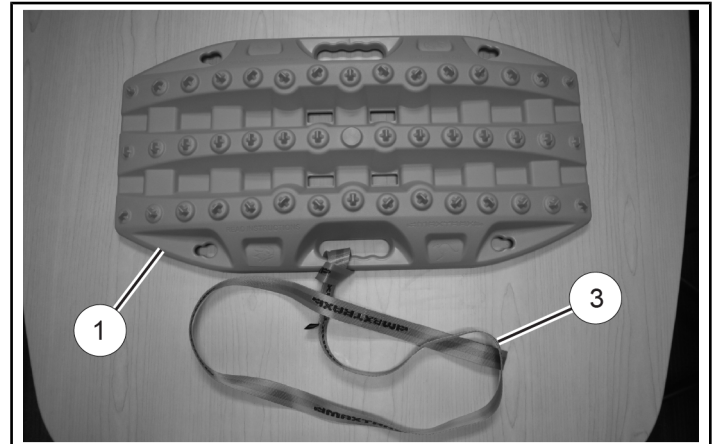

2. Remove and store straps when not in use.