

BULL BAR KIT



P/N 2890855

MISSING OR DAMAGED PARTS

Before beginning assembly, inspect the kit and its component(s) to be sure all parts and tools are accounted for and not damaged. If missing parts or parts are damaged, please contact your Selling Dealer for assistance.

If your accessory was purchased online, please contact POLARIS® customer service at **1-800-POLARIS** (US & Canada only).

APPLICATION

Verify accessory fitment at www.polaris.com.

IMPORTANT

This kit is not compatible with *Front Bumper Kit*, P/N 2884872.

KIT CONTENTS

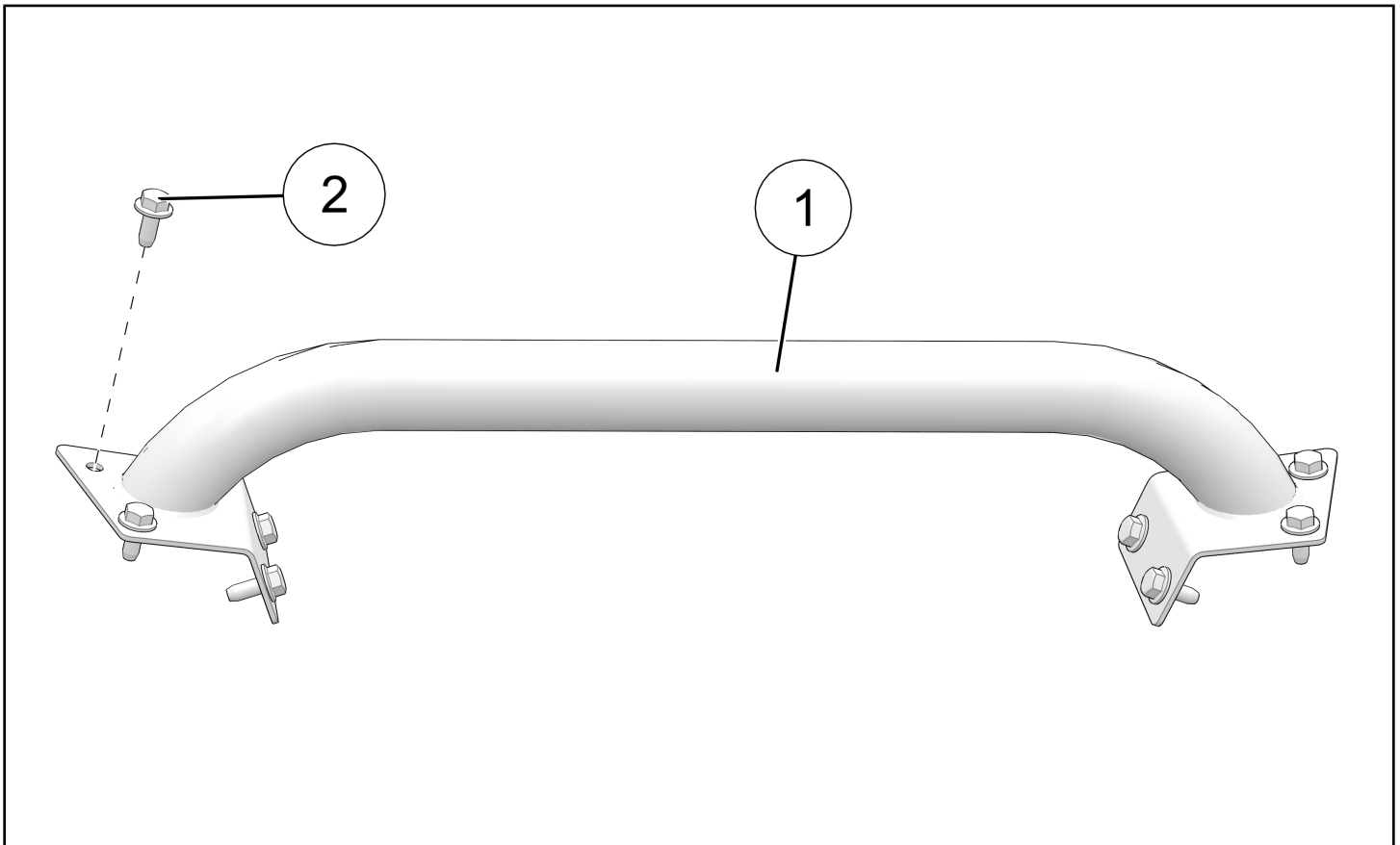

REF	QTY	PART DESCRIPTION	P/N AVAILABLE SEPARATELY
1	1	Bull Bar	1026817-458
2	8	Screw, Hex, Flange, (M8 x 1.25 x 20 mm)	7518555

TOOLS REQUIRED

- Safety Glasses
- Socket Set, Metric
- Torque Wrench

IMPORTANT

Your Bull Bar Kit is exclusively designed for your vehicle. Please read the installation instructions thoroughly before beginning. Installation is easier if the vehicle is clean and free of debris. For your safety, and to ensure a satisfactory installation, perform all installation steps correctly in the sequence shown.

INSTALLATION INSTRUCTIONS

VEHICLE PREPARATION

GENERAL

1. Park vehicle on a flat surface.
2. Shift vehicle into PARK.
3. Turn key to OFF position and remove key.

ACCESSORY INSTALLATION

1. Place bull bar ① on front bumper.

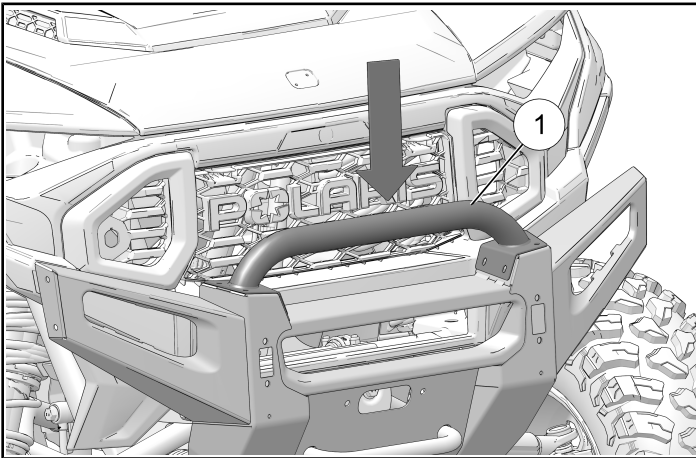

2. Install eight screws ②.

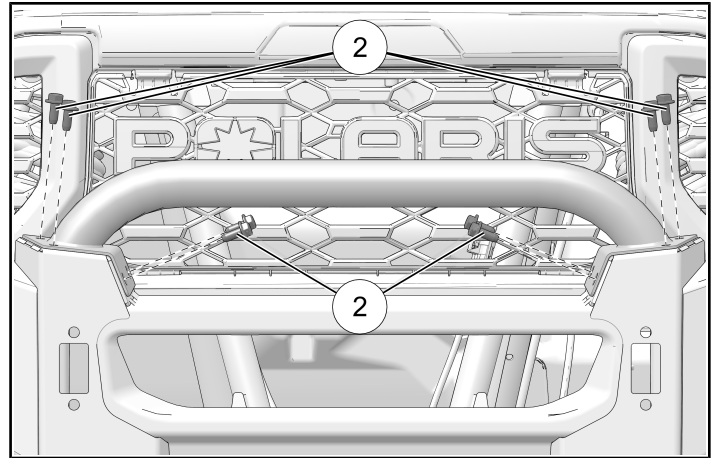

3. Torque screws ② to specification.

TORQUE

Screws ②:
10 ft-lbs (14 N·m)