

REAR WINCH KIT



P/N 2890134

MISSING OR DAMAGED PARTS

Before beginning assembly, inspect the kit and its component(s) to be sure all parts and tools are accounted for and not damaged. If missing parts or parts are damaged, please contact your Selling Dealer for assistance.

If your accessory was purchased online, please contact POLARIS® customer service at **1-800-POLARIS** (US & Canada only).

APPLICATION

Verify accessory fitment at www.polaris.com.

REQUIRED SOLD SEPARATELY

Only parts for installation of the Rear Winch Kit are included. Prior installation of the following additional kits are also required (sold separately):

- *Headache Rack*, P/N 2889538
- *Pulse® Bar*, P/N 2889185

KIT CONTENTS

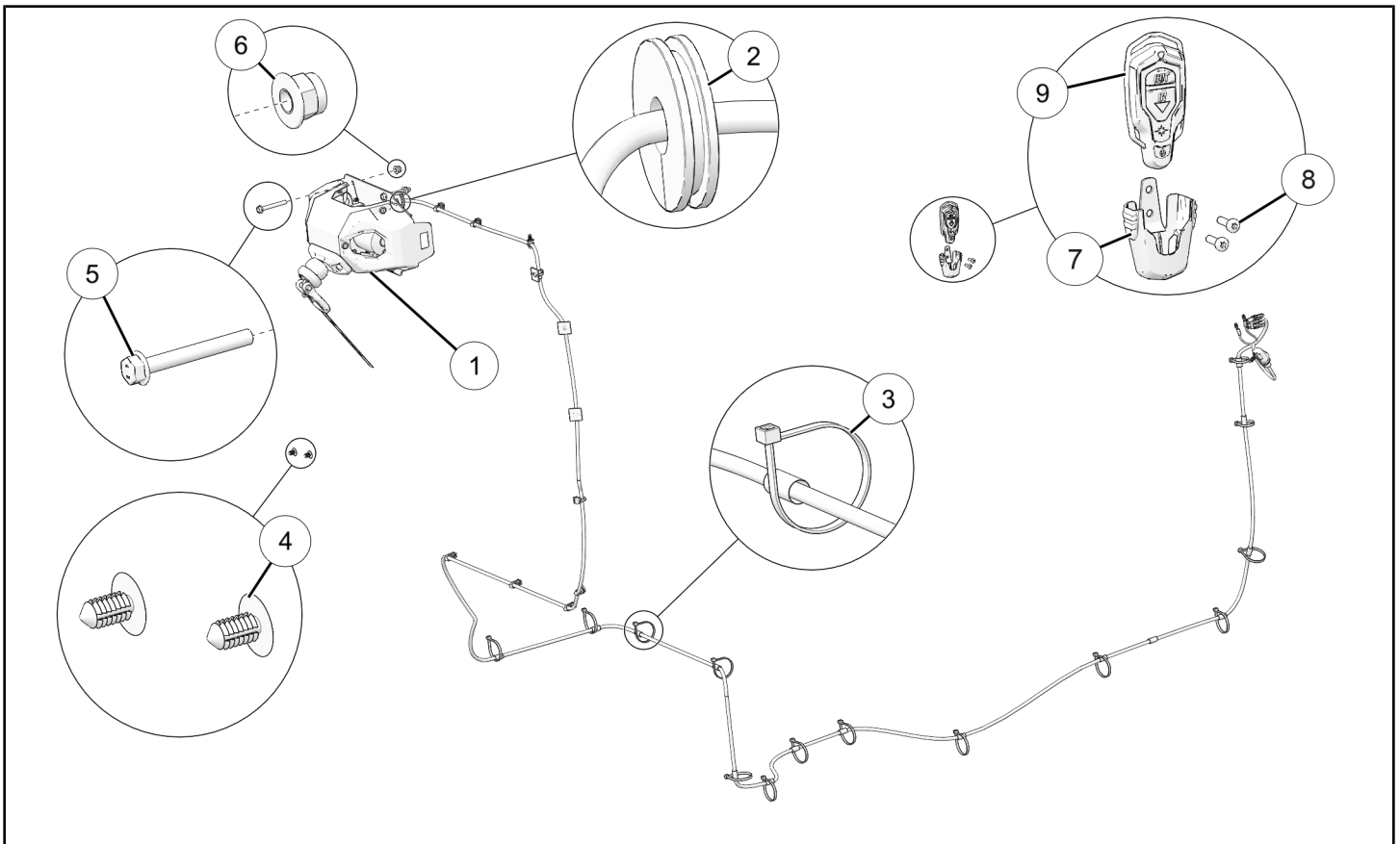

REF	QTY	PART DESCRIPTION	P/N AVAILABLE SEPARATELY
1	1	Rear Rack Winch	2639327
2	1	Grommet	5414504
3	17	Cable Tie	7080492
4	4	Push Dart Clip	7670088
5	4	Screw, Hex, Flange, M8 x 1.25 x 65 mm	7521332-65
6	4	Nut, Hex, Flange, Locking, M8 x 1.25 mm	7548028
7	1	Wireless Winch Remote Holder	5454269
8	2	Screw, Torx®, Self-Threading, #10 x 3/4 in	7512026
9	1	Wireless Winch Remote	n/a

TOOLS REQUIRED

- Safety Glasses
- Drill
- Drill Bit:
 - 1/8 in (3 mm)
- Hole Saw:
 - 1 1/4 in (31 mm)
- Socket Set, Metric
- Socket Set, Torx® Bit
- Tape Measure
- Torque Wrench
- Wrench Set, Metric

CONSUMABLES REQUIRED

- Solvent Wipe (99% Isopropyl Alcohol)

IMPORTANT

Your Rear Winch Kit is exclusively designed for your vehicle. Please read the installation instructions thoroughly before beginning. Installation is easier if the vehicle is clean and free of debris. For your safety, and to ensure a satisfactory installation, perform all installation steps correctly in the sequence shown.

INSTALLATION INSTRUCTIONS

VEHICLE PREPARATION

GENERAL

1. Park vehicle on a flat surface.
2. Shift vehicle into PARK.
3. Turn key to OFF position and remove key.

SEAT REMOVAL

1. Pull rear of seat and turn seat upright.



- Lift seat up and remove from lower hinge brackets.

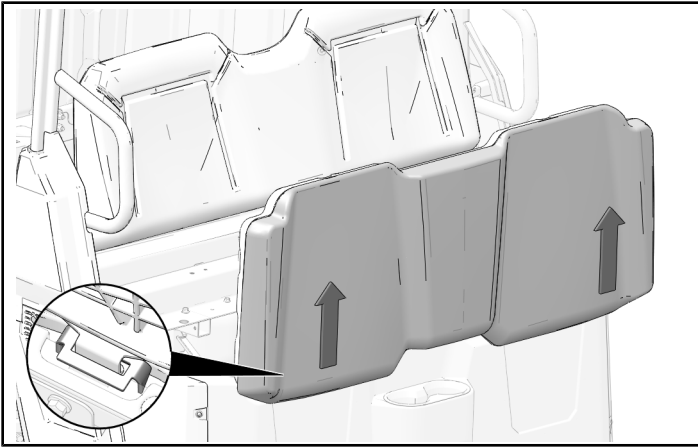

BATTERY DISCONNECT

- Counter-hold nut and remove bolt from negative battery terminal to remove negative (black) battery cable.

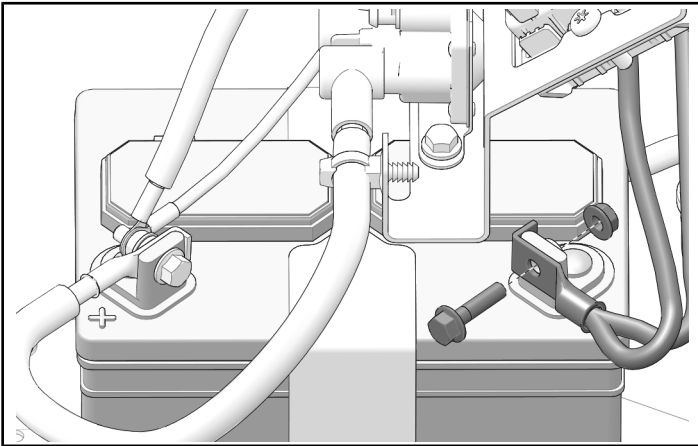

HOOD REMOVAL

- Turn two quarter-turn fasteners to unlock position to remove hood from vehicle.

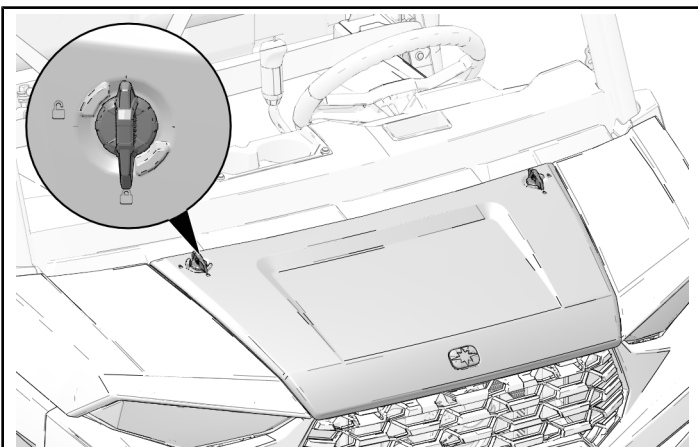

FRONT TUNNEL REMOVAL

- Remove eight push pin rivets. Remove tunnel cover.

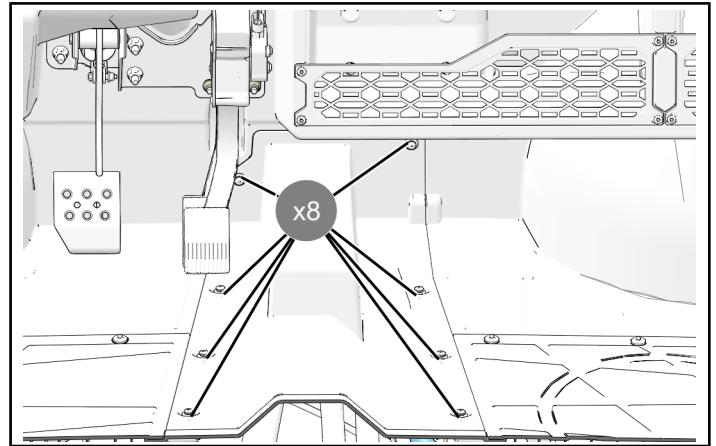

REAR TUNNEL REMOVAL (CREW MODELS)

- Remove four push pin rivets. Remove tunnel cover.

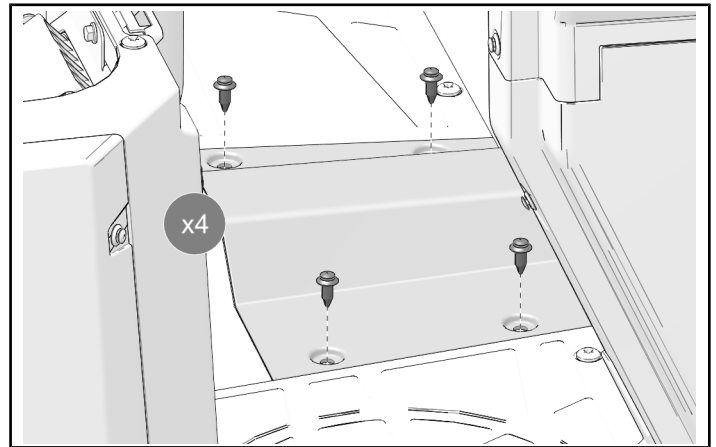

ACCESSORY INSTALLATION

ROOF PREPARATION

- Remove push dart clips from rear of roof liner (if equipped). Pull roof liner down away from roof.

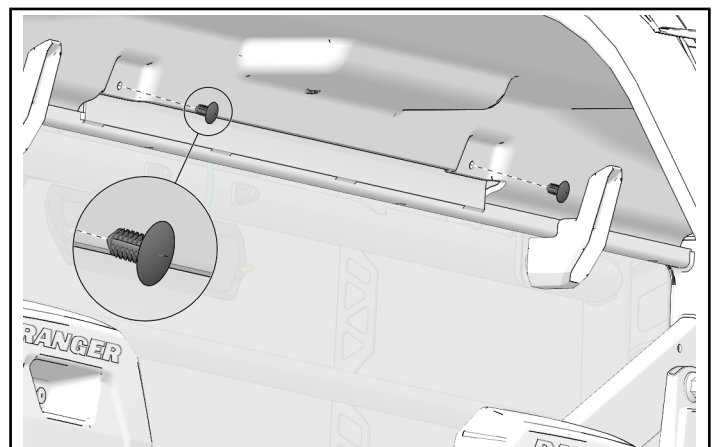

2. Remove and keep four screws at rear of roof.

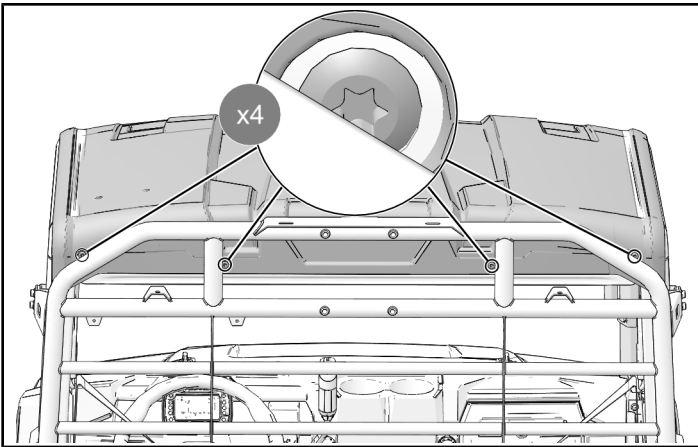

3. Find center point at rear of roof. Measure 2 in (50 mm) from bottom edge of roof. Mark this point.

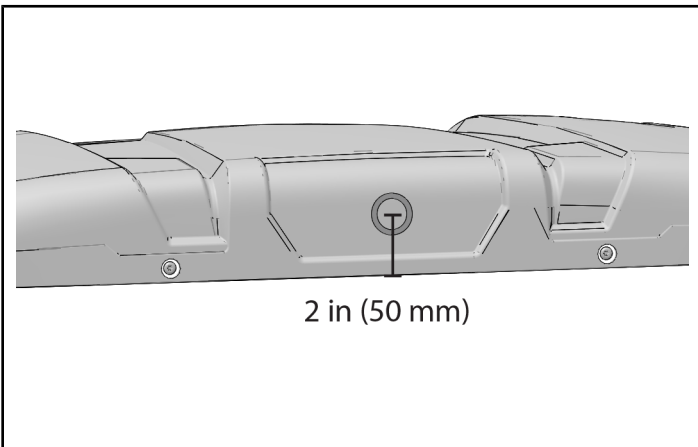

4. Lift roof up away from vehicle. Drill a hole at marked point. Replace roof.

NOTICE

Do not install roof screws at this time.

IMPORTANT

Lift roof away from vehicle to avoid damaging roof structure.

MEASUREMENT

Hole Saw Size:
1 1/4 in (31 mm)

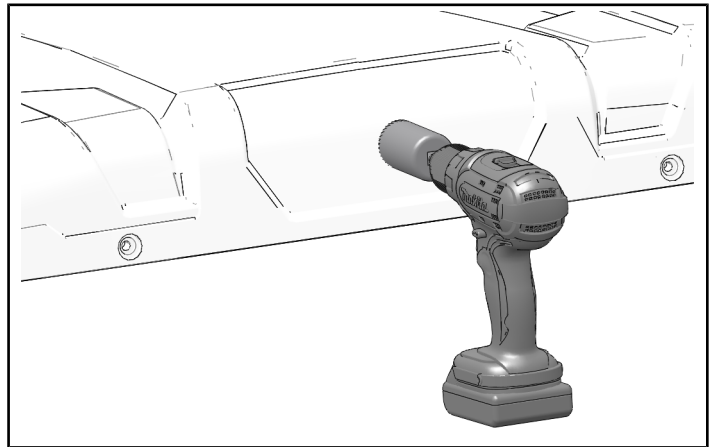

WINCH INSTALLATION

NOTICE

Polaris recommends two people for winch installation.

1. Put winch on headache rack. Align upper winch mounting holes with holes on headache rack. Loosely install two screws ⑤ and two nuts ⑥.

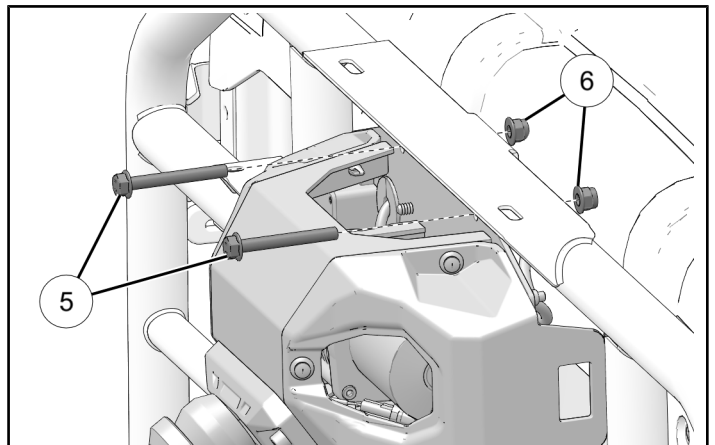

- Route wiring harness through hole in roof until grommet ② can be installed in hole.

TIP

Pull roof liner down to access wiring harness.

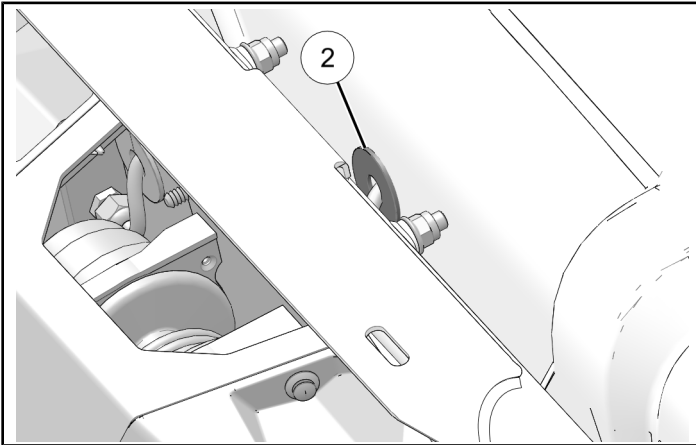

- Loosely install two screws ⑤ and two nuts ⑥ in lower winch assembly mounting holes.

NOTICE

Nuts ⑥ not shown.

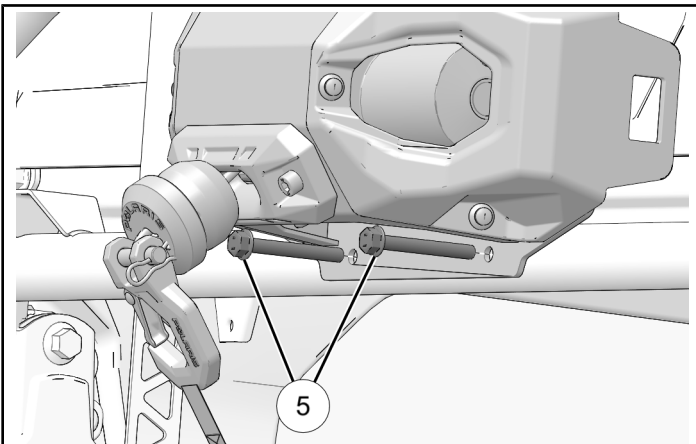

- Torque four nuts ⑥ to specification.

TORQUE

Nuts ⑥:
20 ft-lbs (27 N·m)

WIRING HARNESS INSTALLATION

TIP

Pull roof liner down to access wiring harness.

- Attach harness to vehicle roof brace using edge clips.

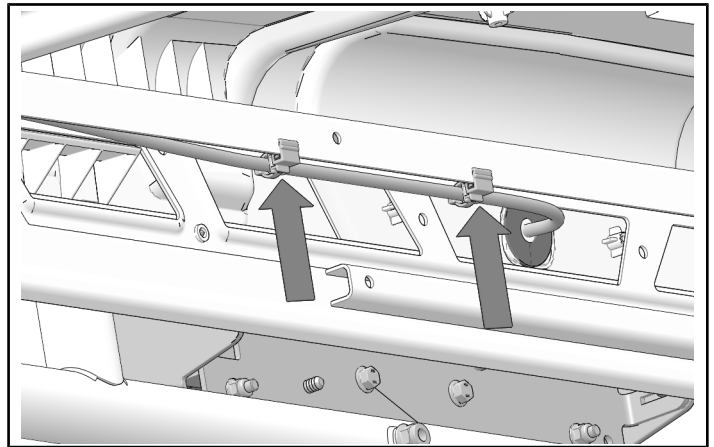

- Attach wiring at corner of vehicle roof brace using push dart clip.

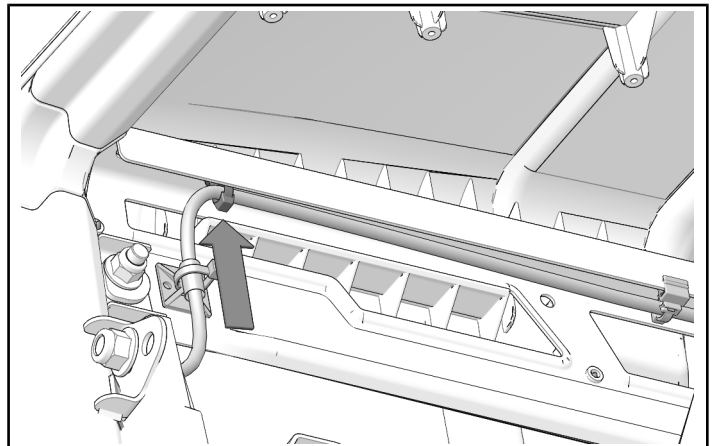

- Attach wiring to vehicle frame behind passenger door opening using adhesive clips. Hold clips firmly in place for 30-seconds.

IMPORTANT

Clean surface using alcohol before attaching clips.

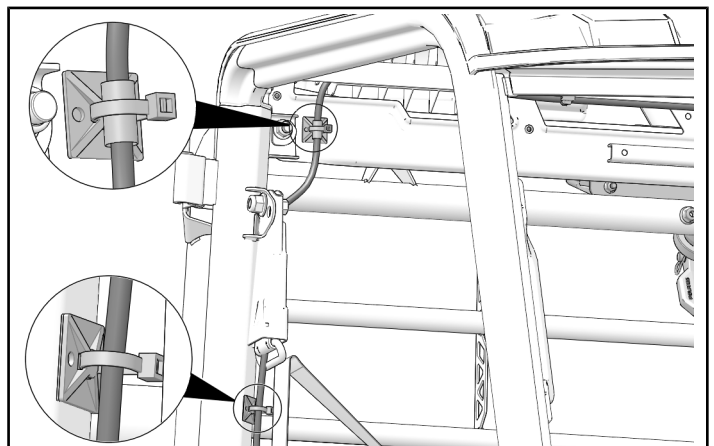

4. Attach wiring to vehicle frame using adhesive clip and edge clips. Hold clips firmly in place for 30-seconds.

NOTICE

Cross brace where edge clips mount is hidden for clarity. Clips attach to rear lower edge of cross brace.

NOTICE

Seat back hidden for clarity.

IMPORTANT

Clean surface using alcohol before attaching clips.

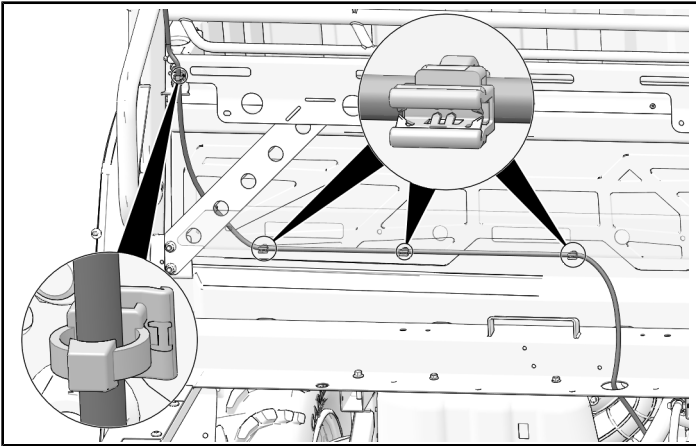

5. Route harness through hole in seat mounting area.

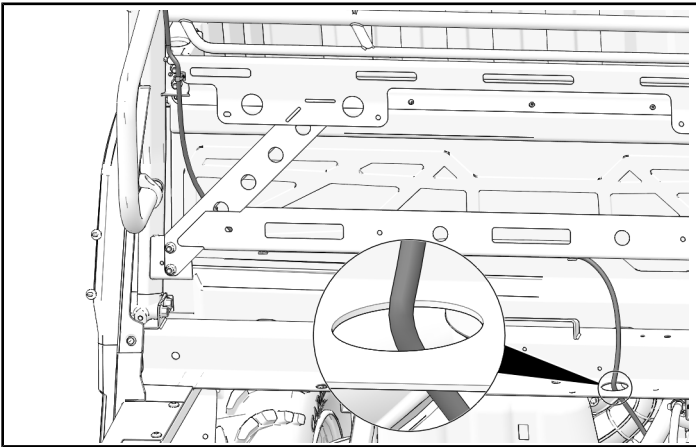

6. Route harness along front edge of seat mount area. Attach to underside of seat mount structure using cable ties ③.

NOTICE

Parts hidden for clarity.

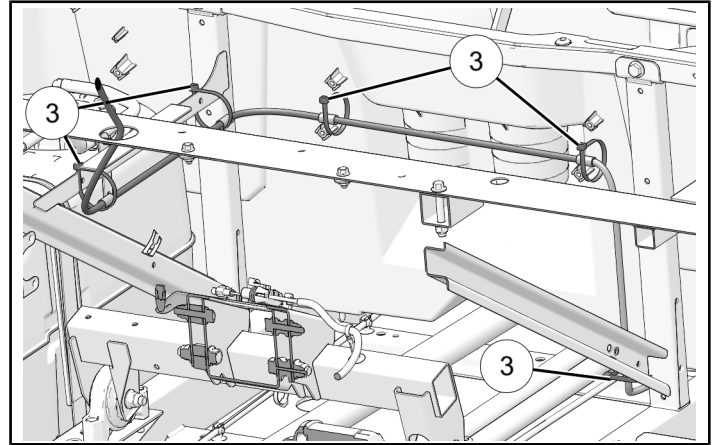

7. Route harness under vehicle floor. Attach to main wiring harness using cable ties ③.

IMPORTANT

On 3-person models installer will be required to bundle extra harness length with cable tie. Harness is marked with white tape to indicate length that should be bundled. Harness should be bundled in area under passenger footwell. Make sure harness bundle is clear of hot and/or moving parts. Crew models will use full length of harness.

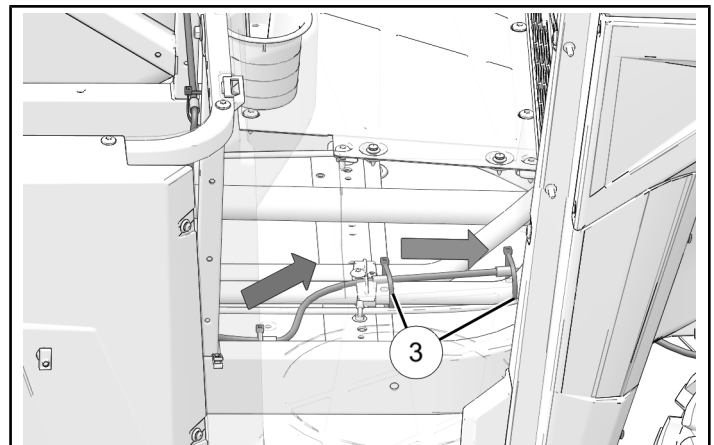

8. Route harness up to underhood area along existing battery cables. Attach using cable tie ③. Make sure wires are kept away from moving parts.

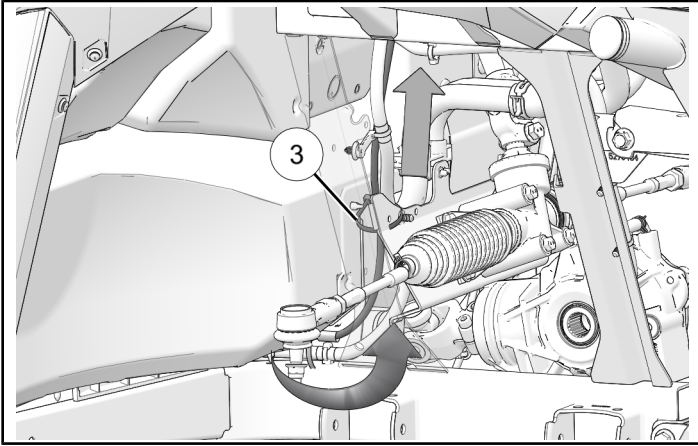

9. Route through opening in Pulse® board. Attach to frame using cable tie ③. Attach fuse holder to location 6 on Pulse® board.

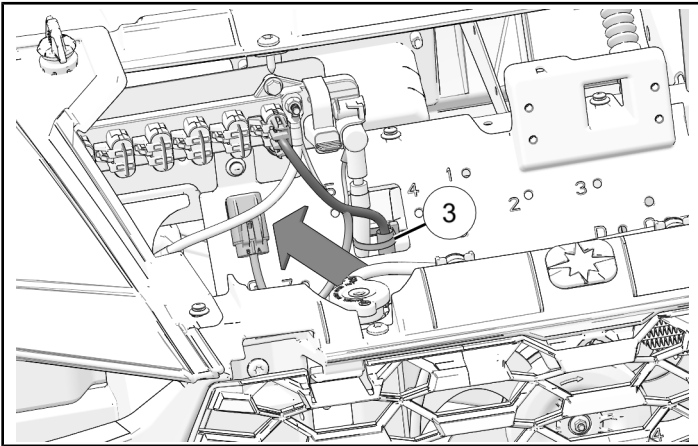

10. Connect wiring to Pulse® bar.

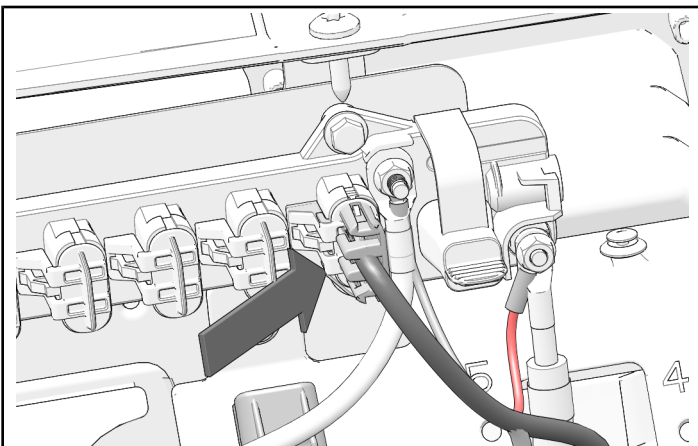

11. Connect positive and negative ring terminals to Pulse® bar. Torque nuts to specification.

TORQUE

Pulse® Terminal Nuts:
44 in-lbs (5 N·m)

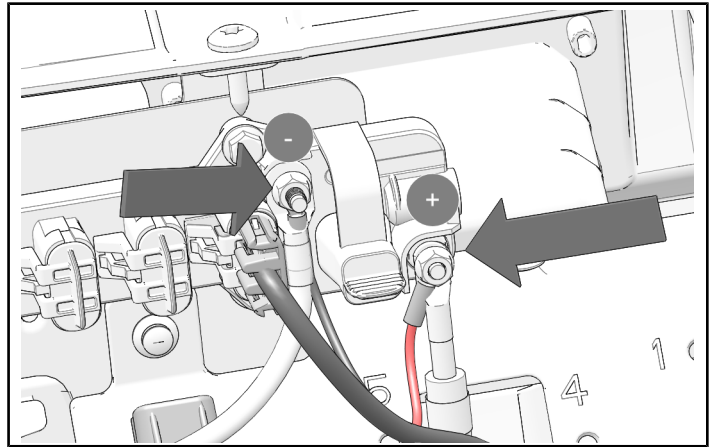

12. Install four kept roof screws. Torque to specification.

TORQUE

Roof Screws:
97 in-lbs (11 N·m)

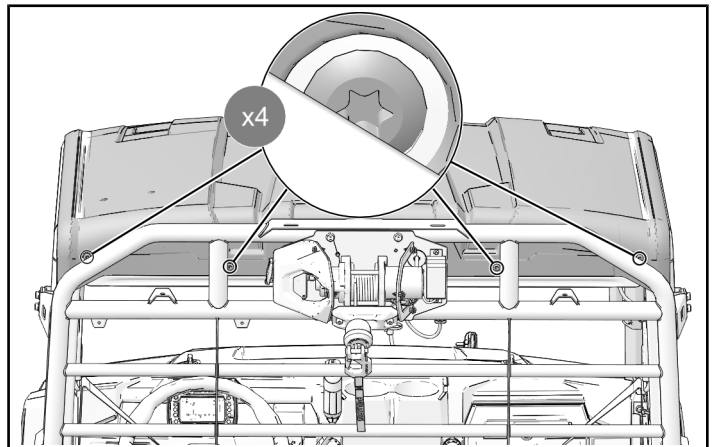

13. Put roof liner in place. Install two push dart clips ④ in roof liner.

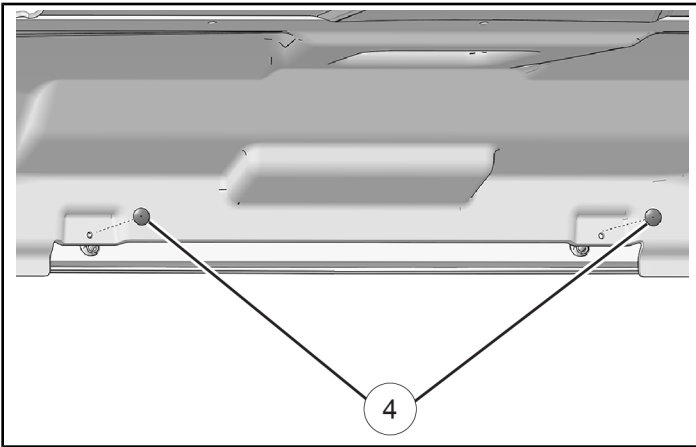

3. Install wireless winch remote ⑨ in wireless winch remote holder ⑦.

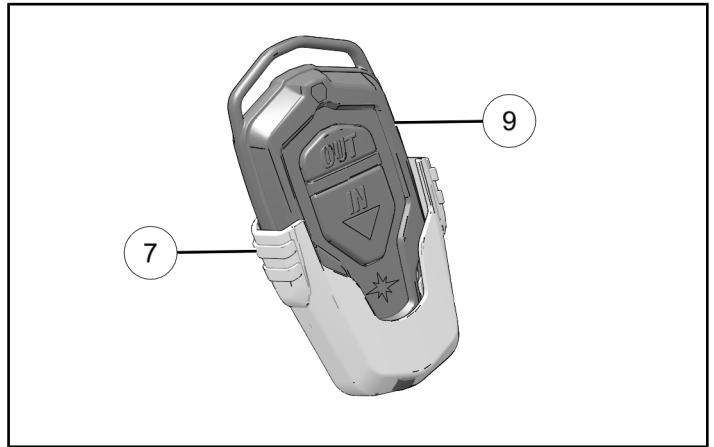

WIRELESS REMOTE INSTALLATION

NOTICE

Wireless remote can be installed in any desired location. Polaris recommends installing wireless remote on dash or in glove box.

1. Use wireless remote holder ⑦ as a template to mark two holes. Drill holes.

MEASUREMENT

Drill Bit Size:
1/8 in (3 mm)

2. Install wireless winch remote holder ⑦ using two screws ⑧. Tighten until fully seated.

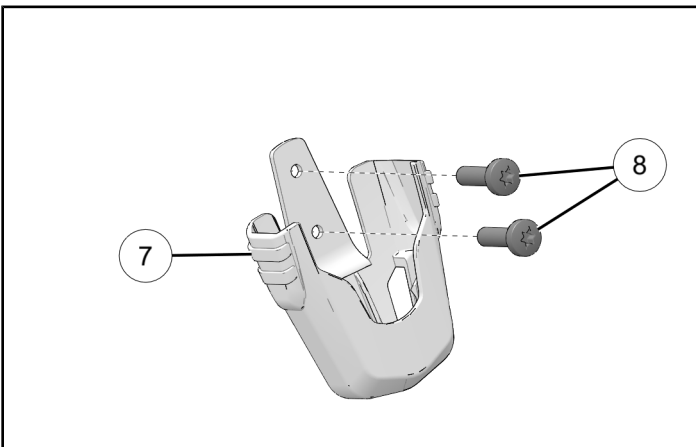

VEHICLE REASSEMBLY

BATTERY CONNECT

1. Install negative (black) battery cable(s) to negative battery terminal with retained hardware. Counter-hold nut and torque one bolt to specification.

TORQUE

Battery Terminal Bolt:
62 in-lbs (7 N·m)

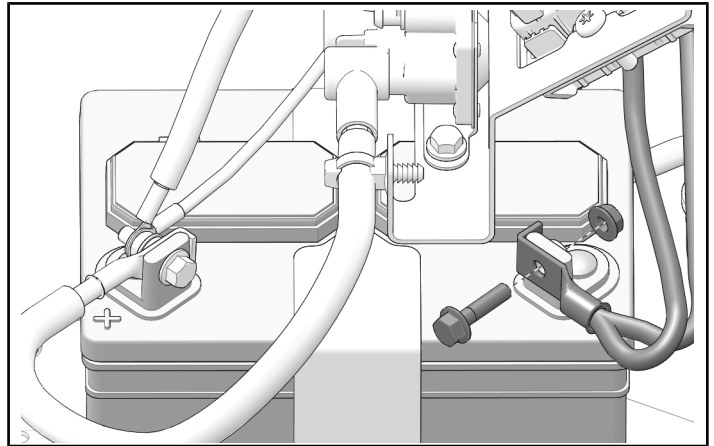

SEAT INSTALLATION

1. Align tabs of seat with hinge brackets.

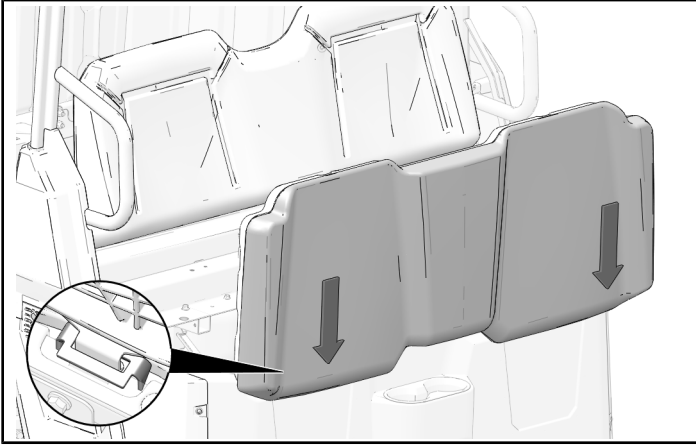

2. Rotate seat to closed position.

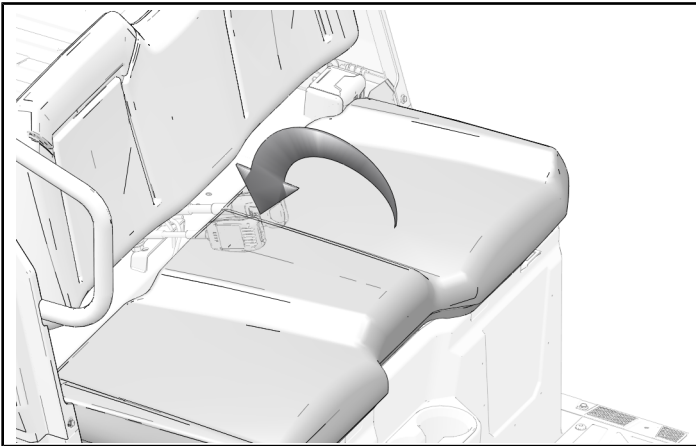

REAR TUNNEL INSTALLATION (CREW MODELS)

1. Install tunnel cover. Attach using four push pin rivets.

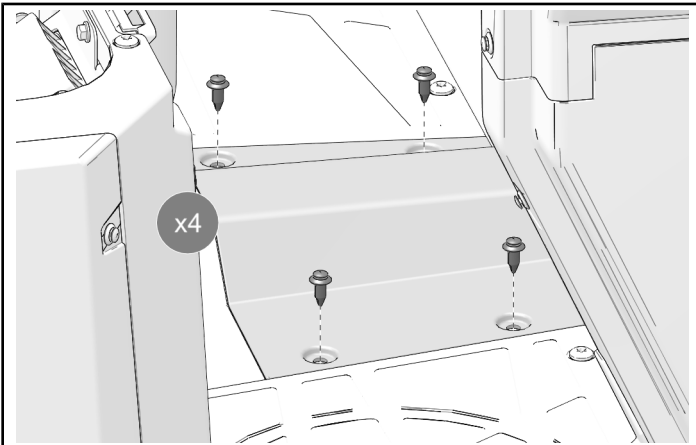

OPERATION

NOTICE

The winch switch will only function if a winch has been properly installed on the vehicle.

FRONT TUNNEL INSTALLATION

1. Install front tunnel cover. Attach using four push pin rivets.

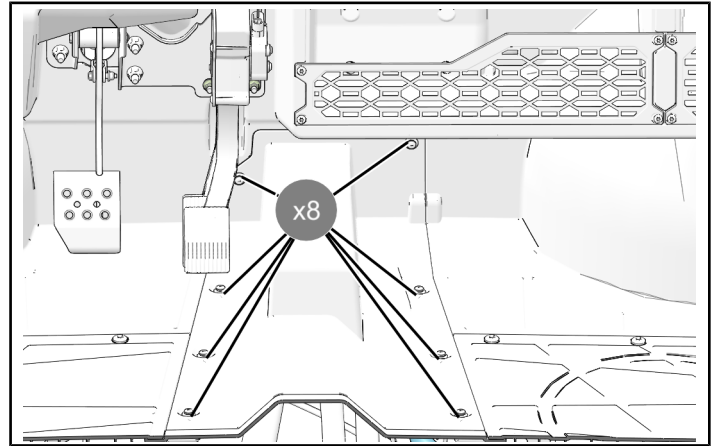

HOOD INSTALLATION

1. Align hood with vehicle and turn two quarter-turn fasteners to lock position to install hood.

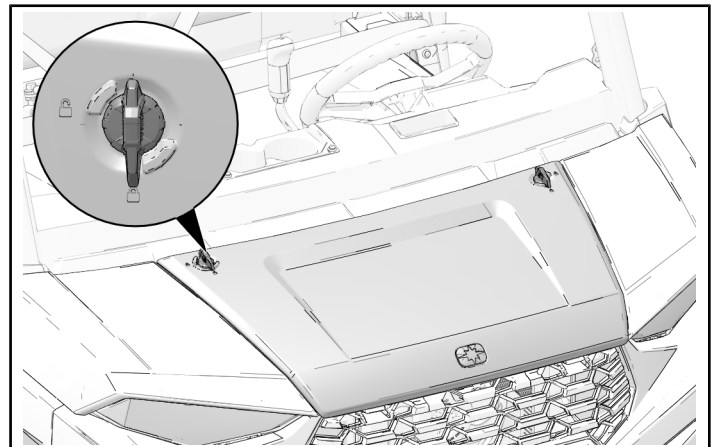

- Winch can be operated using wireless remote ⑨ or switch located on side of winch.

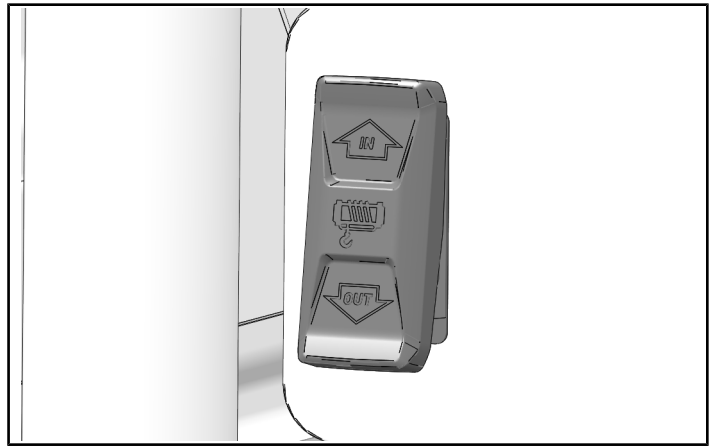
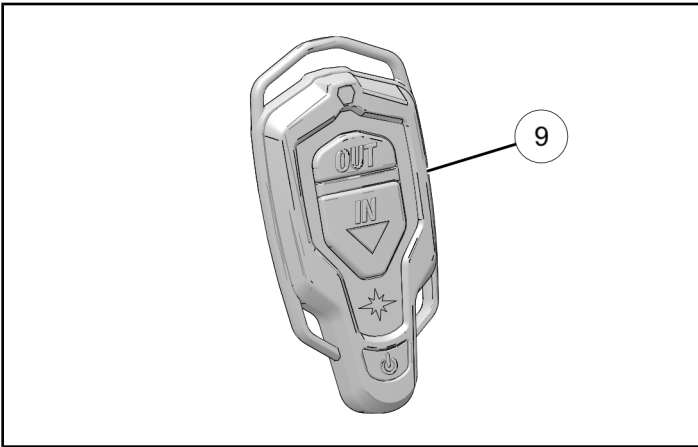

- To operate winch with remote control, push and hold power button until LED lights illuminate.

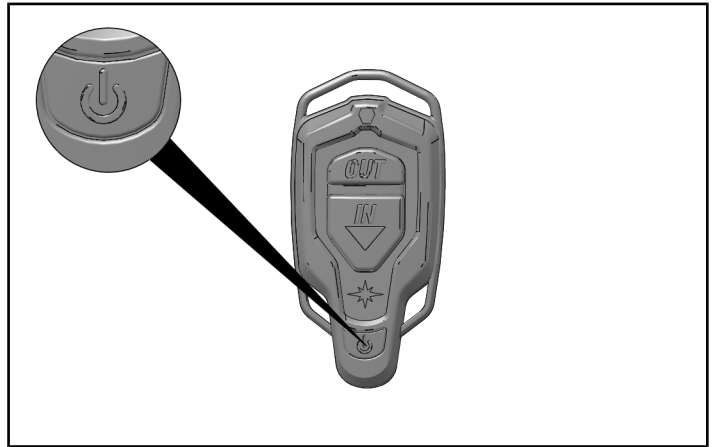
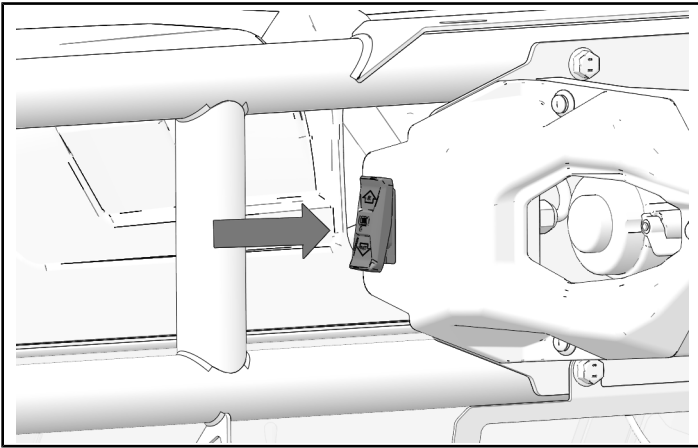

- Push the top button of the switch "IN" to spool line in to winch. Push the bottom button of the switch "OUT" to spool line out from winch.

WINCH SERVICE PARTS

PART DESCRIPTION	P/N AVAILABLE SEPARATELY	AVAILABLE SERVICE KIT
Hardware Kit	n/a	2211502
Winch Rope	2208247	n/a
Fairlead Assembly	2639331	n/a
Bumper	5418451	n/a
Auto Stop Magnet	5415787	n/a
Hook Assembly	5910705	n/a
Switch	4080801	n/a
Remote Service Kit	n/a	2889561