

UHMW PLOW WEAR BAR KIT



P/N 2890289; 2890290; 2890651; 2890652

MISSING OR DAMAGED PARTS

Before beginning assembly, inspect the kit and its component(s) to be sure all parts and tools are accounted for and not damaged. If missing parts or parts are damaged, please contact your Selling Dealer for assistance.

If your accessory was purchased online, please contact POLARIS® customer service at **1-800-POLARIS** (US & Canada only).

APPLICATION

Verify accessory fitment at www.polaris.com.

REQUIRED SOLD SEPARATELY

Only parts for installation of the UHMW Plow Wear Bar Kit are included. For complete installation, the following additional kit is required (sold separately):

- 52", 60", 66", or 72" Glacier Plow Blade

KIT CONTENTS

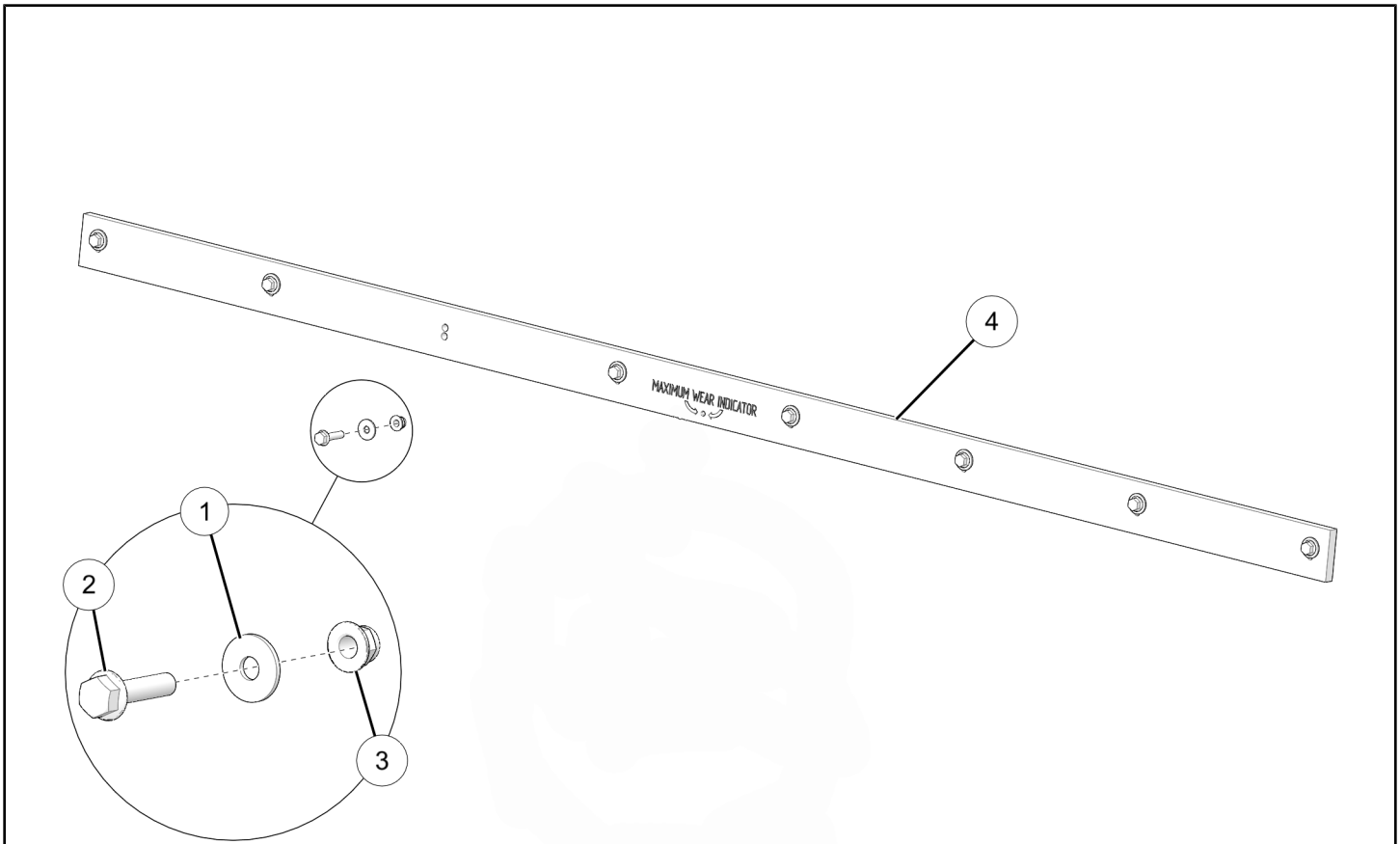

REF	QTY	PART DESCRIPTION	P/N AVAILABLE SEPARATELY
1	n/a	Fender Washer, M8 mm	n/a
2	n/a	Screw, Flange, M8 x 1.25 x 35 mm	n/a

REF	QTY	PART DESCRIPTION	P/N AVAILABLE SEPARATELY
3	n/a	Nut, Flange, Locking M8 x 1.25 mm	n/a
4	1	72 in UHMW Wear Bar	n/a

TOOLS REQUIRED

- Safety Glasses
- Socket Set, Metric
- Torque Wrench
- Wrench Set, Metric

IMPORTANT

Your UHMW Plow Wear Bar Kit is exclusively designed for your vehicle. Please read the installation instructions thoroughly before beginning. Installation is easier if the vehicle is clean and free of debris. For your safety, and to ensure a satisfactory installation, perform all installation steps correctly in the sequence shown.

INSTALLATION INSTRUCTIONS

VEHICLE PREPARATION

GENERAL

1. Park vehicle on a flat surface.
2. Shift vehicle into PARK.
3. Turn key to OFF position and remove key.

ACCESSORY INSTALLATION

NOTICE

Installation shows 72" plow blade. Number of wear bar fasteners will vary depending on length of plow blade.

NOTICE

Place plow carriage on kick stand before servicing plow blade.

IMPORTANT

UHMW wear bar should be at room temperature before installation.

1. Remove and discard existing wear bar and hardware.

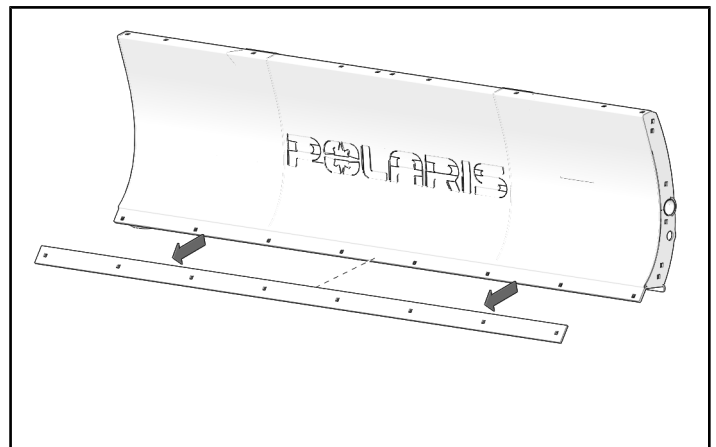
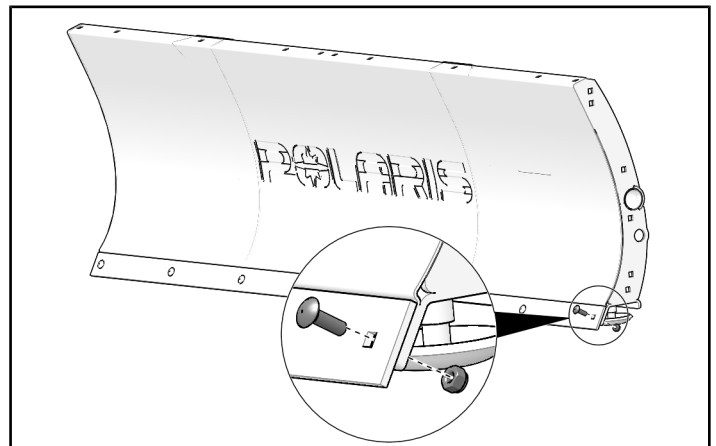

- Put wear bar ④ on plow. Align upper holes on wear bar ④ with mounting holes on plow.

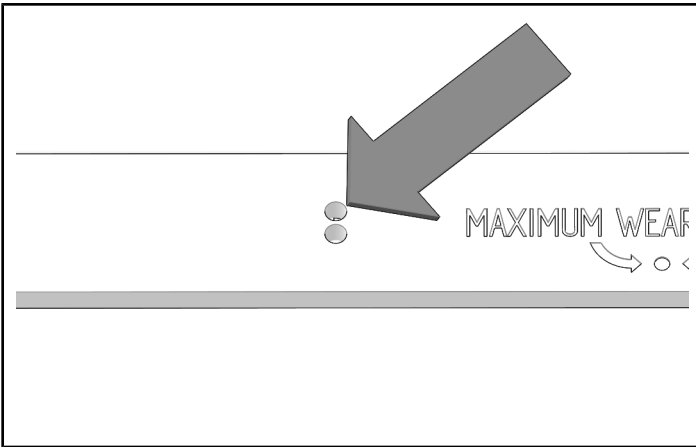
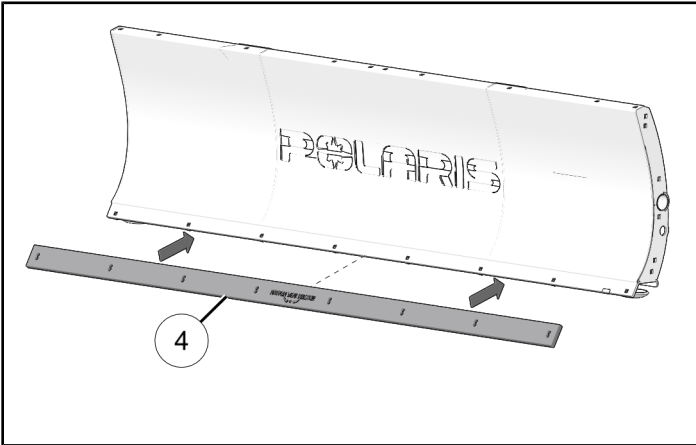

- Make sure wear indicator arrows at center of wear bar are pointing down.

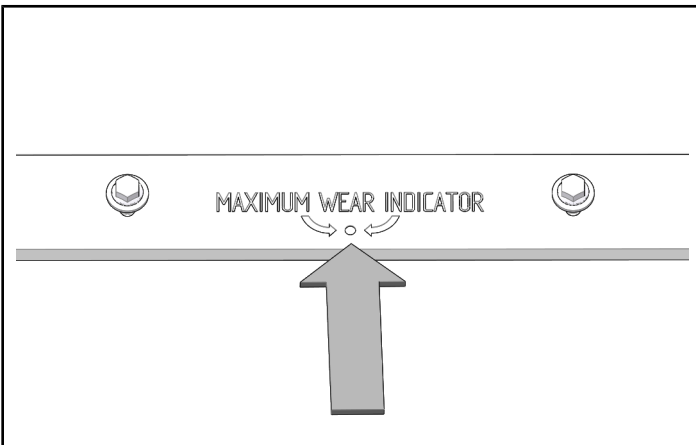

- Loosely attach wear bar ④ to plow blade using screws ②, washers ① and nuts ③. Install middle two fasteners first and continue to ends of wear bar.

DO NOT torque fasteners at this time.

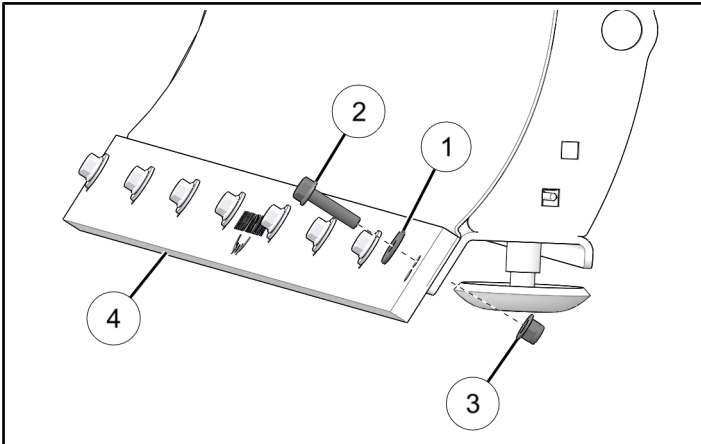
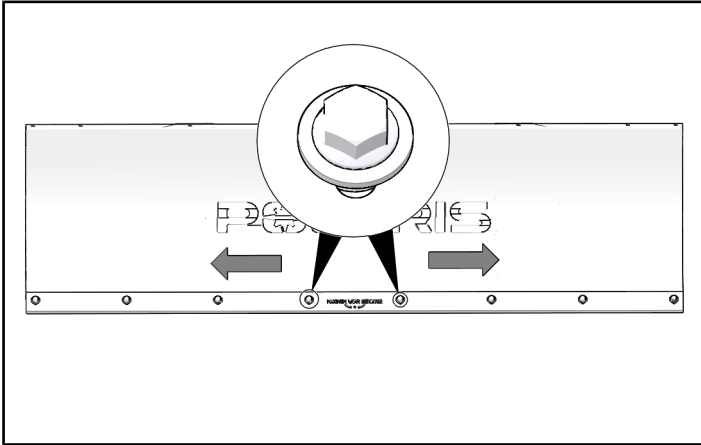

- Torque nuts ③ to specification.

TORQUE
Nuts ③:
12 ft-lbs (16 N·m)

OPERATION

- When wear bar use reaches “Maximum Wear Indicator” plug (A), the wear bar can be removed and flipped to use the opposite edge.

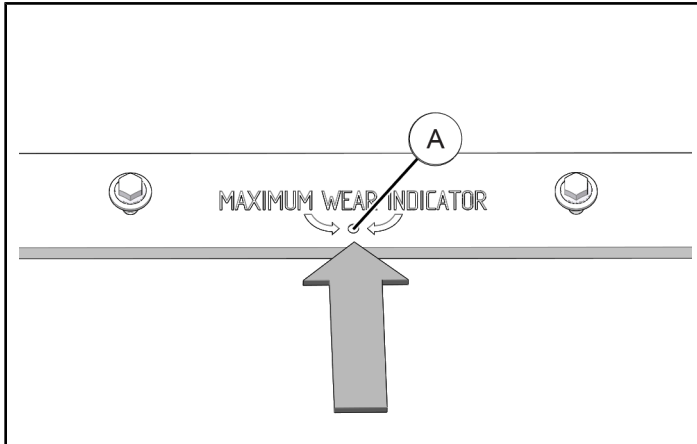

NOTICE

Cross section of wear indicators shown.

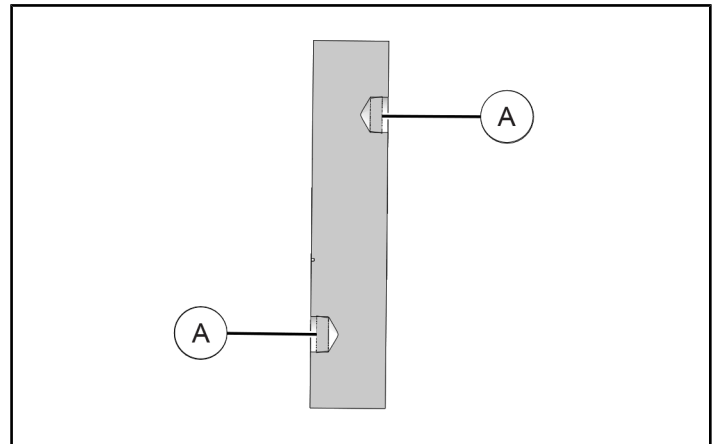

- When second wear indicator plug is reached after flipping wear bar, replace the wear bar.