

GRIPS KIT



P/N 2890218; 2890219; 2890220

IMPORTANT

Due to the technical nature of this kit, Indian Motorcycle® insists that this installation be performed by a certified Indian Motorcycle® technician.

BEFORE YOU BEGIN

Read these instructions and check to be sure all parts and tools are accounted for. Please retain these installation instructions for future reference and parts ordering information.

MISSING OR DAMAGED PARTS

Before beginning assembly, inspect the kit and its component(s) to be sure all parts and tools are accounted for and not damaged. If missing parts or parts are damaged, please contact your Selling Dealer for assistance.

If your accessory was purchased online, please contact Indian Motorcycle® customer service at **1-877-204-3697** (US & Canada only).

APPLICATION

Verify accessory fitment at www.indianmotorcycle.com.

REQUIRED SOLD SEPARATELY

NACELLE MOTORCYCLES WITHOUT DRIVING LIGHTS ONLY

Only parts for installation of the Indian Motorcycle® Grips Kit are included. For complete installation, the following additional kit is required (sold separately):

- *Nacelle Accessory Switch Kit*, P/N 2884951-XXX

NOTICE

XXX = Indian Motorcycle® color code (For example: 266 = Black)

KIT CONTENTS

GRIPS KIT P/N 2890218

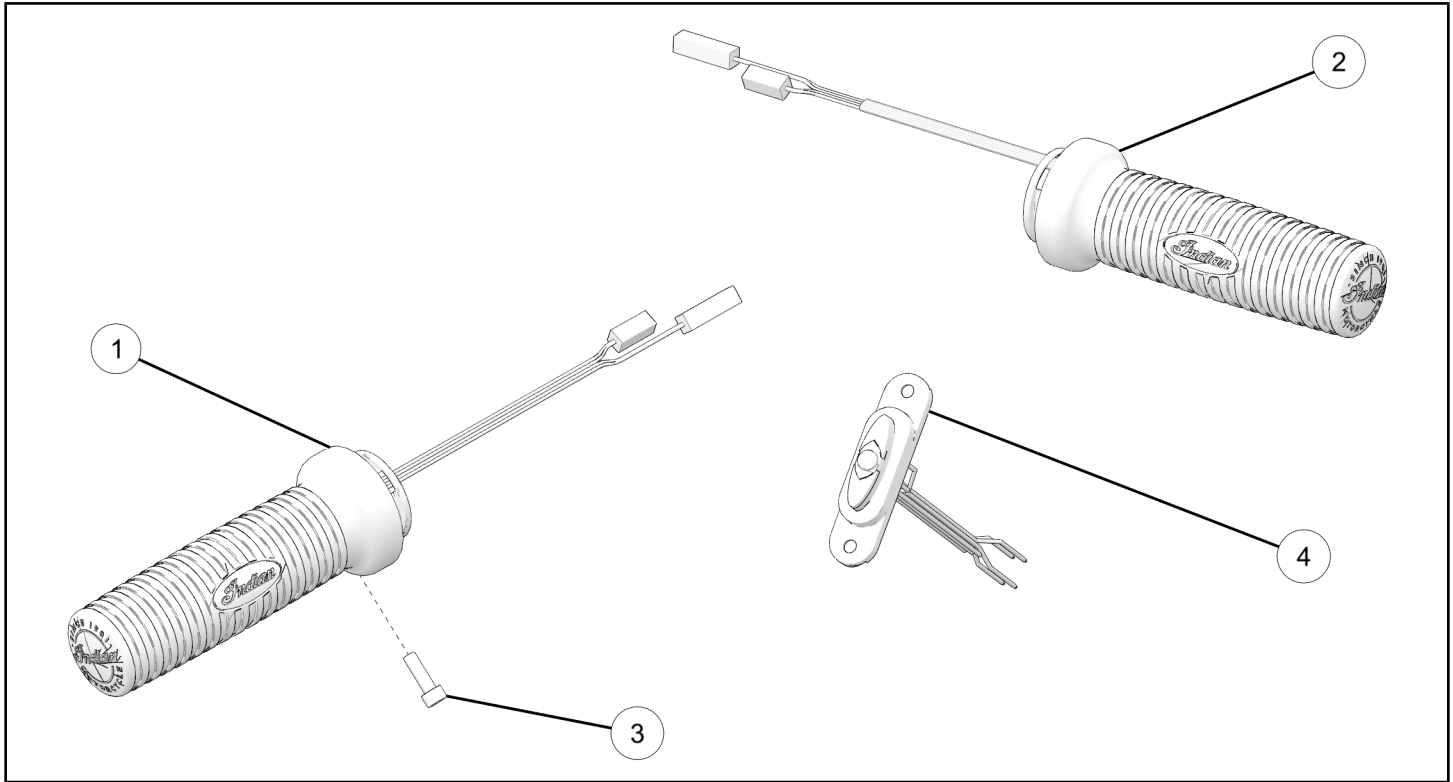

REF	QTY	PART DESCRIPTION	P/N AVAILABLE SEPARATELY
1	1	Grip, Left, Heated	5418250
2	1	Grip, Right, Heated	5418366
3	1	Screw, Socket-Head, M5 x 0.8 x 16 mm	7516610
4	1	Switch, Heated Grip	4015738

GRIPS KIT P/N 2890219; 2890220

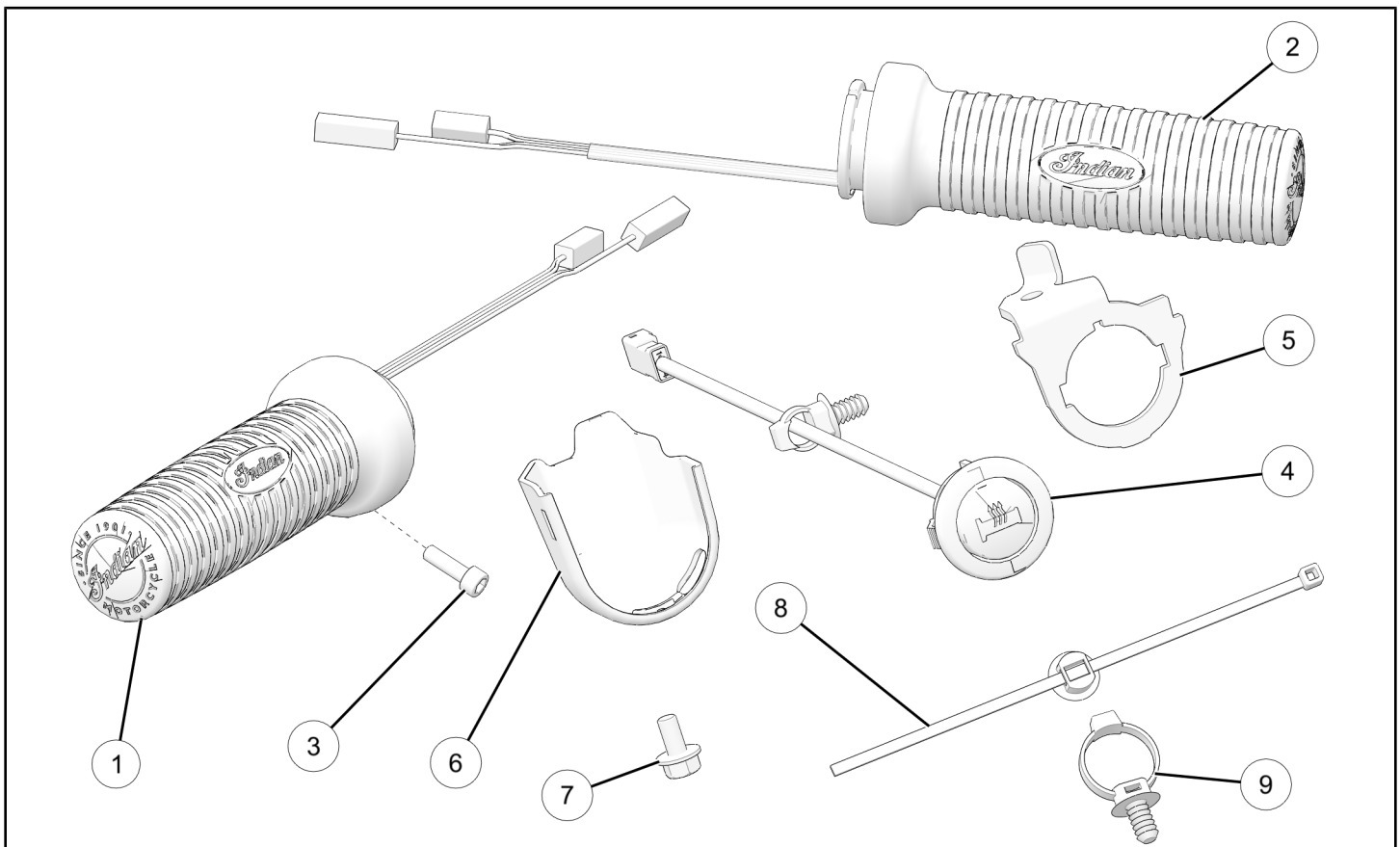

REF	QTY	PART DESCRIPTION	P/N AVAILABLE SEPARATELY
1	1	Grip, Left (kit PN: 2890219) Grip, Left, Heated (Kit PN 2890220)	5418249 5418250
2	1	Grip, Right (kit PN: 2890219) Grip, Right, Heated (Kit PN 2890220)	5418364 5418366
3	1	Screw, Socket-Head, M5 x 0.8 x 16 mm	7516610
4	1	Switch, Heated Grip (Kit PN 2890220 only)	4019306
5	1	Bracket, Grip Switch (Kit PN 2890220 only)	5269485
6	1	Switch Cover, Grip (Kit PN 2890220 only)	5457133
7	1	Screw, Hex Flange Head, M8 x 1.0 x 12 mm (Kit PN 2890220 only)	7517704
8	1	Cable tie, Push-pin clip (Kit PN 2890220 only)	7082003
9	1	Cable Tie, Push-Pin Clip, 33 mm (Kit PN 2890220 only)	7081496

NACELLE ACCESSORY SWITCH KIT P/N 2884951-XXX

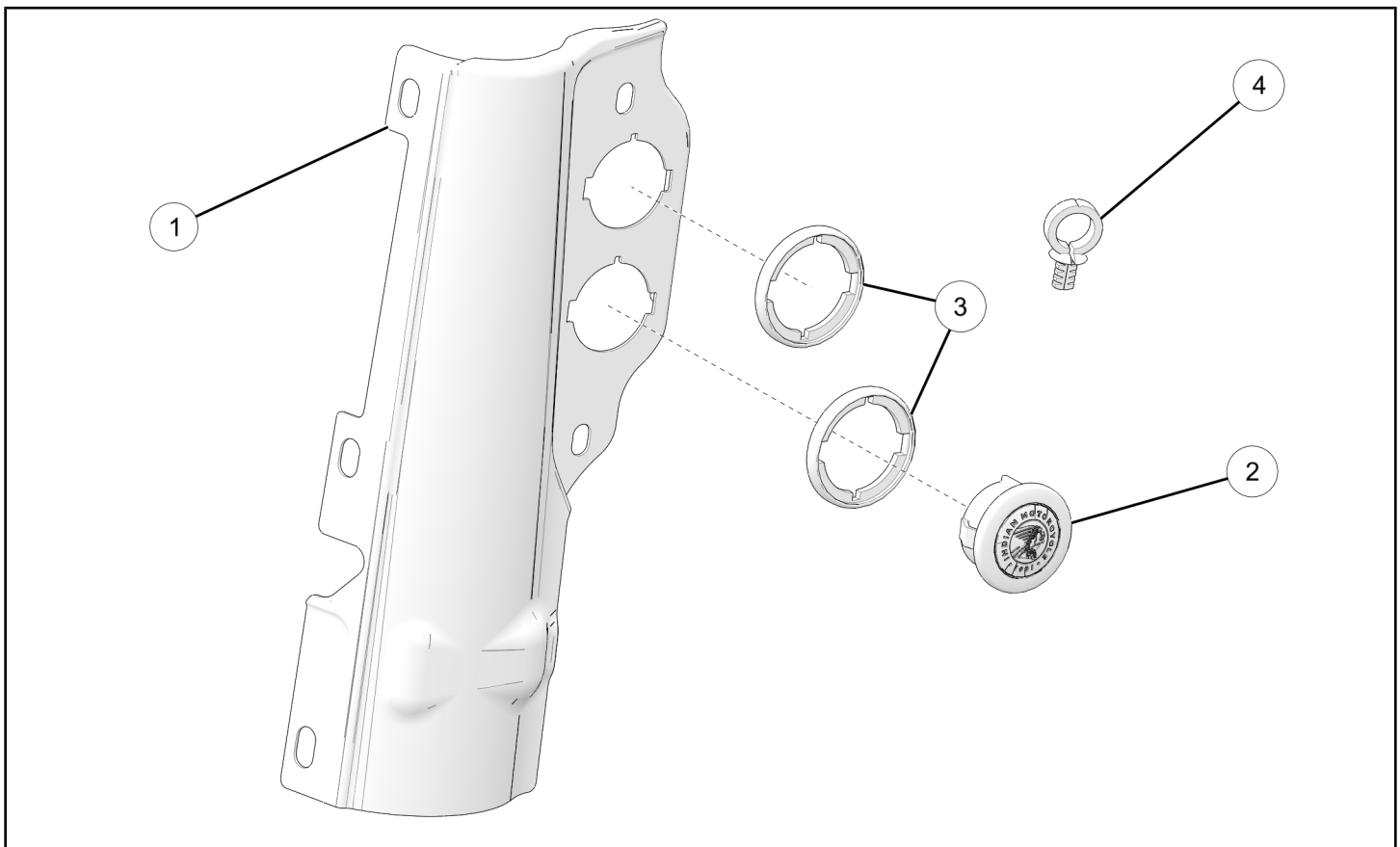

REF	QTY	PART DESCRIPTION	P/N AVAILABLE SEPARATELY
1	1	LH Buttons Rear Cover	N/A
2	1	Fog Button Plug	5417163
3	2	Nacelle Bezel Spacer	5451104
4	1	Routing Clip	7081968

TOOLS REQUIRED

- Safety Glasses
- Hammer, Soft Face
- Pick and Hook Set
- Socket Set, Hex Bit, Metric
- Socket Set, Metric
- Socket Set, Torx® Bit
- Torque Wrench
- Wrench, Strap

CONSUMABLES REQUIRED

- Adhesive Remover (Goo Gone® or 3M™ Citrus Base)

IMPORTANT

Your Indian Motorcycle® Grips Kit is exclusively designed for your vehicle. Please read the installation instructions thoroughly before beginning. Installation is easier if the vehicle is clean and free of debris. For your safety, and to ensure a satisfactory installation, perform all installation steps correctly in the sequence shown.

INSTALLATION INSTRUCTIONS

VEHICLE PREPARATION

GENERAL

IMPORTANT

Update the VCM (Vehicle Control Module) software using Digital Wrench® before installing heated grips.

1. Park motorcycle on a flat surface, fully extend side stand, and make sure vehicle is stable.
2. Turn key to OFF position and remove key.

GLUED LEFT GRIP REMOVAL

LEFT GRIP REMOVAL

1. Loosen, but do not remove, two fasteners on clutch lever assembly.

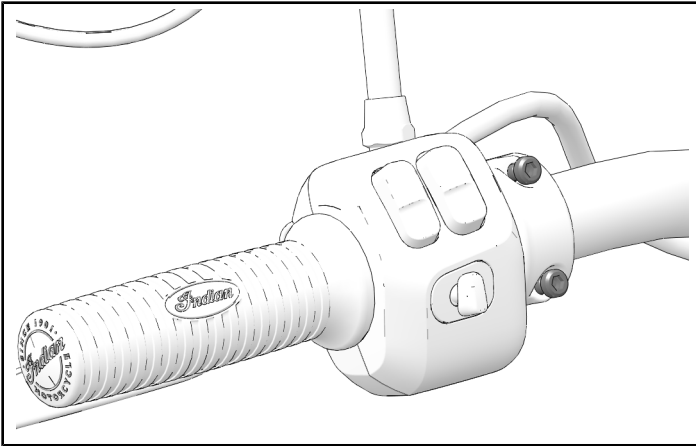

2. Slide and rotate clutch lever assembly to access outer cube fasteners. Use extra caution moving clutch lever assembly. Clutch lever wire is still connected to switch cube.

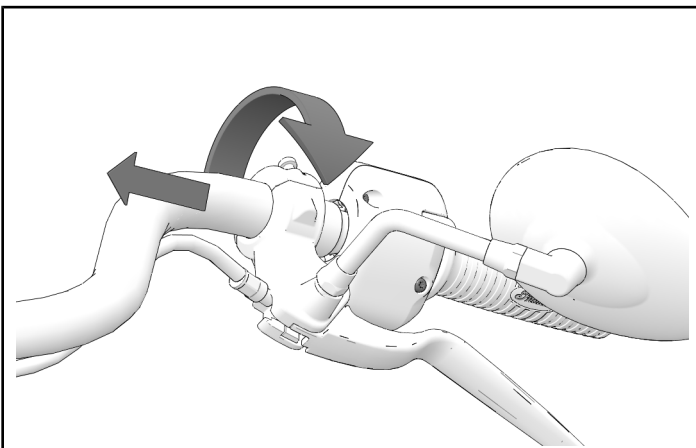

3. Remove two outer cube fasteners and remove two halves of cover.

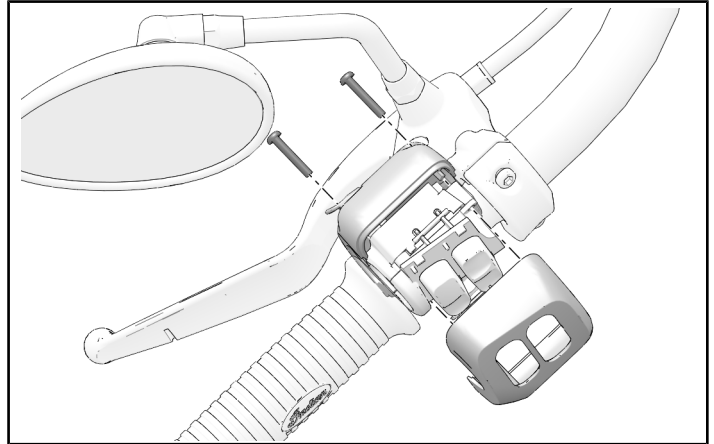

4. Use a small pick to release retaining tab and disconnect clutch lever wire

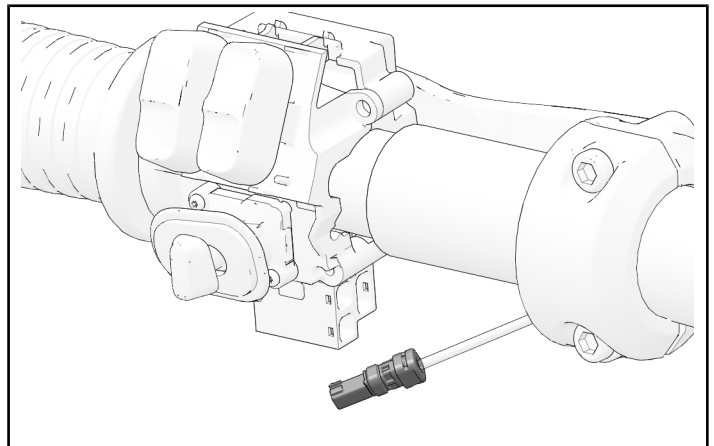

5. Remove two clutch lever assembly fasteners. Carefully let clutch lever assembly hang by clutch cable.

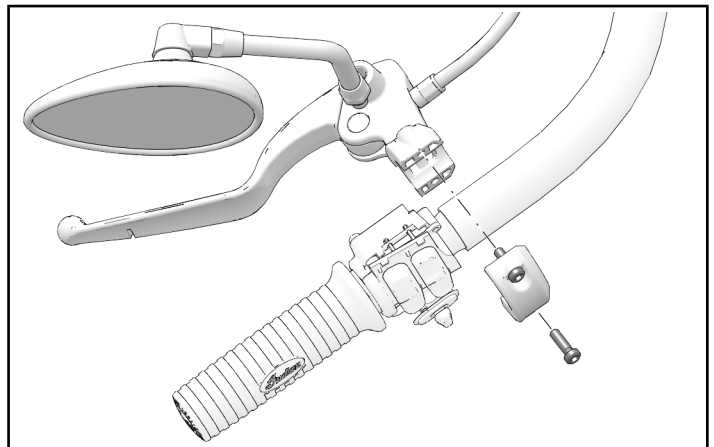

6. Remove two inner cube fasteners. Rotate switch side upward and remove entire assembly. Remaining connectors may stay connected as long as switch cube is supported.

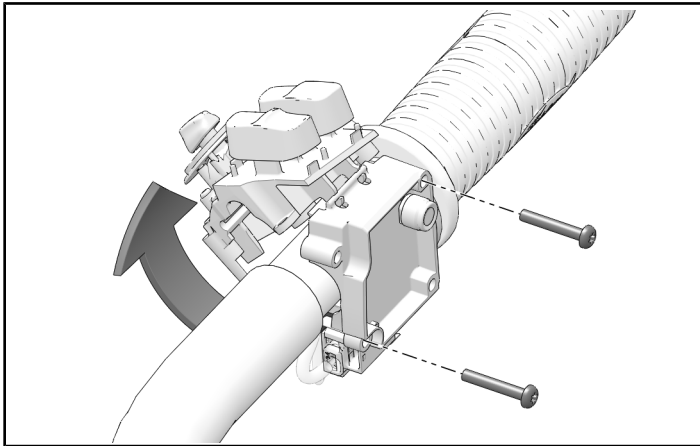

7. Place rubber strap wrench around grip and twist grip to break adhesive free. Use caution to not damage OEM grip. Twist grip back and forth while pulling outward.

TIP

Use a soft hammer to move wrench handle, if needed.

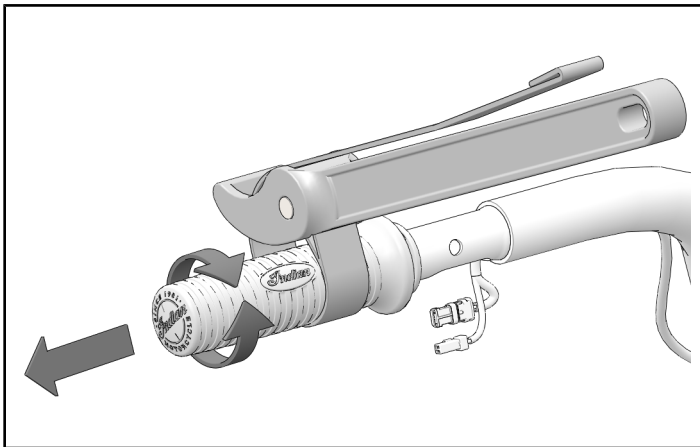

8. Use adhesive remover to clean adhesive residue or grip material from handlebar.

⚠ WARNING

Follow all chemical manufacturer instructions and safety precautions. Failure to follow all manufacturer instructions and precautions may result in severe injury or death.

CLAMPED LEFT GRIP REMOVAL

LEFT GRIP REMOVAL

1. Remove and keep two screws and switch cube cover.

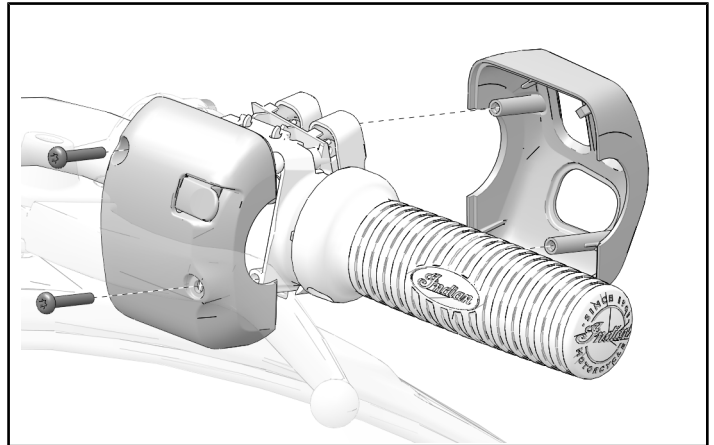

2. Remove two screws from switch, rotate back of switch and remove switch from handlebar. Disconnect any wire connectors from switch.

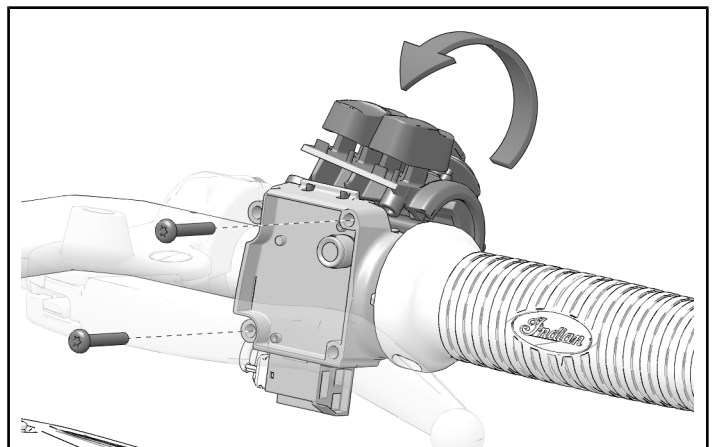

3. Remove fastener from left grip.

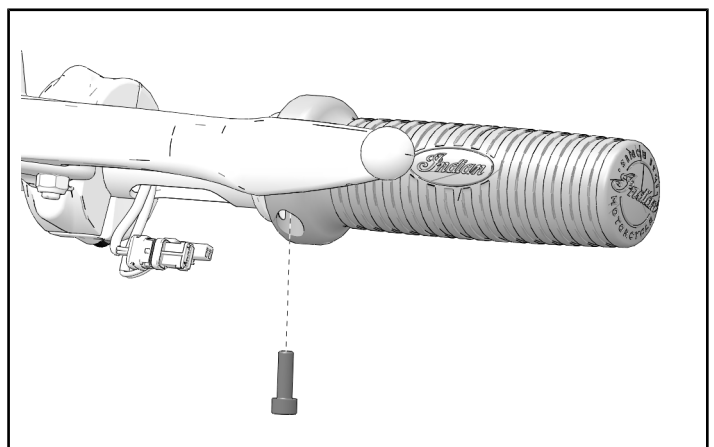

4. Remove left grip.

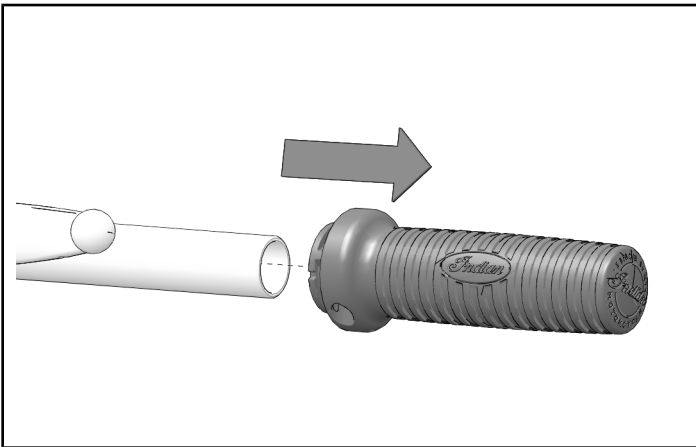

RIGHT GRIP REMOVAL

1. Beginning with lower fastener, remove two fasteners on brake lever assembly. Carefully hang brake lever assembly.

IMPORTANT

Do not allow hand brake master cylinder to be turned upside down once removed. Bleeding the brakes will be required if master cylinder is turned upside down.

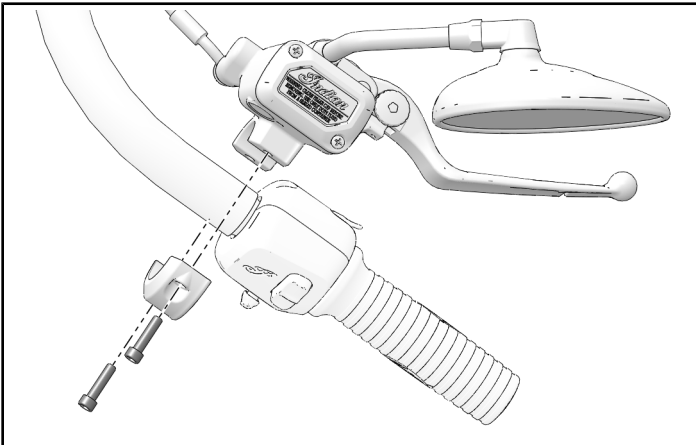

2. Remove two outer cube fasteners and remove two halves of cover.

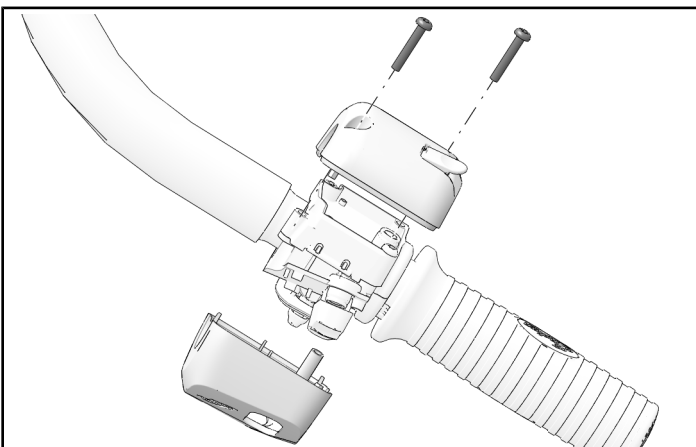

3. Remove two inner cube fasteners. Rotate switch side upward and remove entire assembly. Remaining connectors may stay connected as long as switch cube is supported.

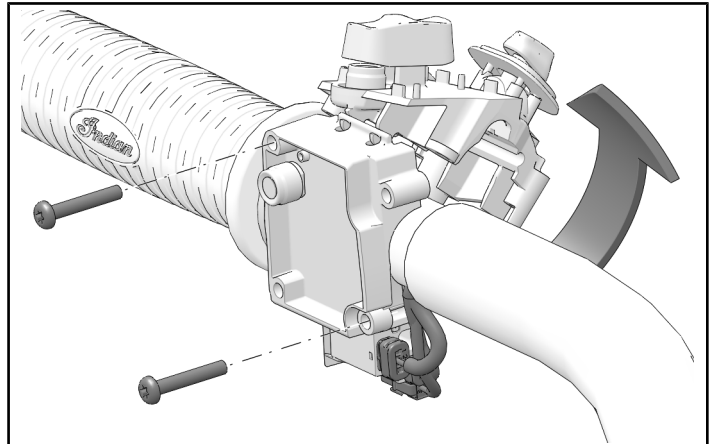

4. Slide and remove right throttle tube/grip from handlebar.

ACCESSORY INSTALLATION

LEFT HEATED GRIP INSTALLATION

1. Install left grip ① onto handlebar end.

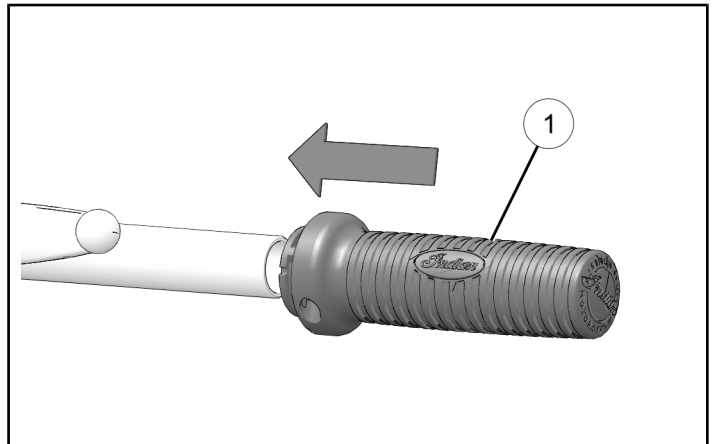

2. Put switch cube onto bar and align tabs on grip ① with notch in switch cube.

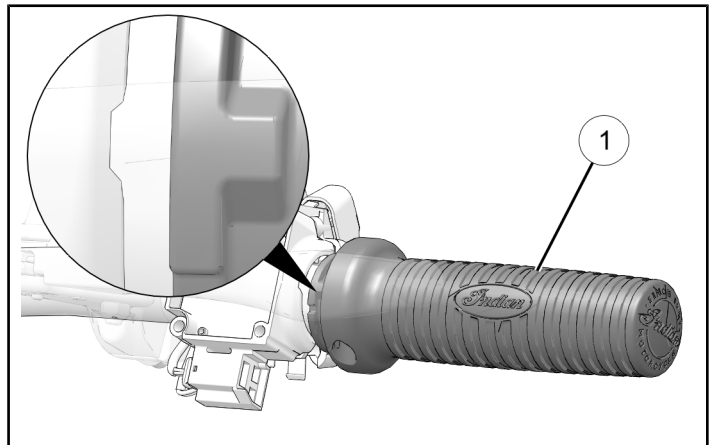

3. When inner switch cube is closed, heated grip wire should exit opening shown with arrow.

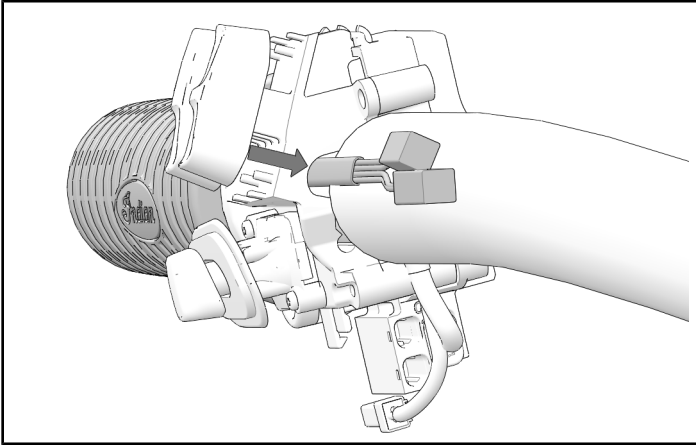

4. Attach inner switch cube with two retained screws. Torque screws to specification.

TORQUE

**Inner Switch Cube Screw:
4.5 in-lbs (0.5 N·m)**

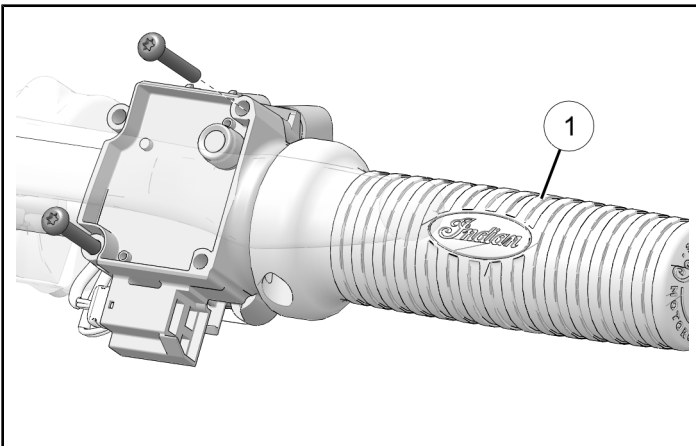

5. Attach grip ① with new screw ③. Torque screw to specification.

TORQUE

**Grip Clamp Screw ③:
53 in-lbs (6 N·m)**

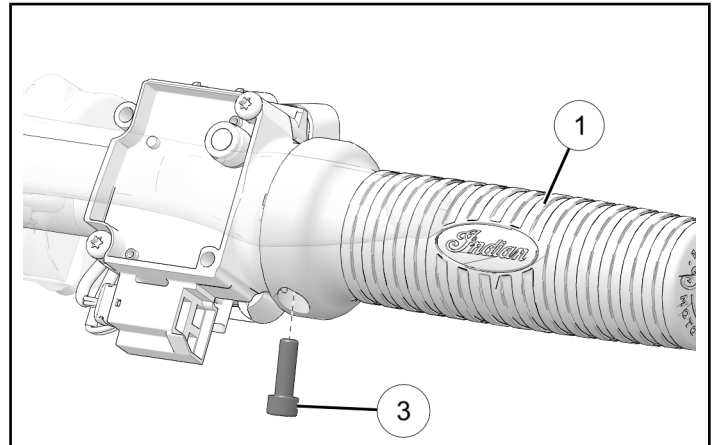

6. Connect all connectors to switch cube assembly and wiring harness as shown.

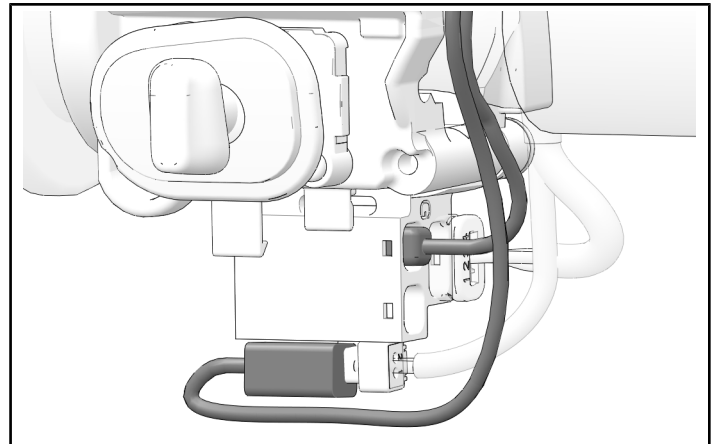

7. Install switch cube covers. Make sure all wiring is inside switch cube covers and attach with two retained screws. Torque screws to specification.

TORQUE

Switch Cube Cover Screw:
4.5 in-lbs (0.5 N·m)

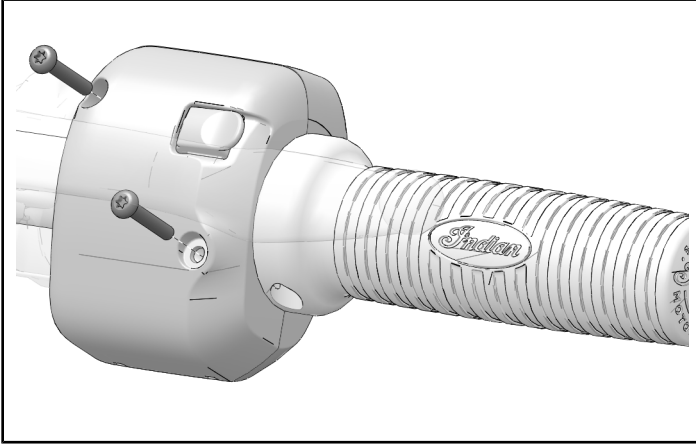

RIGHT-HAND HEATED GRIP INSTALLATION

1. Install new right-hand throttle tube/grip onto handlebar.

TIP

Rotate grip while sliding on to make sure it is fully seated.

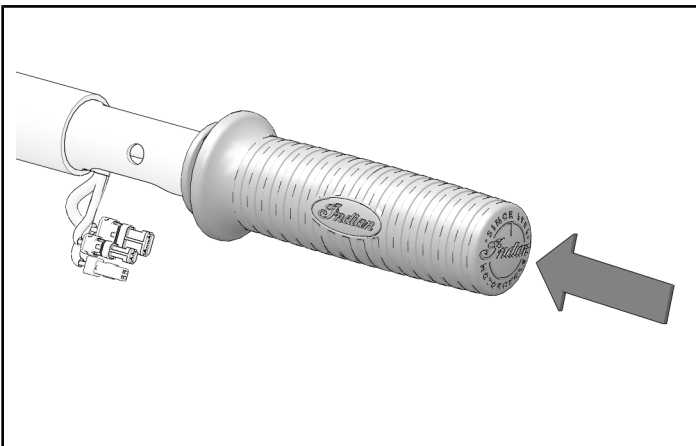

2. Orient inner switch cube so pin is inserted into handlebar. Make sure to line up slots in throttle tube to inner switch cube.

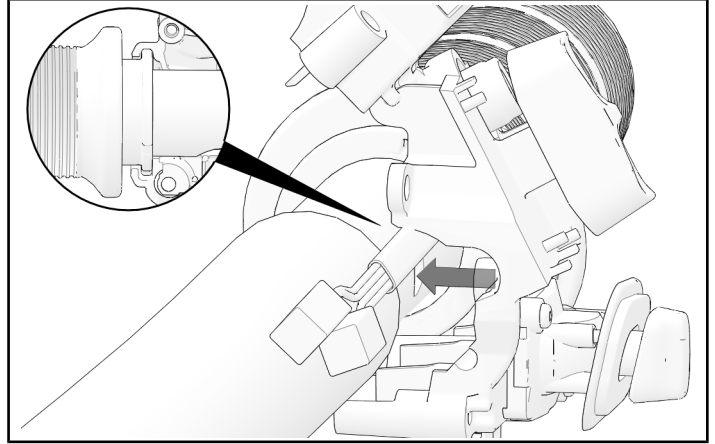

3. When inner switch cube is closed, heated grip wire should exit opening shown with arrow.

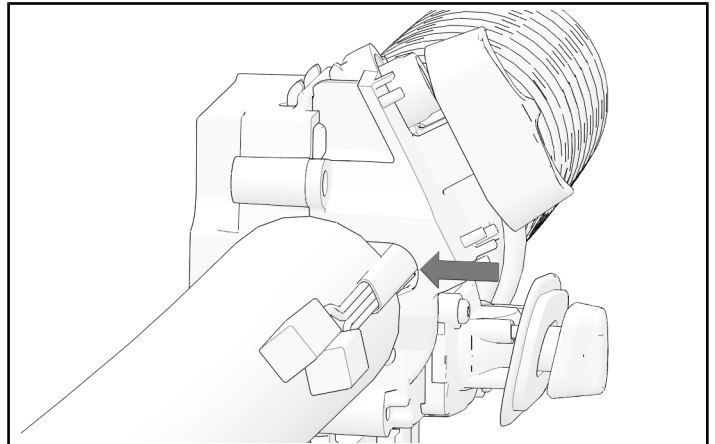

4. Close inner switch cube and reinstall two inner cube fasteners. Torque fasteners to specification.

TORQUE

Inner Cube Fasteners:
7 in-lbs (1 N·m)

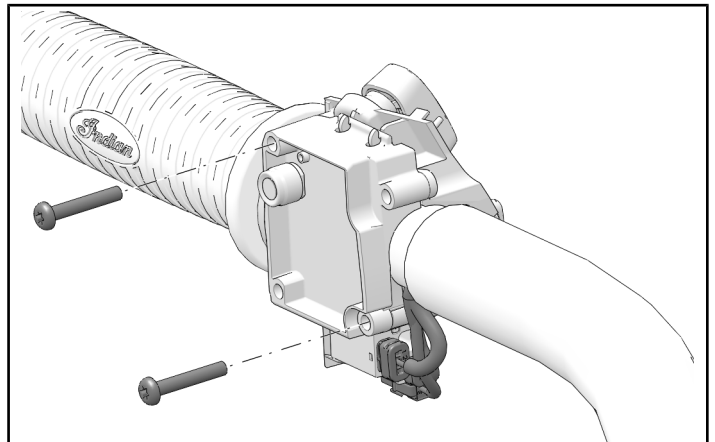

5. Twist throttle fully backward and forward to make sure throttle is properly seated and there is no dragging. If throttle is dragging, repeat previous two steps.
6. Connect all connectors to switch cube assembly and wiring harness as shown.

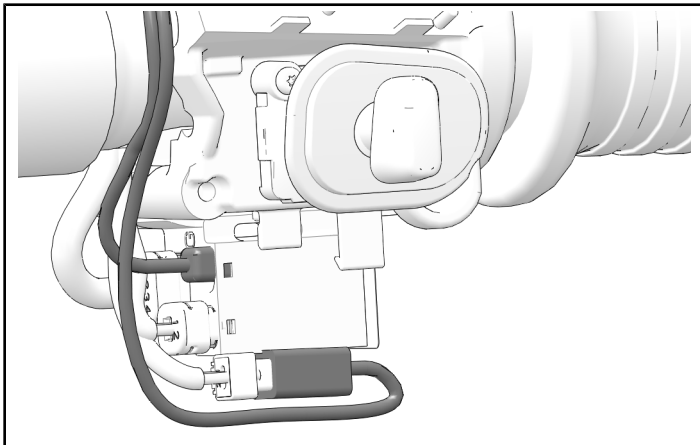

7. Reinstall right-hand switch cube cover using two retained screws. Make sure that all wiring is contained within switch cube. Torque fasteners to specification.

TORQUE

Outer Cube Fasteners:
7 in-lbs (1 N·m)

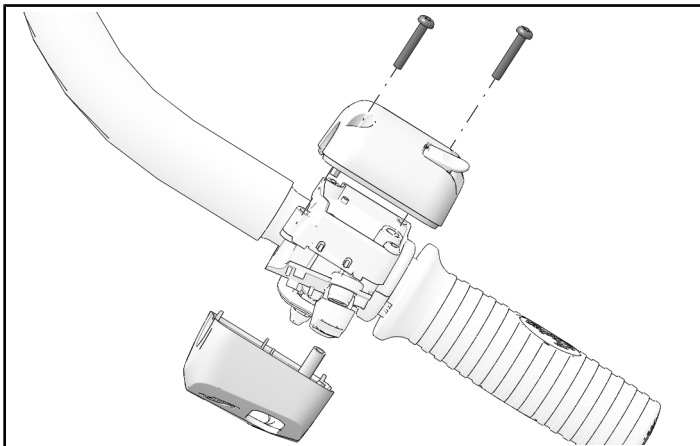

8. Reinstall brake lever assembly using two retained fasteners. Align handle and beginning with top fastener, torque two fasteners to specification.

TORQUE

Brake Lever Assembly Fasteners:
88 in-lbs (10 N·m)

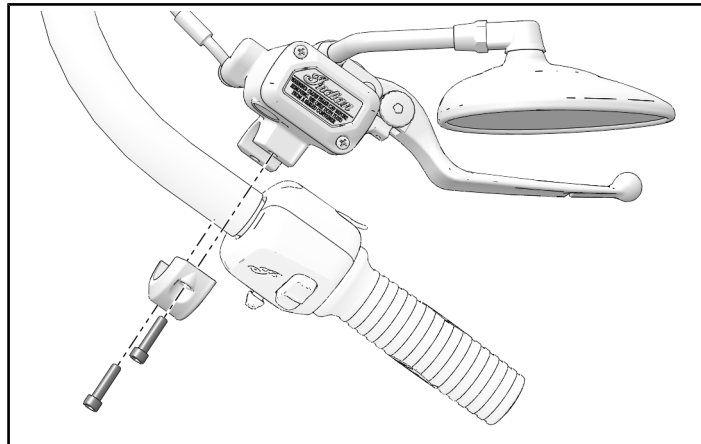

9. Twist throttle fully backward and forward to make sure throttle is properly seated and there is no dragging. If throttle is dragging, repeat installation.

SWITCH INSTALLATION

Choose the correct switch installation section for your motorcycle.

- **Model Year 2022 and Newer Chief Models**
 - Bikes with nacelles go to page 11
 - Bikes without nacelles go to page 13
- **2014 and Newer Heavyweight Aircooled Models** go to page 15
- **2021 and Newer Challenger Models** go to page 16

MODEL YEAR 2022 AND NEWER CHIEF MODELS

SWITCH INSTALLATION (NACELLE MODELS)

For models without driving lights, install *Nacelle Accessory Switch Kit*, P/N 2884951-XXX which is sold separately.

1. Remove and keep five screws **A** that attach the left-hand nacelle trim **B**.

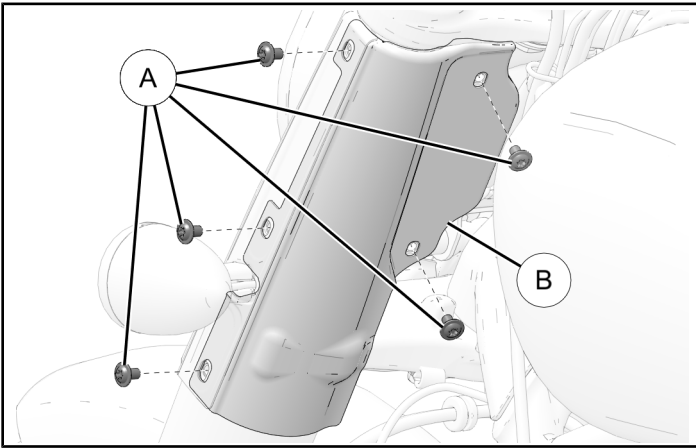

2. Move the nacelle trim **B** away from the bike, providing clearance by gently pulling on the front nacelle part.

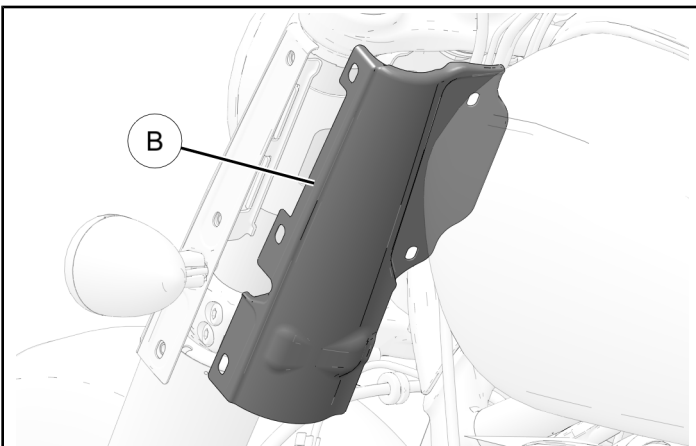

3. Install the routing clip **12**.

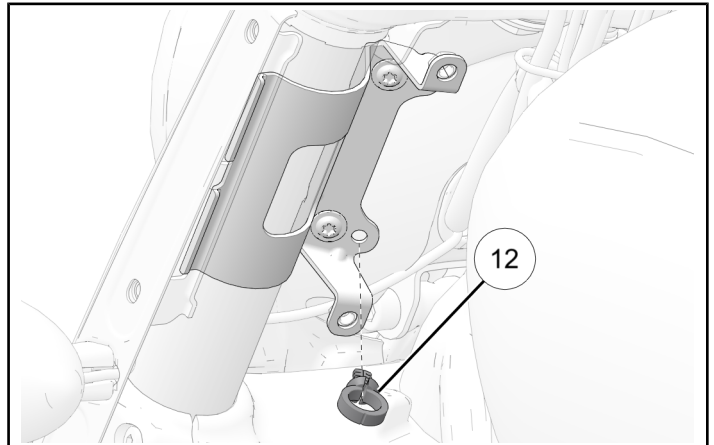

4. Place nacelle bezel spacer **11** on fog button plug **10** and install into bottom hole of the LH buttons rear cover **9**.

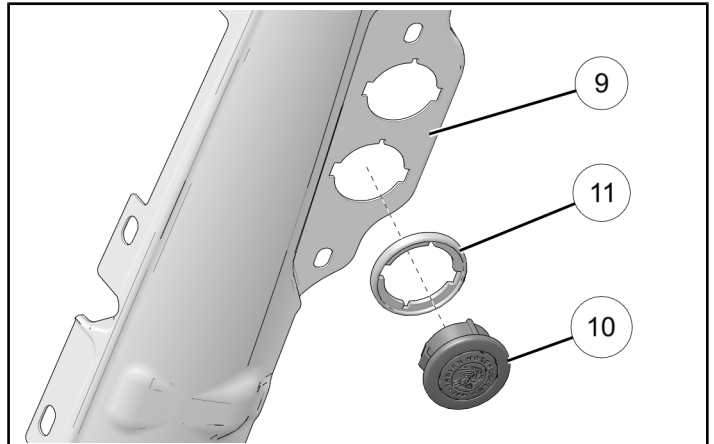

5. Place nacelle bezel spacer (11) on heated grip switch (1) and install into top hole of the LH buttons rear cover (9).

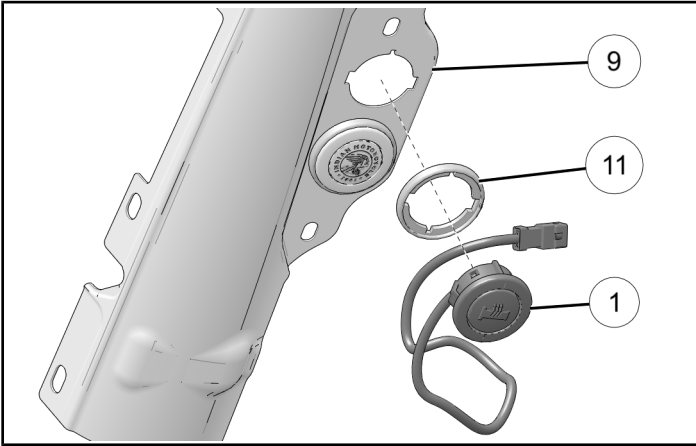

6. Install the LH buttons rear cover (9) onto motorcycle and install the retained screws (A). Torque screws to specification.

TORQUE

LH Buttons Rear Cover Screws (A):
89 in-lbs (10 N·m)

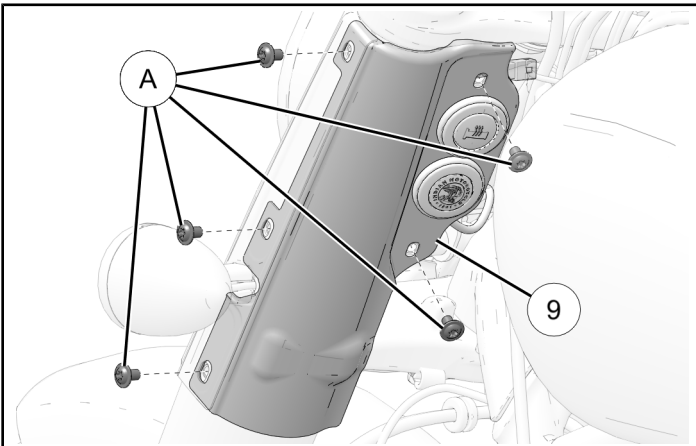

7. Route harness through routing clip (12) and into back of headlight bucket.

NOTICE

The LH buttons rear cover is hidden for image clarity.

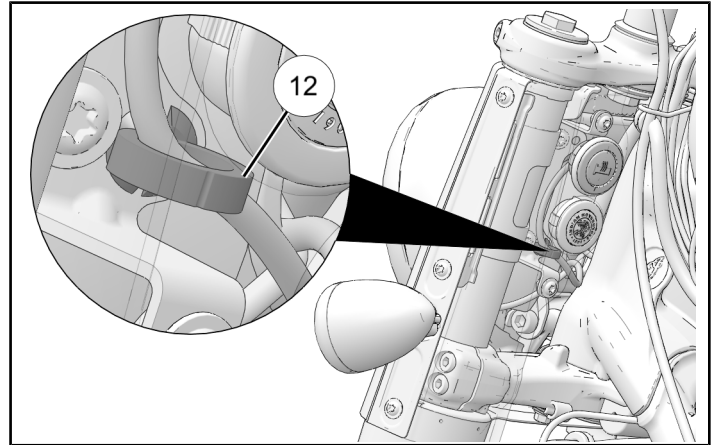

8. If driving lights are installed, loosen the headlight adjustment screw (F).

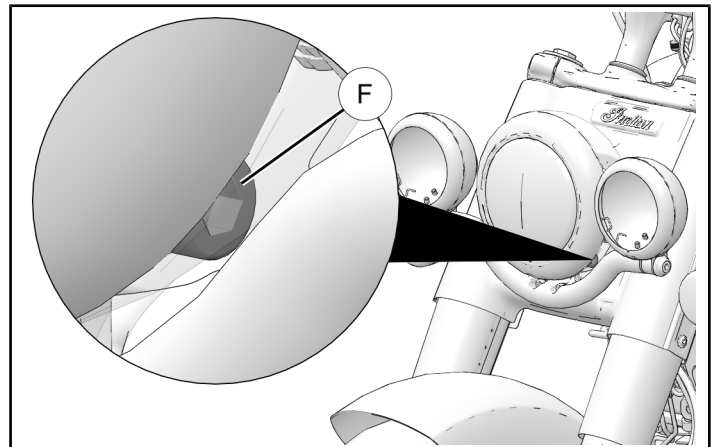

9. If driving lights are installed, pivot headlight bucket (G) rearward to provide access to headlight trim ring screw (C).

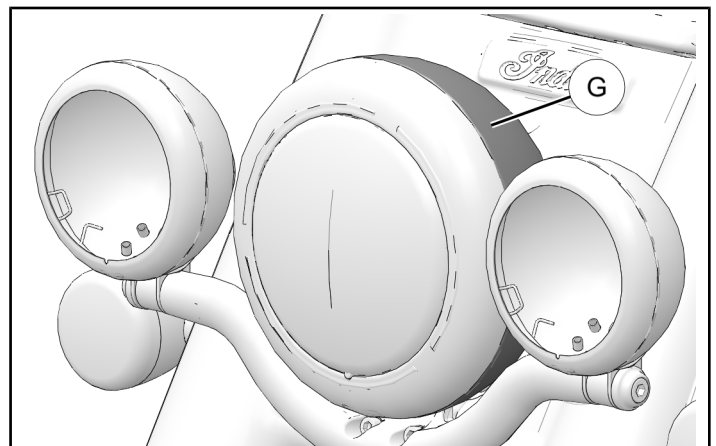

10. Remove and keep headlight trim ring screw (C). Gently remove trim ring (E) and headlight (D) from headlight bucket.

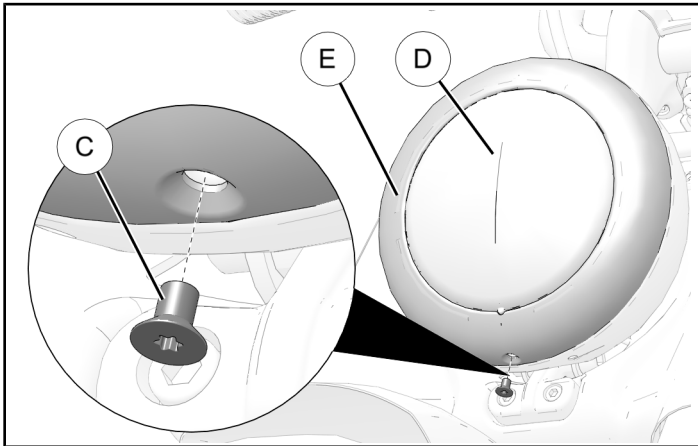

11. Remove and discard the sealed cap from the heated grip lead.
12. Attach the heated grip switch connector to the heated grip connector inside headlight bucket. Install the routing clip (7) to the headlight bucket and use the small pre-installed cable tie on the harness lead to properly position the routing clip.

NOTICE

If driving lights are installed, the routing clip inside headlight bucket will need to be removed and replaced with new routing clip (7).

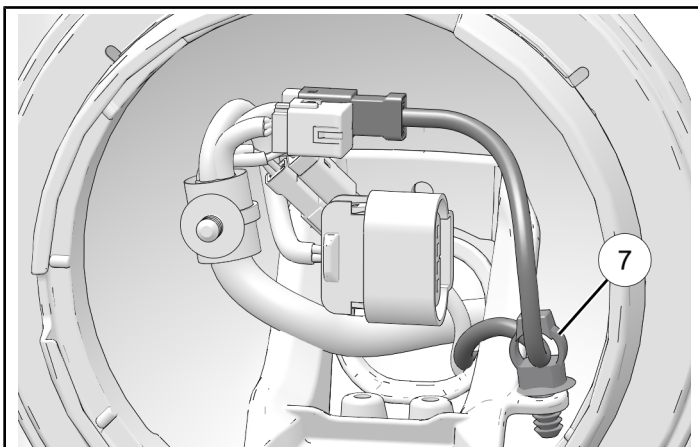

SWITCH INSTALLATION (NON-NACELLE MODELS)

1. Install the heated grip switch bracket (2) and attach with switch bracket mounting screw (6). Torque fastener to specification.

TORQUE

Switch Bracket Mounting Screw (6):
84 in-lbs (9 N·m)

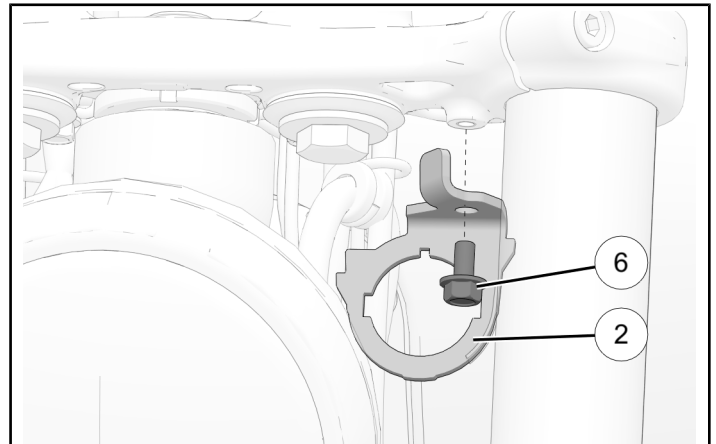

2. Install the heated grip switch (1) into the heated grip switch bracket (2).

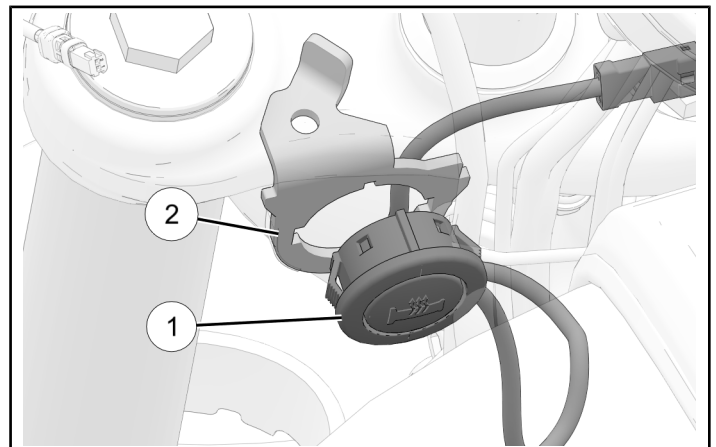

3. Install the heated grip switch cover ⑤ onto heated grip switch bracket, routing the switch through the access hole in the bottom.

NOTICE

Make sure the cover clips in over the bracket tabs.

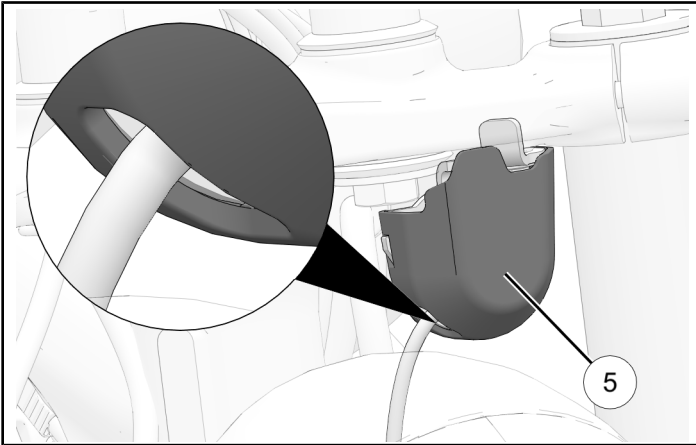

4. Route harness into back of headlight bucket.
5. If driving lights are installed, loosen the headlight adjustment screw ⑥.

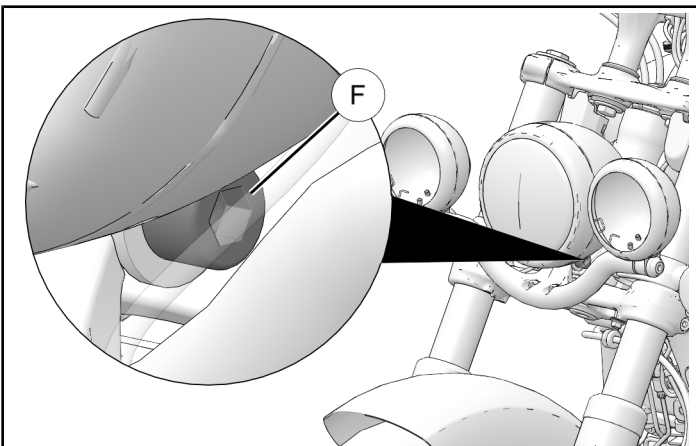

6. If driving lights are installed, pivot headlight bucket ⑥ rearward to provide access to headlight trim ring screw ③.

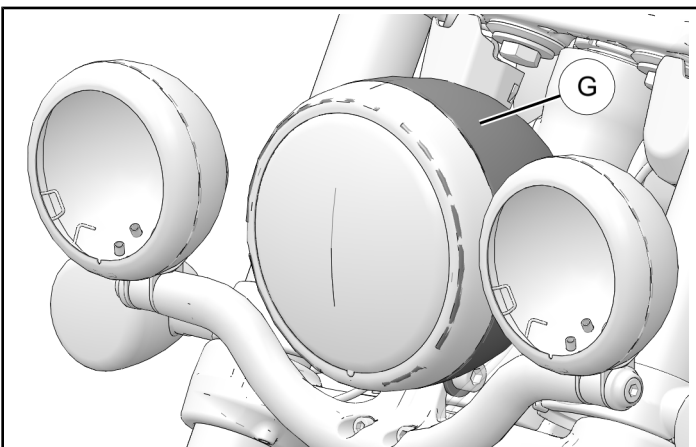

7. Remove and keep headlight trim ring screw ③. Gently remove trim ring ④ and headlight ⑤ from headlight bucket.

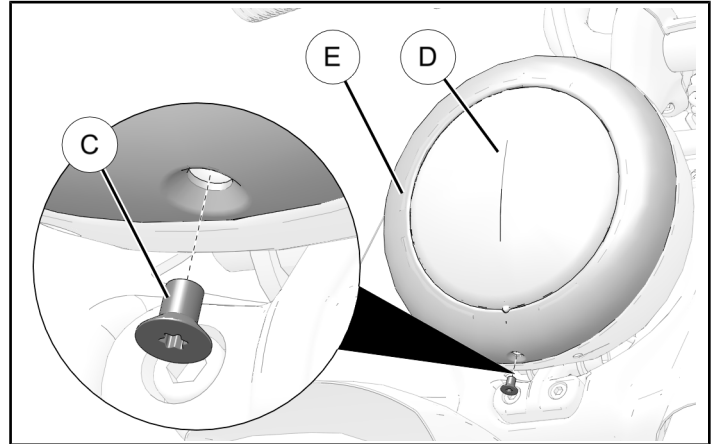

8. Remove and discard the sealed cap from the heated grip lead.
9. Attach the heated grip switch connector to the heated grip connector inside headlight bucket. Install the routing clip ⑦ to the headlight bucket and use the small pre-installed cable tie on the harness lead to properly position the routing clip.

NOTICE

If driving lights are installed, the routing clip inside headlight bucket will need to be removed and replaced with new routing clip ⑦.

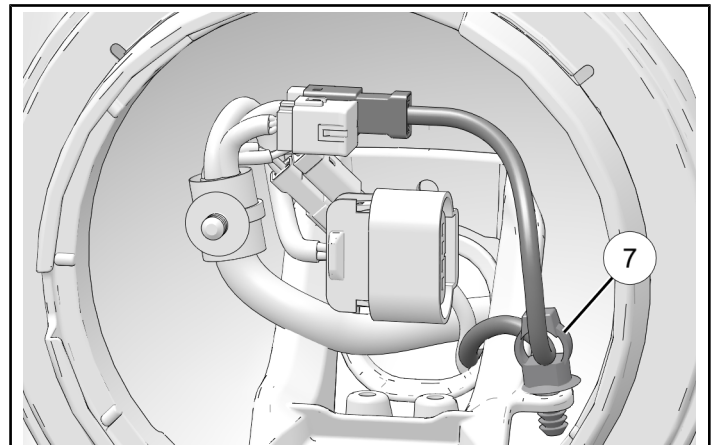

MODEL YEAR 2014 AND NEWER HEAVYWEIGHT AIRCOOLED MODELS

HEATED GRIP SWITCH INSTALLATION

1. Remove and retain tank console fastener(s).

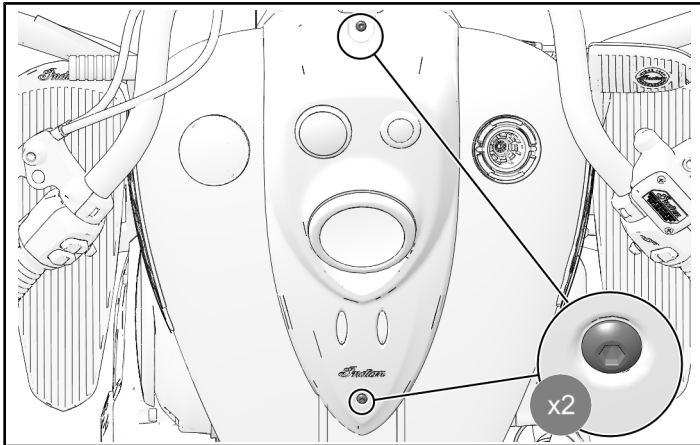

2. Carefully lift tank console from tank, reach under console and disconnect any connectors that may be installed. Carefully set tank console on protective surface.

TIP

There may be up to six (6) connectors under tank console, depending on model and features.

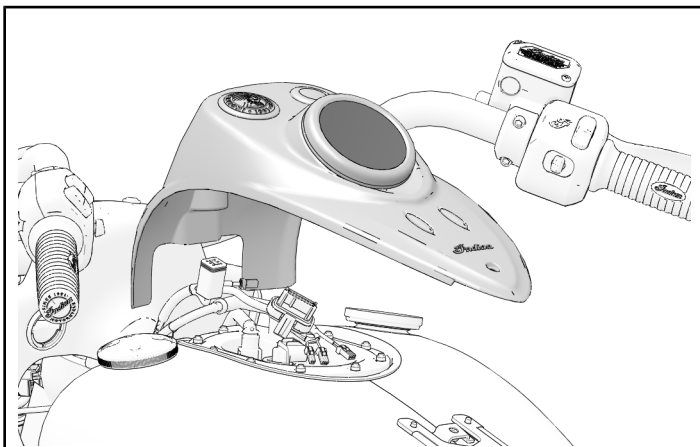

3. Remove and retain two switch fasteners. Remove and discard switch blank.

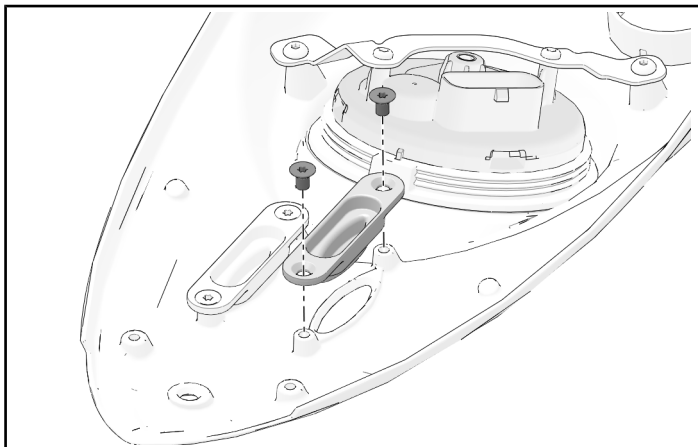

4. Install new switch and secure with two retained switch fasteners.

TORQUE

Switch Fasteners:
20 in-lbs (2 N·m)

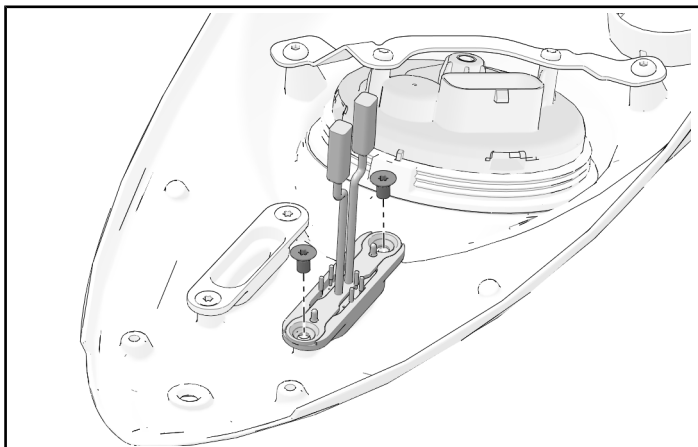

5. Plug heated grip switch connectors into corresponding connectors under console. Reconnect all other connectors under console.

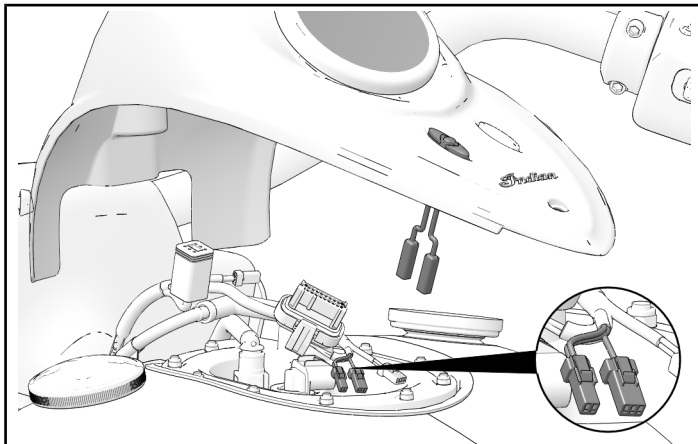

- Reinstall tank console and secure with retained screws.

TORQUE

Console Cover Fasteners:
84 in-lbs (9 N·m)

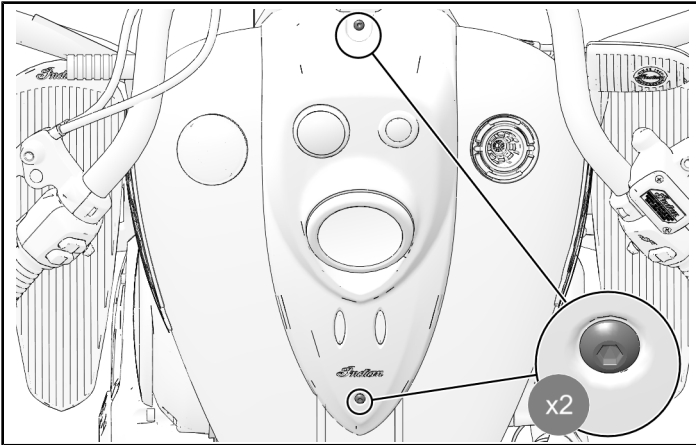

MODEL YEAR 2021 AND NEWER CHALLENGER MODELS

OUTER FAIRING REMOVAL

- Open storage doors (A) and pull out storage liners (B). Set liners aside.

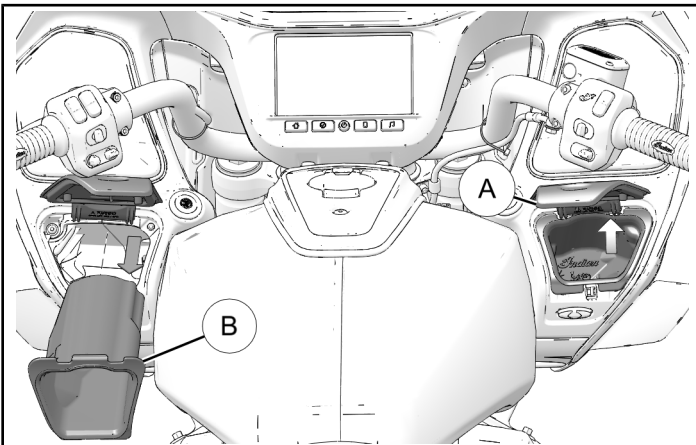

- Carefully pry along edge with non-marring pry tool to disengage speaker grill assemblies (C).

TIP

Use Special Tool:
 Non-marring Pry Tool, P/N 5456907 (or equivalent)

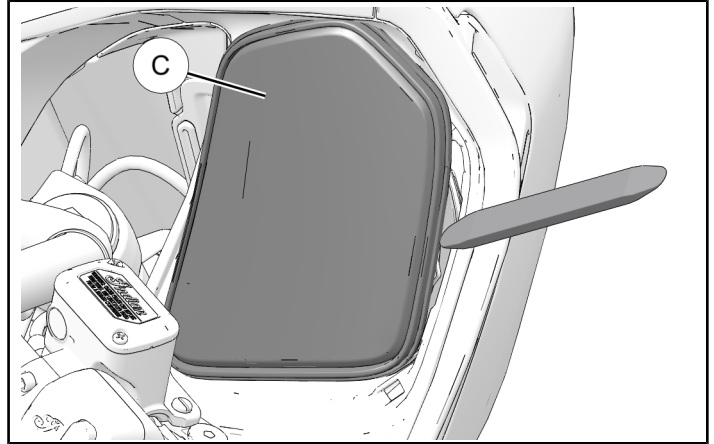

- Gently pry along top edge of headlight bezel (D) with non-marring pry tool. Pull headlight bezel (D) down and out. Carefully set aside.

TIP

Use Special Tool:
 Non-marring Pry Tool, P/N 5456907 (or equivalent)

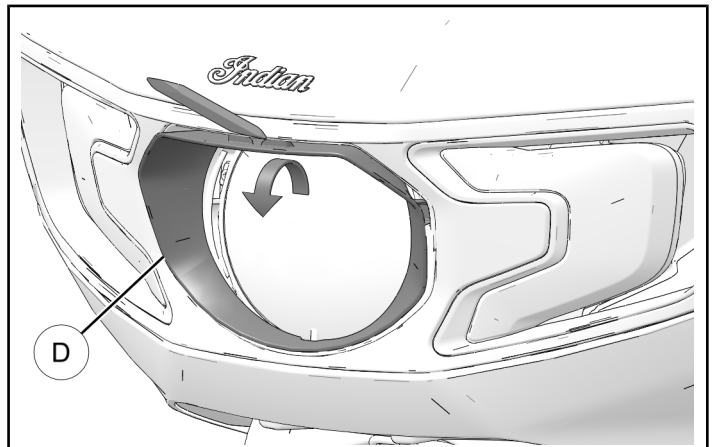

4. Remove and keep three screws (E) from around headlight bezel as shown.

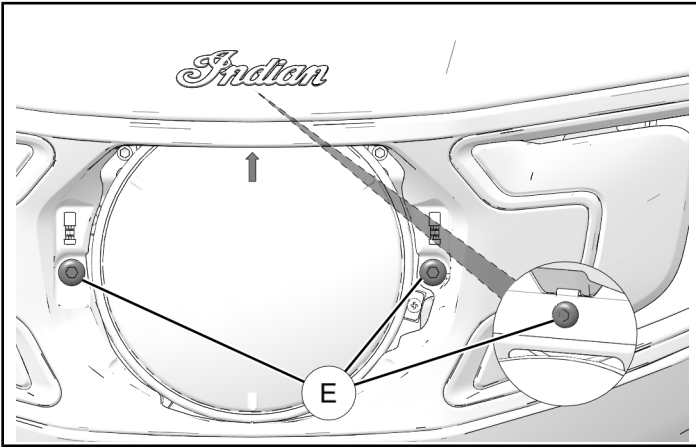

6. Remove and keep one screw (G) from under edge of each side of fairing as shown.

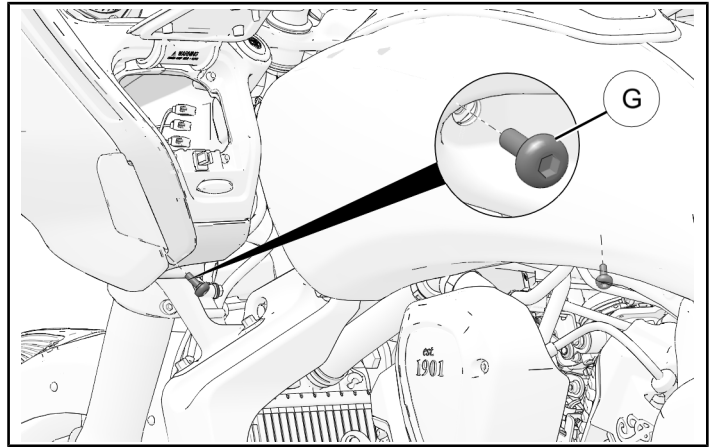

5. Remove and keep two screws (F) from top outer corner of storage openings and two screws (F) from top center of speaker openings.

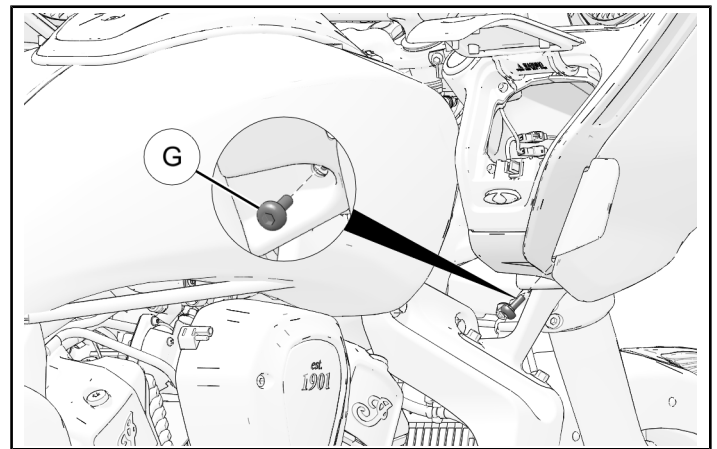
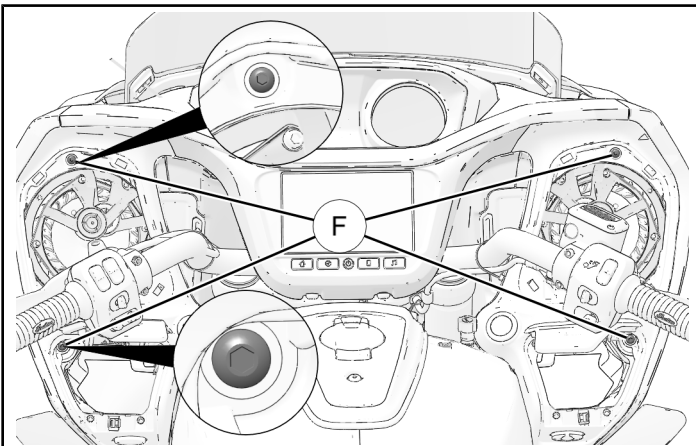

7. Pull fairing outward at top to disengage. Pull fairing out a short distance.

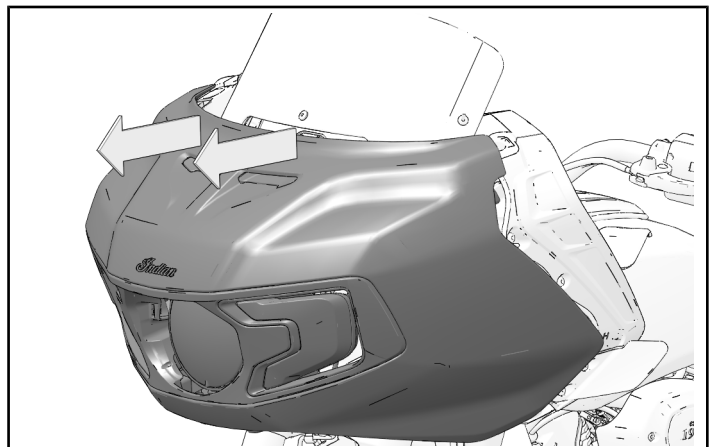

8. Disconnect connectors for headlight (H) and turn signals (J).

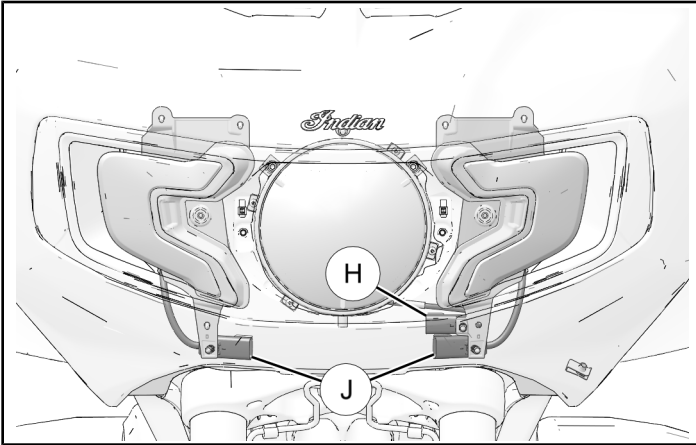

3. Remove and retain two switch fasteners. Remove and discard switch blank.

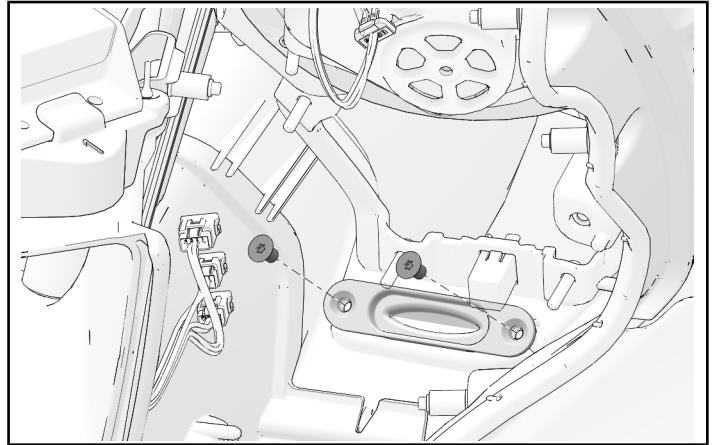

9. Carefully pull outer fairing off motorcycle and set aside.

HEATED GRIP SWITCH INSTALLATION

1. Identify switch blank behind left-hand storage cover.

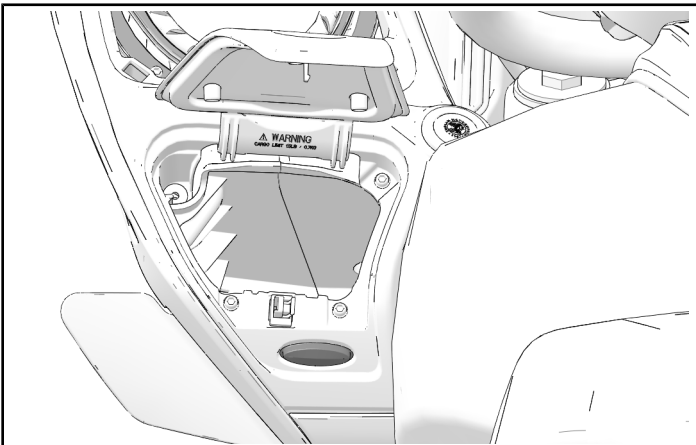

2. Access switch blank from front of fairing.

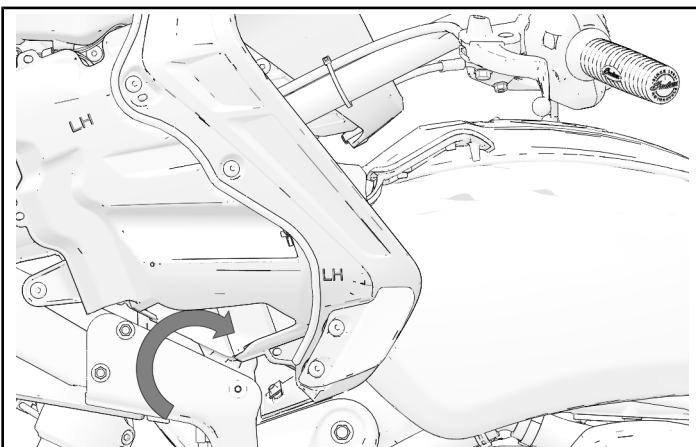

4. Install new switch and secure with two retained switch fasteners.

TORQUE

Switch Fasteners:
20 in-lbs (2 N·m)

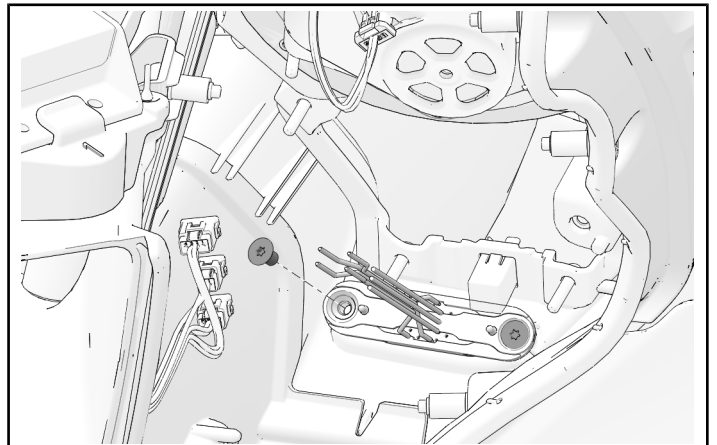

5. Join switch connectors to chassis harness wires, located on the side of storage compartment.

OUTER FAIRING INSTALLATION

1. Lubricate two grommets on inside of fairing with soapy water.

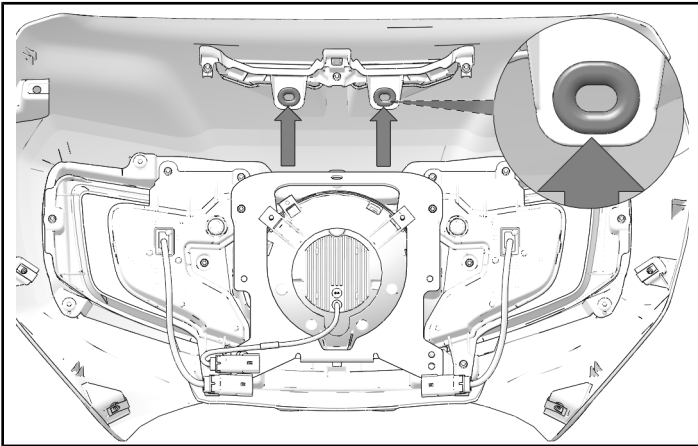

2. Set outer fairing in place and connect turn signal (J) and headlight (H) wire connectors.

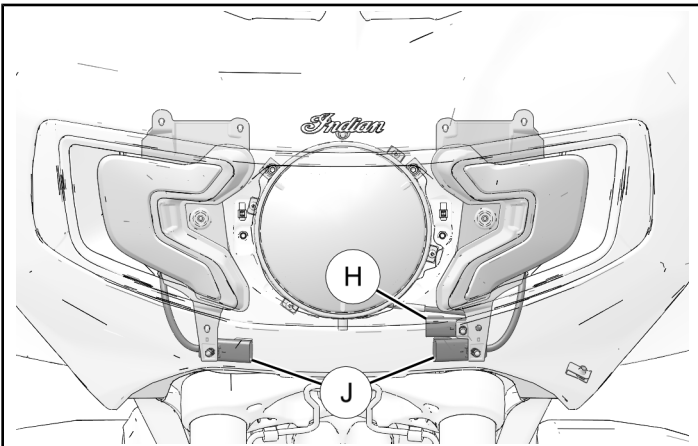

3. Press fairing into place and at top edge to engage locating pins.

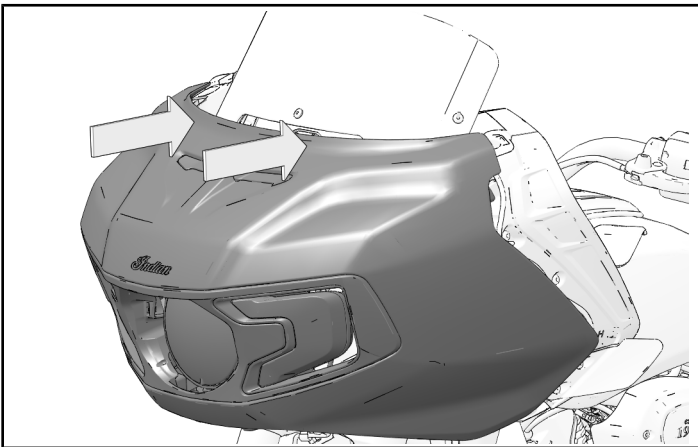

4. Loosely install one screw (G) into hole under edge of each side of fairing as shown.

DO NOT torque fasteners at this time.

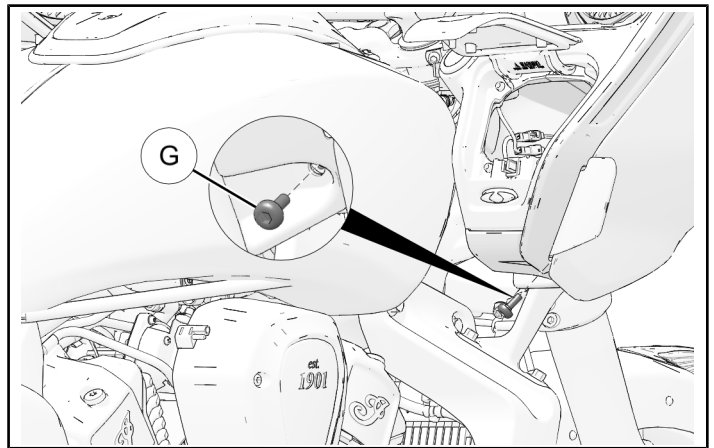
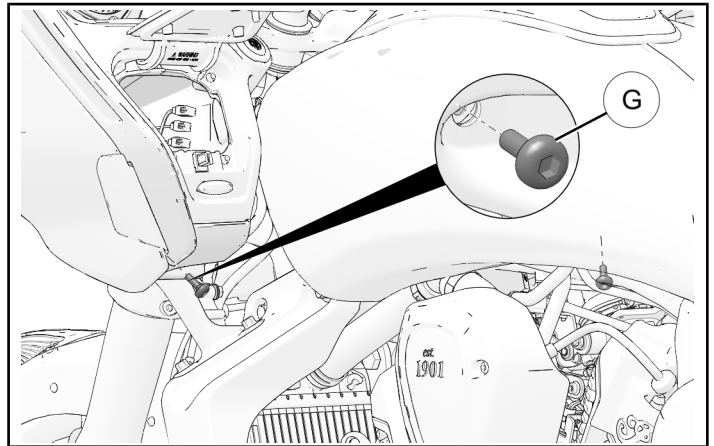

5. Loosely install two screws (F) into top outer corner of storage openings and two screws (F) into top center of speaker openings.

DO NOT torque fasteners at this time.

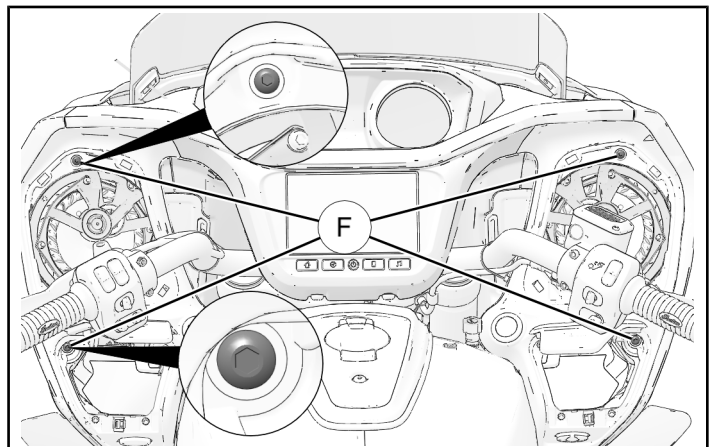

6. Loosely install three screws (E) around headlight bezel as shown.

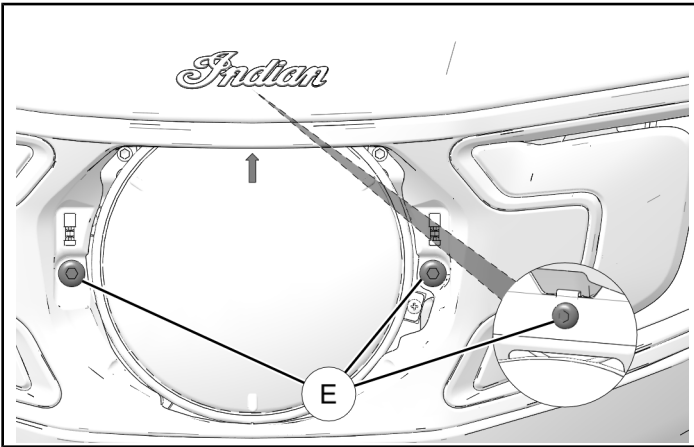

7. Torque all outer fairing screws to specification.

TORQUE

Outer Fairing Screws (E, F, G):
36 in-lbs (4 N·m)

8. Carefully reinstall headlight bezel (D) into outer fairing opening starting with bottom tab. Push down on bezel (or use non-marring tool as shown) to insert upper tabs without damaging finish.

TIP

Use Special Tool:
 Non-marring Pry Tool, P/N 5456907 (or equivalent)

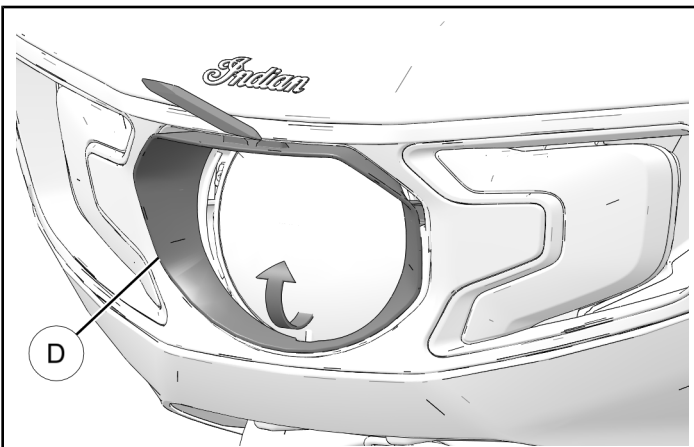

9. Reinstall fairing speaker grills (C).
 10. Reinsert storage liners (B).

VEHICLE REASSEMBLY

HEADLIGHT BUCKET REASSEMBLY WITHOUT DRIVING LIGHTS INSTALLED

1. Install the headlight (D) and trim ring (E) onto headlight bucket. Install the headlight trim ring screw (C) and torque to specification.

TORQUE

Headlight Trim Ring Screw (C):
29 in-lbs (3.3 N·m)

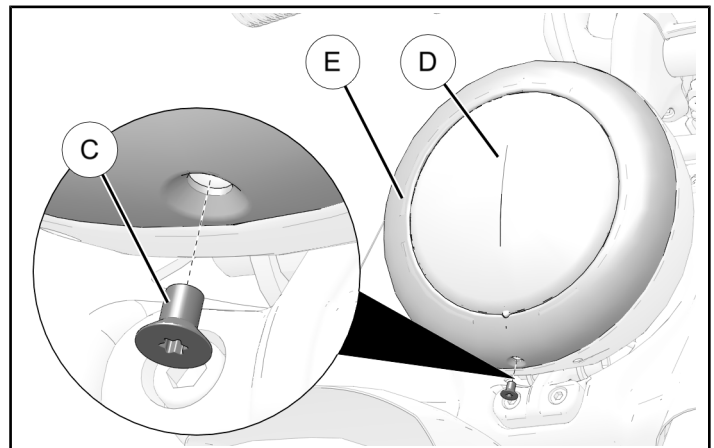

NOTICE

Attach the routing clip (8) to the new heated grip harness lead near the connector body and install into the left-hand top threaded hole in the back of the headlight (D) as it is installed.

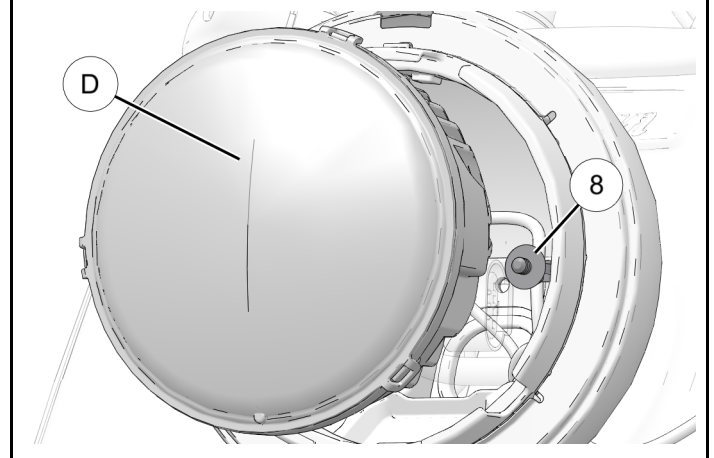

HEADLIGHT BUCKET REASSEMBLY WITH DRIVING LIGHTS INSTALLED

1. Install the headlight ④ and trim ring ⑤ onto headlight bucket. Install the headlight trim ring screw ③ and torque to specification.

TORQUE

Headlight Trim Ring Screw ③:
29 in-lbs (3.3 N·m)

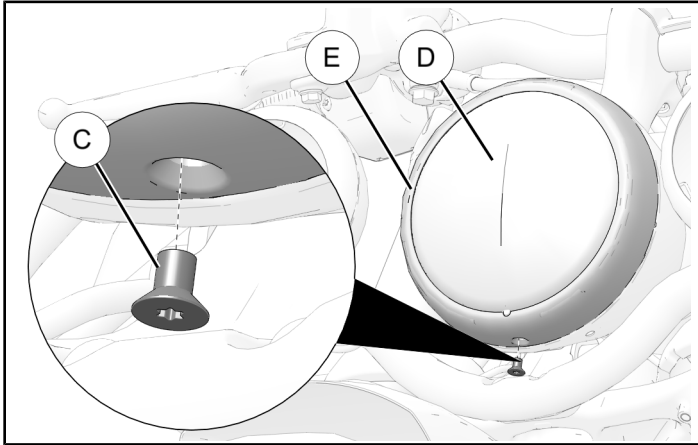

NOTICE

Attach the routing clip ⑧ to both the driving light and the new heated grip harness leads near the connector bodies and install into the left-hand top threaded hole in the back of the headlight ④ as it is installed.

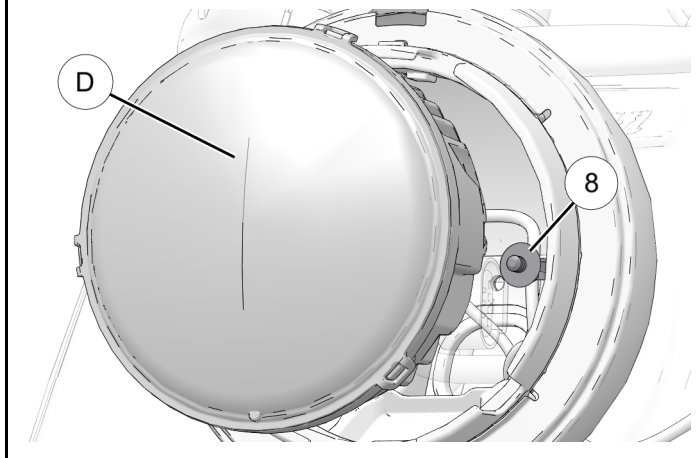

2. Aim headlight as outlined in the owner's manual. Torque headlight adjustment screw ⑥ to specification.

TORQUE

Headlight Adjustment Screw ⑥:
29 ft-lbs (40 N·m)

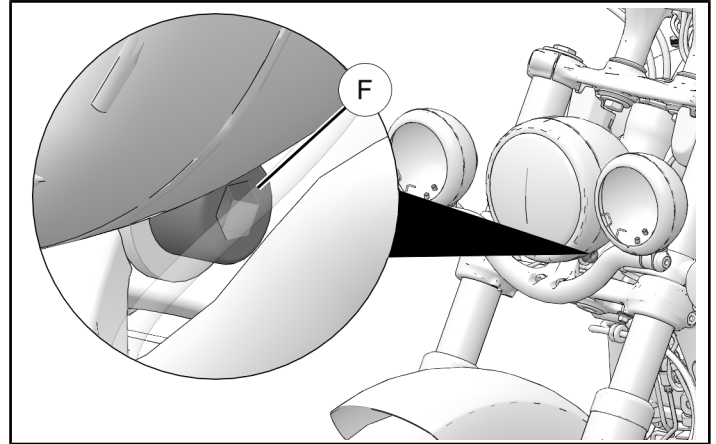

OPERATION

MODEL YEAR 2022 AND NEWER CHIEF MODELS

OPERATION

- High Heat: Push the switch once to activate.
- Medium Heat: Push the switch a second time to activate.
- Low Heat: Push the switch a third time to activate.
- Off: Push the switch a fourth time to turn the heated hand grips off.

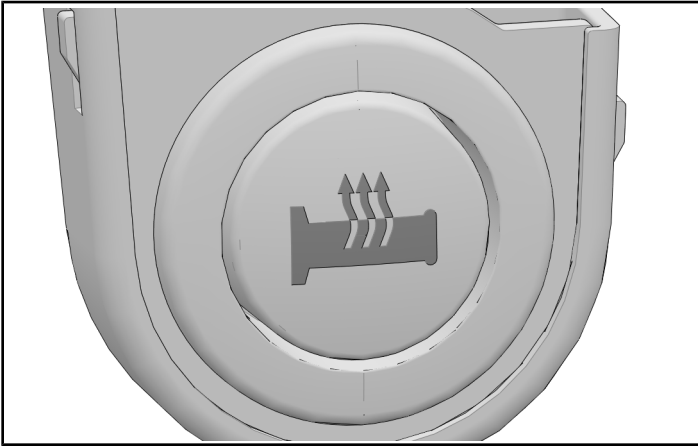

MODEL YEAR 2014 AND NEWER HEAVYWEIGHT MOTORCYCLES

OPERATION

- Press the top or bottom of the switch to turn the hand grip heaters on. The center of the switch illuminates when heaters are on. Press the center of the switch to turn the heaters off ②.

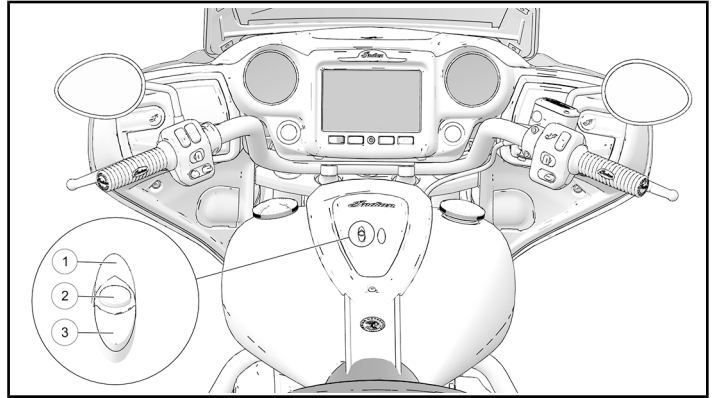

- The heaters have 10 heat levels, ranging from OFF (level 0) to highest heat (level 10). Press and release the top of the switch ① to increase the heat level by one increment. Press and release the bottom of the switch ③ to decrease heat by one increment.
- The heaters turn off when the engine is turned off. When the engine is restarted the heaters turn on at the previous heat level setting.

INSTRUCTION FEEDBACK FORM

A feedback form has been created for the installer to provide any comments, questions or concerns about the installation instructions. The form is viewable on mobile devices by scanning the QR Code® or by clicking [HERE](#) if viewing on a PC.

