

# SNOWPLOW BUMPER MOUNT KIT



P/N 2889578

## MISSING OR DAMAGED PARTS

Before beginning assembly, inspect the kit and its component(s) to be sure all parts and tools are accounted for and not damaged. If missing parts or parts are damaged, please contact your Selling Dealer for assistance.

If your accessory was purchased online, please contact POLARIS® customer service at **1-800-POLARIS** (US & Canada only).

## APPLICATION

Verify accessory fitment at [www.polaris.com](http://www.polaris.com).

## REQUIRED SOLD SEPARATELY

Only parts for installation of the Snowplow Bumper Mount Kit are included. Prior installation of one of the following additional kits are also required (sold separately):

- Bull Bumper Kit, P/N 2884492
- HD Front Bumper Kit, P/N 2884494

## KIT CONTENTS

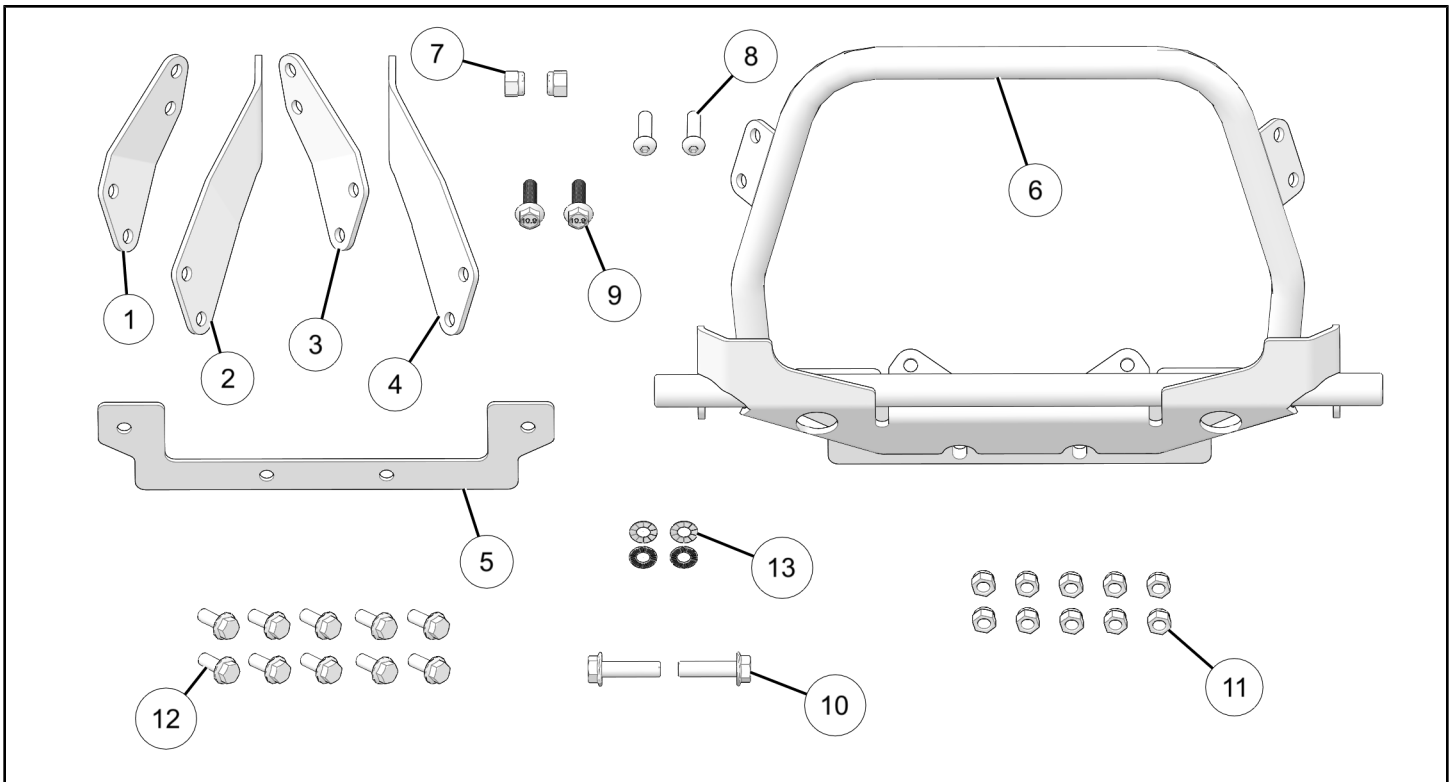

REF	QTY	PART DESCRIPTION	P/N AVAILABLE SEPARATELY	AVAILABLE SERVICE KIT
1	1	Bracket, Left	n/a	2209960
2	1	Bracket, Left	n/a	2209960
3	1	Bracket, Right	n/a	2209960

REF	QTY	PART DESCRIPTION	P/N AVAILABLE SEPARATELY	AVAILABLE SERVICE KIT
4	1	Bracket, Right	n/a	2209960
5	1	Spacer	n/a	2209960
6	1	Plow Mount	n/a	n/a
7	2	Nut, Flange M12 x 1.5 mm	n/a	n/a
8	2	Screw, Hex Button Head M10 x 1.5 x 35 mm	n/a	n/a
9	2	Screw, Hex Flange Head M10 x 1.5 x 35 mm	n/a	n/a
10	2	Screw, Hex Flange Head M12 x 1.5 x 45 mm	n/a	n/a
11	10	Nut, Flange M10 x 1.5 mm	n/a	n/a
12	10	Screw, Hex Flange Head M10 x 1.5 x 25 mm	n/a	n/a
13	2	Washer, Wedge Lock	n/a	n/a

## TOOLS REQUIRED

- Safety Glasses
- Hex Key Set, Metric
- Socket Set, Hex Bit, Metric
- Socket Set, Metric
- Torque Wrench
- Wrench Set, Metric

## IMPORTANT

Your Snowplow Bumper Mount Kit is exclusively designed for your vehicle. Please read the installation instructions thoroughly before beginning. Installation is easier if the vehicle is clean and free of debris. For your safety, and to ensure a satisfactory installation, perform all installation steps correctly in the sequence shown.

## INSTALLATION INSTRUCTIONS

### VEHICLE PREPARATION

#### GENERAL

1. Park vehicle on a flat surface.
2. Shift vehicle into PARK.
3. Turn key to OFF position and remove key.

### ACCESSORY INSTALLATION

#### HD FRONT BUMPER INSTALLATION

1. Remove lower screws at bottom of HD front bumper.

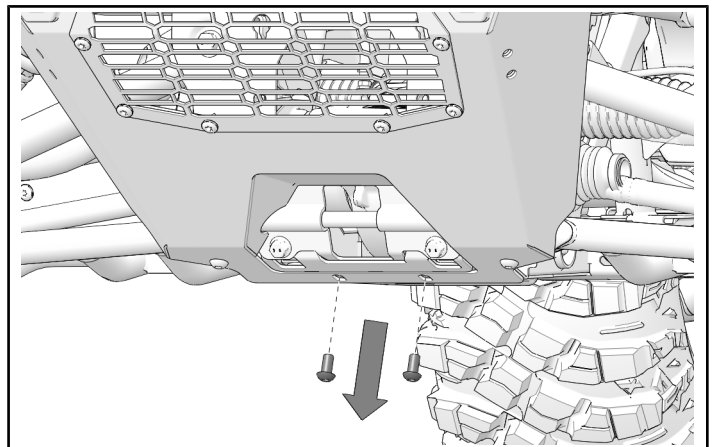

2. Remove two screws from front tow cover.

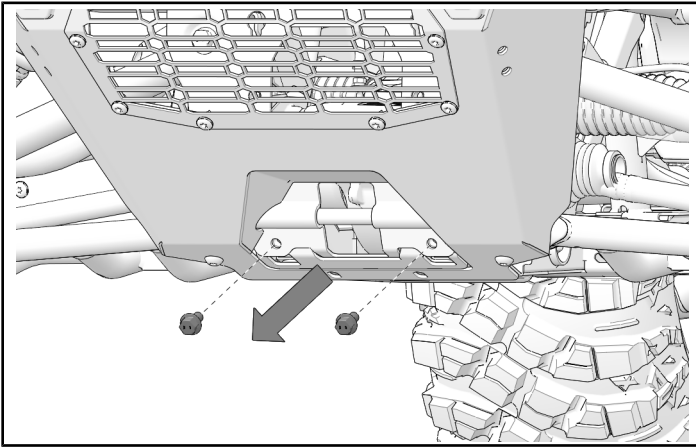

3. Loosely install plow mount (6), two screws (9), two washers (13), and two screws (12).

DO NOT torque fasteners at this time.

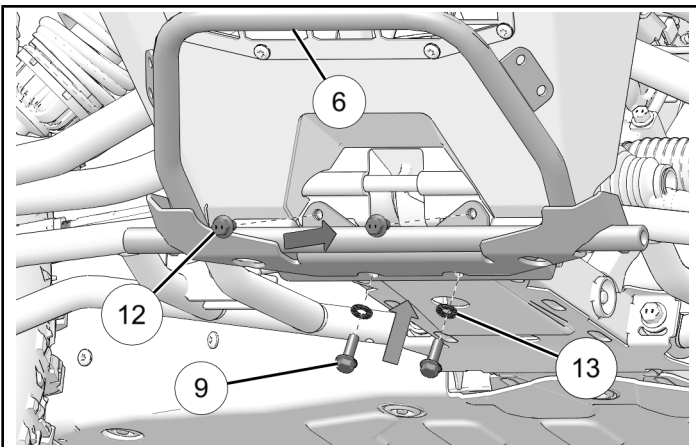

4. Loosely install two button head screws (8) and two nuts (11).

DO NOT torque fasteners at this time.

**NOTICE**

HD Front Bumper and other components hidden for clarity.

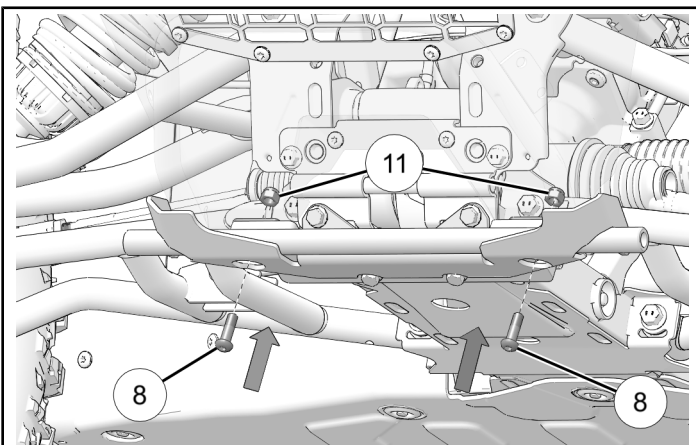

5. Loosely install left bracket (1), right bracket (3), eight nuts (11), and eight screws (12).

DO NOT torque fasteners at this time.

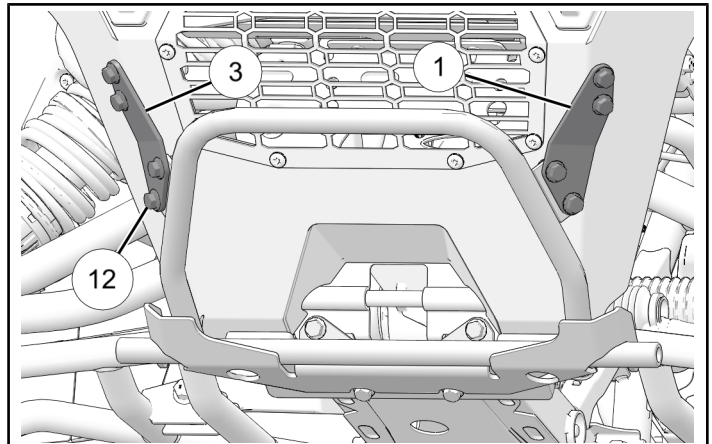

**NOTICE**

Rear view of plow mount shown.

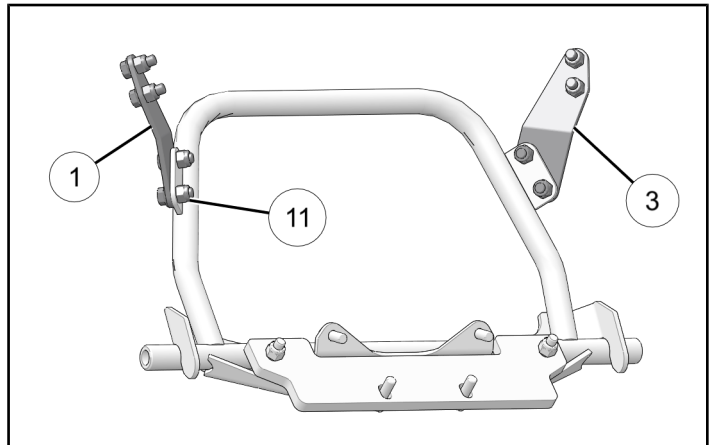

**NOTICE**

Rear view of HD Front Bumper shown.

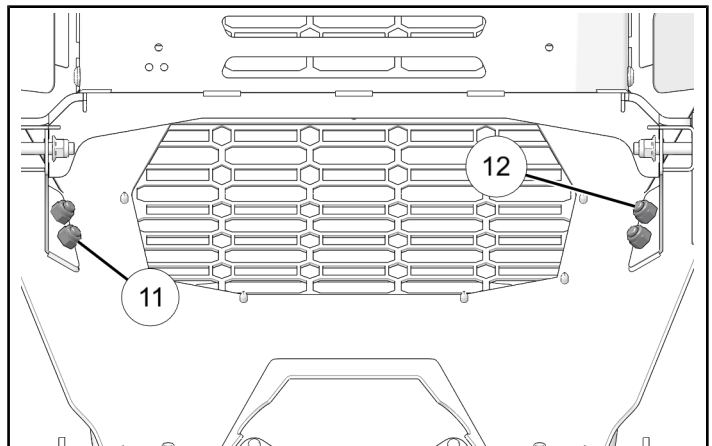

6. Torque all fasteners to specification.

### TORQUE

Screws ⑧ ⑨ ⑫:  
37 ft-lbs (50 N·m)

### NOTICE

After first time installation, re-torque all bolts and nuts after first 30 minutes of operation, and periodically throughout each season. Inspect plow system before, during, and after use. Look for loose parts, winch damage, and snow/ice build-up. Make sure your plow is ready prior to the next big storm.

## BULL BUMPER INSTALLATION

1. Assemble spacer ⑤ to mount ⑥. Use two screws ⑧ and two nuts ⑪ through outermost holes in spacer.

DO NOT torque fasteners at this time.

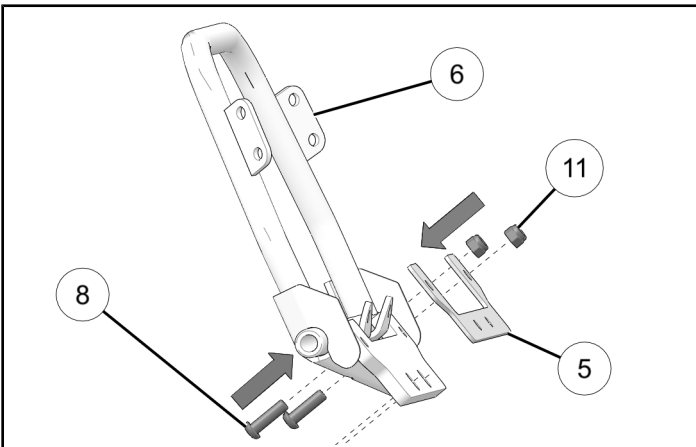

2. Remove two lower bolts from tow cover on vehicle.

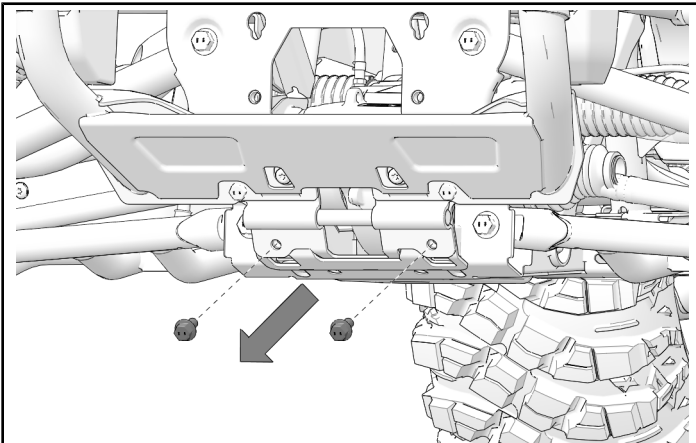

3. Loosely install mount ⑥. Use two screws ⑨, two washers ⑬, and two screws ⑫.

DO NOT torque fasteners at this time.

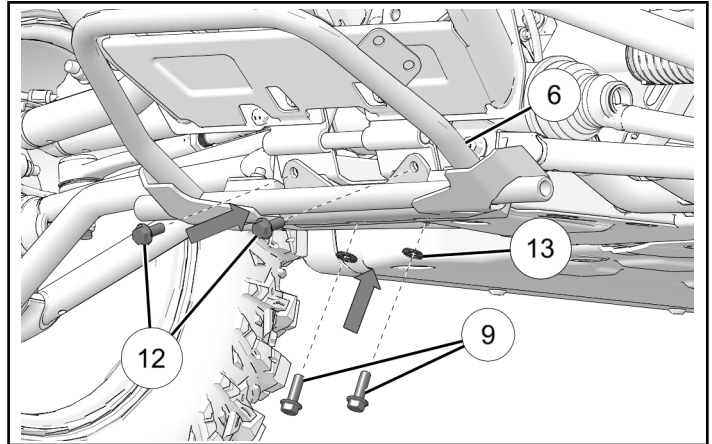

4. Loosely assemble left bracket ② and right bracket ④ to plow mount and bull bumper. Use four screws ⑫ and four nuts ⑪ to attach brackets to plow mount. Use two screws ⑩ and two nuts ⑦ to attach brackets to bull bumper.

DO NOT torque fasteners at this time.

### NOTICE

Make sure brackets are mounted on inside of hole locations on bull bumper.

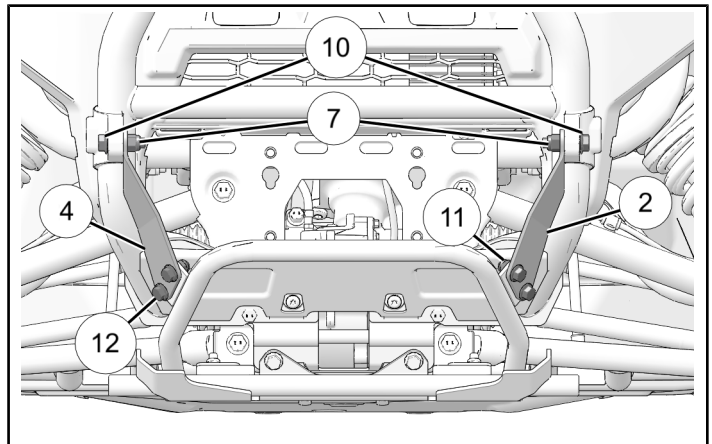

5. Torque all fasteners to specification.

### TORQUE

Screws ⑧ ⑨ ⑫:  
37 ft-lbs (50 N·m)

### TORQUE

Screws ⑩:  
70 ft-lbs (95 N·m)

### *NOTICE*

After first time installation, re-torque all bolts and nuts after first 30 minutes of operation, and periodically throughout each season. Inspect plow system before, during, and after use. Look for loose parts, winch damage, and snow/ice build-up. Make sure your plow is ready prior to the next big storm.