

# REAR CARGO RACK KIT



P/N 2890037

## BEFORE YOU BEGIN

Read these instructions and check to be sure all parts and tools are accounted for. Please retain these installation instructions for future reference and parts ordering information.

## APPLICATION

Verify accessory fitment at [www.polaris.com](http://www.polaris.com).

## KIT CONTENTS

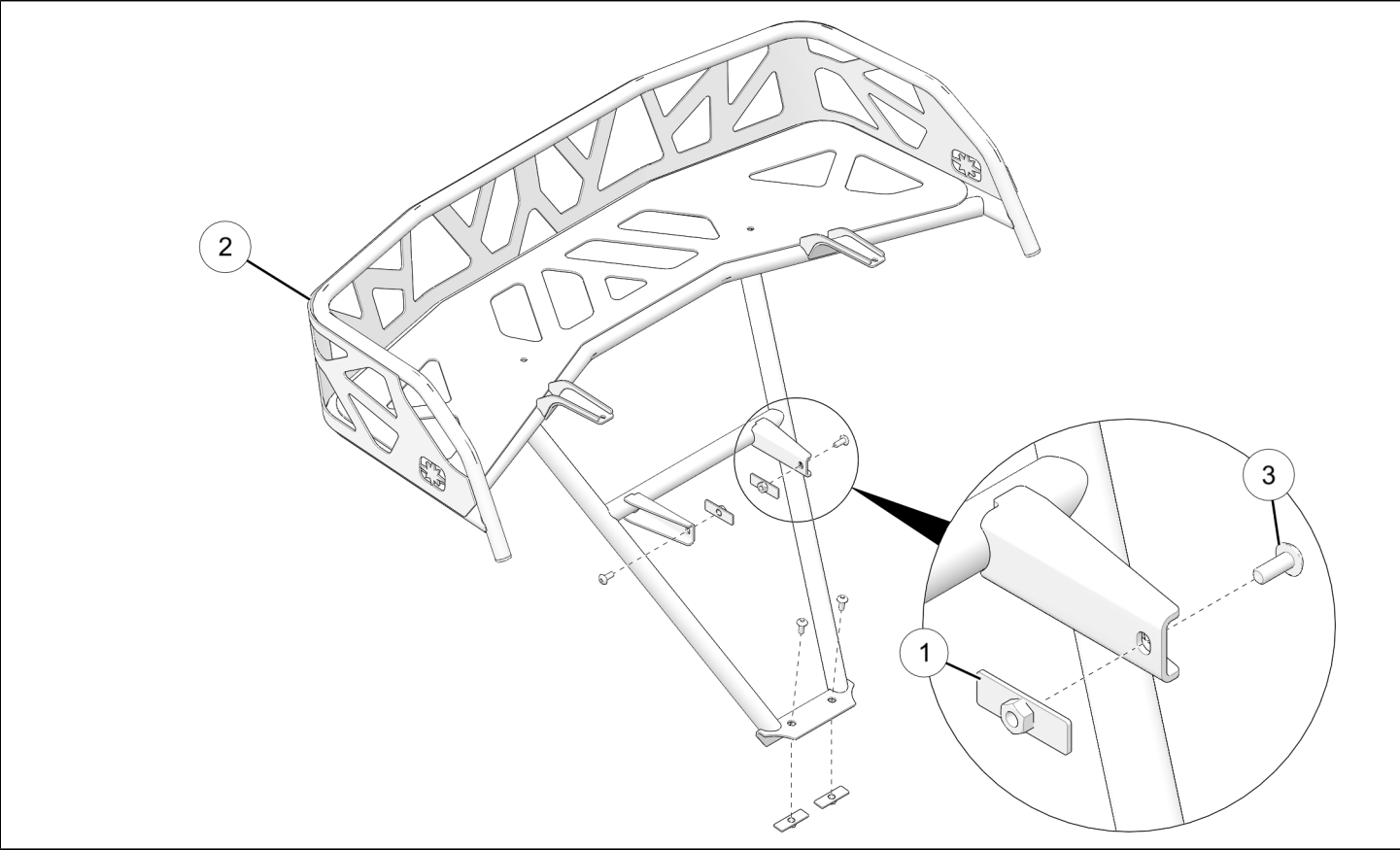

**NOTICE**  
XXX = [BRAND]® color code (For example: 266 = Black)

REF	QTY	PART DESCRIPTION	P/N AVAILABLE SEPARATELY
1	4	Weldment – Mount	1026391–458
2	1	Assembly – Rear Cargo Rack	2639028–458
3	4	Screw – Torx®, M8 x 1.25 x 20 mm	7519260

## TOOLS REQUIRED

- Safety Glasses
- Socket Set, Torx® Bit
- Wrench Set, Metric

## IMPORTANT

Your Rear Cargo Rack Kit is exclusively designed for your vehicle. Please read the installation instructions thoroughly before beginning. Installation is easier if the vehicle is clean and free of debris. For your safety, and to ensure a satisfactory installation, perform all installation steps correctly in the sequence shown.

## INSTALLATION INSTRUCTIONS

### VEHICLE PREPARATION

#### GENERAL

1. Park vehicle on a flat surface.
2. Push engine stop switch to OFF position.
3. Turn key to OFF position and remove key.

### ACCESSORY INSTALLATION

1. Remove and keep two screws from rear cargo rack.

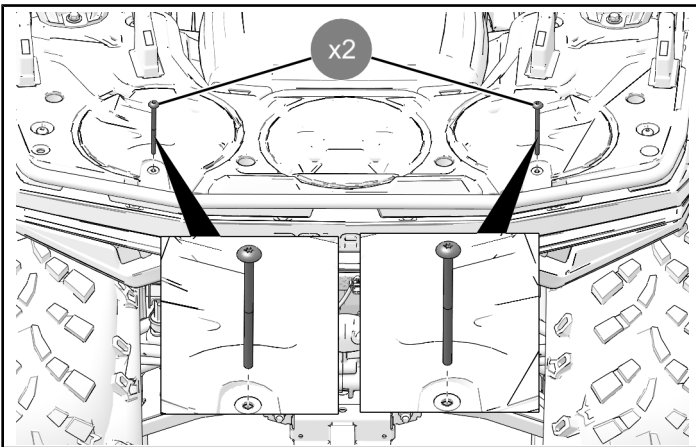

2. Put rear cargo rack extender on vehicle. Line up two top mounting tabs where screws were removed in Step 1.

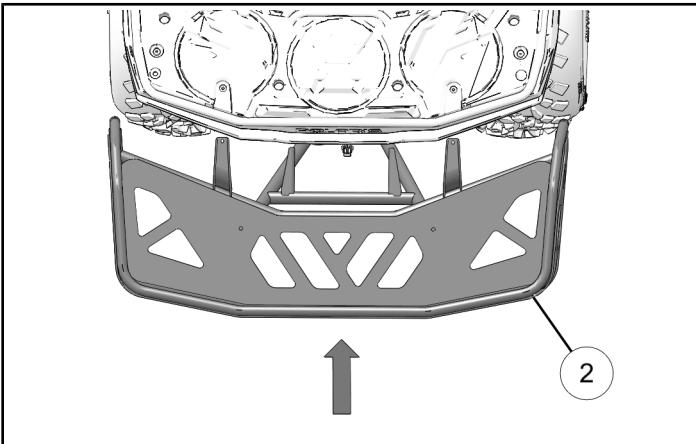

3. Loosely install two kept screws to attach rear rack extender to vehicle.

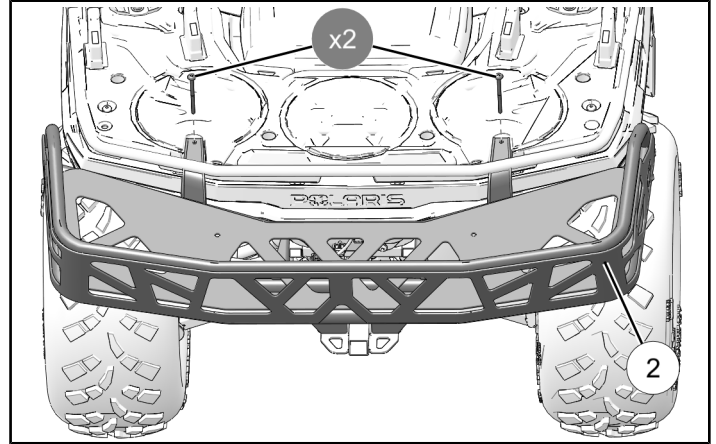

4. Put two weldments ① inside tube above rear hitch receiver. Loosely install two screws ③.

**NOTICE**

Left side weldment ① not shown.

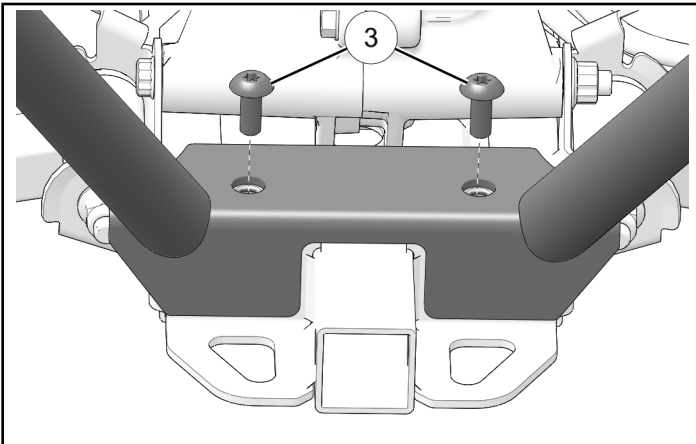
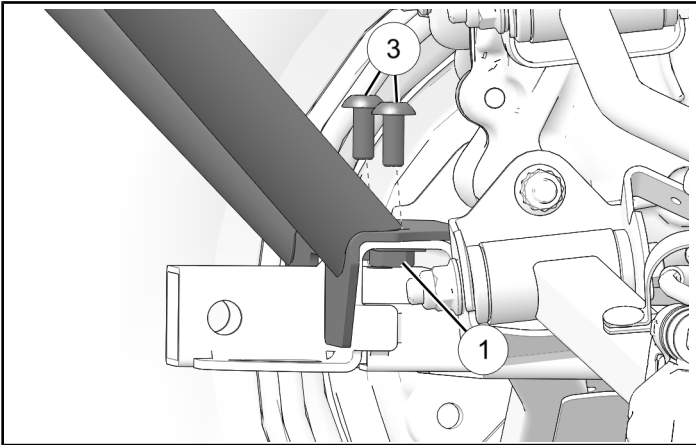

5. Put two weldments ① inside chassis tubes. Line up with middle rear rack extender mounting tabs.

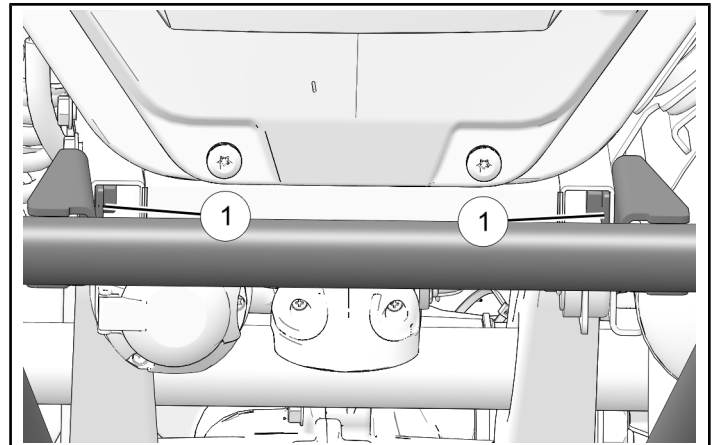
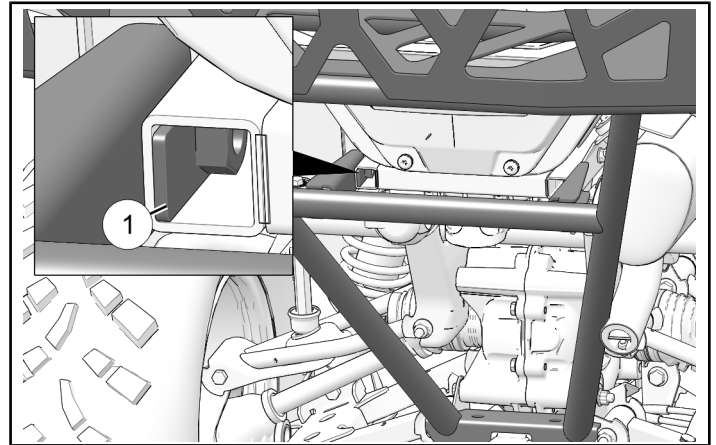

6. Loosely install two screws ③ in weldments ① to attach middle rack extender mounting tabs to frame. Torque four screws ③ to specification.

#### NOTICE

Left side shown, right side similar.

#### TORQUE

Screws ③:  
**17 ft-lbs (24 N·m)**

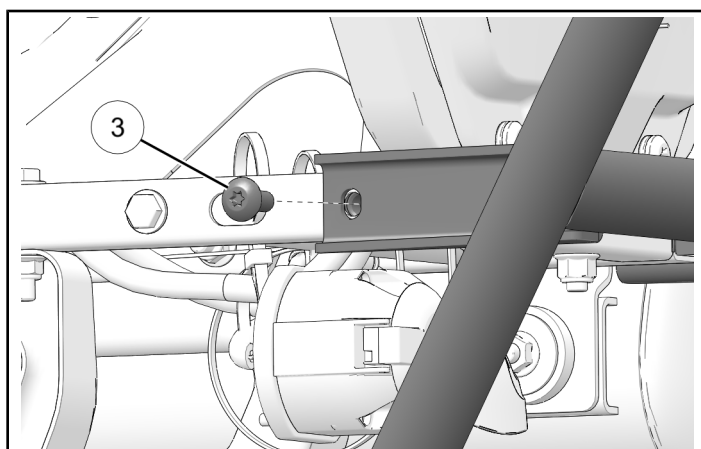
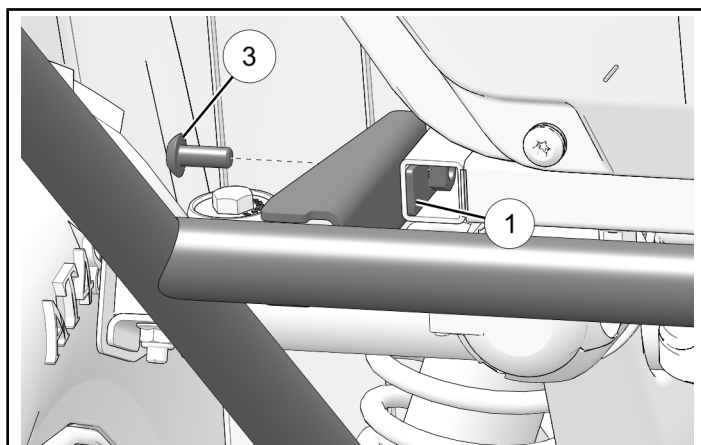

7. Torque two fasteners at top of rack to specification.

#### TORQUE

Rack Platform Screws:  
**35 in-lbs (4 N·m)**

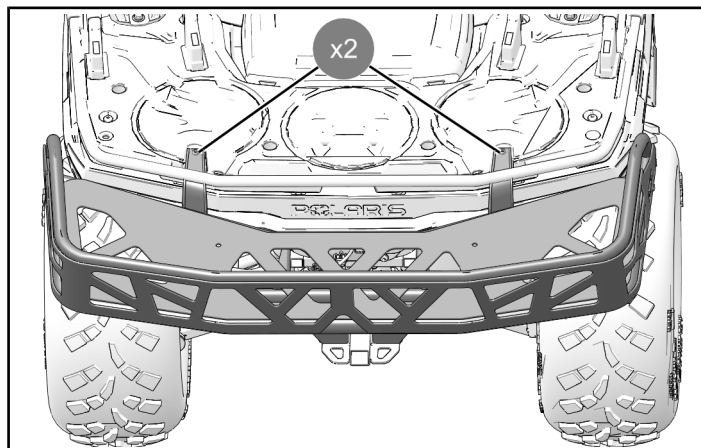

## INSTRUCTION FEEDBACK FORM

A feedback form has been created for the installer to provide any comments, questions or concerns about the installation instructions. The form is viewable on mobile devices by scanning the QR code or by clicking [HERE](#) if viewing on a PC.

