

TIP-OUT WINDSHIELD KIT



P/N 2889085

MISSING OR DAMAGED PARTS

Before beginning assembly, inspect the kit and its component(s) to be sure all parts and tools are accounted for and not damaged. If missing parts or parts are damaged, please contact your Selling Dealer for assistance.

If your accessory was purchased online, please contact POLARIS® customer service at **1-800-POLARIS** (US & Canada only).

APPLICATION

Verify accessory fitment at www.polaris.com.

REQUIRED SOLD SEPARATELY

Only parts for installation of the Tip-Out Windshield Kit are included. For complete installation, the following additional kit is required (sold separately):

- *Fixed Windshield Kit*, P/N 2889086

IMPORTANT

Fixed windshield kit must be installed prior to installation of this kit.

KIT CONTENTS

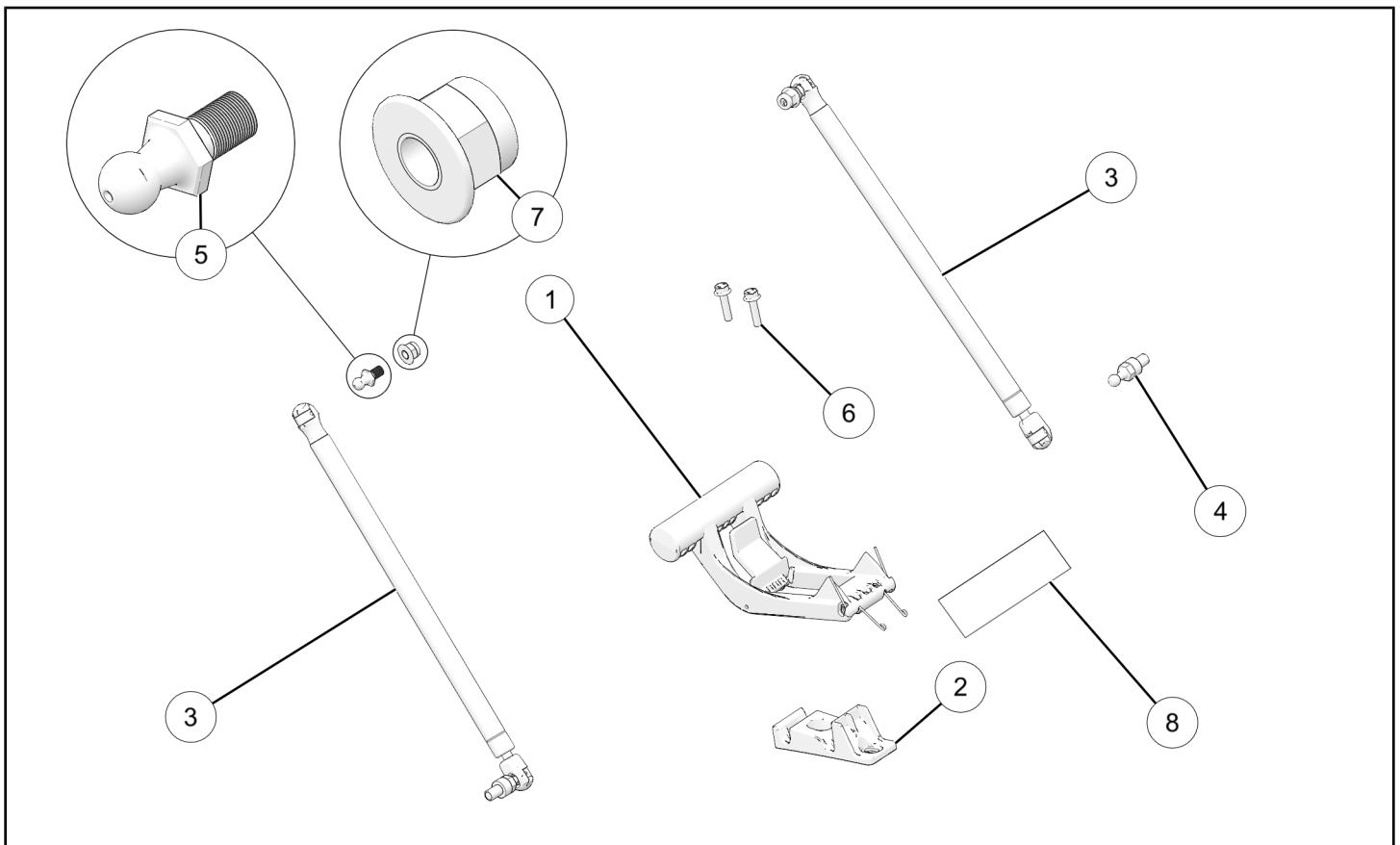

REF	QTY	PART DESCRIPTION	P/N AVAILABLE SEPARATELY	AVAILABLE SERVICE KIT
1	1	Assembly, Windshield Handle	2639001	2209737
2	1	Handle Receiver, Windshield	5465396	2209737
3	2	Gas Shock, Windshield	7045958	2211847
4	2	Ball End, Upper, M8 x 1.25 mm	7082887	2211847
5	2	Ball End, Lower, M8 x 1.25 mm	7082886	2211847
6	2	Screw, Hex Flange Head, M6 x 1.0 x 25 mm	7521331-25	n/a
7	2	Nut, Hex Flange, M8 x 1.25 mm	7548028	2209737
8	1	Decal, Warning	7301002	n/a

TOOLS REQUIRED

- Safety Glasses
- Drill
- Drill Bit:
 - 3/8 in (10 mm)
- Drill Bit, Step
 - 5/8 in (15.8 mm)
- Pliers, Push Pin Rivet
- Socket Set, Metric
- Torque Wrench

IMPORTANT

Your Tip-Out Windshield Kit is exclusively designed for your vehicle. Please read the installation instructions thoroughly before beginning. Installation is easier if the vehicle is clean and free of debris. For your safety, and to ensure a satisfactory installation, perform all installation steps correctly in the sequence shown.

INSTALLATION INSTRUCTIONS

VEHICLE PREPARATION

GENERAL

1. Park vehicle on a flat surface.
2. Shift vehicle into PARK.
3. Turn key to OFF position and remove key.

ACCESSORY INSTALLATION

1. Remove two screws from factory windshield mount.

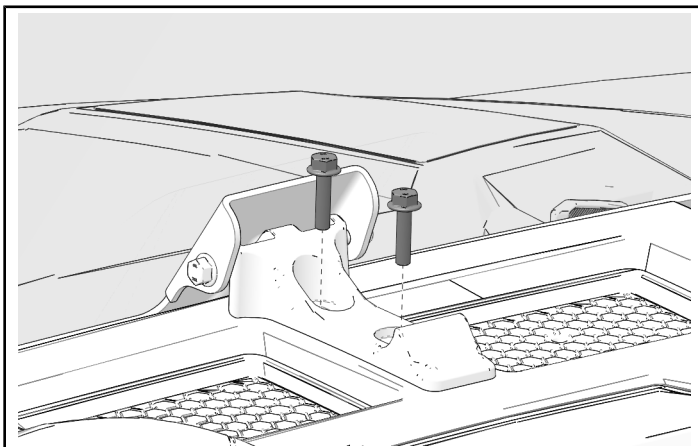

2. Remove and keep screw and nut from windshield (P/N 2889086) and remove windshield mount.

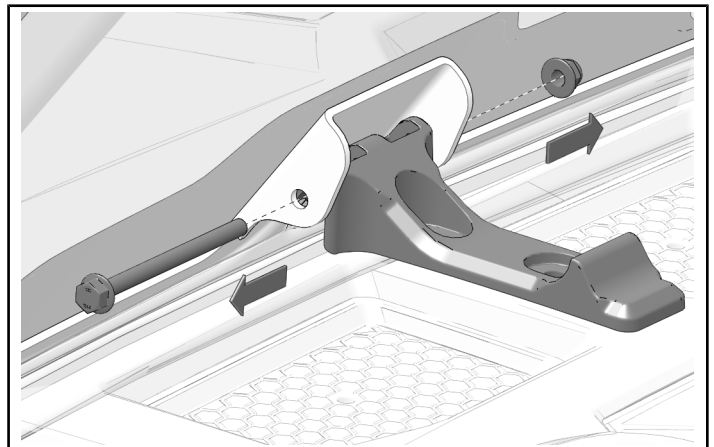

3. Install handle receiver ② using two screws ⑥.

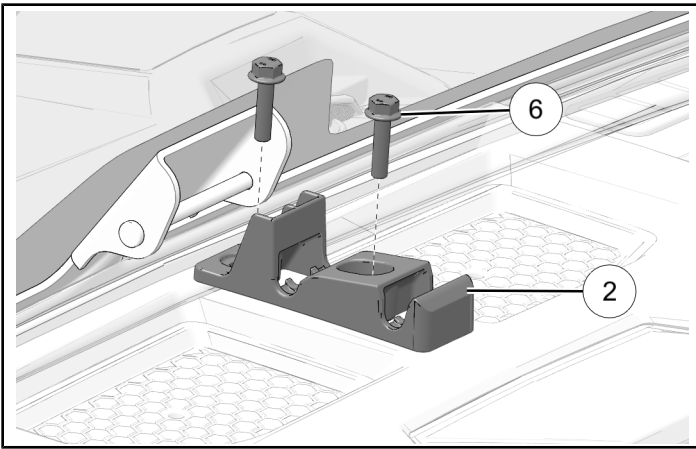

4. Install windshield handle assembly ① to windshield bracket with kept screw and nut.

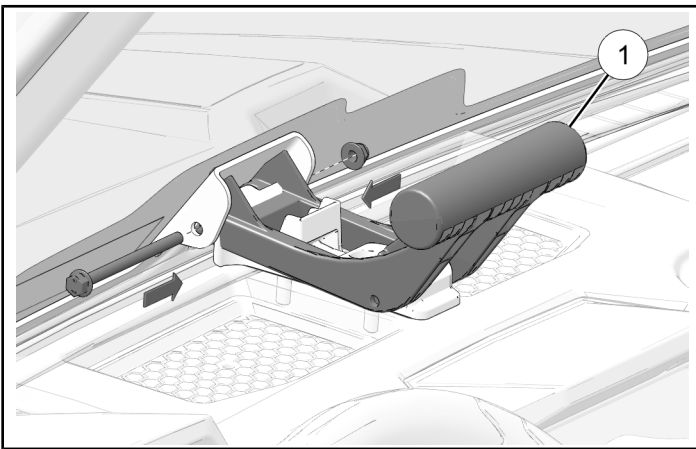

5. Torque nut to specification.

TORQUE
Nut:
48 in-lbs (5.5 N·m)

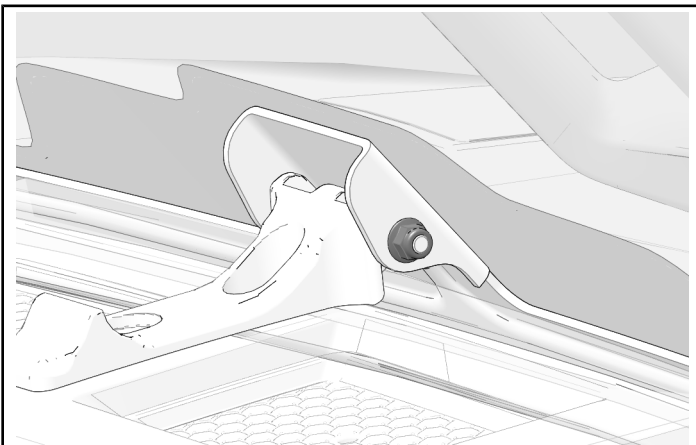

6. Remove and keep push-pin rivets from inner a-pillar panel.

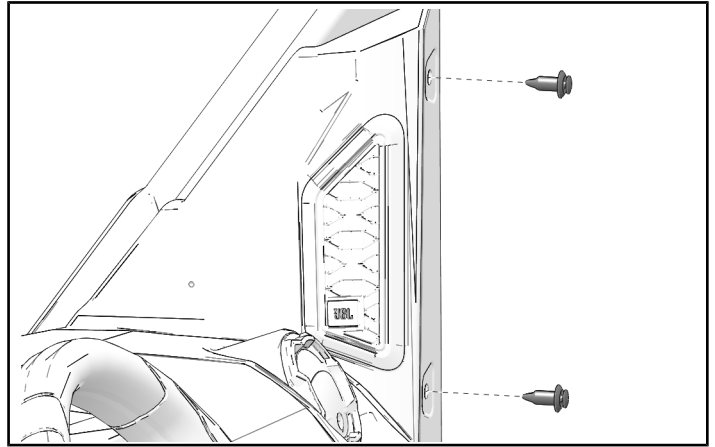

7. Open windshield to vented position.

8. Remove a-pillar panel by disengaging three tabs at bottom of panel.

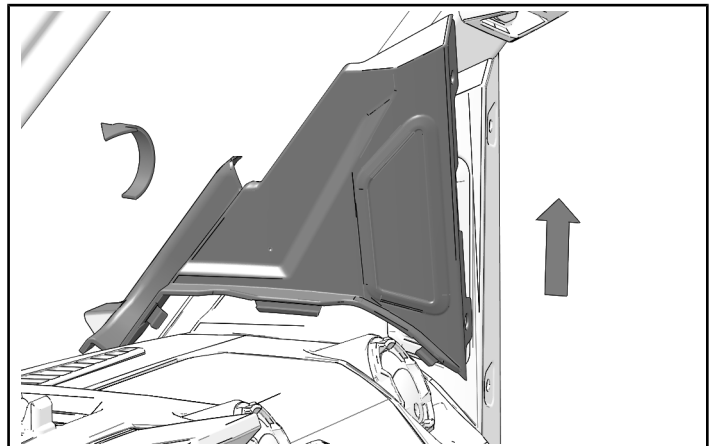

9. Locate and mark dimple in a-pillar panel.

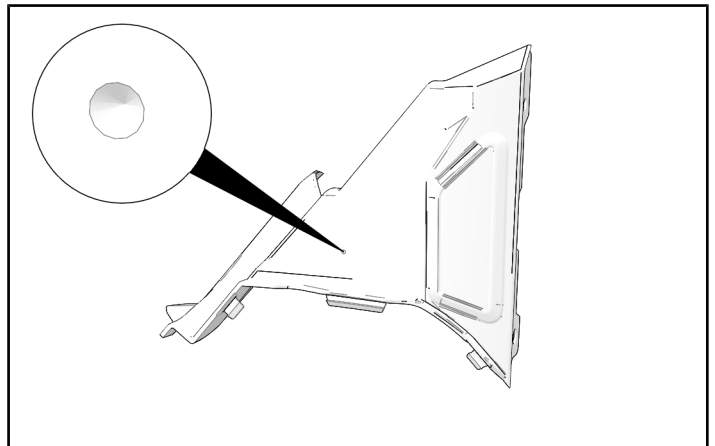

10. Drill hole in marked location.

MEASUREMENT

Step Bit 5/8 in (15.8 mm)

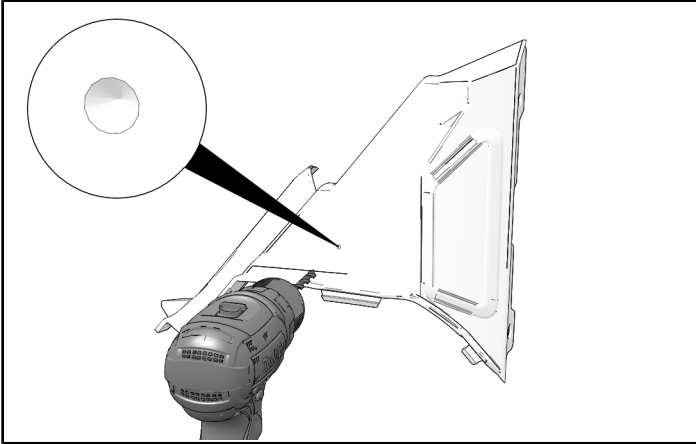

11. Install a-pillar panel by engaging three tabs at bottom of panel.

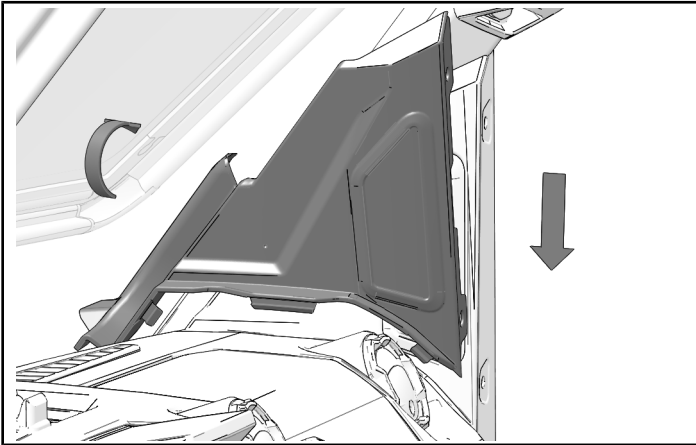

12. Install kept push-pin rivets in a-pillar panel.

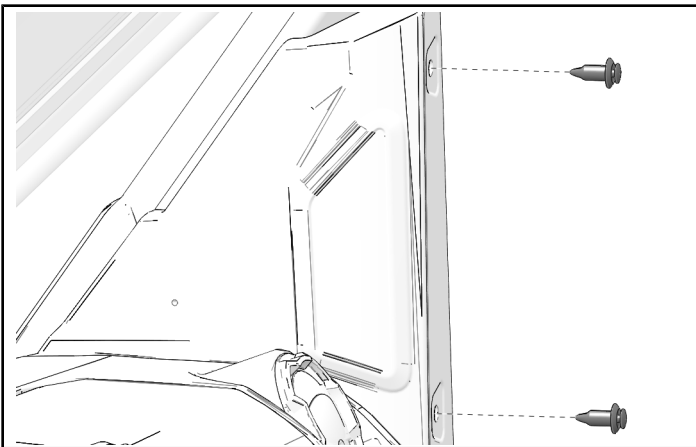

13. Loosely install upper ball end ④ to windshield bracket using nut ⑦.

NOTICE

Right side shown; left side similar.

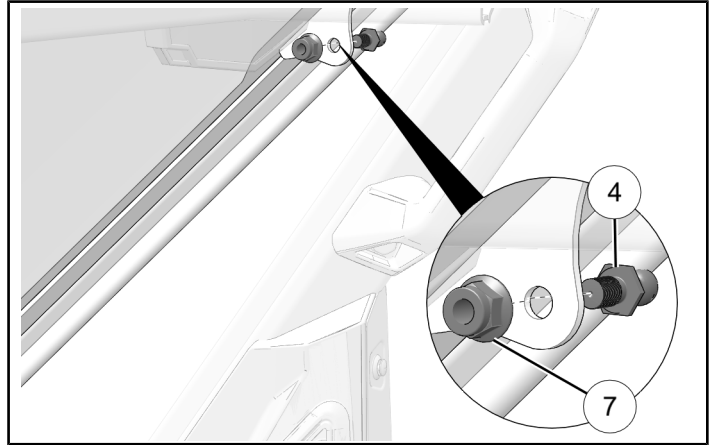

14. Loosely install lower ball end ⑤ to previously drilled hole in inner a-pillar panel.

NOTICE

Right side shown; left side similar.

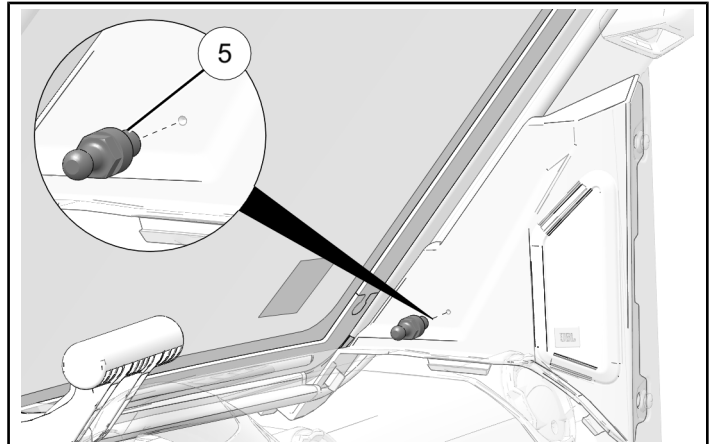

15. Torque upper ball end nut ④, and lower ball end ⑤ to specification.

TORQUE

Upper Ball End Nut ⑦:
48 in-lbs (5.5 N·m)

TORQUE

Lower Ball End ⑤:
18 ft-lbs (25 N·m)

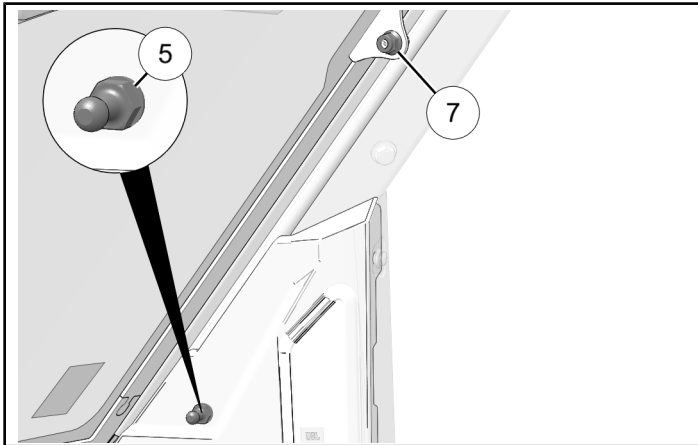

16. Install gas shock assembly ③ to ball ends.

NOTICE

Right side shown; left side similar.

NOTICE

Main shock body should be in the top position.

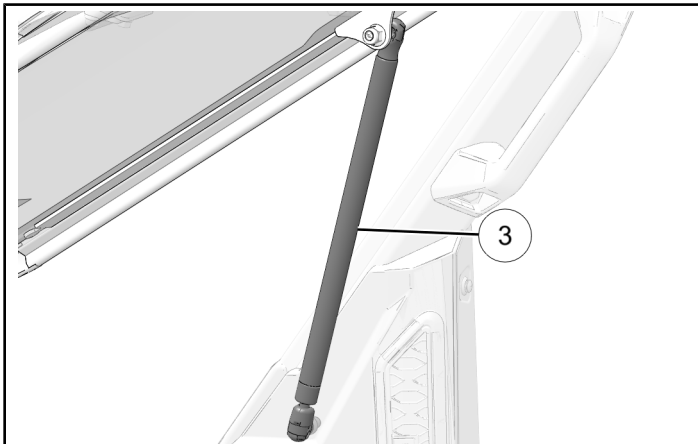

17. Return windshield to closed position.

18. Torque handle receiver screws ⑥ to specification.

TORQUE

Handle Receiver Screws ⑥:
30.9 in-lbs (3.5 N·m)

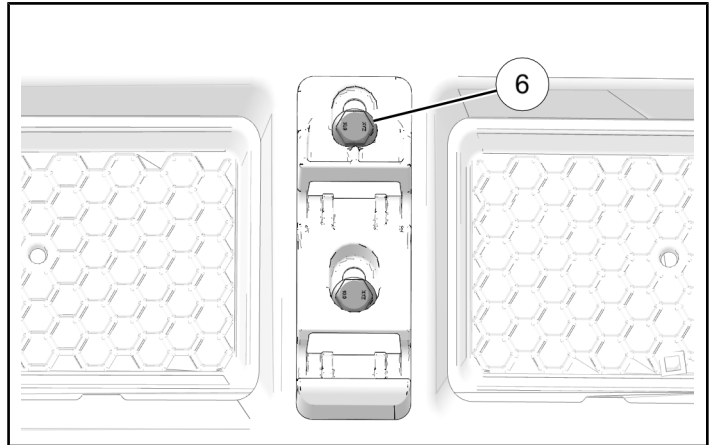

19. Install warning decal ⑧ to blackout area of inner windshield to the left of the handle.

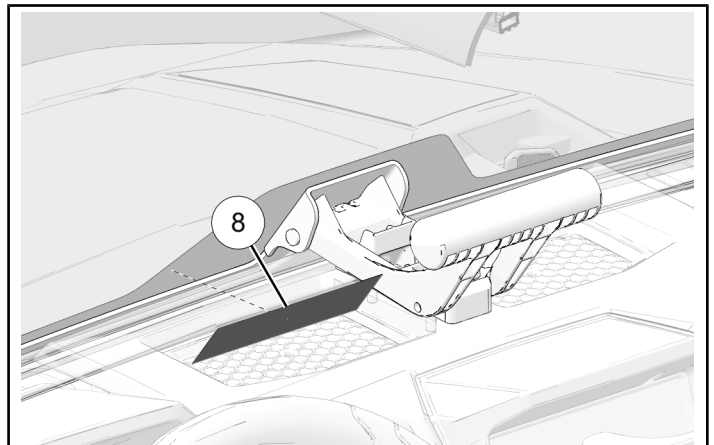

OPERATION

1. Windshield can be opened by pulling handle up and pushing forward.

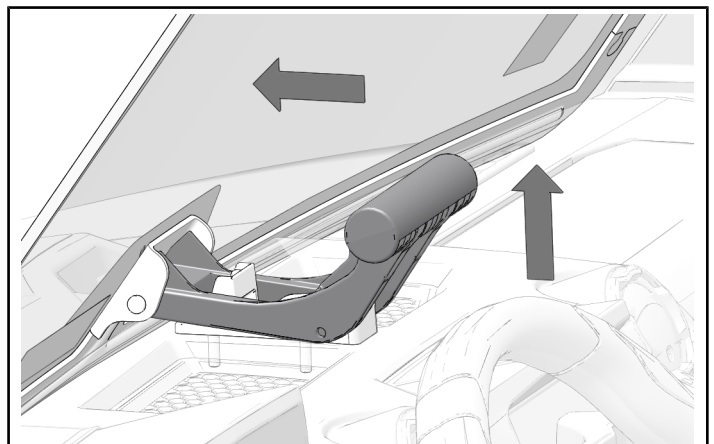

2. Push handle down into recession in handle receiver to lock in place.

