

TOOL MOUNT EXTENSION KIT



P/N 2889911

BEFORE YOU BEGIN

Read these instructions and check to be sure all parts and tools are accounted for. Please retain these installation instructions for future reference and parts ordering information.

APPLICATION

Verify accessory fitment at www.polaris.com.

REQUIRED SOLD SEPARATELY

Only parts for installation of the Tool Mount Extension Kit are included. Prior installation of the following additional kits are also required (sold separately):

- *Main Bed Rack*, P/N 2889847
- *Tool Holder Kit*, P/N 2889846

KIT CONTENTS

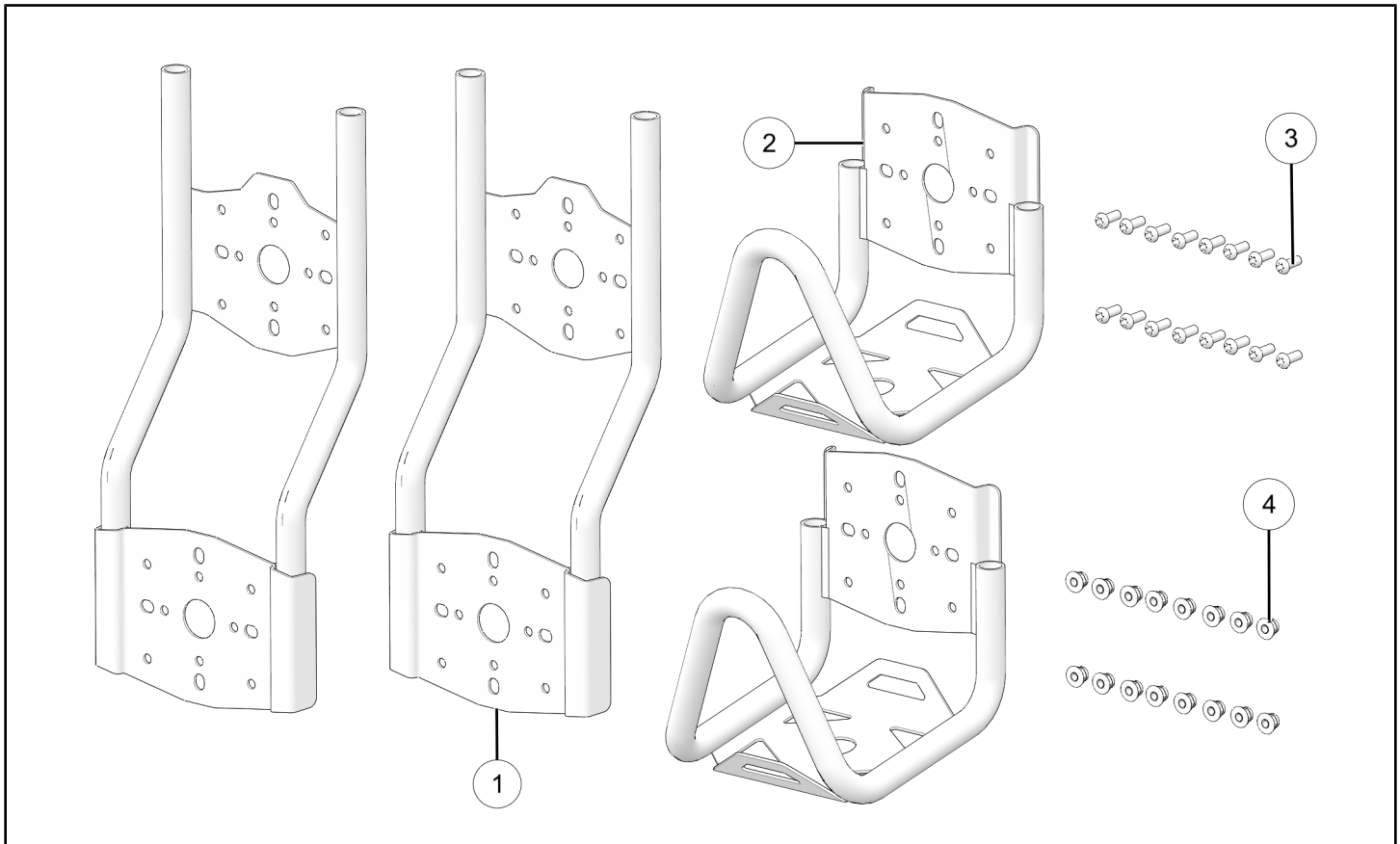

| REF | QTY | PART DESCRIPTION | P/N AVAILABLE SEPARATELY |
|-----|-----|------------------------------|--------------------------|
| 1 | 2 | Weld - Tool, Upper Extension | n/a |
| 2 | 2 | Weld - Tool, Lower Extension | n/a |

| REF | QTY | PART DESCRIPTION | P/N AVAILABLE SEPARATELY |
|-----|-----|--|--------------------------|
| 3 | 16 | Screw, Torx® Drive Button Head M6 x 1.0 mm | 7527947 |
| 4 | 16 | Nut, Hex Flange Head M6 x 1.0 mm | 7548027 |

TOOLS REQUIRED

- Safety Glasses
- Socket Set, Torx® Bit
- Wrench Set, Metric

IMPORTANT

Your Tool Mount Extension Kit is exclusively designed for your vehicle. Please read the installation instructions thoroughly before beginning. Installation is easier if the vehicle is clean and free of debris. For your safety, and to ensure a satisfactory installation, perform all installation steps correctly in the sequence shown.

INSTALLATION INSTRUCTIONS

VEHICLE PREPARATION

GENERAL

1. Park vehicle on a flat surface.
2. Shift vehicle into PARK.
3. Turn key to OFF position and remove key.

ACCESSORY INSTALLATION

NOTICE

One assembly shown; two assemblies included in kit.

1. Align upper extension ① with lower extension ② by lining up the holes.

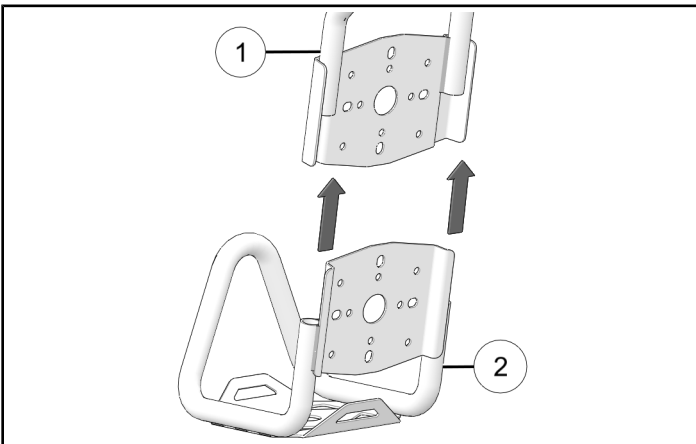

2. Attach upper extension ① to lower extension ② using screws ③ and nuts ④. Torque to specification.

TORQUE

Tool Holder Nuts ④:
106 in-lbs (12 N·m)

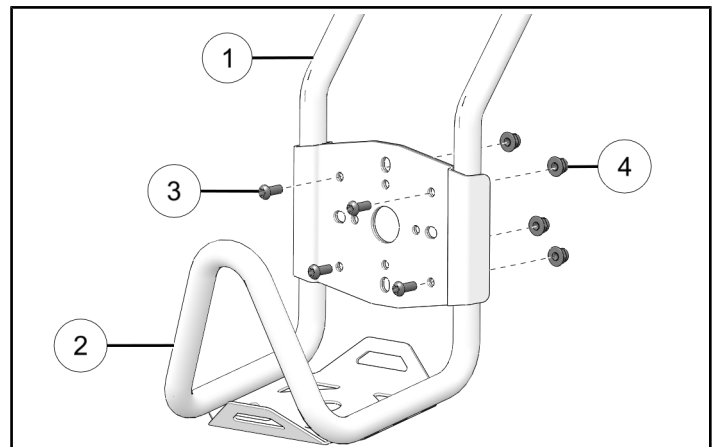

3. Align upper extension ① with tool holder by lining up the holes.

NOTICE

Tool Holder Kit p/n 2889846

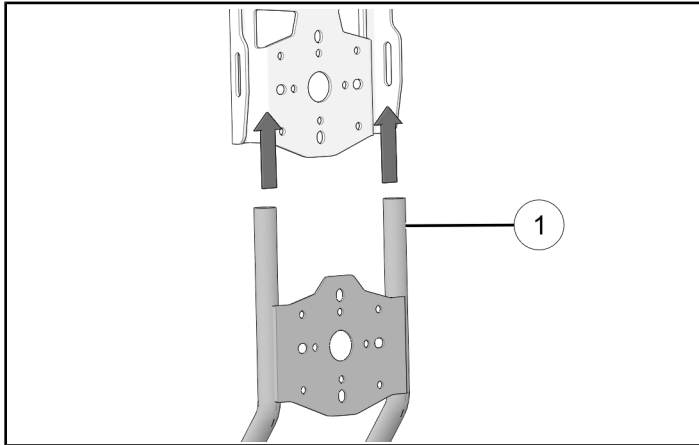

4. Attach upper extension ① to tool holder using screws ③ and nuts ④. Torque to specification.

TORQUE

Tool Holder Nuts ④:
106 in-lbs (12 N·m)

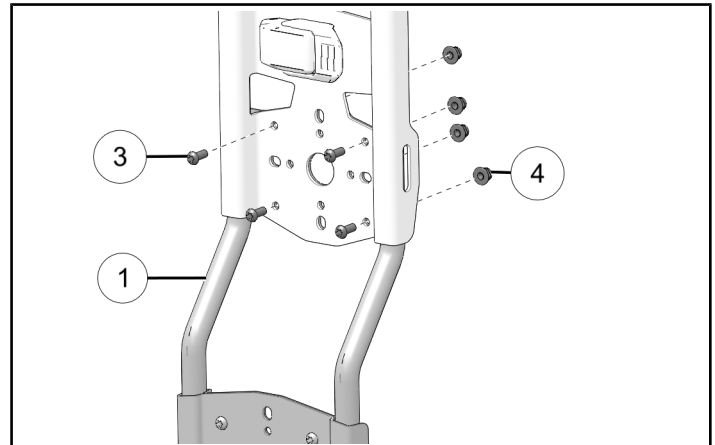

INSTRUCTION FEEDBACK FORM

A feedback form has been created for the installer to provide any comments, questions or concerns about the installation instructions. The form is viewable on mobile devices by scanning the QR Code® or by clicking [HERE](#) if viewing on a PC.

