

BED EXTENDER KIT



P/N 2889109

BEFORE YOU BEGIN

Read these instructions and check to be sure all parts and tools are accounted for. Please retain these installation instructions for future reference and parts ordering information.

APPLICATION

Verify accessory fitment at www.polaris.com.

KIT CONTENTS

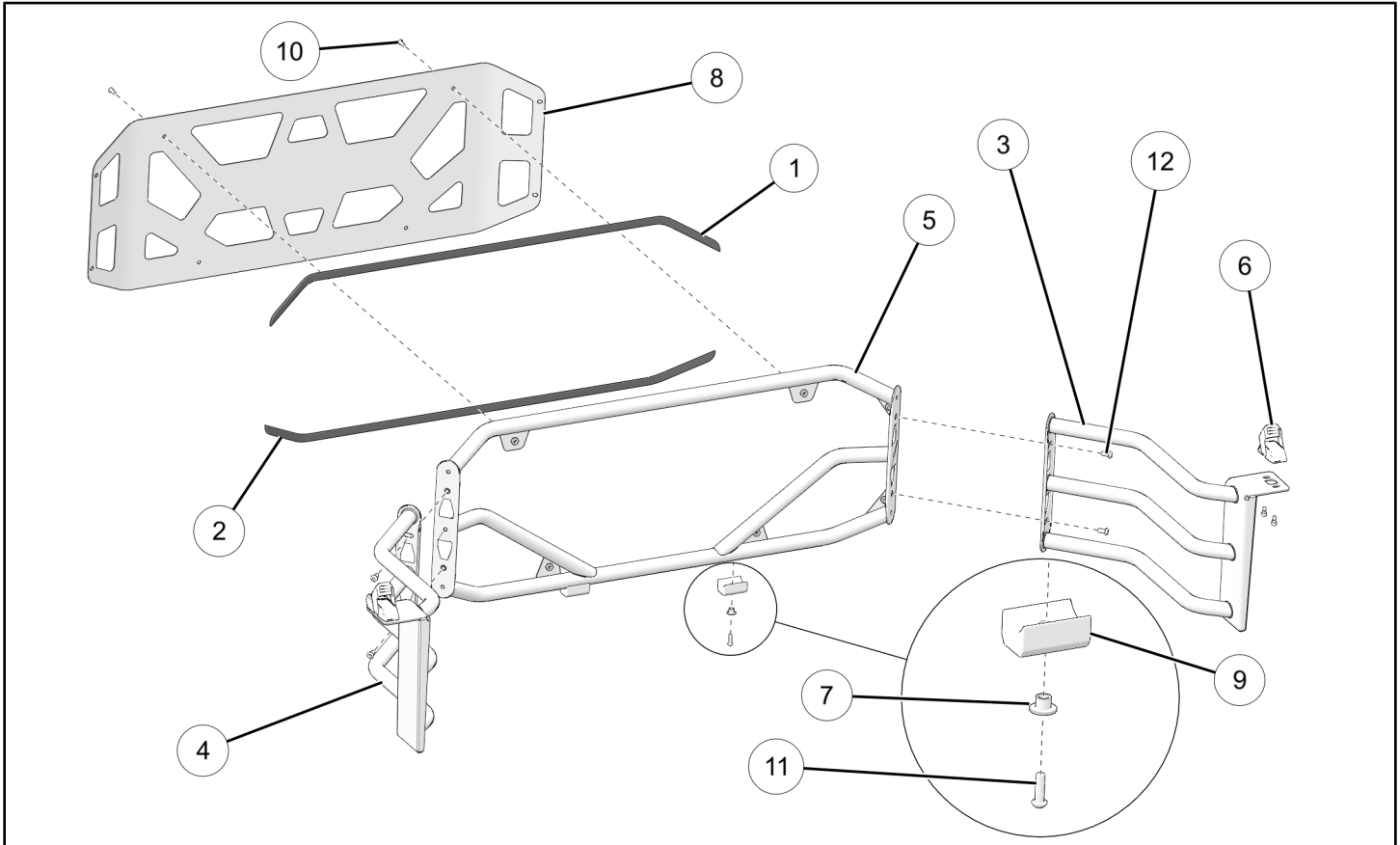

REF	QTY	PART DESCRIPTION	P/N AVAILABLE SEPARATELY	AVAILABLE SERVICE KIT
1	1	Foam – Upper	n/a	n/a
2	1	Foam – Lower	n/a	n/a
3	1	Bed Extender (Left)	1027871	n/a
4	1	Bed Extender (Right)	1027872	n/a
5	1	Bed Extender (Mid)	1027873	n/a
6	2	Lock & Ride MAX® Latching Assembly	2638786	n/a
7	2	Bumper Spacer	n/a	2209699
8	1	Bed Extender Plate	5273265	n/a

REF	QTY	PART DESCRIPTION	P/N AVAILABLE SEPARATELY	AVAILABLE SERVICE KIT
9	2	Bumper Block	n/a	2209699
10	8	Screw, Torx® Button Head M6 x 1.0 x 16 mm	7527947-16	2209699
11	2	Screw, Torx® Button Head M6 x 1.0 x 20 mm	7527947-20	2209699
12	4	Screw, Torx® Button Head M8 x 1.25 x 16 mm	7527948-16	2209699

TOOLS REQUIRED

- Safety Glasses
- Hex Key Set, Metric
- Socket Set, Hex Bit, Metric
- Socket Set, Torx® Bit
- Torque Wrench

IMPORTANT

Your Bed Extender Kit is exclusively designed for your vehicle. Please read the installation instructions thoroughly before beginning. Installation is easier if the vehicle is clean and free of debris. For your safety, and to ensure a satisfactory installation, perform all installation steps correctly in the sequence shown.

INSTALLATION INSTRUCTIONS

VEHICLE PREPARATION

GENERAL

1. Park vehicle on a flat surface.
2. Shift vehicle into PARK.
3. Turn key to OFF position and remove key.

ACCESSORY INSTALLATION

1. Remove adhesive backing from upper foam ①. Apply upper foam to inside top edge of plate ⑧.

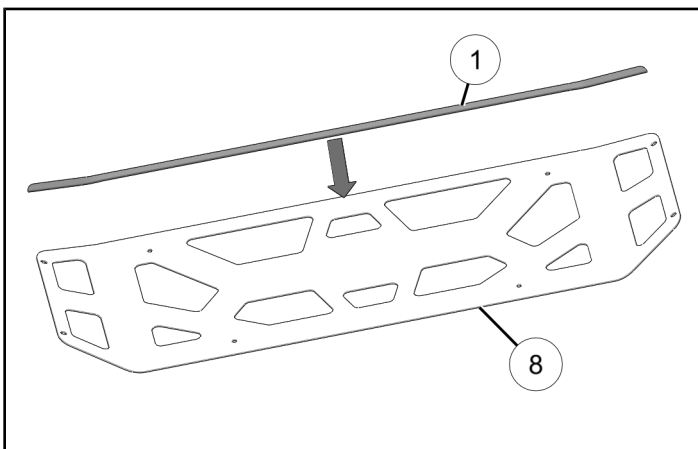

2. Remove adhesive backing from lower foam ②. Apply lower foam to inside bottom edge of plate ⑧.

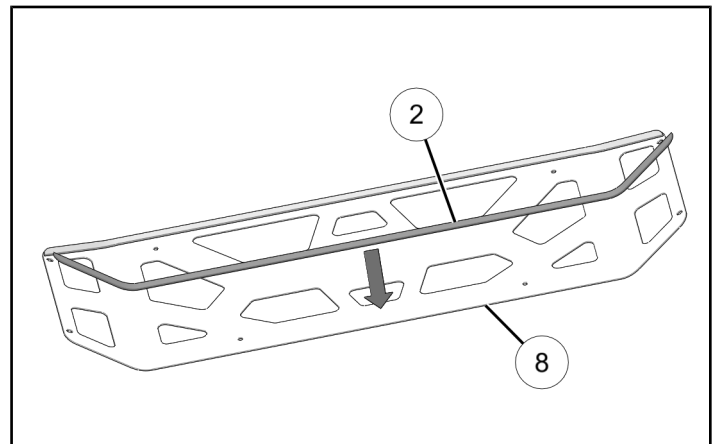

3. Install two bumper blocks (9), bumper spacers (7), and screws (11) on mid bed extender frame (5). Torque screws to specification.

TORQUE

Screws (11):
88 in-lbs (10 N·m)

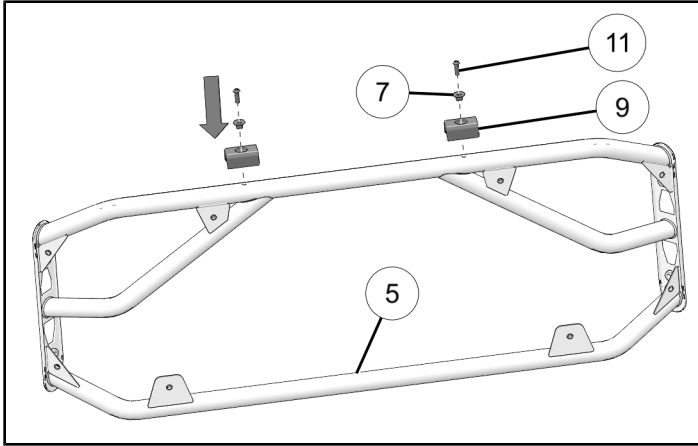

4. Attach plate (8) and eight screws (10) to mid bed extender frame (5). Torque screws to specification.

TORQUE

Screws (10):
88 in-lbs (10 N·m)

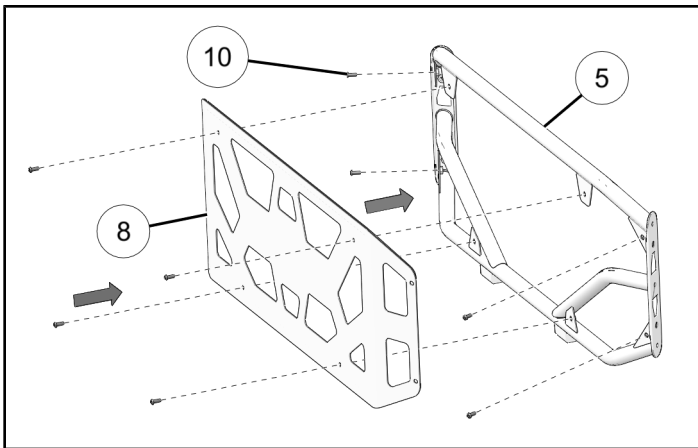

5. Remove and keep two screws from bottom of Lock & Ride MAX® latching assembly (6).

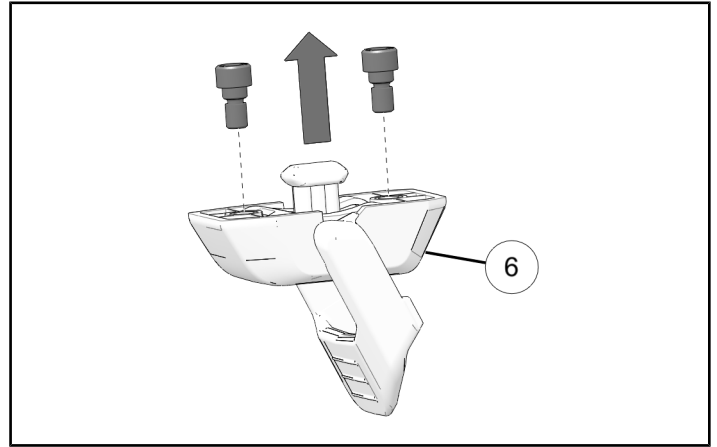

6. Assemble latching assembly to left bed extender frame (3). Torque screws to specification.

NOTICE

Check spring alignment and orientation while installing latching assembly.

TORQUE

Latching Assembly Screws:
44 in-lbs (5 N·m)

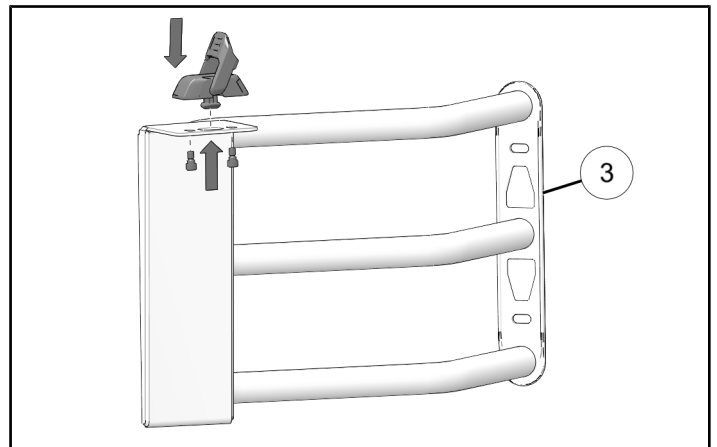

7. Repeat steps 5 and 6 for the right bed extender frame.

8. Assemble left bed extender frame ③ to mid bed extender frame ⑤. Use two screws ⑫.

DO NOT torque fasteners at this time.

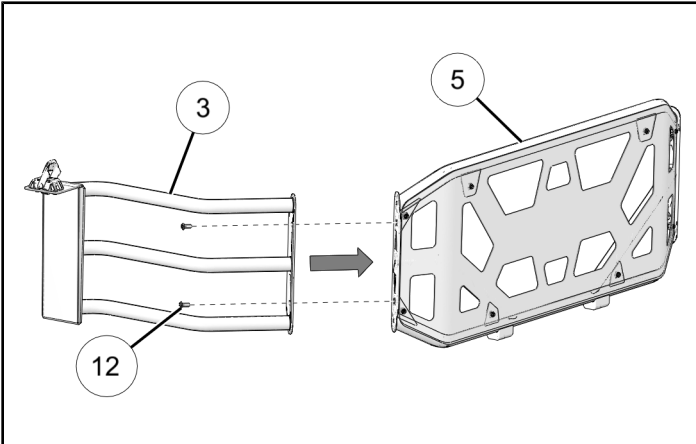

9. Repeat step 8 for right bed extender frame.
10. Install bed extender onto box rails. Make sure that bottoms of latching assemblies fit through port openings in rail.

NOTICE

Left side shown, right side similar.

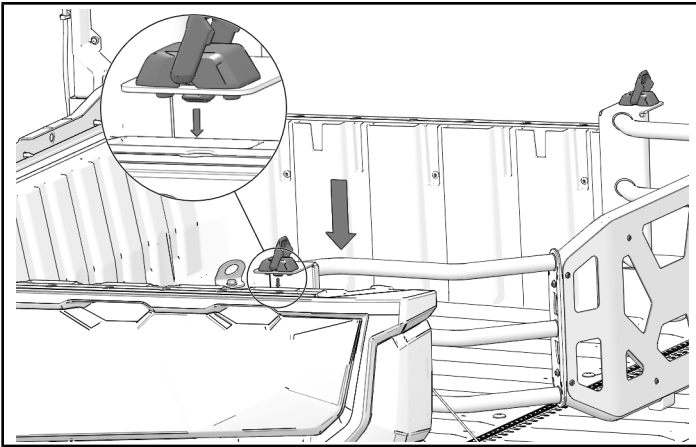

11. Adjust bed extender to desired position. Push down levers on latching assemblies to lock bed extender in place.

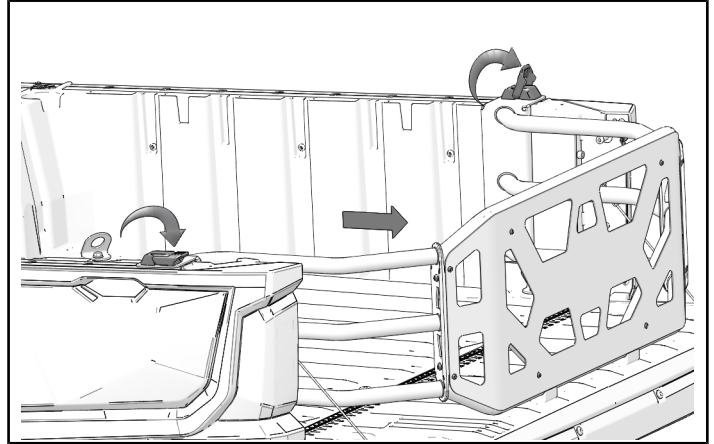

WARNING

Make sure that Lock and Ride MAX® anchors are outside of port openings before locking in place.

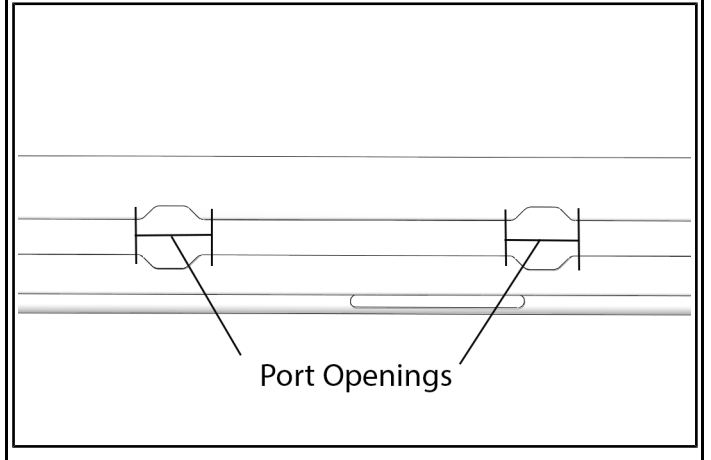

12. After bed extender is locked in place, torque screws ⑫ to specification.

TORQUE

Screws ⑫:
16 ft-lbs (22 N·m)