

SADDLEBAG KIT



P/N 2889857

BEFORE YOU BEGIN

Read these instructions and check to be sure all parts and tools are accounted for. Please retain these installation instructions for future reference and parts ordering information.

APPLICATION

Verify accessory fitment at www.indianmotorcycle.com.

KIT CONTENTS

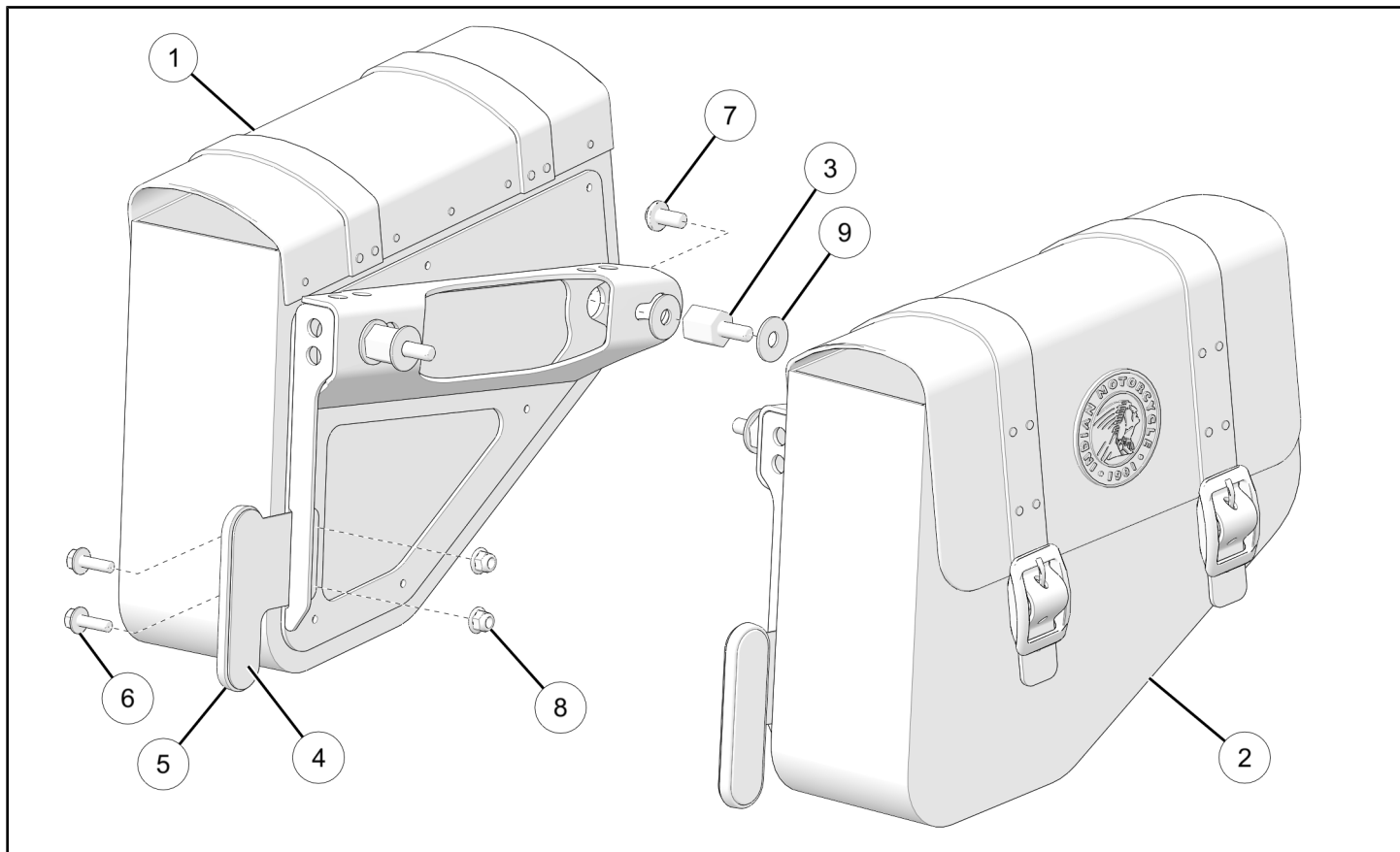

REF	QTY	PART DESCRIPTION	P/N AVAILABLE SEPARATELY
1	1	Assembly – Bag, Side, Bobber, Left-hand	2692651
2	1	Assembly – Bag, Side, Bobber, Right-hand	2692652
3	4	Spacer – 18 mm	5143482
4	2	Plate – Reflector, Mount	5273244
5	2	Reflector – Red, Oval	7180903
6	4	Screw – Hex, Flanged, M6 x 1.0 x 20 mm	7520122
7	4	Screw – Hex, Button Head, M8 x 1.25 x 16 mm	7520456

REF	QTY	PART DESCRIPTION	P/N AVAILABLE SEPARATELY
8	4	Nut – Hex, Flanged, M6 x 1.0 mm	7547453
9	8	Washer – 8.4 x 24 x 2.0 mm	7556045

TOOLS REQUIRED

- Safety Glasses
- Socket Set, Hex Bit, Metric
- Socket Set, Metric
- Torque Wrench

IMPORTANT

Your Indian Motorcycle® Saddlebag Kit is exclusively designed for your vehicle. Please read the installation instructions thoroughly before beginning. Installation is easier if the vehicle is clean and free of debris. For your safety, and to ensure a satisfactory installation, perform all installation steps correctly in the sequence shown.

INSTALLATION INSTRUCTIONS

VEHICLE PREPARATION

GENERAL

1. Park motorcycle on a flat surface, fully extend kickstand, and make sure vehicle is stable.
2. Turn key to OFF position and remove key.

ACCESSORY INSTALLATION

NOTICE

Right side shown, left side similar.

IMPORTANT

Motorcycle visibility requirements vary from location to location. Please review the requirements in your area prior to installing the supplied reflector on your saddlebags.

1. Remove existing screws and washers on fender.

NOTICE

If equipped with backrest, remove and keep backrest.

2. Install washers ⑨ and threaded spacers ③. Torque to specification.

TORQUE

Threaded Spacers ③:
18.5 ft-lbs (25 N·m)

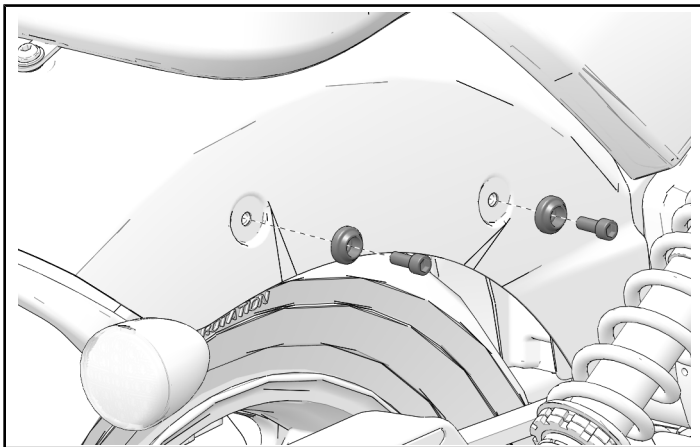
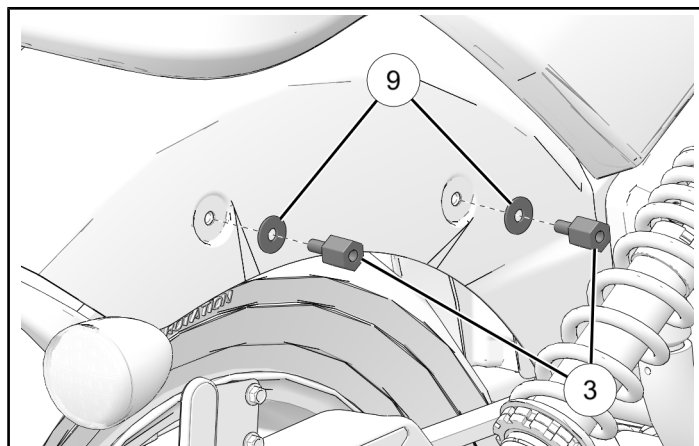

3. Loosely install washers ⑨ and mounting screws ⑦. Only install screws ⑦ part way.

IMPORTANT

If reinstalling backrest, do not install washers ⑨.

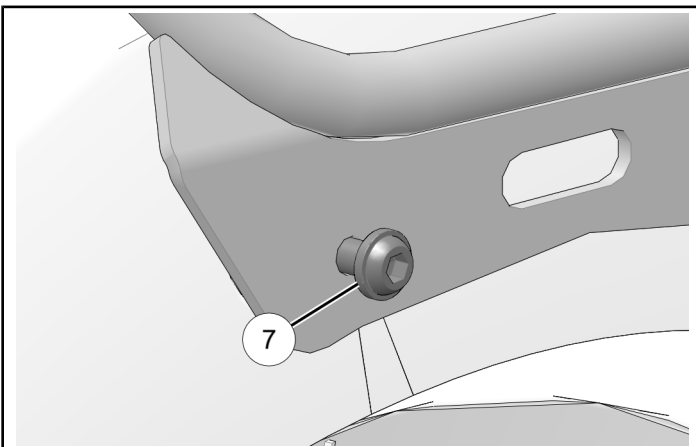
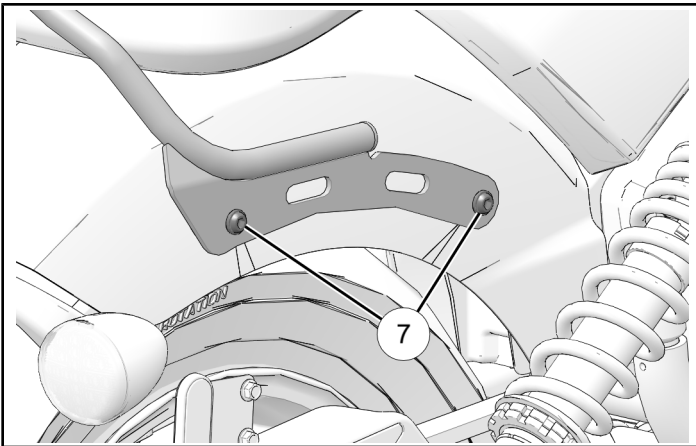
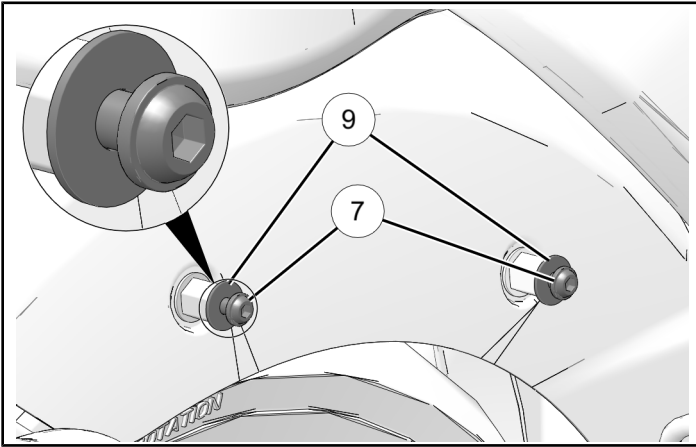

4. Install saddlebag mount ② on screws then slide mount forward.

NOTICE

Saddlebag is riveted to mount. Saddlebag not shown for clarity.

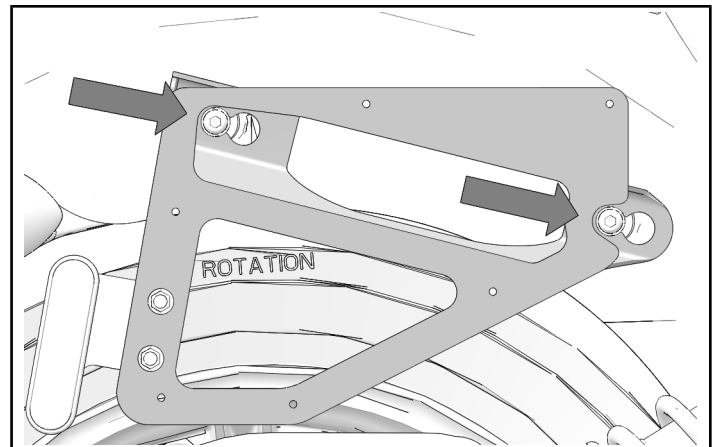
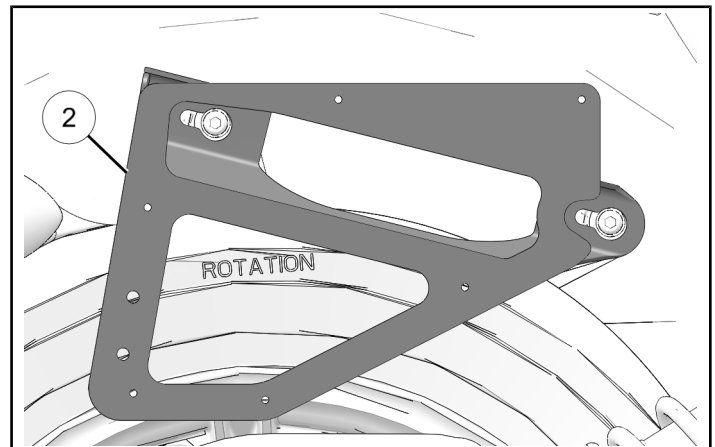

5. Torque screws to specification. Screws are accessible by reaching inside saddlebag.

IMPORTANT

Push on bag while torquing screws.

TORQUE

Saddlebag Mounting Screws ⑦:
13 ft-lbs (18 N·m)

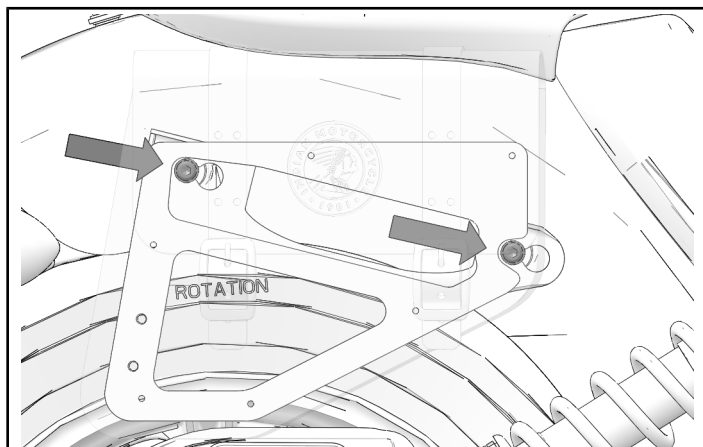

6. Install reflector bracket ⑤ using two screws ⑥ and two nuts ⑧. Reach inside saddlebag to access screws. Torque to specification.

NOTICE

Saddlebag not shown for clarity.

TORQUE

Reflector Bracket Nuts ⑧:
62 in-lbs (7 N·m)

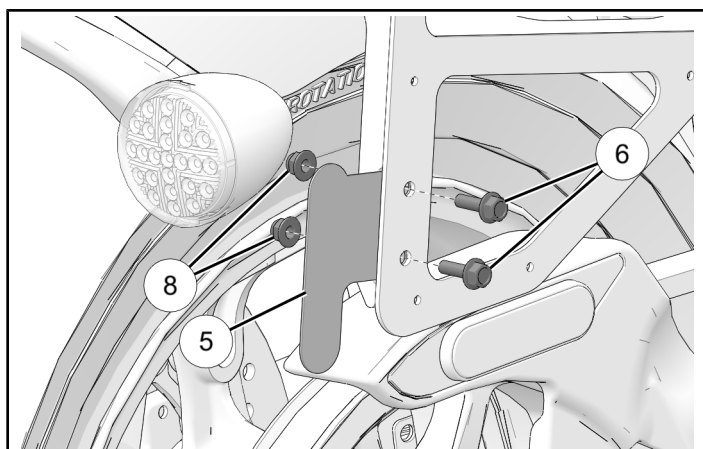

7. Remove backing from reflector ④ and install on reflector bracket ⑤.

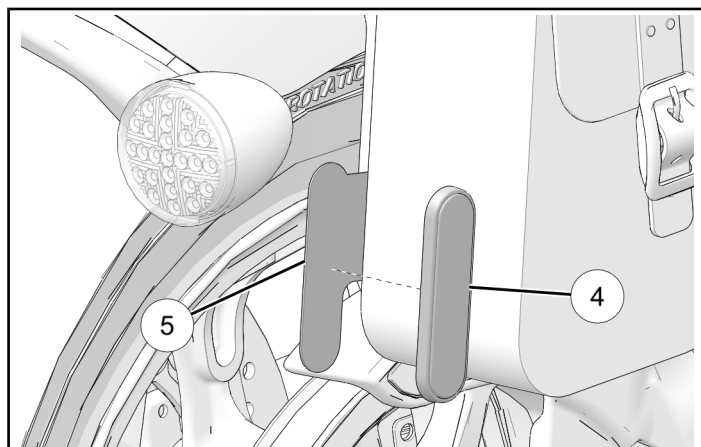

INSTRUCTION FEEDBACK FORM

A feedback form has been created for the installer to provide any comments, questions or concerns about the installation instructions. The form is viewable on mobile devices by scanning the QR Code® or by clicking [HERE](#) if viewing on a PC.

