

# TOOL HOLDER KIT



P/N 2889846

## BEFORE YOU BEGIN

Read these instructions and check to be sure all parts and tools are accounted for. Please retain these installation instructions for future reference and parts ordering information.

## APPLICATION

Verify accessory fitment at [www.polaris.com](http://www.polaris.com).

## REQUIRED SOLD SEPARATELY

Only parts for installation of the Tool Holder Kit are included. Prior installation of the following additional kits are also required (sold separately):

- *Main Bed Rack, P/N 2889847*

## KIT CONTENTS

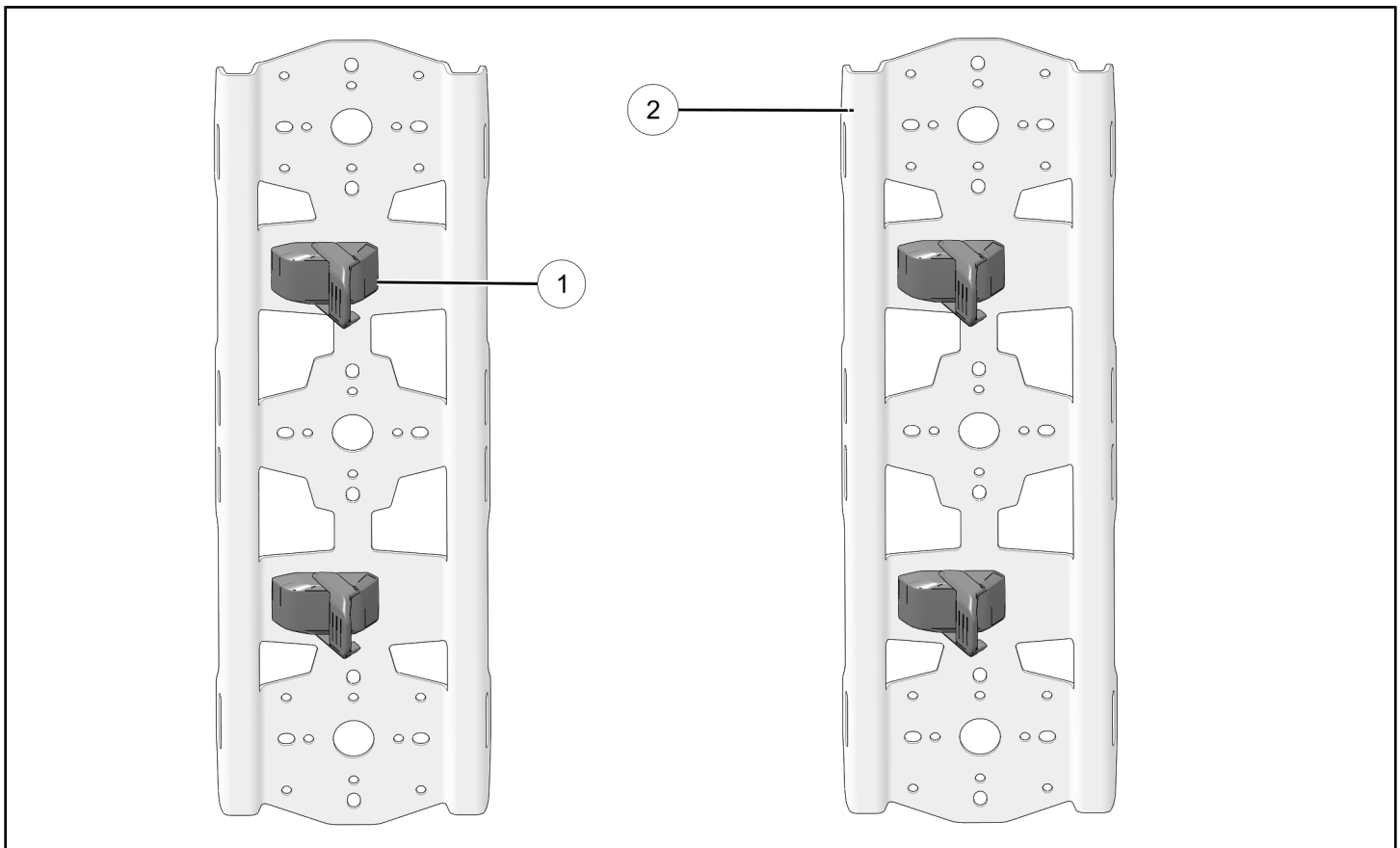

REF	QTY	PART DESCRIPTION	P/N AVAILABLE SEPARATELY
1	4	Lock & Ride MAX® Latching Assembly	n/a
2	2	Plate-Tool Mount Rack	n/a

## TOOLS REQUIRED

- Safety Glasses

# IMPORTANT

Your Tool Holder Kit is exclusively designed for your vehicle. Please read the installation instructions thoroughly before beginning. Installation is easier if the vehicle is clean and free of debris. For your safety, and to ensure a satisfactory installation, perform all installation steps correctly in the sequence shown.

## INSTALLATION INSTRUCTIONS

### VEHICLE PREPARATION

#### GENERAL

1. Park vehicle on a flat surface.
2. Shift vehicle into PARK.
3. Turn key to OFF position and remove key.

### ACCESSORY INSTALLATION

#### NOTICE

One assembly shown; two assemblies included.

1. Open Lock & Ride MAX® latching assembly ①.

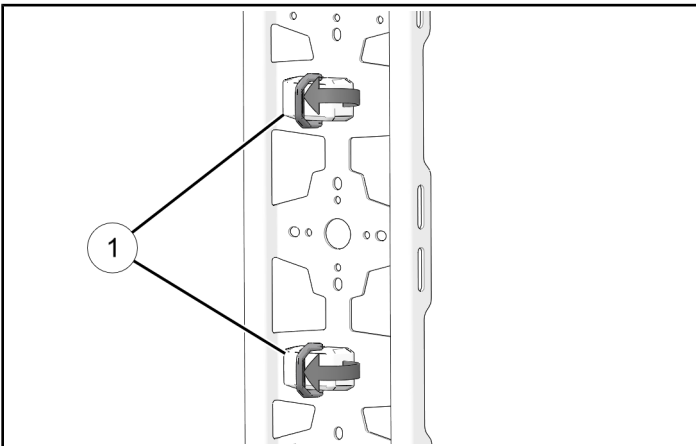

2. Install plate-tool mount rack ② onto main bed rack by aligning latching assembly ① with openings in box rail and install onto rail.

#### NOTICE

Main Bed Rack p/n 2889847.

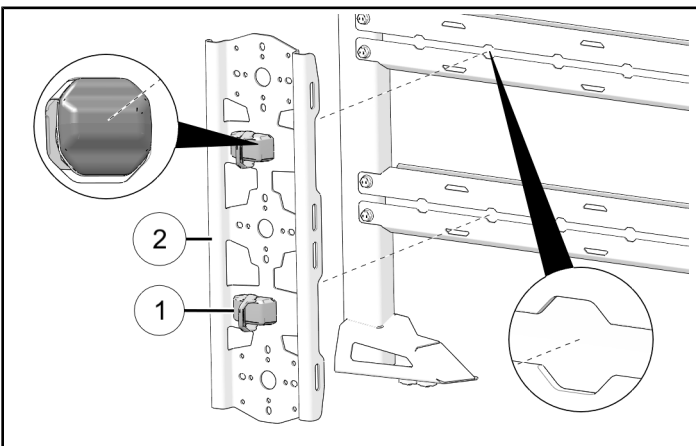

3. Close latching assembly ① to lock in place.

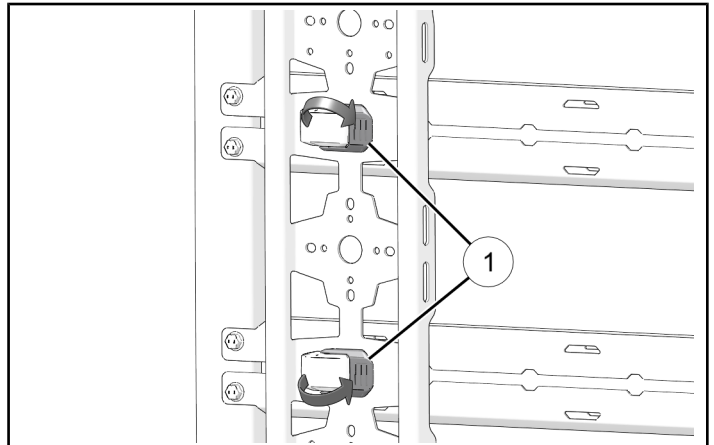

#### WARNING

Make sure that Lock and Ride MAX® anchors are outside of port openings before locking in place.

