

POLYCARBONATE WINDSHIELD KIT



P/N 2889089

MISSING OR DAMAGED PARTS

Before beginning assembly, inspect the kit and its component(s) to be sure all parts and tools are accounted for and not damaged. If missing parts or parts are damaged, please contact your Selling Dealer for assistance.

If your accessory was purchased online, please contact POLARIS® customer service at **1-800-POLARIS** (US & Canada only).

APPLICATION

Verify accessory fitment at www.polaris.com.

KIT CONTENTS

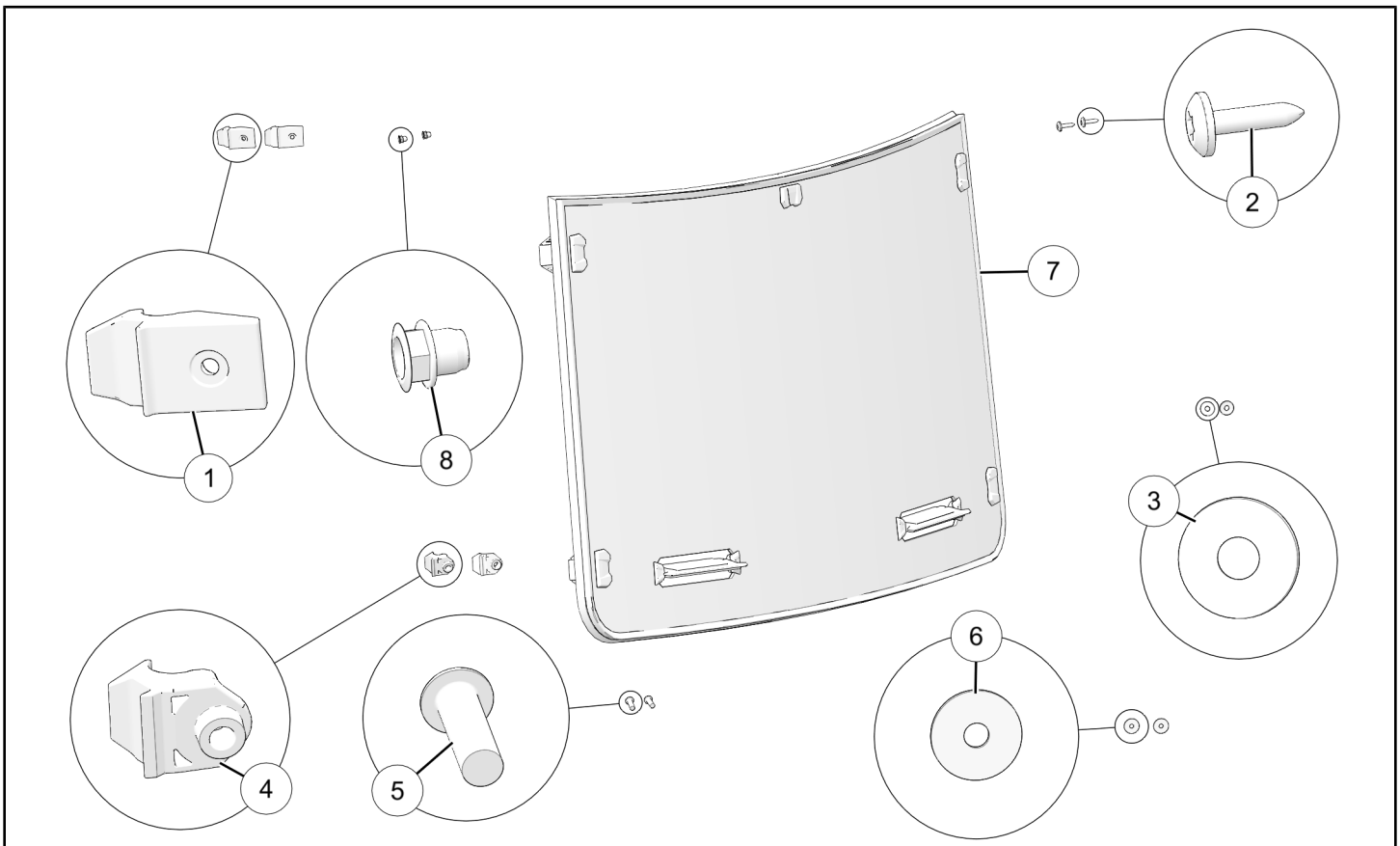

| REF | QTY | PART DESCRIPTION | P/N AVAILABLE SEPARATELY | AVAILABLE SERVICE KIT |
|-----|-----|-----------------------|--------------------------|-----------------------|
| 1 | 2 | Assembly, Base, Upper | n/a | 2209647 |
| 2 | 2 | Screw, Base, Upper | n/a | n/a |
| 3 | 2 | Washer, Base, Upper | n/a | n/a |
| 4 | 2 | Assembly, Base, Lower | 2638929 | 2209647 |
| 5 | 2 | Screw, Base, Lower | n/a | n/a |
| 6 | 2 | Washer, Base, Lower | n/a | n/a |

| REF | QTY | PART DESCRIPTION | P/N AVAILABLE SEPARATELY | AVAILABLE SERVICE KIT |
|-----|-----|----------------------|--------------------------|-----------------------|
| 7 | 1 | Assembly, Windshield | 2638931 | n/a |
| 8 | 2 | Rivnut | n/a | n/a |

TOOLS REQUIRED

- Safety Glasses
- Drill
- Drill Bit:
 - 5/8 in (15.8 mm)
- Drill Bit, Step
 - 5/8 in (15.8 mm)
- Socket Set, Metric
- Socket Set, Torx® Bit
- Torque Wrench

IMPORTANT

Your Polycarbonate Windshield Kit is exclusively designed for your vehicle. Please read the installation instructions thoroughly before beginning. Installation is easier if the vehicle is clean and free of debris. For your safety, and to ensure a satisfactory installation, perform all installation steps correctly in the sequence shown.

INSTALLATION INSTRUCTIONS

VEHICLE PREPARATION

GENERAL

1. Park vehicle on a flat surface.
2. Shift vehicle into PARK.
3. Turn key to OFF position and remove key.

ACCESSORY INSTALLATION

1. Install rivnut ⑧ to hex shaped hole in vehicle frame in upper area of cabin above hand grip.

NOTICE

Right side shown; left side similar.

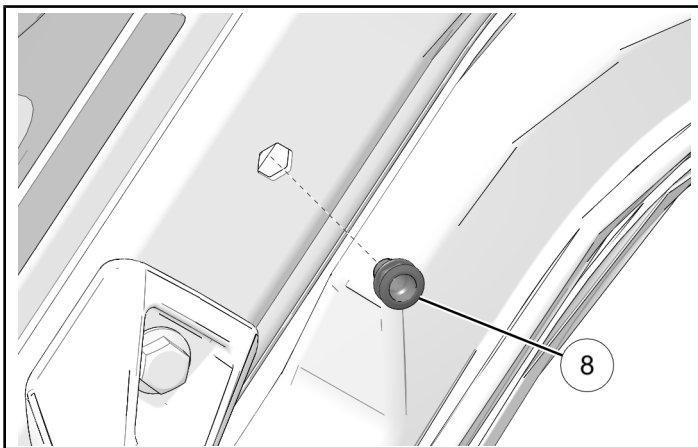

2. Install screw ② and washer ③ into rivnut.

NOTICE

Right side shown; left side similar.

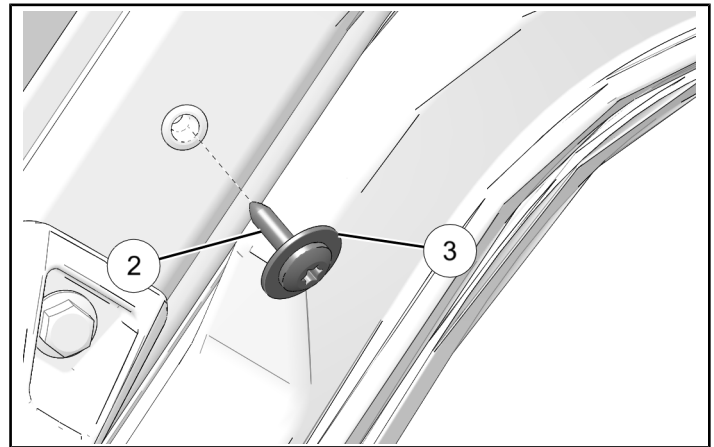

3. Torque screw ② to specification.

NOTICE

Right side shown; left side similar.

TORQUE

Screw ②:
6 ft-lbs (8 N·m)

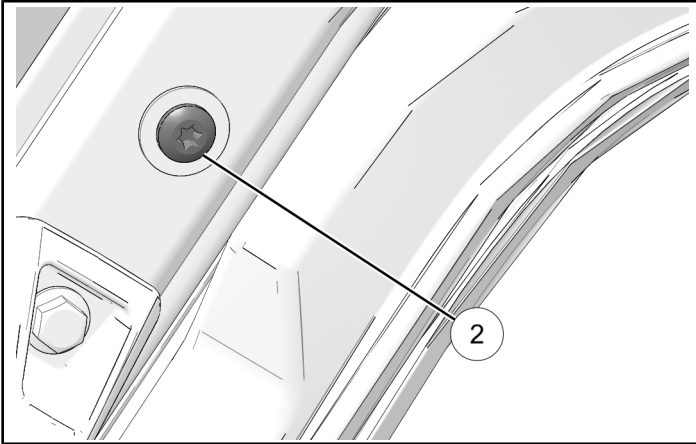

4. Remove and keep screw ② and washer ③ from rivnut.

5. Remove and keep two push darts from inner a-pillar panel.

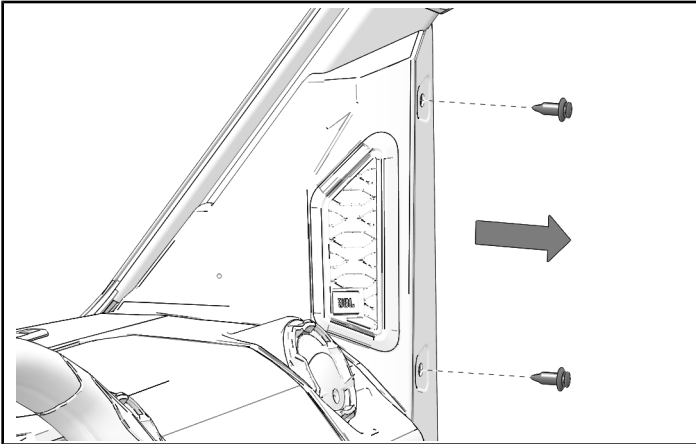

6. Remove a-pillar panel by disengaging three tabs.

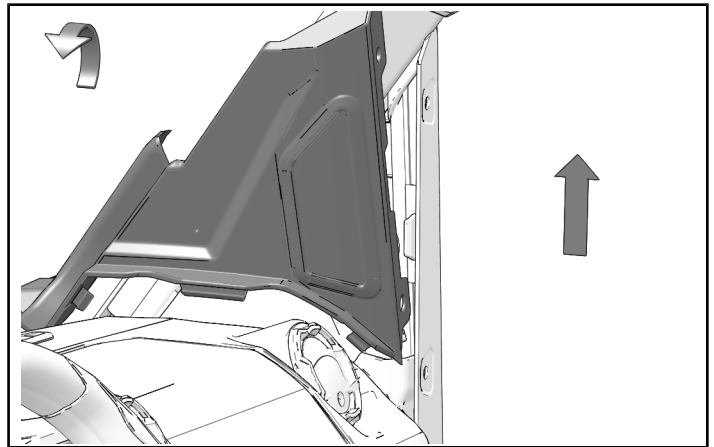

7. Find dimple on inner a-pillar panel.

NOTICE

Right side shown; left side similar.

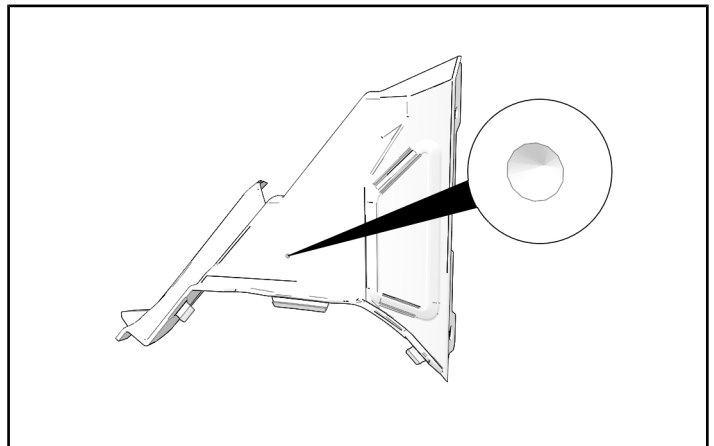

8. Drill hole at dimple.

MEASUREMENT

Drill Bit Size: 5/8 in (15.8 mm)

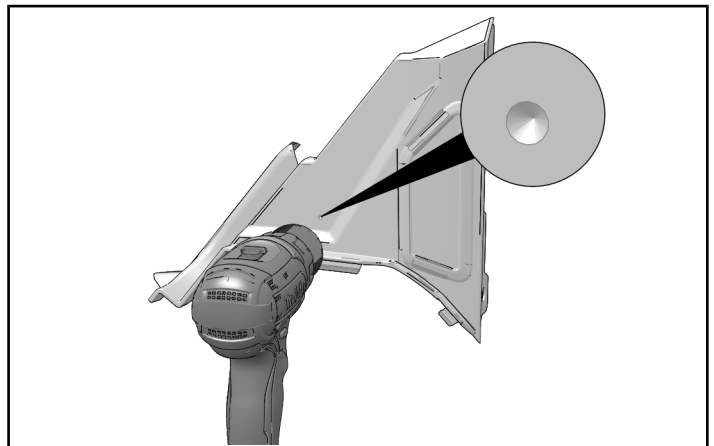

9. Install inner a-pillar panel by engaging three tabs.

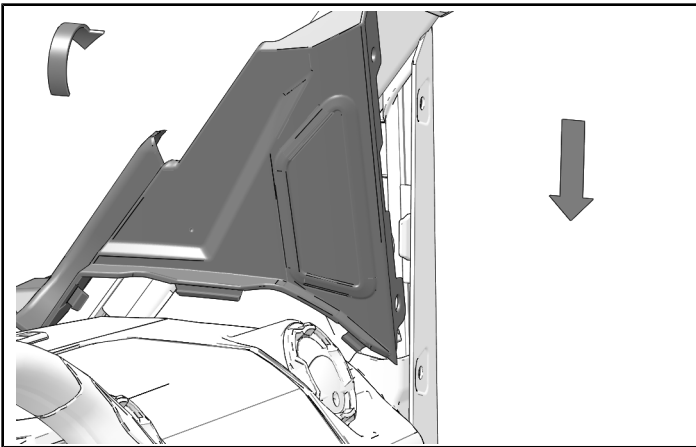

10. Install kept push darts to inner a-pillar panel.

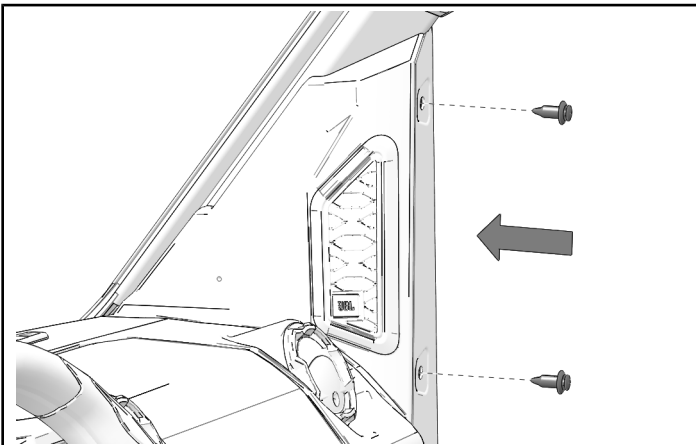

11. Loosely install upper clamp ① to a-pillar using screw ② and washer ③.

NOTICE

Right side shown; left side similar.

NOTICE

Clamps should be snug enough that they can still be adjusted.

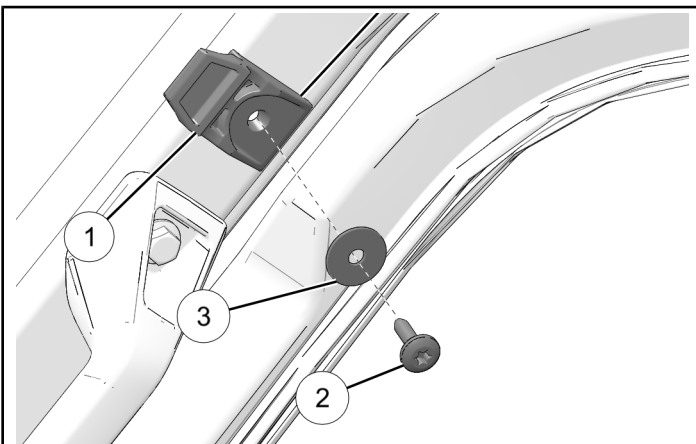

12. Loosely install lower clamp ④ to previously drilled holes in a-pillar panel using screw ⑤ and washer ⑥.

NOTICE

Right side shown; left side similar.

NOTICE

Clamps should be snug enough that they can still be adjusted.

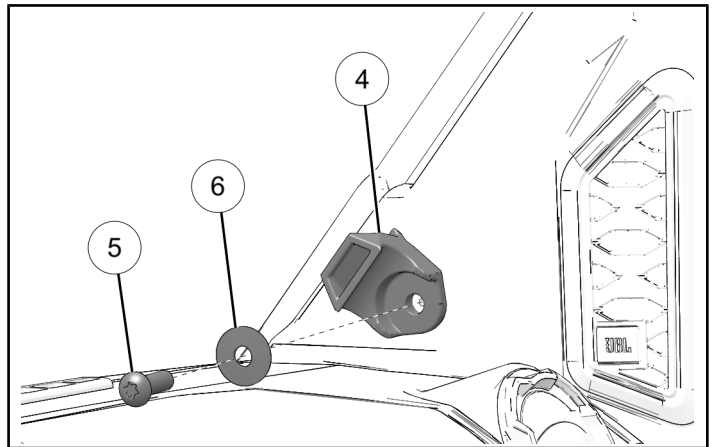

13. Test fit windshield to line up clamps.

14. Torque upper windshield clamp screws ② to specification.

NOTICE

Right side shown; left side similar.

TORQUE

Upper Windshield Clamp Screw ②:
4 ft-lbs (5.4 N·m)

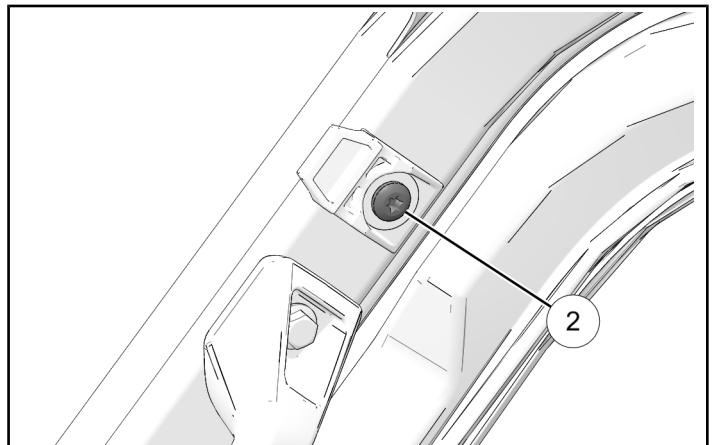

15. Torque lower windshield clamp screws ⑤ to specification.

NOTICE

Right side shown; left side similar.

TORQUE

Lower Windshield Clamp Screw⑤:
4 ft-lbs (5.4 N·m)

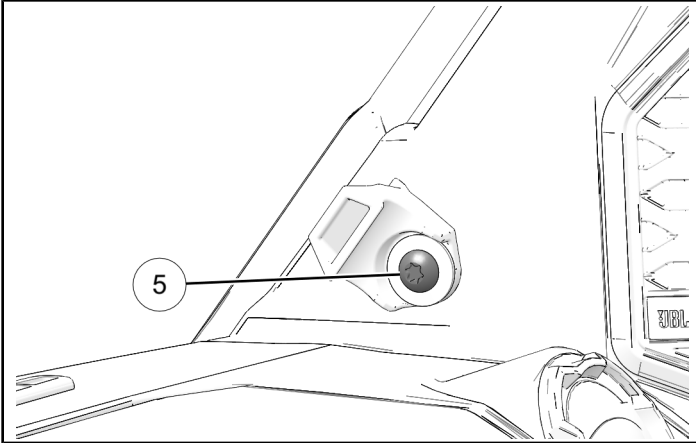

16. Put windshield ⑦ in place on vehicle.

NOTICE

Make sure clip engages with upper stamping.

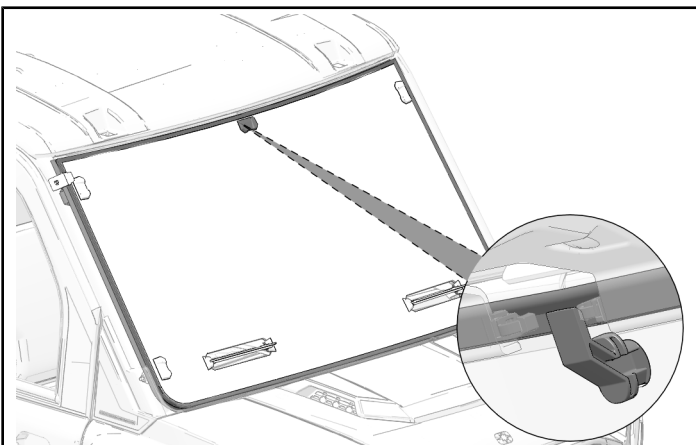
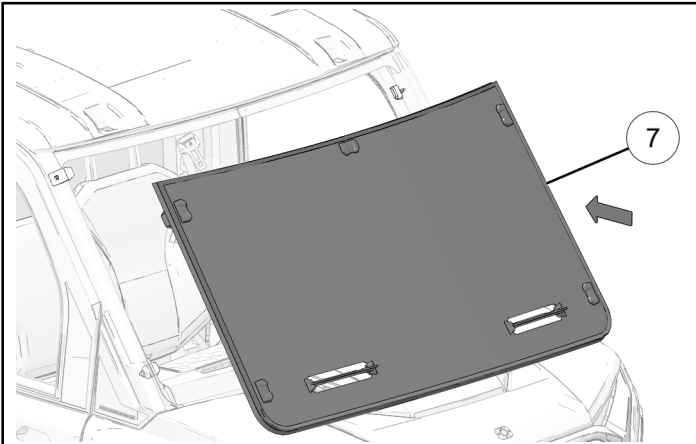

17. Attach windshield to vehicle using all four clamps.

NOTICE

Right side shown; left side similar.

