

# REAR WORK LIGHT KIT



P/N 2889672

## BEFORE YOU BEGIN

Read these instructions and check to be sure all parts and tools are accounted for. Please retain these installation instructions for future reference and parts ordering information.

## APPLICATION

Verify accessory fitment at [www.polaris.com](http://www.polaris.com).

## REQUIRED SOLD SEPARATELY

Only parts for installation of the Rear Work Light Kit are included. Prior installation of the following additional kits are also required (sold separately):

- *Light Bar Harness*, P/N 2883230
- *Light Bar Harness*, P/N 2889675 (*Requires Roof Switch Panel Kit*, P/N 2889674)
- *Crew Extension*, P/N 2883231; extension for 2889675:2890067

## KIT CONTENTS

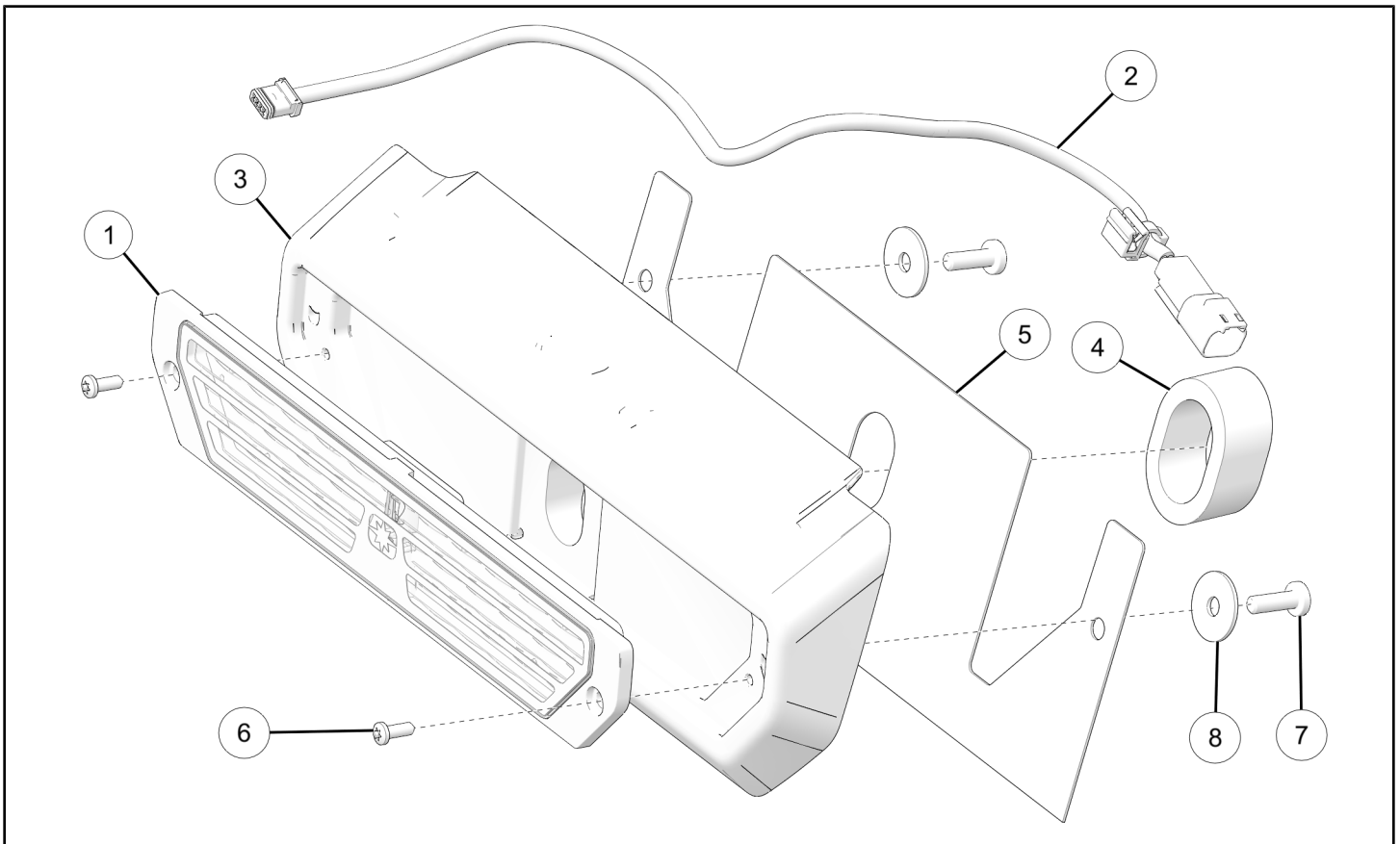

| REF | QTY | PART DESCRIPTION                        | P/N AVAILABLE SEPARATELY |
|-----|-----|---|--------------------------|
| 1   | 1   | Assembly – Worklight, Rear              | 2415906                  |
| 2   | 1   | Harness – Accessory, Worklight, Adapter | 2416563                  |

| REF | QTY | PART DESCRIPTION                  | P/N AVAILABLE SEPARATELY |
|-----|-----|-----------------------------------|--------------------------|
| 3   | 1   | Bezel – Worklight, Rear           | 5459170                  |
| 4   | 1   | Seal – Worklight, Rear            | 5526423                  |
| 5   | 1   | Decal – Template, Worklight, Rear | n/a                      |
| 6   | 2   | Screw – Torx®, #10 x .5 in        | 7519091                  |
| 7   | 2   | Screw – Torx®, #14 x .75 in       | 7519731                  |
| 8   | 2   | Washer – Rubber                   | 7556879                  |

## TOOLS REQUIRED

- Safety Glasses
- Drill
- Drill Bit:
  - 5/16 in (8 mm)
- Pliers, Push Pin Rivet
- Screwdriver Set, Torx®
- Utility Knife/Cutting Tool

## IMPORTANT

Your Rear Work Light Kit is exclusively designed for your vehicle. Please read the installation instructions thoroughly before beginning. Installation is easier if the vehicle is clean and free of debris. For your safety, and to ensure a satisfactory installation, perform all installation steps correctly in the sequence shown.

## INSTALLATION INSTRUCTIONS

### VEHICLE PREPARATION

#### GENERAL

1. Park vehicle on a flat surface.
2. Shift vehicle into PARK.
3. Turn key to OFF position and remove key.

### ACCESSORY INSTALLATION

#### NOTICE

If vehicle is equipped with roof liner, remove roof liner before beginning installation.

1. Put template ⑤ in position on rear of roof. Make sure template is centered on roof.

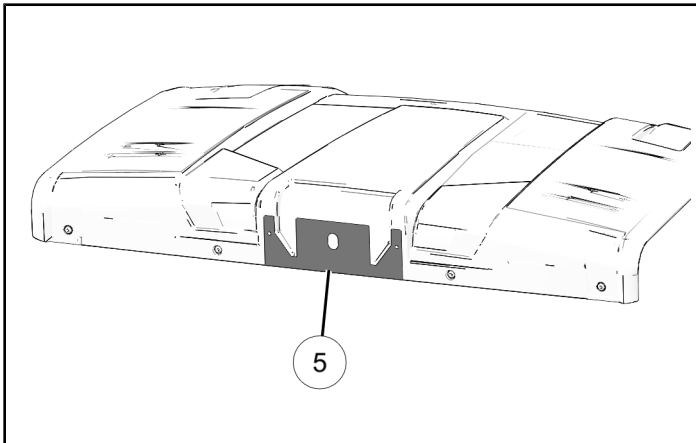

2. Mark drill positions and cutout position. Make sure drill positions are marked in the center of the hole.

#### TIP

A scribe tool or knife is recommended to mark the cutout and drill positions in case the template becomes damaged during installation.

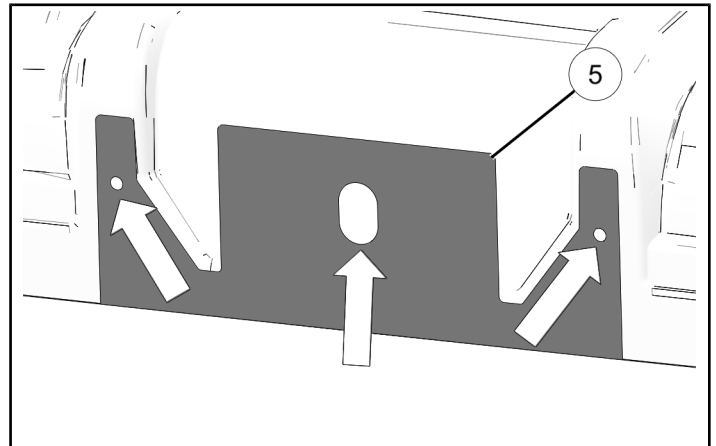

3. Drill two holes.

**NOTICE**

Control drill depth to 1/4 (6mm)

**MEASUREMENT**

Drill Bit Size: 5/16 (8mm)

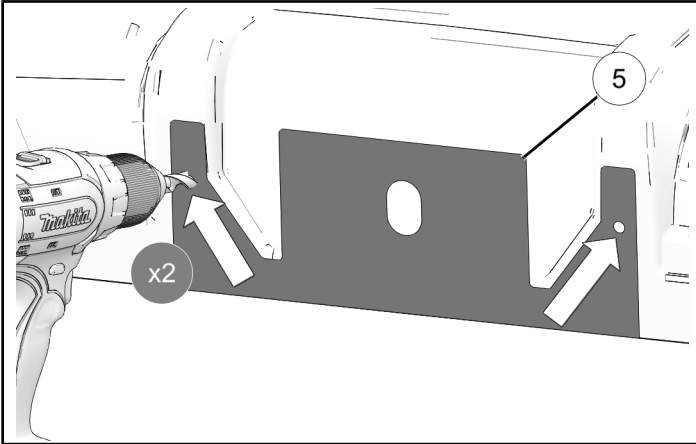

4. Cut middle opening using a utility knife or similar. Remove template when complete.

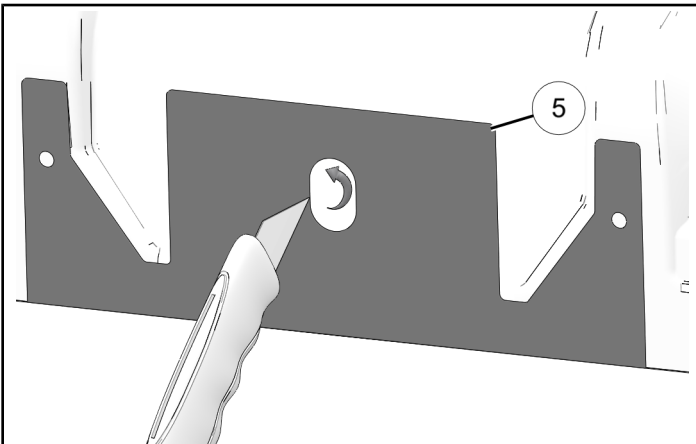

5. Install seal (4) on light bezel (3).

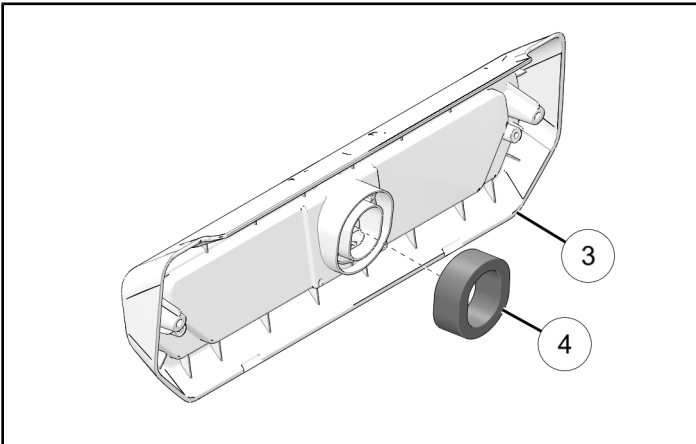

6. Install bezel (3) on roof, align with drilled holes and cutout. Attach to roof using two screws (7) and two washers (8). Torque screws until fully seated.

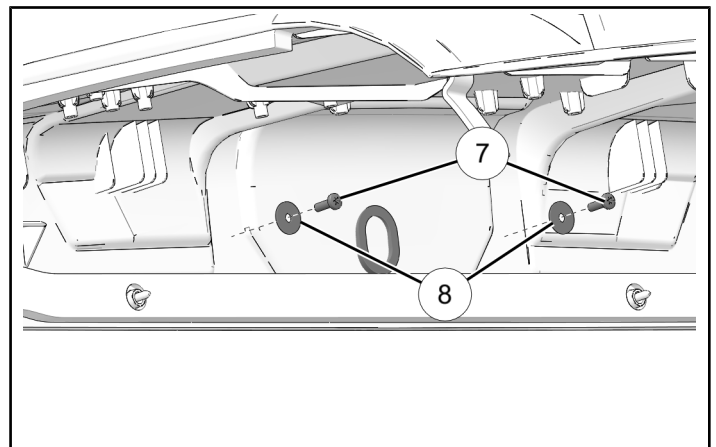
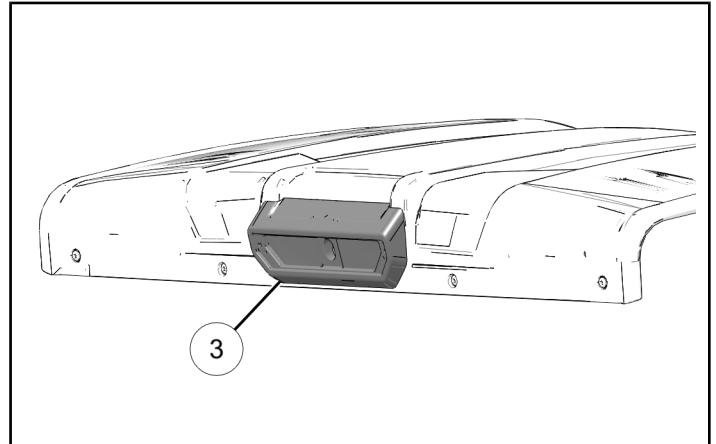

7. Plug wire harness (2) into worklight (1).

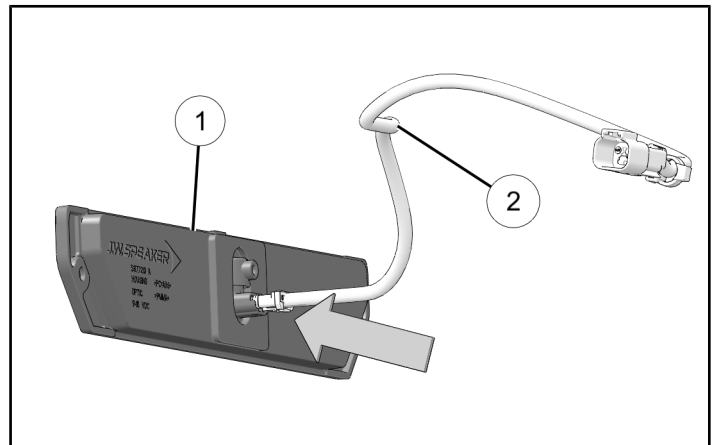

8. Install worklight ① onto bezel. Route wiring through center opening. Install using screws ⑥. Torque until fully seated.

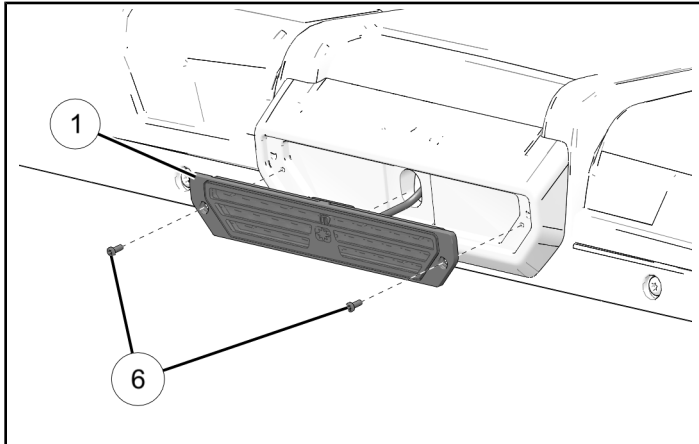

9. Attach wiring harness ② to inside of roof using edge clip. Connect rear work light harness to light bar harness.

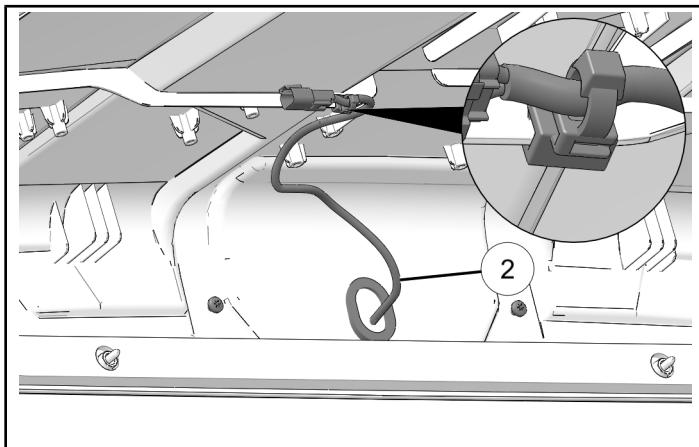

## INSTRUCTION FEEDBACK FORM

A feedback form has been created for the installer to provide any comments, questions or concerns about the installation instructions. The form is viewable on mobile devices by scanning the QR code or by clicking [HERE](#) if viewing on a PC.



## VEHICLE REASSEMBLY

### GENERAL

1. Install roof liner if equipped.