

REAR WORK LIGHT KIT



P/N 2889771

MISSING OR DAMAGED PARTS

Before beginning assembly, inspect the kit and its component(s) to be sure all parts and tools are accounted for and not damaged. If missing parts or parts are damaged, please contact your Selling Dealer for assistance.

If your accessory was purchased online, please contact POLARIS® customer service at **1-800-POLARIS** (US & Canada only).

REQUIRED SOLD SEPARATELY

Only parts for installation of the Rear Work Light Kit are included. Prior installation of the following additional kits are also required (sold separately):

- *Pulse Roof Kit*, P/N 2890262 or 2890441

Only parts for installation of the Rear Work Light Kit are included. For complete installation, the following additional kit is required (sold separately):

- *Switch Panel Kit*, P/N 2890422

KIT CONTENTS

REAR WORK LIGHT KIT P/N 2889771

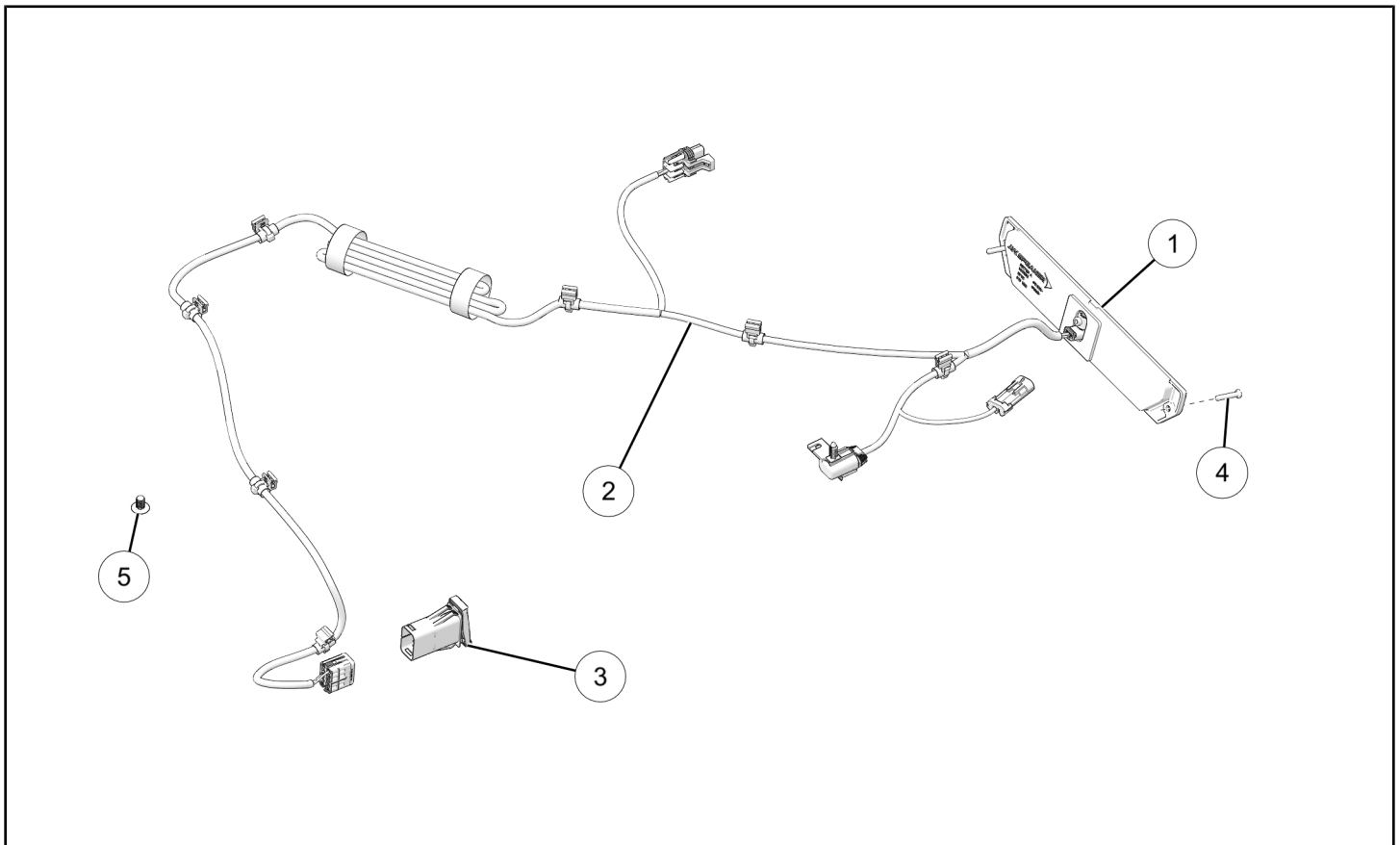

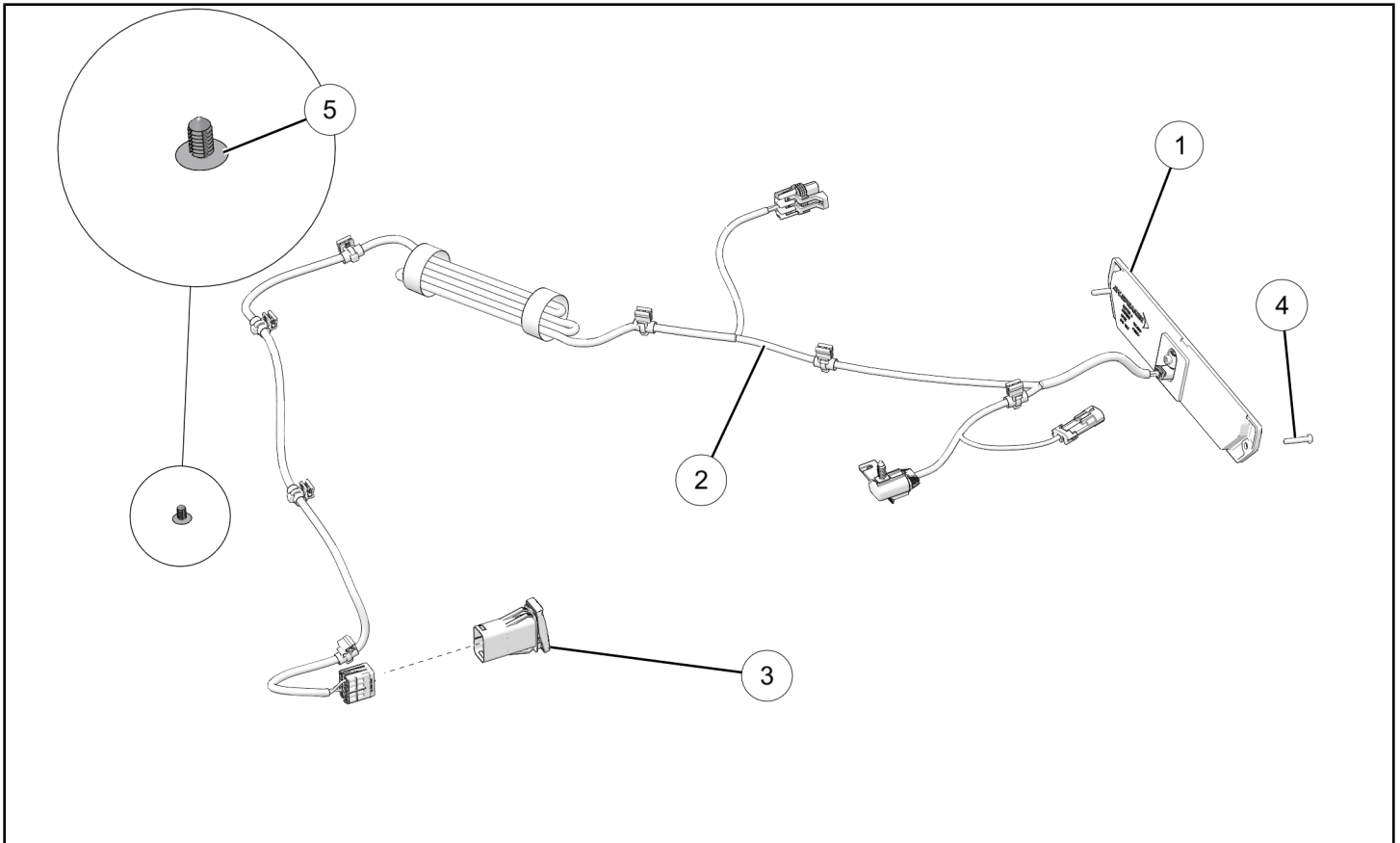

REF	QTY	PART DESCRIPTION	P/N AVAILABLE SEPARATELY
1	1	Rear Work Light	2415906
2	1	Rear Work Light Harness	2417345
3	1	Rear Work Light Switch	4080801-29
4	2	Screw, Torx®, Pan Head, Self Threading, #10 x 1.0 in	7520164
5	13	Push dart clip	7670088

HARNESS DETAIL

REAR WORK LIGHT HARNESS ②

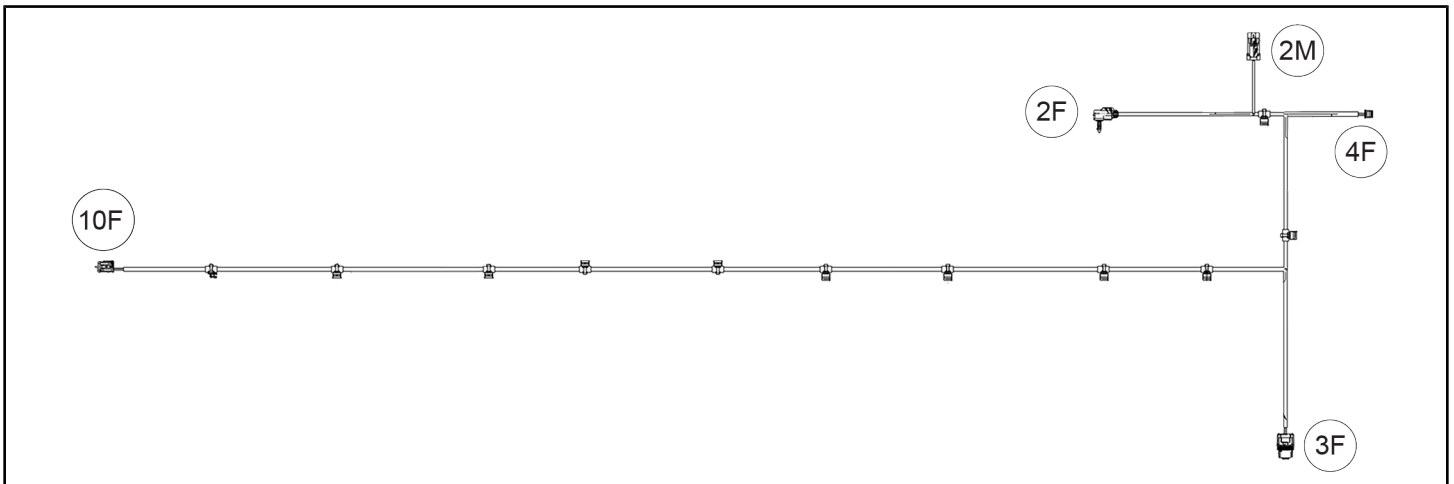

REF	PART DESCRIPTION	CONNECTS TO
10F	Connector	Rear Work Light Switch ③
2F	Fuse Connector	n/a
2M	Connector	n/a
4F	Connector	Rear Work Light ①
3F	Connector	Polaris Pulse® Bar

Example: 16F = 16 pin, Female / 16M = 16 pin, Male (Male terminal fits inside female terminal)

TOOLS REQUIRED

- Safety Glasses
- Drill
- Hole Saw:
 - 7/8 in (22 mm)
- Pliers, Side Cutting
- Socket Set, Torx® Bit
- Torque Wrench
- Utility Knife/Cutting Tool

IMPORTANT

Your Rear Work Light Kit is exclusively designed for your vehicle. Please read the installation instructions thoroughly before beginning. Installation is easier if the vehicle is clean and free of debris. For your safety, and to ensure a satisfactory installation, perform all installation steps correctly in the sequence shown.

INSTALLATION INSTRUCTIONS

VEHICLE PREPARATION

GENERAL

1. Park vehicle on a flat surface.
2. Shift vehicle into PARK.
3. Turn key to OFF position and remove key.

REAR GLASS PANEL REMOVAL

1. Turn handle down.

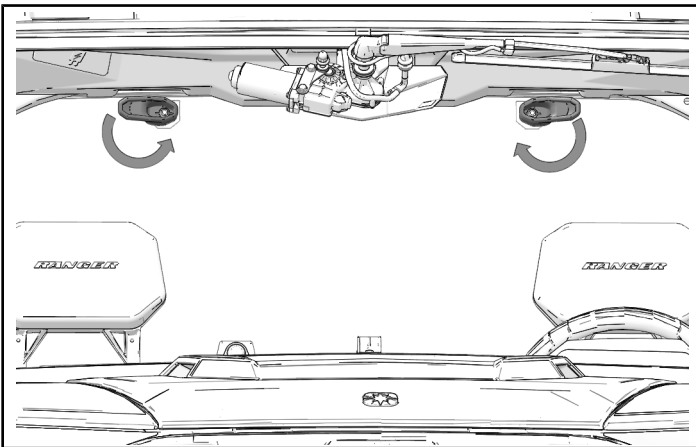

2. Lift up rear glass panel from the bottom edge. Move bottom of rear glass panel away from bottom of cab frame.

TIP

It is recommended that two people do this step.

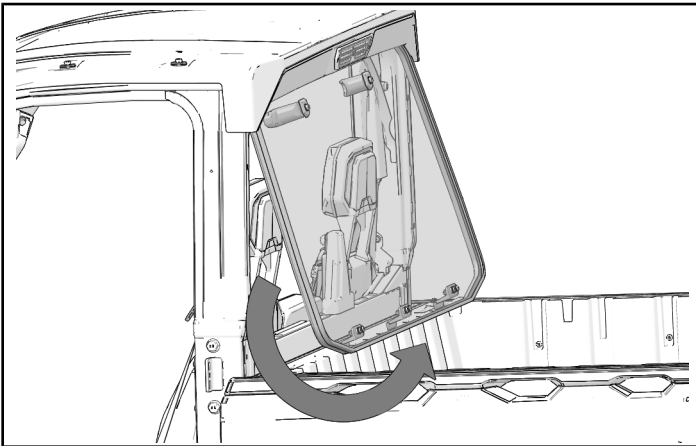
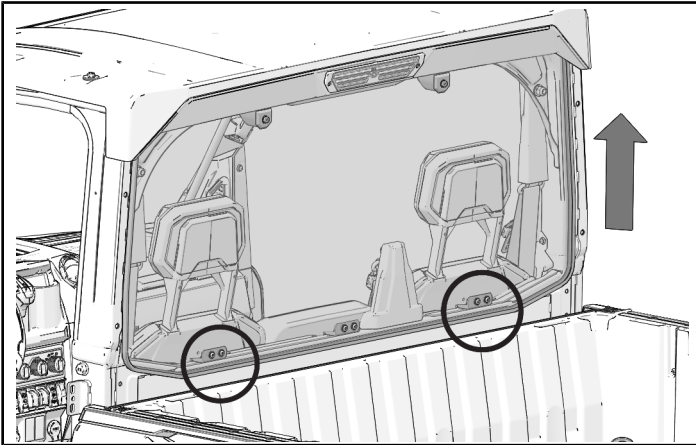

3. Remove rear glass panel from vehicle.

ROOF LINER FRONT REMOVAL

1. Remove and keep six push dart clips from front edge of liner.

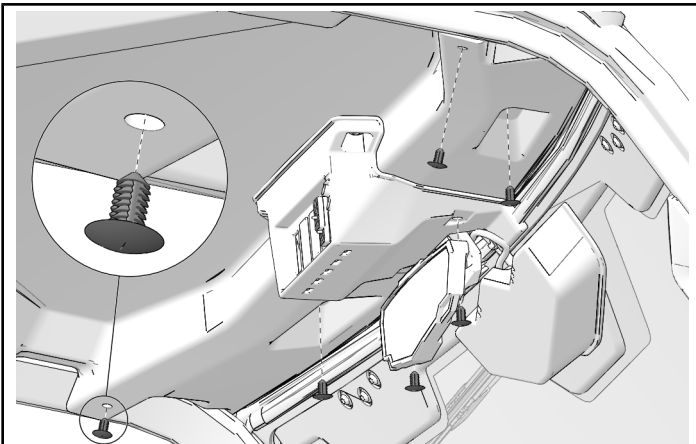

2. If equipped with upper switch panel, remove two screws from switch panel. Disconnect any harness attached. Remove Switch Panel.

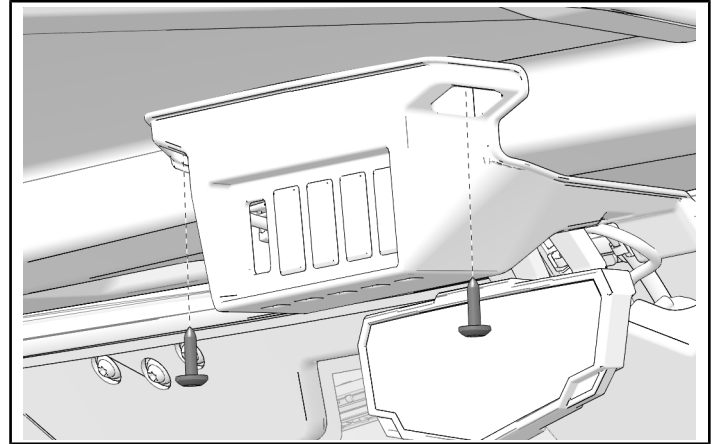

3. Remove two screws from middle of front roof liner. If equipped with dome light, remove dome light and disconnect any wiring.

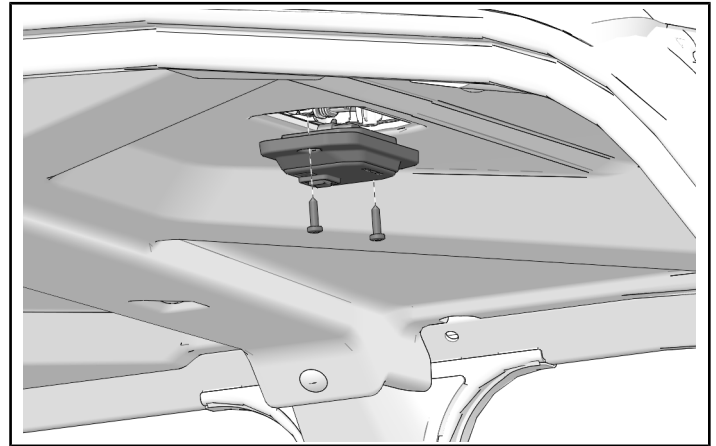

4. Crew Model Only: Remove five push dart clips from back of front roof liner.

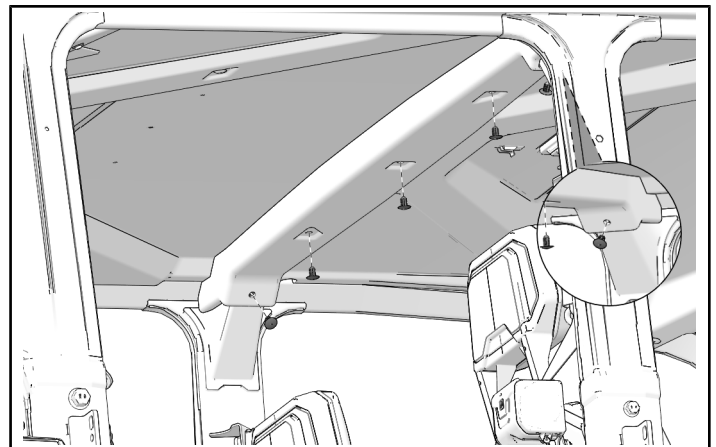

5. Three-passenger Vehicle Only: Remove two screws and two push dart clips from rear of front liner.

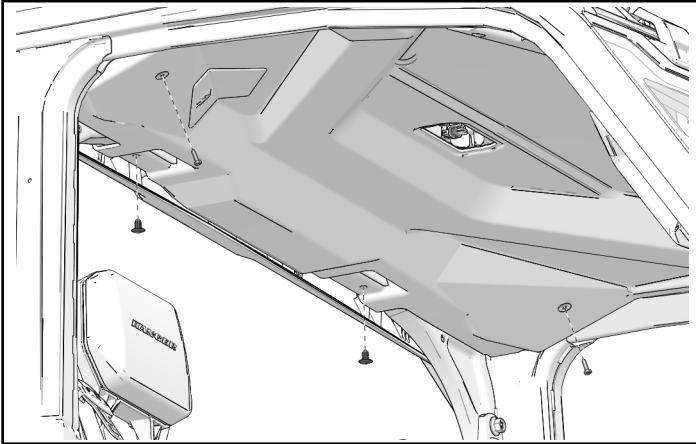

6. Pull front of roof liner down to remove from roof.

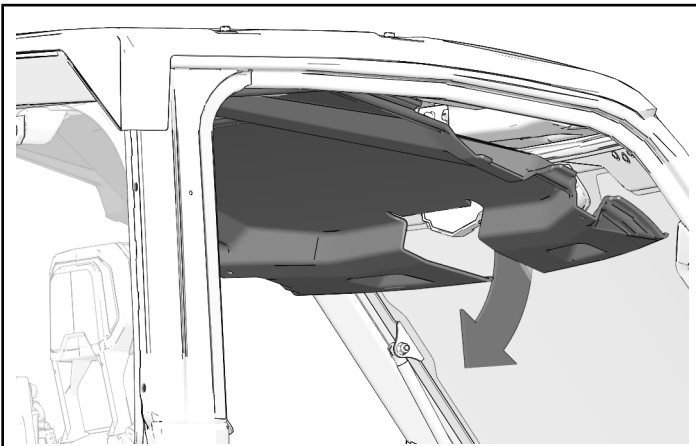

REAR ROOF LINER REMOVAL (CREW VEHICLES ONLY)

NOTICE

Vehicle hidden for clarity.

1. Remove two screws and four push dart clips from rear roof liner.

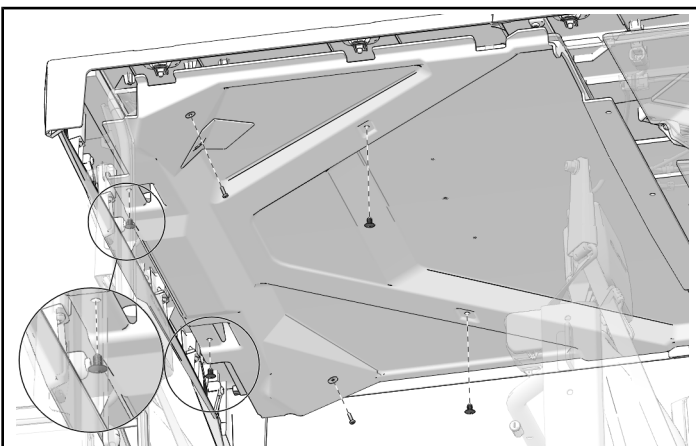

2. Remove rear roof liner from roof.

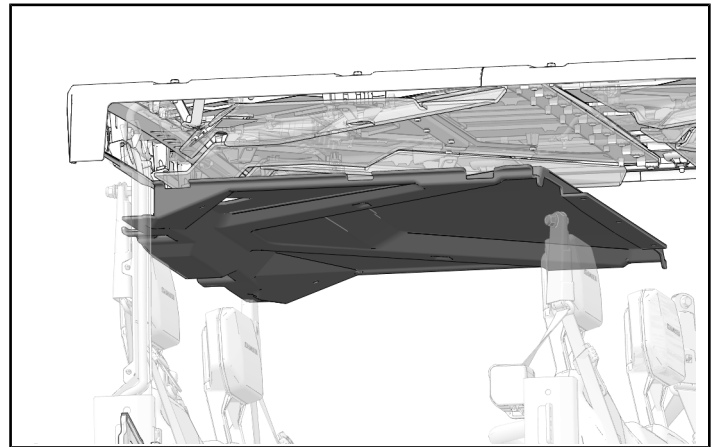

ACCESSORY INSTALLATION

ROOF PREPARATION

1. Remove and keep two rear roof screws.

NOTICE

Two-passenger vehicle shown; crew vehicle similar.

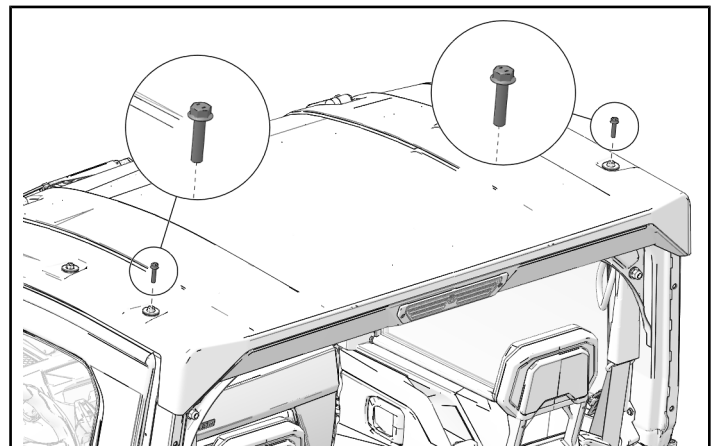

SWITCH PANEL PREPARATION

NOTICE

If switch panel has not been installed on this vehicle, please refer to the switch panel kit accessory instruction for this section.

DRILLING

1. Lightly cut with hole saw into the top dimple on rear roof panel to make a circle.

MEASUREMENT

Drill Bit Size:
7/8 in (22 mm)

NOTICE

Do not drill through rear roof panel.

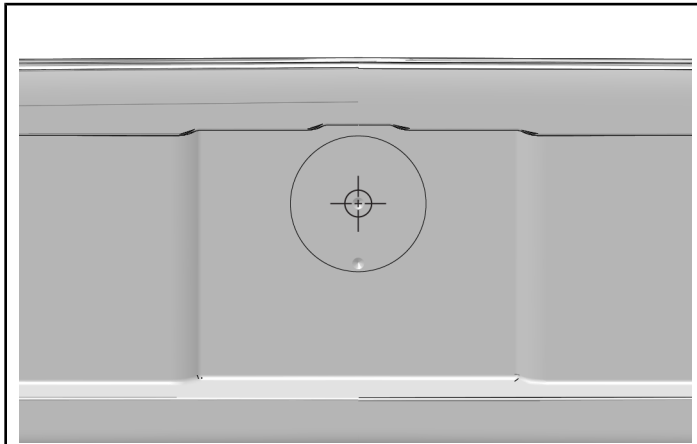
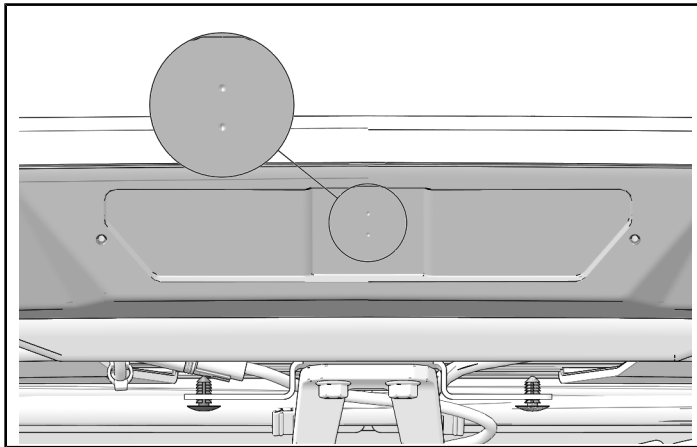

2. Drill through bottom dimple.

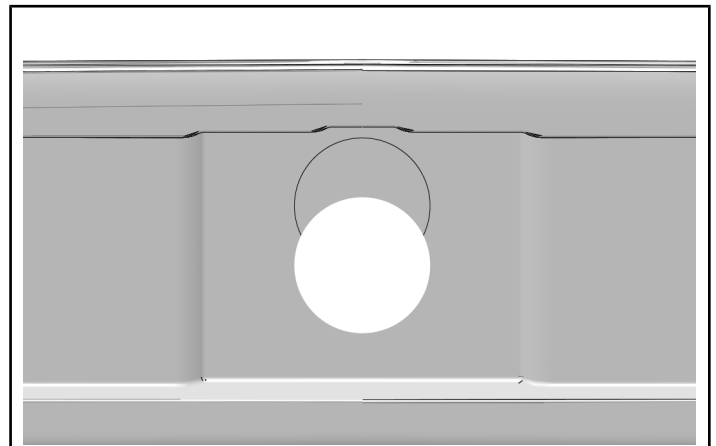
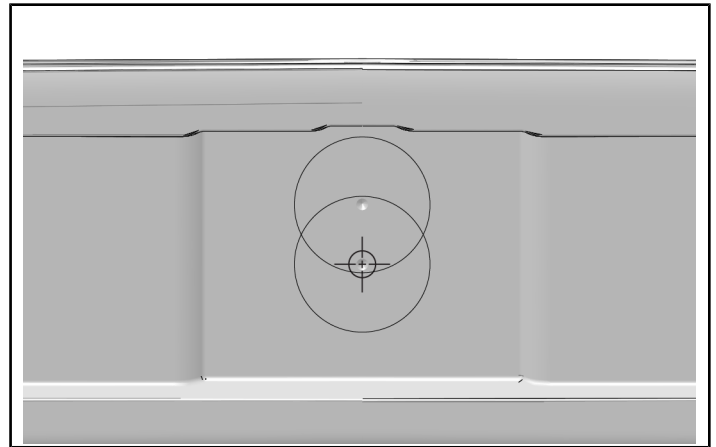

3. Connect the two sides of the circles. Cut remaining material inside the lines with a utility knife.

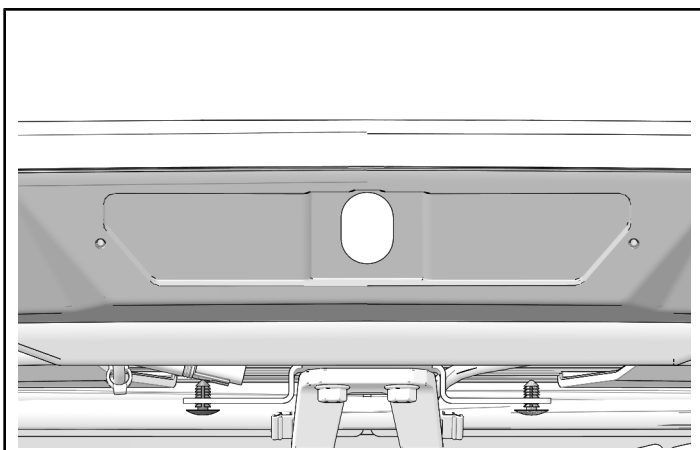
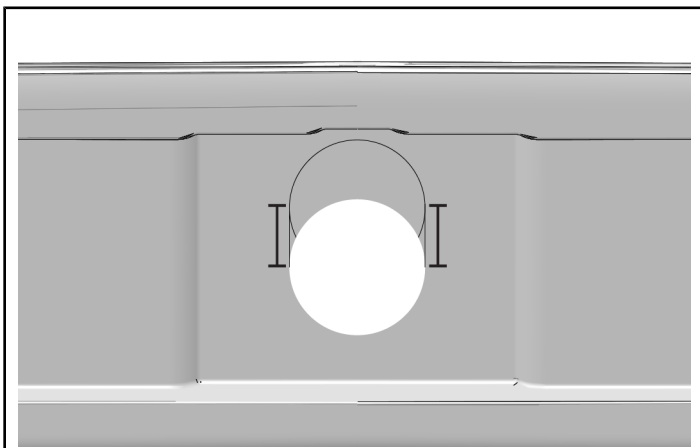

REAR WORK LIGHT HARNESS INSTALLATION

REAR WORK LIGHT HARNESS ② THREE-PASSENGER VEHICLE OVERVIEW

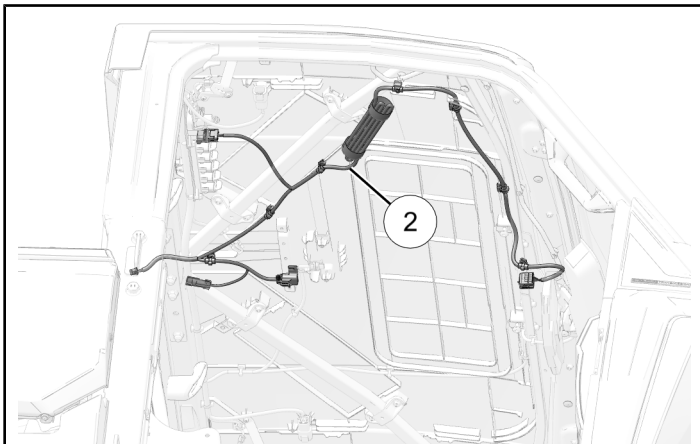

THREE-PASSENGER VEHICLE HARNESS ROUTING

1. Install three edge clips near front of roof. Make sure harness ② connector **10F** is located near the front.

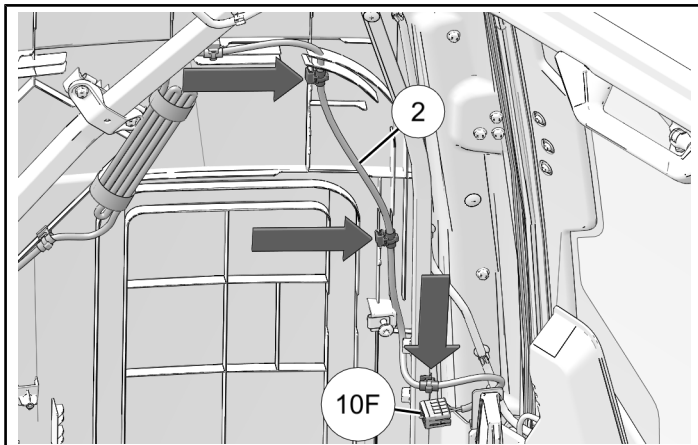

2. Install four edge clips.

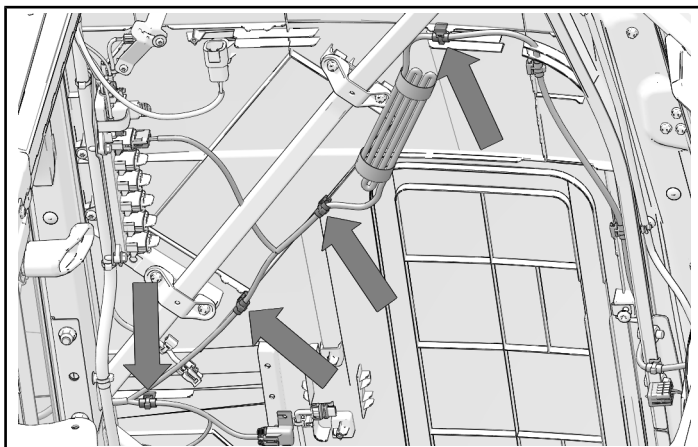

REAR WORK LIGHT HARNESS ② CREW VEHICLE OVERVIEW

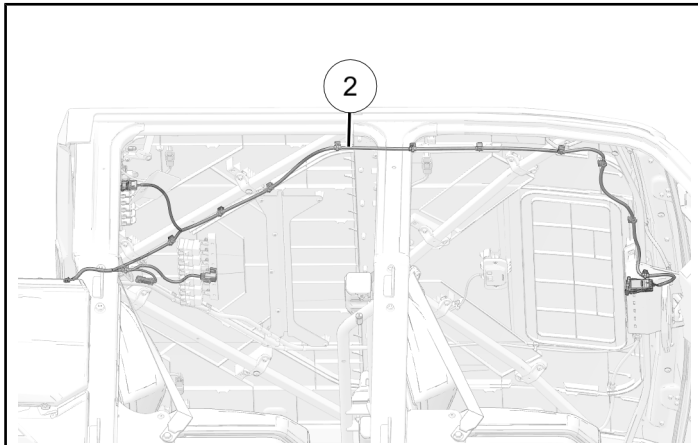

CREW VEHICLE HARNESS ROUTING

1. Cut electrical tape on rear work light harness ②.

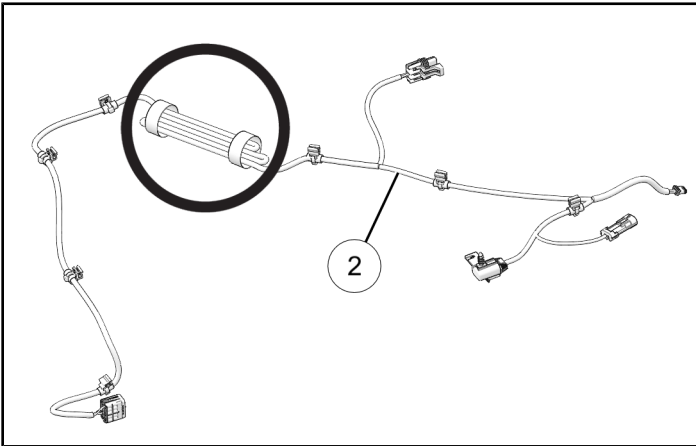

2. Install three edge clips near front of roof. Make sure harness ② connector 10F is located near the front.

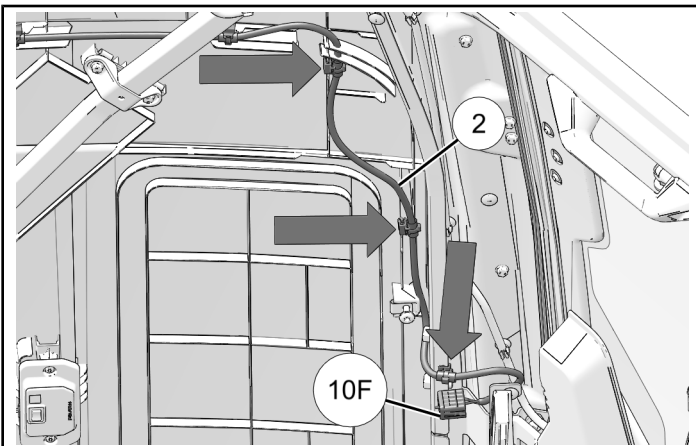

3. Install four edge clips along roof.

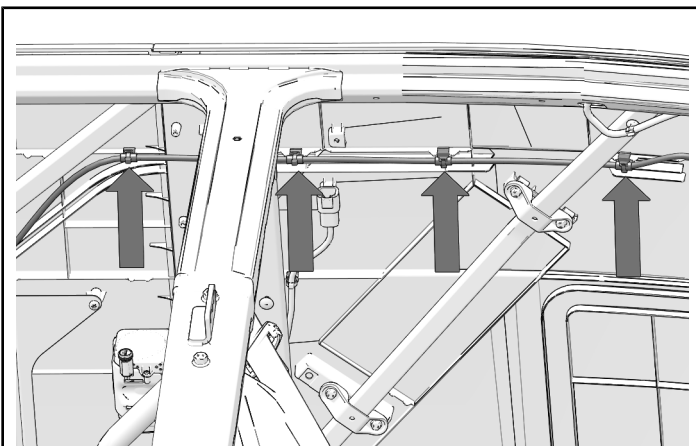

4. Install four edge clips near rear end of roof.

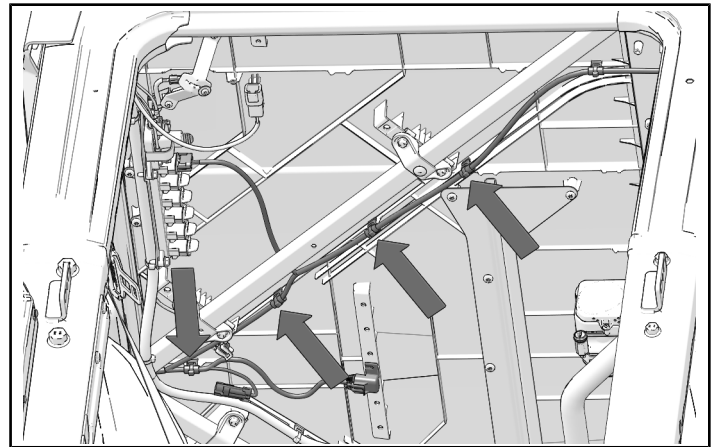

ACCESSORY INSTALLATION AND HARNESS CONNECTIONS

NOTICE

Three-passenger vehicle shown; crew model similar.

1. Lift back of roof by the edge to pull harness ② connector 4F underneath roof seal into roof cutout.

NOTICE

Roof hidden for clarity.

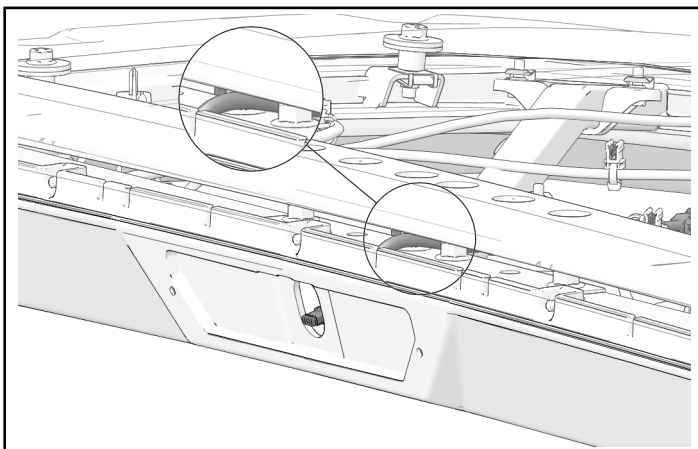
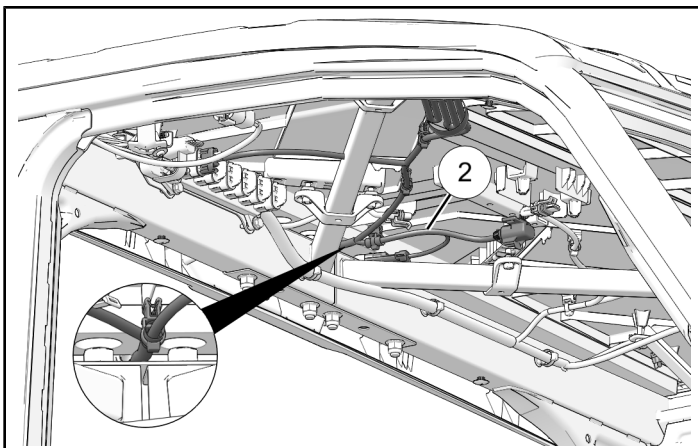
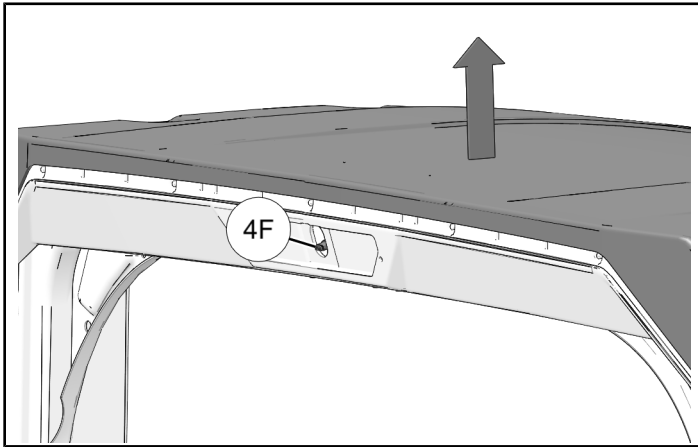

2. Connect harness ② connector 4F to rear work light ①.

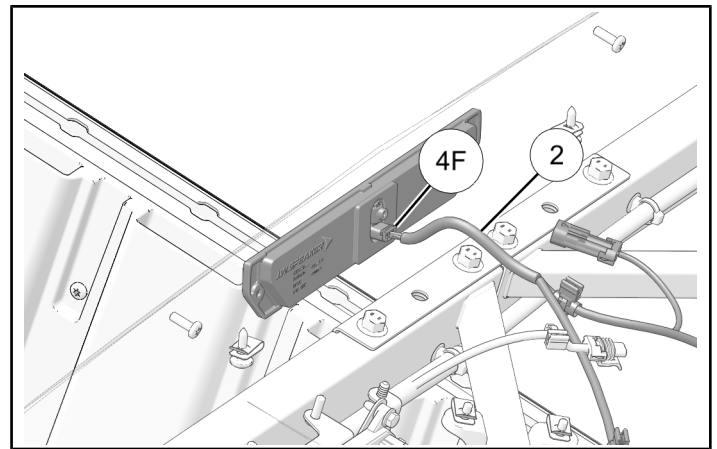
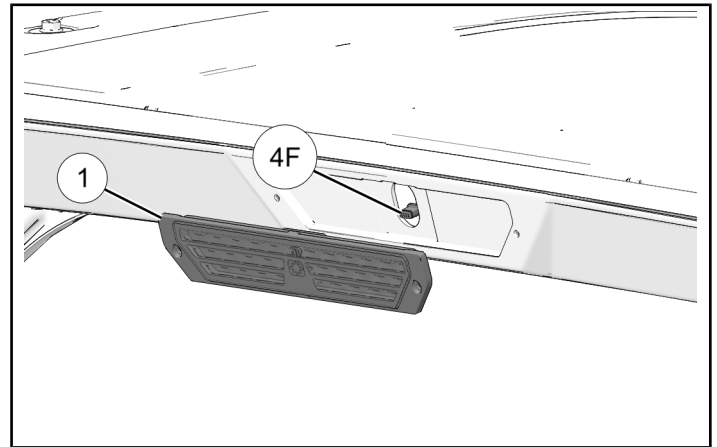

3. Install two screws ④ into rear work light ①. Torque screws to specification.

TORQUE

Screws ④:
22 in-lbs (2.5 N·m)

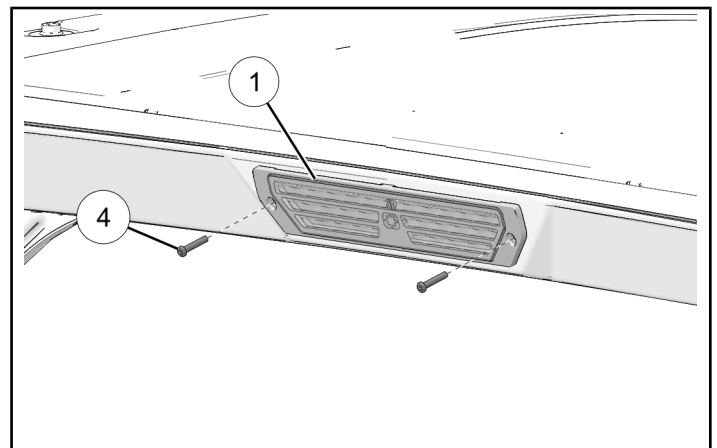

- Connect harness ② connector 3F to Polaris Pulse® Bar.

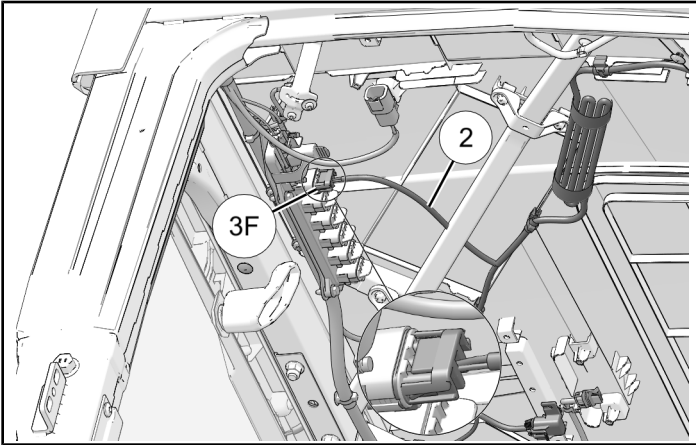

- Attach harness ② fuse connector 2F to roof hole with push dart clip.

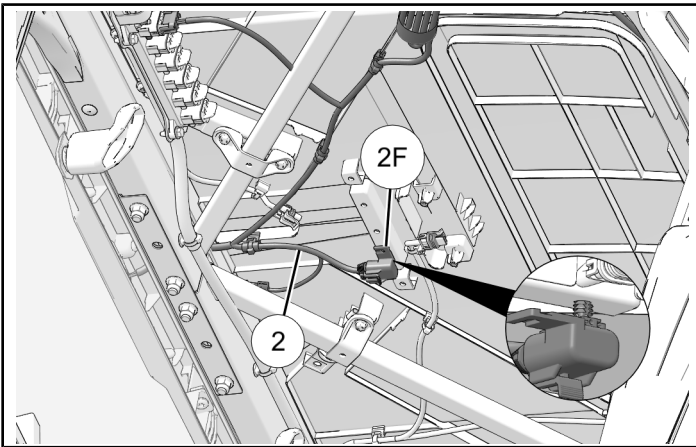

- Install two kept rear roof screws. Torque screws to specification.

TORQUE

Roof Screws:
70 in-lbs (8 N·m)

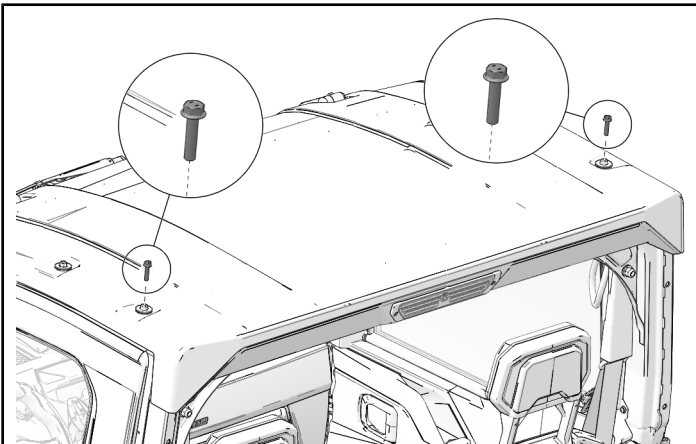

VEHICLE REASSEMBLY

REAR ROOF LINER INSTALLATION

- Install rear roof liner onto roof.

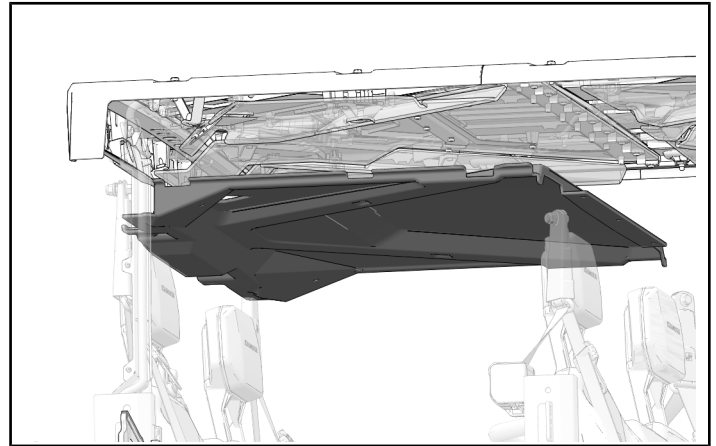

- Install two screws ① and four push dart clips into rear roof liner.

NOTICE

If kit contains new push dart clips, install roof liner using new push dart clips.

TORQUE

Screws ①:
22 in-lbs (2.5 N·m)

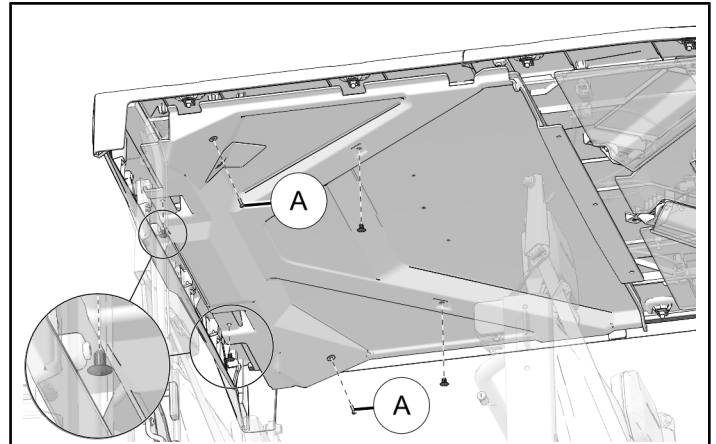

FRONT ROOF LINER INSTALLATION

1. Install rear edge of roof liner then lift front into place.

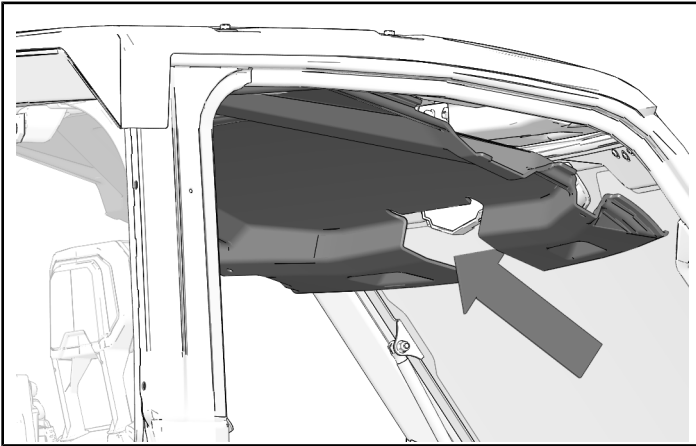

2. Install four push dart clips at front of roof liner.

NOTICE

If kit contains new push dart clips, install roof liner using new push dart clips.

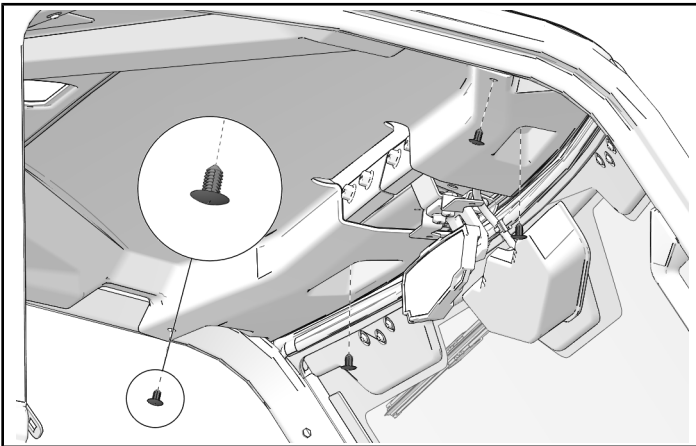

3. If vehicle is equipped with dome light, connect dome light and install onto roof liner with two screws. Torque two screws to specification

NOTICE

Vehicles without dome light will still have two screws.

TORQUE

Screws:

17 in-lbs (2 N·m)

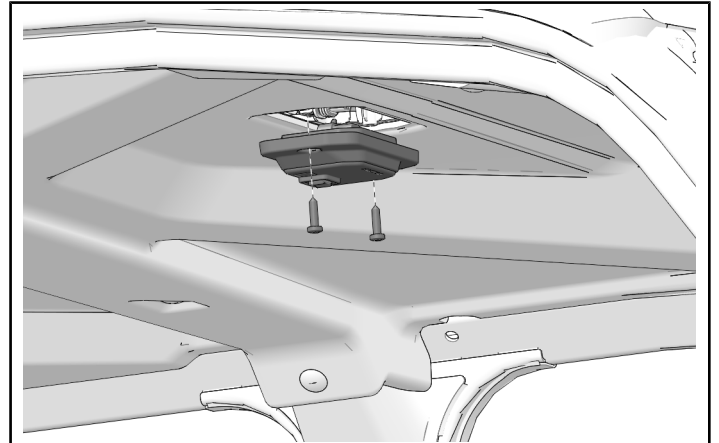

4. Crew Model Only: Install five push dart clips to rear of front roof liner.

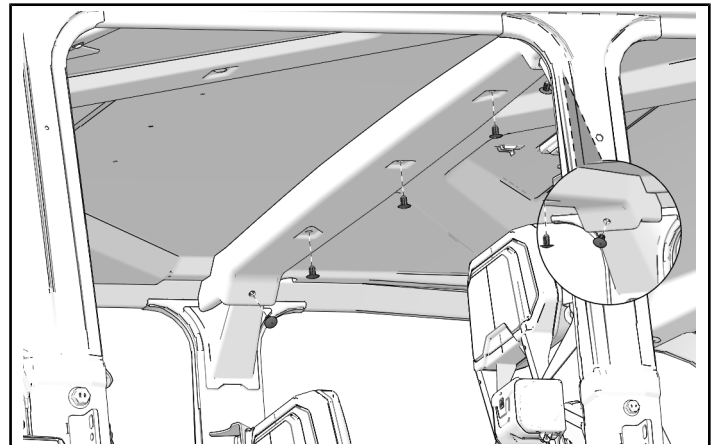

- Three-passenger Model Only: Install two screws and two push dart clips from rear of front liner. Torque screws to specification.

TORQUE

Screws:
22 in-lbs (2.5 N·m)

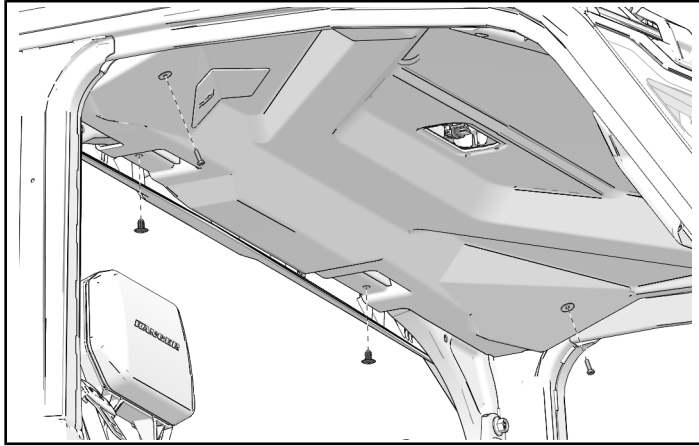

- Turn handle up.

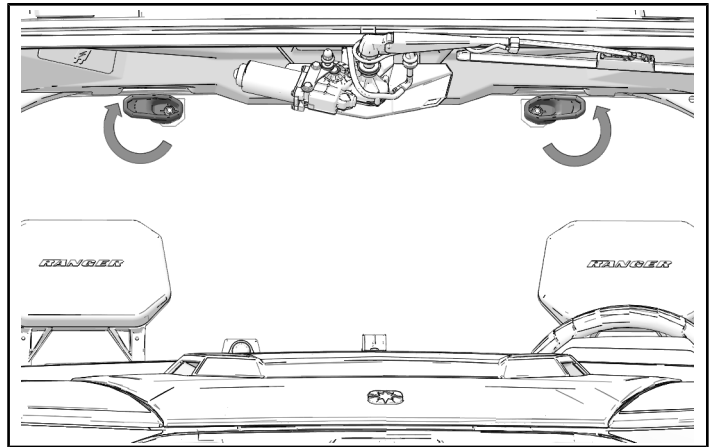

REAR GLASS PANEL INSTALLATION

- Put rear glass panel underneath rear of roof.

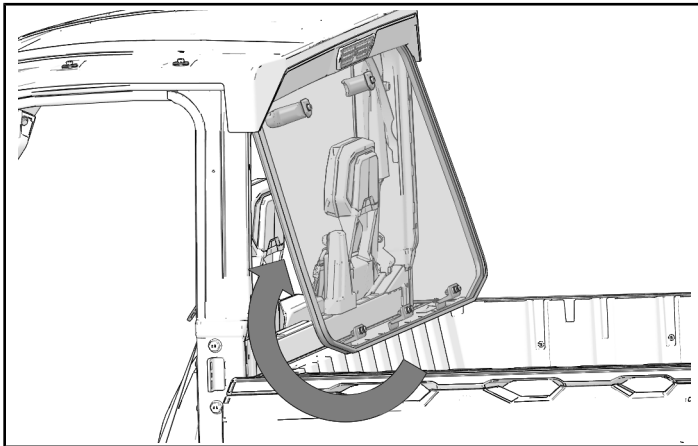

- Put rear panel mounts onto the cab frame.



WORK LIGHT SWITCH INSTALLATION

NOTICE

Switch Panel Kit (sold separately) may be needed for this section.

- Remove switch blank from desired switch panel slot.

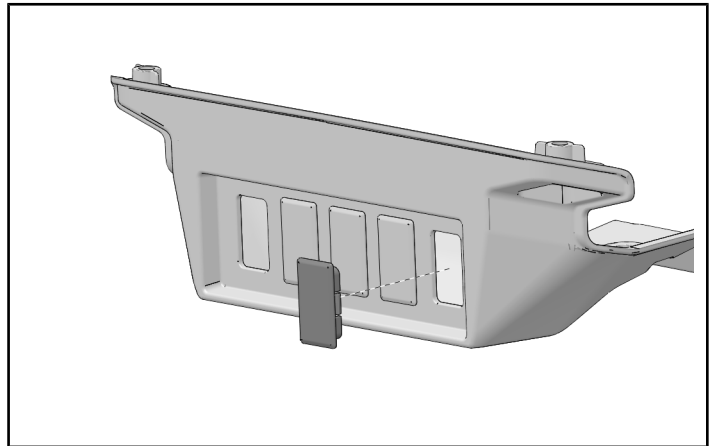

- Install rear work light switch ③ into switch panel slot.

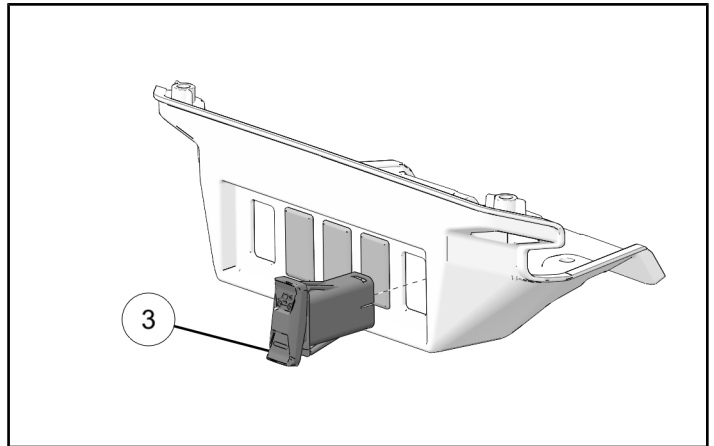

3. Put switch panel near rear work light harness ② connector **10F**. Connect work light harness ② connector **10F** to work light switch ③.

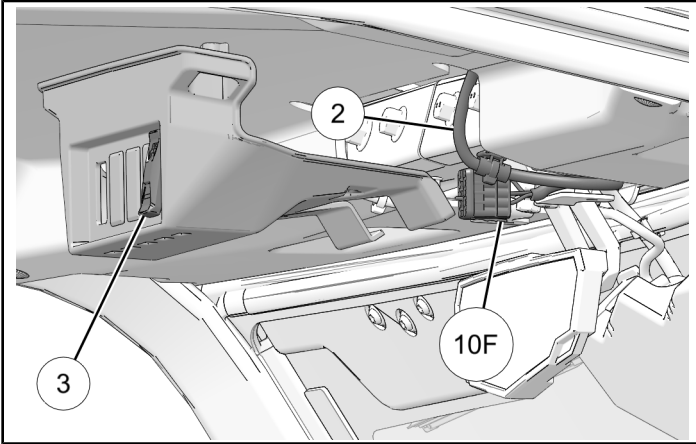

4. Install switch panel to roof using two push-pin darts and two screws. Torque screws to specification.

TORQUE

Switch Panel Screws:
31 in-lbs (3.5 N·m)

