

BUMPER LIGHT KIT



P/N 2889767

BEFORE YOU BEGIN

Read these instructions and check to be sure all parts and tools are accounted for. Please retain these installation instructions for future reference and parts ordering information.

APPLICATION

Verify accessory fitment at www.polaris.com.

KIT CONTENTS

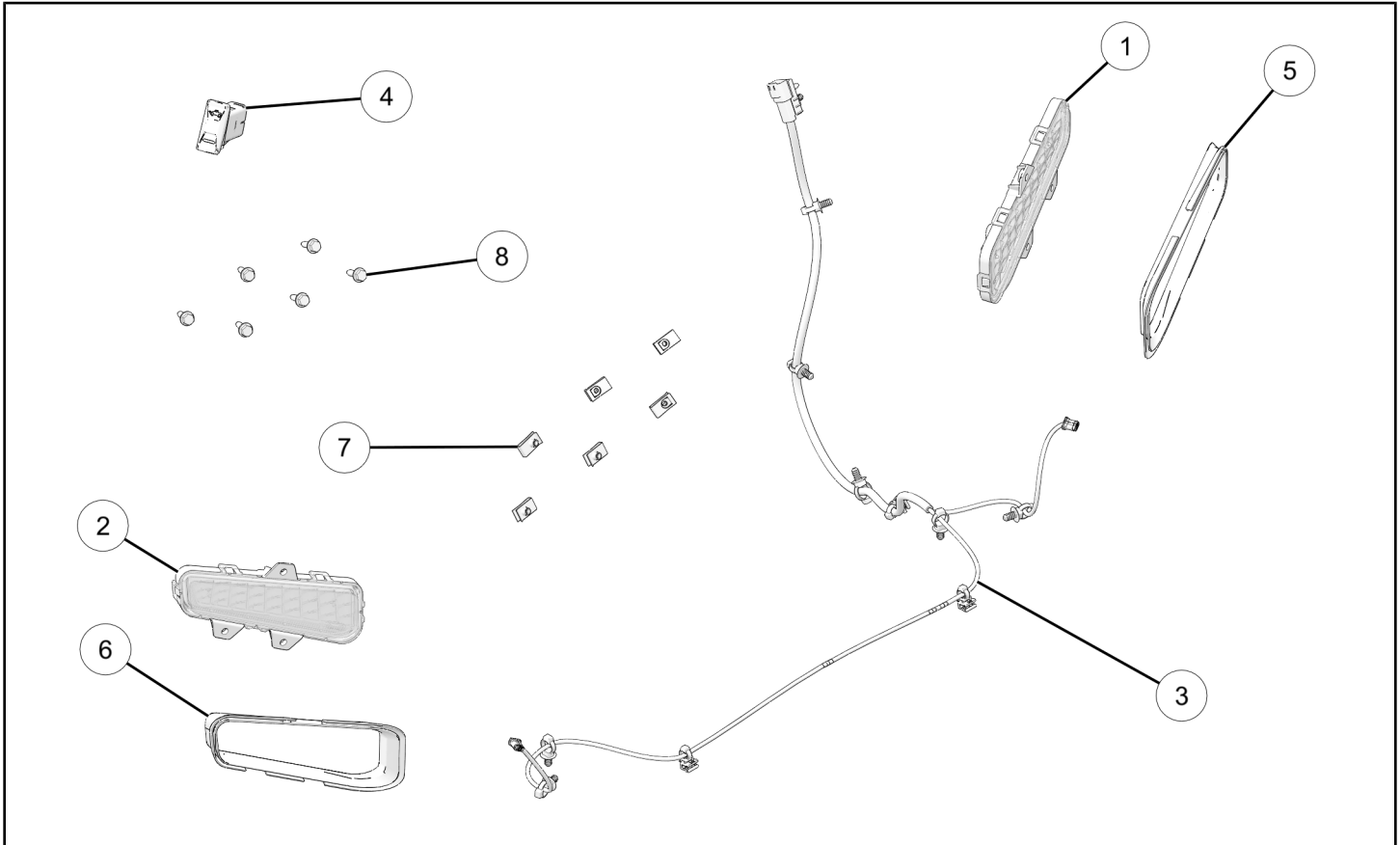

REF	QTY	PART DESCRIPTION	P/N AVAILABLE SEPARATELY
1	1	Auxiliary Light, Front, Left	2415999
2	1	Auxiliary Light, Front, Right	2416000
3	1	Harness – Auxiliary Light	2416508
4	1	Switch – Auxiliary Light	4080801-06
5	1	Gasket – Auxiliary Light, Front, Left	5418085
6	1	Gasket – Auxiliary Light, Front, Right	5418086
7	6	U-Clip	7081305
8	6	Screw – Hex, M6 x 1.0 x 20 mm	7518529

HARNES DETAIL

BUMPER LIGHT HARNESS

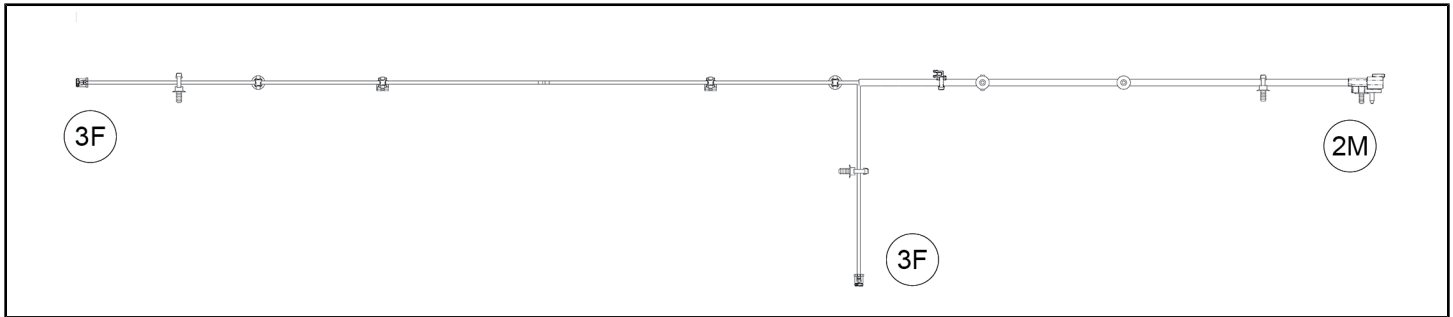

REF	PART DESCRIPTION	CONNECTS TO
3F	Three Pin Female Connector	Left Bumper Light
2M	Male Two Pin Connector	Chassis Harness
3F	Three Pin Female Connector	Right Bumper Light

Example: 16F = 16 pin, Female / 16M = 16 pin, Male (Male terminal fits inside female terminal)

TOOLS REQUIRED

- Safety Glasses
- Utility Knife/Cutting Tool
- Socket Set, Metric
- Pry Tool

IMPORTANT

Your Bumper Light Kit is exclusively designed for your vehicle. Please read the installation instructions thoroughly before beginning. Installation is easier if the vehicle is clean and free of debris. For your safety, and to ensure a satisfactory installation, perform all installation steps correctly in the sequence shown.

INSTALLATION INSTRUCTIONS

VEHICLE PREPARATION

GENERAL

1. Park vehicle on a flat surface.
2. Shift vehicle into PARK.
3. Turn key to OFF position and remove key.

ACCESSORY INSTALLATION

NOTICE
Left side shown right side similar.

1. Install gasket ⑤ in bumper opening. Gasket installs on inside of bumper. Make sure bumper flange fits inside channel in gasket.

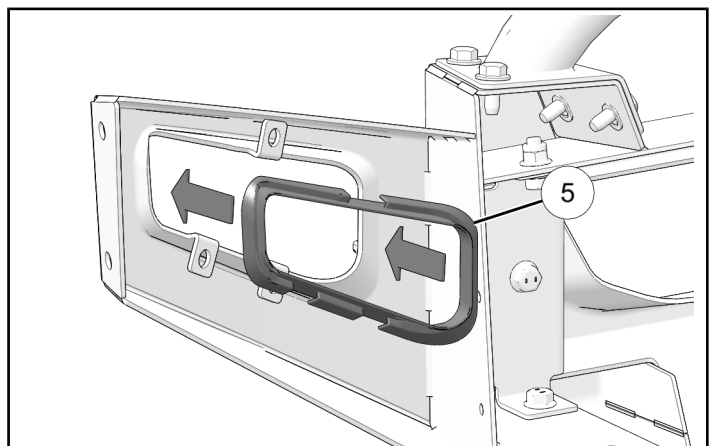

2. Install u-nuts ⑦ on mounting tabs inside bumper.

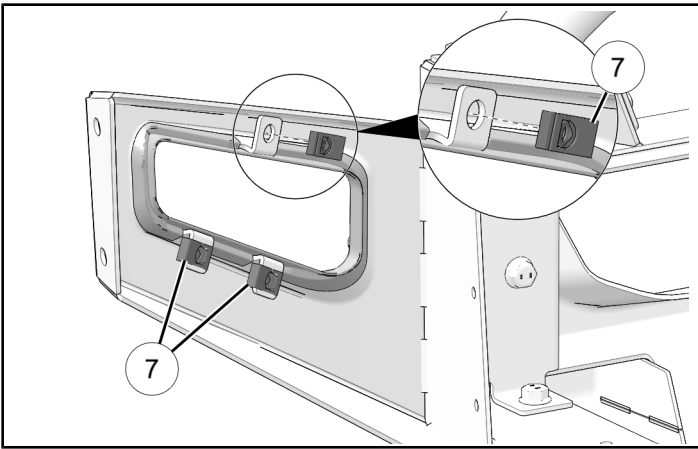

3. Install wiring harness ③. Attach to bumper using push pin clips and edge clips in positions show.

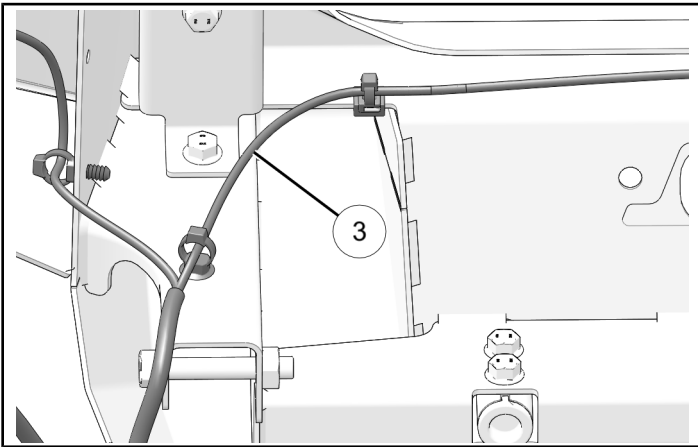
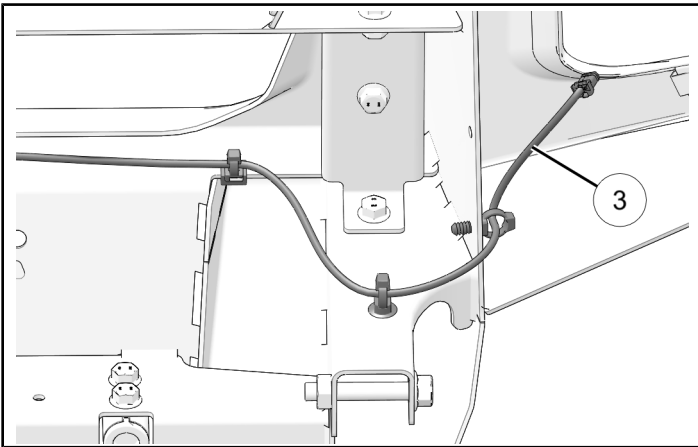

4. Route harness ③ along chassis tube. Attach using push pin clips and edge clips. Connect 2M to chassis wiring harness.

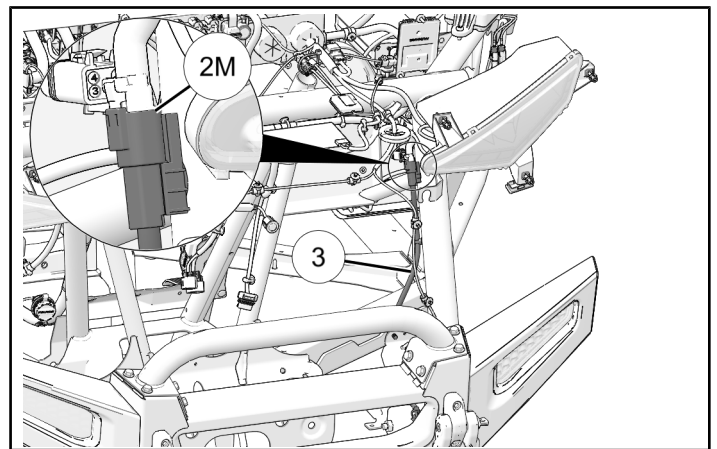
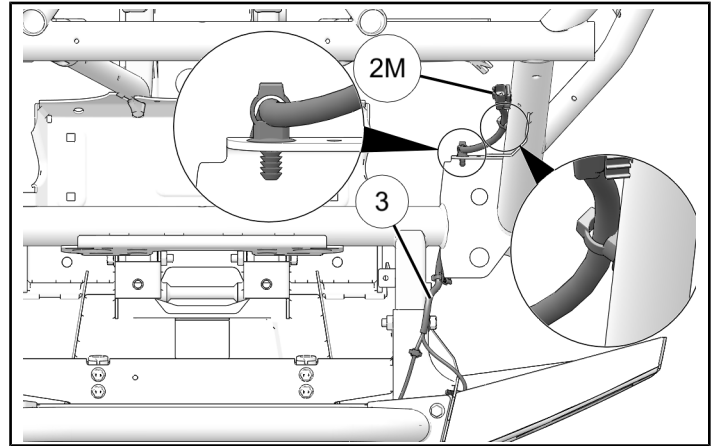

5. Install light ① using three screws ⑧. Torque to specification.

TORQUE

Screws ⑧:
22 in-lbs (2.5 N·m)

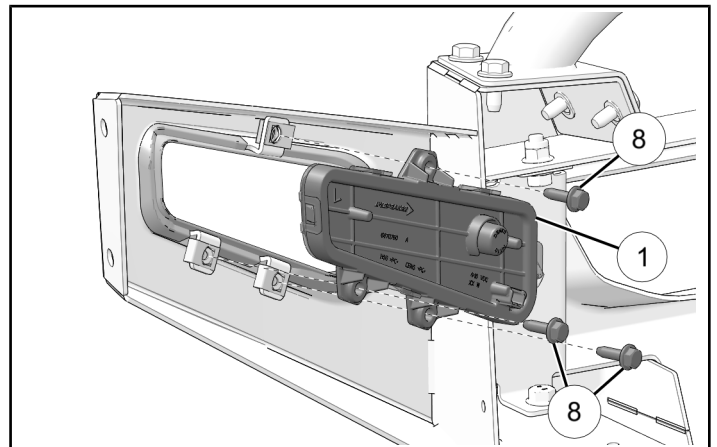

6. Connect wiring plug 3F to light ①.

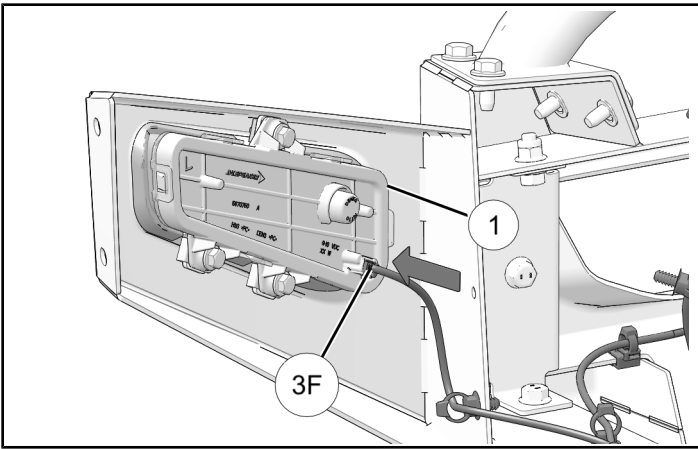

7. Remove blank switch plug in switch location shown.

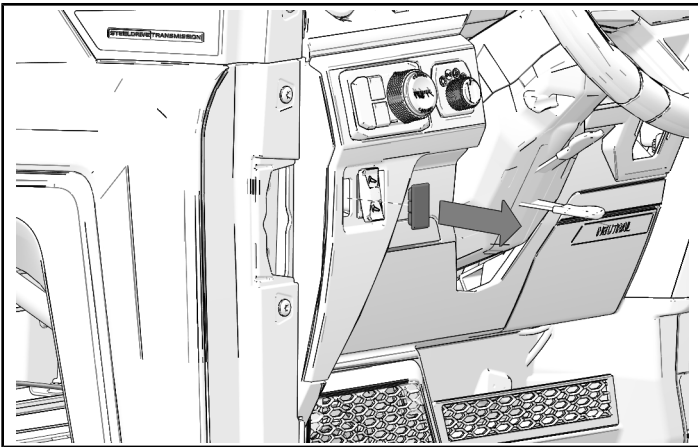
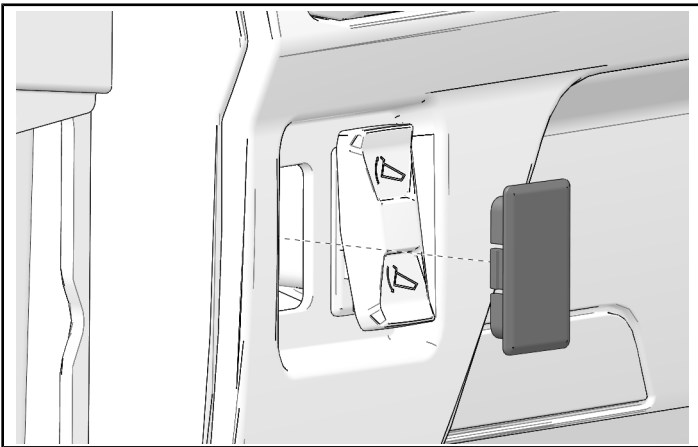

8. Remove panel. Use a pry tool to gently remove panel.



9. Install switch ④ in panel.

NOTICE

If another switch is installed in the panel only pull panel out far enough to connect switch ④.

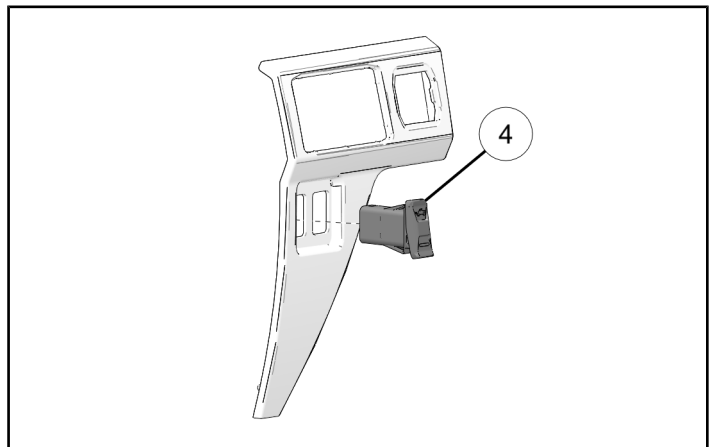

10. Pull wiring plug through opening and connect to switch ④.

NOTICE

If another switch is installed in the panel only pull panel out far enough to connect switch ④.

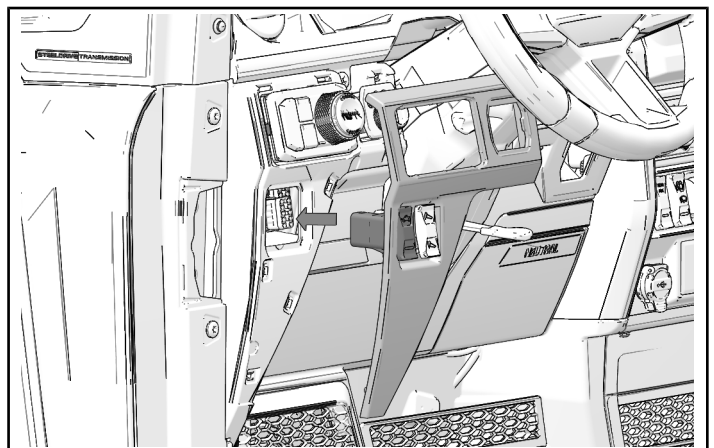

INSTRUCTION FEEDBACK FORM

A feedback form has been created for the installer to provide any comments, questions or concerns about the installation instructions. The form is viewable on mobile devices by scanning the QR Code® or by clicking [HERE](#) if viewing on a PC.

