

P/N 2889749

BEFORE YOU BEGIN

Read these instructions and check to be sure all parts and tools are accounted for. Please retain these installation instructions for future reference and parts ordering information.

APPLICATION

Verify accessory fitment at www.polaris.com.

REQUIRED SOLD SEPARATELY

Only parts for installation of the HD Plow Flap are included. For complete installation, the following additional kit is required (sold separately):

- *HD Glacier Plow Frame*, P/N 2889111
- *HD Glacier Plow Blade*, P/N 2889112
- *Plow Controller Kit*, P/N 2883247, 2889769

KIT CONTENTS

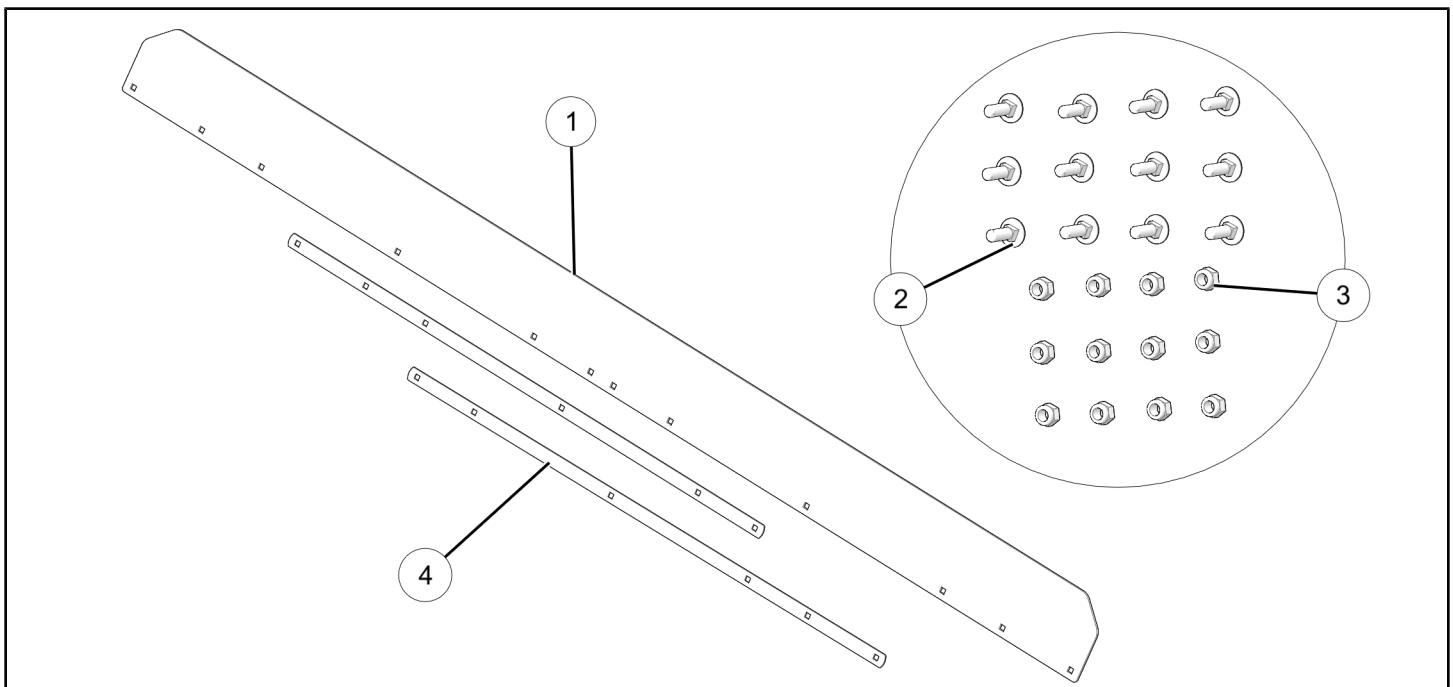

REF	QTY	PART DESCRIPTION	P/N AVAILABLE SEPARATELY	SERVICE KIT
1	1	Flap, 84 Inches	719033	n/a
2	12	Screw, M8 x 1.25 x 25 mm	n/a	2209946
3	12	Nut, M8 x 1.25 x 8 mm	n/a	2209946
4	2	Flap Bracket	n/a	n/a

TOOLS REQUIRED

- Safety Glasses
- Socket Set, Metric

IMPORTANT

Your HD Plow Flap is exclusively designed for your vehicle. Please read the installation instructions thoroughly before beginning. Installation is easier if the vehicle is clean and free of debris. For your safety, and to ensure a satisfactory installation, perform all installation steps correctly in the sequence shown.

INSTALLATION INSTRUCTIONS

VEHICLE PREPARATION

GENERAL

1. Park vehicle on a flat surface.
2. Shift vehicle into PARK.
3. Turn key to OFF position and remove key.

CAUTION

Make sure blade is resting firmly on ground prior to installation. If blade falls, personal injury may result.

ACCESSORY INSTALLATION

REMOVE ORIGINAL SNOW DEFLECTOR IF INSTALLED

1. Remove and discard twelve nuts and screws.

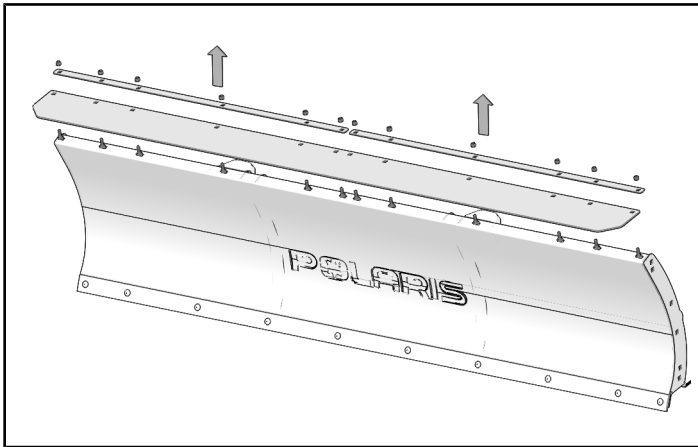

2. Remove and discard two flap brackets and flap.

INSTALL HD GLACIER PLOW FLAP

1. Loosely install flap ① and flap bracket ④ with twelve screws ② and twelve nuts ③.

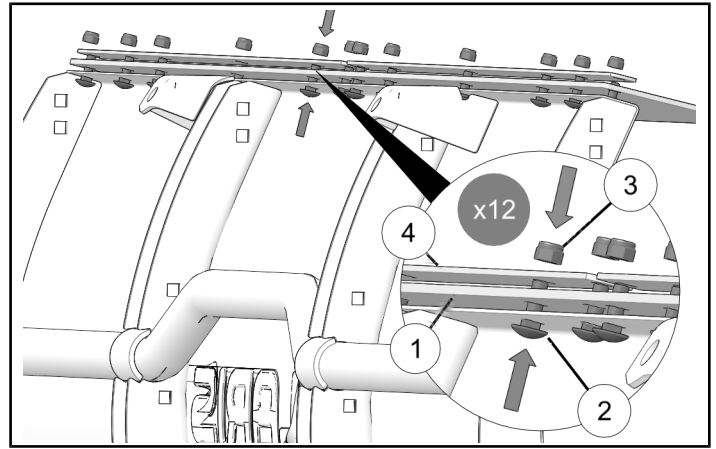

2. Tighten nuts ③ and screws ② starting at the center of each flap bracket ④ work outwards until all screws are seated evenly.

NOTICE

Do not over tighten.