

RANGER FULL-SIZE WINCH KIT



P/N 2889693; 2889694; 2889695; 2889696; 2891568;
2891569; 2891570; 2891571

BEFORE YOU BEGIN

Before beginning assembly, inspect the kit and its component(s) to be sure all parts and tools are accounted for and not damaged. If missing parts or parts are damaged, please contact your Selling Dealer for assistance.

If your accessory was purchased online, please contact POLARIS customer service at **1-800-POLARIS** (US & Canada only).

APPLICATION

Verify accessory fitment at www.polaris.com.

KIT CONTENTS

Kit P/N 2889693 shown; others similar except as noted below.

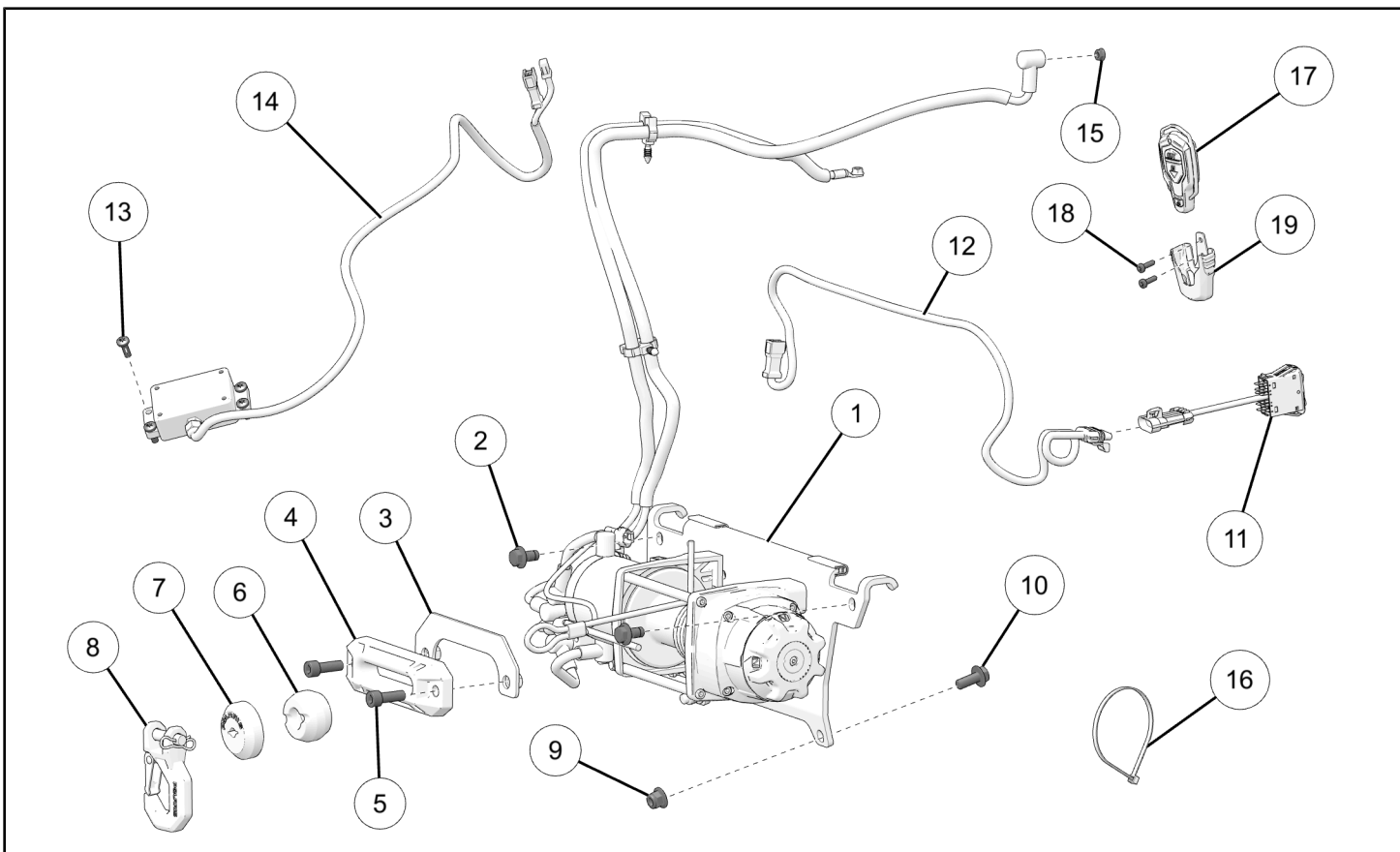

REF	QTY	PART DESCRIPTION	P/N AVAILABLE SEPARATELY	AVAILABLE SERVICE KIT
1	1	Winch Assembly, 6000 lb. Pro (P/N 2889693) Winch Assembly, 4500 lb. Pro (P/N 2889694) Winch Assembly, 4500 lb. HD (P/N 2889695) Winch Assembly, 6000 lb. HD (P/N 2889696) Winch Assembly, 6000 lb. Pro (P/N 2891568) Winch Assembly, 4500 lb. Pro (P/N 2891569) Winch Assembly, 4500 lb. HD (P/N 2891570) Winch Assembly, 6000 lb. HD (P/N 2891571)	2639347 2639348 2639349 2639350 2640385 2640386 2640387 2640388	n/a
2	2	Screw, Hex Flange, M10 x 1.5 x 20 mm Screw, Hex Flange, M10 x 1.5 x 20 mm (P/N 2889696 only)	7519905 7519905	2207258 2208141
3	1	Fairlead Mount Bracket (P/N 2889693; 2889694; 2889695 only)	5271082	n/a
4	1	Autostop Fairlead Assembly (P/N 2889693; 2889694; 2889696 only) Fairlead Assembly (P/N 2889695 only) Autostop Fairlead Assembly (P/N 2891568; 2891569; 2891571 only) Fairlead Assembly (P/N 2891570 only)	2637781 5143230 2640557 5145859	2889690
5	2	Screw, Socket Head, M10 x 1.5 x 30 mm Screw, Socket Head, M10 x 1.5 x 30 mm (P/N 2889696 only)	7519844 7519844	n/a 2208141
6	1	Winch Jounce Bumper	5418451	n/a
7	1	Magnet Stop, Bumper Non-Magnet Stop, Bumper (P/N 2889695 only)	5415787 5416562	2889690 (P/N 2889693; 2889694) n/a
8	1	Winch Hook Latch	5910706	n/a
9	2 4	Nut, M10 x 1.5 mm Nut, M10 x 1.5 mm (P/N 2889696 only)	7547423 7547423	2207258 2208141
10	2	Screw, Hex Flange, M10 x 1.5 x 25 mm Screw, Hex Flange, M10 x 1.5 x 25 mm (P/N 2889696 only)	7519071 7519071	2207258 2208141
11	1	Winch Switch, Sealed	4080274-03	n/a
12	1	Winch Jumper Switch, Sealed	2415055	n/a
13	4	Screw, Torx® Pan Head (P/N 2889693; 2889694 only)	7519731	2207258
14	1	Winch Wireless Receiver (P/N 2889693 only)	n/a	2883455
15	2	Nut, Hex Flange Head Nut, Hex Flange Head (P/N 2889696 only)	7547270 7547270	n/a 2208141
16	10	Cable Tie Cable Tie (P/N 2889696 only)	7080492 7080492	2207258 2208141
17	1	Winch Wireless Remote (P/N 2889693; 2889694 only)	n/a	2883455
18	2	Screw, Torx®, #10 x 3/4 in (P/N 2889693; 2889694 only)	7512026	2207258

REF	QTY	PART DESCRIPTION	P/N AVAILABLE SEPARATELY	AVAILABLE SERVICE KIT
19	1	Wireless Remote Holder (P/N 2889693; 2889694 only)	5454269	n/a
20	1	Winch Guide Manual (not shown)	9923644	n/a

HARNES DETAIL

WINCH HARNES ①

NOTICE

Winch hidden for clarity.

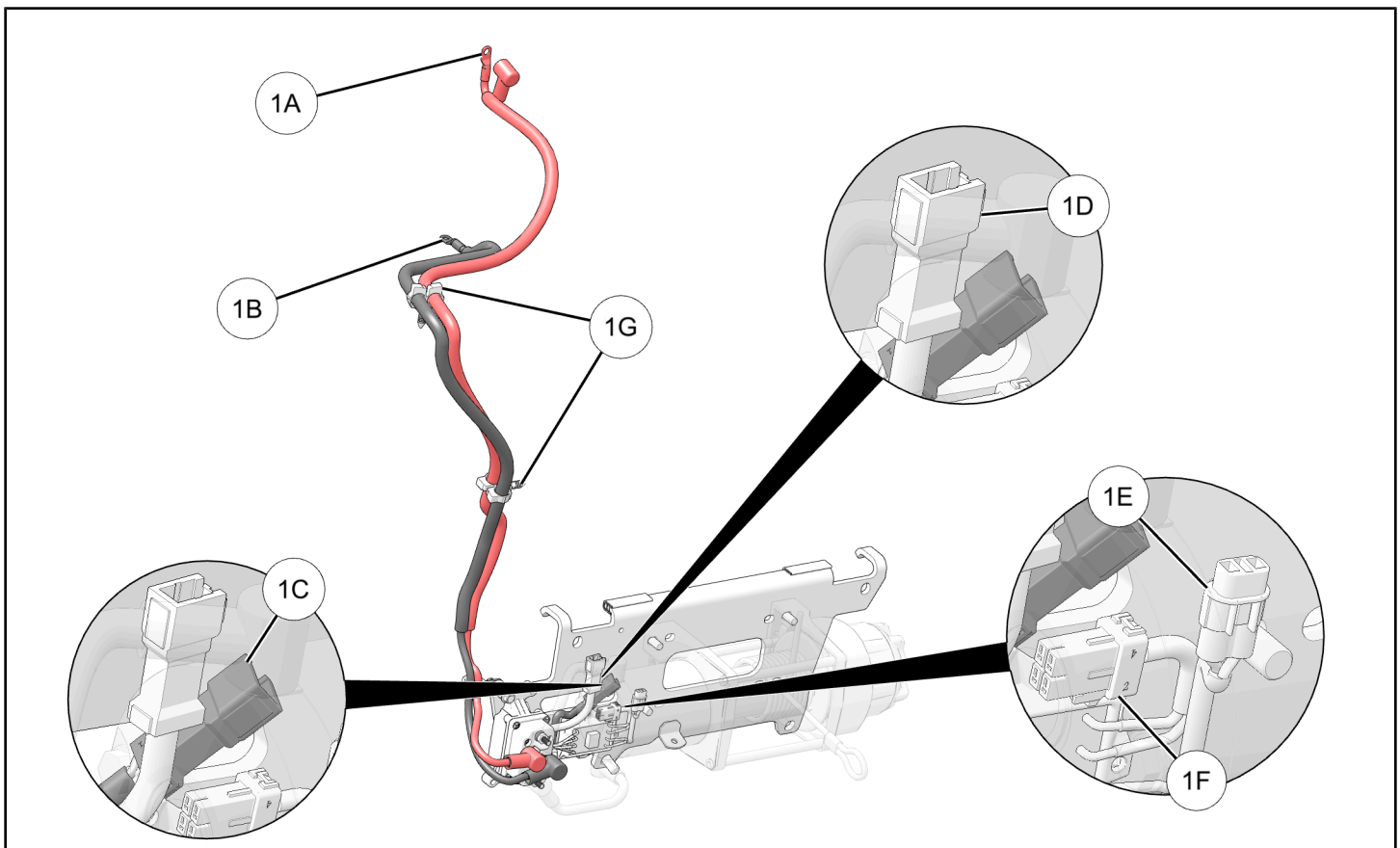

REF	PART DESCRIPTION	CONNECTS TO
1A	Terminal Ring, Positive (+), 1F	Battery Terminal Block, Positive (+)
1B	Terminal Ring, Negative (-), 1F	Chassis Ground, Negative (-)
1C	Winch Remote Connector, 4M	Chassis Harness Connector ①
1D	Winch Controller/Contactor Connector, 4M	Pre-connected to 1F
1E	Autostop Fairlead Connector, 2F	Autostop Fairlead Connector 4A
1F	Winch Controller/Contactor Connector, 4F	Pre-connected to 1D
1G	Routing Clip	Vehicle

Example: 16F = 16 pin, Female / 16M = 16 pin, Male (Male terminal fits inside female terminal)

AUTO STOP FAIRLEAD HARNESS ④

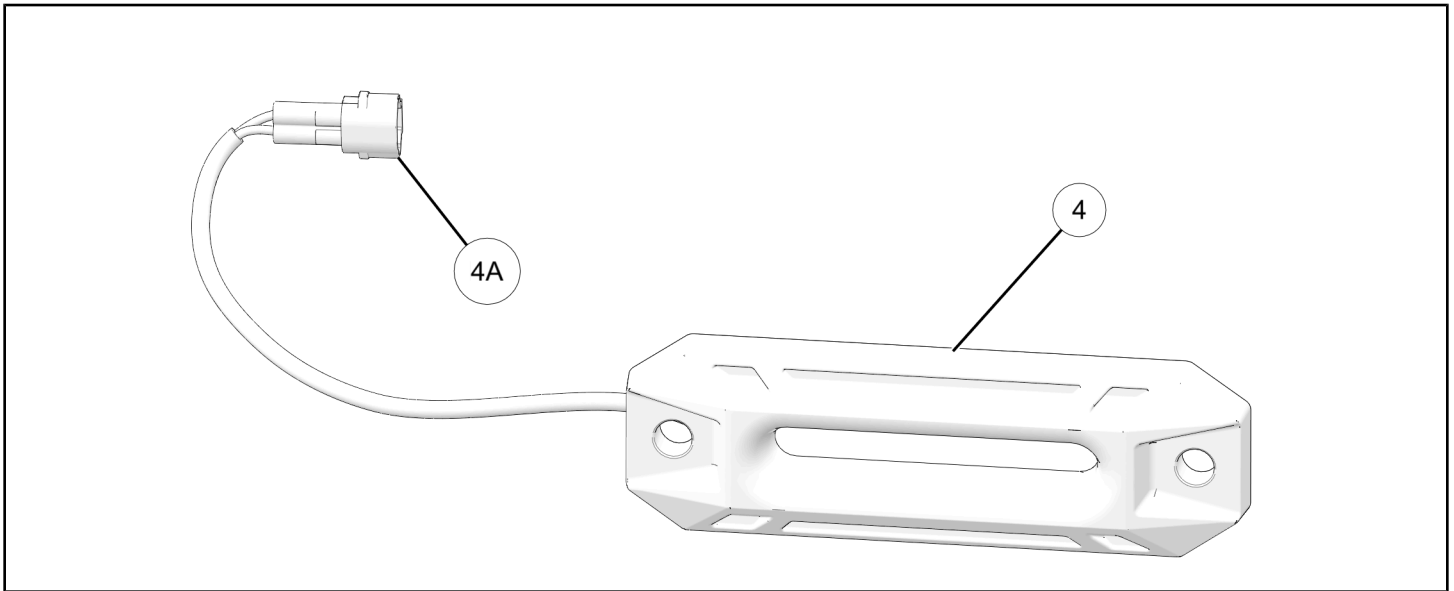

REF	PART DESCRIPTION	CONNECTS TO
4A	Autostop Fairlead Connector, 2M	Autostop Fairlead Connector 1E
Example: 16F = 16 pin, Female / 16M = 16 pin, Male (Male terminal fits inside female terminal)		

WIRELESS RECEIVER HARNESS ⑭

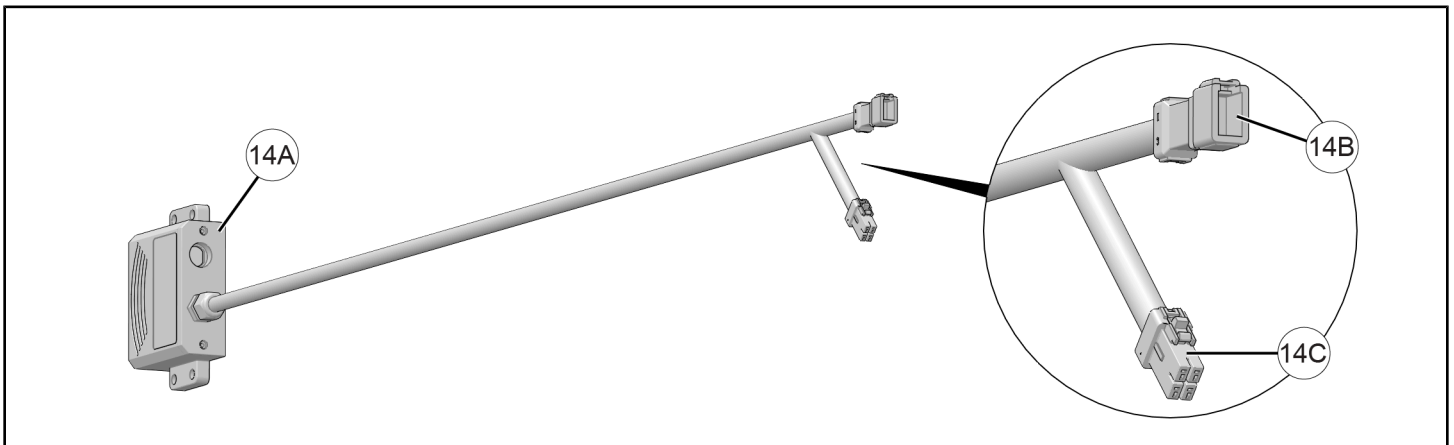

REF	PART DESCRIPTION	CONNECTS TO
14A	Wireless Receiver	Vehicle Structure
14B	Winch Controller/Contactor Connector, 4M	Vehicle Harness Breakout Connector (M)
14C	Wired Remote Connector, 4F	Winch Jumper Harness (12)
Example: 16F = 16 pin, Female / 16M = 16 pin, Male (Male terminal fits inside female terminal)		

TOOLS REQUIRED

- Safety Glasses
- Drill
- Drill Bit:
 - 1/8 in (3 mm)
- Pliers, Push Pin Rivet
- Socket Set, Metric
- Socket Set, Torx® Bit

- Torque Wrench

- Wrench Set, Metric

IMPORTANT

Your Ranger Full-Size Winch Kit is exclusively designed for your vehicle. Please read the installation instructions thoroughly before beginning. Installation is easier if the vehicle is clean and free of debris. For your safety, and to ensure a satisfactory installation, perform all installation steps correctly in the sequence shown.

INSTALLATION INSTRUCTIONS

VEHICLE PREPARATION

GENERAL

1. Park vehicle on a flat surface.
2. Shift vehicle into PARK.
3. Turn key to OFF position and remove key.

HOOD REMOVAL

1. Turn two quarter-turn fasteners to unlock and remove hood from vehicle.

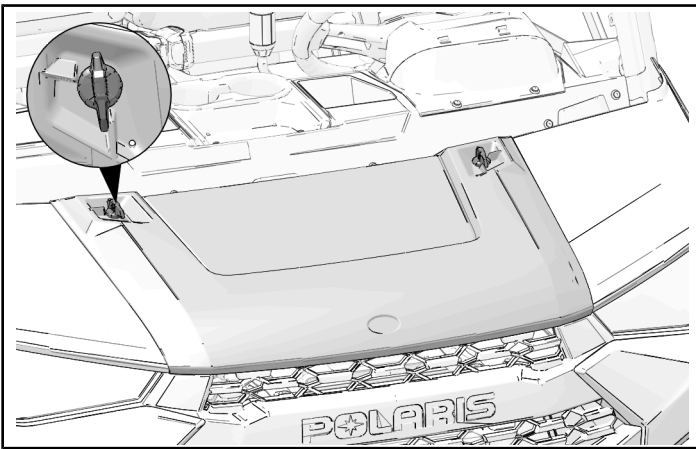

GRILLE REMOVAL

1. Push two tabs down to remove grille.

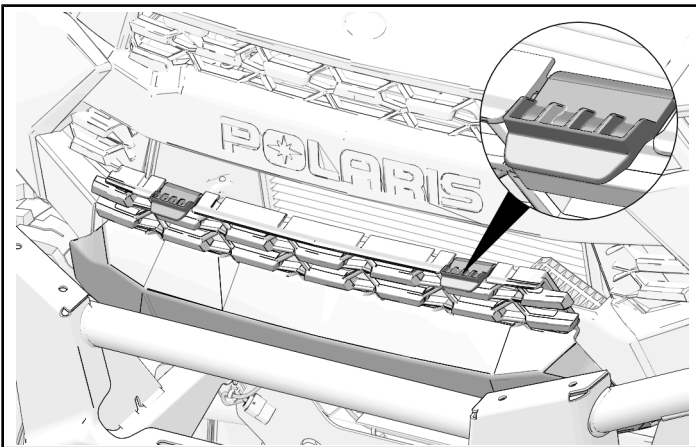

FRONT BUMPER REMOVAL

NOTICE

Front brushguard bumper shown; other bumpers similar.

CAUTION

Front bumper weighs approximately 38 lbs. (17 kg). Provide adequate support for bumper before removing final screws. Failure to provide adequate support may result in personal injury or damage to bumper.

1. Remove and keep two nuts and two screws from the bottom of the front bumper.

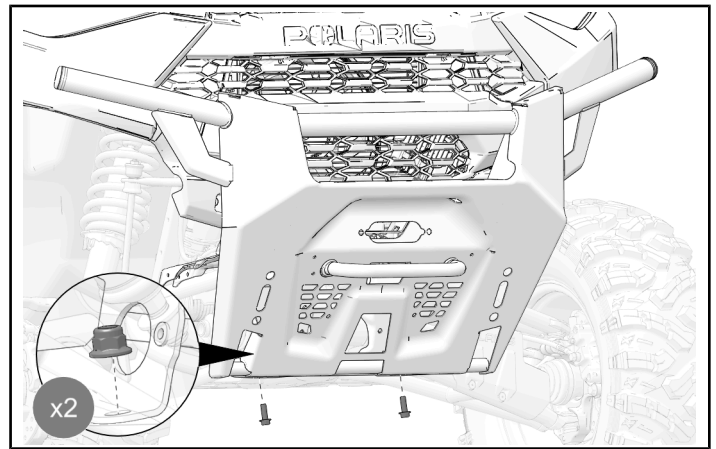

2. Remove and keep two nuts and two screws from front bumper support bracket.

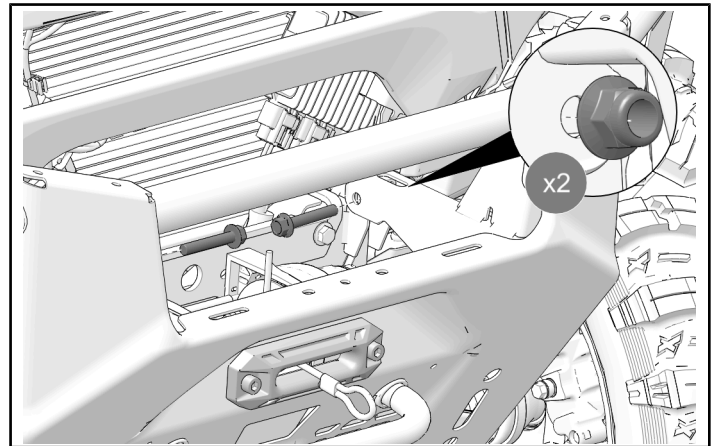

RANGER 1000 MODEL VEHICLES

BATTERY DISCONNECT

NOTICE

Ranger 1000 3-passenger: Battery is located under passenger seat. Ranger 1000 Crew: Battery is located under rear passenger seat.

⚠ WARNING

Make sure red positive (+) battery terminal is **COMPLETELY COVERED** by protective boot. Accidental tool contact across both battery terminals will result in high current electrical arc, and may result in battery explosion. Death or serious injury may occur.

1. Lift up passenger seat.



2. Remove bin and set aside.

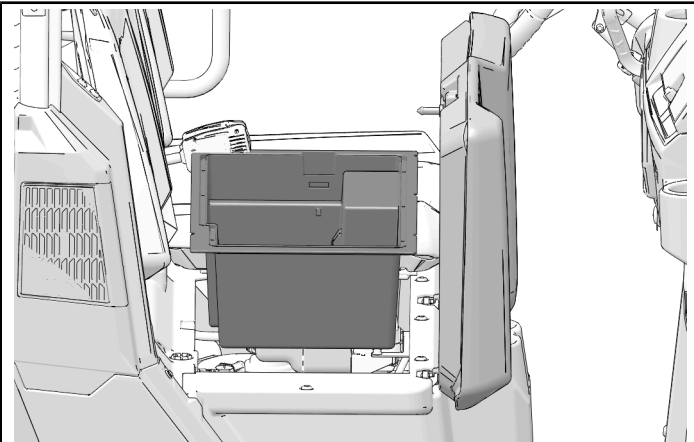

3. Loosen nut on negative (-) wire and remove wire from battery.

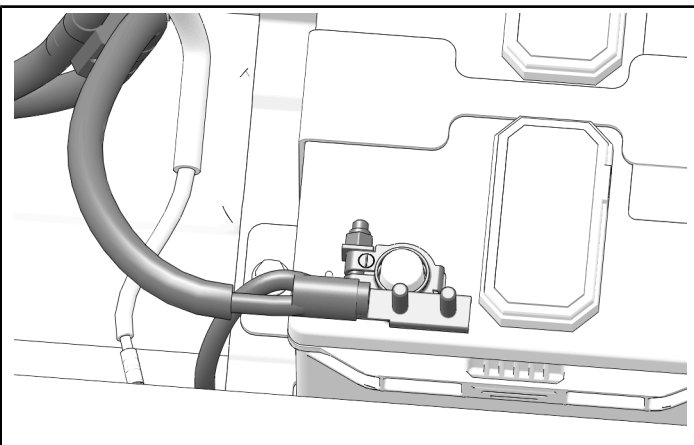

UPPER DASH REMOVAL

1. Remove two push-pin rivets **Ⓐ** from upper dash cupholder. Move cupholder forward to remove from dash.

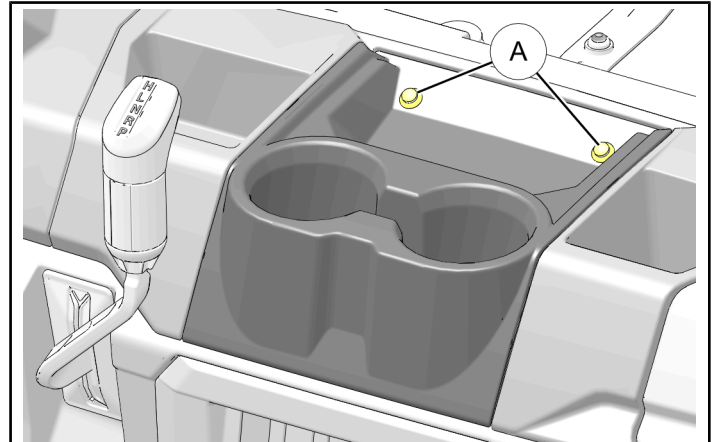

2. Remove six push-pin rivets **Ⓑ** along forward edge of dash.

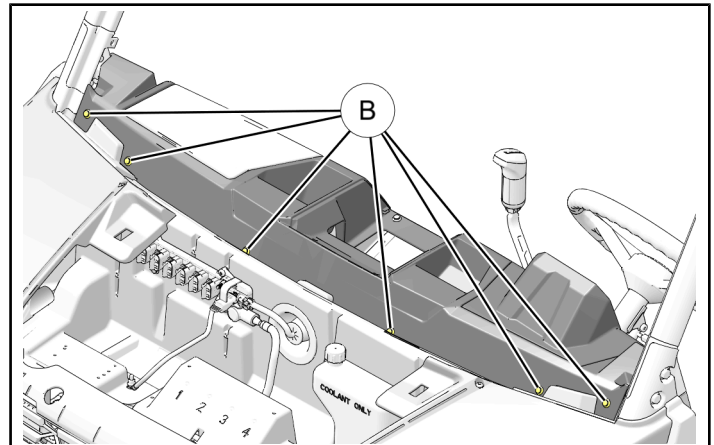

3. Remove five push-pin rivets **Ⓒ** from left side of dash: two at center cupholder, two below instrument cluster, and one on underside of dash above cupholder.

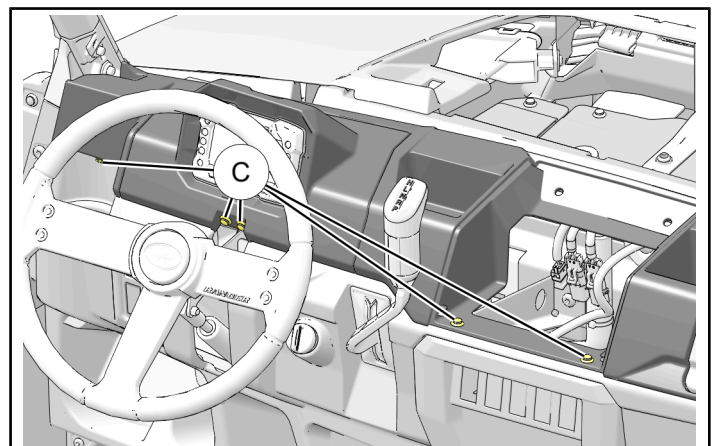

- Open door to upper storage compartment. Remove three push-pin rivets (D) from right side of dash: two inside storage compartment and one on underside of dash above cupholder.

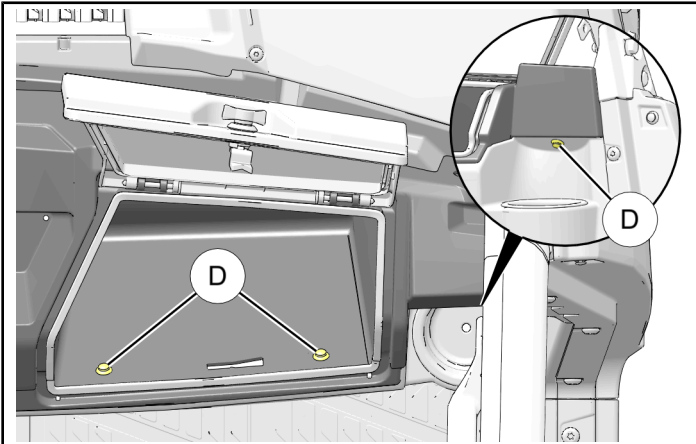

- Move upper dash (with instrument cluster) backwards, then disconnect instrument cluster wiring harness.

RANGER XP 1000 MODEL VEHICLES

BATTERY DISCONNECTION

NOTICE

Ranger XP 1000 3-passenger: Battery is located under passenger seat. Ranger XP 1000 Crew: Battery is located under rear right seat.

⚠ WARNING

Make sure red positive (+) battery terminal is **COMPLETELY COVERED** by protective boot. Accidental tool contact across both battery terminals will result in high current electrical arc, and may result in battery explosion. Death or serious injury may occur.

- Lift up passenger seat.

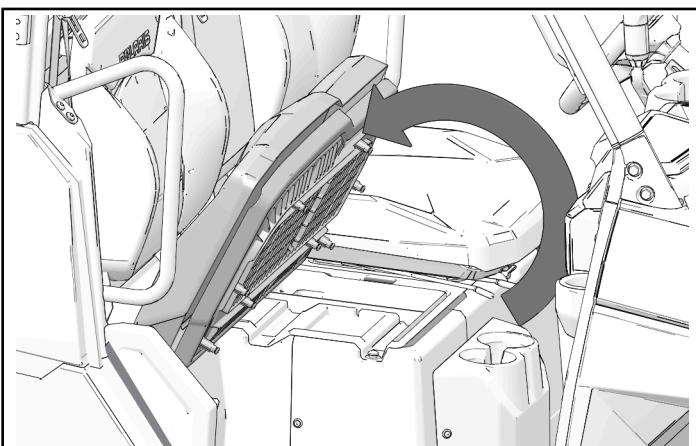

- Remove bin and set aside.

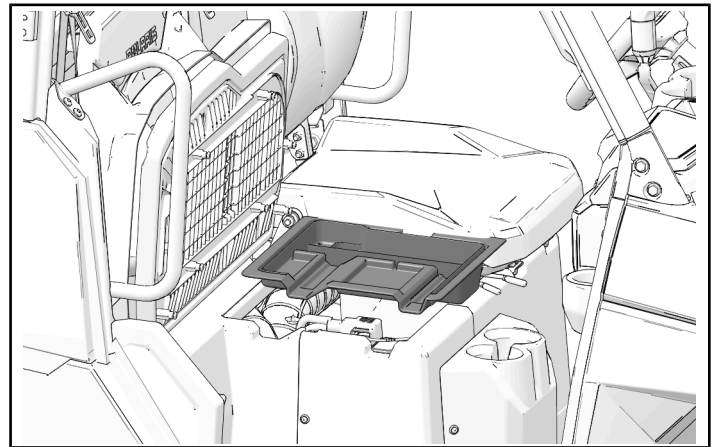

- Loosen nut on negative (-) wire and remove wire from battery.

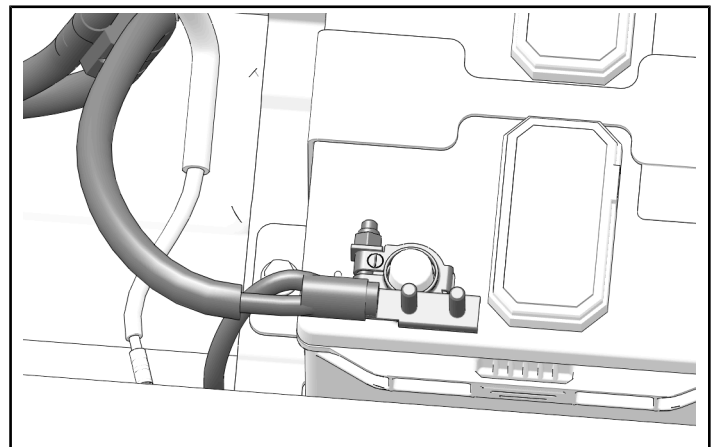

INSTRUMENT CLUSTER REMOVAL

- Tilt steering wheel to full down position.

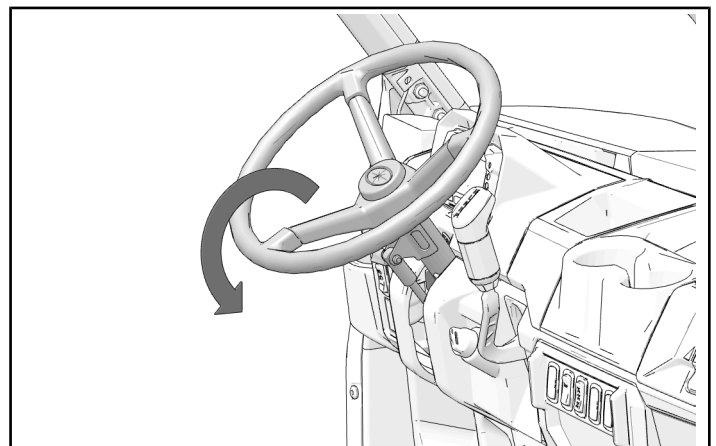

2. Remove two push-pin rivets from instrument cluster bezel.

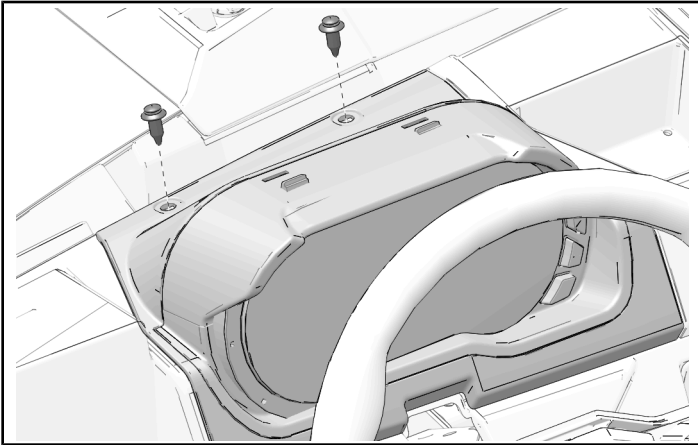

3. Remove the instrument cluster by pulling straight out towards the steering wheel.

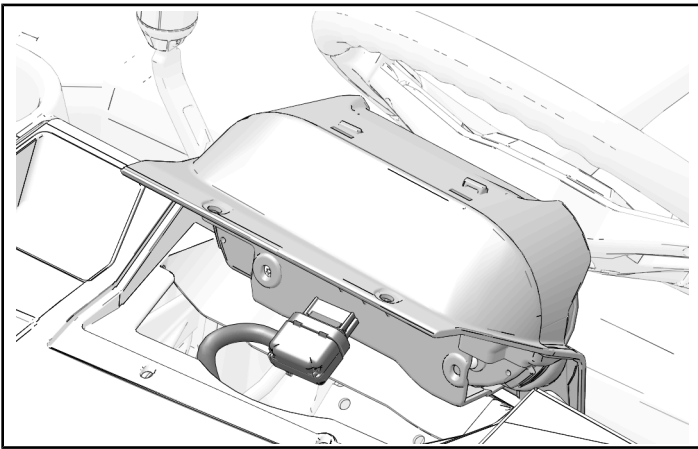

4. Disconnect instrument cluster from chassis harness.

CUP HOLDER REMOVAL (IF EQUIPPED)

1. Remove two push-pin rivets from cup holder.

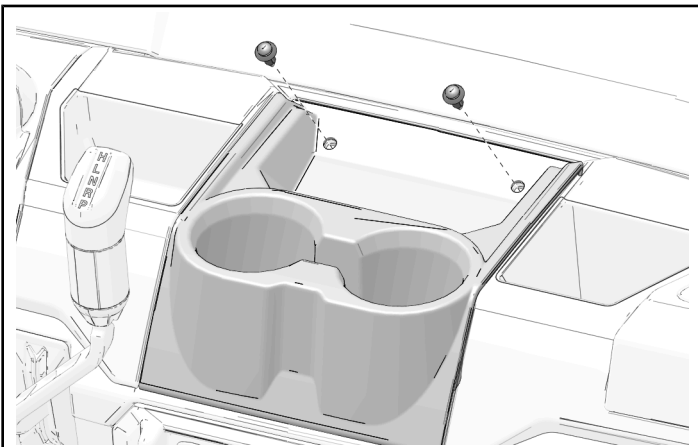

2. Remove cup holder from dashboard.

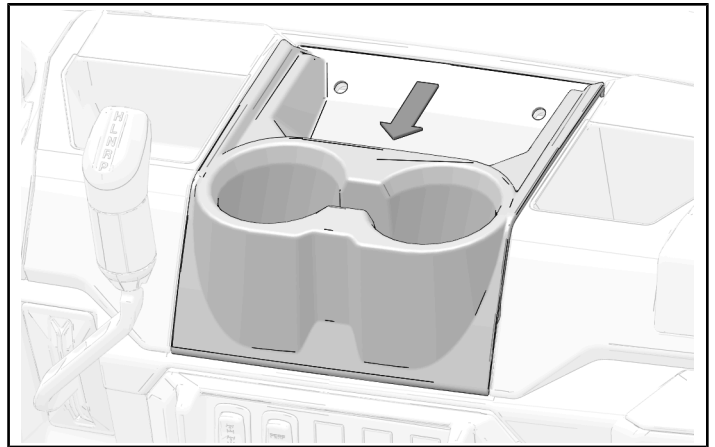

DASHBOARD STORAGE REMOVAL

1. Open dashboard storage compartment.
2. Remove and keep four screws from inside storage compartment.

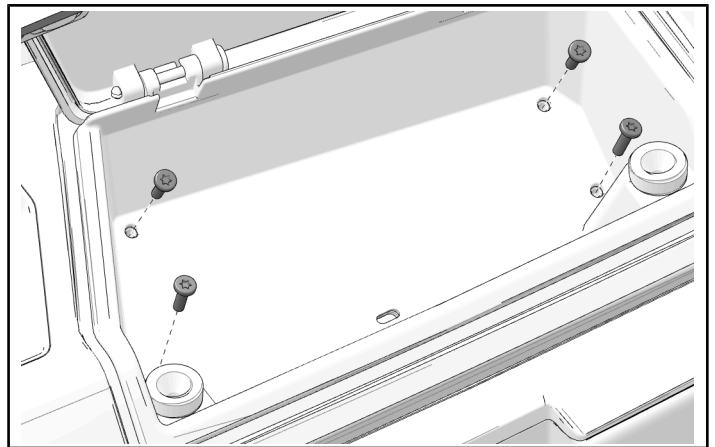

3. Remove storage compartment from dashboard.

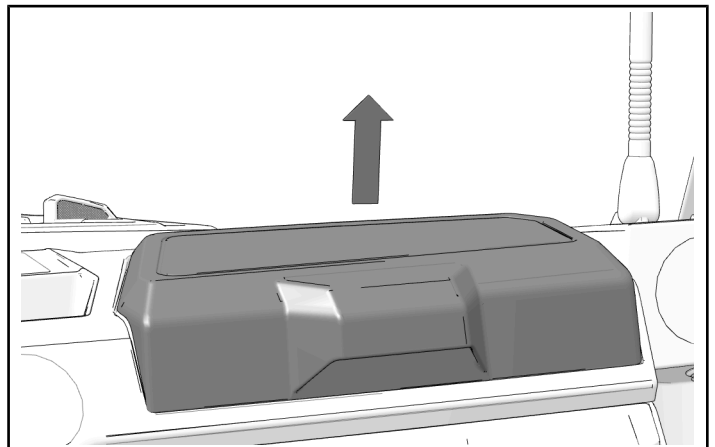

UPPER DASHBOARD REMOVAL

1. Remove and keep one push-pin rivet from top of driver side cup holder.

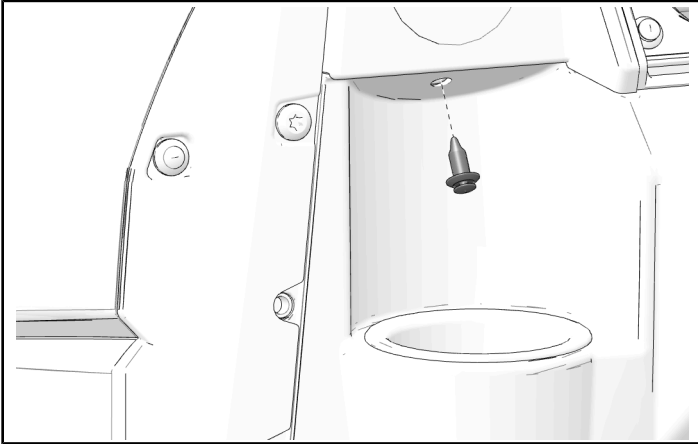

2. Remove and keep one push-pin rivet from top of passenger side cup holder.

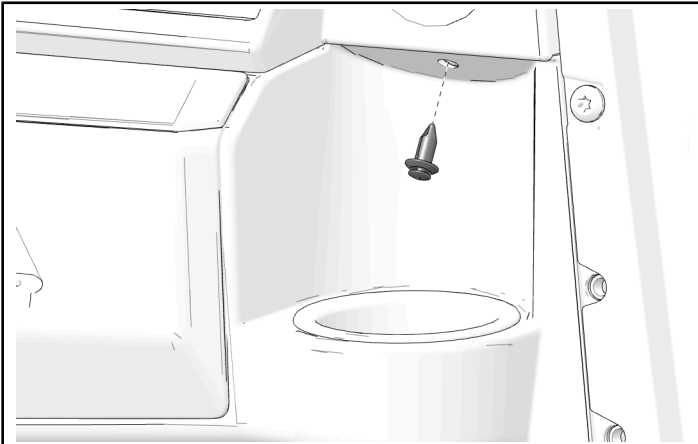

3. Remove and keep two push-pin rivets from upper storage compartment area.

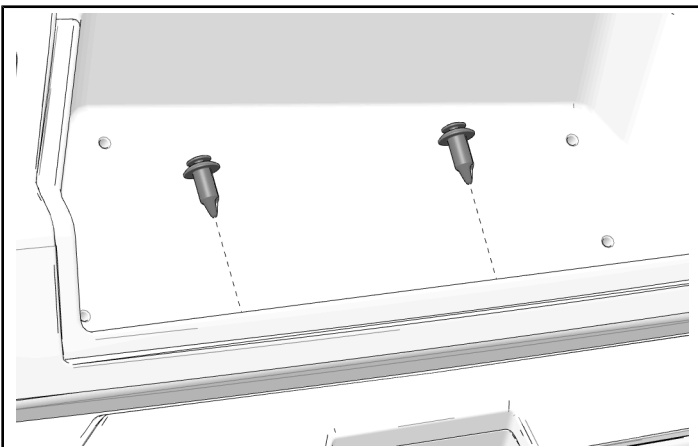

4. Remove and keep two push-pin rivets from center cup holder.

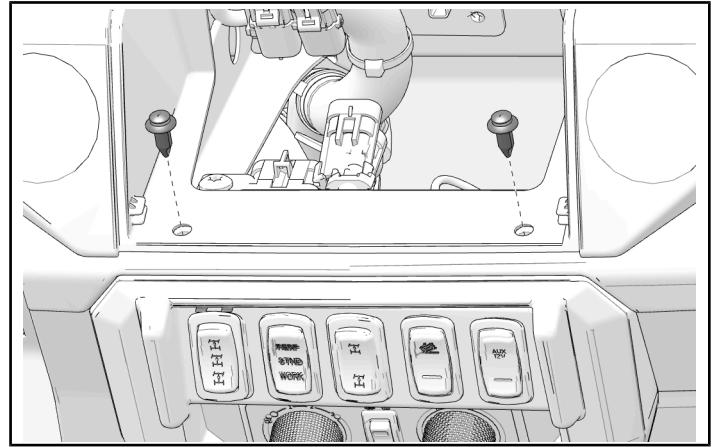

5. Remove and keep two push-pin rivets from instrument cluster opening.

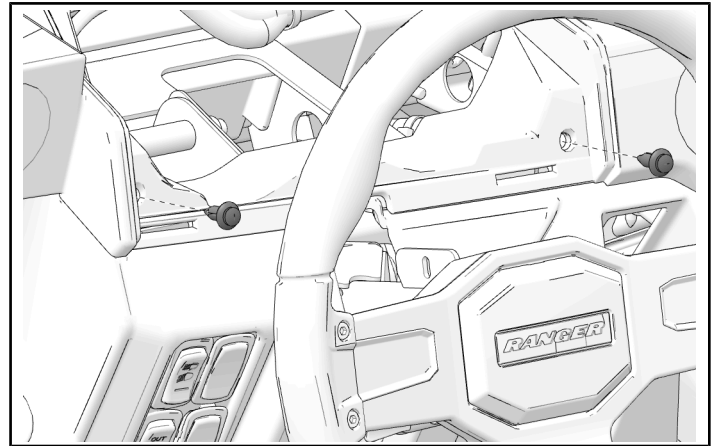

6. Remove and keep six screws from front of upper dash.

NOTICE

MY 2022 and older will have six push-pin rivets instead of six screws.

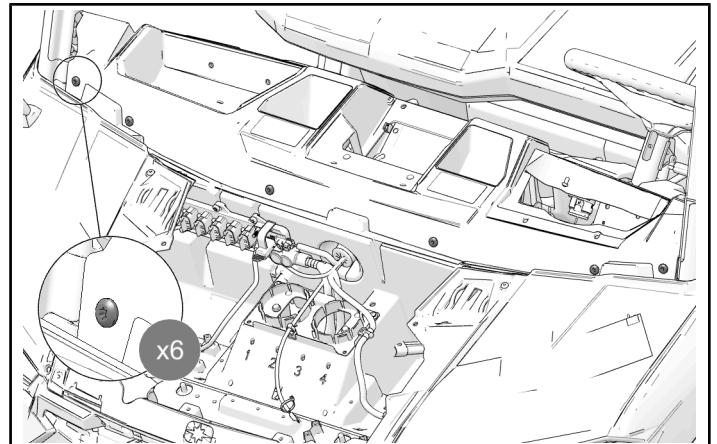

7. Remove upper dash and set aside.

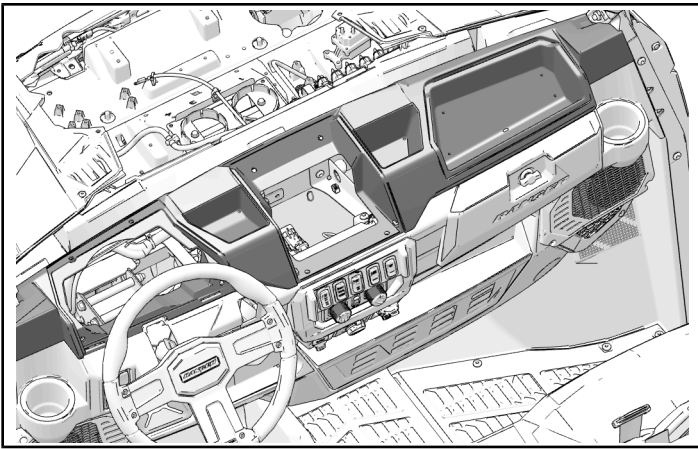

ACCESSORY INSTALLATION

AUTOSTOP FAIRLEAD INSTALLATION

1. Route fairlead harness ④ through groove in bumper.

NOTICE

Rear facing side of bumper shown.

• MY 2024 and older:

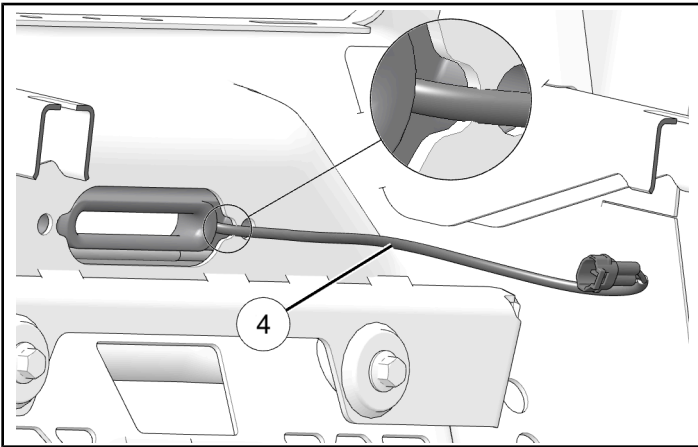

• MY 2025 and newer:

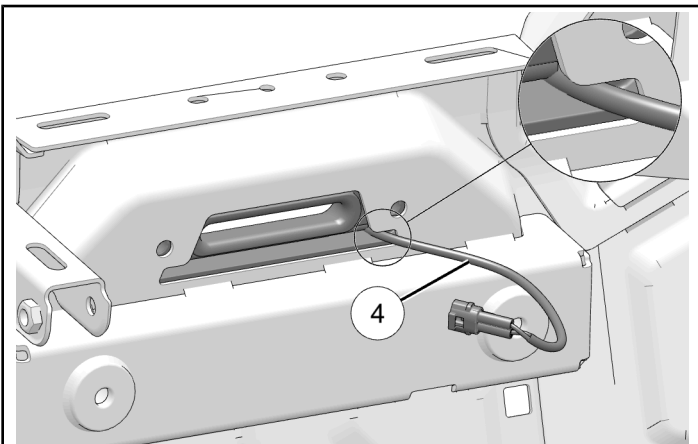

2. Install autostop fairlead ④ and fairlead backer plate ③ to bumper using two screws ⑤.

TIP

Make sure fairlead harness routes through cutout in bumper and is not pinched when fairlead is tightened.

IMPORTANT

Make sure the autostop fairlead is installed with the harness exiting on the right side of the bumper, as shown.

• MY 2024 and older:

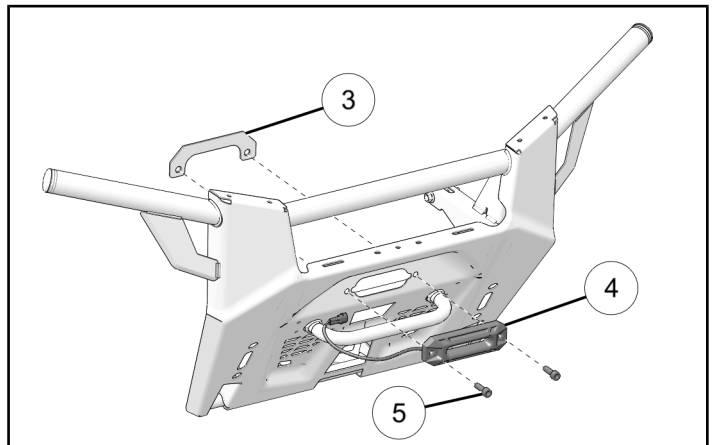
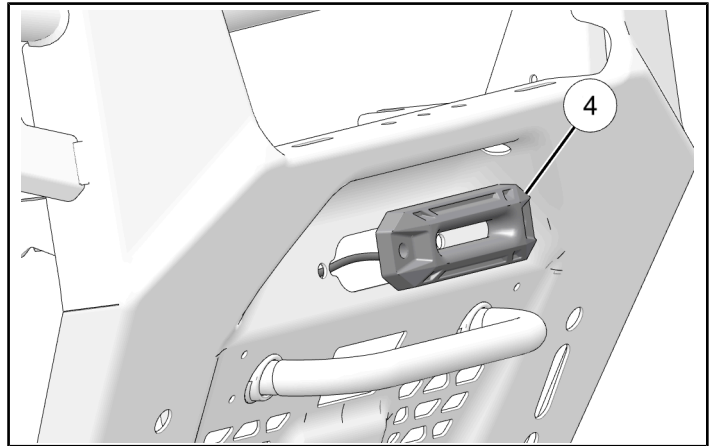

- MY 2025 and newer:

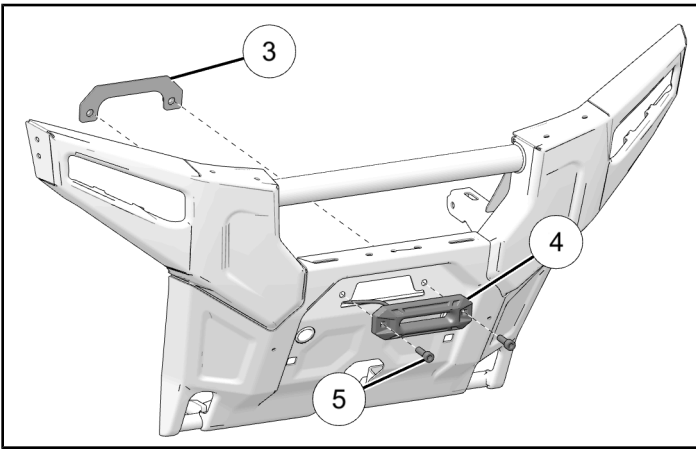
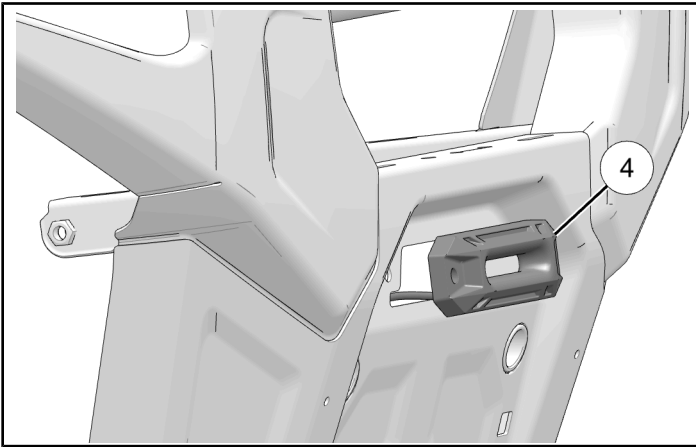

3. Hand tighten screws and set bumper aside.

WINCH INSTALLATION

1. Install rear hooks on winch assembly ① to vehicle front support structure.

NOTICE
Center winch between two bumper support brackets ④, as shown.

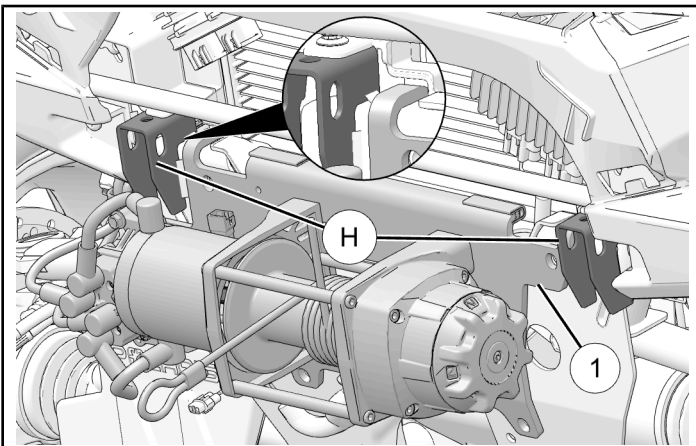

2. Loosely install two screws ② through upper holes on winch into vehicle front support structure.

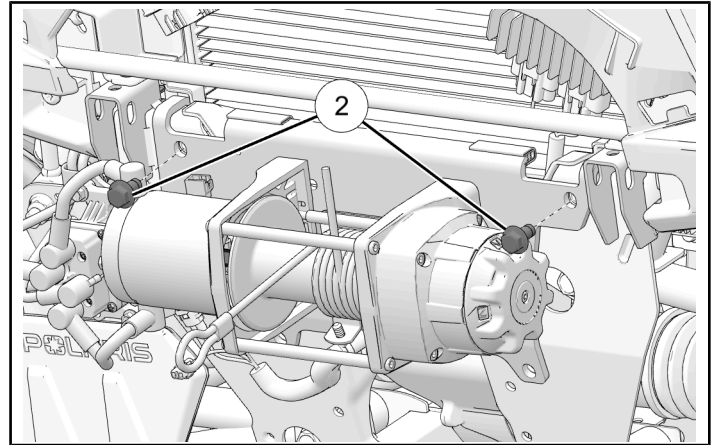

3. Loosely install two screws ⑩ and two nuts ⑨ through lower holes on winch into vehicle front support structure.

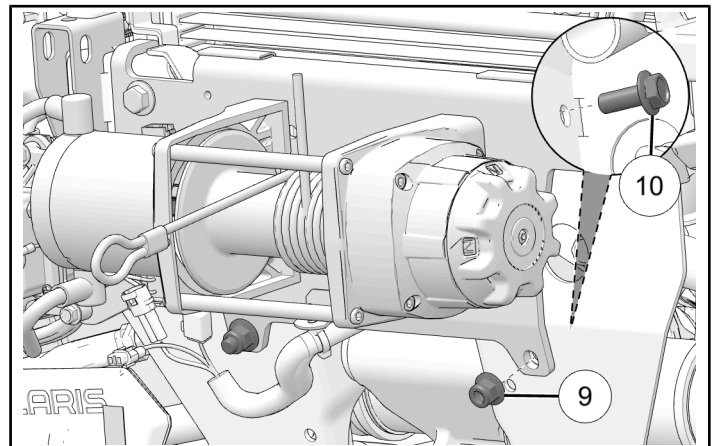

4. Torque screws ② and nuts ⑨ to specification.

TORQUE
Winch Screws ②: 40 ft-lbs (54 N·m)

TORQUE
Winch Nuts ⑨: 40 ft-lbs (54 N·m)

WINCH HARNESS INSTALLATION

NOTICE
Parts of vehicle have been hidden for clarity.

1. Route positive (+), **1A**, and negative (-), **1B**, winch harness cables up from winch ①, (not shown), through cut-out in under-hood liner.

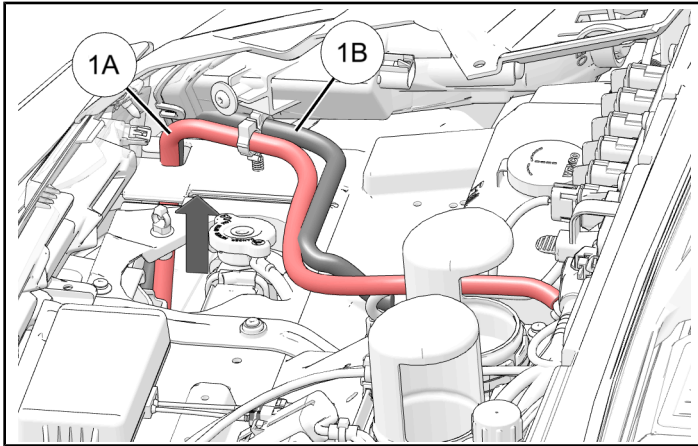

2. Attach winch harness cables to vehicle with lower routing clip **1G**.

NOTICE

If vehicle does not have attachment points for routing clips, use cable ties to attach the harness to the chassis bar. Make sure to keep all electrical harnesses away from moving parts.

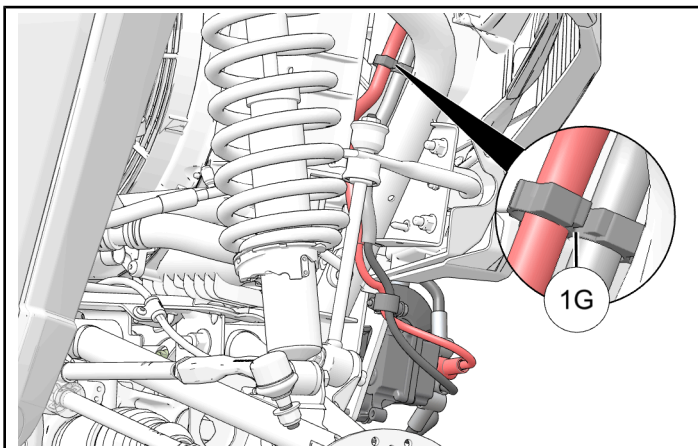

3. Install terminal ring **1A** on winch harness to positive (+) connection on pulse bar with nut **15**.

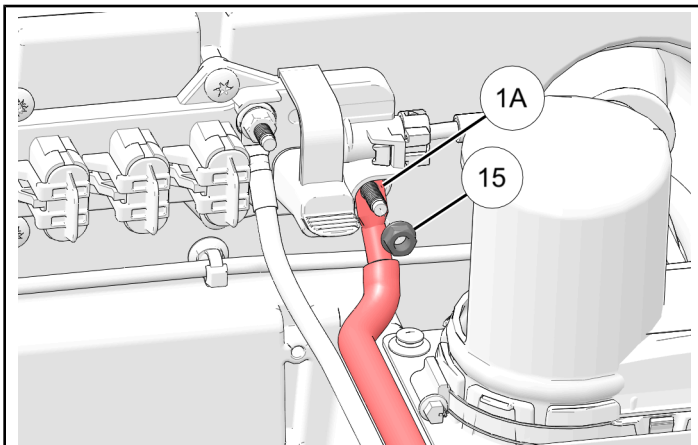

4. Torque nut to specification and install boot.

TORQUE

Positive (+) Battery Cable Nut **15**:
30 in-lbs (3.4 N·m)

NOTICE

If two cable boots exist for same terminal, then slide inner boot (closest to terminal block) down cable. Unused boot can remain on cable.

5. Install terminal ring **1B** on winch harness to negative (-) chassis ground on vehicle with nut **15**.

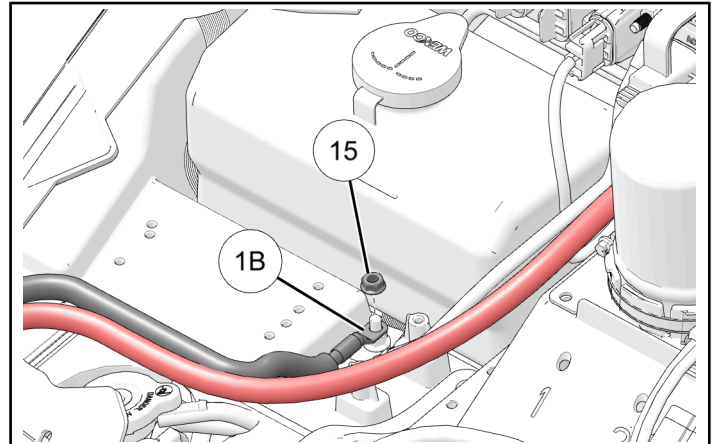

6. Torque nut to specification.

TORQUE

Negative (-) Battery Cable Nut **15**:
8 ft-lbs (6 N·m)

7. Attach winch harness cables to under-hood panel with upper routing clip **1G**.

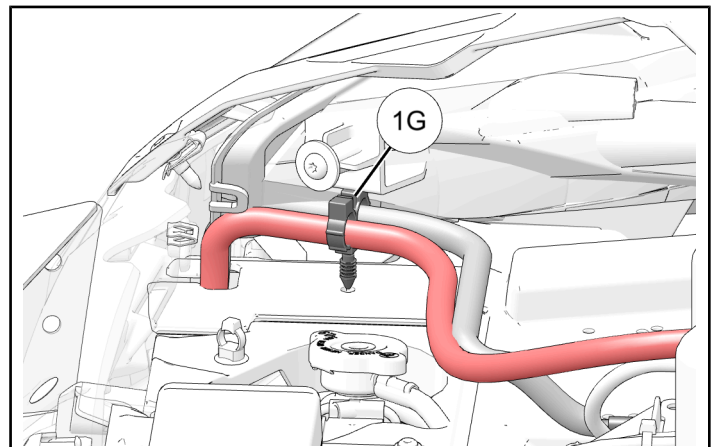

8. Route chassis harness through harness routing tab on winch bracket.

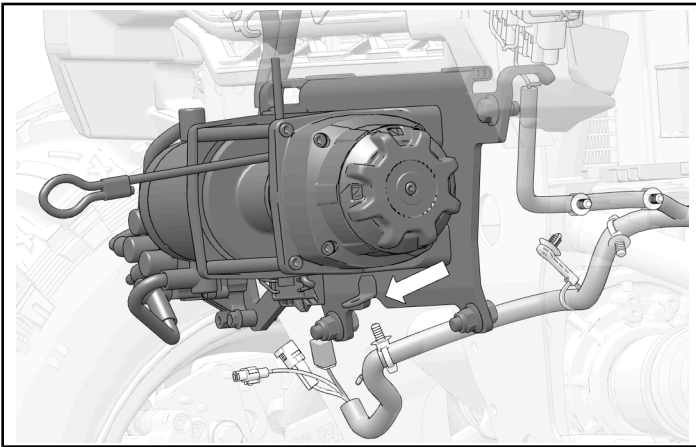

9. Remove and discard cap from chassis harness connector **L**. Connect winch connector **1C** to chassis harness connector **L**.

NOTICE

Parts of vehicle and winch motor have been hidden for clarity.

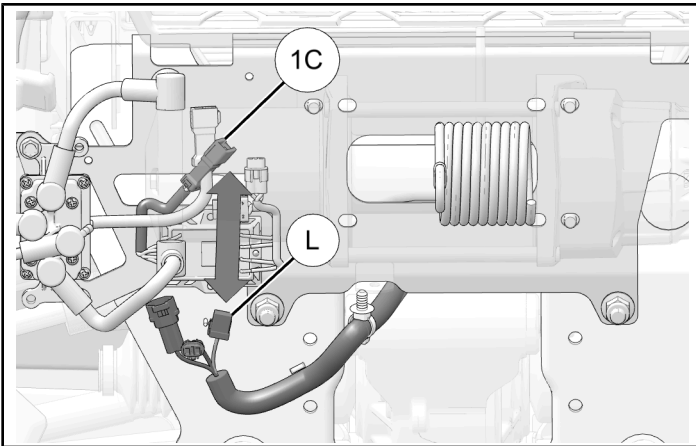

10. Install fir tree clip on chassis harness to winch bracket.

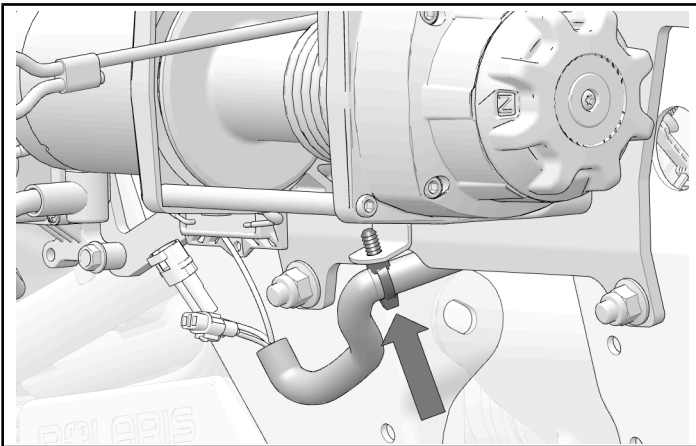

11. Install wireless receiver **14** to under-hood panel using four screws **13**. Tighten screws until fully seated.

Do not over-tighten screws.

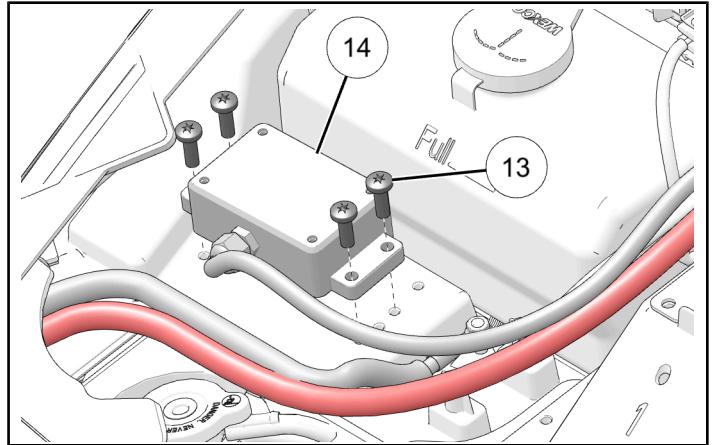

12. Route wireless receiver **14** connectors **14B** and **14C** rearward through firewall grommet into upper dash compartment.

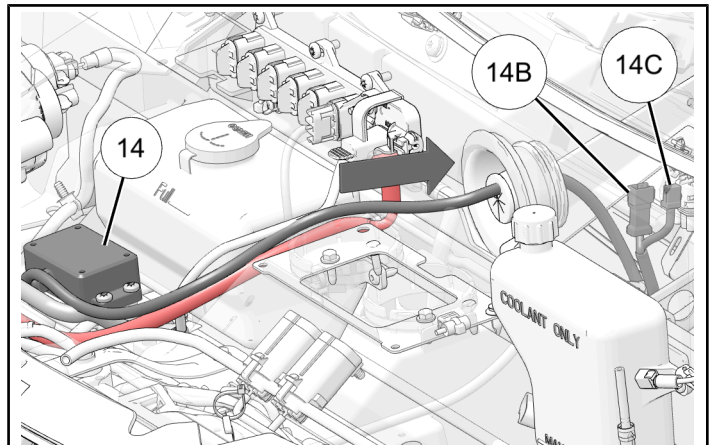

13. Remove and discard cap from winch connector on vehicle harness **M**. Connect wireless receiver connector **14B** to winch connector **M**.

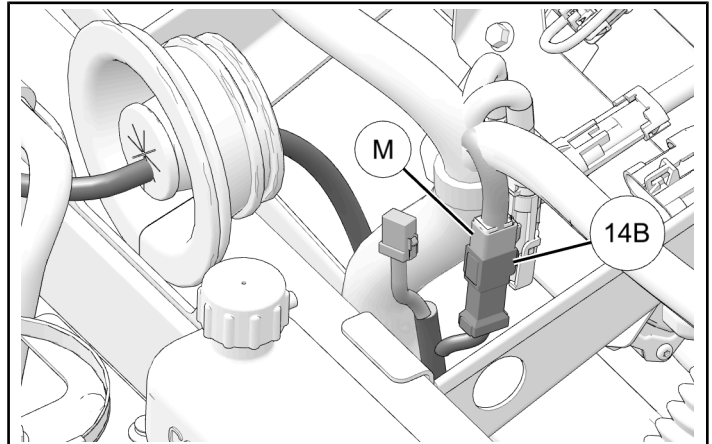

WINCH SWITCH HARNESS INSTALLATION

1. Disconnect winch switch ⑪ from the jumper harness ⑫ and set aside.

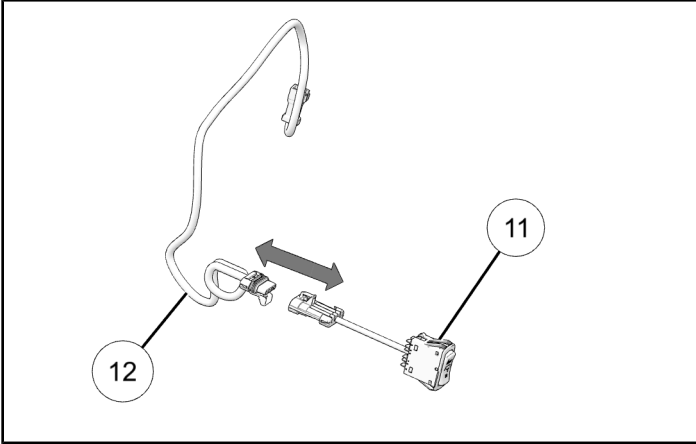

2. Cut out one of the blank switch locations in the dash.

NOTICE

Blank switch locations may vary based on vehicle options. Any unused switch blank located left of the steering wheel may be used.

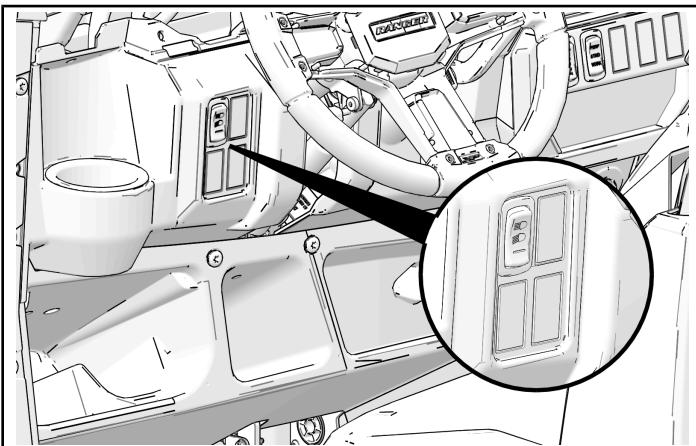

3. Pull the jumper harness connector ⑫ through the dash cutout and connect to the winch switch ⑪. Make sure the connector is fully seated into the switch.

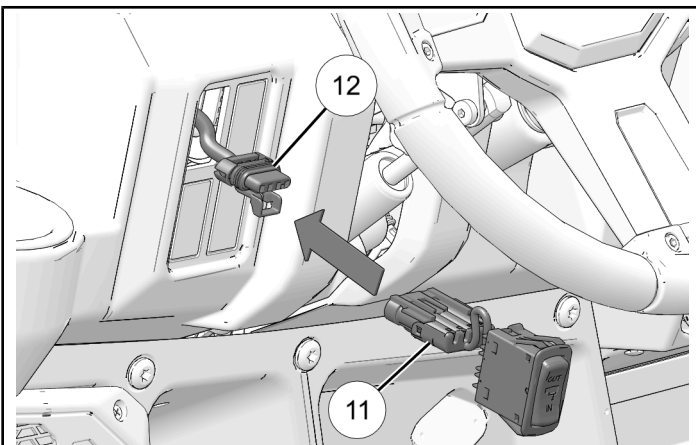

4. Push the switch into the dash cutout until fully seated.

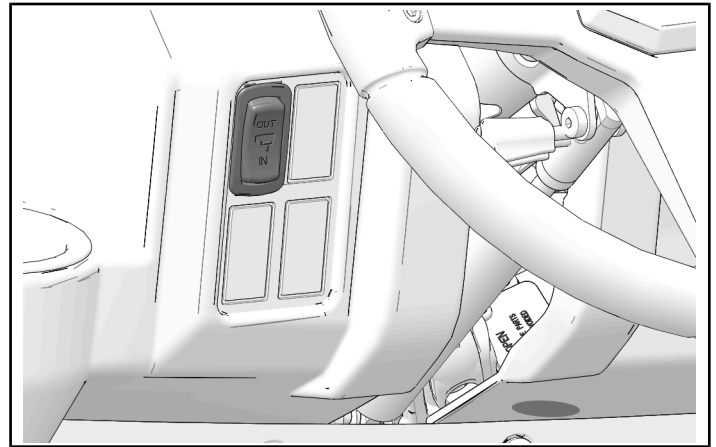

5. Route jumper harness ⑫ along underside up upper dash towards the cupholder.

NOTICE

Use cable ties to secure harness away from moving parts.

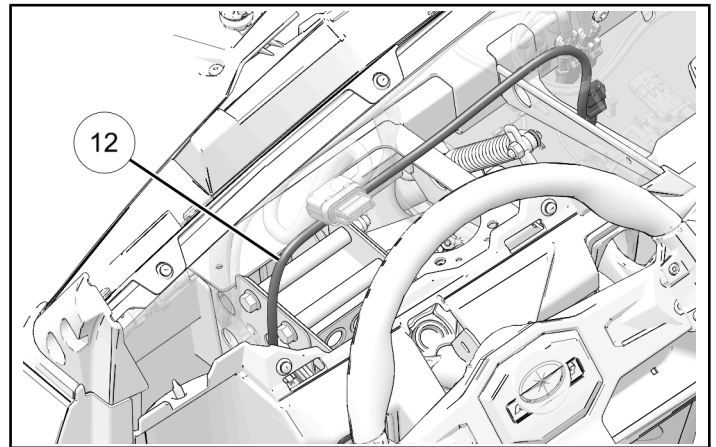

6. Install jumper harness ⑫ to connector 14C located on the wireless receiver harness ⑭.

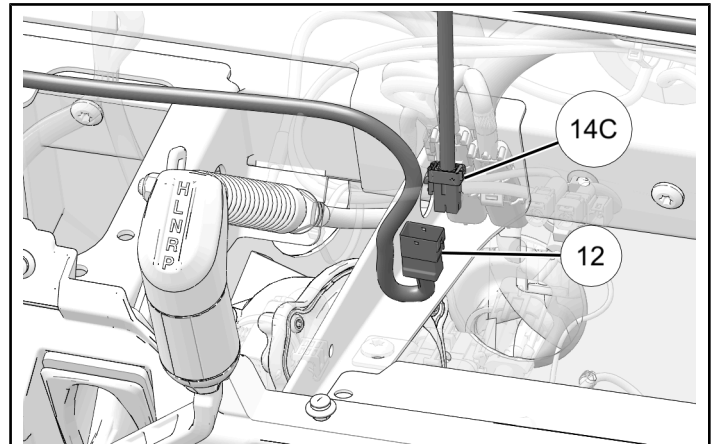

WIRELESS REMOTE INSTALLATION (P/N 2889693 AND P/N 2889694 ONLY)

NOTICE

Installation of wireless remote holder is optional. Wireless remote can be stored in any suitable location. Holder ⑱ is not required.

1. Remove wireless remote ⑰ from holder ⑱. Determine suitable mounting location for holder with special attention to the following:
 - Driver operation of vehicle (including travel of controls, such as shift lever).
 - Driver visibility.
 - Adequate clearance between holder mounting fasteners and other vehicle components on underside of mounting surface.

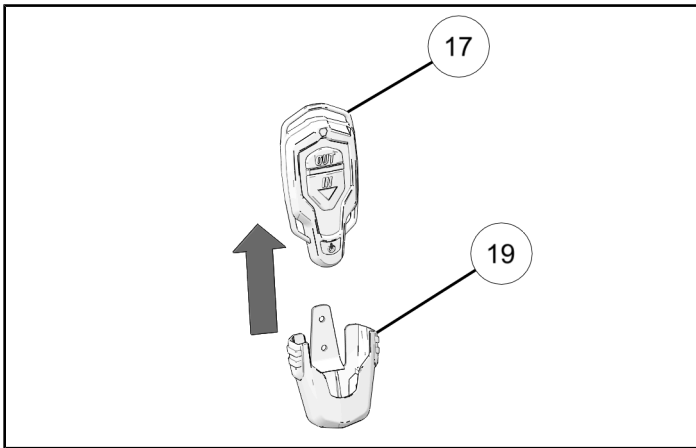

2. Use remote holder ⑱ as a template and mark two holes onto dash surface.

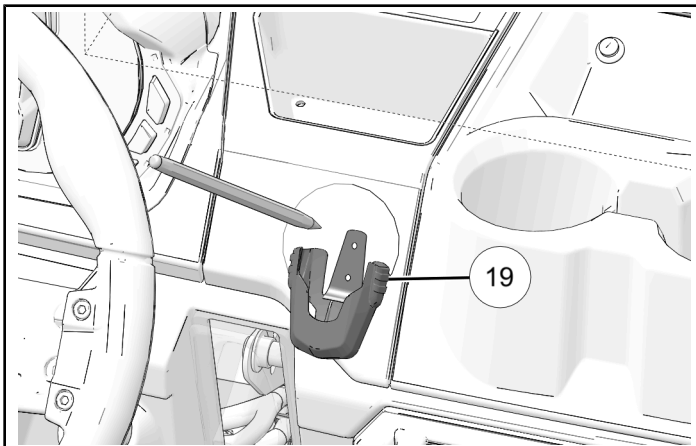

3. Drill two holes into preferred location on dash.

MEASUREMENT

Drill Bit Size:
1/8 in (3 mm)

IMPORTANT

Control drill depth to prevent damage to underlying structure or components.

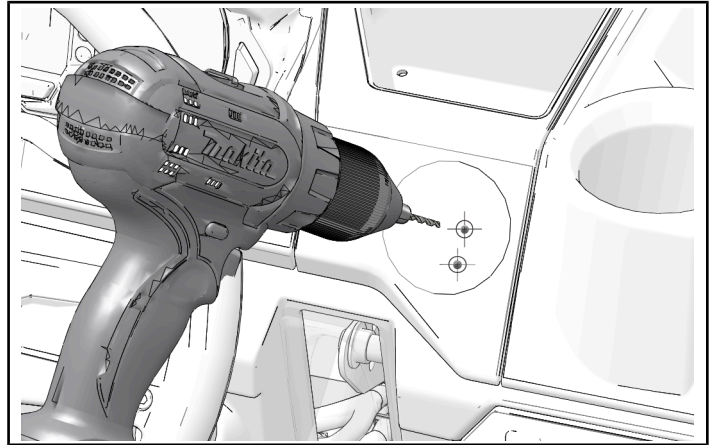

4. Install holder ⑱ to dash with two screws ⑱. Tighten screws until fully seated.

Do not over-tighten screws.

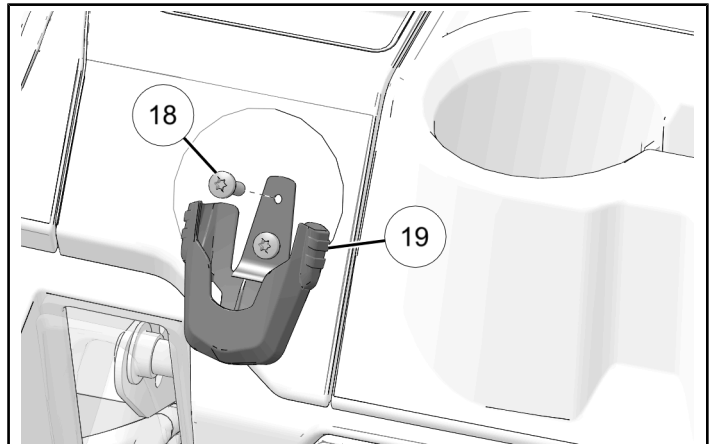

5. Install wireless remote ⑰ into holder.

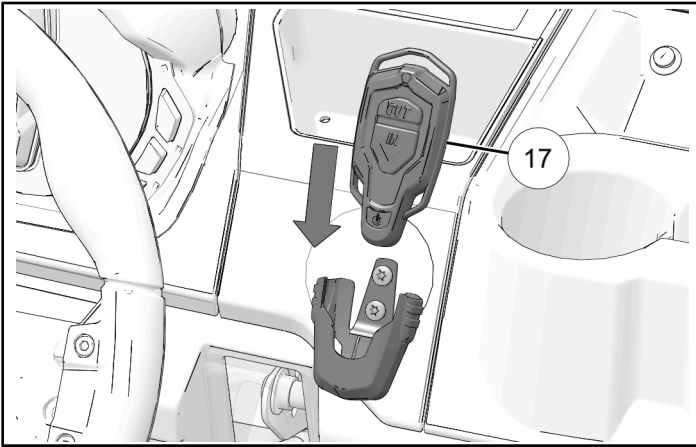

BUMPER INSTALLATION

NOTICE

MY 2024 bumper shown; other bumpers similar.

1. Unwind **BY HAND** several turns of rope from the winch spool. While lifting bumper into position thread loop at end of rope through bumper and fairlead ④.

IMPORTANT

Do **NOT** electrically operate winch at this time.

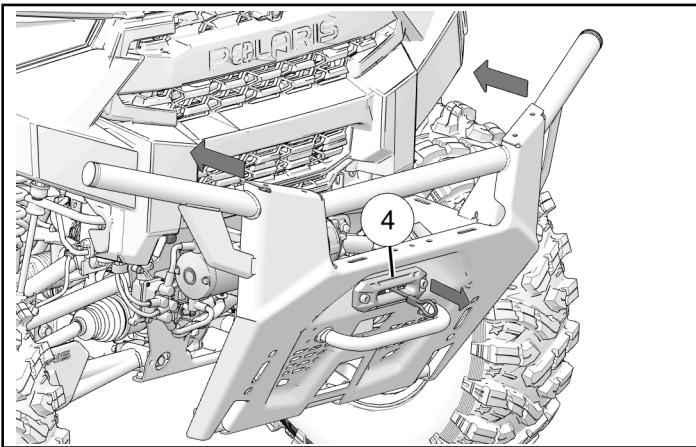

2. Loosely install middle of bumper to vehicle frame using two kept screws and nuts.

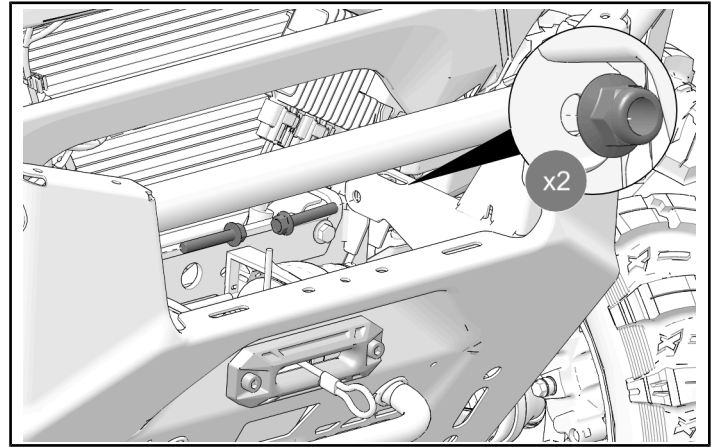

3. Loosely install bottom of bumper to vehicle frame using two kept screws and nuts.

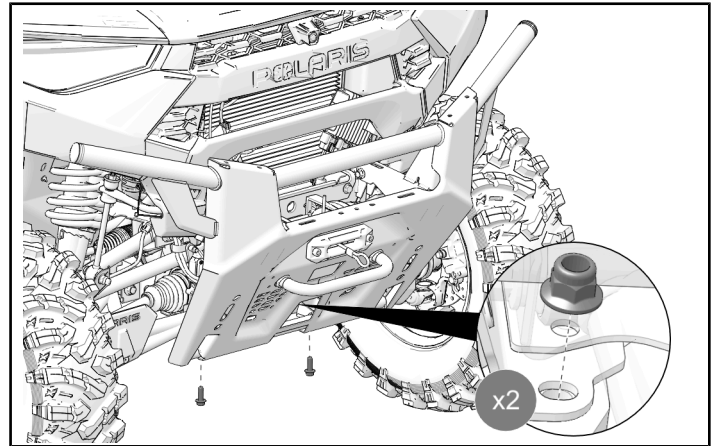

4. Torque fasteners to specification.

TORQUE

Bumper Fasteners:
40 ft-lbs (54 N·m)

LOWER GRILLE INSTALLATION

1. Put bottom of grille in first and push top of grille in until two tabs engage upper front fascia.

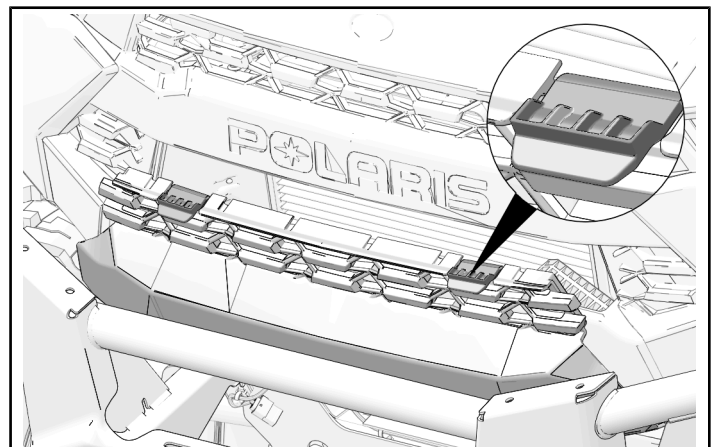

AUTOSTOP FAIRLEAD CONNECTION

NOTICE

Installation of Ride Command® Kit (P/N 2882872, 2884564, or equivalent) may affect some of the following connections. See instructions included with Ride Command® Kit for details.

1. Connect connector **1E** on winch **①** to autostop fairlead connector **4A**.

NOTICE

Winch and front bumper hidden for clarity.

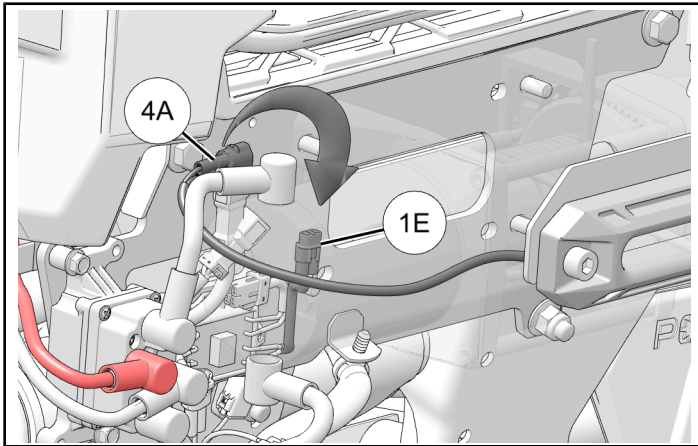

WINCH COMPONENTS INSTALLATION

1. Put loop at end of winch rope through jounce bumper **⑥** and magnetic stop **⑦**. Make sure stop is oriented with WIDE end (with magnet) towards winch, and BEVELED end (with "POLARIS") towards hook.

TIP

Loop a cable tie to end of rope, but do not tighten. Put looped cable tie through jounce bumper and magnetic stop, then pull cable tie and rope through jounce bumper and magnetic stop.

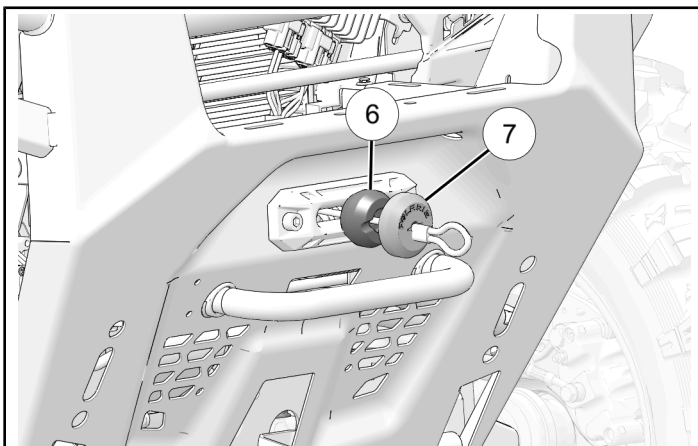

2. Install hook **⑧** to loop at end of rope with clevis and cotter pin. Bend ends of cotter pin around clevis pin.

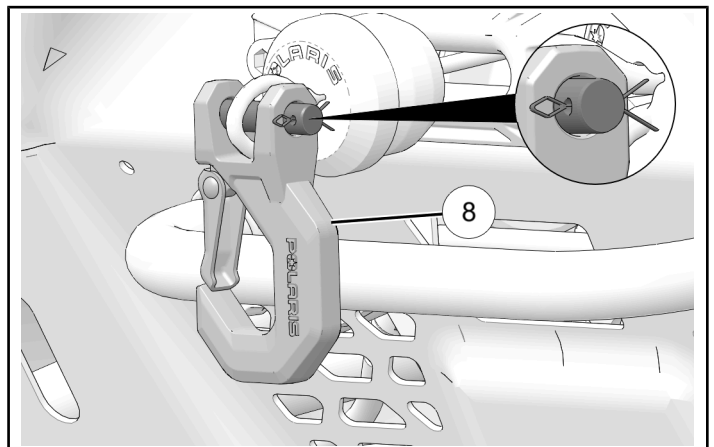
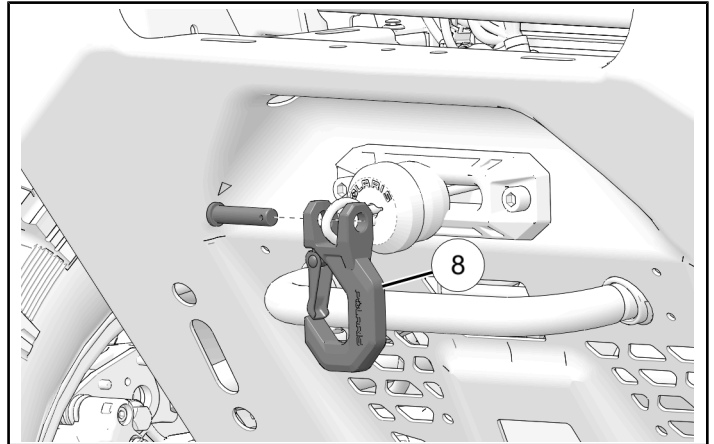

3. Attach all electrical harnesses using cable ties **⑯** as required to prevent contact with hot components, sharp edges, or moving parts.

VEHICLE REASSEMBLY

RANGER 1000 MODEL VEHICLES

UPPER DASH INSTALLATION

1. Move upper dash (with instrument cluster) forward. Connect instrument cluster wiring harness.

- Open door to upper storage compartment. Install three push-pin rivets **D** from right side of dash: two inside storage compartment and one on underside of dash above cupholder.

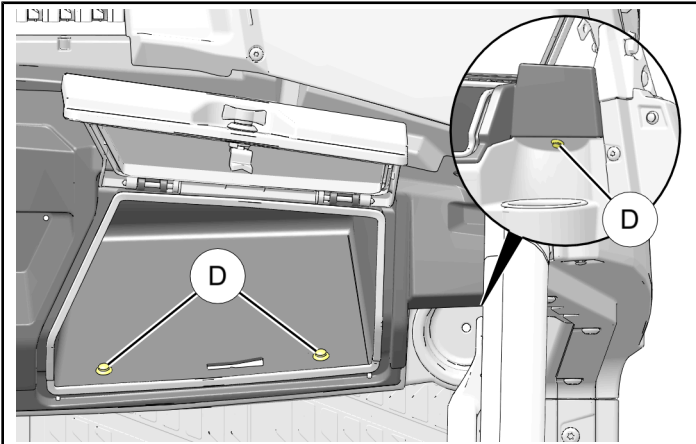

- Install five push-pin rivets **C** to left side of dash: two at center cupholder, two below instrument cluster, and one on underside of dash above cupholder.

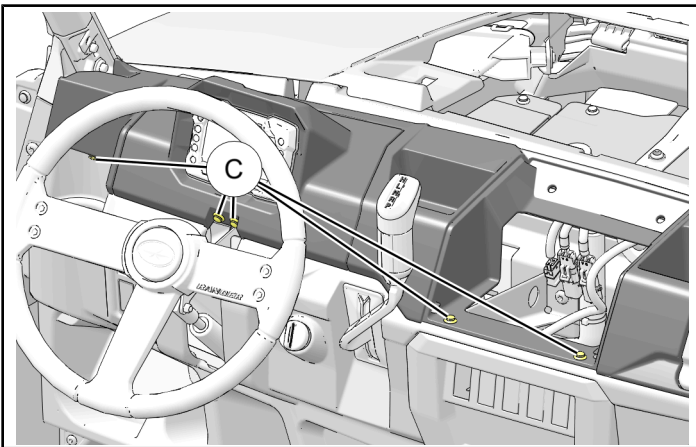

- Install six push-pin rivets **B** into forward edge of dash.

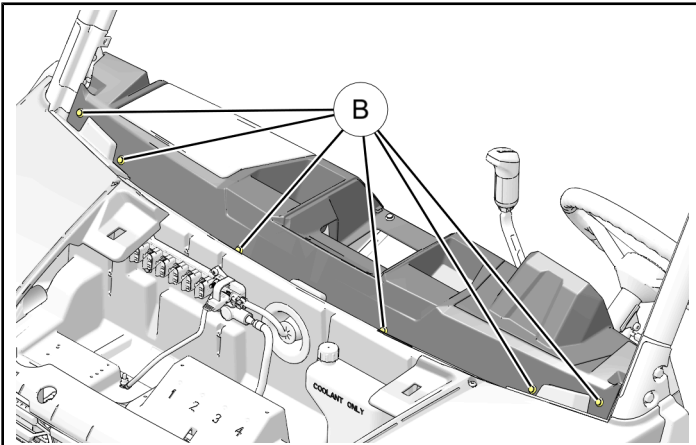

- Put cupholder in dash opening and move rearward. Install two push-pin rivets **A** into upper dash cupholder.

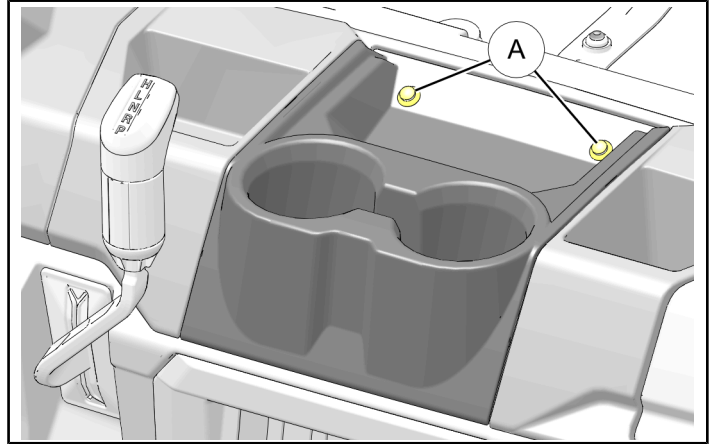

INSTRUMENT CLUSTER INSTALLATION

- Connect instrument cluster to chassis harness.
- Align instrument cluster with bezel. Push firmly to install.

NOTICE

Some parts hidden for clarity.

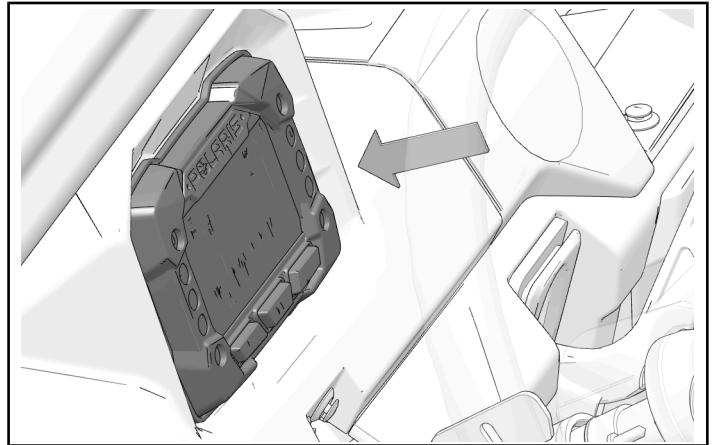

BATTERY CONNECTION

1. Install black negative (-) wire on battery by tightening the nut until seated.

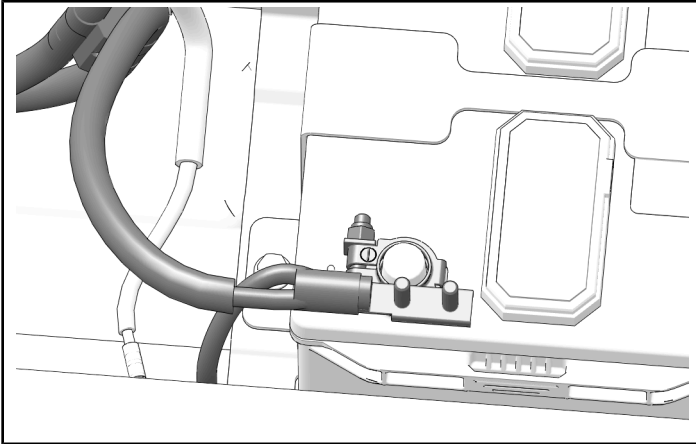

2. Install passenger side storage bin.

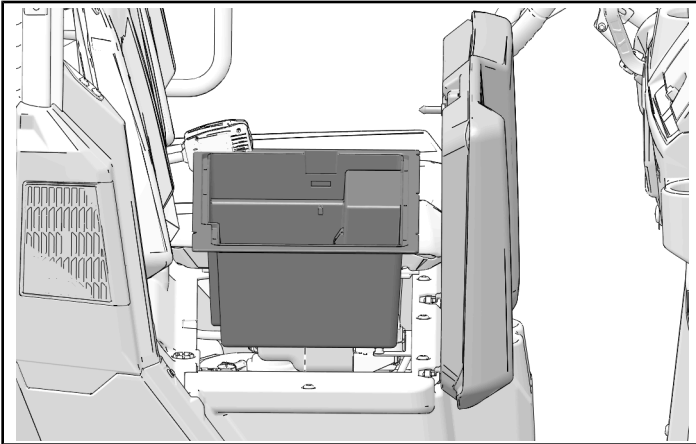

3. Close passenger seat.

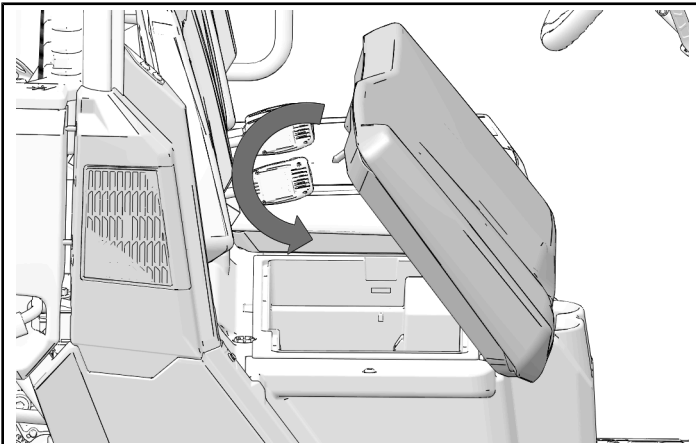

RANGER XP 1000 MODEL VEHICLES

UPPER DASH INSTALLATION

1. Align upper dash with vehicle.

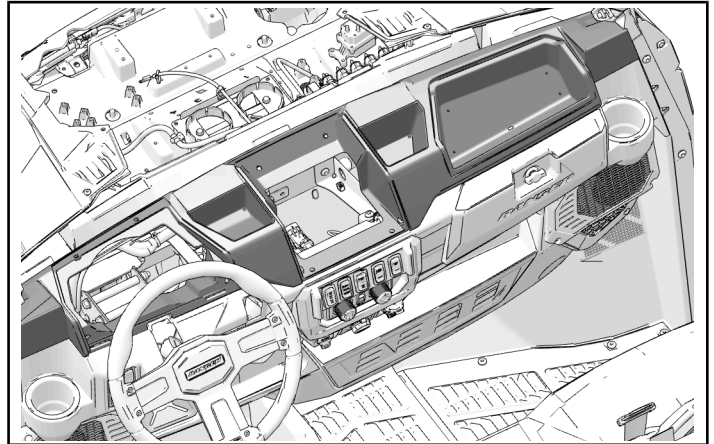

2. Install using six kept screws onto front of upper dash. Tighten screws until fully seated.

NOTICE

MY 2022 and older will have six push-pin rivets instead of six screws.

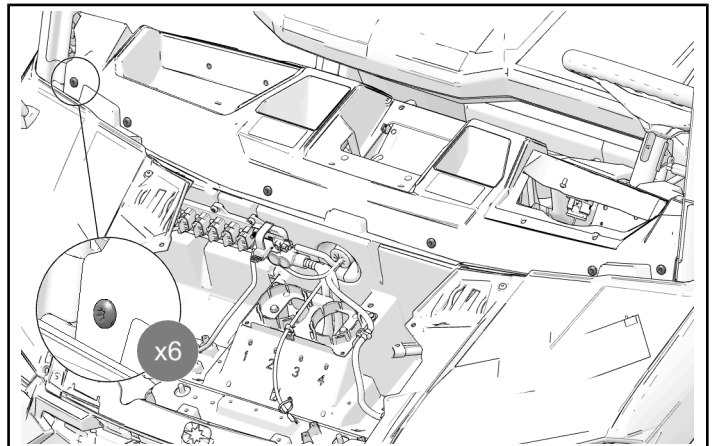

3. Install two kept push-pin rivets in instrument cluster area.

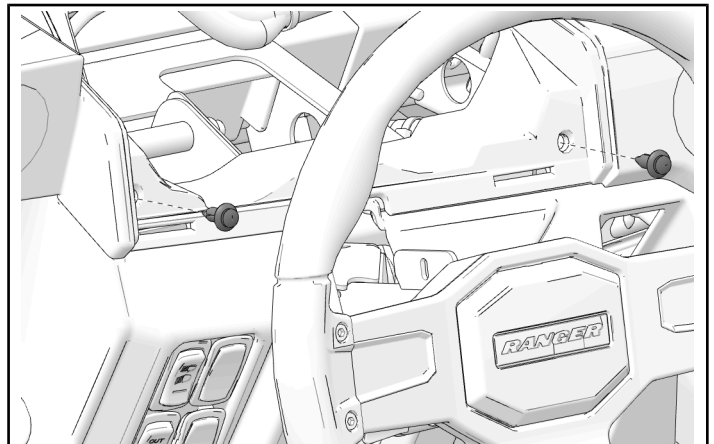

4. Install two kept push-pin rivets in center cup holder area.

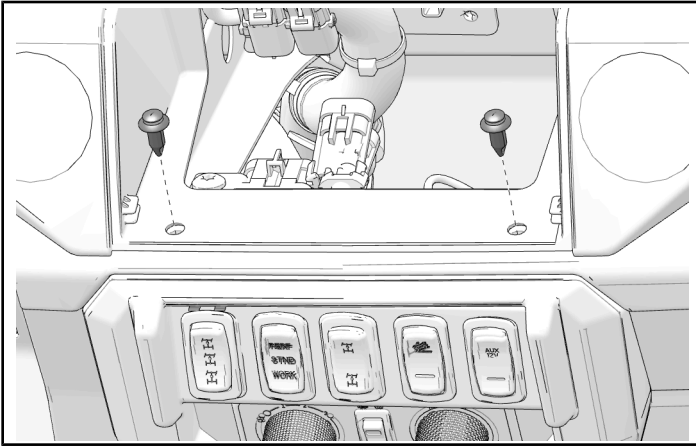

7. Install one push-pin rivet on top of passenger side cup holder.

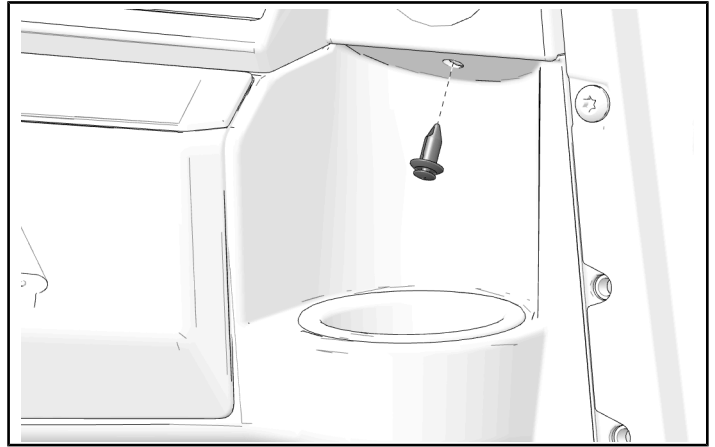

5. Install two kept push-pin rivets in upper storage compartment area.

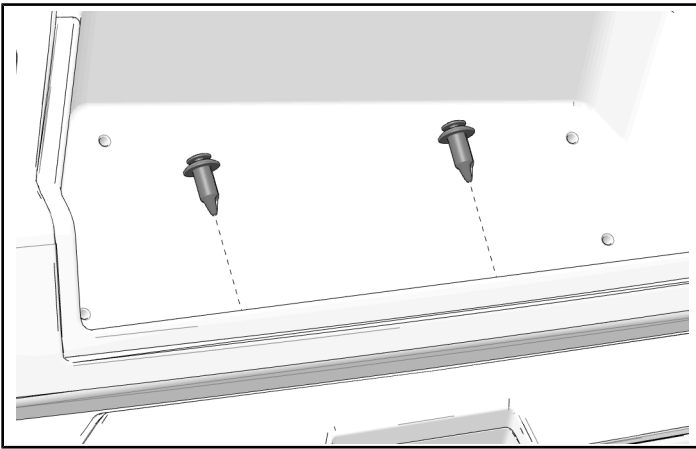

DASHBOARD STORAGE INSTALLATION

1. Put storage compartment in dashboard.

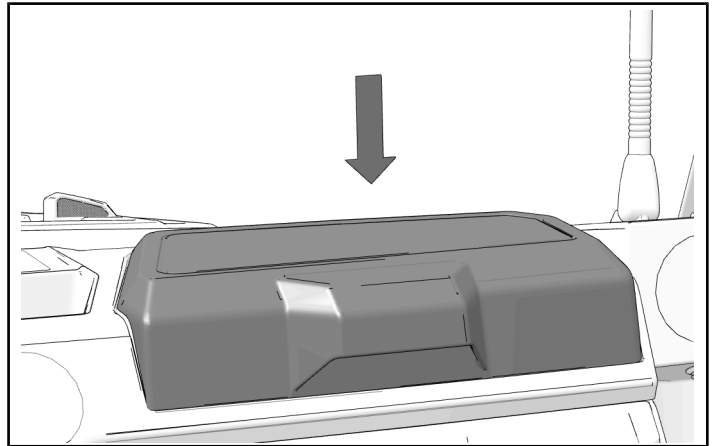

6. Install one push-pin rivet on top of driver side cup holder.

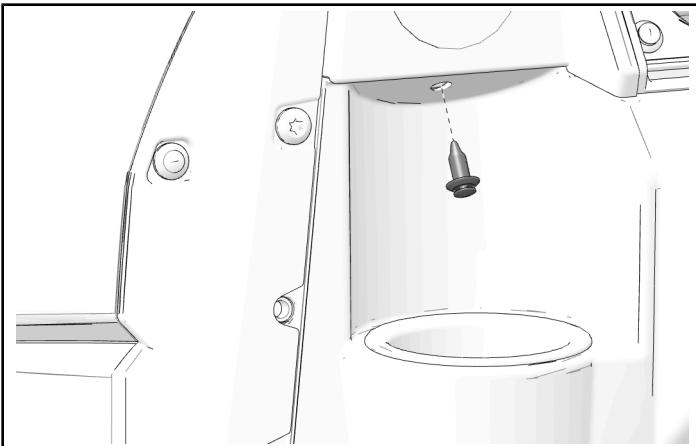

2. Open dashboard storage compartment.

3. Install storage compartment using four kept screws. Tighten until fully seated.

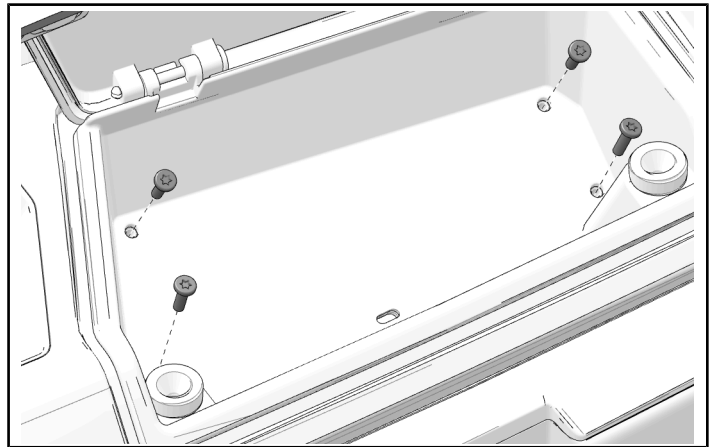

CUP HOLDER INSTALLATION (IF EQUIPPED)

1. Put cup holder in vehicle.

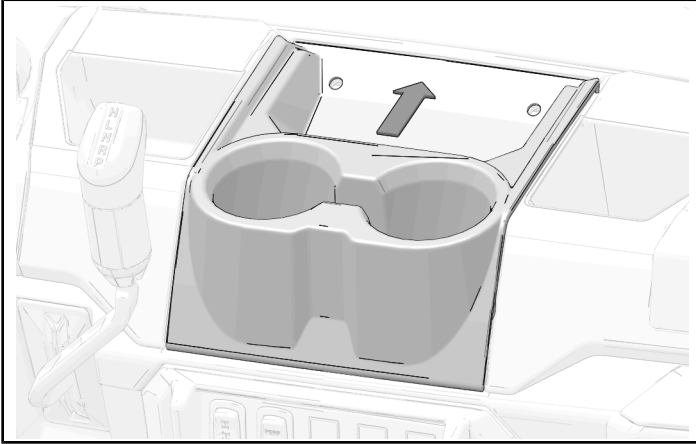

2. Install cup holder with two kept push-pin rivets.

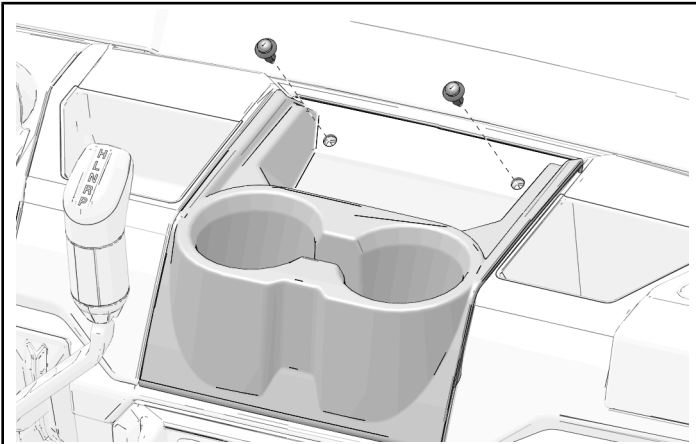

INSTRUMENT CLUSTER INSTALLATION

1. Connect the instrument cluster to the chassis electrical harness.

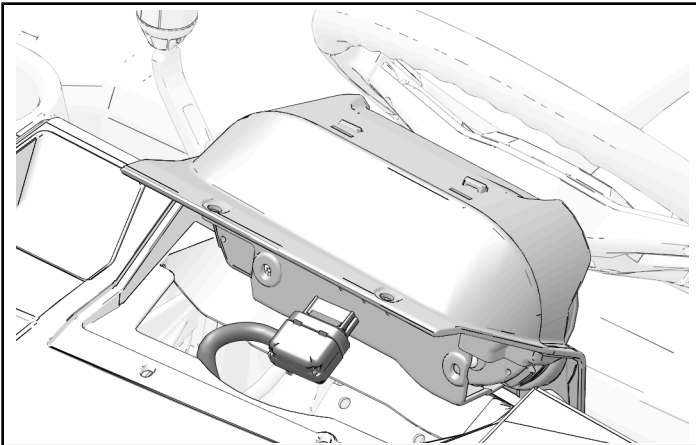

2. Install the instrument cluster bezel with two kept push-pin rivets.

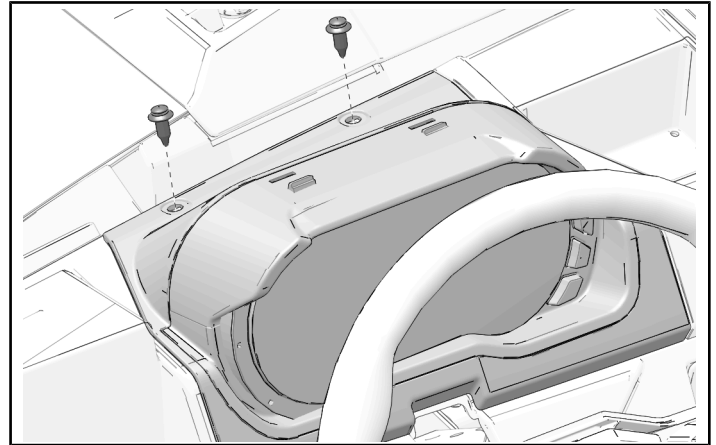

BATTERY CONNECTION

NOTICE

Ranger XP 1000 3-passenger: Battery is located under passenger seat. Ranger XP 1000 Crew: Battery is located under rear right seat.

⚠ WARNING

Make sure red positive (+) battery terminal is **COMPLETELY COVERED** by protective boot. Accidental tool contact across both battery terminals will result in high current electrical arc, and may result in battery explosion. Death or serious injury may occur.

1. Install negative (-) harness cable to negative (-) connection on battery with battery nut.

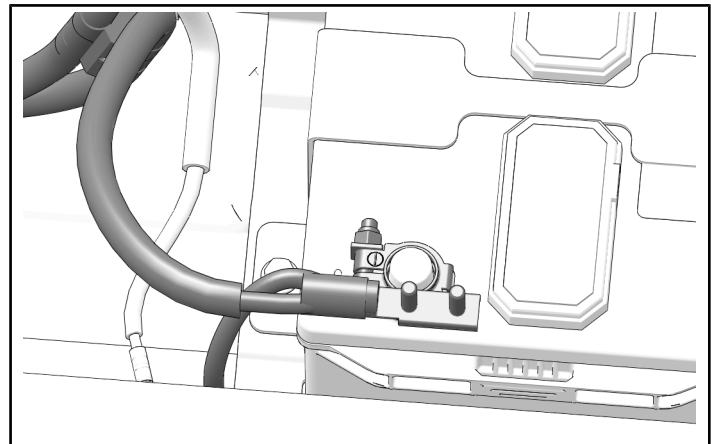

2. Torque nut to specification.

TORQUE

Battery Nut:
8 ft-lbs (11 N·m)

3. Install underseat storage bin.

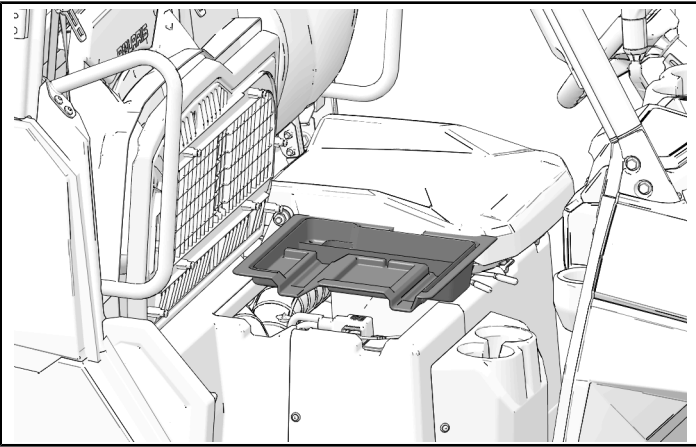

4. Lower passenger seat.

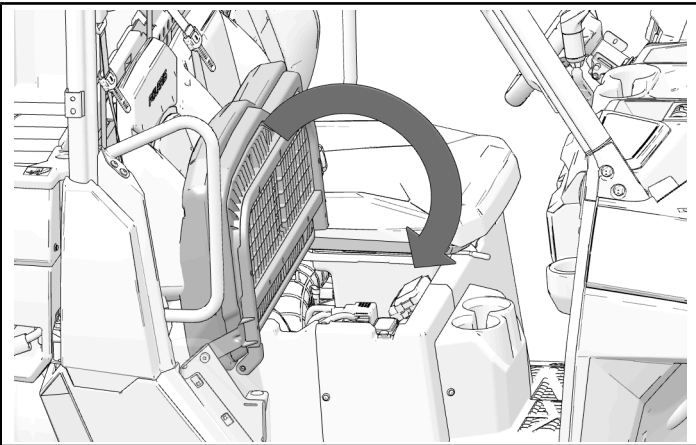

HOOD INSTALLATION

1. Align hood with vehicle and turn two quarter-turn fasteners to lock hood into position.

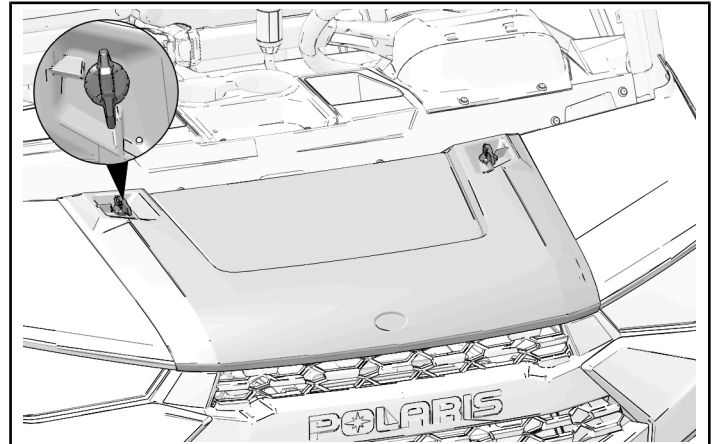

OPERATION

NOTICE

The winch switch ⑪ will only function if a winch has already been properly installed on the vehicle.

The winch switch ⑪ has two functions that activate by pressing the top or bottom of the switch.

- Press the top of the switch (“OUT”) to spool line out from the winch.
- Press the bottom of the switch (“IN”) to spool line in to the winch.

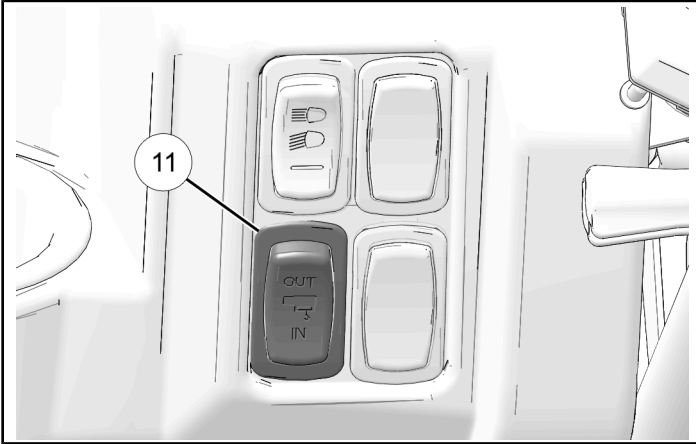

SERVICE KIT CONTENTS

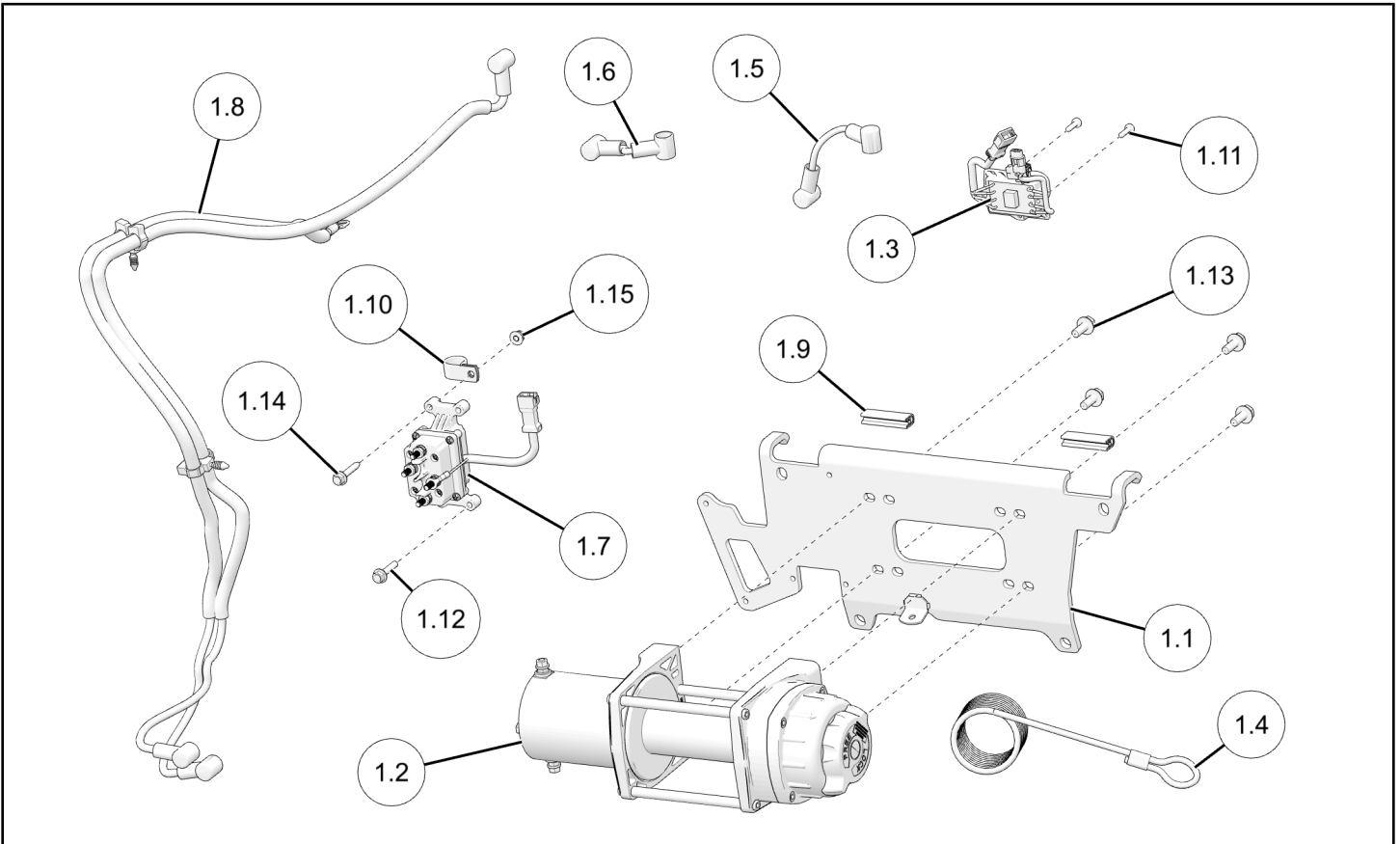

REF	QTY	PART DESCRIPTION	P/N AVAILABLE SEPARATELY	AVAILABLE SERVICE KIT
1.1	1	Winch Mount Bracket	1029762	n/a
1.2	1	Winch Assembly	n/a	2207977 (P/N 2889693) 2207742 (P/N 2889694) 2207828 (P/N 2889695) 2204856 (P/N 2889696) 2212717 (P/N 2891568) 2212710 (P/N 2891569) 2212703 (P/N 2891570) 2212852 (P/N 2891571)
-	-	- Winch Motor Service Kit	n/a	2212762 (P/N 2891568) 2212759 (P/N 2891569) 2212758 (P/N 2891570) 2212761 (P/N 2891571)
1.3	1	Autostop Controller (P/N 2889693; 2889694; 2889696)	2416576	n/a
1.4	1	Winch Rope	n/a	2879188
1.5	1	Yellow Winch Cable	4013468-120	n/a
1.6	1	Blue Winch Cable	4013469-95	n/a
1.7	1	Contactora	4015600	n/a
1.8	1	Winch Power Harness	4080876	n/a
1.9	2	Edge Trim	5815773	n/a
1.10	1	Clamp	7081235	n/a
1.11	2	Screw, Torx® Pan Head #10 x 3/4 in	7512026	n/a
1.12	1	Screw, Hex Flange, M6 x 1.0 x 30 mm	7518713	n/a
1.13	4	Screw, Hex Flange, M8 x 1.25 x 20 mm	7519133	n/a
1.14	1	Screw, Hex Flange, M6 x 1.0 x 35 mm	7528158	n/a
1.15	1	Nut, Flange, M6 x 1.0 mm	7548027	n/a
1.16	-	Winch Handle (P/N 2891568; 2891569 only) (not shown)	5454752	n/a