

RANGER FULL-SIZE WINCH KIT



P/N 2889693; 2889694; 2889695; 2889696

BEFORE YOU BEGIN

Read these instructions and check to be sure all parts and tools are accounted for. Please retain these installation instructions for future reference and parts ordering information.

APPLICATION

Verify accessory fitment at www.polaris.com.

KIT CONTENTS

Kit PN 2889693 shown; Kit PN 2889694, 2889695, 2889696 similar except as noted below.

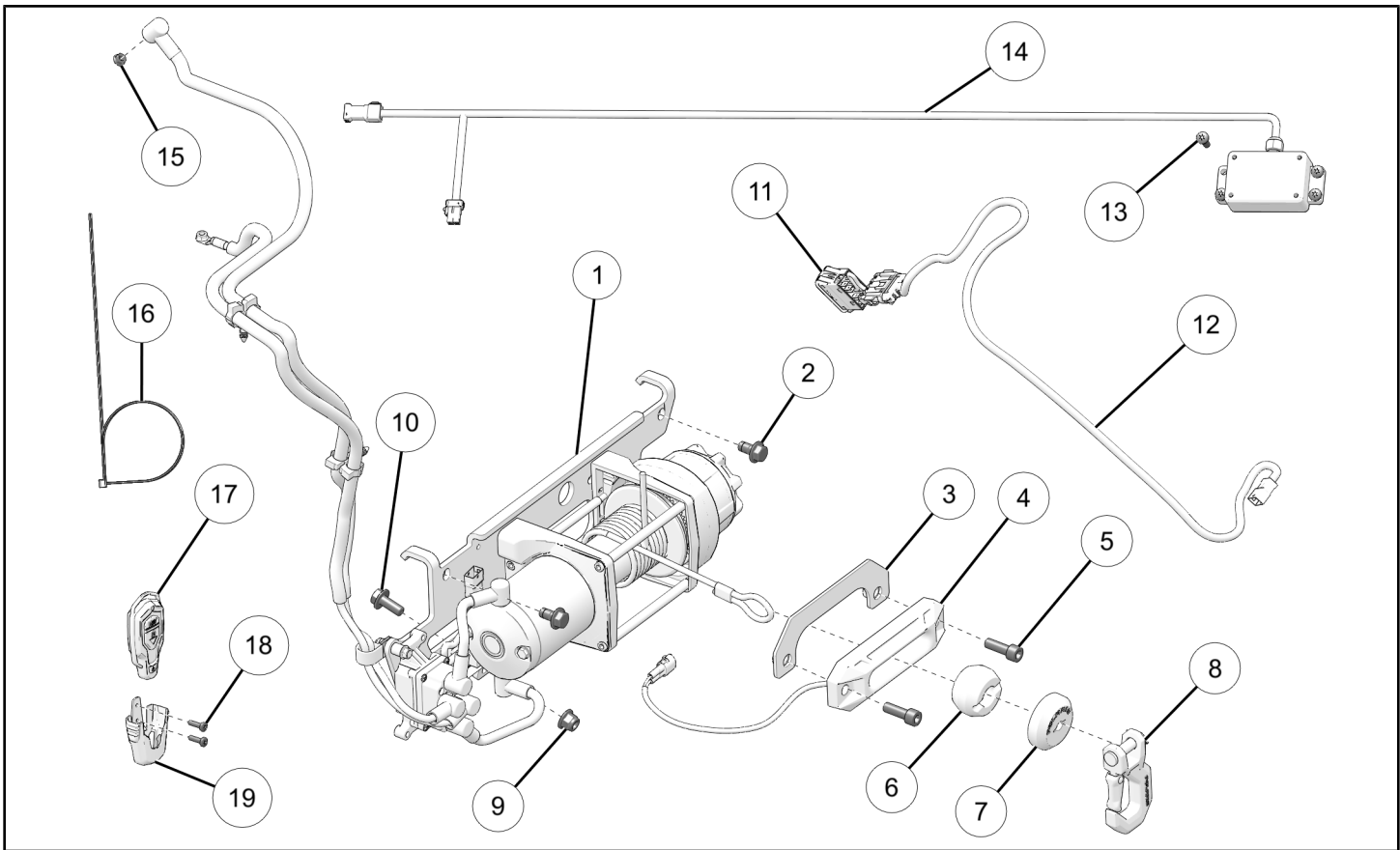

REF	QTY	PART DESCRIPTION	P/N AVAILABLE SEPARATELY	AVAILABLE SERVICE KIT
1	1	Winch Assembly, 6000 lb. Pro Winch Assembly, 4500 lb. Pro (not shown) Winch Assembly, 4500 lb. HD (not shown) Winch Assembly, 6000 lb. HD (not shown)	2638876 2638877 2638878 2638879	n/a n/a n/a n/a
2	2	Screw – Hex Flange, M10 x 1.5 x 20 mm Screw – Hex Flange, M10 x 1.5 x 20 mm (Kit 2889696 only)	7519905 7519905	2207258 2208141
3	1	Bracket – Mount, Fairlead	5271082	n/a
4	1	Fairlead Assembly	2637781	n/a

REF	QTY	PART DESCRIPTION	P/N AVAILABLE SEPARATELY	AVAILABLE SERVICE KIT
5	2	Screw – Socket Head, M10 x 1.5 x 30 mm Screw – Socket Head, M10 x 1.5 x 30 mm (Kit 2889696 only)	7519844 7519844	n/a 2208141
6	1	Bumper – Jounce, Winch	5417894	n/a
7	1	Stop – Magnet, Bumper	5415787	n/a
8	1	Hook – Latch, Winch	5910706	n/a
9	2 4	Nut, M10 x 1.5 mm Nut, M10 x 1.5 mm (Kit 2889696 only)	7547423 7547423	2207258 2208141
10	2	Screw – Hex Flange, M10 x 1.5 x 25 mm Screw – Hex Flange, M10 x 1.5 x 25 mm (Kit 2889696 only)	7519071 7519071	2207258 2208141
11	1	Switch – Winch, Sealed	4080274–03	n/a
12	1	Jumper – Winch, Switch, Sealed	2415055	n/a
13	4	Screw – Torx® Panhead (Kit 2889693 only)	7519731	2207258
14	1	Receiver – Wireless, Winch (Kit 2889693 only)	2414496	n/a
15	2	Nut – Hex Flange Head Nut – Hex Flange Head (Kit 2889696 only)	7547270 7547270	n/a 2208141
16	10	Cable Tie Cable Tie (Kit 2889696 only)	7080492 7080492	2207258 2208141
17	1	Remote – Winch, Wireless	4080061	n/a
18	2	Screw – Torx®, #10 x 3/4 in Hi-Lo	7512026	2207258
19	1	Holder – Remote, Wireless	5454269	n/a
20	1	Manual – Winch Guide (not shown)	9923644	n/a

SERVICE PARTS DETAIL

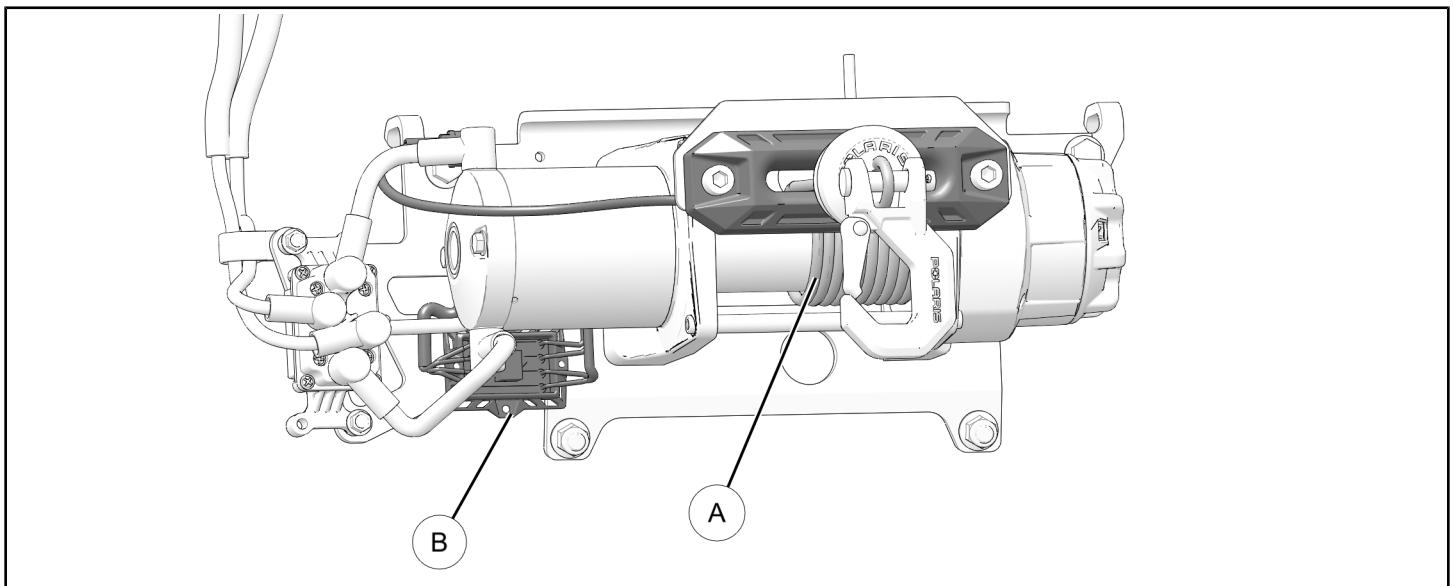

REF	QTY	PART DESCRIPTION	P/N AVAILABLE SEPARATELY
A	1	Rope, 6000 lb. Winches Rope, 4500 lb. Winches	2879188 2879187
B	1	Controller, Auto Stop	2889690

HARNES DETAIL

WINCH HARNESS ①

NOTICE

Winch hidden for clarity.

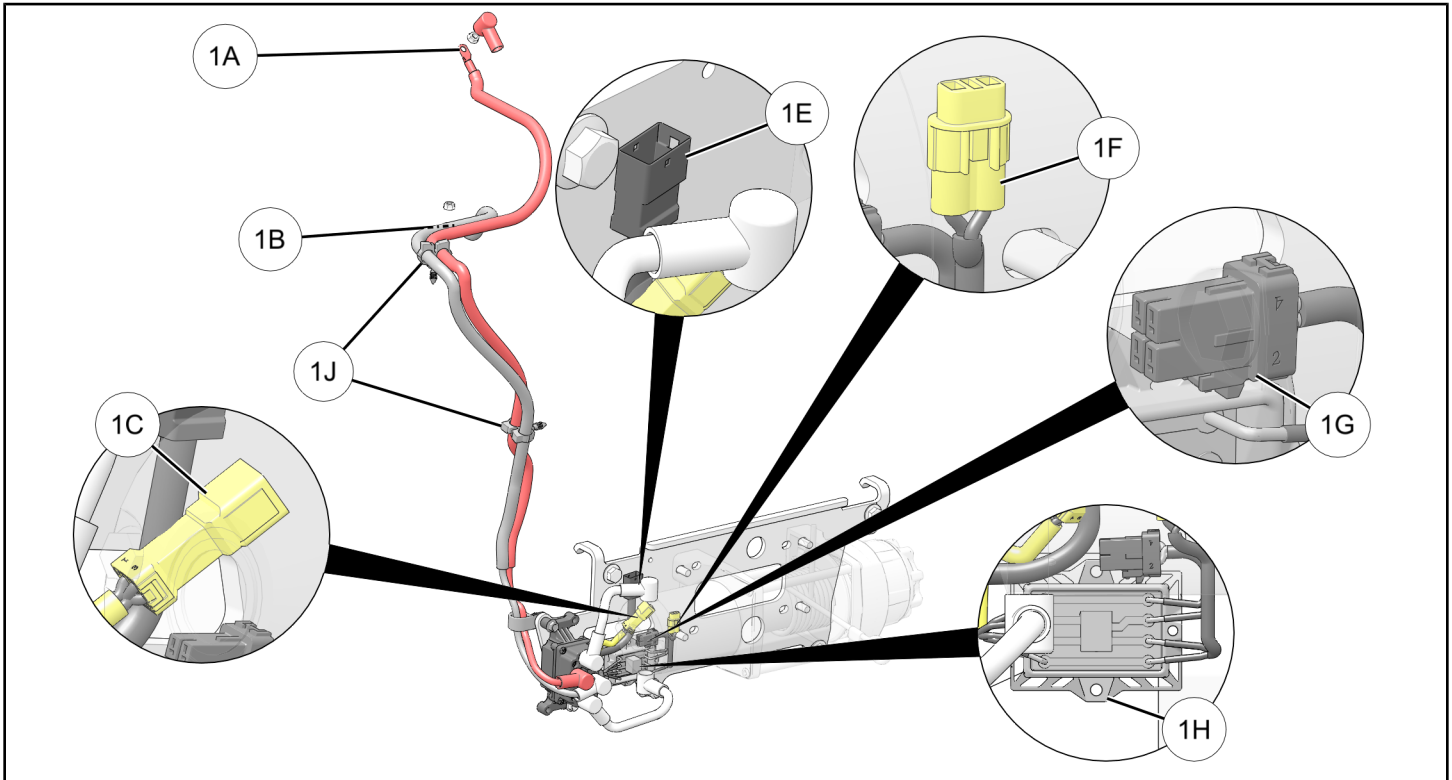

REF	PART DESCRIPTION	WIRE COLOR	PIN QTY/ GENDER	CONNECTS TO
1A	Ring Terminal, 45 degree (with cap) - 1/4 inch (6 mm)	Red	-	Terminal block, battery positive (+)
1B	Ring Terminal - 1/4 inch (6 mm)	Black	-	Chassis ground / battery negative (-)
1C	Connector, Winch Controller/Contactor	-	4 male	Main vehicle harness breakout; see instructions for detail
1D	(not used)	-	-	-
1E	Connector, Winch Controller/Contactor	-	4 male	PRE-CONNECTED to 1G
1F	Connector, Autostop Fairlead	-	2 female	See instructions for detail
1G	Connector, Winch Controller/Contactor	-	4 female	PRE-CONNECTED to 1E

REF	PART DESCRIPTION	WIRE COLOR	PIN QTY/ GENDER	CONNECTS TO
1H	Autostop Controller; shown for reference only	-	-	-
1J	Clip, Routing	-	-	Vehicle structure

AUTO STOP FAIRLEAD HARNESS ④

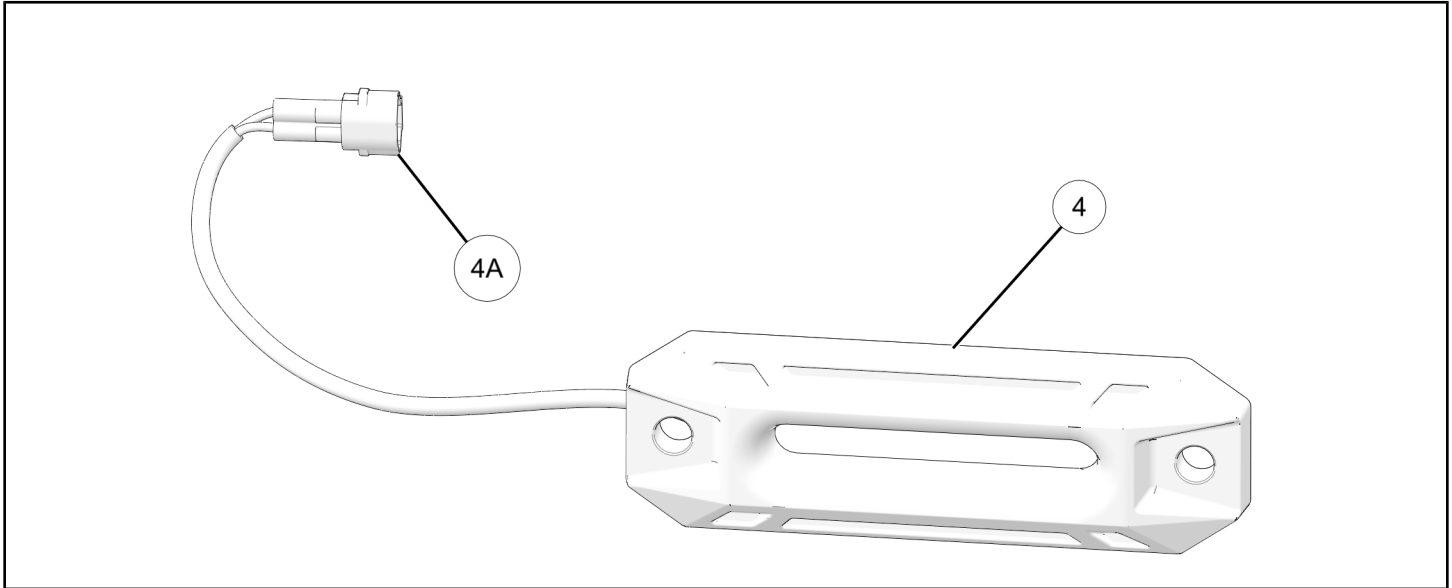

REF	PART DESCRIPTION	WIRE COLOR	PIN QTY/ GENDER	CONNECTS TO
4A	Connector, Autostop Fairlead	-	2 male	See instructions for detail

WIRELESS RECEIVER HARNESS ⑭

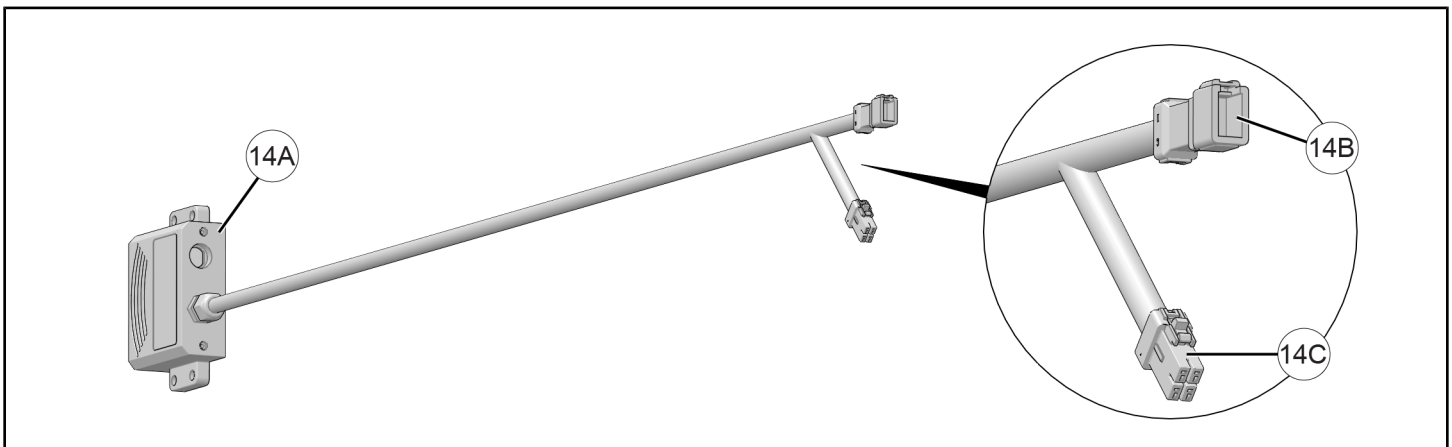

REF	PART DESCRIPTION	WIRE COLOR	PIN QTY/ GENDER	CONNECTS TO
14A	Wireless Receiver	-	-	Vehicle structure
14B	Connector, Winch Controller/Contactor	-	4 male	Main vehicle harness breakout; see instructions for detail
14C	Connector, Wired Remote	-	4 female	OPTIONAL: Wired remote socket, connector 17B*

* Or compatible kit.

TOOLS REQUIRED

- Safety Glasses
- Pliers, Push Pin Rivet
- Socket Set, Metric
- Socket Set, Torx® Bit
- Torque Wrench
- Wrench Set, Metric

IMPORTANT

Your Ranger Full-Size Winch Kit is exclusively designed for your vehicle. Please read the installation instructions thoroughly before beginning. Installation is easier if the vehicle is clean and free of debris. For your safety, and to ensure a satisfactory installation, perform all installation steps correctly in the sequence shown.

INSTALLATION INSTRUCTIONS

VEHICLE PREPARATION

GENERAL

1. Park vehicle on a flat surface.
2. Shift vehicle into PARK.
3. Turn key to OFF position and remove key.

DISCONNECT BATTERY

1. Shift vehicle into PARK.
2. Turn ignition switch to OFF position and remove key.
3. Flip up passenger seat bottom (**CREW VEHICLES**: right rear passenger seat bottom) and remove underseat storage compartment. Disconnect black negative (-) cable from battery.

WARNING

Ensure red positive (+) battery terminal is COMPLETELY COVERED by protective boot. Accidental tool contact across both battery terminals will result in high current electrical arc, and may result in battery explosion. Death or serious personal injury may occur.

HOOD REMOVAL

1. Turn two quarter-turn fasteners to unlock position to remove hood from vehicle.

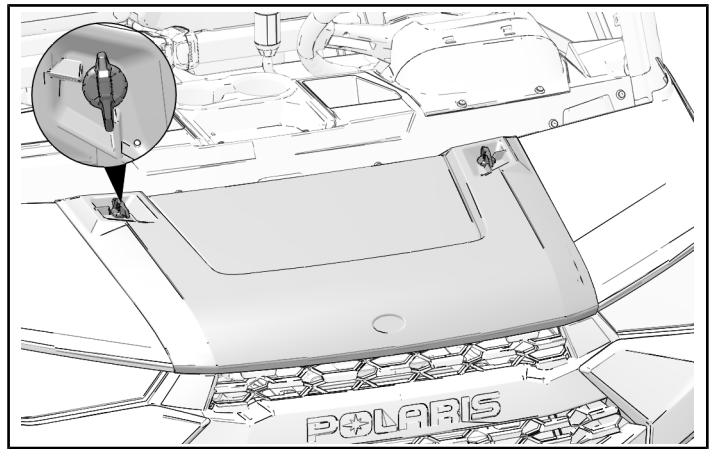

GRILLE REMOVAL

1. Push two tabs down to remove grille.

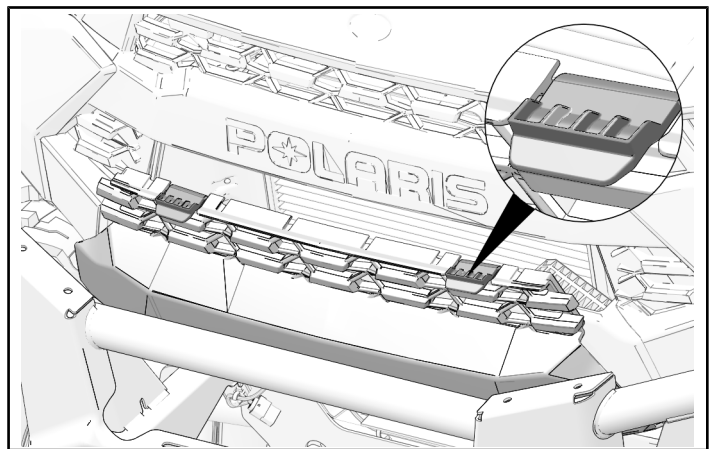

UPPER DASHBOARD REMOVAL

1. Remove and keep six push-pin rivets from front of upper dashboard.

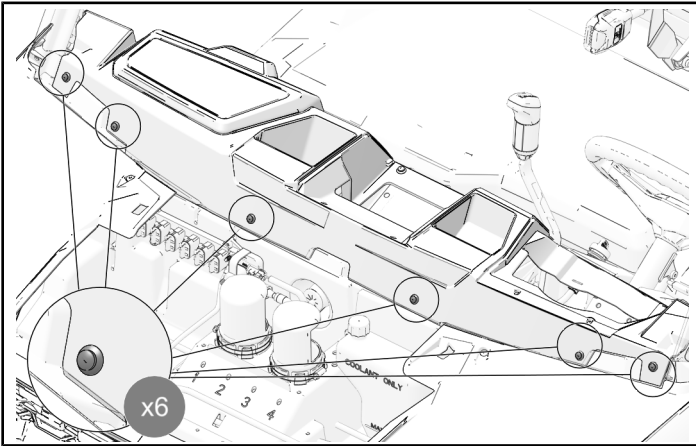

2. Remove and keep four push-pin rivets from driver's side of upper dashboard.

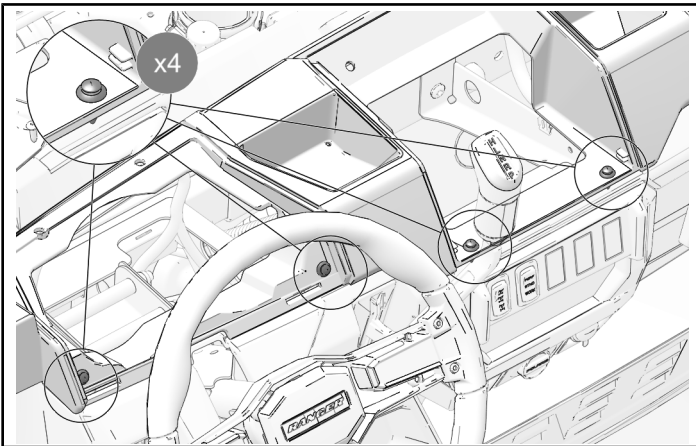

3. Remove and keep two push-pin rivets from passenger's side of upper dashboard.

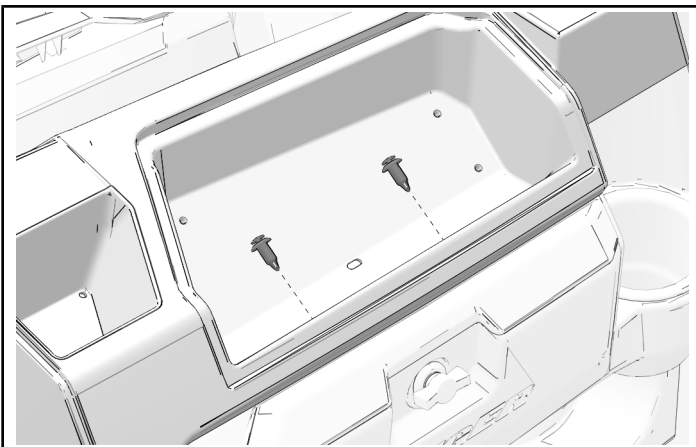

4. Remove and keep two push-pin rivets from underside of upper dashboard.

TIP

Push-pin rivets are located above side cup holders.

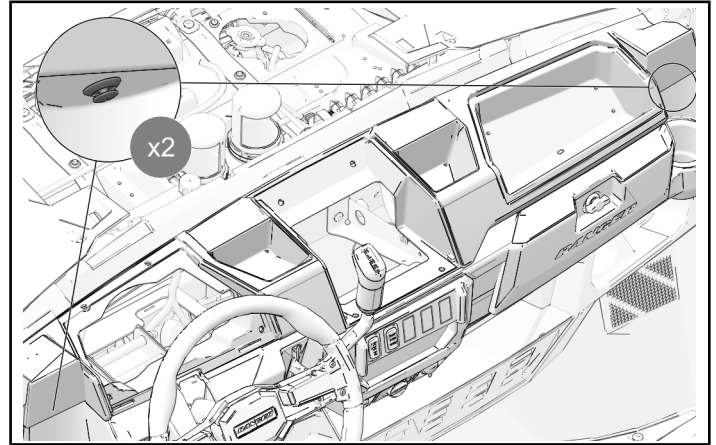

5. Remove upper dashboard from vehicle.

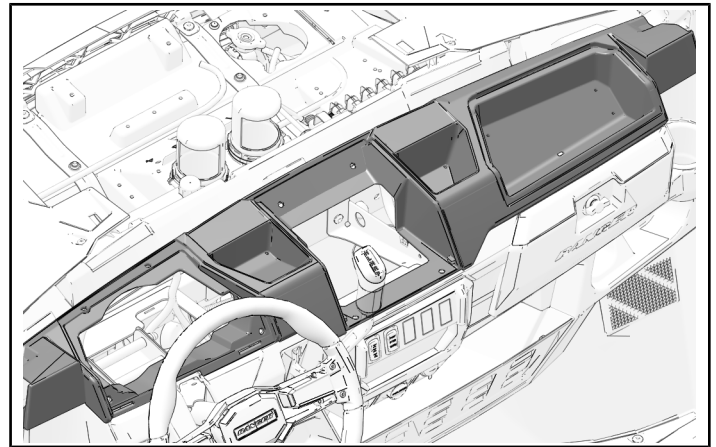

FRONT BUMPER REMOVAL

CAUTION

Front bumper weighs approximately 38 lbs. (17 kg). Provide adequate support for bumper before removing final screws. Failure to provide adequate support may result in personal injury or damage to bumper.

1. Remove and keep two nuts and two screws from the bottom of the front bumper.

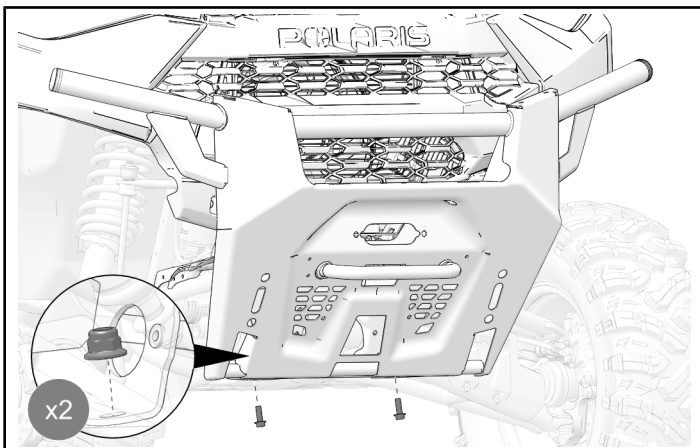

2. Remove and keep two nuts and two screws from front bumper support bracket.

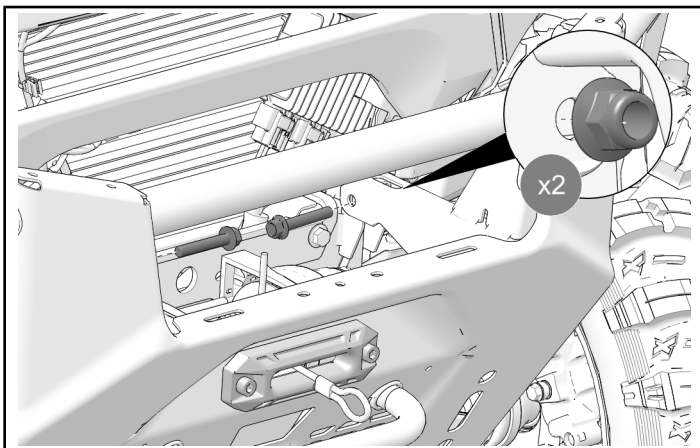

ACCESSORY INSTALLATION

AUTO STOP FAIRLEAD INSTALLATION

1. Install auto stop fairlead (4) and fairlead backer plate (3) to bumper using two screws (5).

IMPORTANT

Make sure the auto stop fairlead is installed with the harness exiting on the right side of the bumper, as shown.

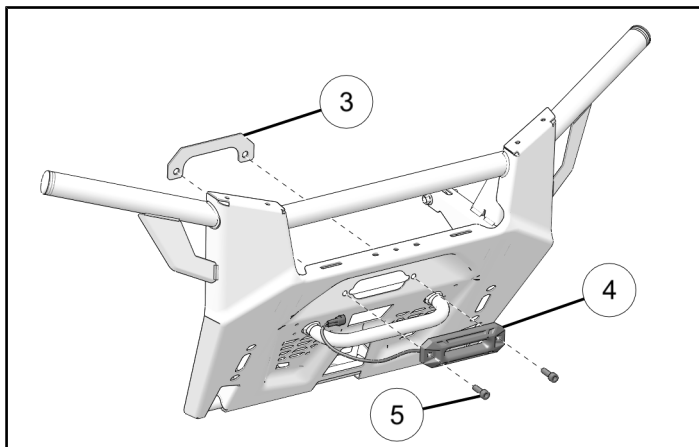

2. Hand tighten screws and set bumper aside.

WINCH INSTALLATION

1. Install rear hooks on winch assembly (1) to vehicle front support structure.

NOTICE

Center winch between two bumper support brackets (H), as shown.

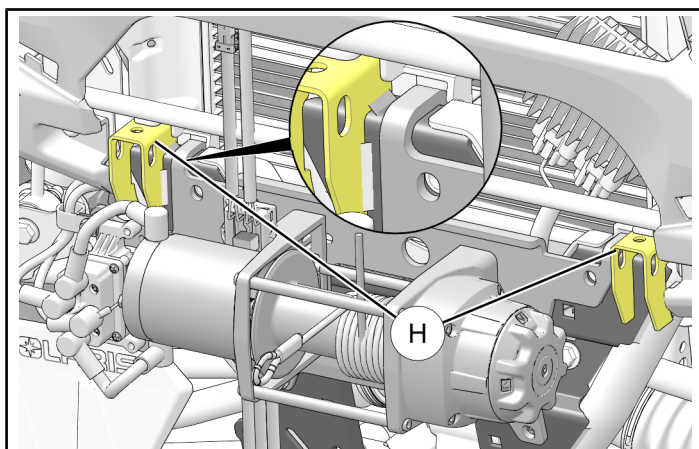

- Loosely install two screws ② through upper holes on winch into vehicle front support structure.

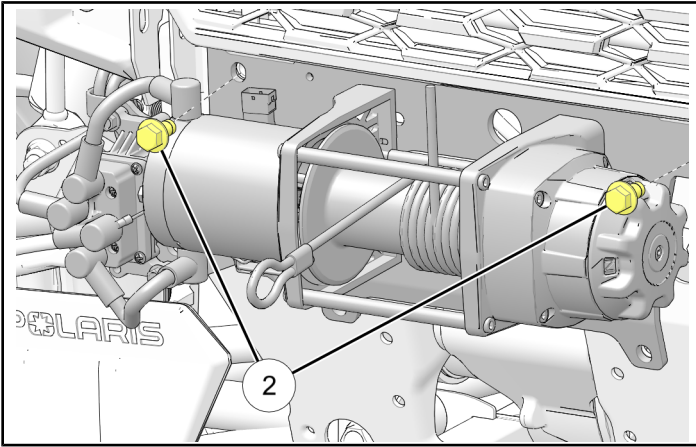

- Loosely install two screws ⑩ and two nuts ⑨ through lower holes on winch into vehicle front support structure.

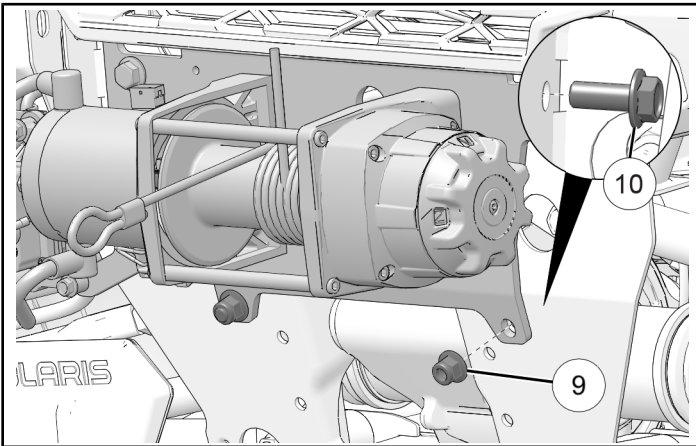

- Torque screws ② and nuts ⑨ to specification.

TORQUE

Winch Screws ②:
40 ft-lbs (54 N·m)

TORQUE

Winch Nuts ⑨:
40 ft-lbs (54 N·m)

WINCH HARNESS INSTALLATION

- Route terminal block cables ① up from winch ① through cut-out in under-hood liner ⑫.
- Attach cables to vehicle with lower routing clips 1J.

NOTICE

If vehicle does not have attachment points for routing clips, use cable ties to attach the harness to the chassis bar. Make sure to keep all electrical harnesses away from moving parts.

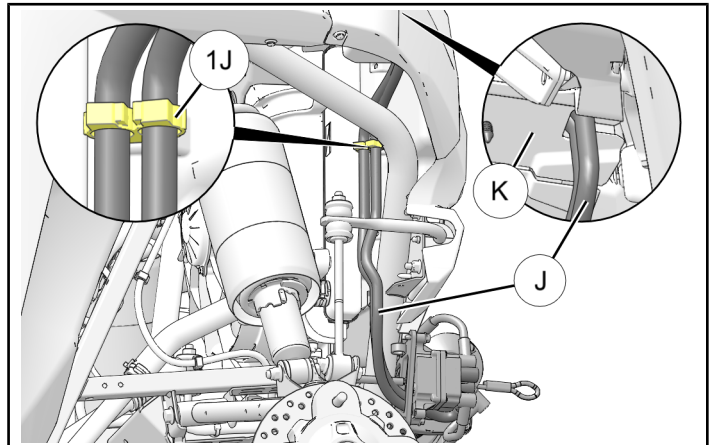

- Attach terminal block cables ① to under-hood liner using upper routing clip 1J.

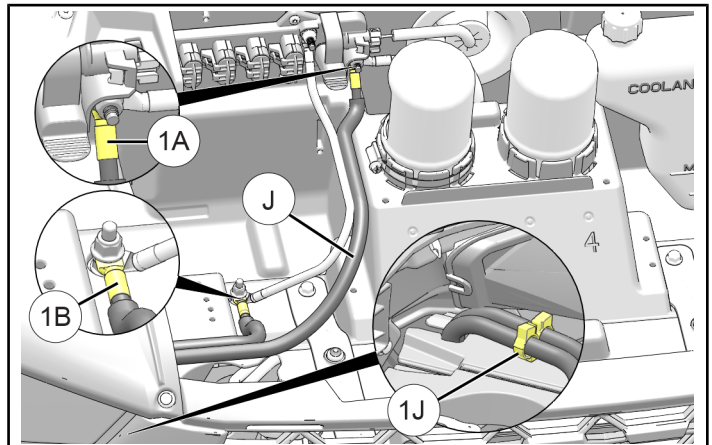

4. Connect RED 45 degree ring terminal 1A to positive (+) terminal on battery and install nut 15.

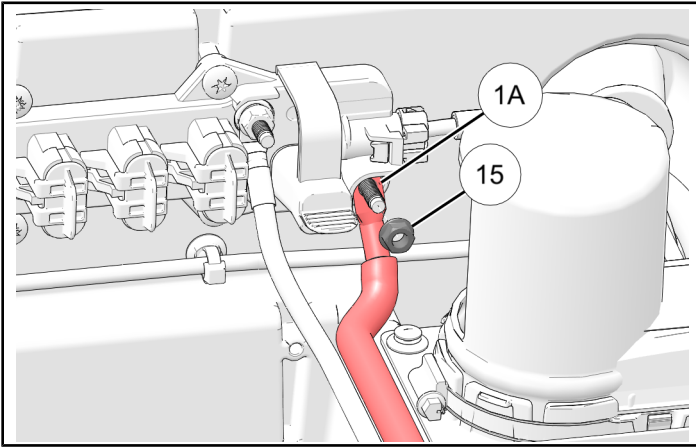

5. Torque nut to specification and install boot.

TORQUE

Positive (+) Battery Cable Nut 15:
30 in-lbs (3.4 N·m)

NOTICE

If two cable boots exist for same terminal, then slide inner boot (closest to terminal block) down cable. Unused boot can remain on cable.

6. Connect BLACK straight ring terminal 1B to negative (-) chassis ground/battery terminal and install nut 15.

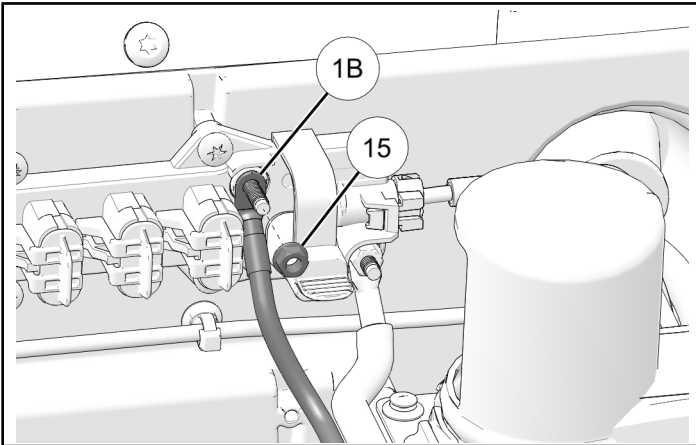

7. Torque nut to specification.

TORQUE

Negative (-) Battery Cable Nut 15:
8 ft-lbs (6 N·m)

8. Locate UNUSED 4-pin main vehicle harness breakout connector L (near head of lower left winch attachment screw 10). Remove cap from connector, then join to mating winch connector 1C.

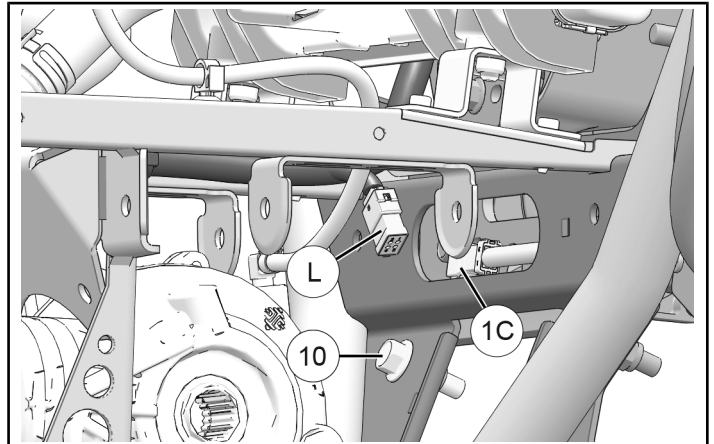

9. Install wireless receiver 14 to right-hand side of under-hood liner using four screws 13.

Do not over-tighten screws.

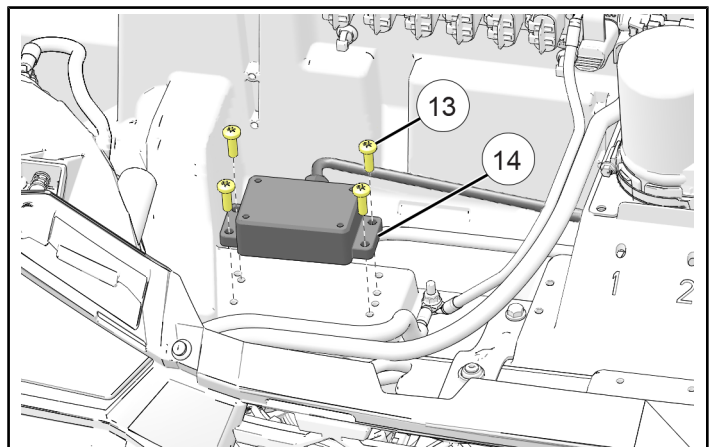

10. Route wireless receiver connectors 14B and 14C rearward through firewall grommet into upper dash compartment.

11. Locate UNUSED 4-pin main vehicle harness breakout connector (M) in cavity where cupholder was removed. Remove cap from connector, then join to mating wireless receiver connector 14B.

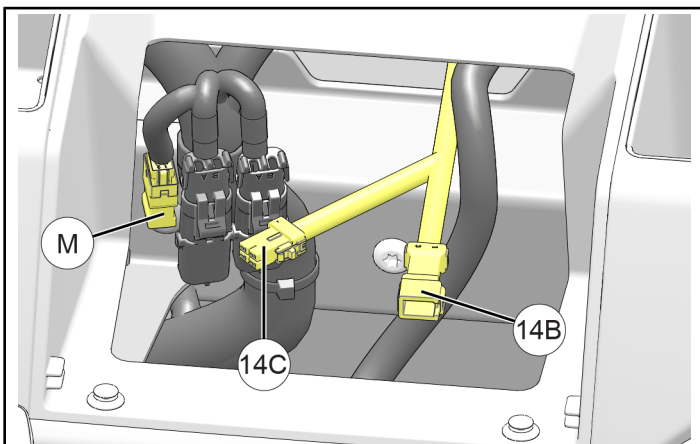

WINCH SWITCH HARNESS INSTALLATION

1. Remove winch switch (11) from the jumper harness (12) and set aside.

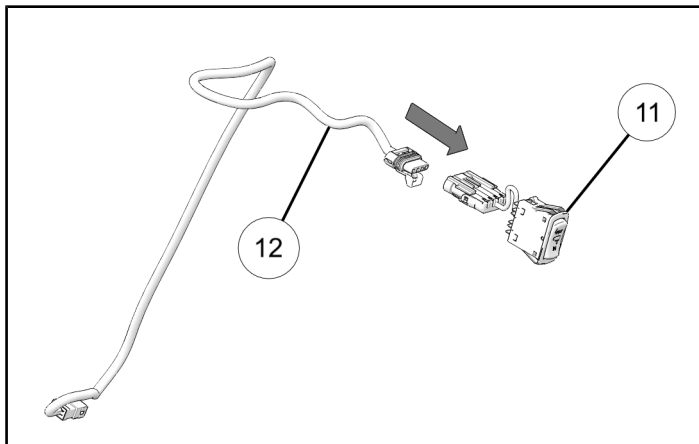

2. Cut out one of the blank switch locations in the dash.

NOTICE

Blank switch locations may vary based on vehicle options. Any unused switch blank located left of the steering wheel may be used.

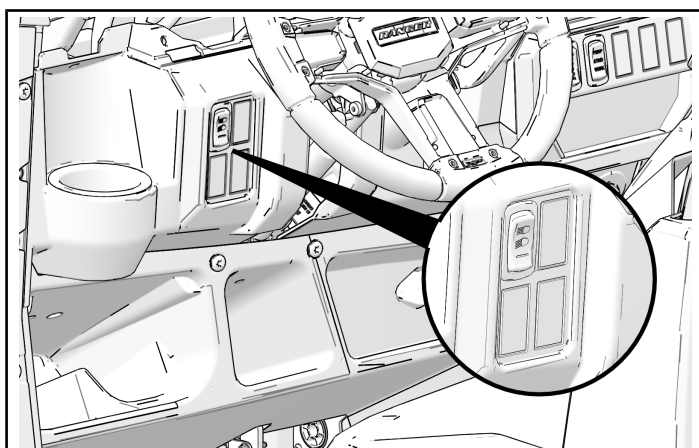

3. Pull the jumper harness connector (12) through the dash cutout and connect to the winch switch (11). Make sure the connector is fully seated into the switch.

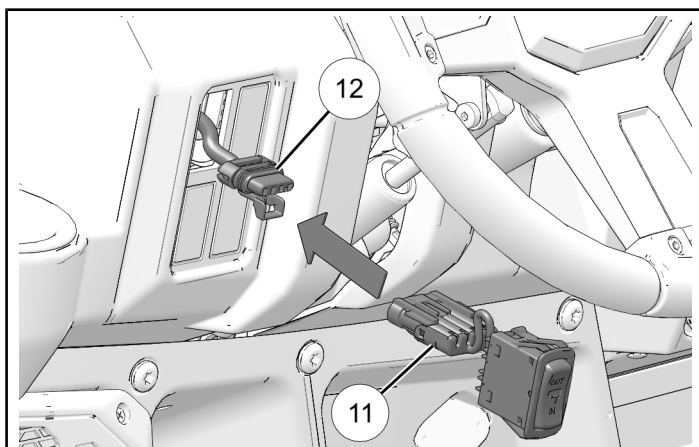

4. Push the switch into the dash cutout until fully seated with an audible click.

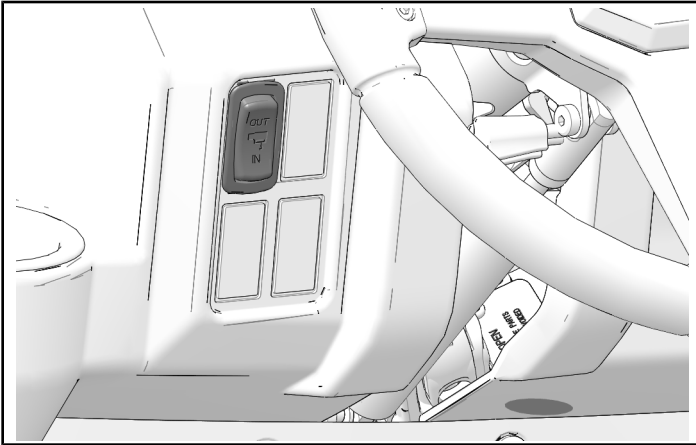

5. Route jumper harness ⑫ along underside up upper dash towards the cupholder.

NOTICE

Use cable ties to secure harness away from moving parts.

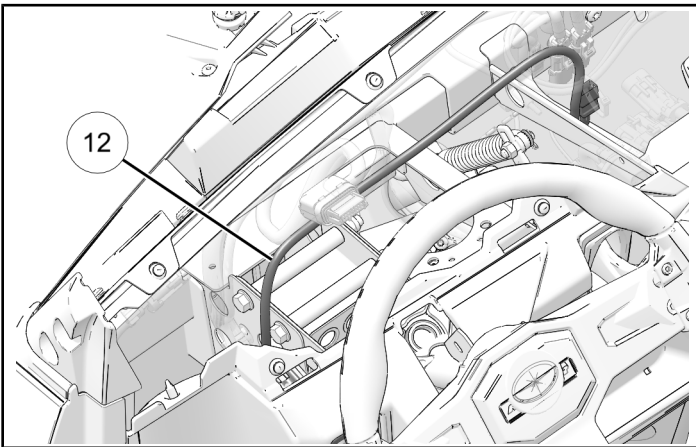

6. Install jumper harness ⑫ to connector 14C located on the wireless receiver harness ⑭.

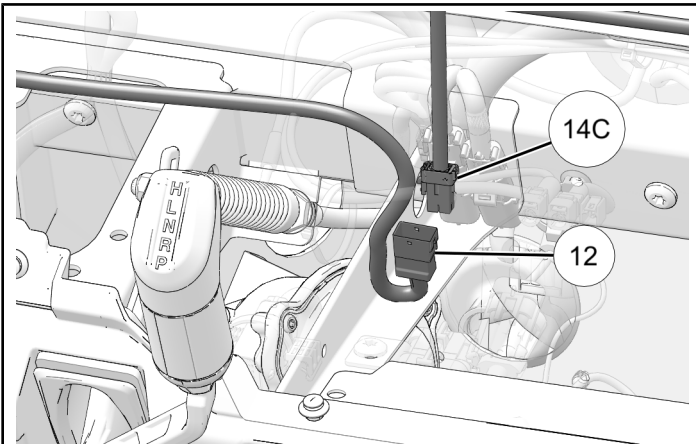

WIRELESS REMOTE INSTALLATION

NOTICE

Installation of wireless remote holder is optional. Wireless remote can be stored in any suitable location. Holder ⑲ is not required.

1. Remove wireless remote ⑰ from holder ⑲. Determine suitable mounting location for holder with special attention to the following:
 - Driver operation of vehicle (including travel of controls, such as shift lever)
 - Driver visibility
 - Adequate clearance between holder mounting fasteners and other vehicle components on underside of mounting surface

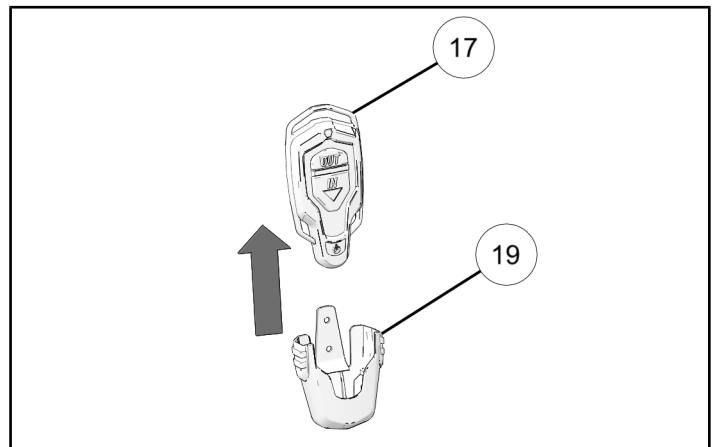

2. Use remote holder ⑲ as a template and mark two holes onto dash surface.

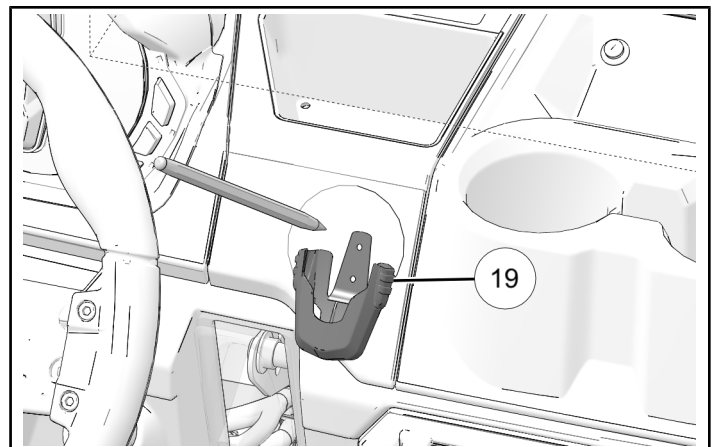

3. Drill two holes into preferred location on dash.

MEASUREMENT

Drill Bit Size:
1/8 in (3 mm)

IMPORTANT

Control drill depth to prevent damage to underlying structure or components.

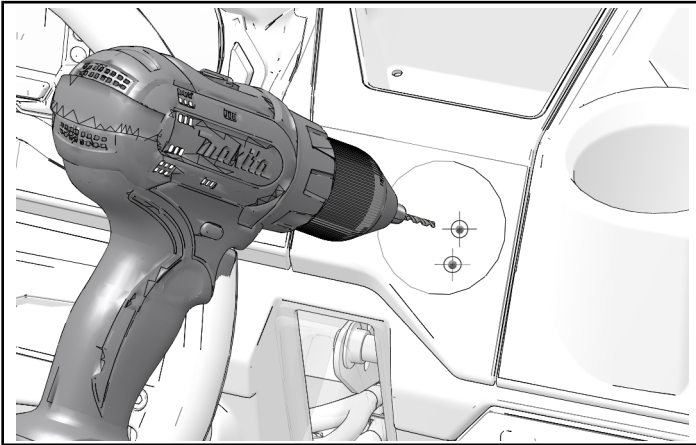

4. Install holder (19) to dash with two screws (18). Tighten screws until fully seated.

Do not over-tighten screws.

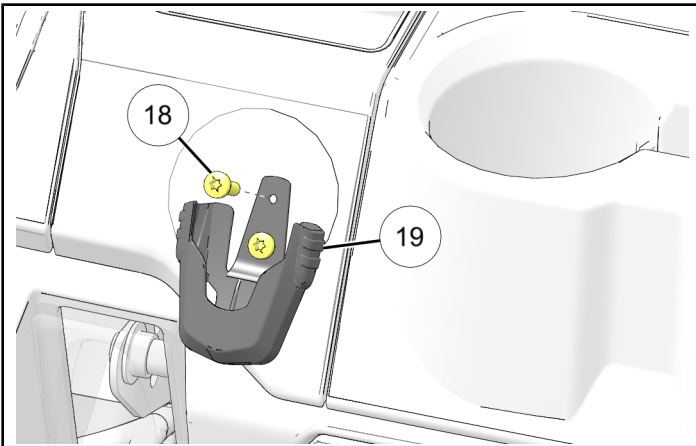

5. Install wireless remote (17) into holder.

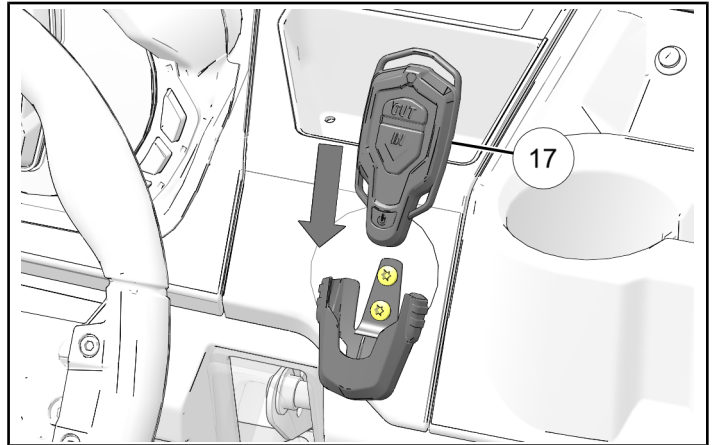

BUMPER INSTALLATION

1. Unwind BY HAND several turns of rope from the winch spool. While lifting bumper into position thread loop at end of rope through bumper and fairlead (4).

IMPORTANT

Do NOT electrically operate winch at this time.

2. Loosely install middle of bumper to vehicle frame using two each retained screws and nuts.

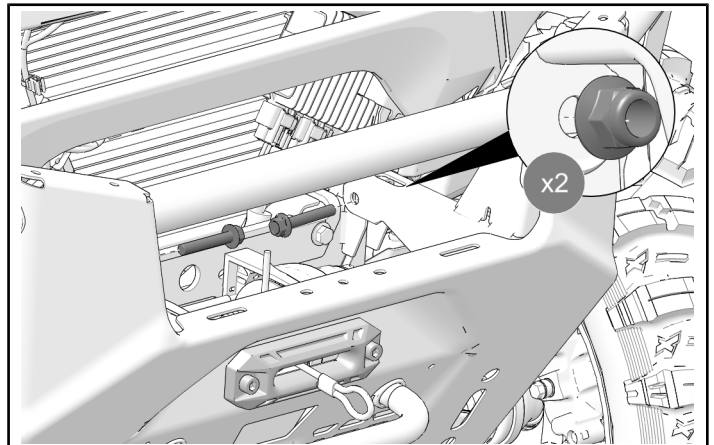

3. Loosely install bottom of bumper to vehicle frame using two each screws and nuts.

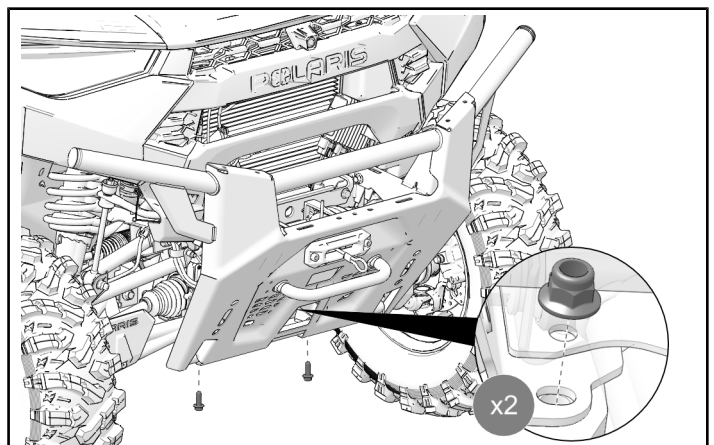

4. Torque fasteners to specification.

TORQUE

Bumper Fasteners:
40 ft-lbs (54 N·m)

LOWER GRILLE INSTALLATION

1. Put bottom of grille in first and push top of grille in until two tabs engage upper front fascia.

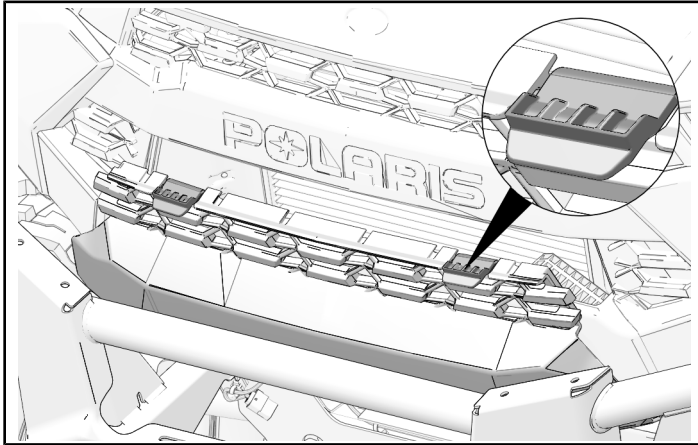

AUTO STOP FAIRLEAD CONNECTION

NOTICE

Installation of RIDE COMMAND® Kit (PN 2882872, 2884564, or equivalent) may affect some of the following connections. See instructions included with RIDE COMMAND® Kit for details.

1. Your vehicle will have one of two chassis harness configurations at front of vehicle. Harness configuration will affect installation of autostop fairlead connector.

FACTORY CHOICE harness has the following breakouts:

- Two regulators (N)
- 4-pin female connector (L) (previously joined to connector 1C)

- 2-pin male connector (P)
- 2-pin female connector (Q)

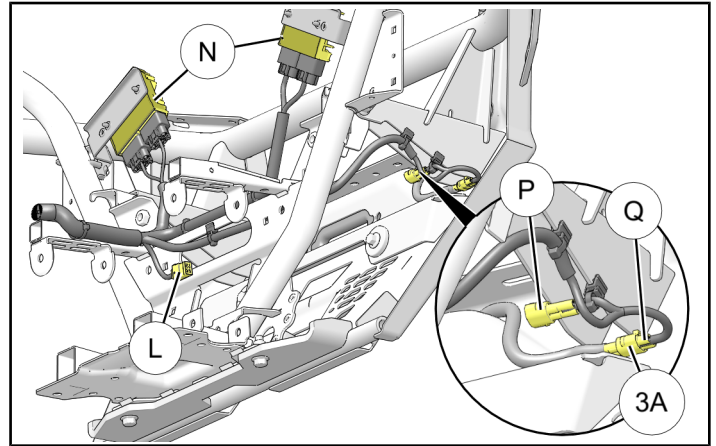

NON-FACTORY CHOICE harness has the following breakouts:

- One regulator (N)
- 4-pin female connector (L) (previously joined to connector 1C)

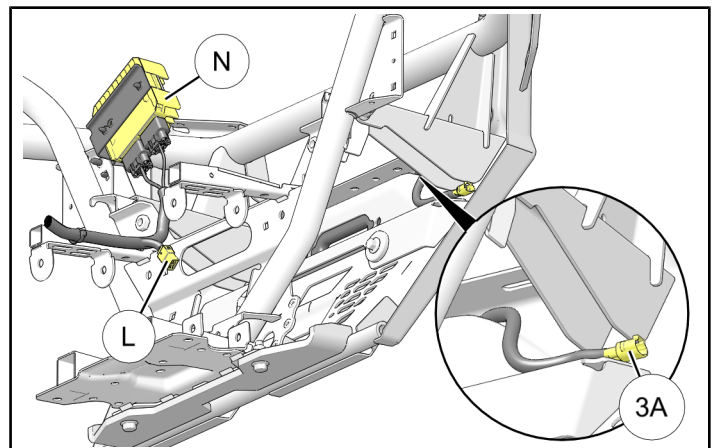

2. Install electrical connections.

NOTICE

See previous section, **HARNES DETAIL** for connector identification.

FACTORY CHOICE

IMPORTANT

Make sure routing prevents harness contact with hot components, sharp edges, or moving parts.

- Join connector 1F on winch (1) to main chassis harness connector (P).
- Join main chassis harness connector (Q) to connector 3A on autostop fairlead (4).

NON-FACTORY CHOICE

- Join connector 1F on winch (1) to connector 3A on autostop fairlead (4).

WINCH COMPONENTS INSTALLATION

1. Thread loop at end of winch rope through jounce bumper ⑥ and magnetic stop ⑦. Make sure stop is oriented with WIDE end (with magnet) towards winch, and BEVELED end (with "POLARIS") towards hook.

TIP

Loop a cable tie to end of rope, but do not tighten. Thread looped cable tie through jounce bumper and magnetic stop, then pull cable tie and rope through jounce bumper and magnetic stop.

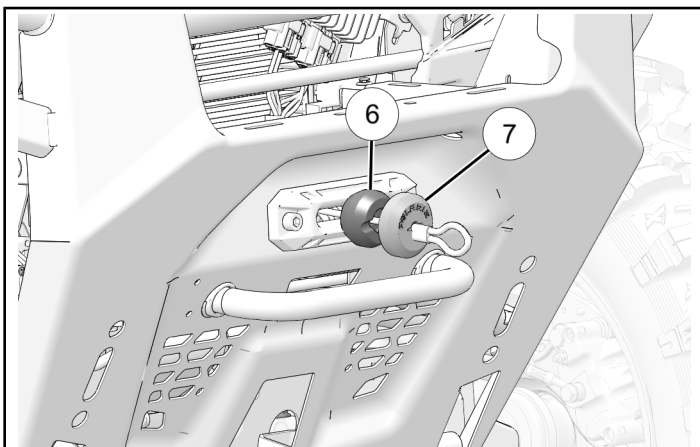

2. Install hook ⑧ to loop at end of rope with clevis and cotter pin. Make sure cotter pin is secured.

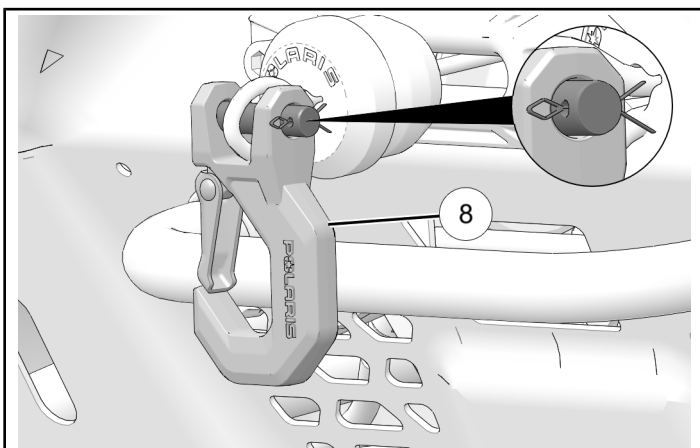
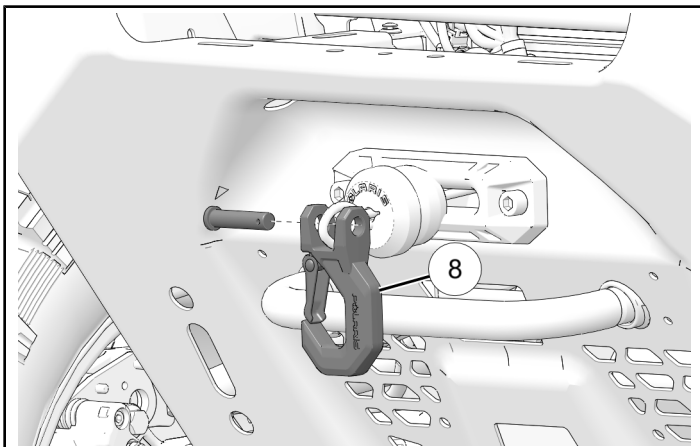

3. Secure all electrical harnesses using cable ties ⑯ as required to prevent contact with hot components, sharp edges, or moving parts.

VEHICLE REASSEMBLY

UPPER DASHBOARD INSTALLATION

1. Put upper dashboard in vehicle.

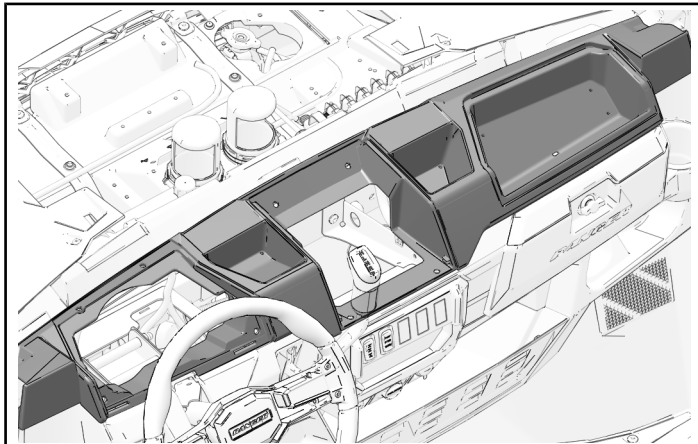

2. Install upper dashboard with two retained push-pin rivets.

TIP

Push-pin rivets are installed above side cup holders.

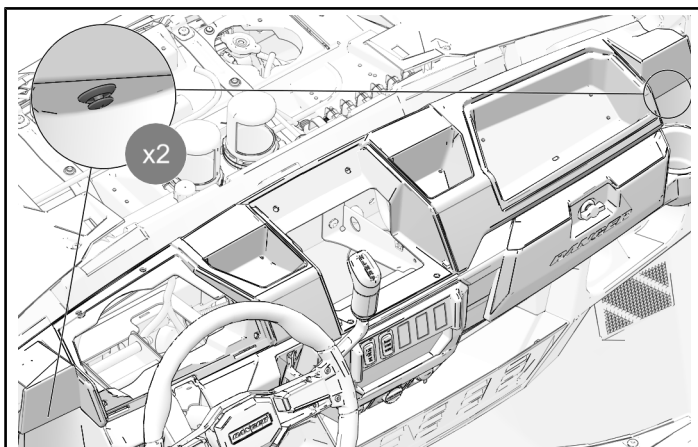

3. Install two retained push-pin rivets on passenger's side of upper dashboard.

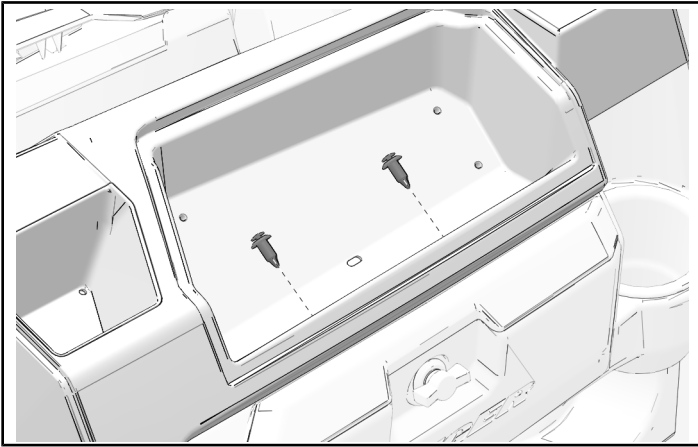

4. Install four retained push-pin rivets on driver's side of upper dashboard.

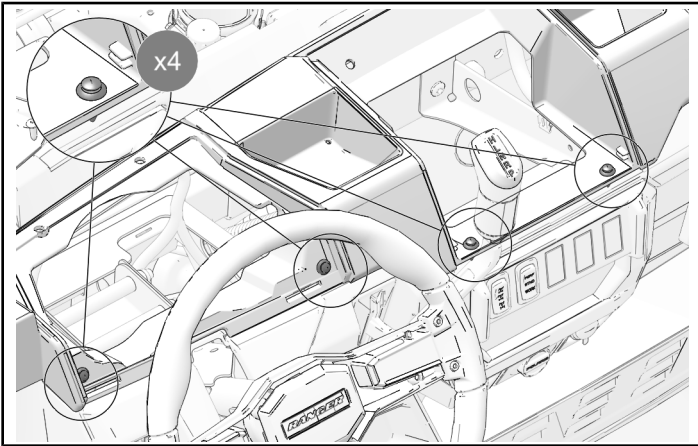

5. Install front of upper dashboard with six retained push-pin rivets.

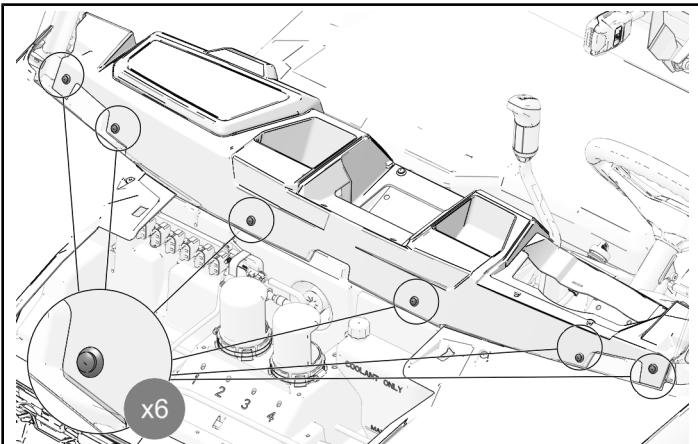

HOOD INSTALLATION

1. Align hood with vehicle and turn two quarter-turn fasteners to lock position and install hood.

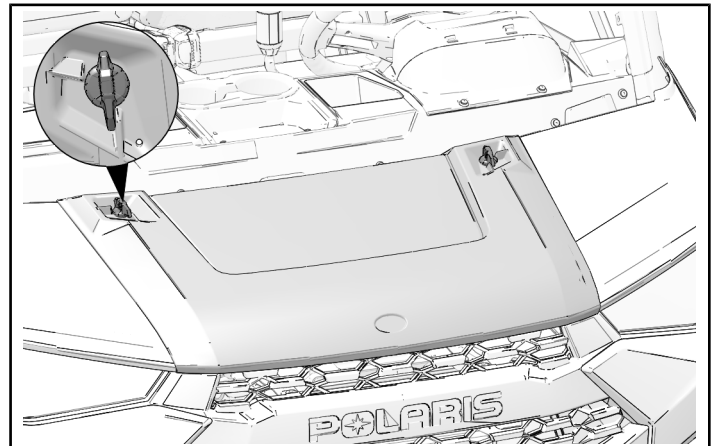

OPERATION

NOTICE

The winch switch ⑪ will only function if a winch has already been properly installed on the vehicle.

The winch switch ⑪ has two functions that activate by pressing the top or bottom of the switch.

- Press the top of the switch (“OUT”) to spool line out from the winch.
- Press the bottom of the switch (“IN”) to spool line in to the winch.

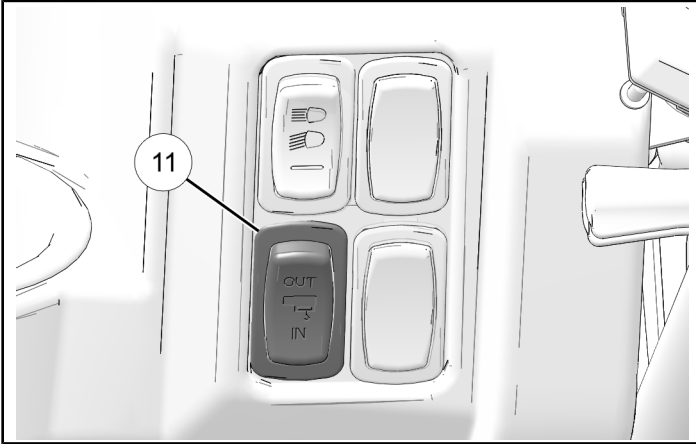

INSTRUCTION FEEDBACK FORM

A feedback form has been created for the installer to provide any comments, questions or concerns about the installation instructions. The form is viewable on mobile devices by scanning the QR code or by clicking [HERE](#) if viewing on a PC.

