

# ADAPTIVE HEADLIGHT KIT



P/N 2884995-156; 2884995-266

## BEFORE YOU BEGIN

Read these instructions and check to be sure all parts and tools are accounted for. Please retain these installation instructions for future reference and parts ordering information.

## APPLICATION

Verify accessory fitment at [www.indianmotorcycle.com](http://www.indianmotorcycle.com).

## KIT CONTENTS

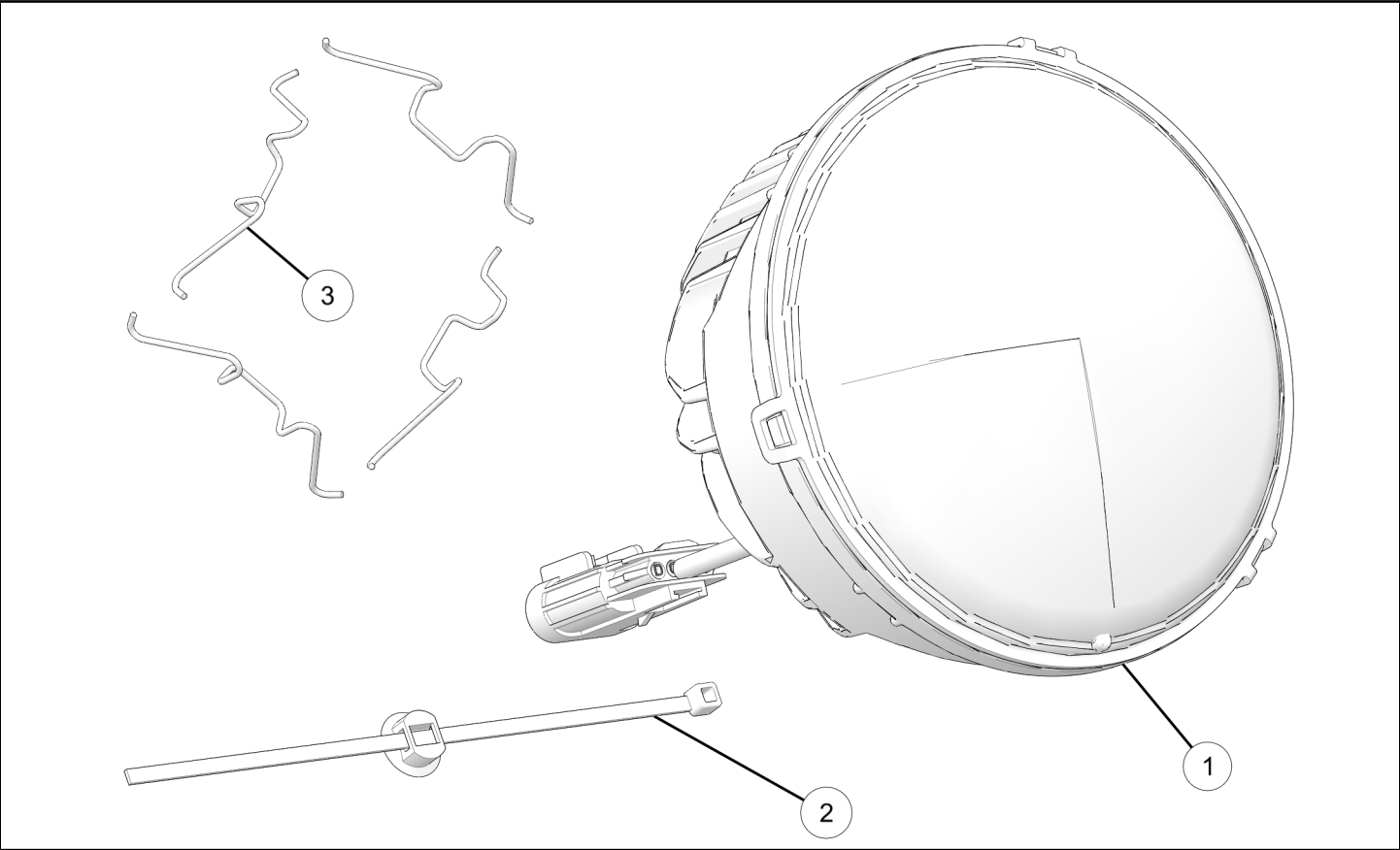

### NOTICE

XXX = Indian Motorcycle® color code (For example: 266 = Black)

REF	QTY	PART DESCRIPTION	P/N AVAILABLE SEPARATELY
1	1	Assembly, Headlight, Adaptive	n/a
2	1	Cable Tie, Push-Pin Clip	7082003
3	4	Clip, Spring, Headlight (Not Used)	5341622

## TOOLS REQUIRED

- Safety Glasses
- Socket Set, Torx® Bit
- Torque Wrench

## IMPORTANT

Your Indian Motorcycle® Adaptive Headlight Kit is exclusively designed for your vehicle. Please read the installation instructions thoroughly before beginning. Installation is easier if the vehicle is clean and free of debris. For your safety, and to ensure a satisfactory installation, perform all installation steps correctly in the sequence shown.

## INSTALLATION INSTRUCTIONS

### VEHICLE PREPARATION

#### GENERAL

1. Park motorcycle on a flat surface, fully extend side stand, and make sure vehicle is stable.
2. Turn key to OFF position and remove key.

#### HEADLIGHT RING REMOVAL

1. Remove headlight ring screw.

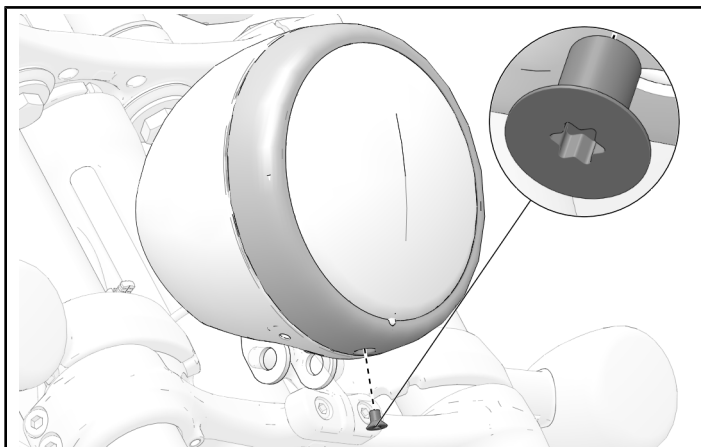

2. Lift and remove headlight and trim ring assembly. Disconnect headlight from harness and carefully set aside.

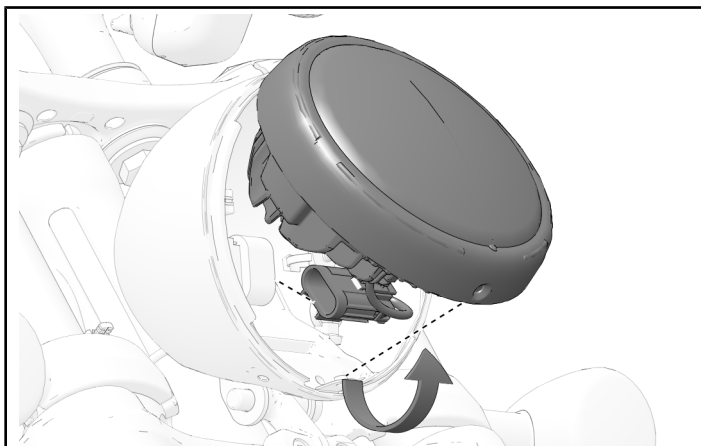

#### HEADLIGHT DISASSEMBLY

1. Separate trim ring and retaining ring from headlight.

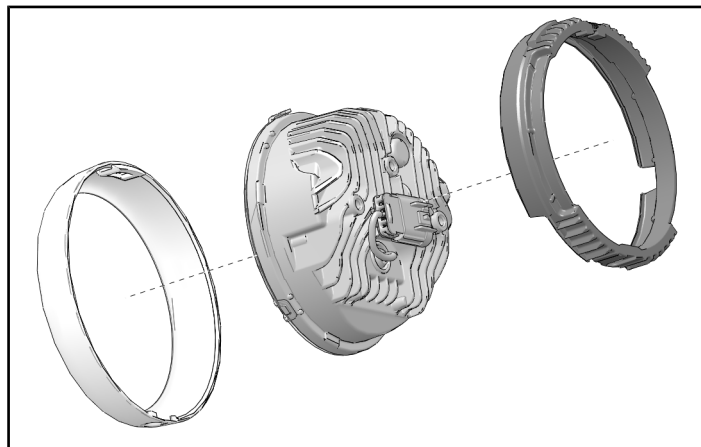

#### ACCESSORY INSTALLATION

1. Assemble trim ring and retainer ring with new headlight assembly ①.

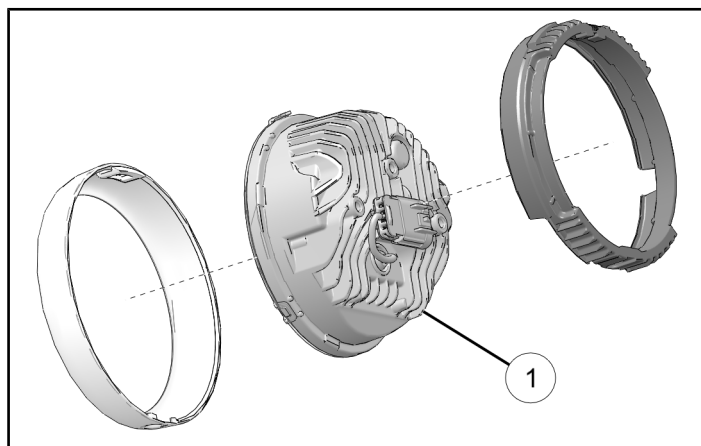

2. Make sure top of headlight ① and “TOP” mark are both aligned with tab of trim ring as shown.

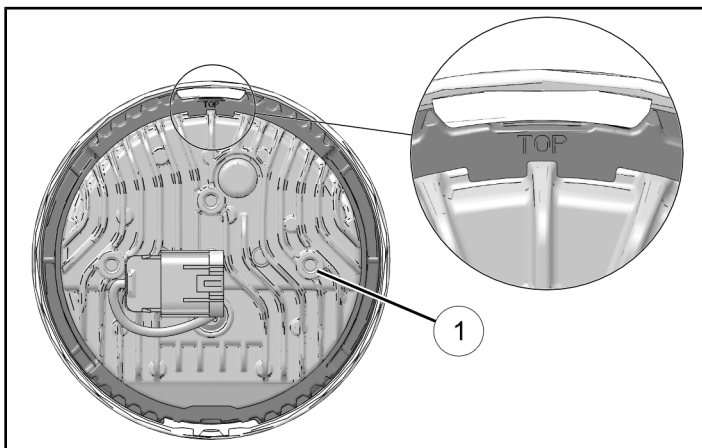

3. Hold headlight assembly together and connect new headlight to bike harness connector.

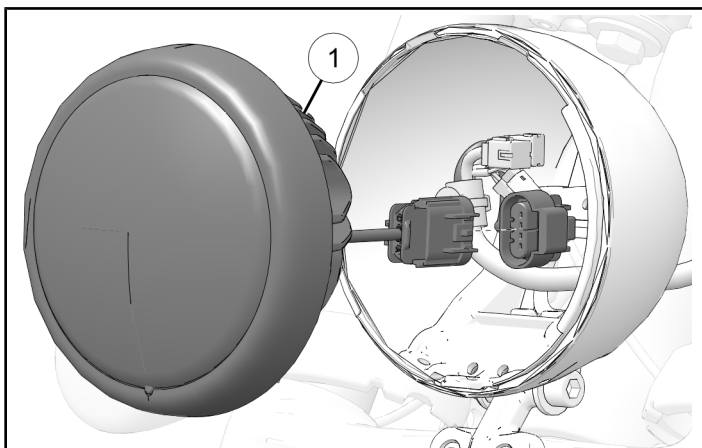

4. Install new push-pin clip cable tie ② to light harness and attach harness to new headlight ① as shown.

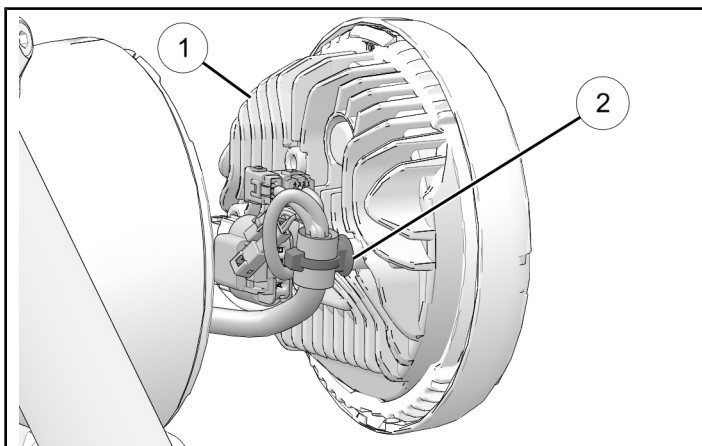

5. Install top of headlight assembly so tabs are aligned and pivot headlight in until it snaps into place.

#### IMPORTANT

Make sure wiring is completely inside of headlight housing.

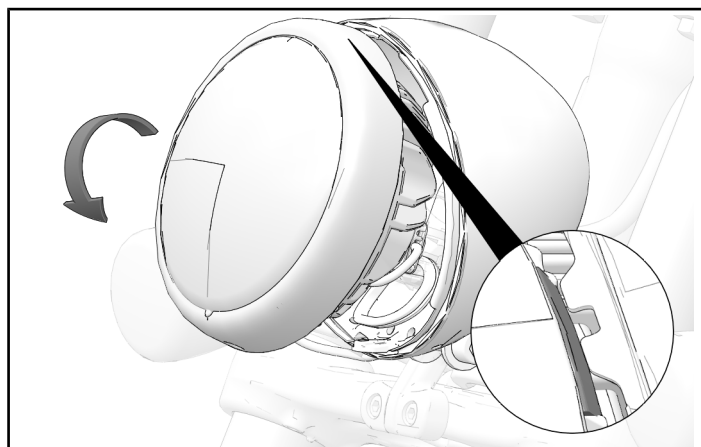

6. Attach headlight assembly with retained screw. Torque screw to specification.

#### TORQUE

Headlight Bezel Screw:  
27 in-lbs (3 N·m)

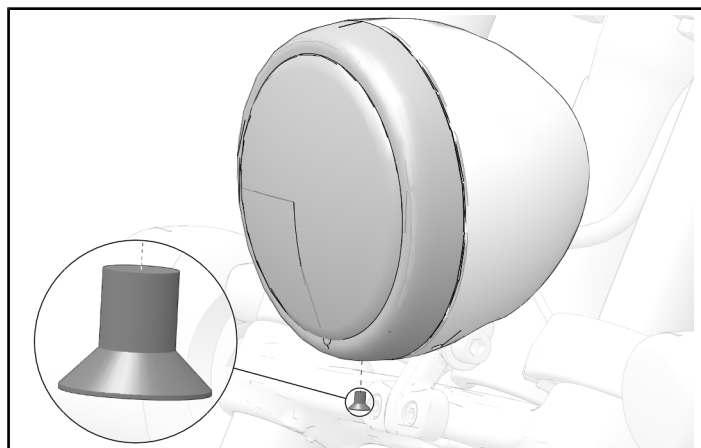

LED HEADLIGHT AIMING AND INSPECTION

LED HEADLIGHT AIM INSPECTION PROCEDURE

IMPORTANT

Adjust headlight and aim when there is a change in load (rider, cargo, accessories, etc.) and /or after suspension adjustment.

- Follow all steps below to ensure accurate aim inspection.
1. Check and adjust the tire pressure to specification.
  2. Verify suspension ride height (preload) is set to specification.
  3. Move the motorcycle to a clear area with a level floor and dim lighting, and place it so the top front edge of the headlight housing is 32 ft10 in (10 m) from the wall.
  4. With the rider and passenger (if applicable) on board, bring the motorcycle to a fully upright position. Center the handlebars in a straight ahead position.
  5. Start the engine and switch the headlight on in LOW mode.
  6. Compare the position of headlight beam on the wall to the illustration below and adjust if necessary.

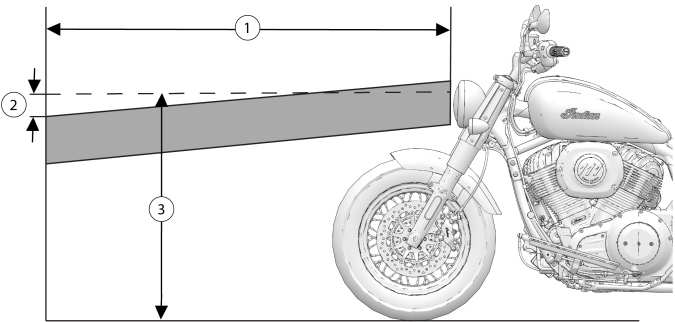

INSTRUCTION FEEDBACK FORM

A feedback form has been created for the installer to provide any comments, questions or concerns about the installation instructions. The form is viewable on mobile devices by scanning the QR Code® or by clicking [HERE](#) if viewing on a PC.

With the headlight switched to LOW beam, the top of the highest intensity (appears as a diamond shape for standard LED and a horizontal line for adaptive LED) should be 4 in (10 cm) below the height of the headlight center ③ when centered straight ahead at 32 ft10 in (10 m).

LOCATION	MEASUREMENT
①	32 ft 10 in (10 m)
②	4 in (10 cm)
③	Headlight Center

HEADLIGHT AIM ADJUSTMENT

The headlight adjustment screw is located on the left side of the headlight housing base.

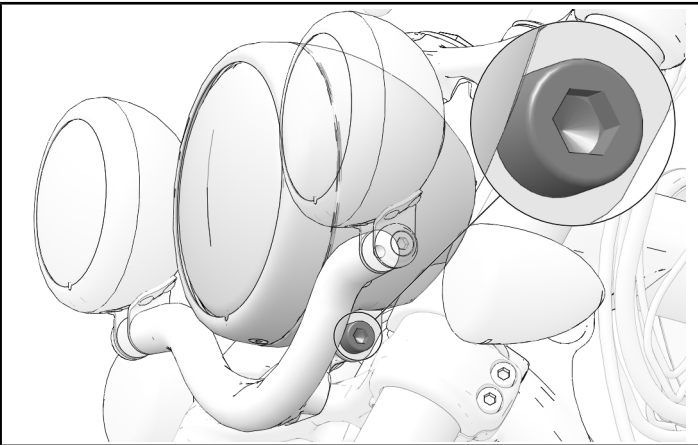

1. To adjust the headlight vertically, loosen the headlight pivot fastener. Rotate the headlight assembly upward or downward.
2. When the headlight beam is correct, tighten the fastener to specification.

TORQUE
Headlight Pivot Fastener: 29 ft-lbs (40 N·m)

