

EXCURSION TOP KIT



P/N 2889466

IMPORTANT

Due to the technical nature of this kit, Polaris® insists that this installation be performed by a certified Slingshot® technician.

BEFORE YOU BEGIN

Read these instructions and check to be sure all parts and tools are accounted for. Please retain these installation instructions for future reference and parts ordering information.

APPLICATION

Verify accessory fitment at www.polarisslingshot.com.

INSTALLATION VIDEO

A video of the installation is viewable on mobile devices by scanning the QR code or by clicking [HERE](#) if viewing on a PC.



DISCLAIMER ACCESSORY WEIGHT

When adding accessories, equipment, passengers and luggage to your vehicle, do not exceed the total weight capacity of the vehicle or of the front or rear axle (GVWR or GAWR as indicated on the Safety Compliance Certification label). Ask an authorized dealer for specific weight information if you need assistance. It is the owner's responsibility to use the Polaris Slingshot Accessories website as a tool for limiting the amount of accessories, based on maximum allowable vehicle weight requirements. It may be a violation of the Clean Air Act or the NHTSA regulations to disregard these requirements. For a complete listing of the accessories that are available for your vehicle, please contact your authorized dealer or visit the online store web site: Web Address (United States): <http://www.polaris.com/en-us/slingshot/shop/accessories>.

KIT CONTENTS

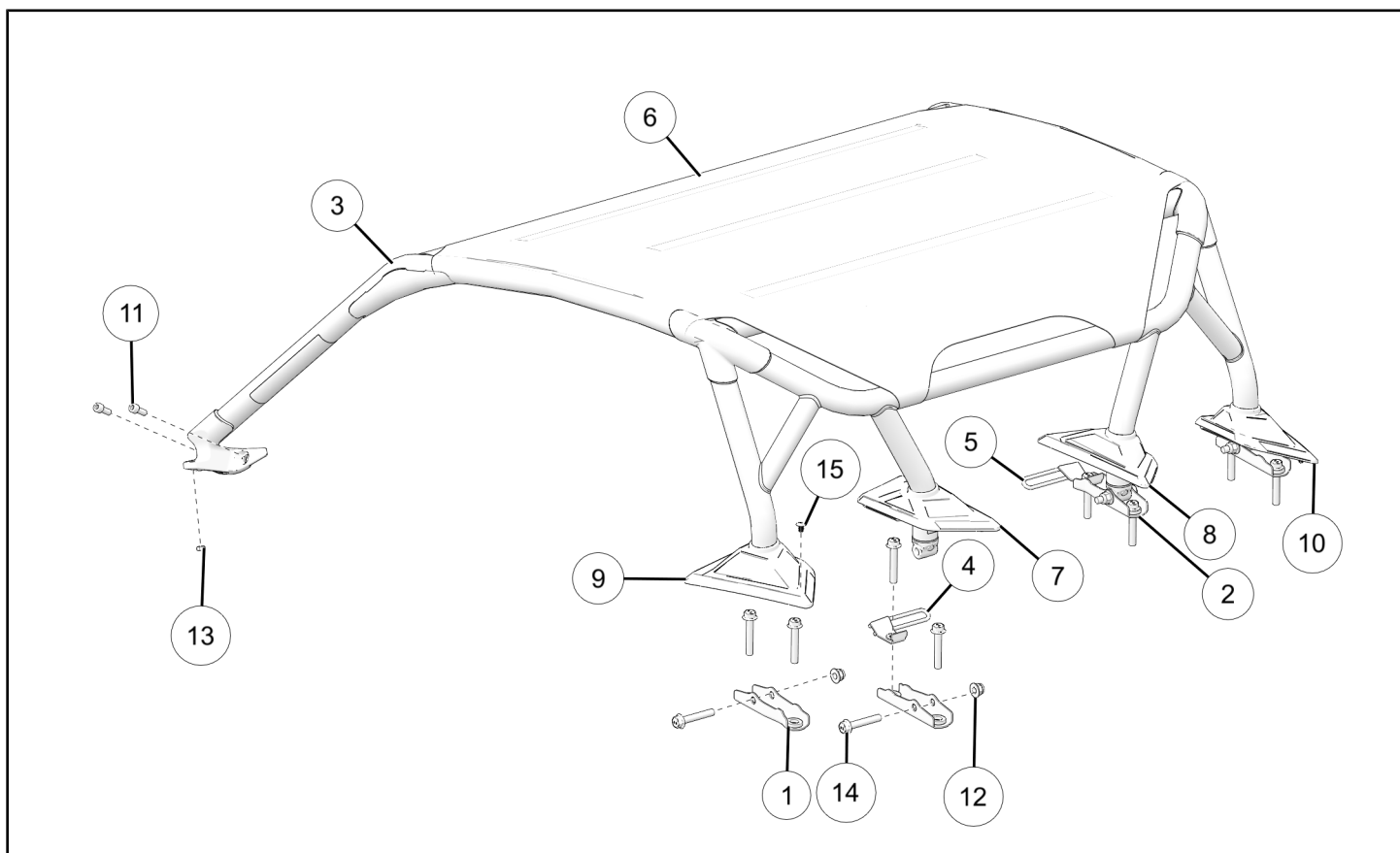

REF	QTY	PART DESCRIPTION	P/N AVAILABLE SEPARATELY
1	2	Weld – Mount, Rear, Left	1027101
2	2	Weld – Mount, Rear, Right	1027102
3	1	Assembly – Excursion Frame	n/a
4	1	Guide, Seat Belt, Left-Hand	2637686
5	1	Guide, Seat Belt, Right-Hand	2637687
6	1	Top, Excursion	2889509
7	1	Cover – Excursion Top, Inner, Left	5418275
8	1	Cover – Excursion Top, Inner, Right	5418276
9	1	Cover – Excursion Top, Outer, Left	5418277
10	1	Cover – Excursion Top, Outer, Right	5418278
11	4	Screw, Socket Head, M10 x 1.5 x 25 mm	7519890
12	12	Nut, Hex, Flanged, M12 x 1.75 mm	7547441
13	2	Nut, Hex, M8 x 1.25 mm	7547076
14	12	Screw, Hex, Flange Head, M12 x 1.75 x 70 mm	7521334-70
15	6	Clip, Push Pin Rivet, Nylon	7670088
16	1	Template – Excursion Top, Boots (not shown)	9940665

TOOLS REQUIRED

- Safety Glasses
- Drill
- Drill Bit:
 - 1/4 in (6 mm)
- Drill Stop
- Flexible Magnetic Pickup Tool
- Pick and Hook Set
- Pliers, Arc Joint
- Pry Tool
- Push Dart (Panel Clip) Tool
- Scissors
- Service Manual
- Socket Set, Hex Bit, Metric
- Socket Set, Metric
- Socket Set, Torx® Bit
- Tape Measure
- Torque Wrench
- Wrench Set, Metric
- **Special Service Tool:**
 - Non-marring Pry Tool, P/N 5456907 (or equivalent)

IMPORTANT

Your Excursion Top Kit is exclusively designed for your vehicle. Please read the installation instructions thoroughly before beginning. Installation is easier if the vehicle is clean and free of debris. For your safety, and to ensure a satisfactory installation, perform all installation steps correctly in the sequence shown.

INSTALLATION INSTRUCTIONS

VEHICLE PREPARATION

GENERAL

1. Park vehicle on a flat surface.
2. Shift vehicle to NEUTRAL.
3. Press START/STOP button to turn vehicle OFF.
4. Apply parking brake.
5. Remove key fob from proximity of vehicle.

OPEN HOOD

WARNING

Do not grab plastic directly above the hood release lever to open the hood. This may damage the hood.

1. Make sure parking brake is applied.

2. Pull hood release lever upward to disengage four hood latches.

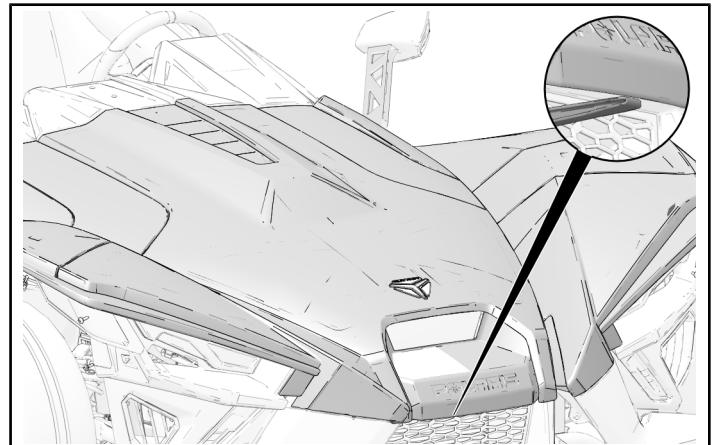

3. Pull upwards on hood underside, above LED lamp, using two hands.

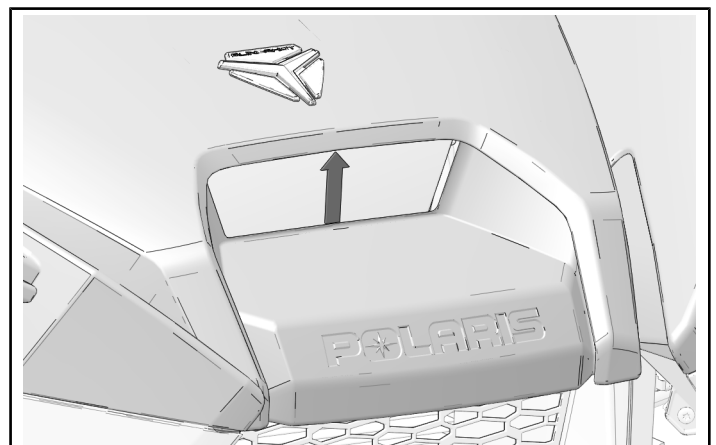

4. Pull hood upward and forward, rotating hood to a vertical position.

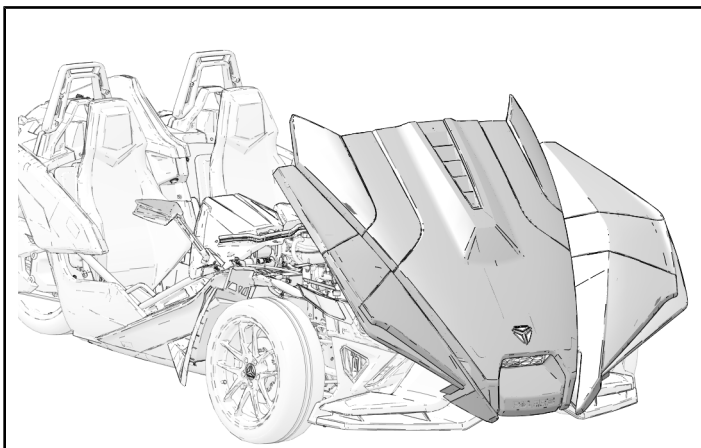

EXCURSION TOP SIDE MIRROR REMOVAL

1. Remove one mirror fastener to remove side mirror.

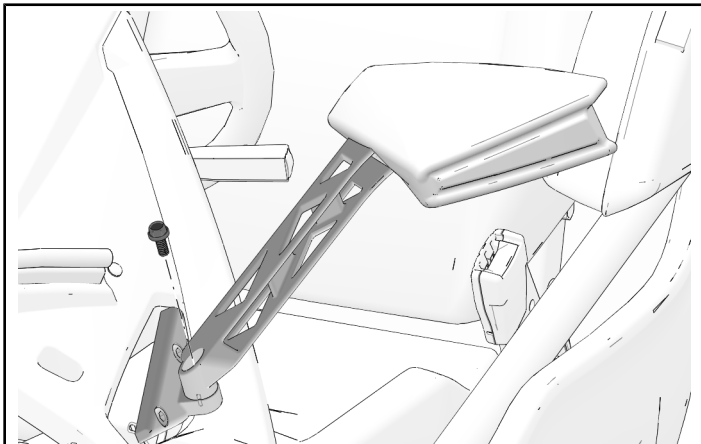

2. Remove two mounting plate fasteners and mounting plate from vehicle.

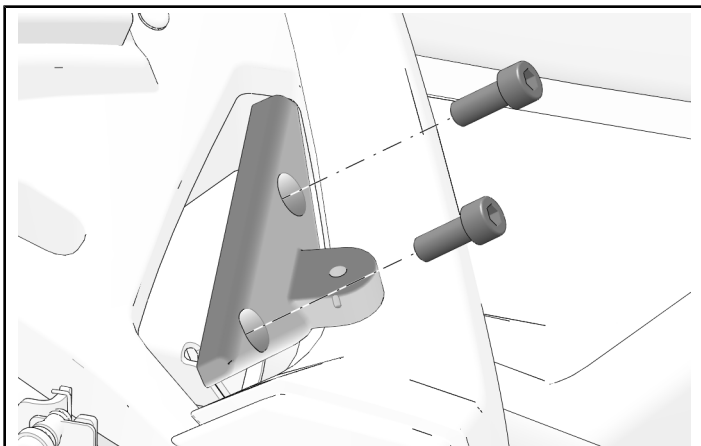

3. Discard rubber damper.

SIDE TRIM REMOVAL

NOTICE

Right side shown, left side similar.

1. Remove two side trim fasteners (A).

NOTICE

Open glove box door to access right side fasteners.

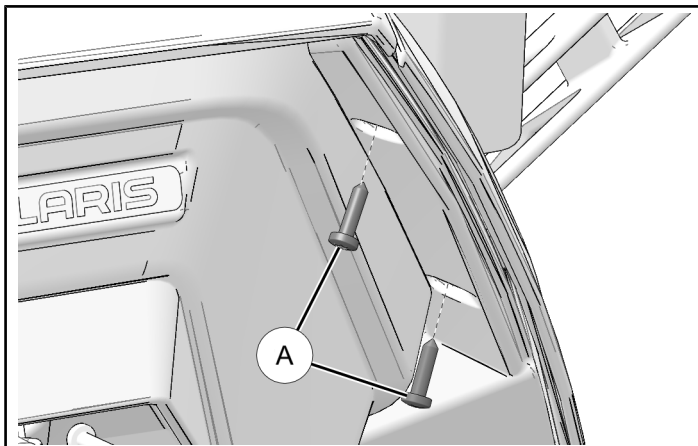

2. Remove two push pin rivets (B) from underside of trim piece.

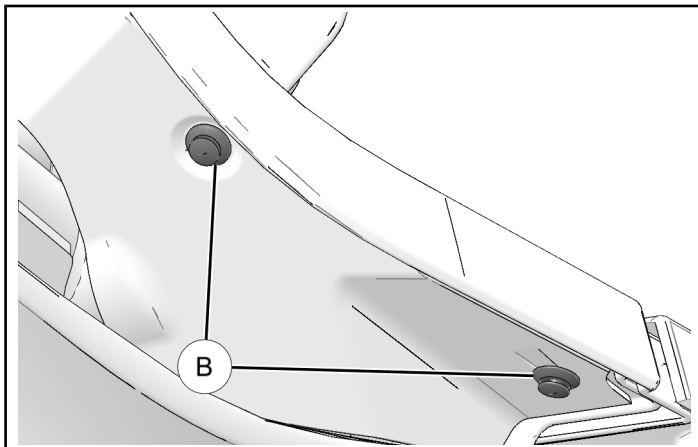

3. Gently pry side panel away from vehicle.

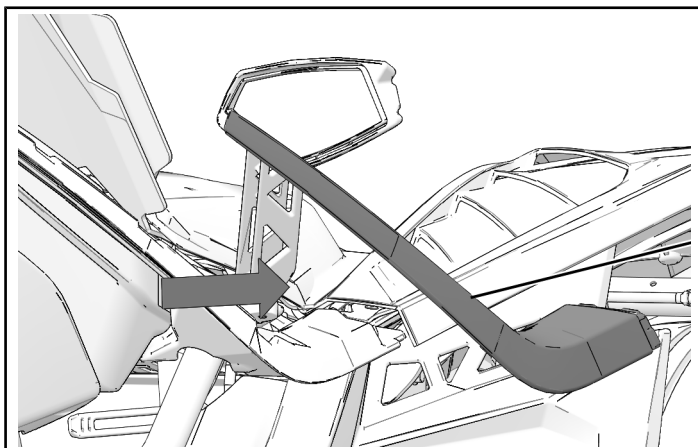

IDENTIFY ROLL HOOPS

IMPORTANT

Identify which type of roll hoop the vehicle is equipped with, then perform the appropriate vehicle preparation.

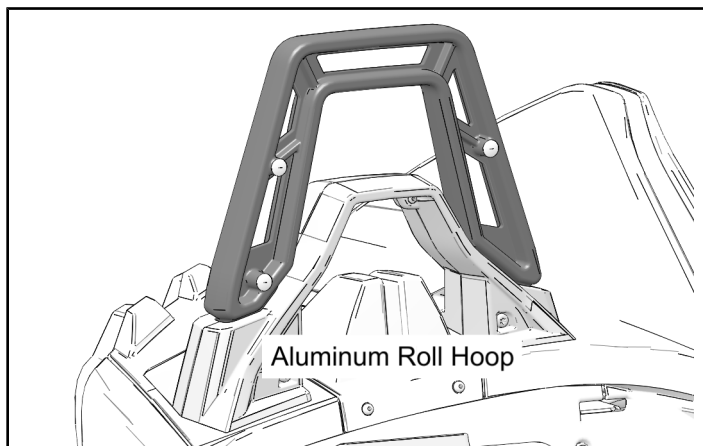
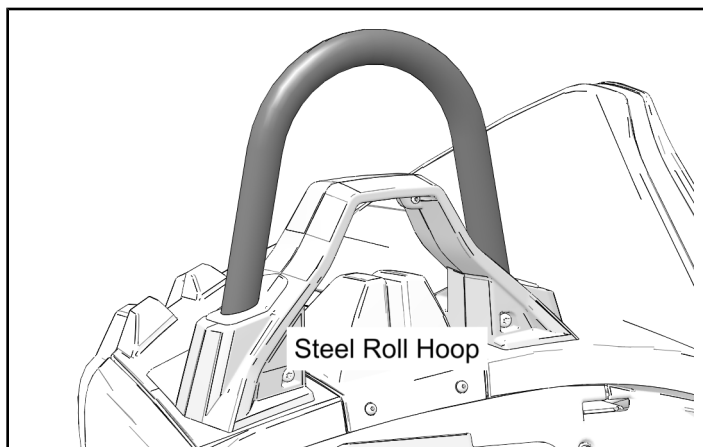

INSTALLATION PREPARATION FOR MODELS EQUIPPED WITH STEEL ROLL HOOPS

TIP

Move seats all the way forward to ease roll hoop and deck removal.

ROLL HOOP COVER REMOVAL

NOTICE

Right roll hoop cover shown; left cover similar.

1. Remove two upper cover fasteners.

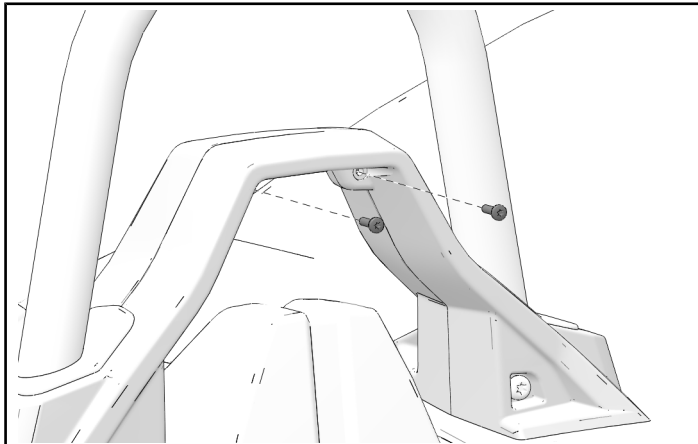

2. Remove two lower cover fasteners.

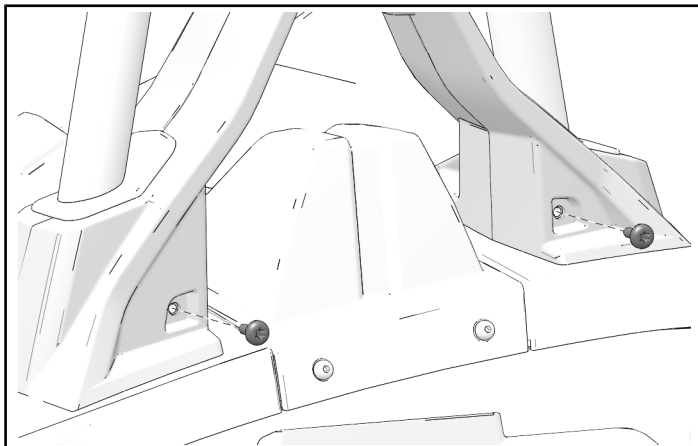

3. Remove two rear cover fasteners.

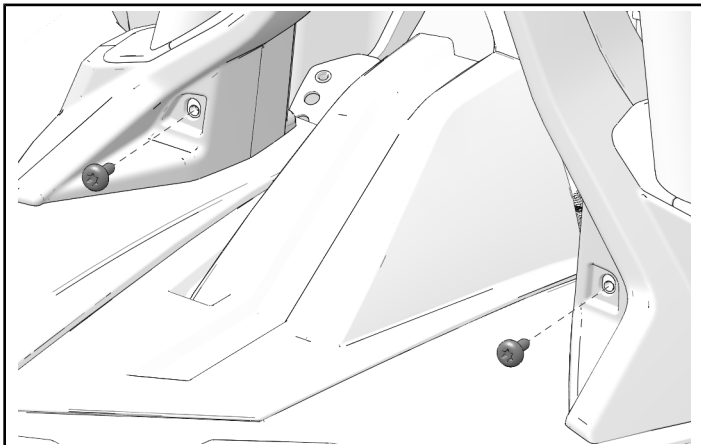

2. Remove two deck hump retainer screws (C).

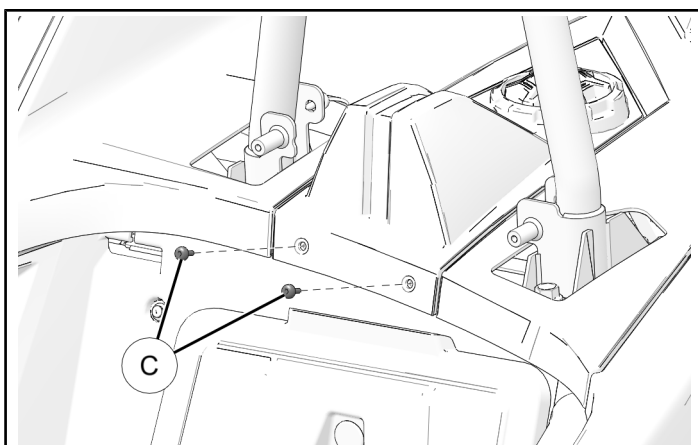

4. Remove front and rear covers from roll hoop.

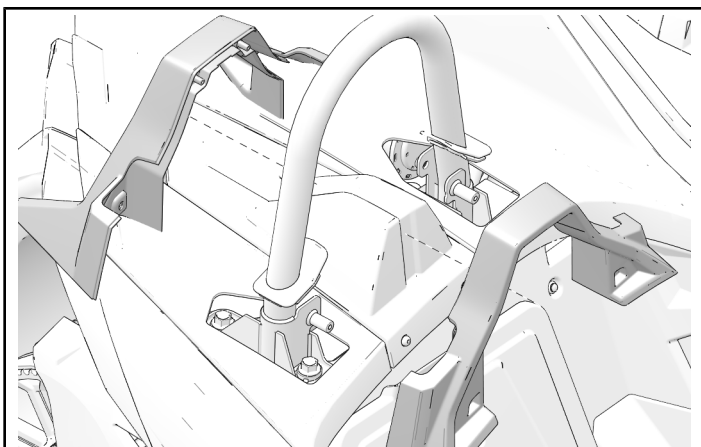

3. Pull deck hump (D) forward slightly the lift front of deck up to remove from vehicle.

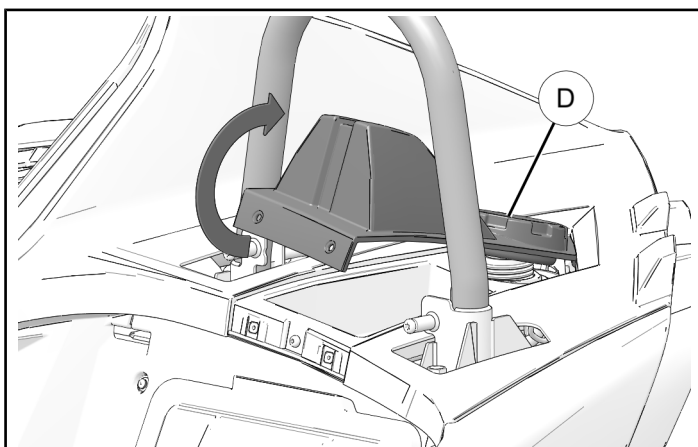

REMOVE DECK HUMPS

1. Remove fuel cap (A) and fuel tank retainer nut (B).

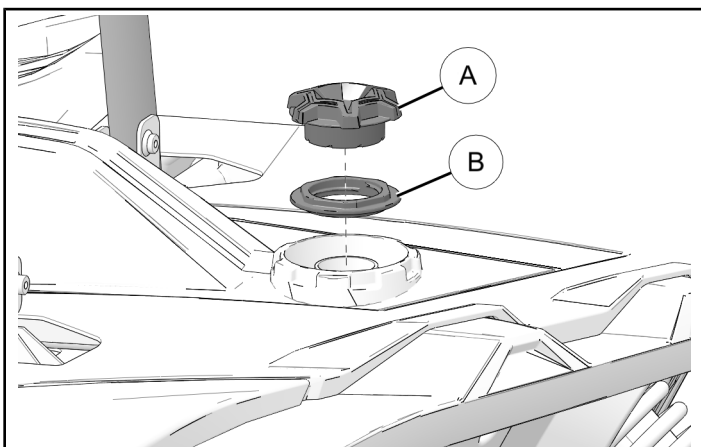

4. Re-install fuel cap to prevent debris from entering fuel tank.

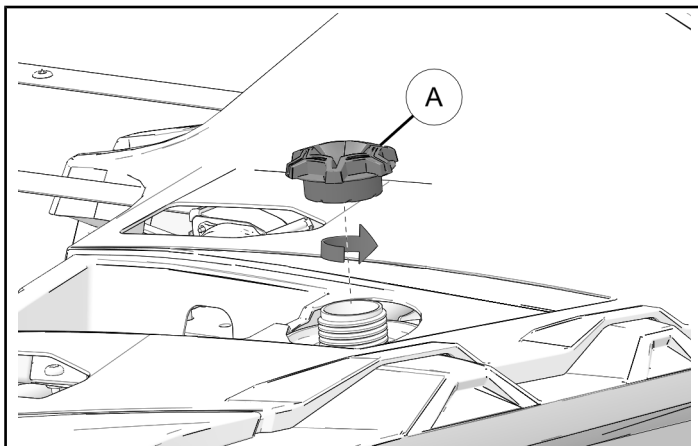

5. Remove two deck hump retainer screws (E).

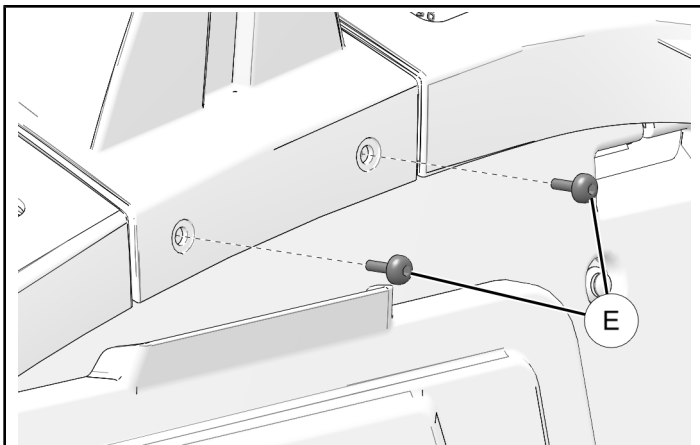

2. Remove rubber grommets if present.

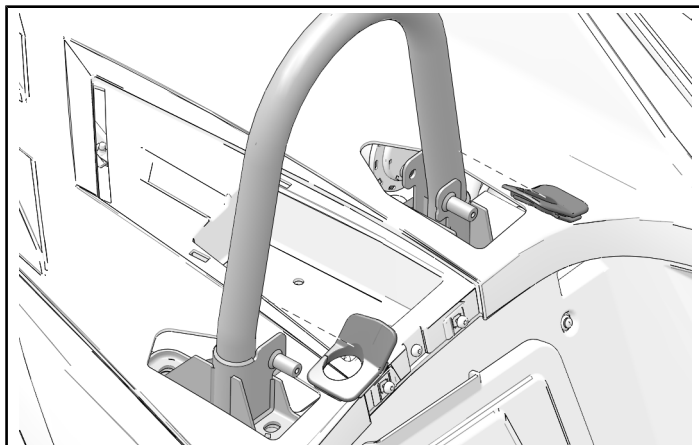

6. Pull deck hump (F) forward slightly the lift front of deck up to remove from vehicle.

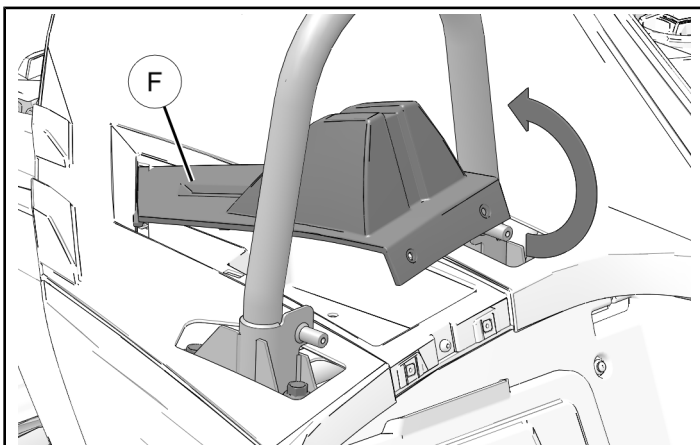

3. Remove roll hoop from vehicle.

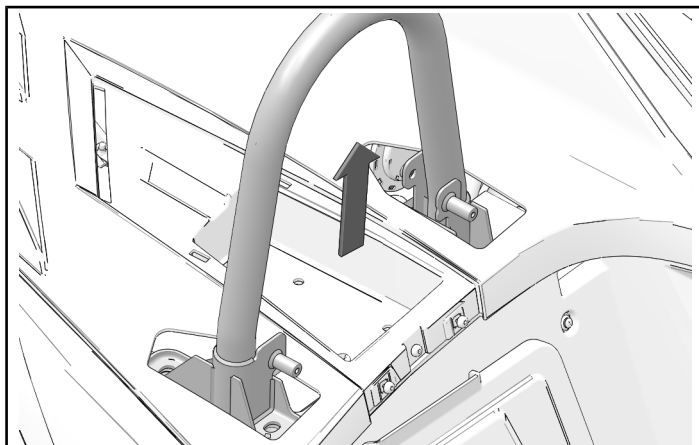

REMOVE STEEL ROLL HOOPS

NOTICE

Right roll hoop shown; left roll hoop similar.

1. Remove four roll hoop fasteners.

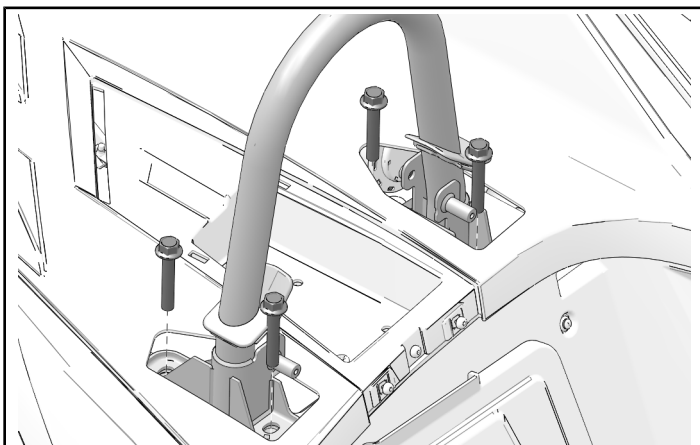

REMOVE REAR LOWER COVER

1. Remove and keep nine fasteners (A) from rear lower cover.

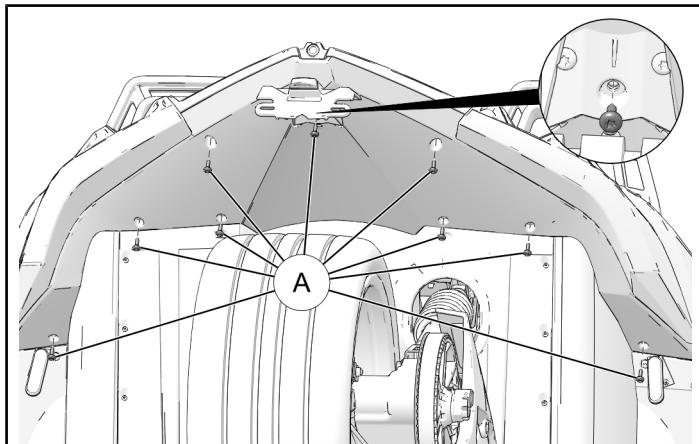

2. Lower panel from vehicle and disconnect any electrical connectors. Carefully set aside panel.

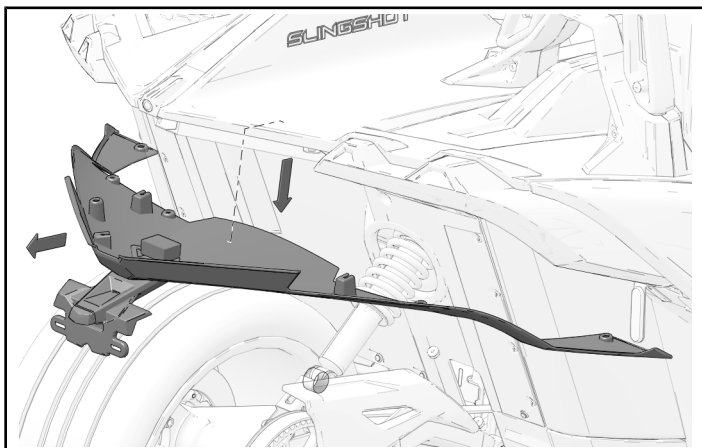

REAR DECK REMOVAL

1. Remove and keep two push pin rivets (A) under wing panel.

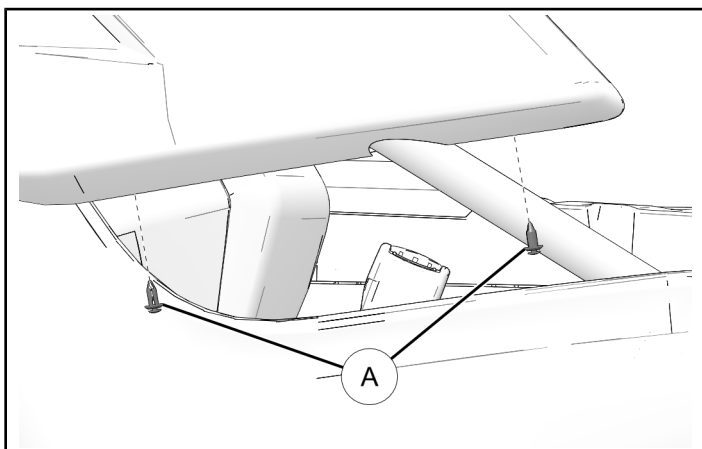

2. Remove and keep two fasteners (B) under wing panel.

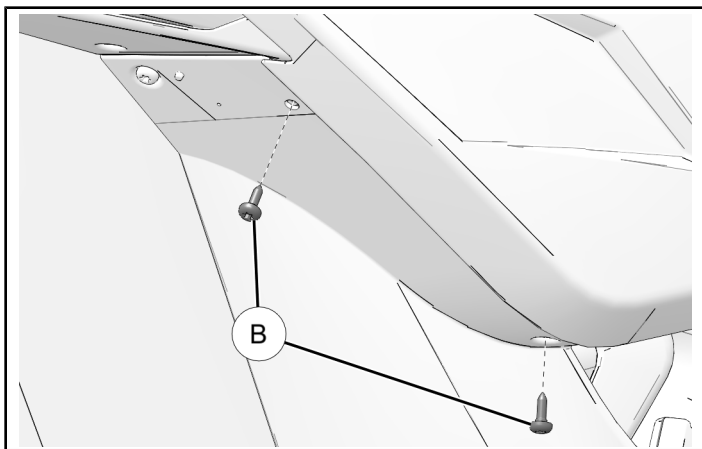

3. Remove upper body trim piece (C).

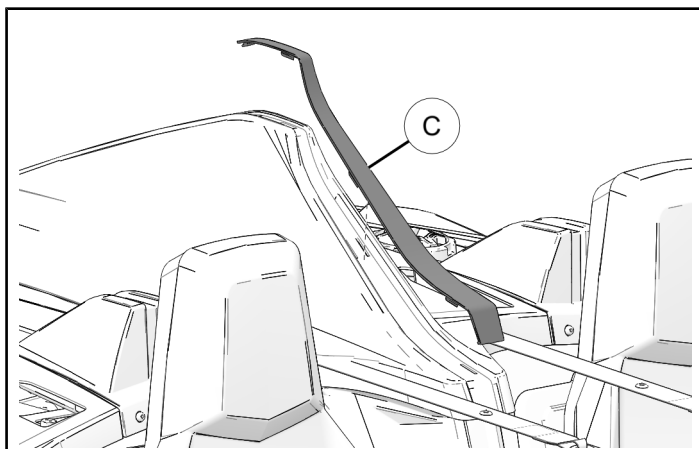

4. Remove trim piece at rear of upper body. If equipped with rear back-up camera, disconnect electrical connector.

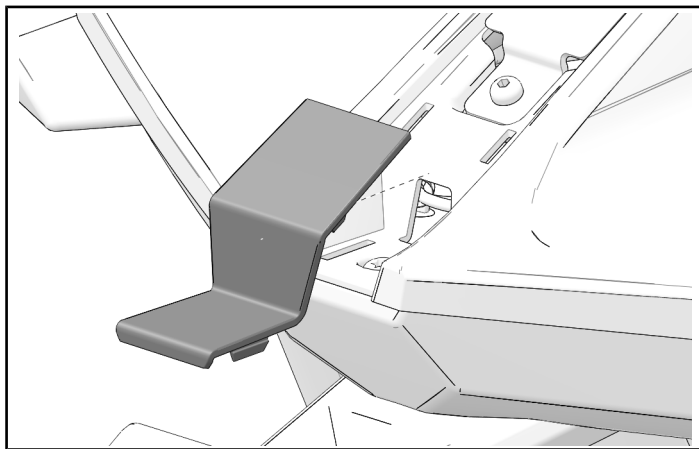

5. Remove and keep upper body trim fasteners (D) and lift trim piece (E) away from vehicle. If equipped with center tail lamp, disconnect electrical connector.

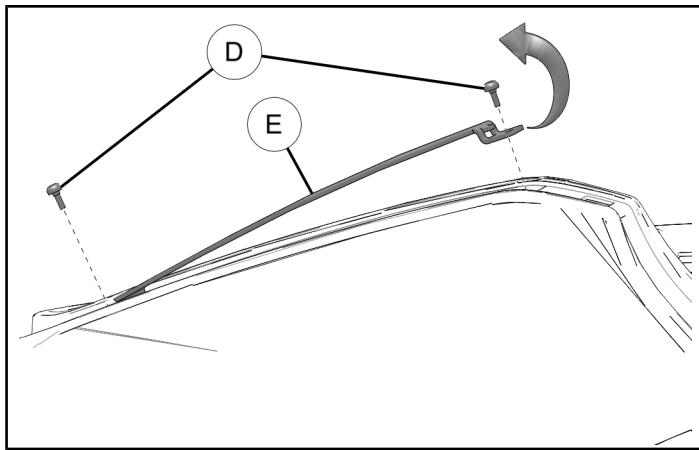

6. Remove fasteners ⑥ at the front of deck hump.

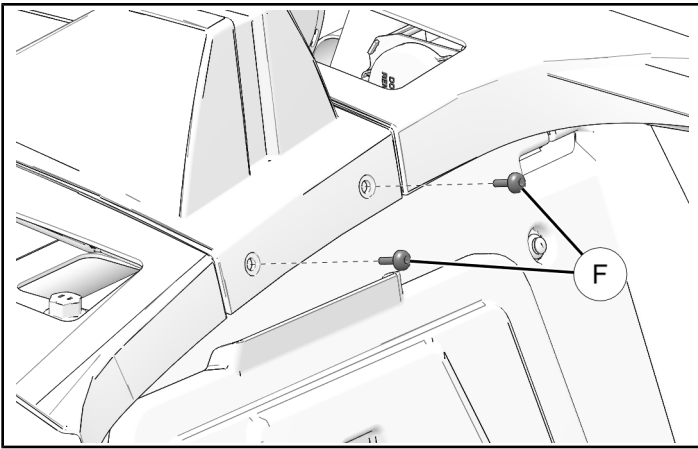

7. Lift deck hump ⑦ away from vehicle.

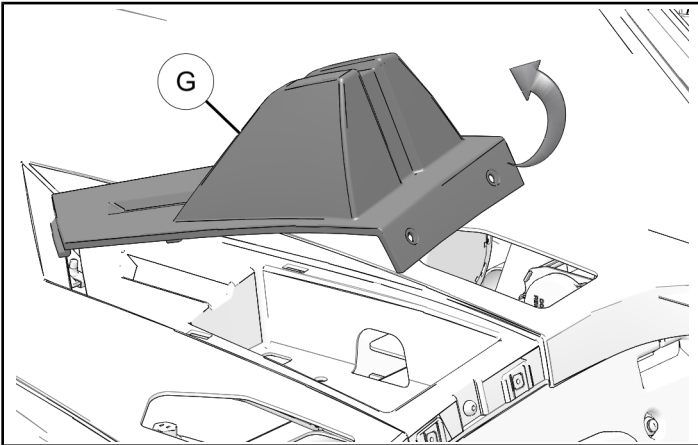

8. Remove fastener ⑧ under deck hump.

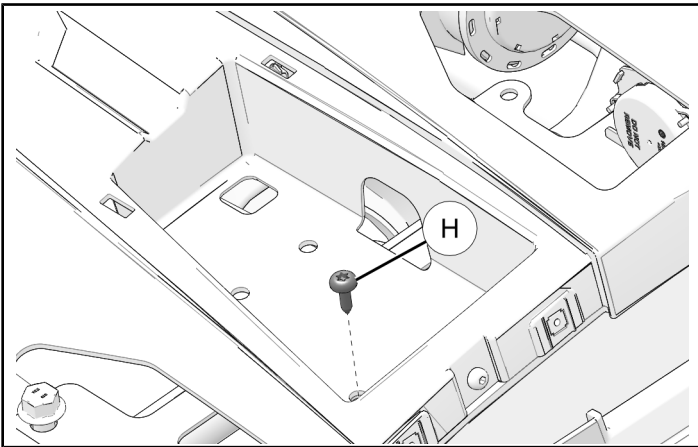

9. Remove gas cap ① and gas filler neck retaining nut ②.

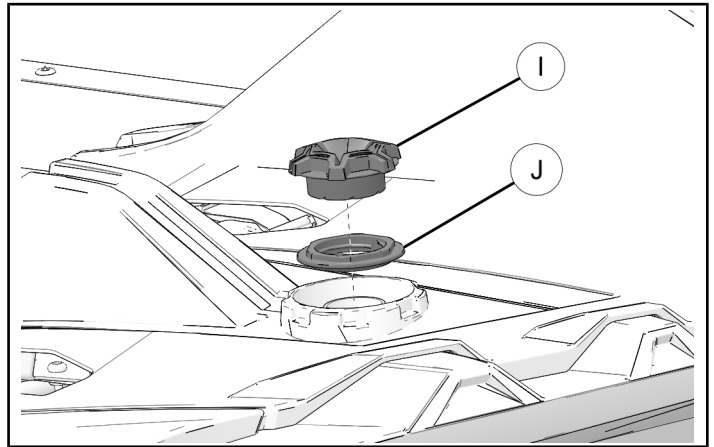

10. Remove left side deck hump fasteners ③.

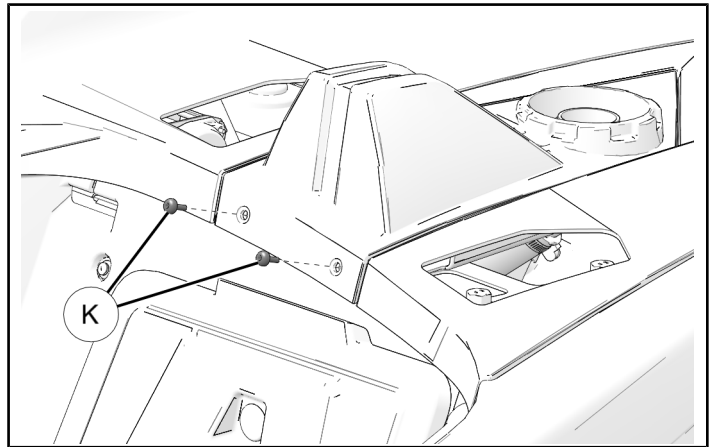

11. Remove left side deck hump ④.

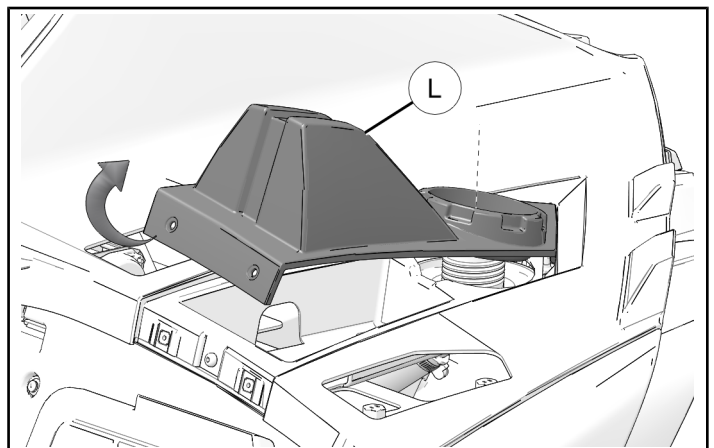

12. Install fuel cap ① to prevent debris from entering fuel tank.

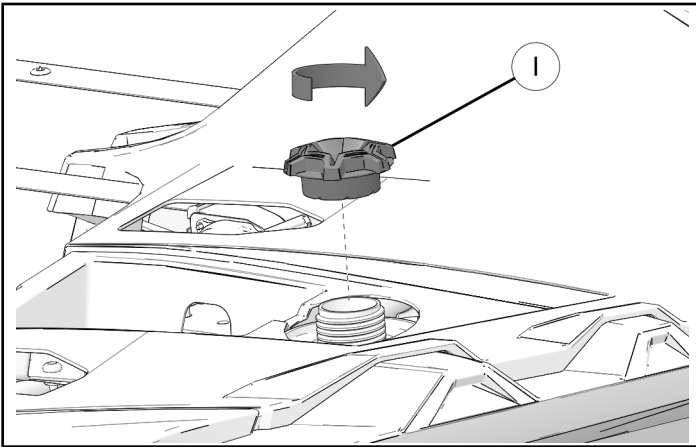

13. Remove fastener ③ under deck hump.

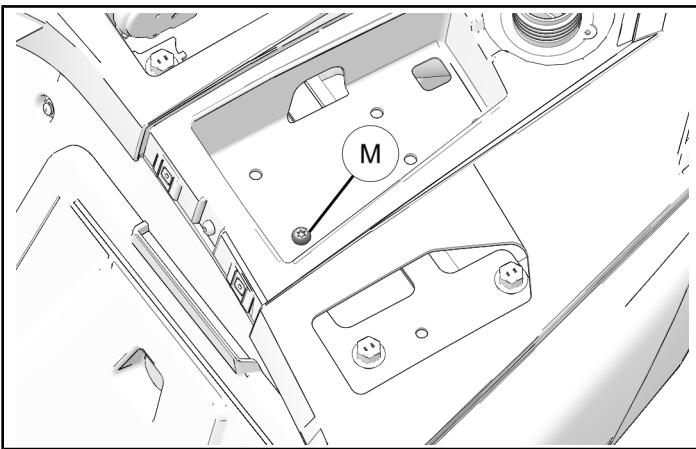

14. Remove fastener ④ at rear of deck.

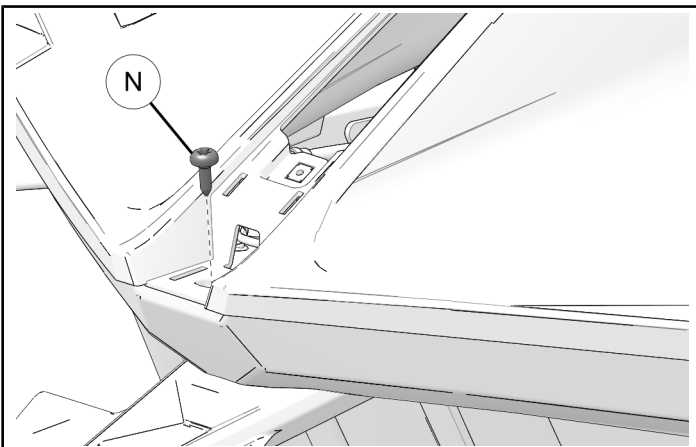

15. Remove screw ⑤ located behind headrest.

NOTICE

Right side shown, left side similar.

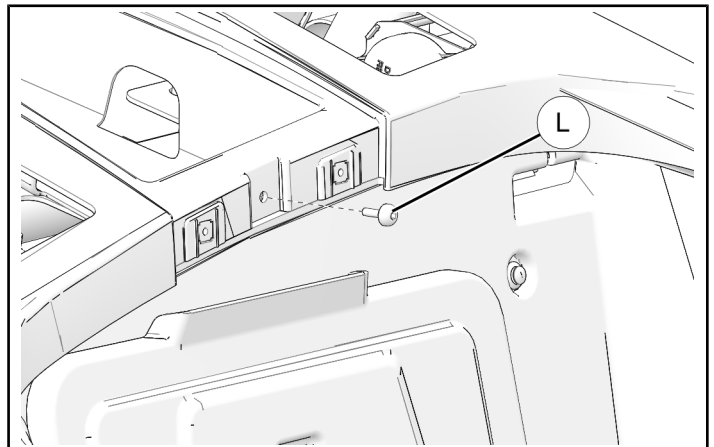

16. Remove two screws ⑥ from rear of deck.

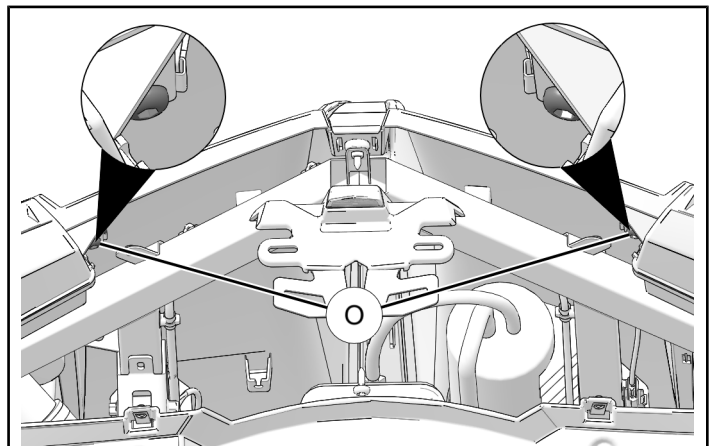

17. Remove screw ⑦ from front center of rear deck.

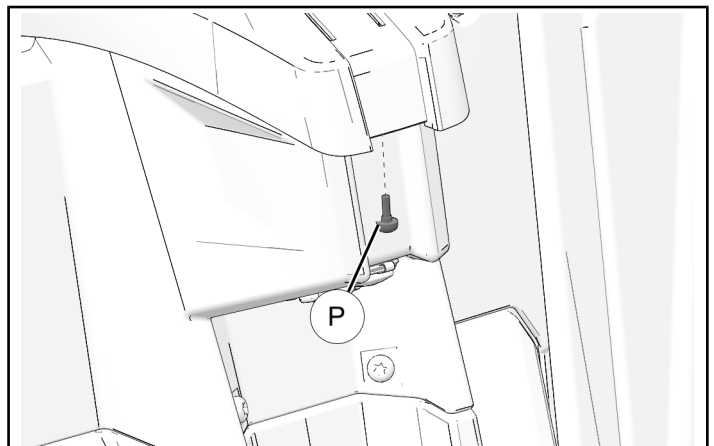

18. Pull out on side wings and lift rear deck away from vehicle.

IMPORTANT

Deck removal requires two people.

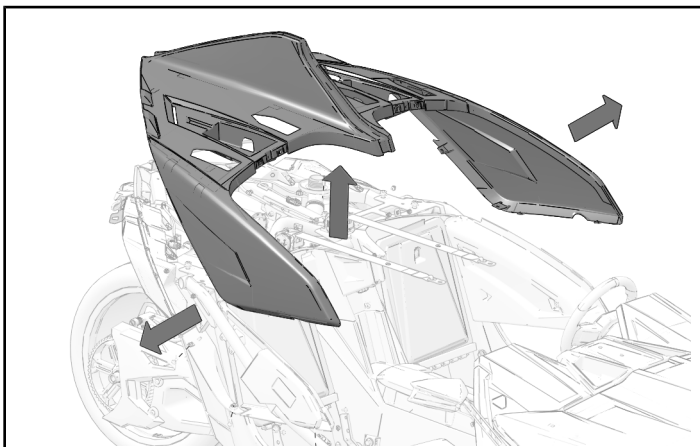

SEAT BELT GUIDE REMOVAL

NOTICE

Right seat belt shown; left seat belt similar.

IMPORTANT

Note seat belt orientation before beginning.

1. Remove one fastener and one washer from lower mounting bracket.

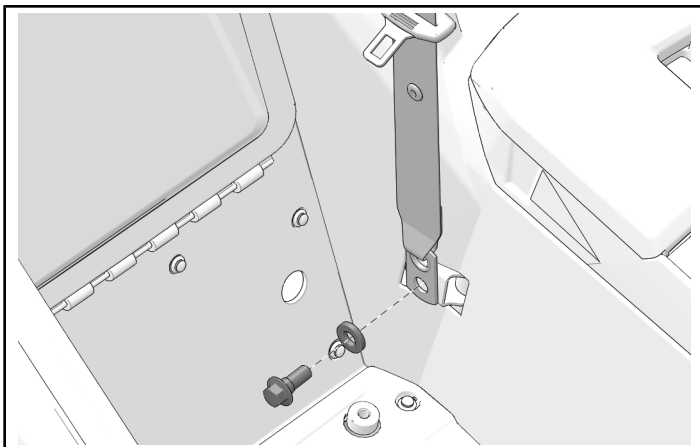

2. Pull seat belt through seat belt guide.

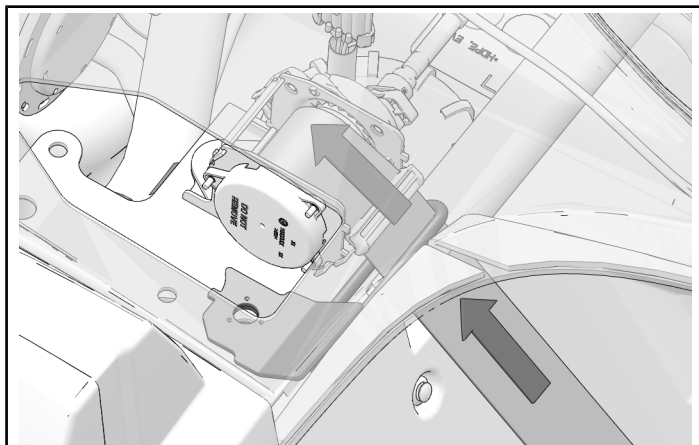

3. Remove seat belt guide from vehicle.

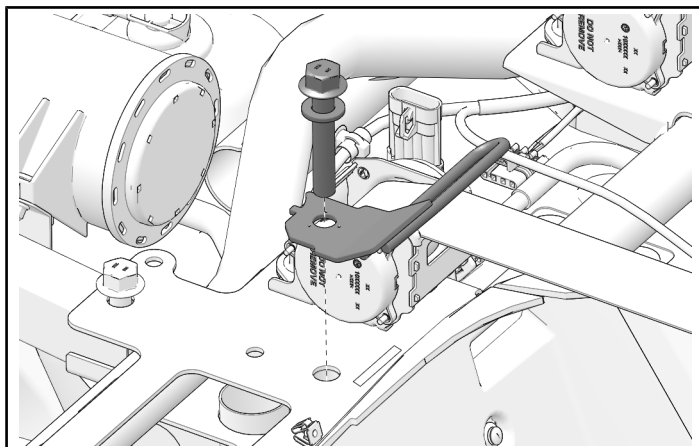

INSTALL NEW SEAT BELT GUIDE

NOTICE

Right side shown, left side similar.

1. Route seat belt through new seat belt guide ⑤.

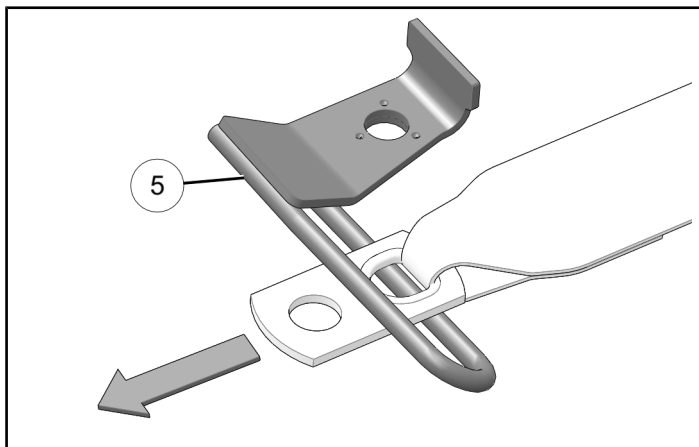

2. Install seat belt. Make sure seat belt mount washer is centered on bolt shoulder and seat belt mount pivots freely around mounting bolt.

TIP

When installing seat belt, pull belt straight out, then turn belt 1/4 turn toward the outside of the vehicle.

IMPORTANT

Make sure seat belt lays flat. If seat belt is twisted, reconfigure until it lays flat when installed.

TORQUE

Seat Belt Fastener:
40 ft-lbs (54 N·m)

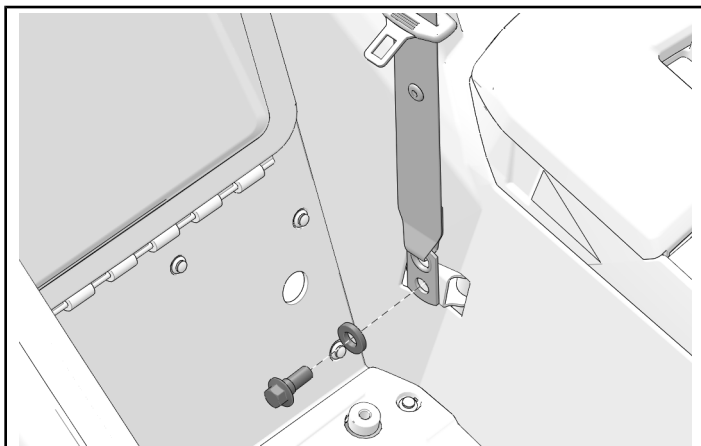
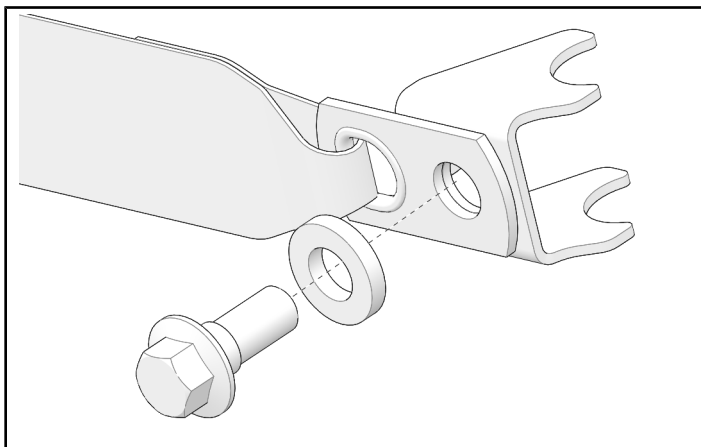

REAR DECK INSTALLATION

1. Pull out on side panels and put rear deck in position on vehicle.

IMPORTANT

Deck installation requires two people.

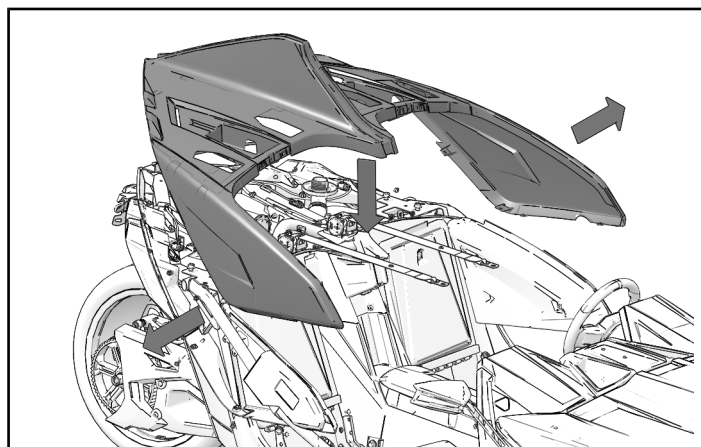

2. Install two screws ① under rear of deck.

NOTICE

Fasteners ① are shorter and have a flat tip.

TORQUE

Trim Screws ①:
35 in-lbs (4 N·m)

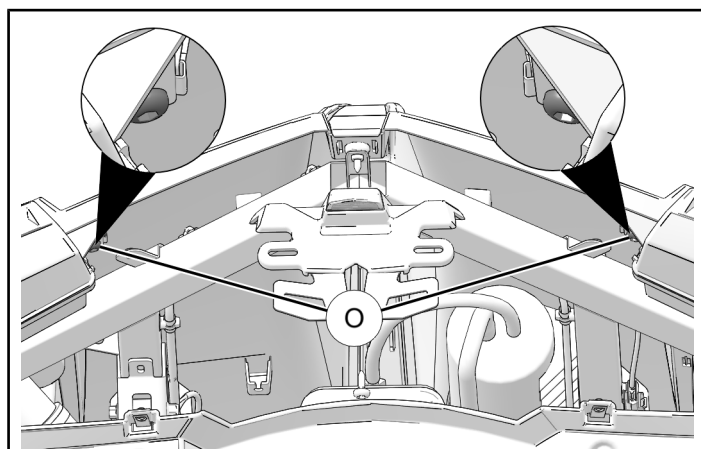

3. Install fastener ①K at rear of deck.

TORQUE

Screw ①K :
61 in-lbs (7 N·m)

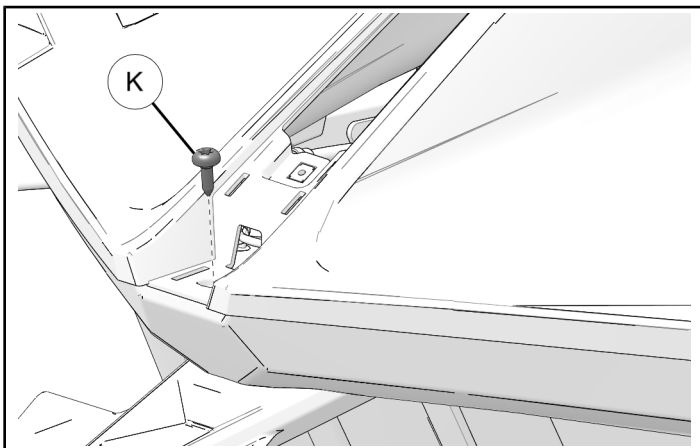

5. Install screw ①P at front of deck.

TORQUE

Screw ①P :
35 in-lbs (4 N·m)

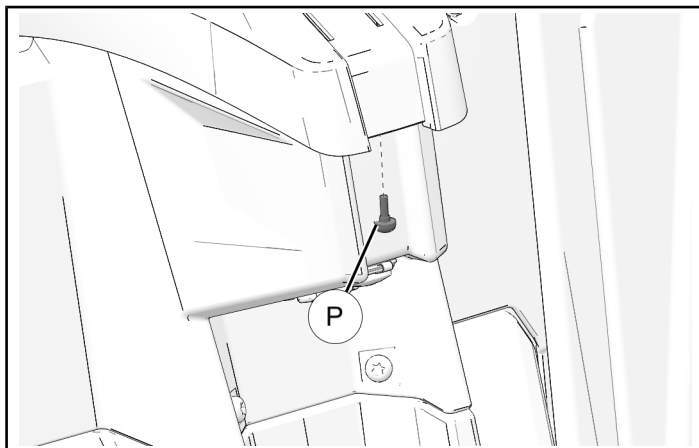

4. Install screw ①L located behind seat headrest.

NOTICE

Right side shown, left side similar.

TORQUE

Screw ①P :
35 in-lbs (4 N·m)

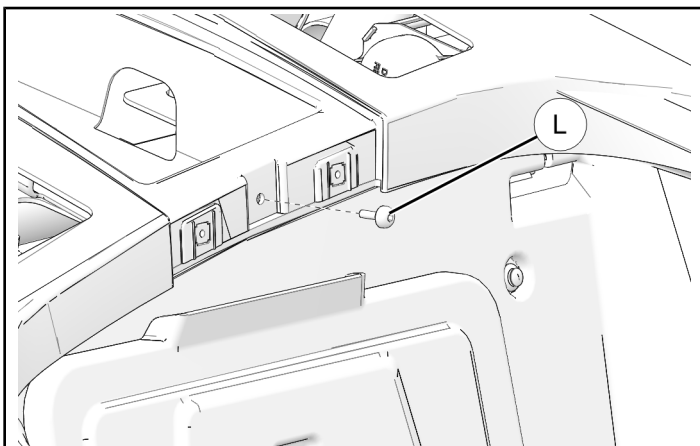

6. Install two fasteners ①B under wing panel.

TORQUE

Trim Screws ①B:
35 in-lbs (4 N·m)

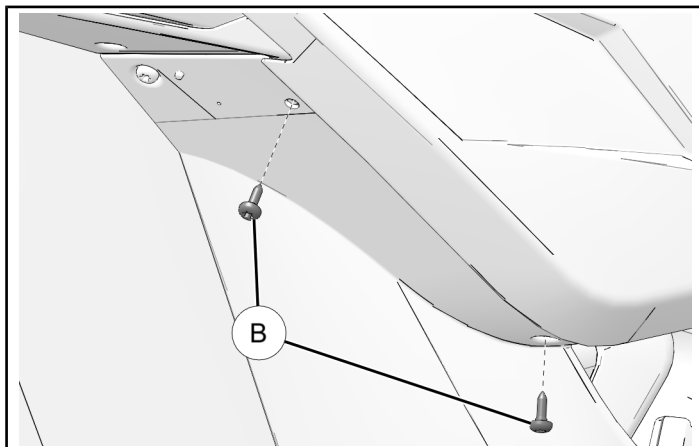

7. Install two push pin rivets ①A under wing panel.

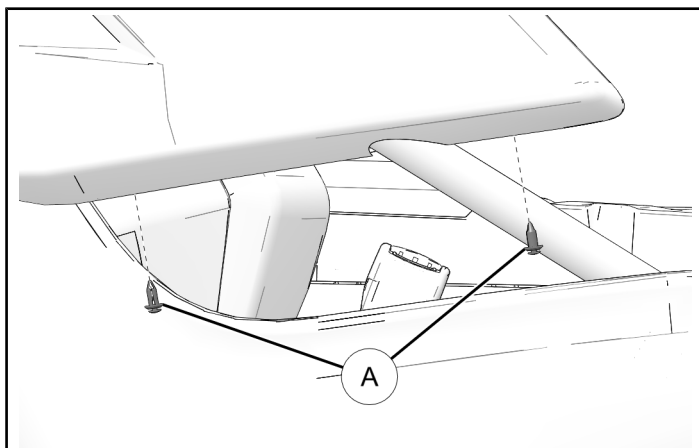

8. Install fasteners **(H)** and **(M)** under deck humps.

TORQUE

Screws **(H)** **(M)**:
61 in-lbs (7 N·m)

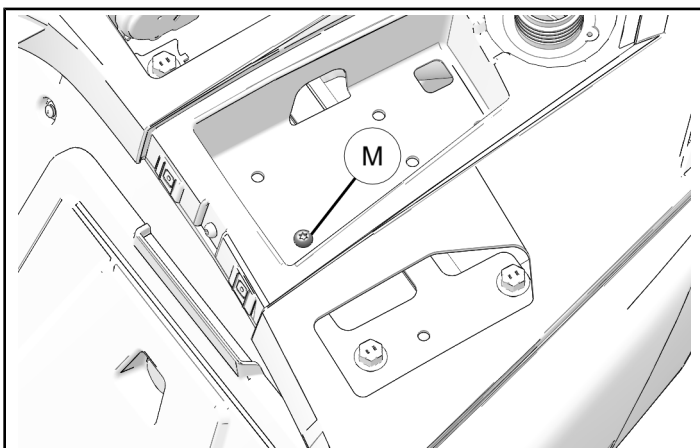
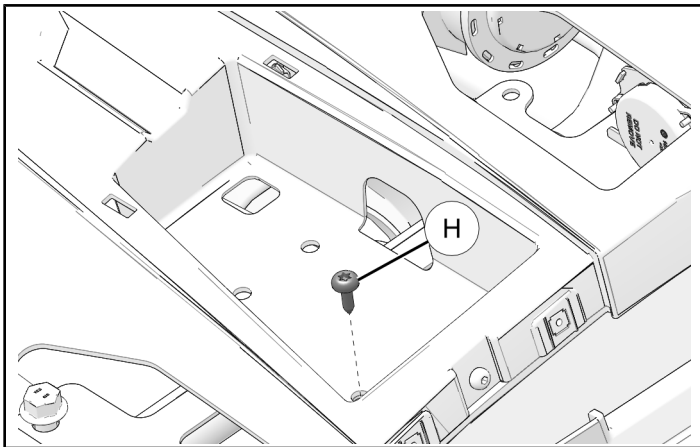

9. Install trim piece at rear of deck. If equipped with back-up camera, install camera assembly.

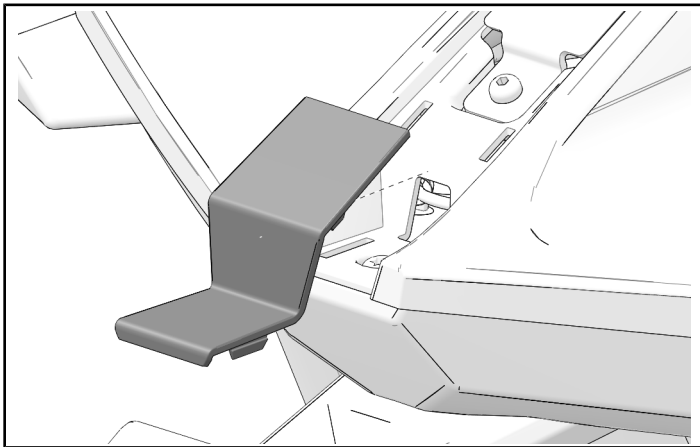

10. Install upper body trim **(E)** and secure with fasteners **(D)**. Connect wiring if equipped with center tail lamp.

NOTICE

If vehicle is equipped with rear camera, make sure camera is connected and set aside before installing upper body trim.

TORQUE

Trim Screws **(D)**:
35 in-lbs (4 N·m)

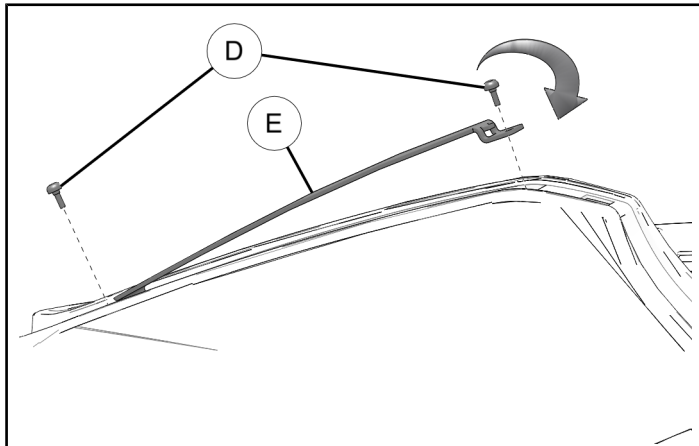

11. Install upper body trim piece **(C)**.

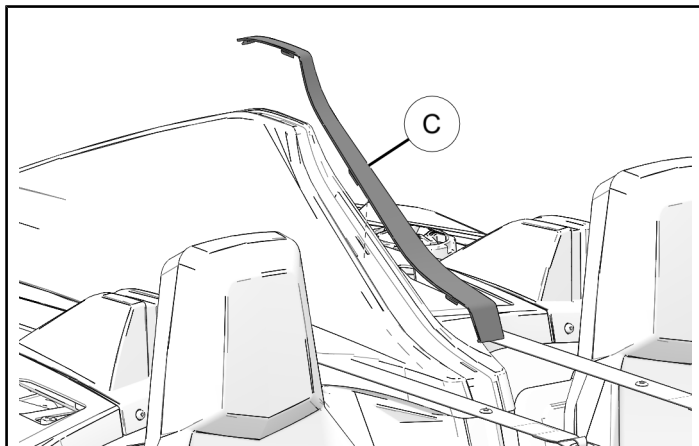

INSTALL REAR LOWER COVER

1. Connect any electrical connectors above panel and lift panel into place.

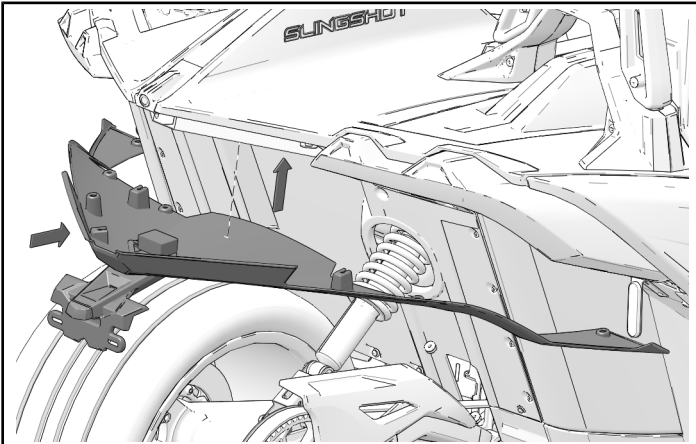

2. Install seven retained fasteners (A) and two retained fasteners (B) to rear lower cover. Torque fasteners to specification.

TORQUE

Rear Lower Cover Fasteners (A):
62 in-lbs (7 N·m)

TORQUE

Rear Lower Cover Fasteners (B):
36 in-lbs (4 N·m)

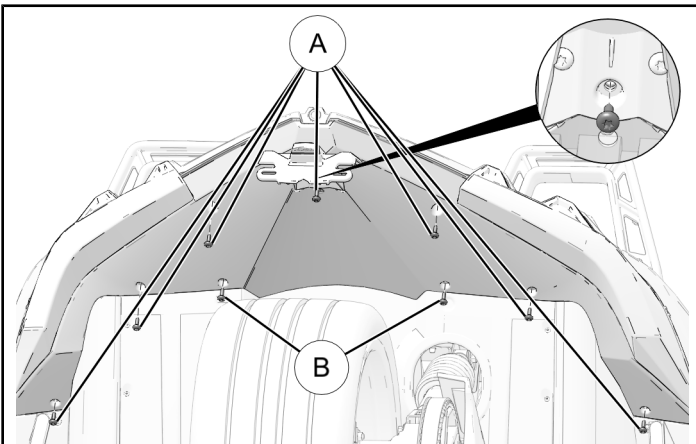

INSTALLATION PREPARATION FOR MODELS EQUIPPED WITH ALUMINUM ROLL HOOPS

REMOVE ROLL HOOP COVERS

REMOVE RIGHT ROLL HOOP COVER

1. Move right seat to forward-most position.
2. Remove and keep two upper fasteners (A) and two lower fasteners (B) on front of hoop trim.

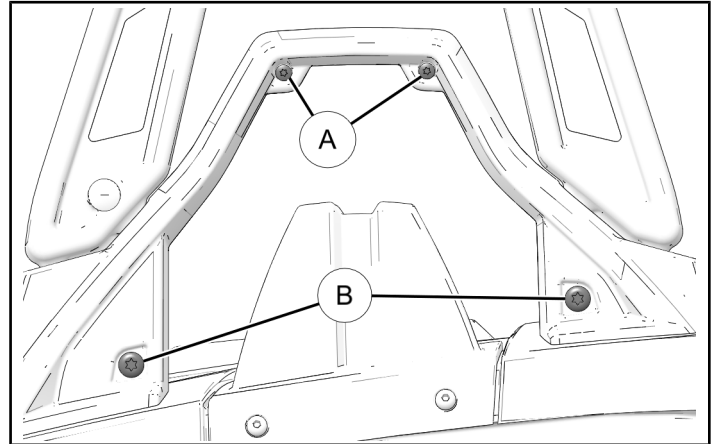

3. Remove and keep two fasteners (C) on back of hoop trim.

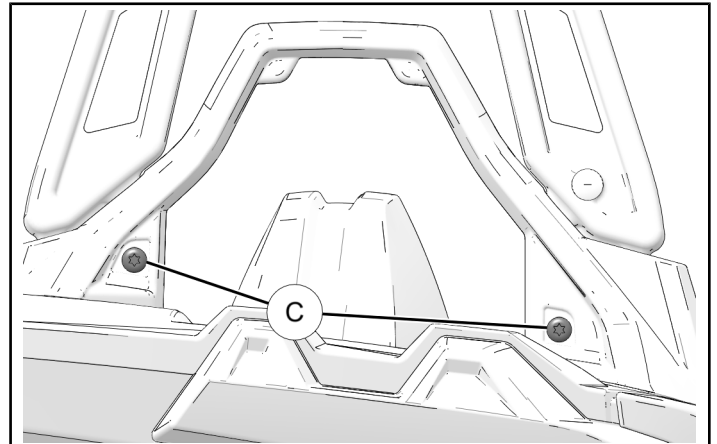

4. Remove two halves of trim piece.

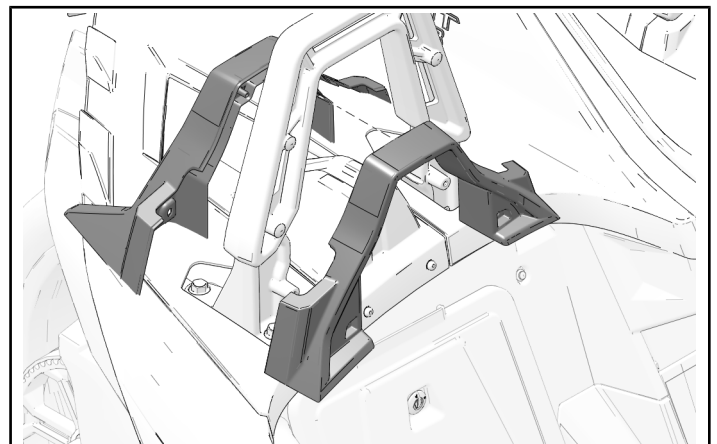

5. Remove two fasteners ① from deck hump.

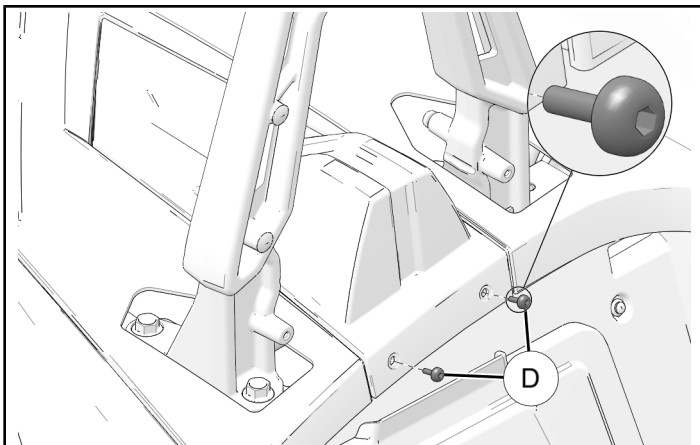

3. Remove two fasteners ③ on back of hoop trim.

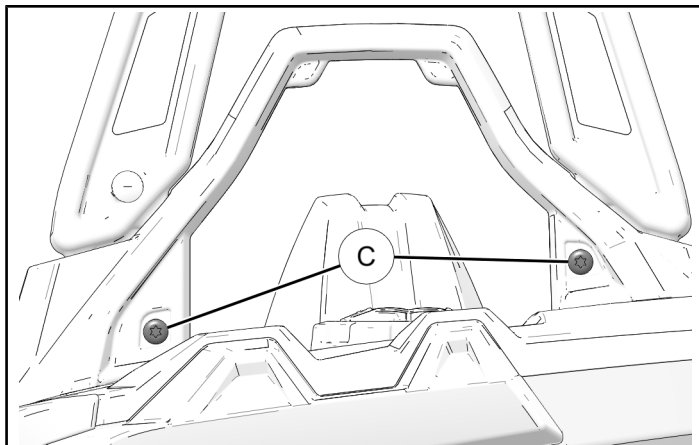

6. Lift front edge of deck hump and pull forward to remove.

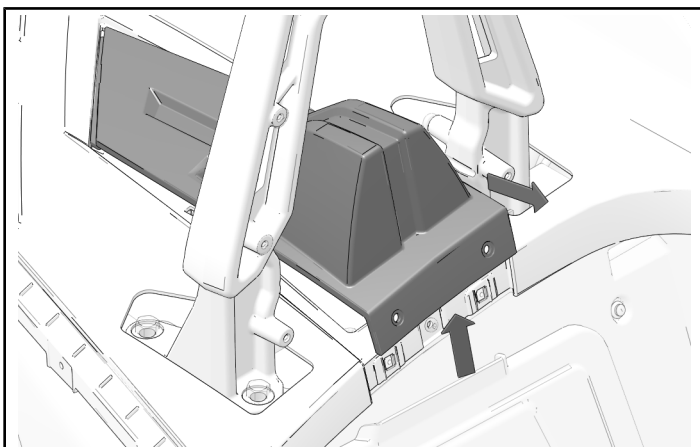

4. Remove two halves of trim piece.

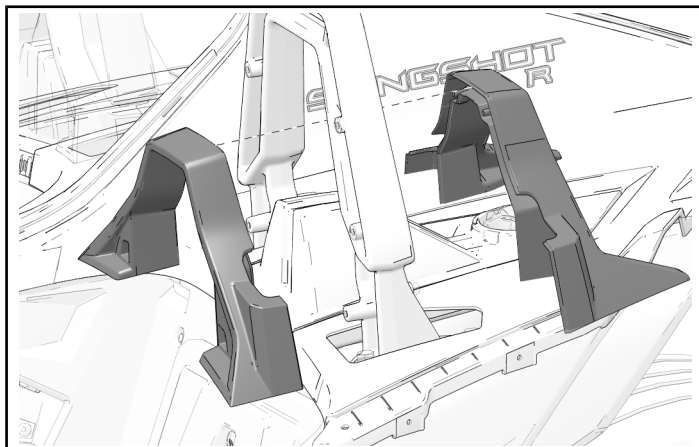

REMOVE LEFT ROLL HOOP COVER

1. Move left seat to forward-most position.
2. Remove two upper fasteners ④ and two lower fasteners ⑤.

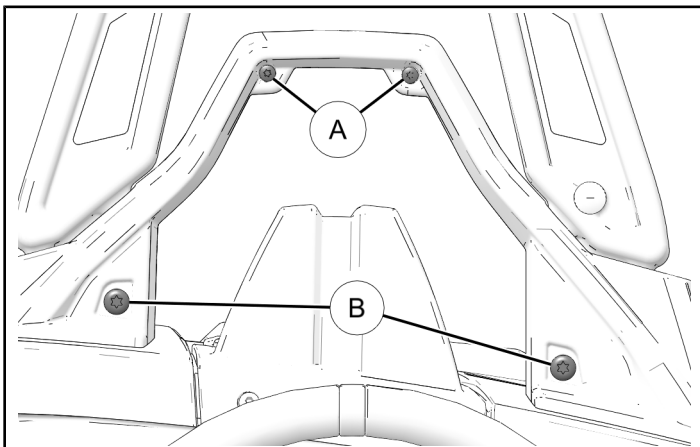

5. Remove fuel cap.

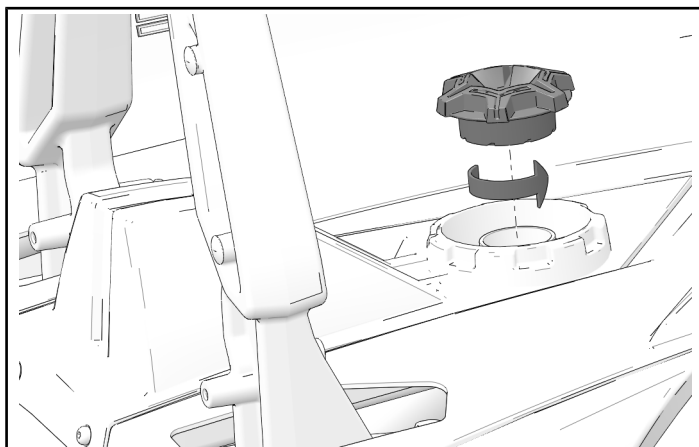

6. Remove fuel filler nut.

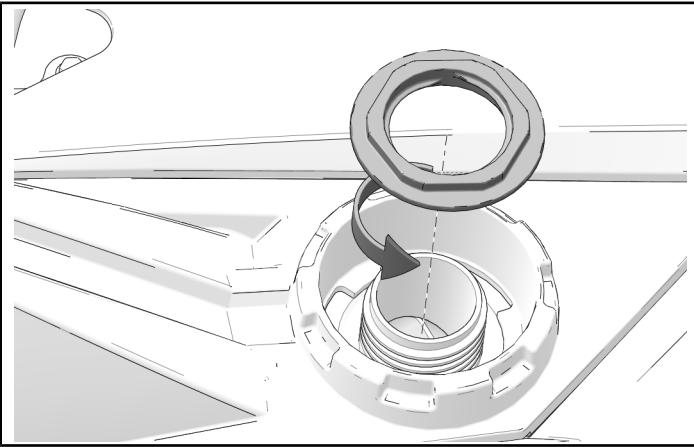

9. Install fuel cap to make sure debris does not fall into tank during vehicle service.

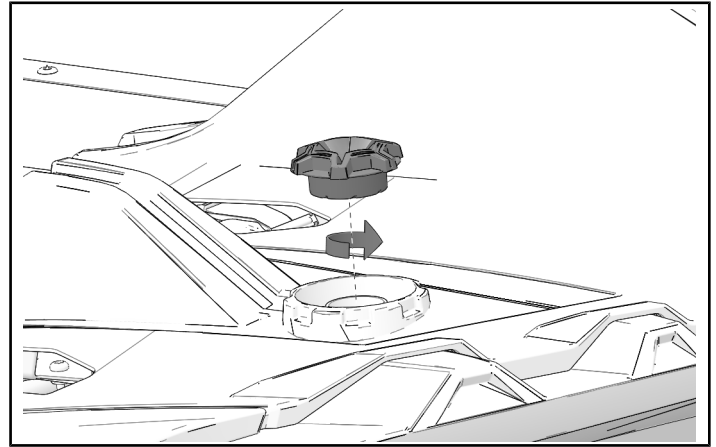

7. Remove two fasteners ① from deck hump.

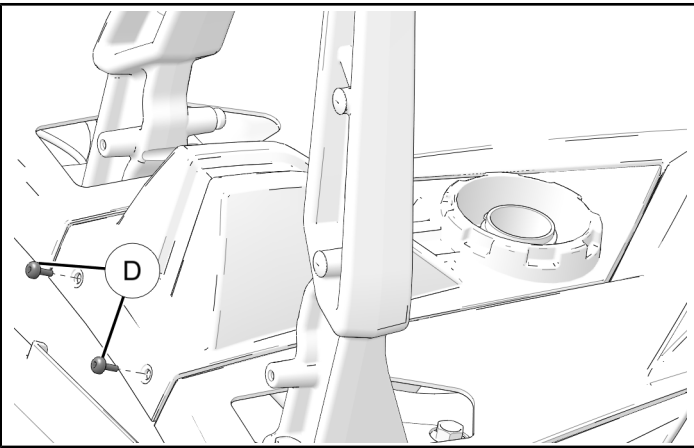

8. Lift front edge deck hump and pull forward to remove.

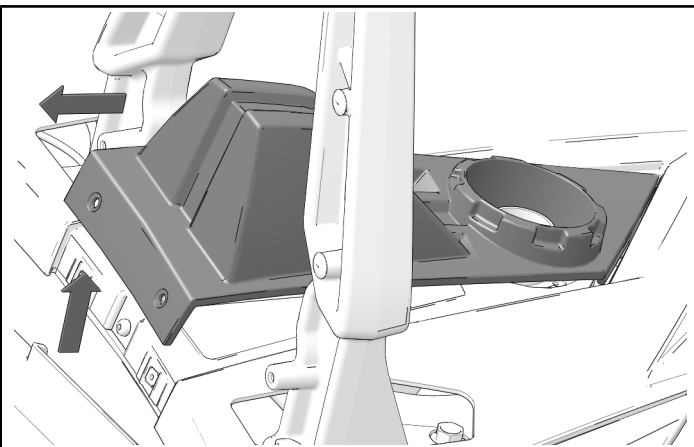

ALUMINUM ROLL HOOP REMOVAL

NOTICE

Right side shown, left side similar.

1. Remove four roll hoop fasteners.

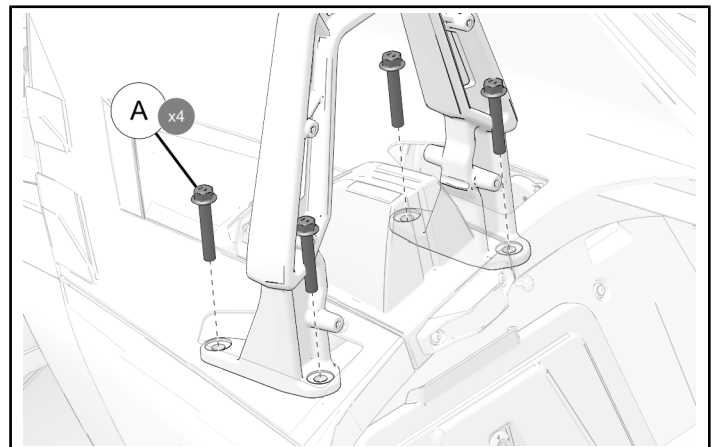

2. Lift roll hoop away from vehicle.

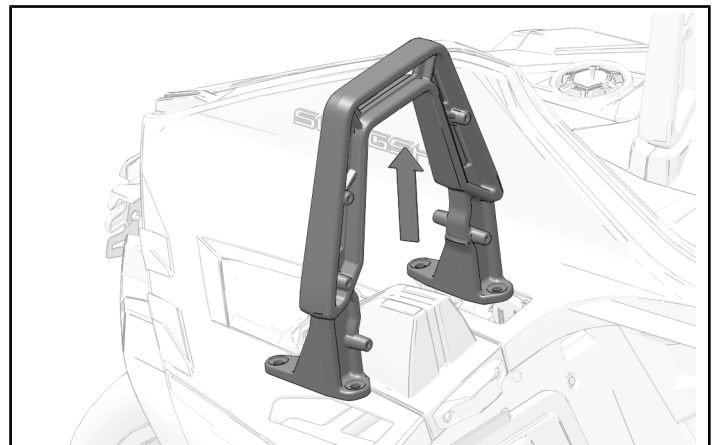

ACCESSORY INSTALLATION

DRILL REAR DECK

NOTICE

Left side outer shown, others similar. Align templates by matching template shape to shape in body cutout.

IMPORTANT

When drilling rear deck use a drill stop to avoid damaging vehicle components. Before drilling, check inside panel to make sure there are no components that may be damaged during the drilling process.

1. Print template and cut out with scissors. Aligns with opening in rear deck and tape in place. Mark drilling positions with marker or similar.
2. Drill holes in positions marked. Use drill stop set to 1/2 in

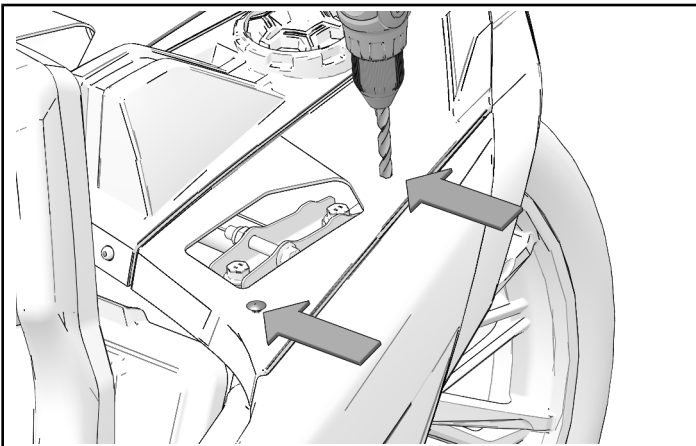

INSTALL INNER FRAME MOUNTS

NOTICE

Models equipped with aluminum roll hoops will re-use existing seat belt guide.

1. Put right side inner frame mount ② and seat belt guide ⑤ in place. Make sure seat belt guide ⑤ is installed on top of frame mount. Make sure offset frame mount holes are installed toward the rear of the vehicle.

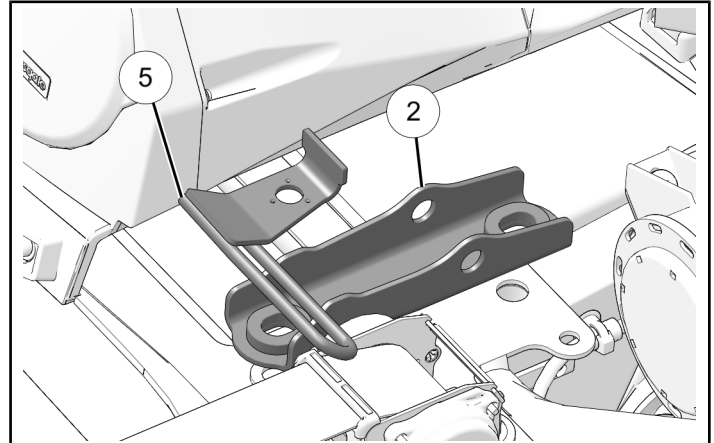

2. Put left side inner frame mount ① and seat belt guide ④ in place. Make sure seat belt guide ④ is installed on top of frame mount. Make sure offset frame mount holes are installed toward the rear of the vehicle.

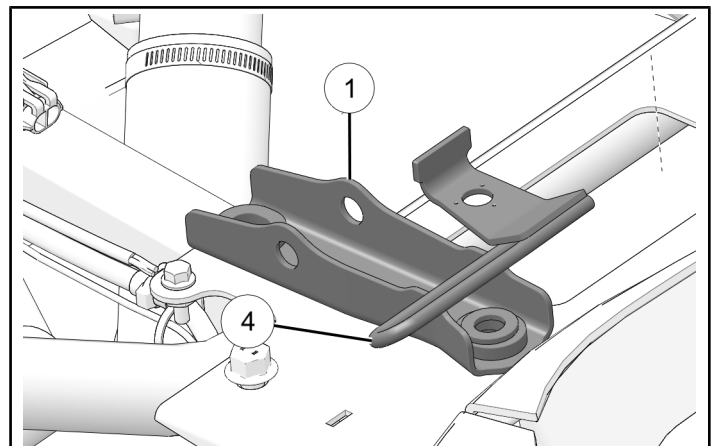

INSTALL FRAME

IMPORTANT

Two or more people are required to install the Excursion Top frame assembly.

1. Install push pin rivets ⑮ onto rubber boots.

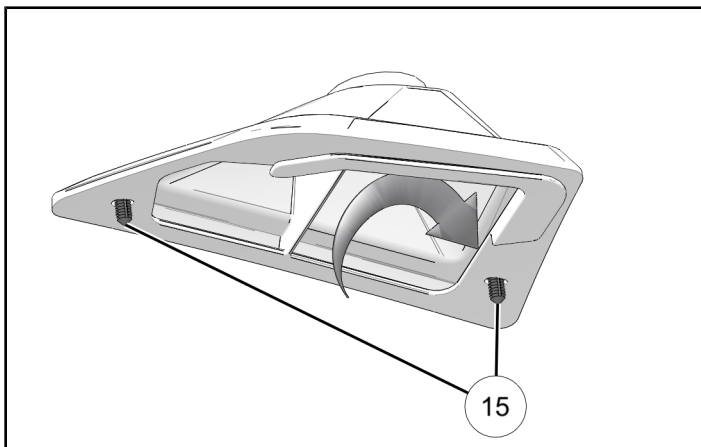

2. Place rubber boots ⑨, ⑦, ⑧, and ⑩ onto frame.

TIP

Inspect underside of rubber boots to determine correct position.

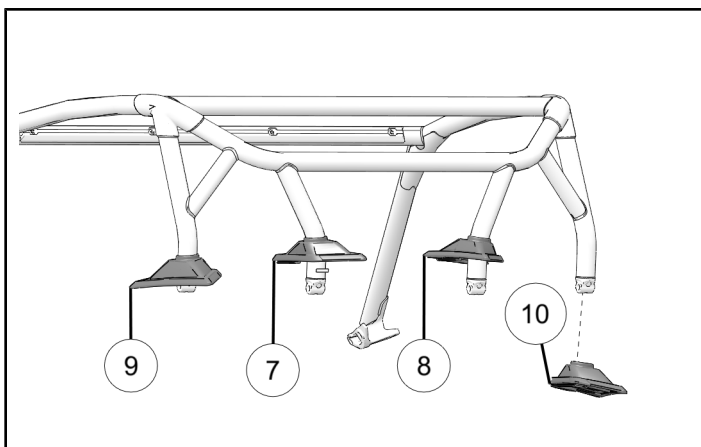

3. Loosely install outer frame mounts ① and ② onto frame leg using screw ⑭ and nut ⑫. Make sure outer mount is offset toward the front of the vehicle.

NOTICE

Make sure nut is placed on inboard side of frame mount.

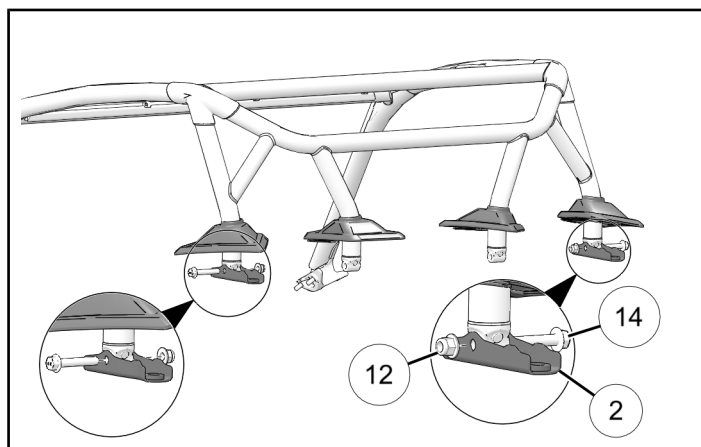
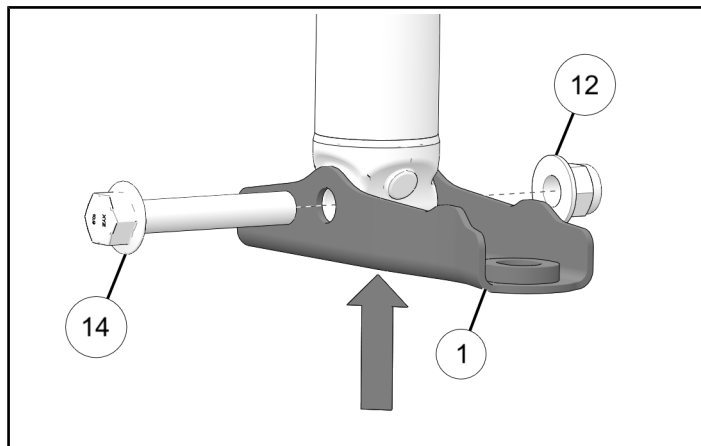

4. Install frame assembly ③ on vehicle. Make sure frame is placed on inner mounts ① and ②.

IMPORTANT

Frame assembly installation requires two people.

IMPORTANT

Make sure frame does not damage painted surfaces.

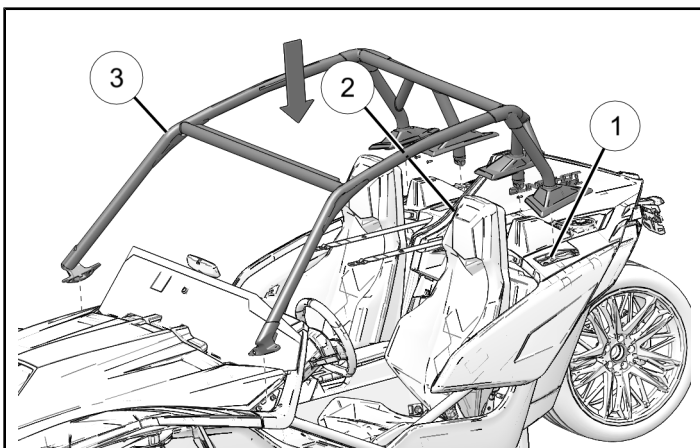

5. Loosely install screws ⑭ to secure inner mount to vehicle.

TIP

Use flexible magnet to aid installation of rear fastener.

NOTICE

Left side shown, right side similar.

IMPORTANT

Make sure seat belt functions properly within seat belt guide.

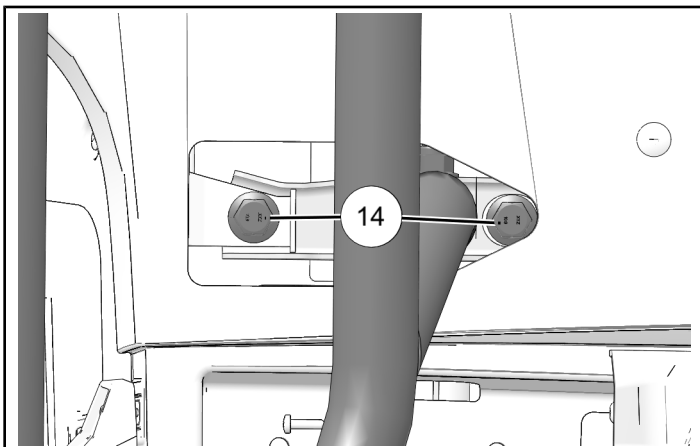

6. Loosely install screw ⑭ and nut ⑫ to secure frame to inner mount ②.

NOTICE

Right side shown, left side similar.

NOTICE

Make sure nut is placed on inboard side of frame mount.

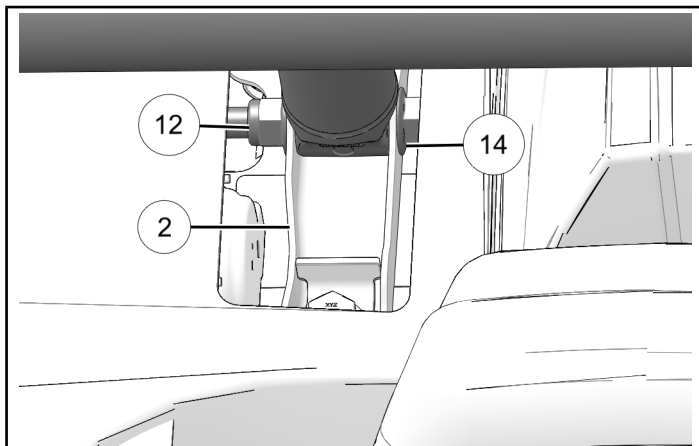

7. Loosely install screws ⑭ to secure outer frame mounts to the vehicle.

NOTICE

Left side shown, right side similar.

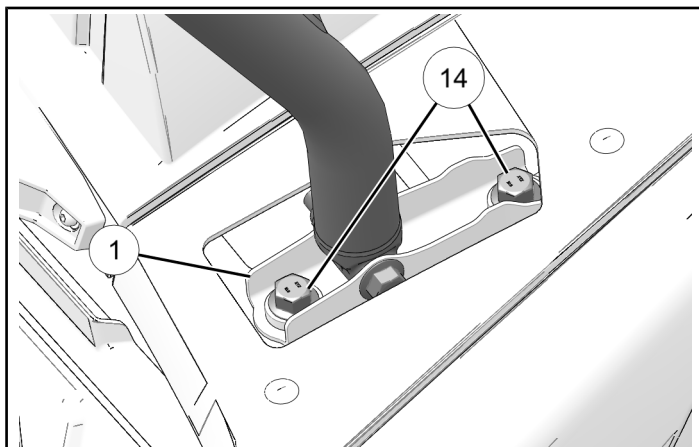

8. Loosely install cap screws ⑪ to secure front of frame ③.

IMPORTANT

Do not reinstall rubber mirror mount damper.

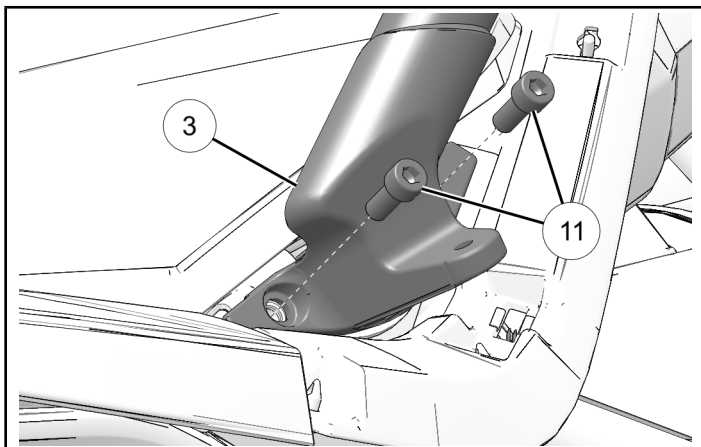

9. Torque all fasteners to specification.

IMPORTANT

Torque fasteners in order shown .

TORQUE

Front Frame Cap Screws ⑪:
35 ft-lbs (47.5 N·m)

TORQUE

Frame Mount Fasteners ⑭:
59 ft-lbs (80 N·m)

TORQUE

Frame To Mount Nuts ⑫:
59 ft-lbs (80 N·m)

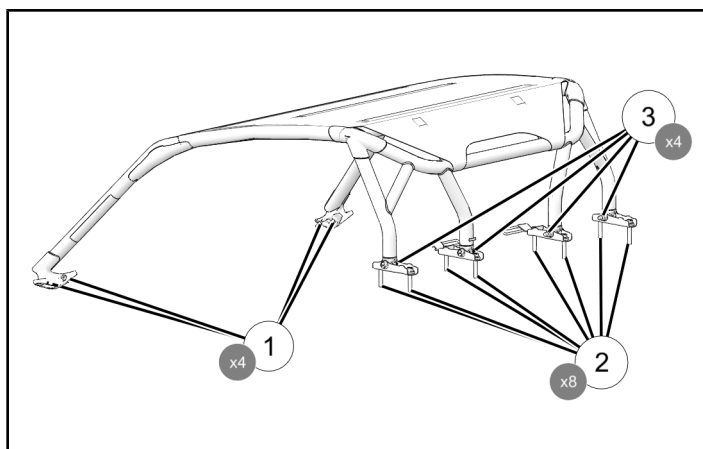

10. Push boots down onto rear deck. Make sure push pin rivets are inserted into holes drilled in deck. Fit edges of boots into deck openings.

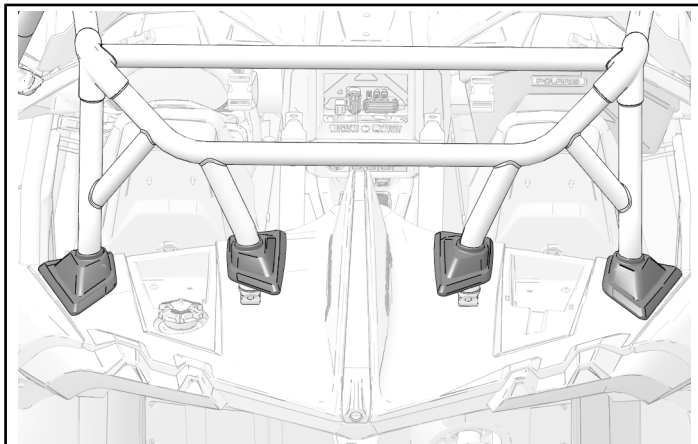

VEHICLE REASSEMBLY

INSTALL SIDE TRIM

NOTICE

Right side shown, left side similar.

1. Put side trim ⑧ in place on vehicle. Make sure clips on bottom end of side piece are in place.

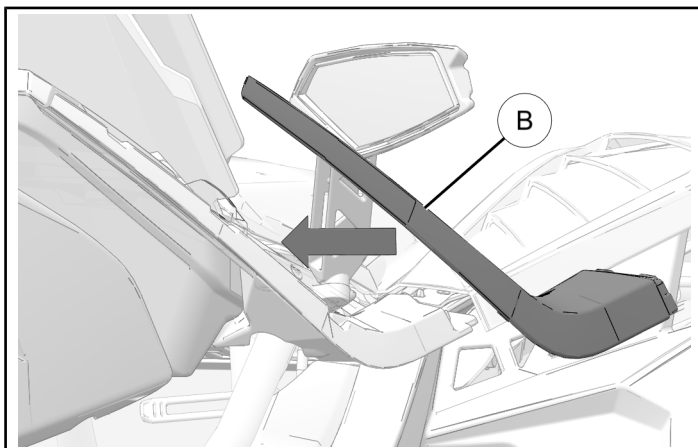

2. Install two fasteners ①. Tighten securely by hand.

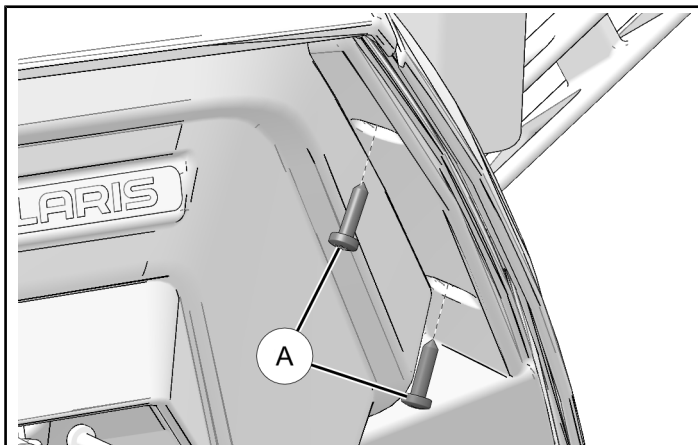

INSTALL MIRRORS ON FRAME

1. Remove mirror stalk from original mount. Use existing cap screw and nut ③ from Kit Contents to mount mirror to frame mount. Make sure alignment markings on mirror and frame are matched up.

TORQUE

Mirror Mounting Screw:
27 ft-lbs (36.5 N·m)

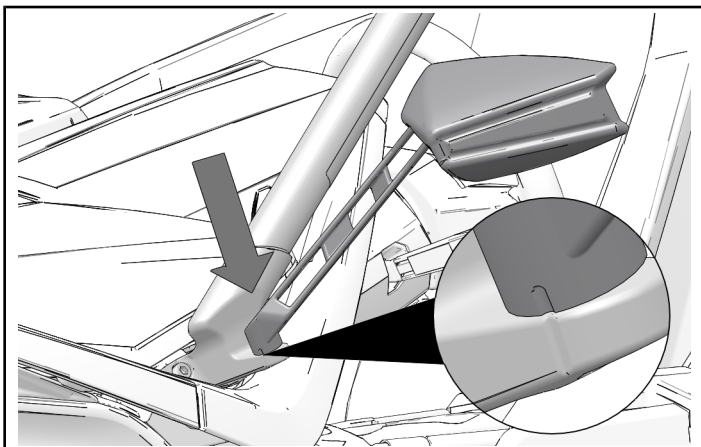

INSTALL DECK HUMPS

1. Install deck hump ① using screws ②. Tighten by hand until secure.

NOTICE

Right side shown, left side similar.

TORQUE

Deck Hump Screws ②:
35 in-lbs (4 N·m)

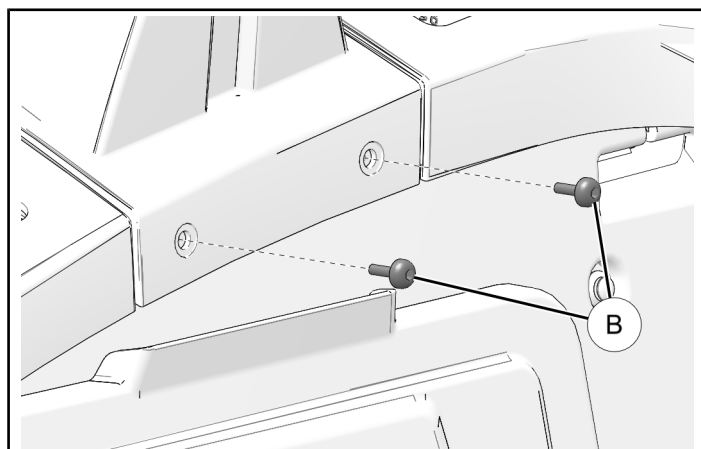
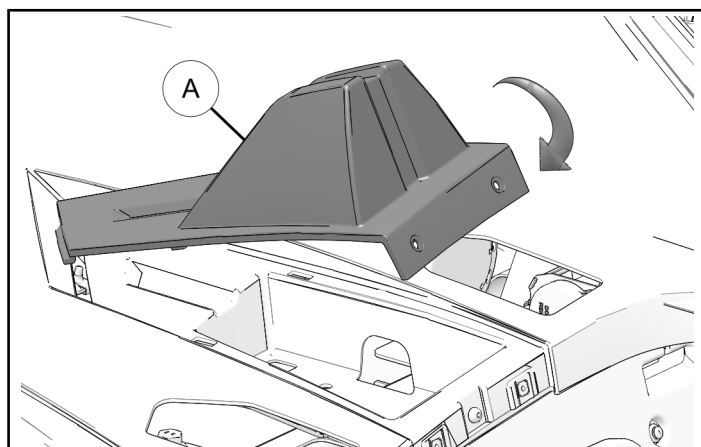

INSTALL FUEL CAP AND RETAINER NUT

1. Install fuel tank retainer nut ①. Tighten fuel tank retainer nut until fully-seated. Install fuel cap ②.

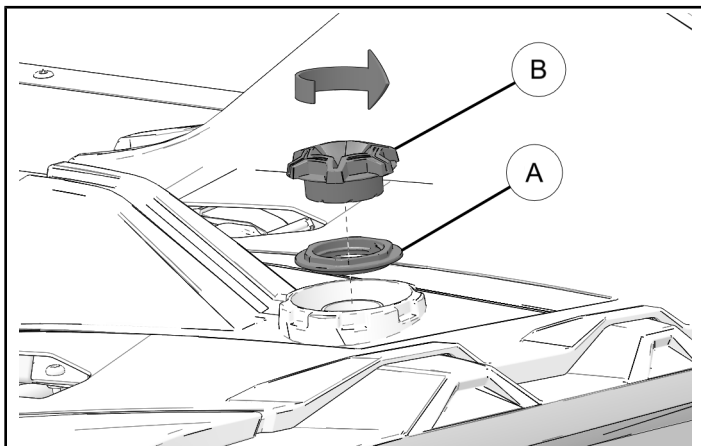

OPERATION

INSTALL EXCURSION TOP

1. Remove excursion top from it's protective storage case. Leave the top rolled up.
2. Insert semi-rigid front edge of Excursion top into the channel at the front of the frame assembly.

NOTICE

Make sure screen printing faces inward as shown.

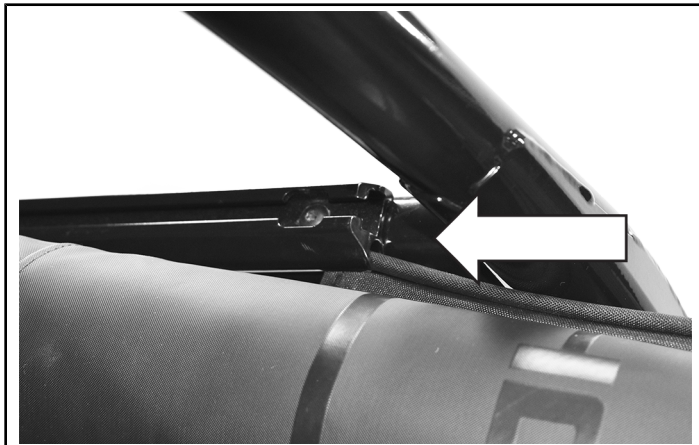

3. Slide the semi-rigid front edge into the channel. Make sure the top is centered in the channel by matching the overhang amount on each side.



4. Route the top over the front of the frame assembly and unroll toward the rear of the vehicle. Make sure the top remains evenly spaced on the frame assembly.

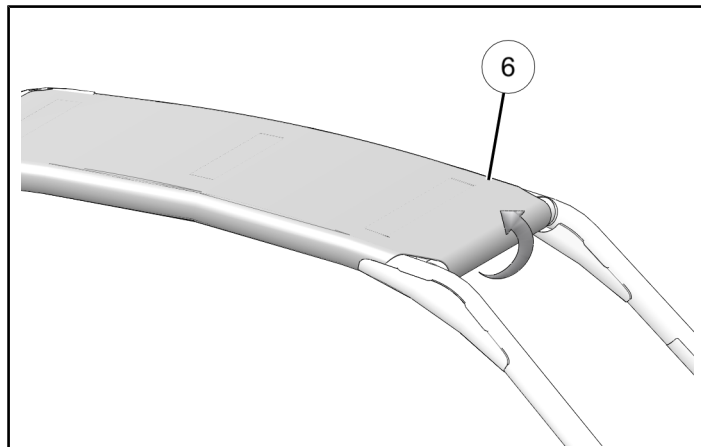

5. Fasten the two rear buckles (A) around the rear of the frame assembly.

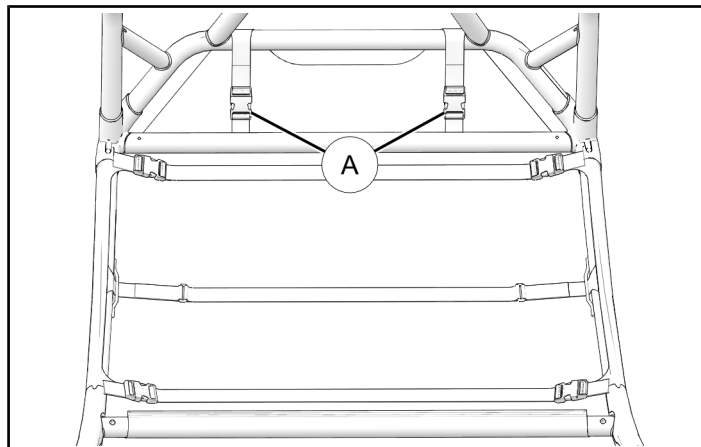

6. Fasten the four side buckles (B).

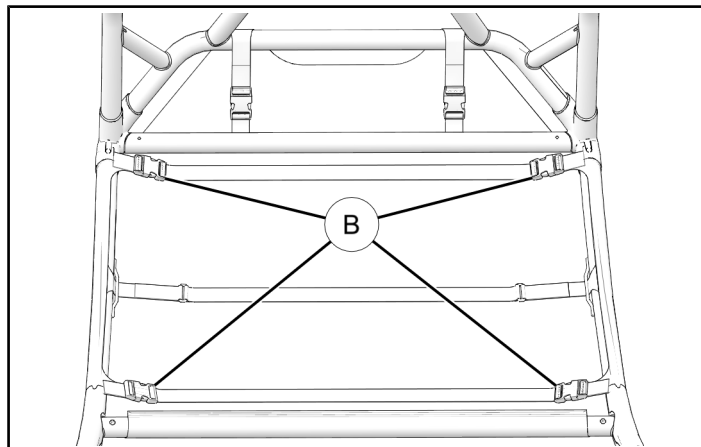

7. Feed center strap ③ through welded loop on frame assembly, then through attached ring. Loosely fasten using hook and loop material.

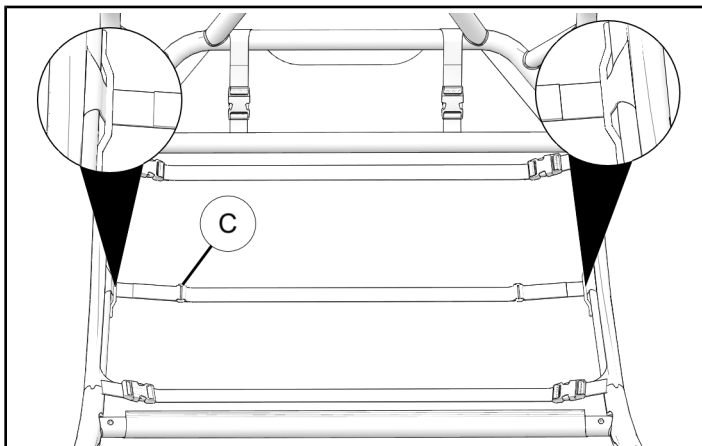

8. Make sure top is centered on frame assembly. Gradually tighten rear and side buckles, making sure top stays centered.

9. When six buckles are tight, tighten center strap.

EXCURSION TOP REMOVAL

1. Detach hook and loop material on center strap ③. Remove strap ends from welded loop in frame assembly.

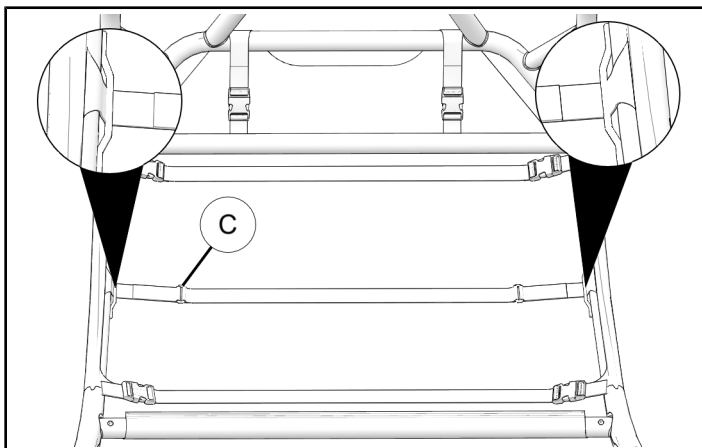

2. Unlatch buckles ② at sides of top.

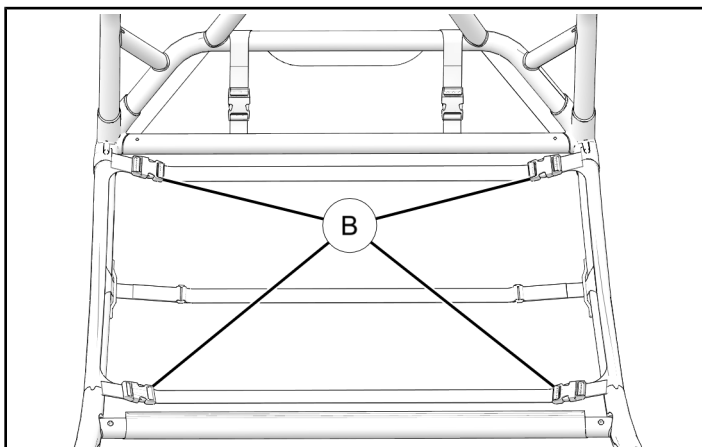

3. Unlatch buckles ① at rear of top.

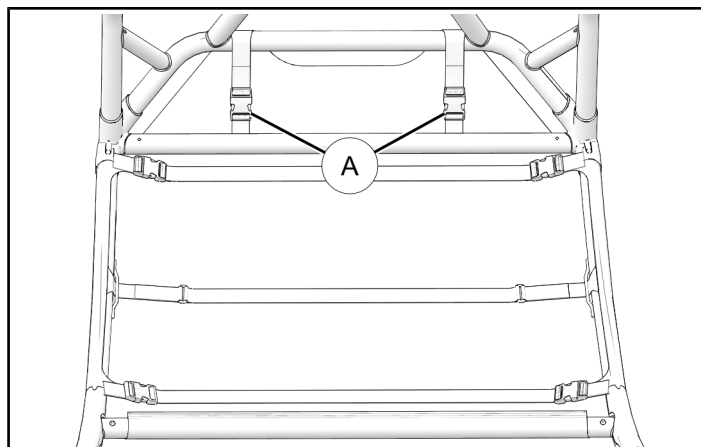

4. Roll up top ⑥, starting at the rear of the vehicle.

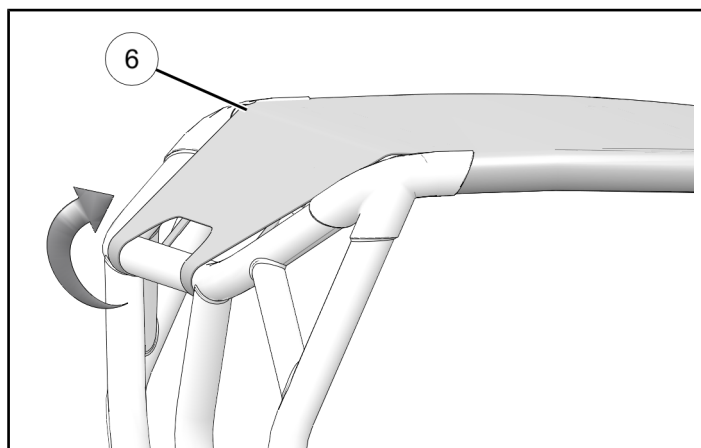

5. Slide semi-rigid front edge of top out of the mounting channel at front of frame assembly.



CLEANING AND STORAGE

Care and Cleaning

- Mix one gallon of lukewarm water and 2 oz. mild soap such as Dawn or Woolite.
- Clean top using soft bristle brush and cleaning solution.
- Rise thoroughly with cold water.
- Lay flat, air dry.

Storage

- Lay top flat on clean surface. Fasten all buckles and hook and loop material.
- Roll top tightly front to rear.
- Slide top into storage bag and cinch closed.

INSTRUCTION FEEDBACK FORM

A feedback form has been created for the installer to provide any comments, questions or concerns about the installation instructions. The form is viewable on mobile devices by scanning the QR code or by clicking [HERE](#) if viewing on a PC.

