

SPORTSMAN WINCH KIT



P/N 2889469; 2889470; 2889471

BEFORE YOU BEGIN

Read these instructions and check to be sure all parts and tools are accounted for. Please retain these installation instructions for future reference and parts ordering information.

APPLICATION

Verify accessory fitment at www.polaris.com.

KIT CONTENTS

2500 P/N 2889469

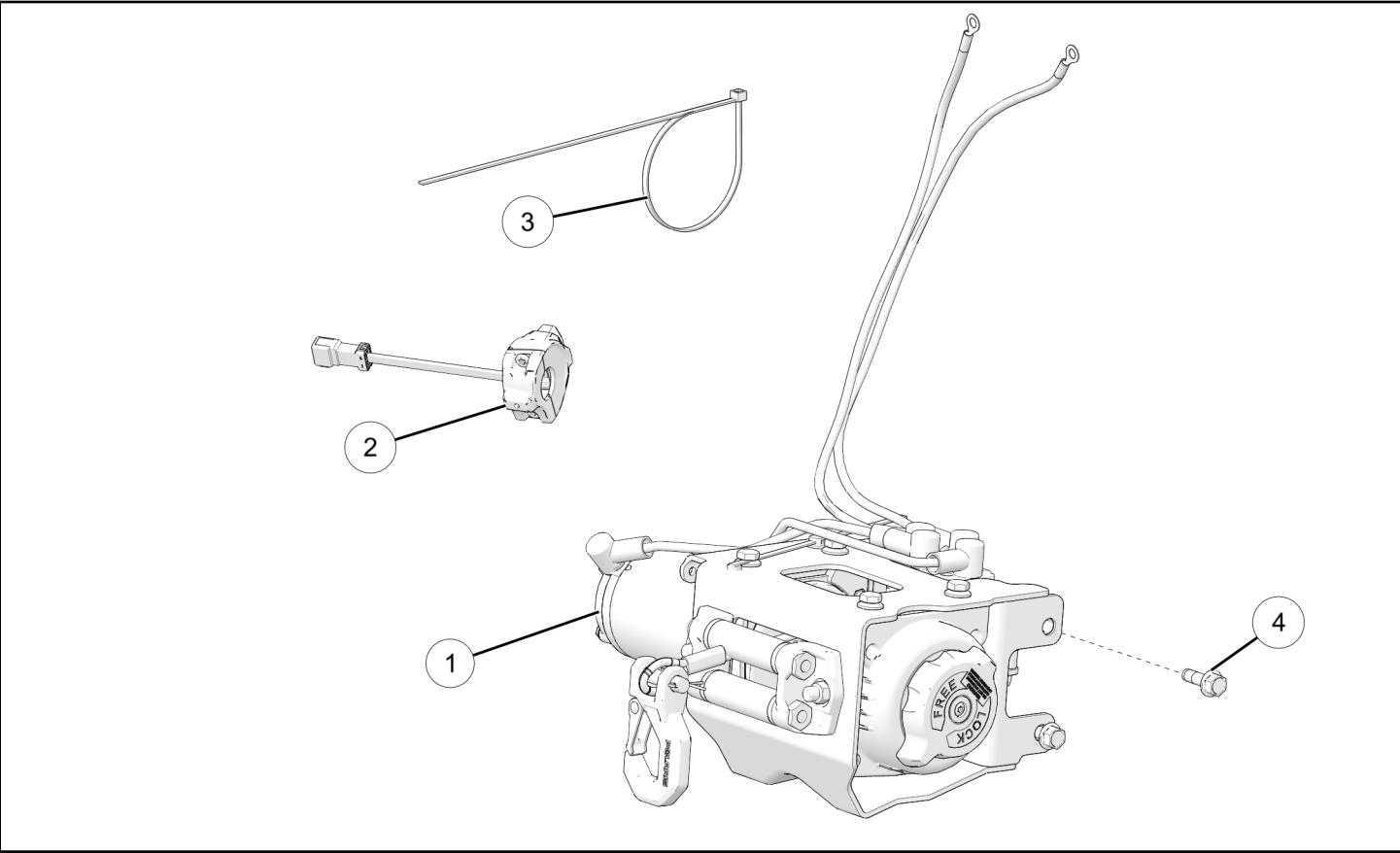

REF	QTY	PART DESCRIPTION	P/N AVAILABLE SEPARATELY
1	1	Winch assembly, 2.5HD	2638706
2	1	Winch switch, ATV	2207175
3	5	Cable tie 76 mm	7080492
4	4	Screw, hex, flanged M8 x 1.25 x 25 mm	7519739
5	1	Manual, Winch Guide (not shown)	9923644

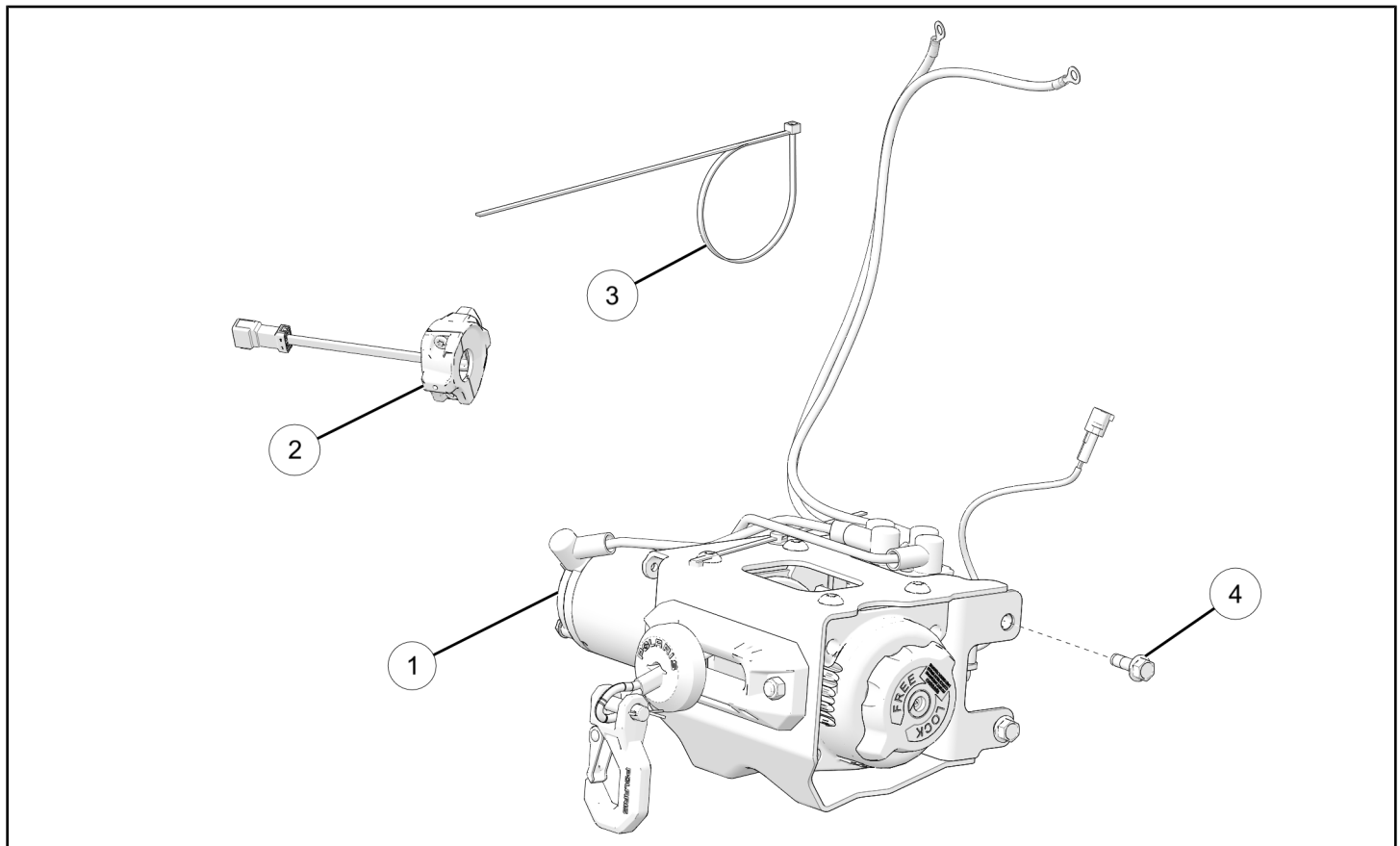

REF	QTY	PART DESCRIPTION	P/N AVAILABLE SEPARATELY
1	1	Winch assembly, 3.5HD	2638706
2	1	Winch switch, ATV	2207175
3	5	Cable tie 76 mm	7080492
4	4	Screw, hex, flanged M8 x 1.25 x 25 mm	7519739
5	1	Manual, Winch Guide (not shown)	9923644

3500 PRO P/N 2889471

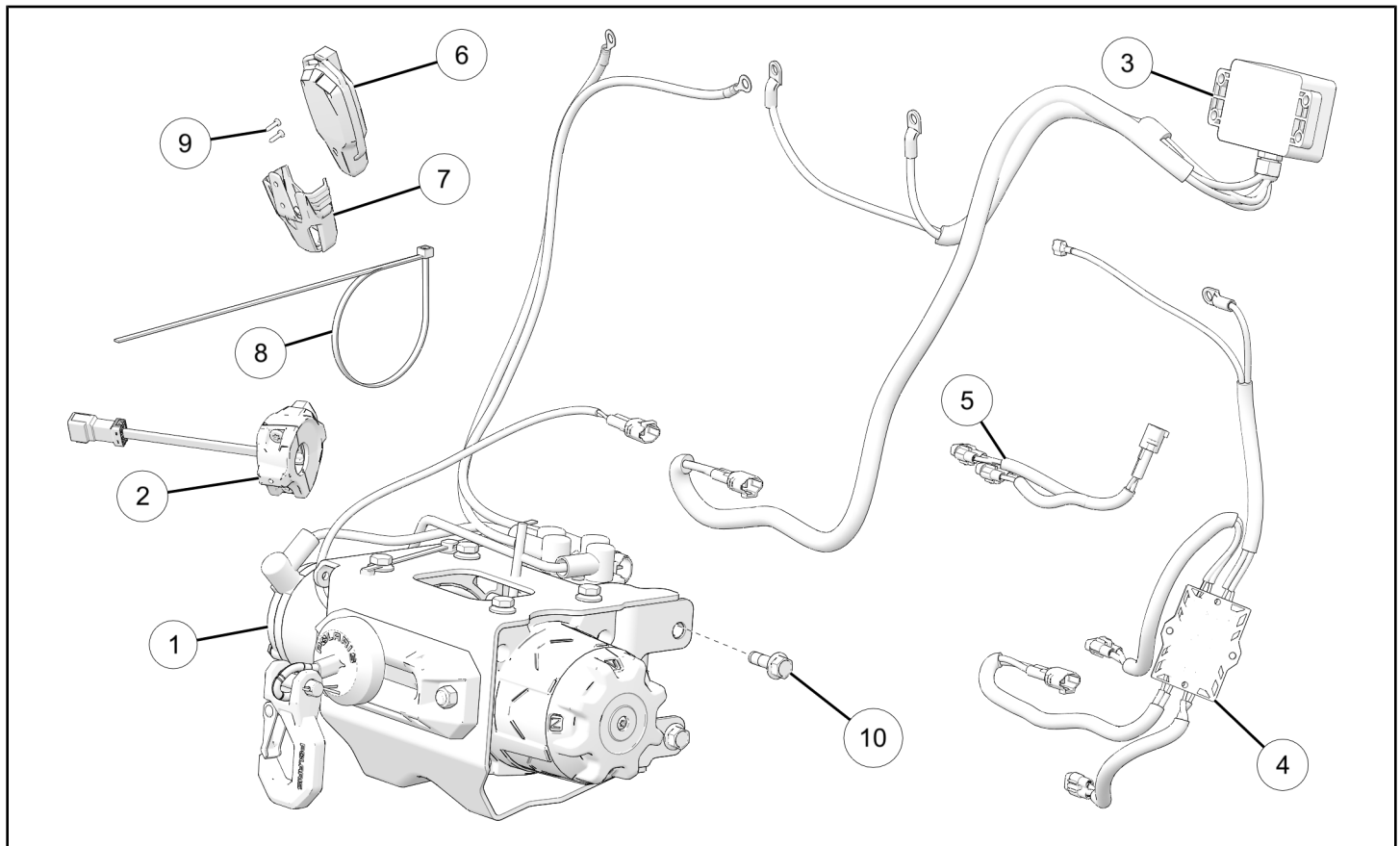

REF	QTY	PART DESCRIPTION	P/N AVAILABLE SEPARATELY
1	1	Winch assembly, 3.5 Pro	2638078
2	1	Winch switch, ATV	2207175
3	1	Receiver, wireless, winch, ATV (wiring may be pre-connected)	n/a
4	1	Control box, fairlead	2415867
5	1	Harness, wireless remote, winch (wiring may be pre-connected)	4017126
6	1	Remote, winch, wireless	4080061
7	1	Holder, remote, wireless winch	5454269
8	5	Cable tie 76 mm	7080492
9	2	Screw, Torx®, self-threading #10 x 3/4 in	7512026
10	4	Screw, hex, flanged M8 x 1.25 x 25 mm	7519739
11	1	Manual, Winch Guide (not shown)	9923644

TOOLS REQUIRED

- Safety Glasses
- Hex Key Set, Metric
- Screwdriver, Phillips
- Socket Set, Metric
- Socket Set, Torx® Bit
- Torque Wrench
- Wire Cutters

IMPORTANT

Your Sportsman Winch Kit is exclusively designed for your vehicle. Please read the installation instructions thoroughly before beginning. Installation is easier if the vehicle is clean and free of debris. For your safety, and to ensure a satisfactory installation, perform all installation steps correctly in the sequence shown.

INSTALLATION INSTRUCTIONS

VEHICLE PREPARATION

GENERAL

1. Park vehicle on a flat surface.
2. Push engine stop switch to OFF position.
3. Turn key to OFF position and remove key.

BATTERY DISCONNECT

1. Release rubber latch on both sides and open front rack.

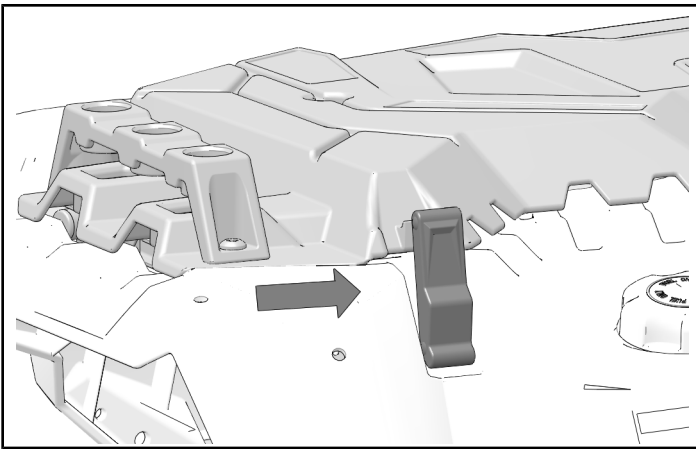

2. Remove two fasteners from front storage bin. Remove front storage bin.

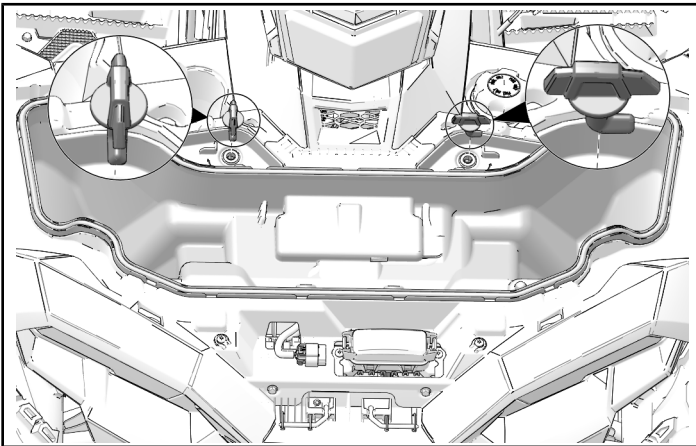

3. Fold up ends of battery cover to access battery bolts.

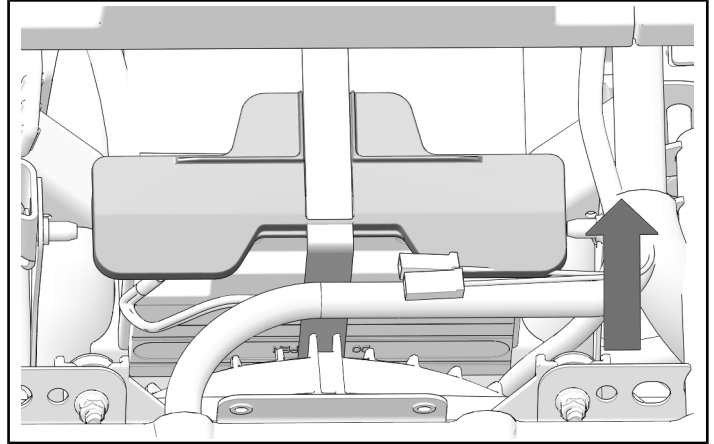

4. Remove bolt from black negative battery cable and disconnect negative battery cable. Remove bolt from red positive battery cable and disconnect positive battery cable.

⚠ WARNING

Always disconnect black negative cable from battery FIRST. Failure to do so will result in high current electrical arc and may result in battery explosion if tool touches grounded frame. Death or serious personal injury may occur.

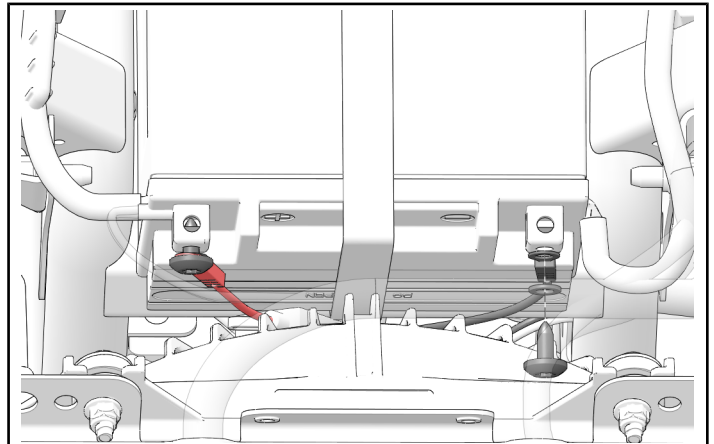

FRONT BUMPER COVER REMOVAL

1. Remove and keep four bolts from lower front bumper cover. Remove lower front bumper cover.

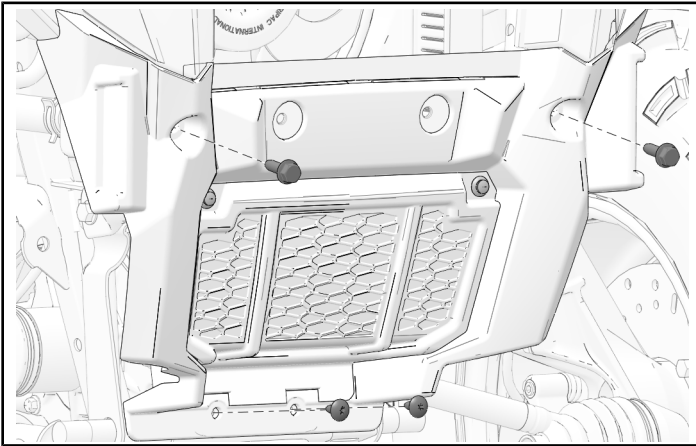

2. Remove two push pin rivets from panel on front bumper cover. Remove panel.

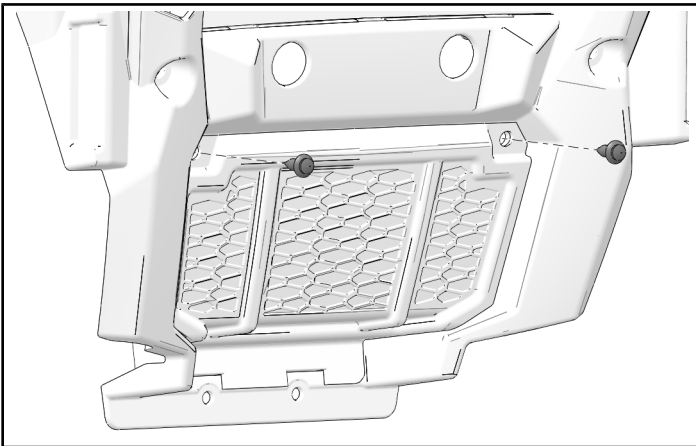

ACCESSORY INSTALLATION

WINCH AND CONTROL INSTALLATION – ALL MODELS

IMPORTANT

The winch assembly is heavy and there are many parts that need to be lined up correctly during assembly. Enlist at least one helper during winch installation.

1. Identify four winch mounting holes at front of vehicle.

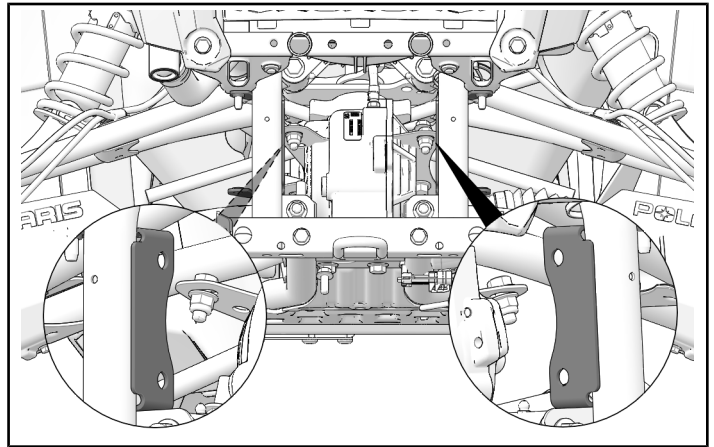

2. Put winch in position on vehicle, lining up four mounting points. Make sure not to pinch any wires.

IMPORTANT

Enlist a helper to hold winch in position.

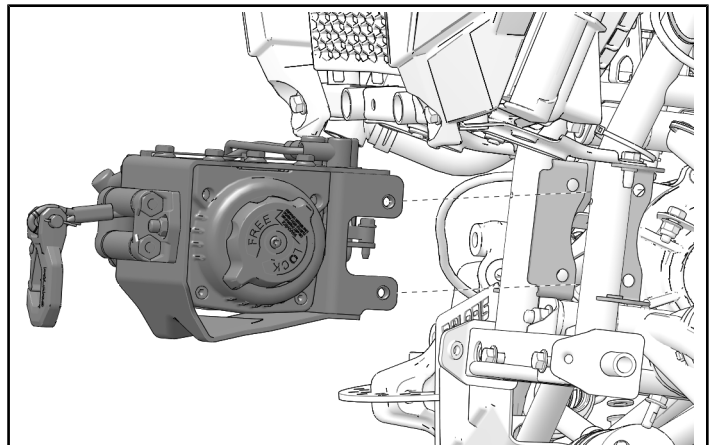

3. Install winch power cables, route under frame piece, then route along frame tube as shown.

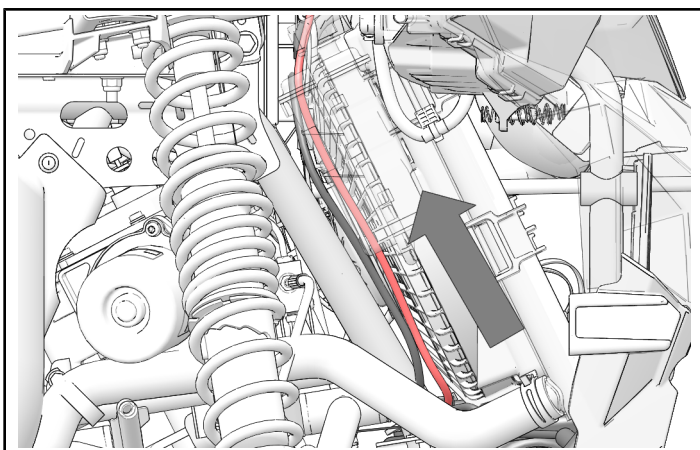
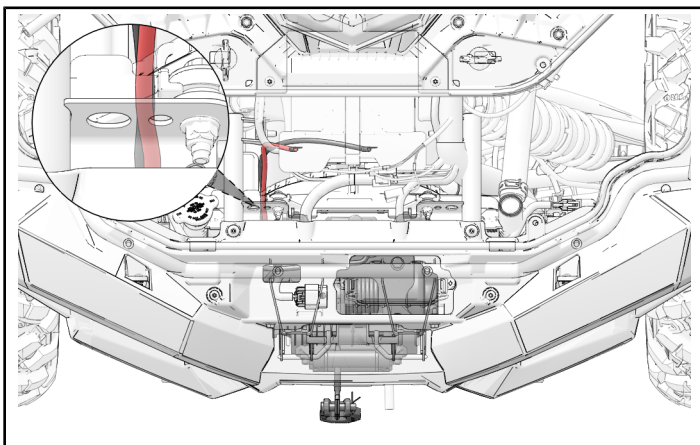

4. Install four screws ④ and torque to specification.

NOTICE

Left side shown, right side similar.

TORQUE

Winch Mounting Screws ④:
20 ft-lbs (27 N·m)

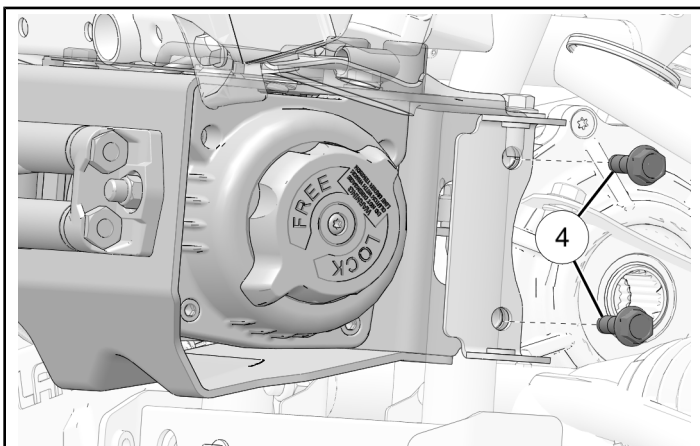

5. Install the handlebar switch ② on the left side handlebar. Connect wiring plug to vehicle wiring harness.

TORQUE

Handlebar Switch Screws:
24 in-lbs (2.7 N·m)

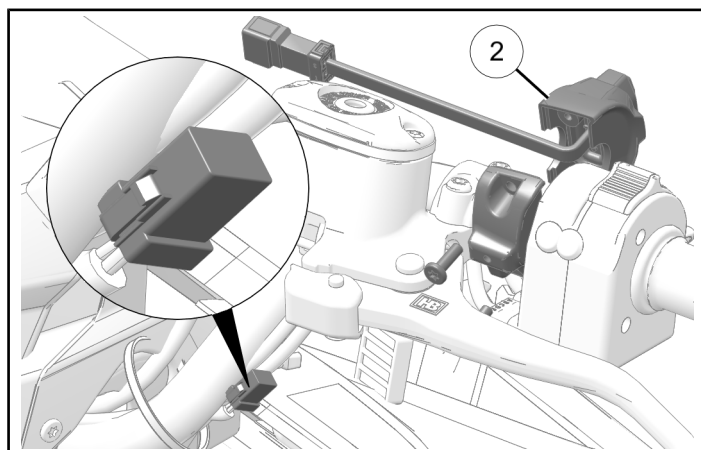
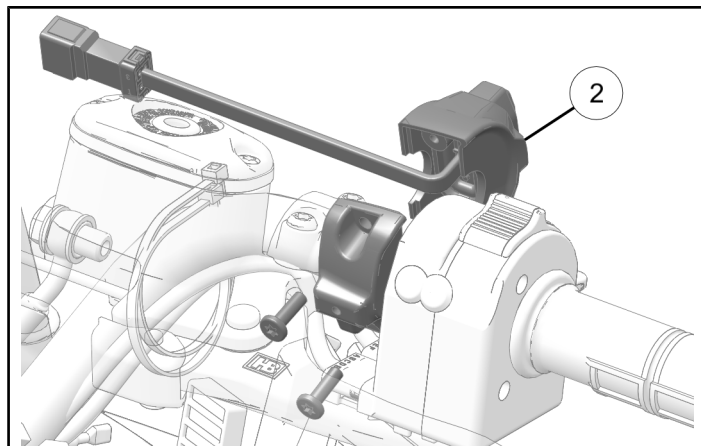

AUTO STOP WIRING CONNECTION – HD 3500 AND HD 3500 PRO

1. Connect Auto Stop wiring to chassis harness.

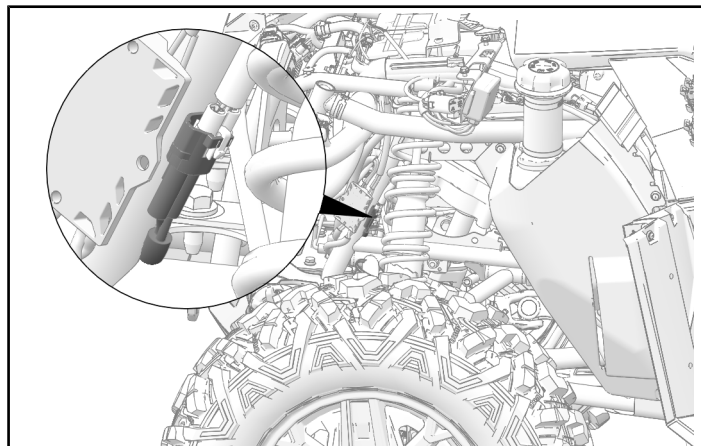

REMOTE CONTROL AND FAIRLEAD CONTROL SYSTEM INSTALLATION - HD 3500 PRO

1. Install fairlead control module ④ on left side frame tube. Attach control module with cable ties.

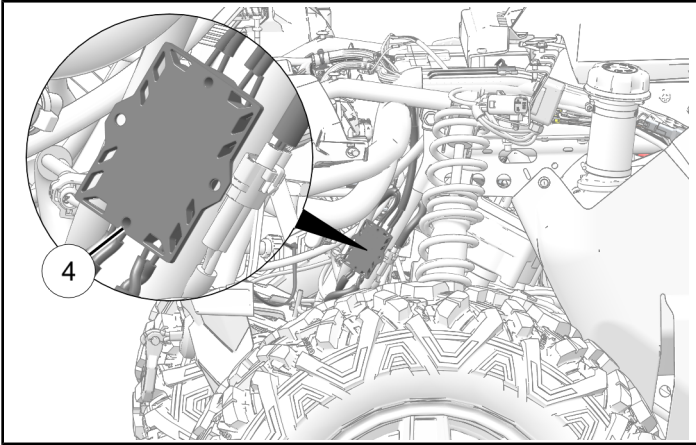

2. Install wireless receiver ③ on upper body bracket. Install cables along frame tube as shown. Attach wireless receiver with cable ties.

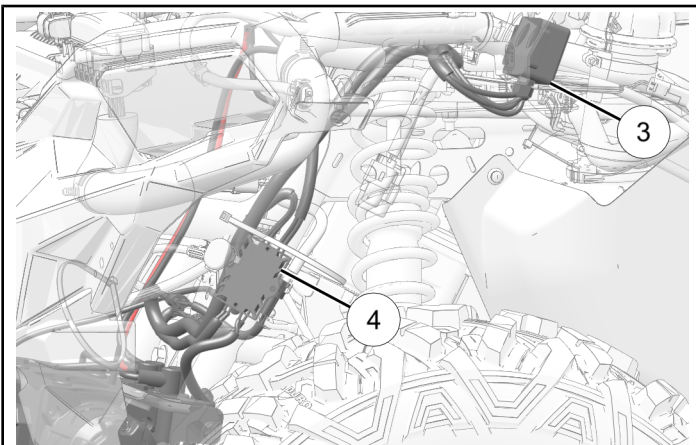
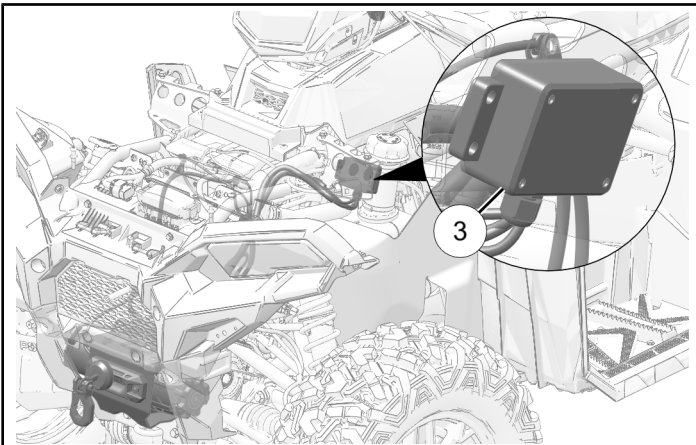

3. Install wireless remote control holder ⑦ using screws ⑨.

TIP

Location shown is a suggestion. Wireless remote holder may be installed in other locations. Make sure no fuel or electrical connections are at risk of being contacted by mounting screws.

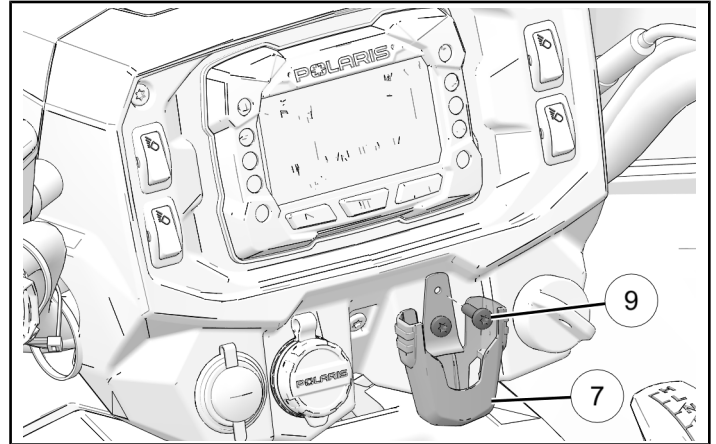

VEHICLE REASSEMBLY

GENERAL

1. Make sure there are no exposed wires or terminals, or pinched wiring. Tightly bind all loose wires and attach away from moving parts and heat sources.

BATTERY CONNECTION

1. Connect all wires using retained battery connection screws.

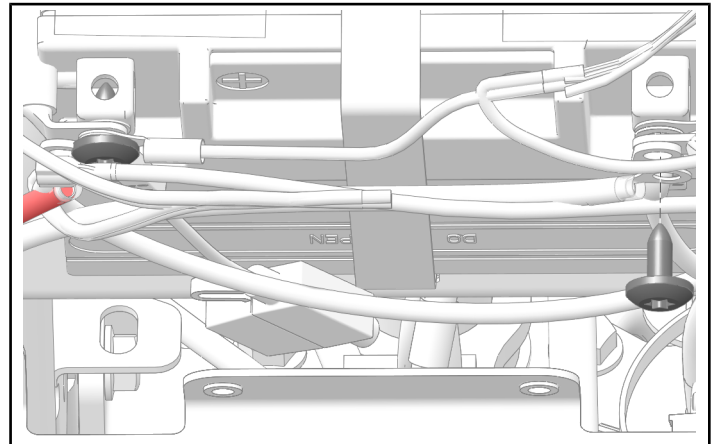

2. Put battery cover in place.

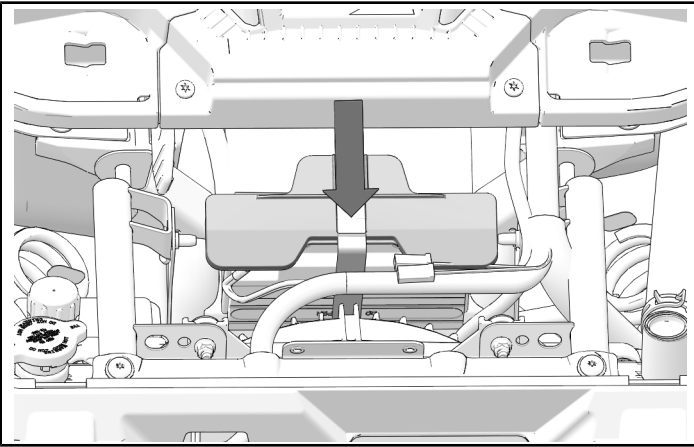

3. Install storage bin and lock in place.

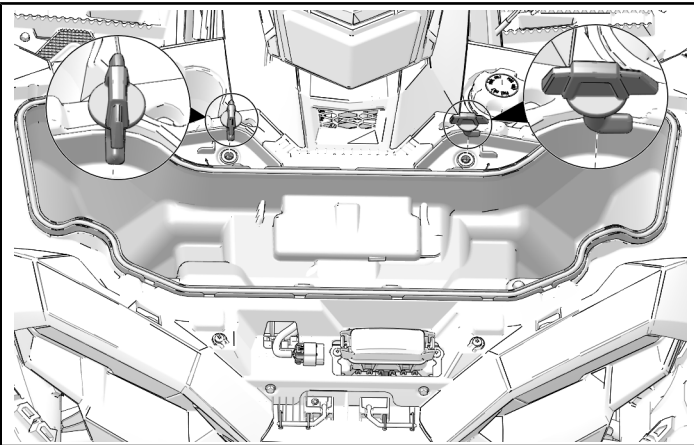

4. Install storage bin cover and secure with straps.

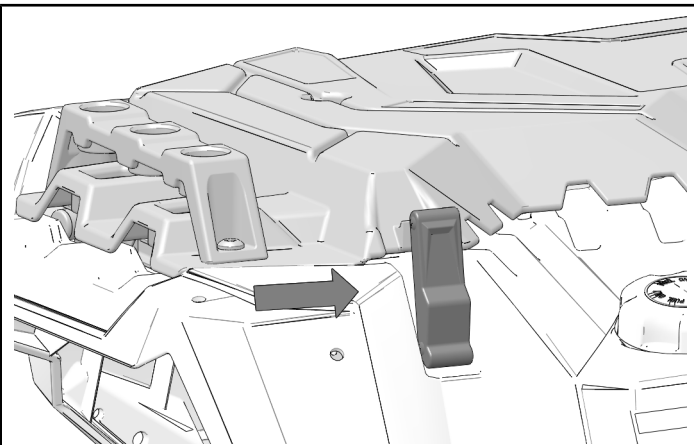

FRONT BUMPER COVER INSTALLATION

1. Put bumper cover in position on vehicle.

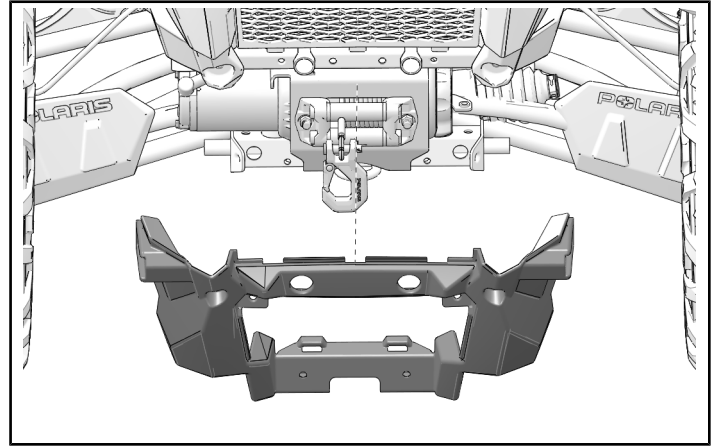

2. Install four retained bolts and torque to specification.

TORQUE

Bumper Cover Bolts:
79 in-lbs (9 N·m)

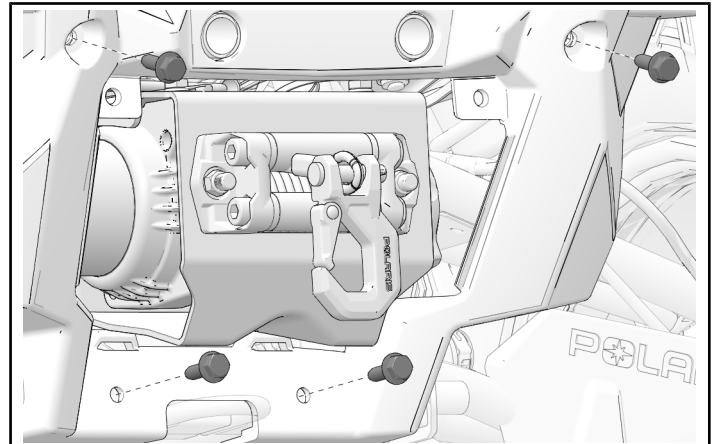

INSTRUCTION FEEDBACK FORM

A feedback form has been created for the installer to provide any comments, questions or concerns about the installation instructions. The form is viewable on mobile devices by scanning the QR code or by clicking [HERE](#) if viewing on a PC.

