

FRONT RECEIVER KIT



P/N 2884692

BEFORE YOU BEGIN

Read these instructions and check to be sure all parts and tools are accounted for. Please retain these installation instructions for future reference and parts ordering information.

APPLICATION

Verify accessory fitment at www.polaris.com.

KIT CONTENTS

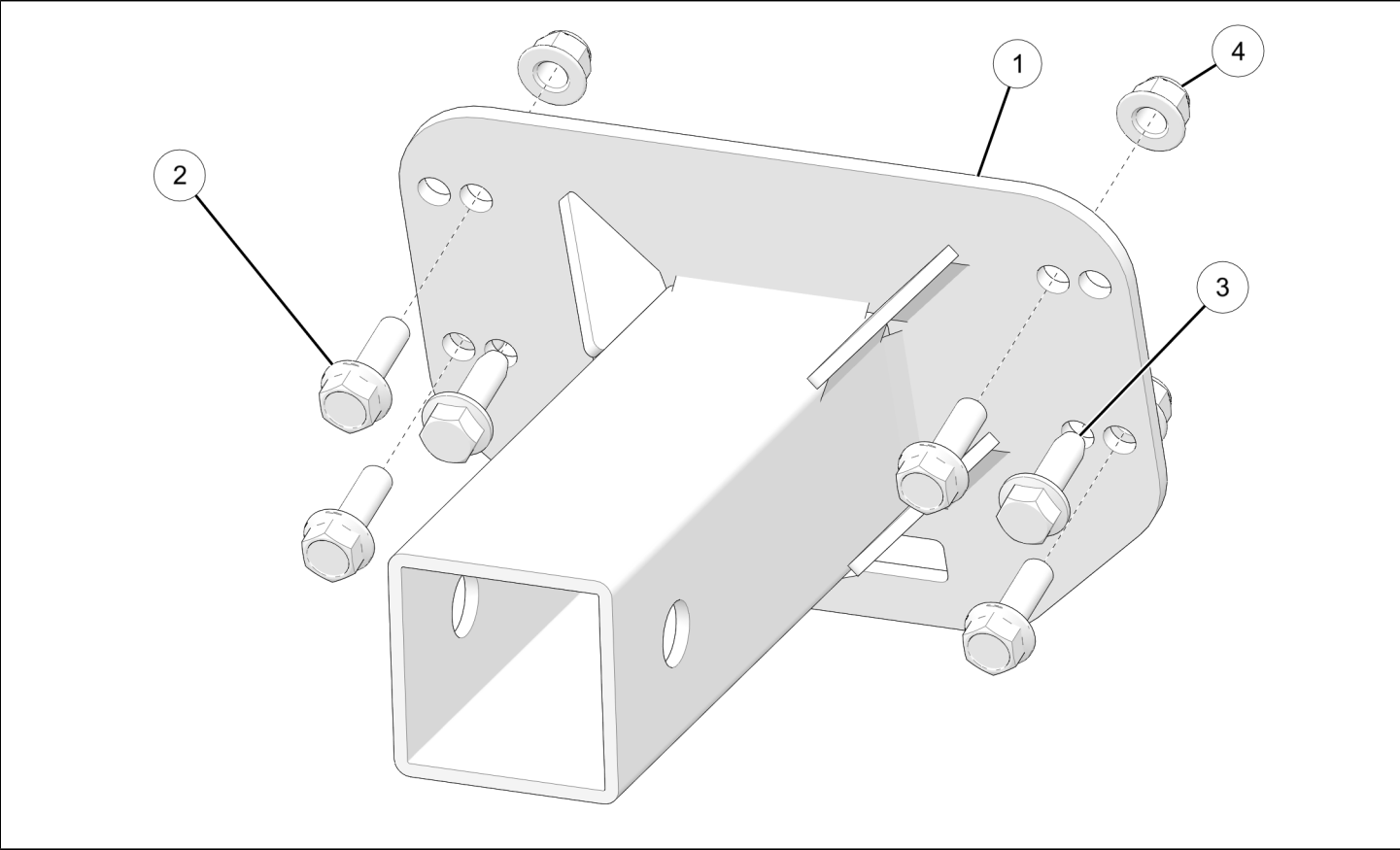

REF	QTY	PART DESCRIPTION	P/N AVAILABLE SEPARATELY
1	1	Receiver, Front	N/A
2	4	Screw, Hex Flange, M8 x 1.25 x 25 mm	7518514
3	2	Screw, Hex Flange, Self-Tapping, M8 x 1.25 x 25 mm	7519156
4	4	Nut, Hex Flange, Locking, M8 x 1.25 mm	7547332

TOOLS REQUIRED

- Safety Glasses
- Torque Wrench
- Socket Set, Metric
- Wrench Set, Metric

IMPORTANT

Your Front Receiver Kit is exclusively designed for your vehicle. Please read the installation instructions thoroughly before beginning. Installation is easier if the vehicle is clean and free of debris. For your safety, and to ensure a satisfactory installation, perform all installation steps correctly in the sequence shown.

INSTALLATION INSTRUCTIONS

WARNING

Do not exceed maximum capacities. Exceeding maximum capacities may result in receiver failure, resulting in death, serious personal injury, or serious damage to vehicle or property.

Maximum Tongue Weight: 100 lbs (45 Kg)

Maximum Tow Weight: 1200 lbs (540 Kg)

VEHICLE PREPARATION

GENERAL

1. Park vehicle on a flat surface.
2. Shift vehicle into PARK.
3. Turn key to OFF position and remove key.

NON-HD FRONT BUMPER REMOVAL

CAUTION

Bumper weighs approximately 31 lbs (14 kg). Failure to adequately support bumper during removal may result in personal injury or damage to equipment.

1. Remove and keep nut (A) and bolt (B). Repeat for opposite side.

NOTICE

RH side detail shown; LH side similar.

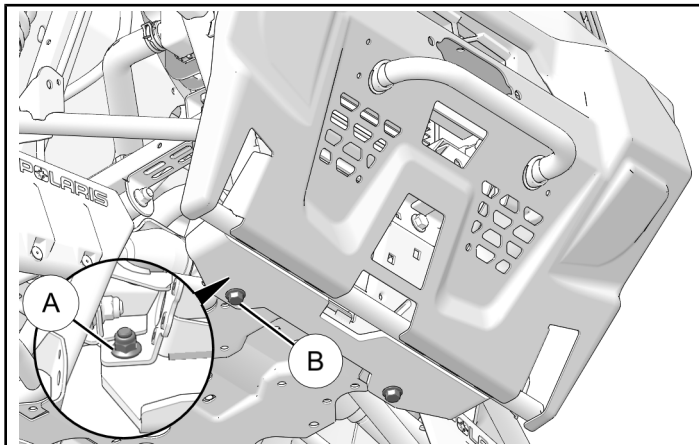

2. Support bumper, remove and keep nut (C) and bolt (D). Repeat for opposite side.

NOTICE

RH side detail shown; LH side similar.

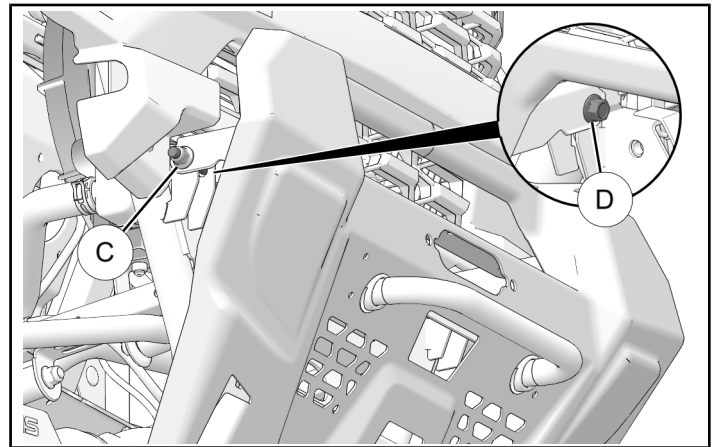

ACCESSORY INSTALLATION

TIP

To differentiate between screws (3) and (2):
Screw (2) is NOT self-tapping and has a blunt tip without any tapering.
Screw (3) is self-tapping and will be notched and tapered.

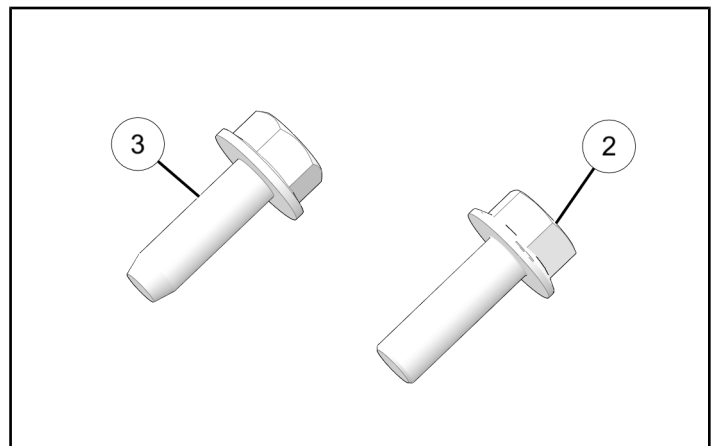

MY20 AND OLDER MODELS

1. Put front receiver ① in position on bracket. Install two screws ② through top two inside holes. Install two nuts ④ onto screws. Install two self tapping screws ③ through the bottom two inside holes. Torque nuts and screws to specification. **Make sure the screws are installed through the inside holes.**

TORQUE

Screw ③ and Nut ④:
18 ft-lbs (24 N·m)

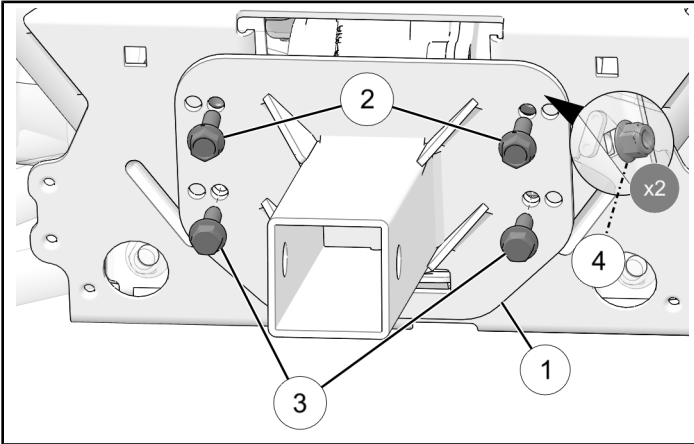

MY21 AND NEWER MODELS

1. Put front receiver ① in position on bracket. Install with four screws ② through the four outside holes. Install four nuts ④ onto screws. Torque nuts to specification. **Make sure the screws are installed through the outside holes.**

TORQUE

Nut ④:
18 ft-lbs (24 N·m)

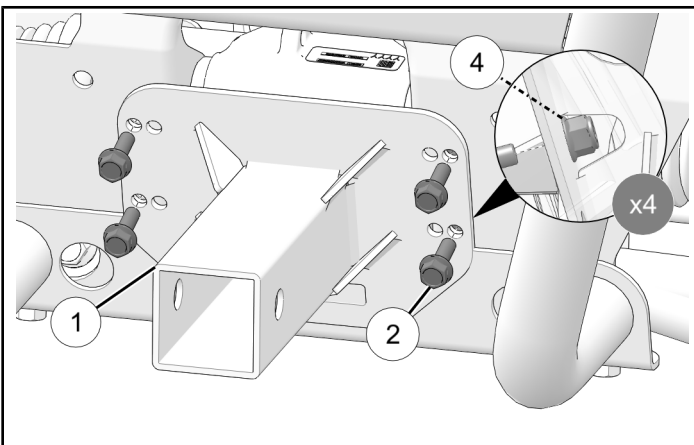

VEHICLE REASSEMBLY

NON-HD FRONT BUMPER INSTALLATION

⚠ CAUTION

Bumper weighs approximately 31 lbs (14 kg). Failure to adequately support bumper during installation may result in personal injury or damage to equipment.

1. Support bumper, install nut ③ and bolt ⑤. Torque to specification. Repeat for opposite side.

NOTICE

RH side detail shown; LH side similar.

TORQUE

Nut ③:
36 ft-lbs (50 N·m)

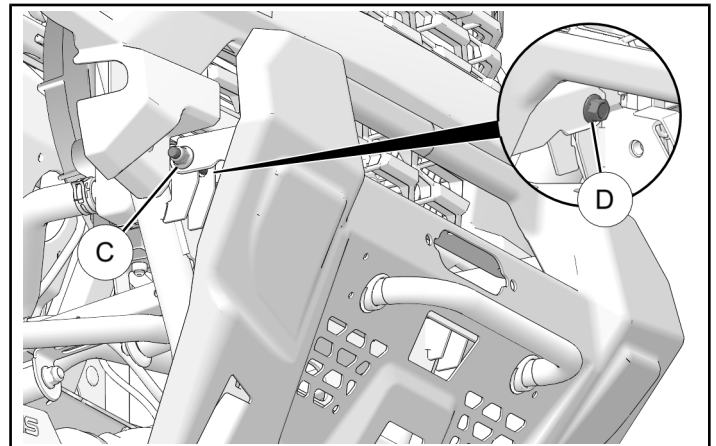

2. Install nut ① and bolt ②. Torque to specification.
Repeat for opposite side.

NOTICE

RH side detail shown; LH side similar.

TORQUE

Nut ①:
36 ft-lbs (50 N·m)

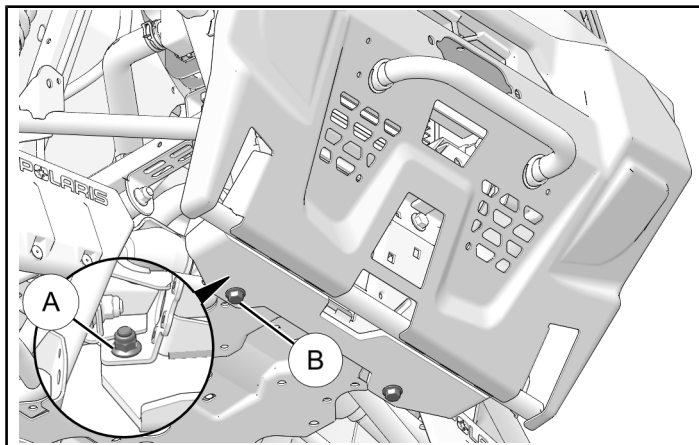

INSTRUCTION FEEDBACK FORM

A feedback form has been created for the installer to provide any comments, questions or concerns about the installation instructions. The form is viewable on mobile devices by scanning the QR code or by clicking [HERE](#) if viewing on a PC.

