

ROPS MOUNTED SIDE MIRROR KIT



P/N 2889243

BEFORE YOU BEGIN

Read these instructions and check to be sure all parts and tools are accounted for. Please retain these installation instructions for future reference and parts ordering information.

APPLICATION

Verify accessory fitment at www.polaris.com.

KIT CONTENTS

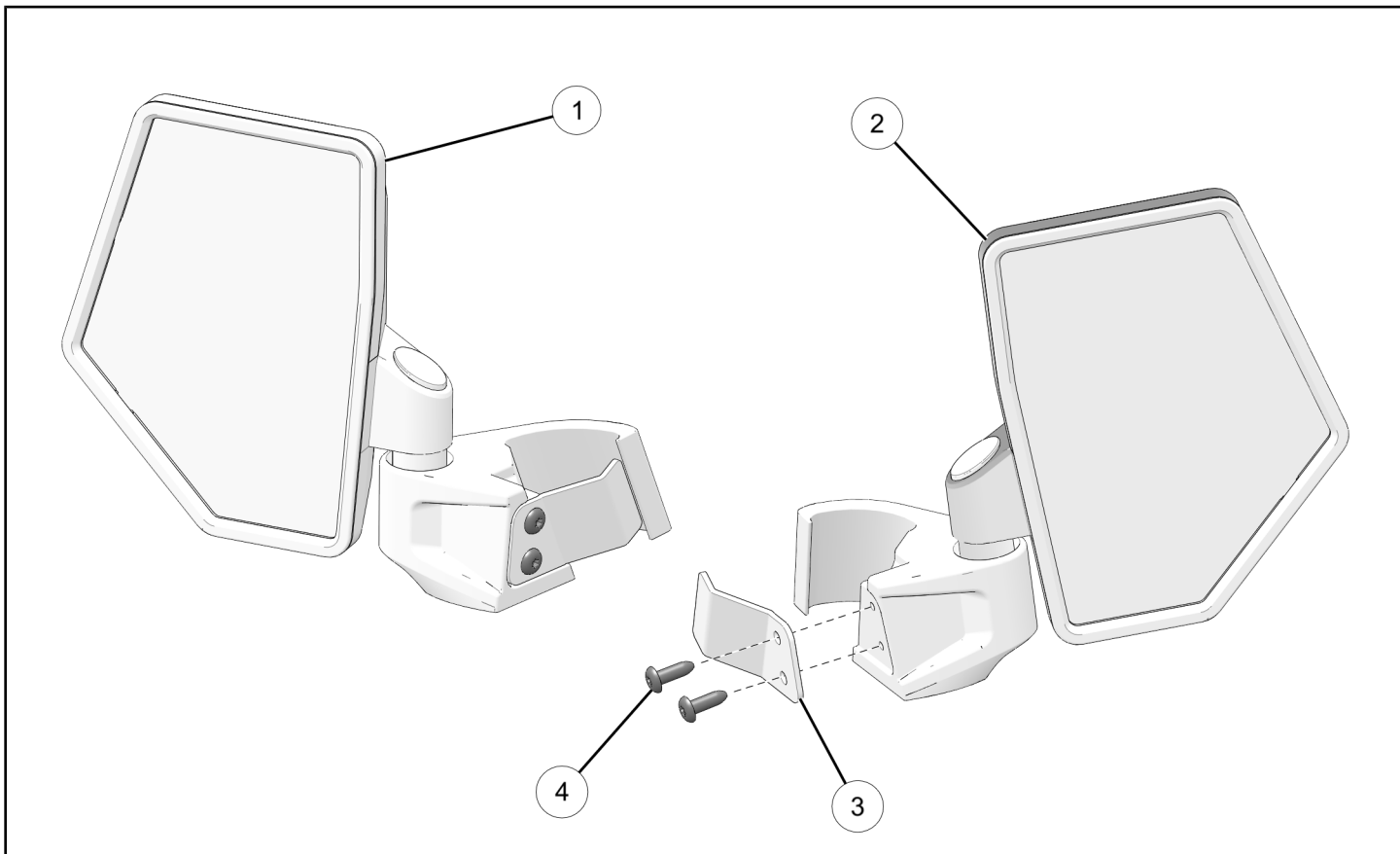

REF	QTY	PART DESCRIPTION	P/N AVAILABLE SEPARATELY	AVAILABLE SERVICE KIT
1	1	Assembly – Mirror, Left-hand, ROPS	n/a	2209162
2	1	Assembly – Mirror, Right-hand, ROPS	n/a	2209163
3	2	Assembly – Mounts, ROPS	n/a	2209165
4	4	Screw – Truss Head, #14 x 3/4 in	n/a	2209165

TOOLS REQUIRED

- Socket Set, Hex Bit, Metric
- Socket Set, Torx® Bit

IMPORTANT

Your ROPS Mounted Side Mirror Kit is exclusively designed for your vehicle. Please read the installation instructions thoroughly before beginning. Installation is easier if the vehicle is clean and free of debris. For your safety, and to ensure a satisfactory installation, perform all installation steps correctly in the sequence shown.

INSTALLATION INSTRUCTIONS

VEHICLE PREPARATION

GENERAL

1. Park vehicle on a flat surface.
2. Shift vehicle into PARK.
3. Turn key to OFF position and remove key.

ACCESSORY INSTALLATION

NOTICE

Left side shown; right side similar.

1. Lock left-hand mirror assembly ① onto driver side roll over protection system (ROPS) bar.

NOTICE

The mirror will click into place and lock onto the ROPS bar.

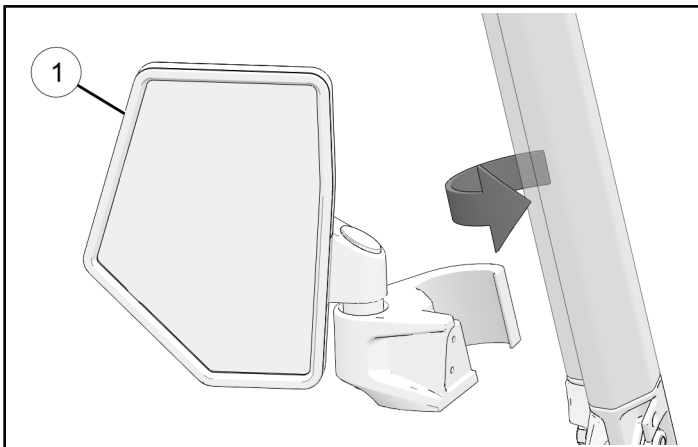

2. Install mirror plate ③ with two screws ④.

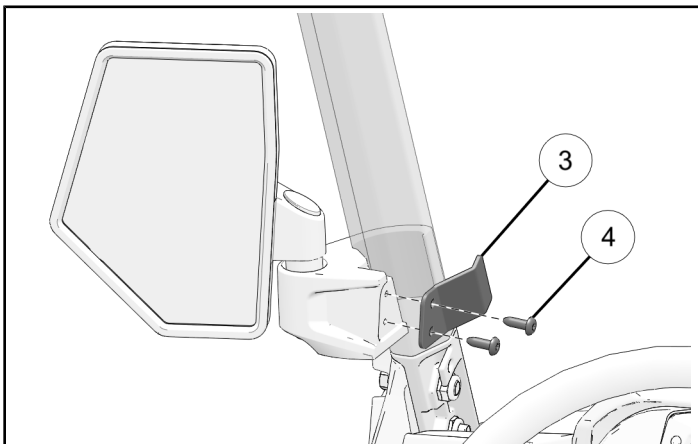

3. Tighten screws until fully seated.

OPERATION

1. Adjust mirrors for best visibility.
2. Tighten pivot bolt as needed.

IMPORTANT

Mirror pivot joint is designed to give way under impact to avoid potential damage. Avoid over tightening pivot bolt when in areas or situations where mirror impacts are more likely to happen. Over tightening pivot bolts could cause damage to the side mirrors in the event of an impact.

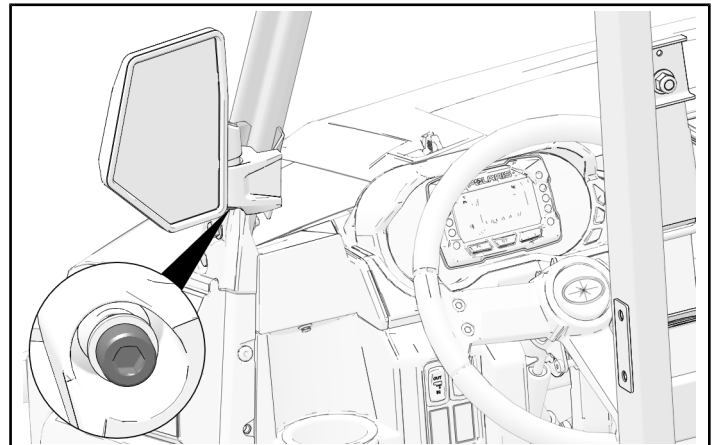

INSTRUCTION FEEDBACK FORM

A feedback form has been created for the installer to provide any comments, questions or concerns about the installation instructions. The form is viewable on mobile devices by scanning the QR code or by clicking [HERE](#) if viewing on a PC.

