

RHINO-RACK® BOX BACKBONE KIT



P/N 2889235

BEFORE YOU BEGIN

Read these instructions and check to be sure all parts and tools are accounted for. Please retain these installation instructions for future reference and parts ordering information.

APPLICATION

Verify accessory fitment at www.polaris.com.

REQUIRED SOLD SEPARATELY

Only parts for installation of the Rhino-Rack® Box Backbone Kit are included. For complete installation, the following additional kit is required (sold separately):

- Platform Kit, P/N 2889236

KIT CONTENTS

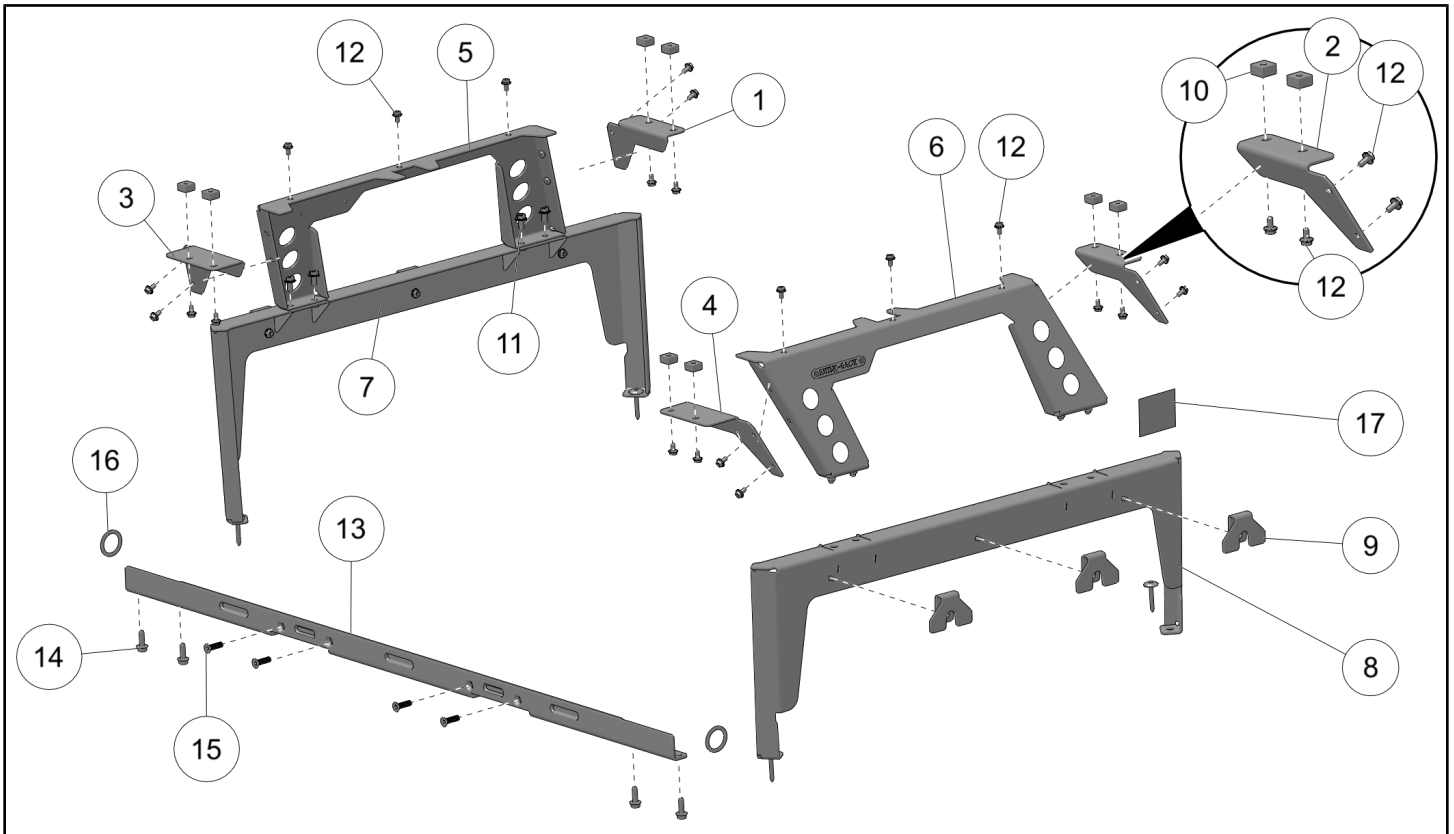

REF	QTY	PART DESCRIPTION	P/N AVAILABLE SEPARATELY	AVAILABLE SERVICE KIT
1	1	Bracket-Front, Tube, Left	n/a	n/a
2	1	Bracket-Front, Tube, Right	n/a	n/a
3	1	Bracket-Rear, Tube, Left	n/a	n/a
4	1	Bracket-Rear, Tube, Right	n/a	n/a
5	1	Weld-Backbone, Lower, Left	n/a	n/a

REF	QTY	PART DESCRIPTION	P/N AVAILABLE SEPARATELY	AVAILABLE SERVICE KIT
6	1	Weld-Backbone, Lower, Right	n/a	n/a
7	1	Weld-Bracket, Box, Lower, Left	n/a	n/a
8	1	Weld-Bracket, Box, Lower, Right	n/a	n/a
9	6	Bracket, Box-Wall	n/a	2209073
10	8	Nut, M6 20 x 20 X 1 1 mm Channel	n/a	2209073
11	8	Screw, Hex Flange Head, M8 x 1.25 X 16 mm	n/a	2209073
12	28	Screw, Hex Flange Head, M6 x 1.0 X 12 mm	n/a	2209073
13	1	Weld-Rhino-Rack®, Box, Brace	1027841	n/a
14	4	Screw, Hex Flange Head, M8 x 1.25 X 25 mm	7519156	n/a
15	4	Screw, Torx® Flat Head, M8 x 1.25 X 30 mm	7528129	n/a
16	2	Washer, 1.28 x 1.69 x .075 mm	7555939	n/a
17	1	Warning Decal, Never Carry Fuel	7186122	n/a

TOOLS REQUIRED

- Drill
- Screwdriver Set, Torx®
- Socket Set, Torx® Bit
- Torque Wrench
- Wrench Set, Metric
- **Special Service Tool:**
 - Torque Tool, included in *Platform Kit*, P/N2889236 (or equivalent)
 - T4 — 10 mm Socket **1/4 in** Driver, included in *Platform Kit*, P/N2889236 (or equivalent)

IMPORTANT

Your Rhino-Rack® Box Backbone Kit is exclusively designed for your vehicle. Please read the installation instructions thoroughly before beginning. Installation is easier if the vehicle is clean and free of debris. For your safety, and to ensure a satisfactory installation, perform all installation steps correctly in the sequence shown.

INSTALLATION INSTRUCTIONS

VEHICLE PREPARATION

GENERAL

1. Park vehicle on a flat surface.
2. Shift vehicle into PARK.
3. Turn key to OFF position and remove key.

ACCESSORY INSTALLATION

BRACKET INSTALLATION

1. Remove and keep four screws (A), remove and discard four angled box brackets (B) from corners of cargo box.

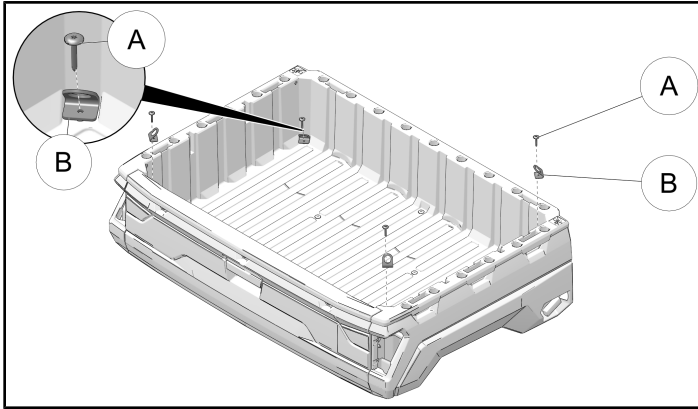

2. Install three box-wall brackets (9) onto left lower box bracket (7) and three box-wall brackets (9) onto right lower box bracket (8). Loosely secure with six screws (12).

DO NOT torque fasteners at this time.

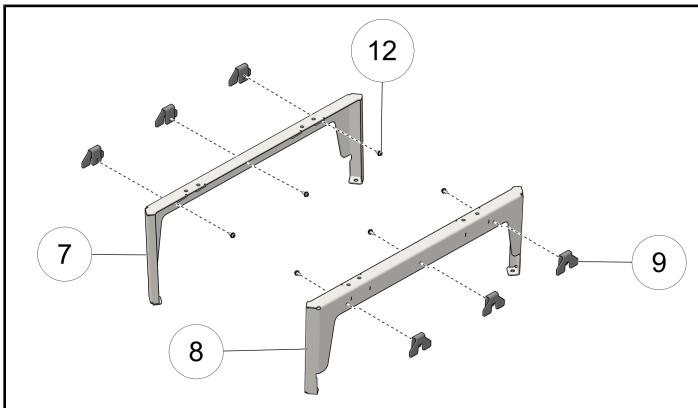

3. Place lower assembly brackets (7) and (8) in cargo box along left and right sides, aligning box-wall brackets (9) with cargo box walls.

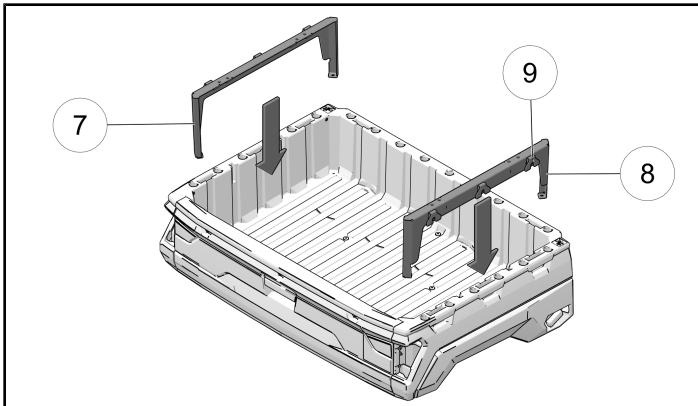

4. Secure lower box brackets (7) and (8) with 4 screws (A). Torque to specifications below.

NOTICE

Requires Torque Tool included in *Platform Kit* P/N 2889236.

TORQUE

Cargo Box Screws (A):
44 in-lbs (5 N·m)

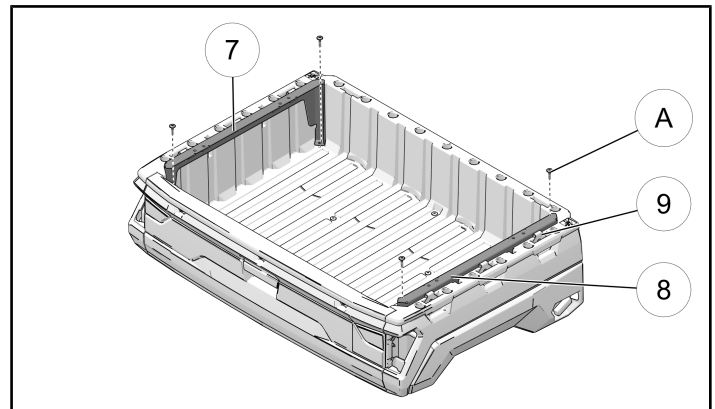

5. Secure box wall brackets (9). Torque screws (12) to specifications below.

TORQUE

Box Wall Bracket Screws (12):
10 ft-lbs (14 N·m)

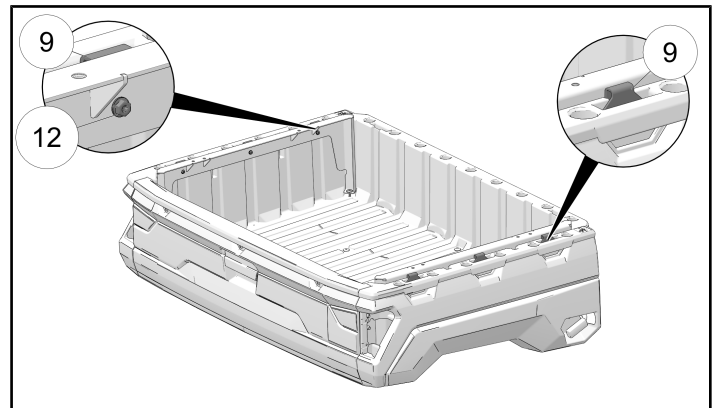

6. Install left backbone bracket ⑤ and right backbone bracket ⑥. Loosely secure with four screws ⑪ each.

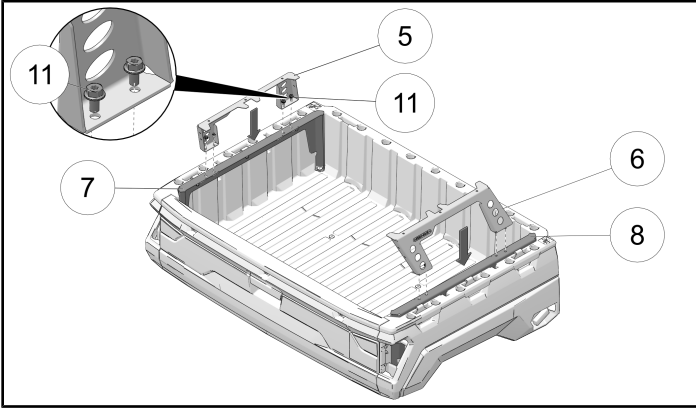

7. Insert eight channel nuts ⑩ into channel window of Platform Rack ③.

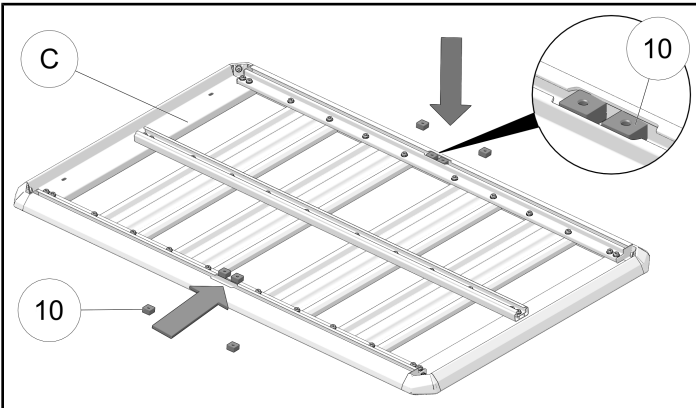

8. Loosely install front left ①, front right ②, rear left ③, and rear right ④ brackets to channel nuts ⑩ with screws ⑫, as shown below.

DO NOT torque fasteners at this time.

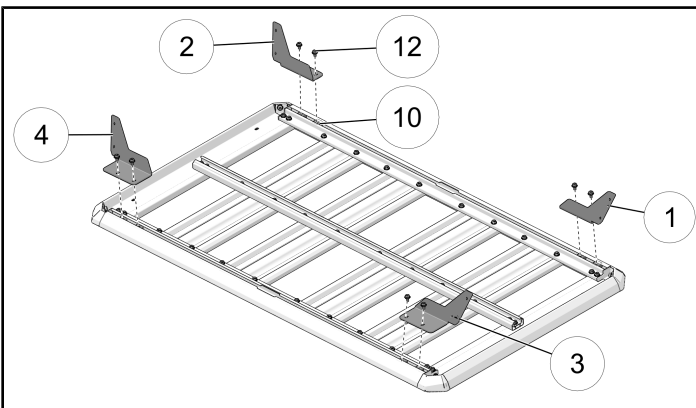

9. Rotate Platform Rack ③ so brackets ①, ②, ③, and ④ are on the bottom, as shown below.

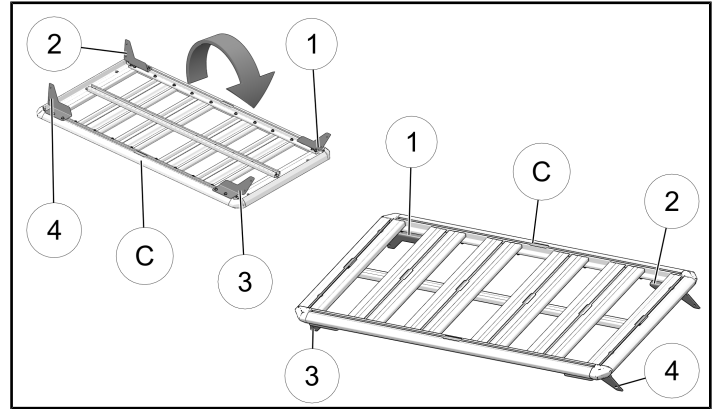

10. Secure the Platform Rack ③ onto backbone brackets ⑤ and ⑥ with screws ⑫, torque using torque tool included in Kit P/N 2889236 until tool clicks, or torque to specifications below.

TORQUE

Backbone Bracket Screws ⑫:
44 in-lbs (5 N·m)

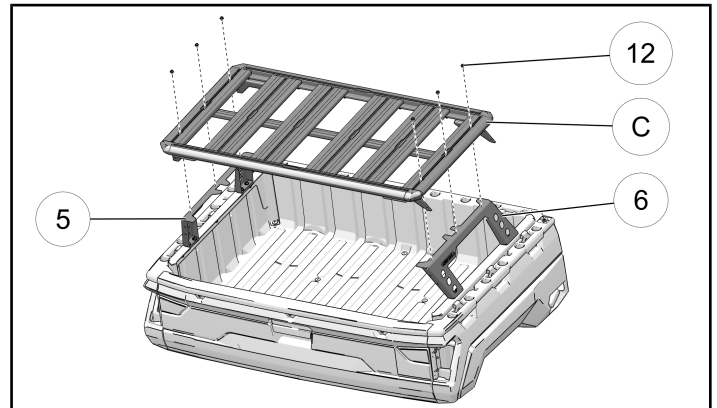

11. Secure backbone brackets. Torque eight screws ⑪ to specifications below.

TORQUE
Backbone Bracket Screws ⑪:
89 in-lbs (10 N·m)

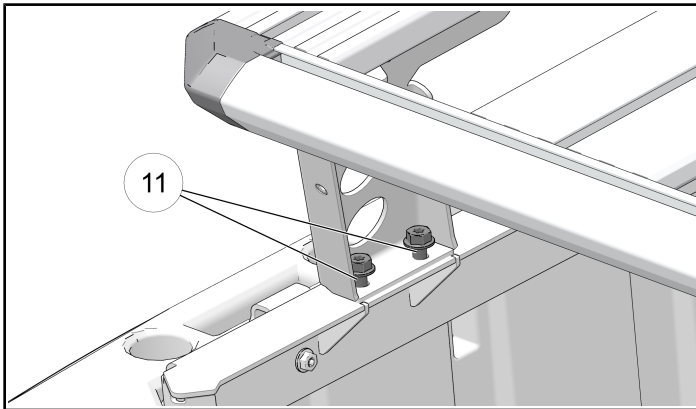

12. Slide front bracket ① and rear bracket ③ to the left. Slide front bracket ② and rear bracket ④ to the right. Loosely secure to backbone brackets ⑤ and ⑥ using 2 screws ⑫, each.

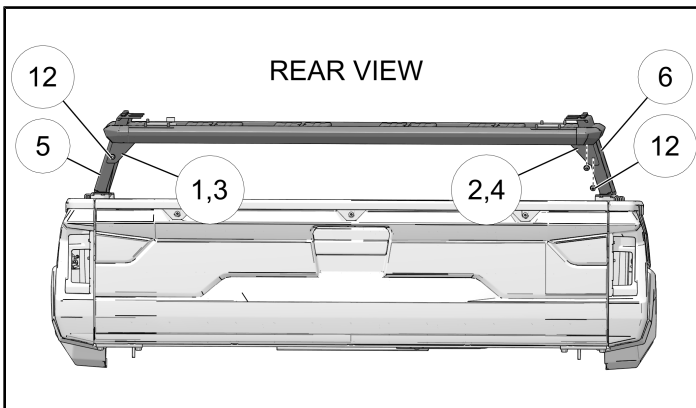

13. Use torque tool to tighten four screws ⑫ to front and rear brackets ①, ②, ③, ④.
Turn each screw with torque tool until in clicks or torque to specifications below.

TORQUE
Backbone Bracket Screws ⑫:
44 in-lbs (5 N·m)

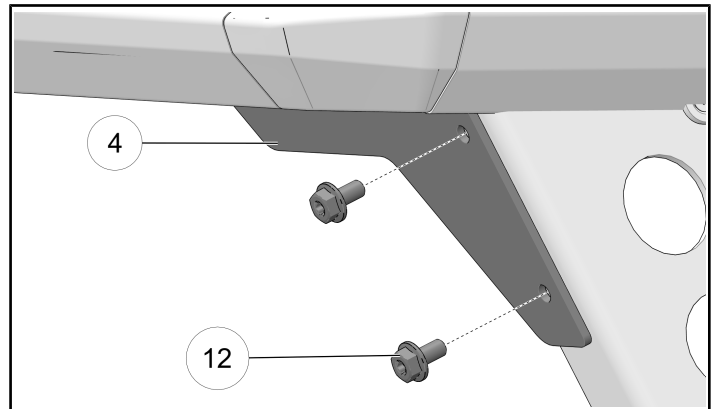

14. Secure Platform Rack ③ to top of front and rear brackets ①, ②, ③, and ④. Torque eight screws ⑫ using torque tool until tool clicks, or torque to specifications below.

TORQUE
Backbone Bracket Screws ⑫ :
44 in-lbs (5 N·m)

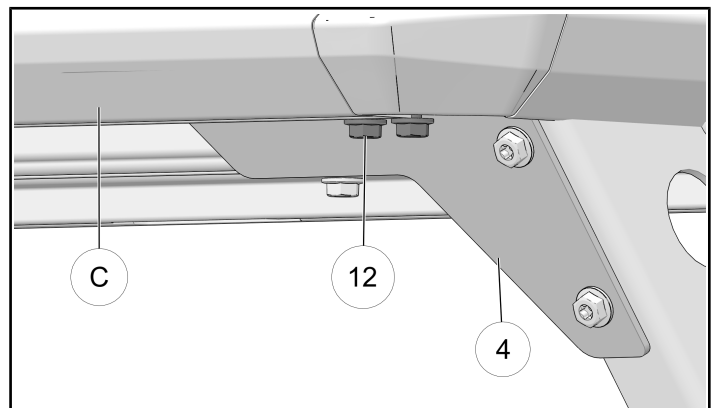

TAILGATE REMOVAL

1. Remove the cables from each side of the cargo box by lifting them off of each screw.

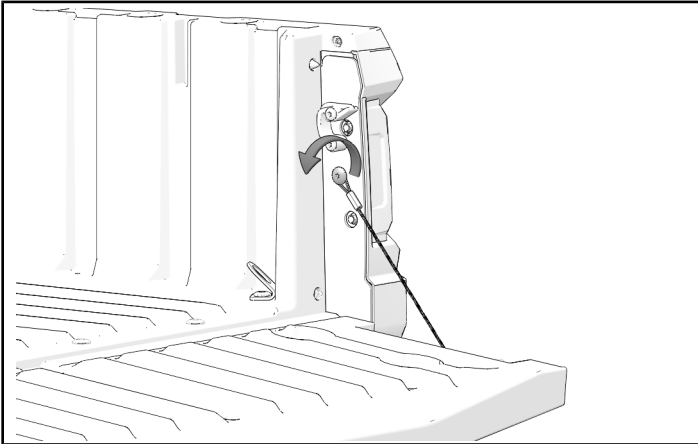

2. Tilt the tailgate downward.

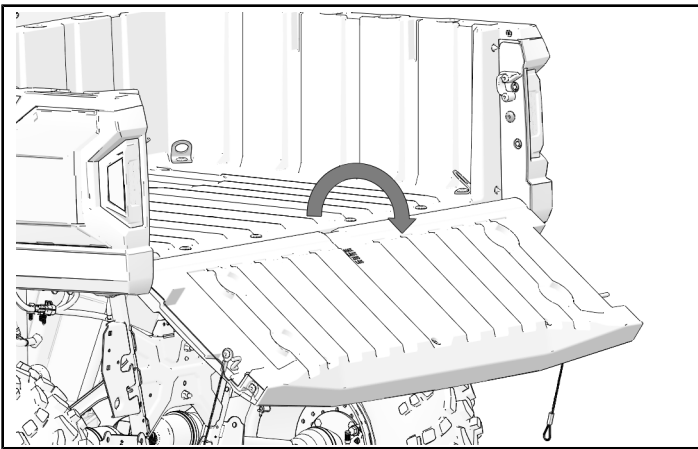

3. Pull left side of tailgate down, then move tailgate off of right side pivot on cargo box.

NOTICE

Left side pivot is slotted to allow tailgate to lift out.

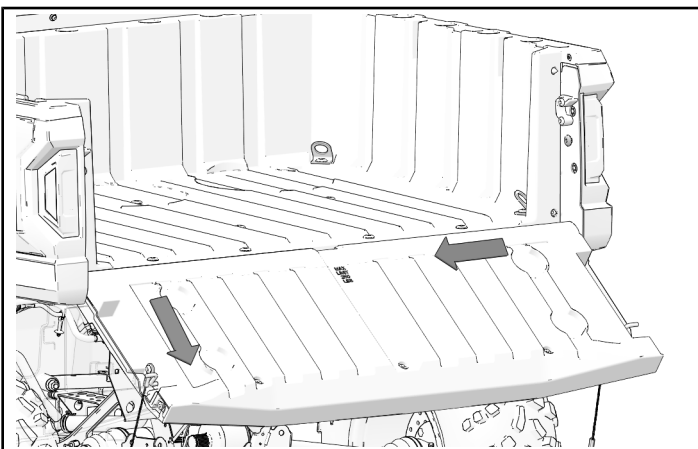

4. Set tailgate aside.

BRACE INSTALLATION

1. Remove and discard four screws (E) from below cargo box.

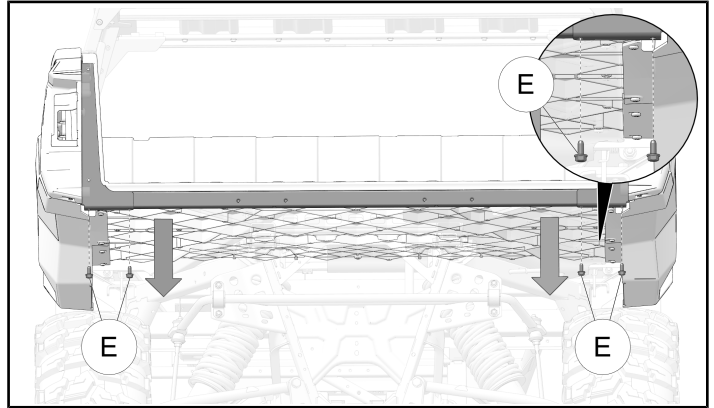

2. Place brace (B) against cargo box and loosely secure from underneath with four screws (14).

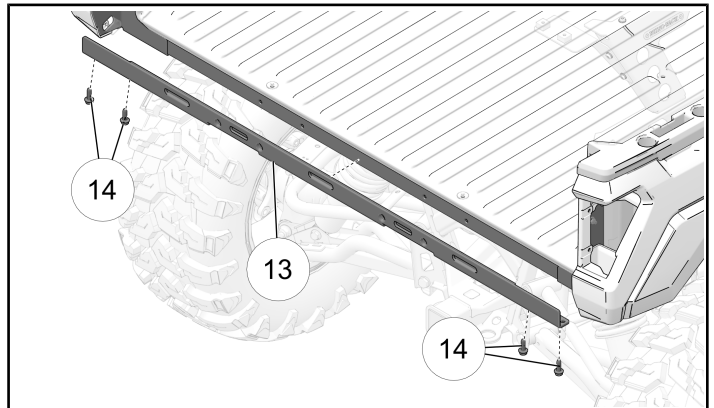

3. Install four screws ⑮ through the rear side of the brace. Torque to specifications below.

TIP

- For ease of installation, use impact driver or drill with T40 bit to install screws ⑮.
- If unable to align brace, use C-Clamps to hold brace to box.

TORQUE

Brace Screw ⑮:
10 ft-lbs (14 N·m)

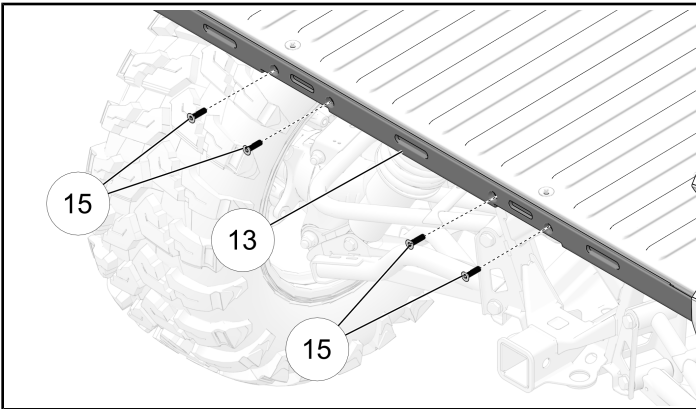

4. Torque lower screws ⑭ to specifications below.

TORQUE

Lower Brace Screw ⑭:
10 ft-lbs (14 N·m)

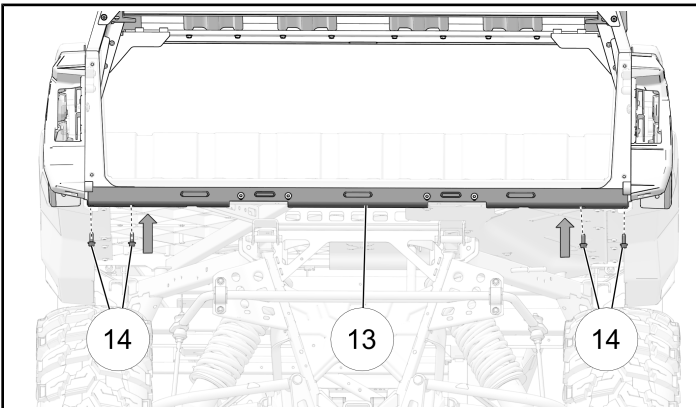

VEHICLE REASSEMBLY

TAILGATE INSTALLATION

1. Install tailgate into slotted pivot on cargo box and move to the right.

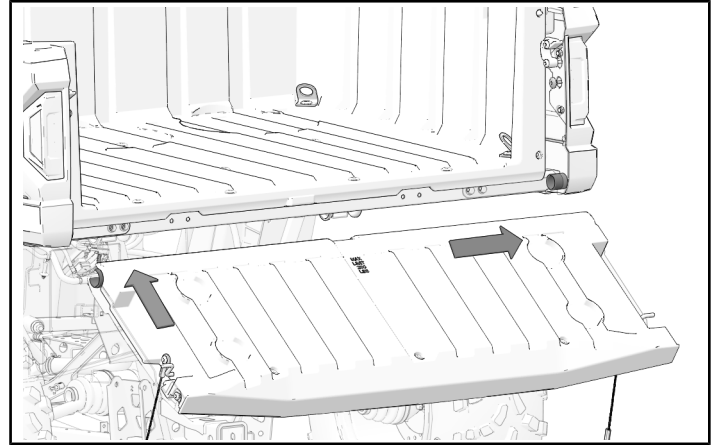

2. Check tailgate for side to side play. If there is not excessive play, skip to **step 4**.

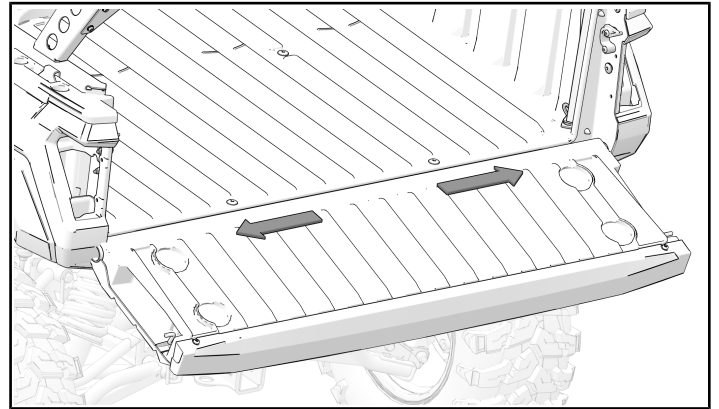

3. Remove excessive tailgate play by removing tailgate and installing washers ⑯ to the box side tailgate pivots ⑰.

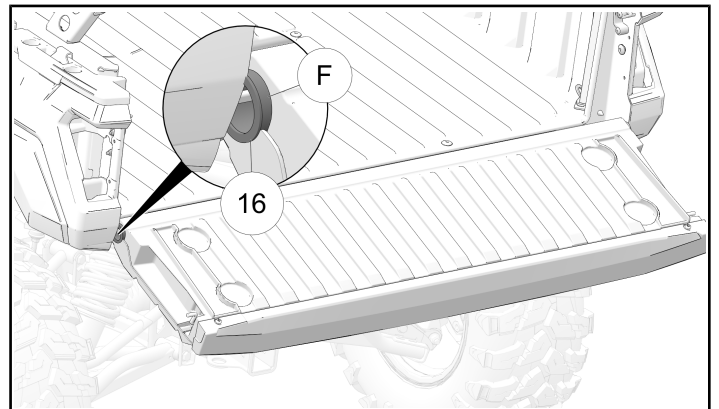

4. Attach cables to screws on cargo box.

5. Close tailgate.

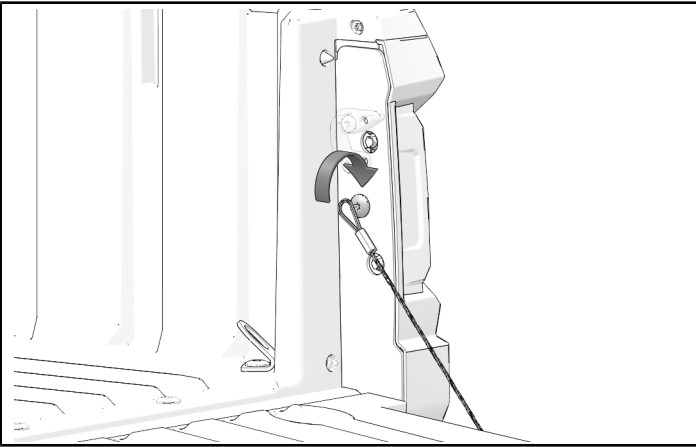

INSTRUCTION FEEDBACK FORM

A feedback form has been created for the installer to provide any comments, questions or concerns about the installation instructions. The form is viewable on mobile devices by scanning the QR code or by clicking [HERE](#) if viewing on a PC.

