

ROCK SLIDERS KIT



P/N 2889208-XXX

BEFORE YOU BEGIN

Read these instructions and check to be sure all parts and tools are accounted for. Please retain these installation instructions for future reference and parts ordering information.

ACCESSORY WEIGHT

Accessories, passengers, and other factors may negatively affect ride performance. Refer to your vehicle's owner's manual for maximum weight capacity and suspension adjustment procedures.

APPLICATION

Verify accessory fitment at www.polaris.com.

KIT CONTENTS

NOTICE

XXX = Polaris® color code (For example: 458 = Black)

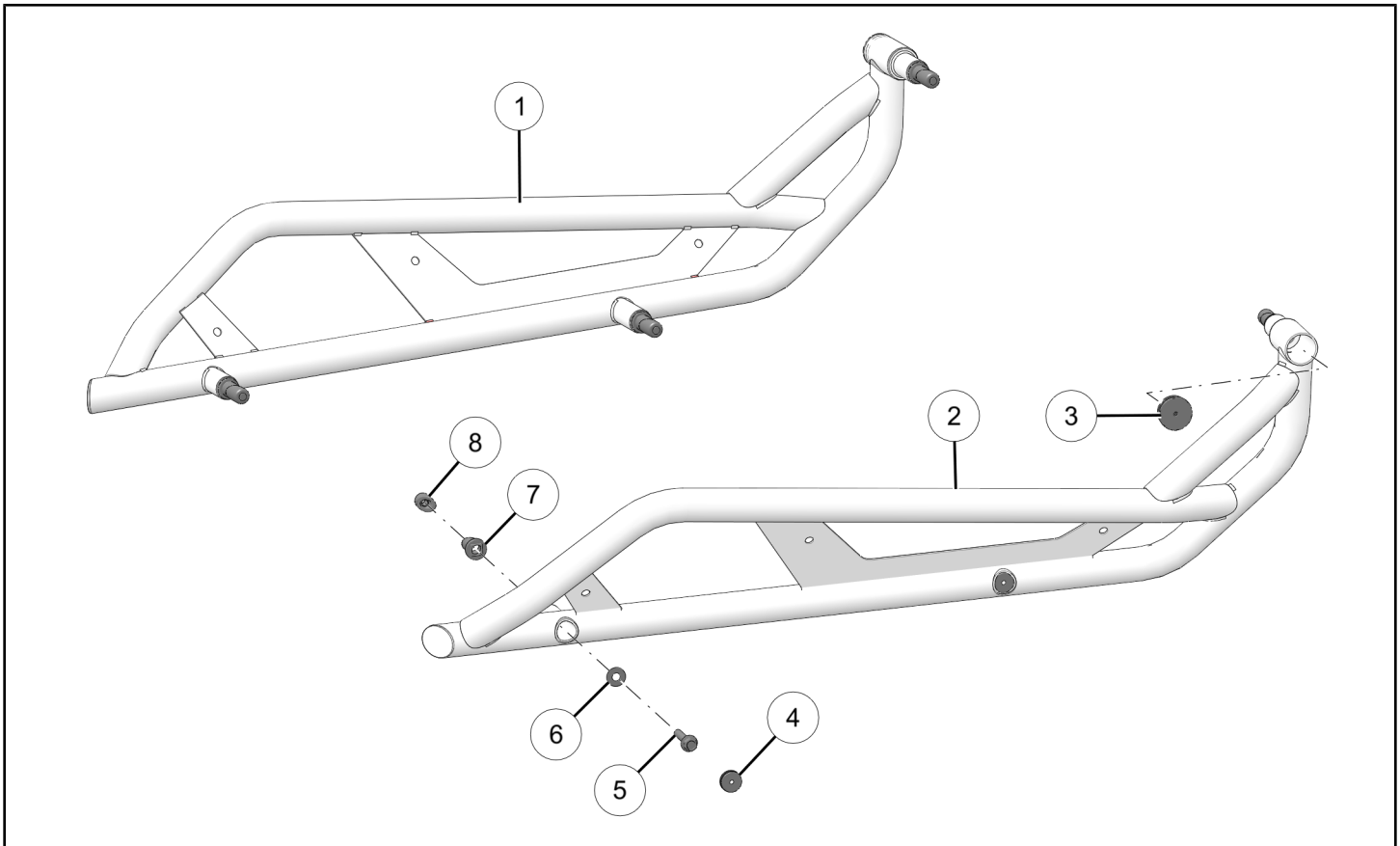

REF	QTY	PART DESCRIPTION	P/N AVAILABLE SEPARATELY	AVAILABLE SERVICE KIT
1	1	Weld-Rock Slider, Right-Hand	n/a	n/a
2	1	Weld-Rock Slider, Left-Hand	n/a	n/a
3	2	Plug-End Cap, 1.625 in Diameter	n/a	2208956

REF	QTY	PART DESCRIPTION	P/N AVAILABLE SEPARATELY	AVAILABLE SERVICE KIT
4	4	Plug–End Cap, 1.125 in Diameter	n/a	2208956
5	6	Screw–Hex Flange, M10 x 1.5 x 55 mm	n/a	2208956
6	6	Washer–0.453 x 1.0 x 0.078 in	n/a	2208956
7	6	Anchor–Wedge, Unthreaded	n/a	2208956
8	6	Anchor–Wedge, Threaded	n/a	2208956

TOOLS REQUIRED

- Safety Glasses
- Socket Set, Metric
- Torque Wrench

IMPORTANT

Your Rock Sliders Kit is exclusively designed for your vehicle. Please read the installation instructions thoroughly before beginning. Installation is easier if the vehicle is clean and free of debris. For your safety, and to ensure a satisfactory installation, perform all installation steps correctly in the sequence shown.

INSTALLATION INSTRUCTIONS

VEHICLE PREPARATION

GENERAL

1. Park vehicle on a flat surface.
2. Shift vehicle into PARK.
3. Turn key to OFF position and remove key.

ACCESSORY INSTALLATION

NOTICE

Left rock slider shown; right rock slider similar.

1. Loosely install one fastener ⑤ through washer ⑥, rock slider, unthreaded wedge anchor ⑦, and into threaded wedge anchor ⑧. Repeat for other anchor assemblies.

IMPORTANT

Make sure unthreaded wedge engages with rock slider mount.

TIP

Wedge anchors are glued together to ease alignment and installation. Avoid twisting anchors and breaking anchors apart before installing into chassis.

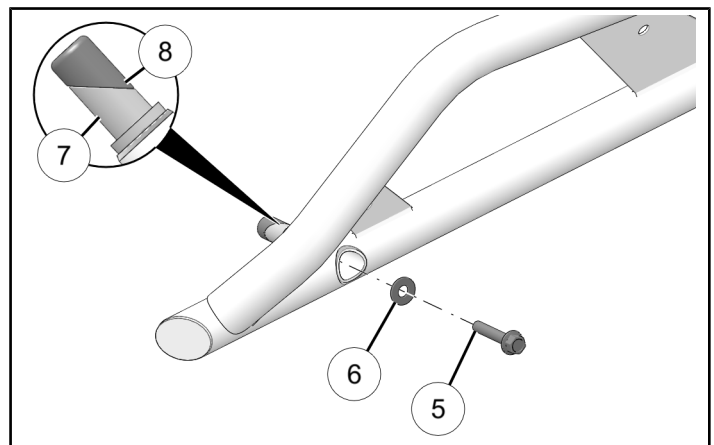

2. Identify three mounting locations on vehicle.

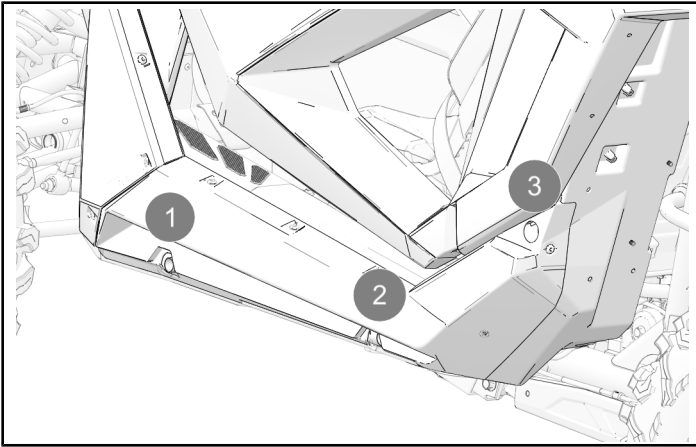

3. Put anchor assemblies into chassis mounting locations.

IMPORTANT

Make sure each anchor assembly is fully inserted into chassis tubes.

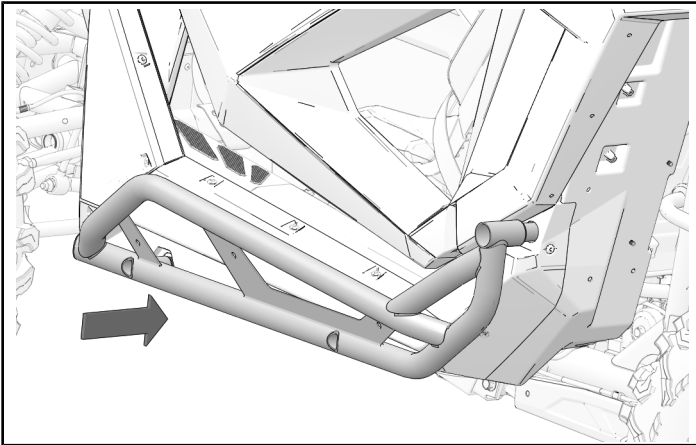

4. Torque three fasteners ⑤ to specification.

TIP

This torque specification deforms the chassis mount slightly, reducing the risk of a fastener loosening upon impact. Torquing the fasteners again is required in the following step.

TORQUE

Rock Slider Fasteners ⑤:
74 ft-lbs (100 N·m)

5. Loosen fasteners and torque three fasteners ⑤ to the new specification.

TORQUE

Rock Slider Fasteners ⑤:
50 ft-lbs (68 N·m)

6. Install two small diameter plugs ④ and one large diameter plug ③ into rock slider.

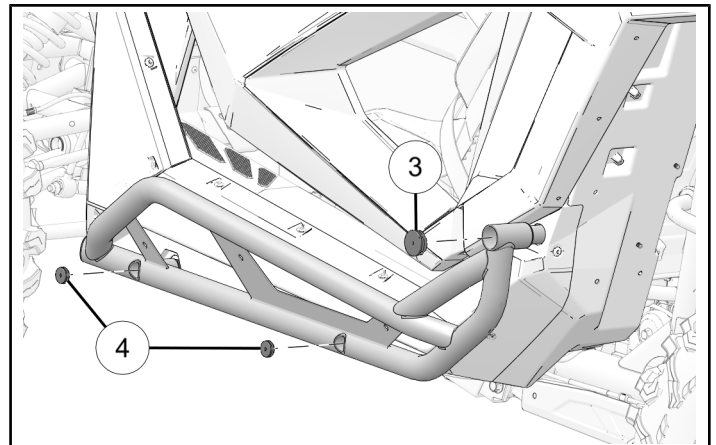

INSTRUCTION FEEDBACK FORM

A feedback form has been created for the installer to provide any comments, questions or concerns about the installation instructions. The form is viewable on mobile devices by scanning the QR code or by clicking [HERE](#) if viewing on a PC.

