

# PLOW LIFT KIT



P/N 2889058

## BEFORE YOU BEGIN

Read these instructions and check to be sure all parts and tools are accounted for. Please retain these installation instructions for future reference and parts ordering information.

## APPLICATION

Verify accessory fitment at [www.polaris.com](http://www.polaris.com).

## KIT CONTENTS

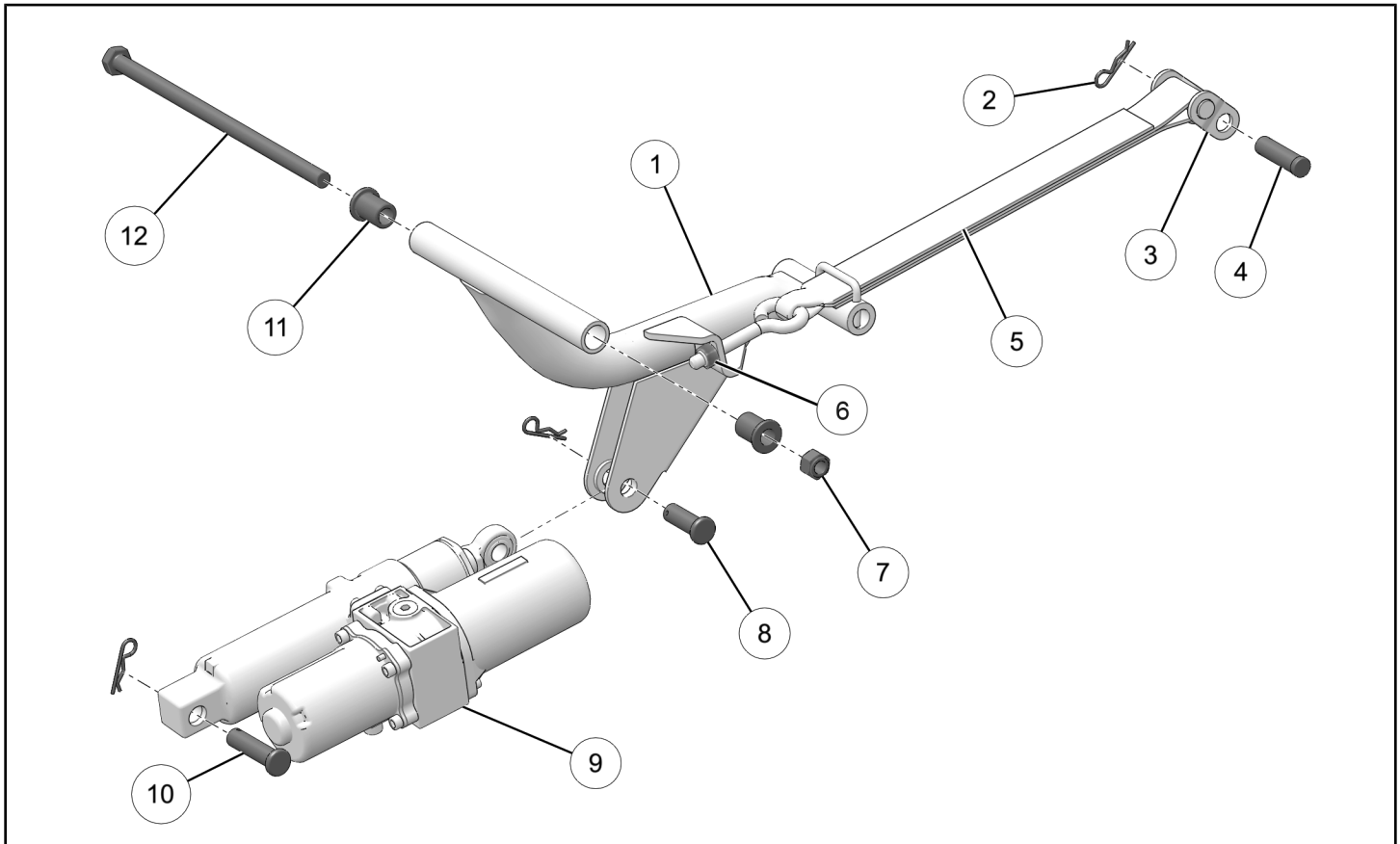

REF	QTY	PART DESCRIPTION	P/N AVAILABLE SEPARATELY	AVAILABLE SERVICE KIT
1	1	Plow-Lift Arm	n/a	n/a
2	3	Cotter Pin - 3 x 25	n/a	2204891
3	1	Link, Strap	n/a	2204891
4	1	Pin, Clevis - M14 x 47	n/a	2204891
5	1	Strap	n/a	2204963
6	1	Nut, Hex, Locking - M10 x 1.5	n/a	2204963
7	1	Nut, Hex, Locking - M12 x 1.75	n/a	2204891
8	1	Pin, Clevis - M14 x 39	n/a	2204891

REF	QTY	PART DESCRIPTION	P/N AVAILABLE SEPARATELY	AVAILABLE SERVICE KIT
9	1	Cylinder, Plow Lift	n/a	n/a
10	1	Pin, Clevis - M14 x 54	n/a	2204891
11	2	Bushing	n/a	2204891
12	1	Screw, Hex - M12 x 1.75 x 260	n/a	2204891
13	2	Cable Tie (not shown)	7080492	n/a

## TOOLS REQUIRED

- Safety Glasses
- Socket Set, Metric
- Wrench Set, Metric

## IMPORTANT

Your Plow Lift Kit is exclusively designed for your vehicle. Please read the installation instructions thoroughly before beginning. Installation is easier if the vehicle is clean and free of debris. For your safety, and to ensure a satisfactory installation, perform all installation steps correctly in the sequence shown.

## INSTALLATION INSTRUCTIONS

### VEHICLE PREPARATION

#### GENERAL

1. Park vehicle on a flat surface.
2. Shift vehicle into PARK.
3. Turn key to OFF position and remove key.

### ACCESSORY INSTALLATION

#### REMOVE PLOW LIFT FROM WINCH

1. If winch is NOT used to provide plow lift function, then proceed to Plow Lift installation step 1.
2. If winch IS used to provide plow lift function, then detach winch lift components. Make sure blade is resting firmly on the ground and that there is some slight slack in the winch cable/rope.

3. Remove and discard hairpin clip (A) and clevis pin (B).

#### NOTICE

Winch Kit P/N 2882716 shown; other winch kits similar.

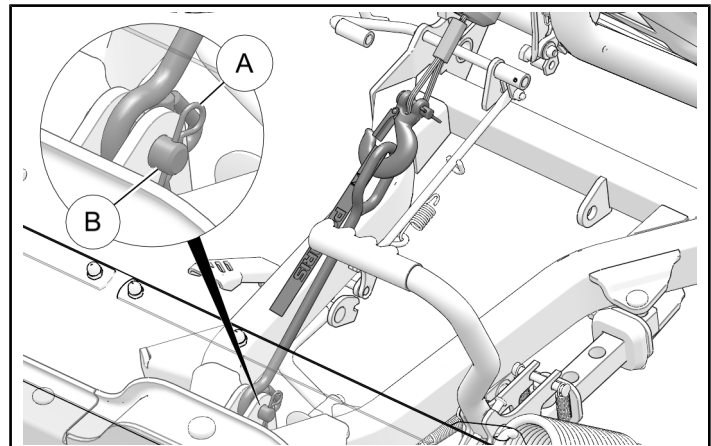

- Remove and discard lift link ③ from winch hook ④.

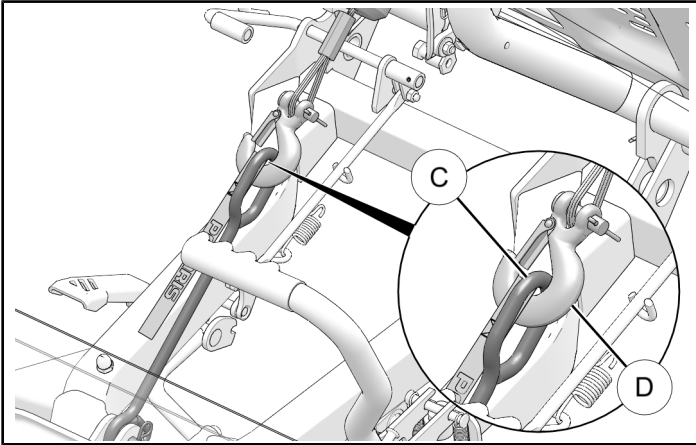

- Turn ignition switch to ACC position. Recover winch rope/cable, then turn ignition switch to OFF position and remove key.

**NOTICE**

See Winch Kit instructions for operation detail.

**PLOW LIFT INSTALLATION**

- Observe length and head profile of three clevis pins included in this kit.

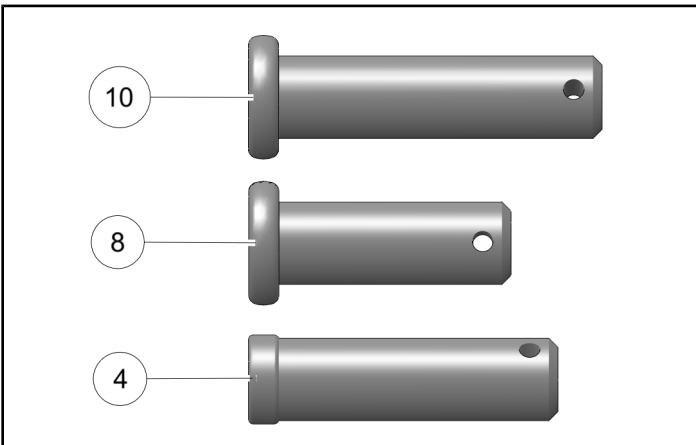

- Install rear end of lift cylinder ⑨ to pushframe bracket using LONG clevis pin ⑩ and hairpin clip ②.

**NOTICE**

Carefully allow cylinder to pivot down until forward end rests on kickstand ⑤.

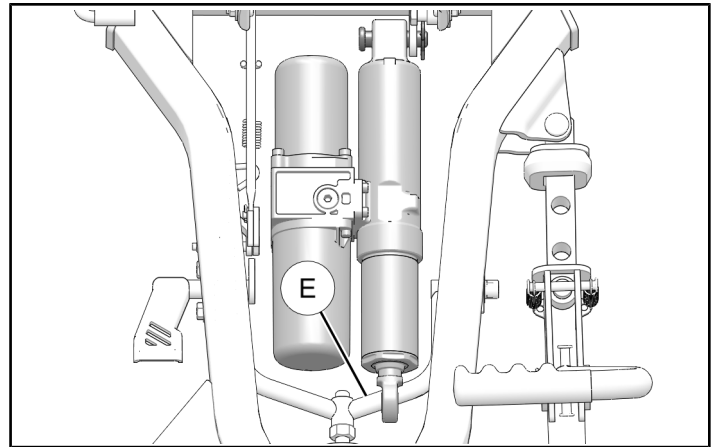
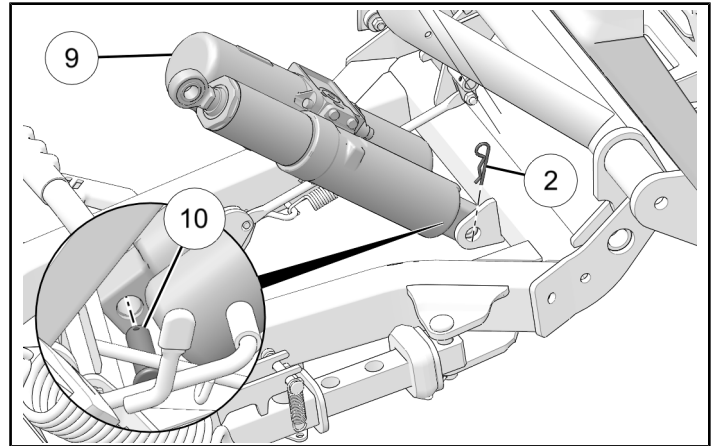

- Insert two bushings ⑪ into lift arm ①.

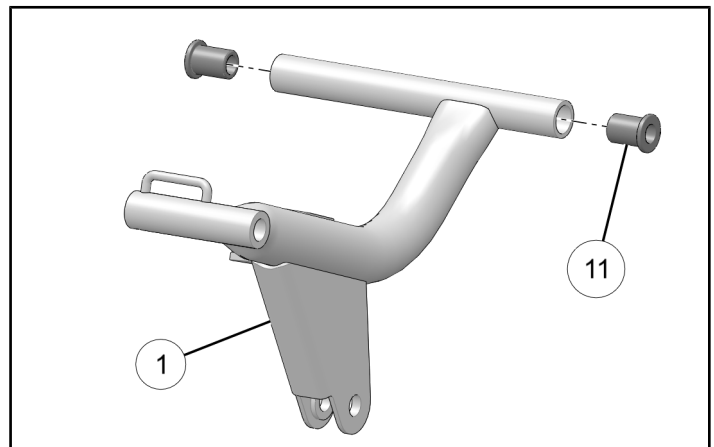

4. Install upper end of lift arm ① to pushframe brackets using bolt ⑫ and nut ⑦.

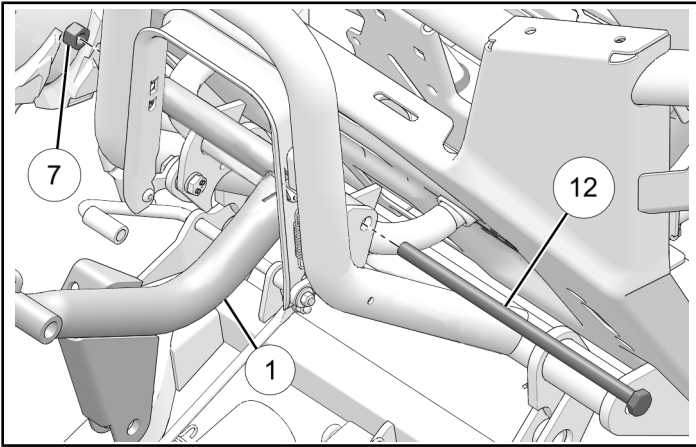

5. Tighten nut until play is removed, but not so tight as to prevent lift arm from pivoting freely on bolt.
6. Connect lower end of lift arm ① to front end of lift cylinder ⑨ using SHORT clevis pin ⑧ and hairpin clip ②.

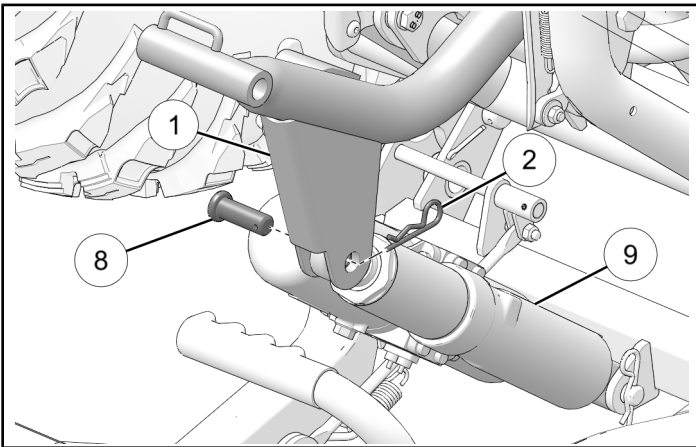

7. Insert strap ⑤ through guide ⑆ in lift arm, then install eye bolt to lift arm using nut ⑥.

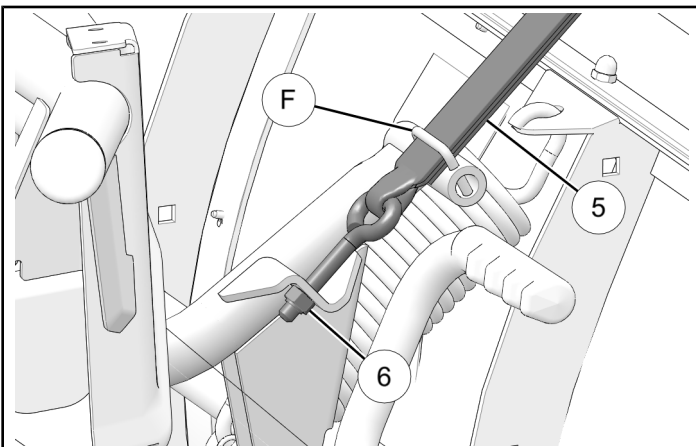

8. Insert strap link ③ through loop in end of strap ⑤, then install link to pushframe using clevis pin ④ and hairpin clip ②.

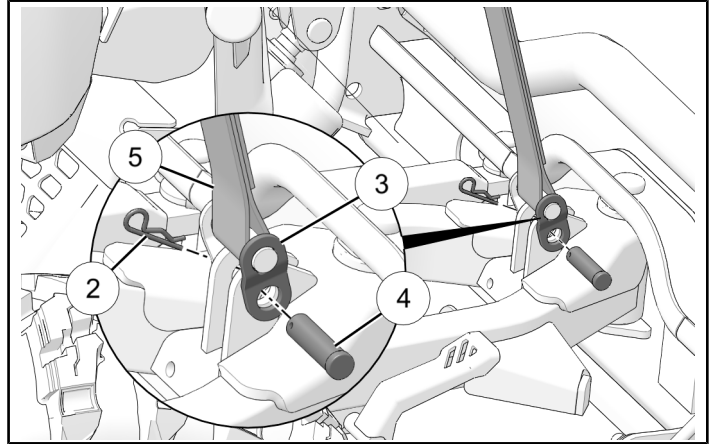

9. Attach connector from lift cylinder ⑨ to mating **LIFT** connector from Plow Controller Kit (sold separately).

### IMPORTANT

Make sure harness routing will prevent binding and contact with sharp edges or moving parts, **THROUGHOUT THE FULL RANGE** of cylinder travel. See Plow Controller Kit instructions for connector details.

### ADJUST LIFT STRAP

1. Adjust lift strap length. Goal is to adjust strap length to provide BOTH of the following:
  - As **SHORT** as possible to provide maximum ground clearance when blade is lifted, but **WITHOUT** pushframe contacting mechanical stops at full cylinder extension.
  - As **LONG** as necessary to allow blade to drop into shallow valleys or depressions during plowing, as well as provide easy removal/ installation of clevis pin ④ when on level ground.
2. Turn ignition switch to ACC position.
3. Fully extend cylinder using UP button on controller. Make sure harness does not bind, or contact sharp edges or moving parts, during cylinder travel.

4. Lift blade up, then perform the following:

**IMPORTANT**

Weight of installed assembly at blade approximately 90 lbs (41 Kg).

**CAUTION**

It is recommended that two people lift the blade up. Plow blade is large and heavy and may be difficult for one person to easily handle. Failure to have two people lift blade could result in damage to vehicle and/or plow blade and possible personal injury.

- If blade CAN be lifted, then lower blade to ground, TIGHTEN nut ⑥ ONE full revolution, then return to Step 3.
- If blade CAN NOT be lifted, then lower blade to ground, LOOSEN nut ⑥ ONE full revolution, then return to Step 3.

**NOTICE**

Make sure blade is on GROUND, not kickstand, during adjustment.

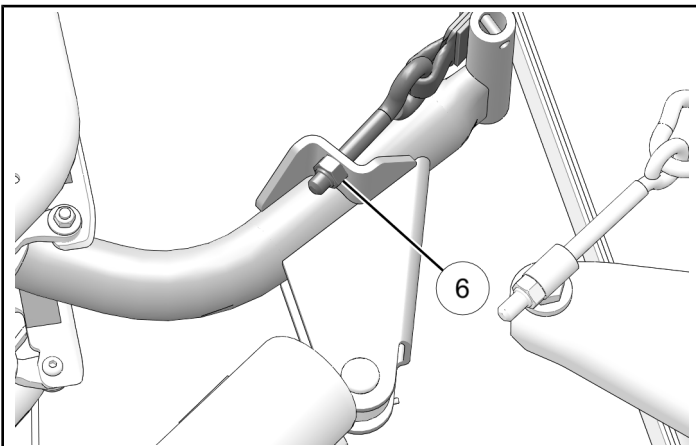

**INSTRUCTION FEEDBACK FORM**

A feedback form has been created for the installer to provide any comments, questions or concerns about the installation instructions. The form is viewable on mobile devices by scanning the QR code or by clicking [HERE](#) if viewing on a PC.



5. Repeat Steps 3-4 until full cylinder extension occurs JUST PRIOR to pushframe contacting mechanical stops.

6. Lower blade to ground.

7. Turn ignition switch to OFF position and remove key.

8. Make sure plow system can be removed and installed without binding. If binding occurs, LOOSEN nut ⑥ as required.

**IMPORTANT**

Lift strap may stretch slightly with use. Periodically adjust strap as required.

9. Attach harness using two cable ties ⑬.

**WARNING**

Damaged or worn lift strap must be replaced. Failure to comply may allow blade to drop unexpectedly to ground, causing vehicle to slow or stop suddenly, resulting in serious personal injury or death.

10. Inspect lift strap annually, or whenever damage may be suspected. Replace strap if damaged or worn.