

VENTED GLASS WINDSHIELD KIT



P/N 2884350; 2884823; 2889019

BEFORE YOU BEGIN

Read these instructions and check to be sure all parts and tools are accounted for. Please retain these installation instructions for future reference and parts ordering information.

APPLICATION

Verify accessory fitment at www.polaris.com.

KIT CONTENTS

NOTICE	
Vented Glass Windshield Kit, P/N 2884350 shown; others similar.	

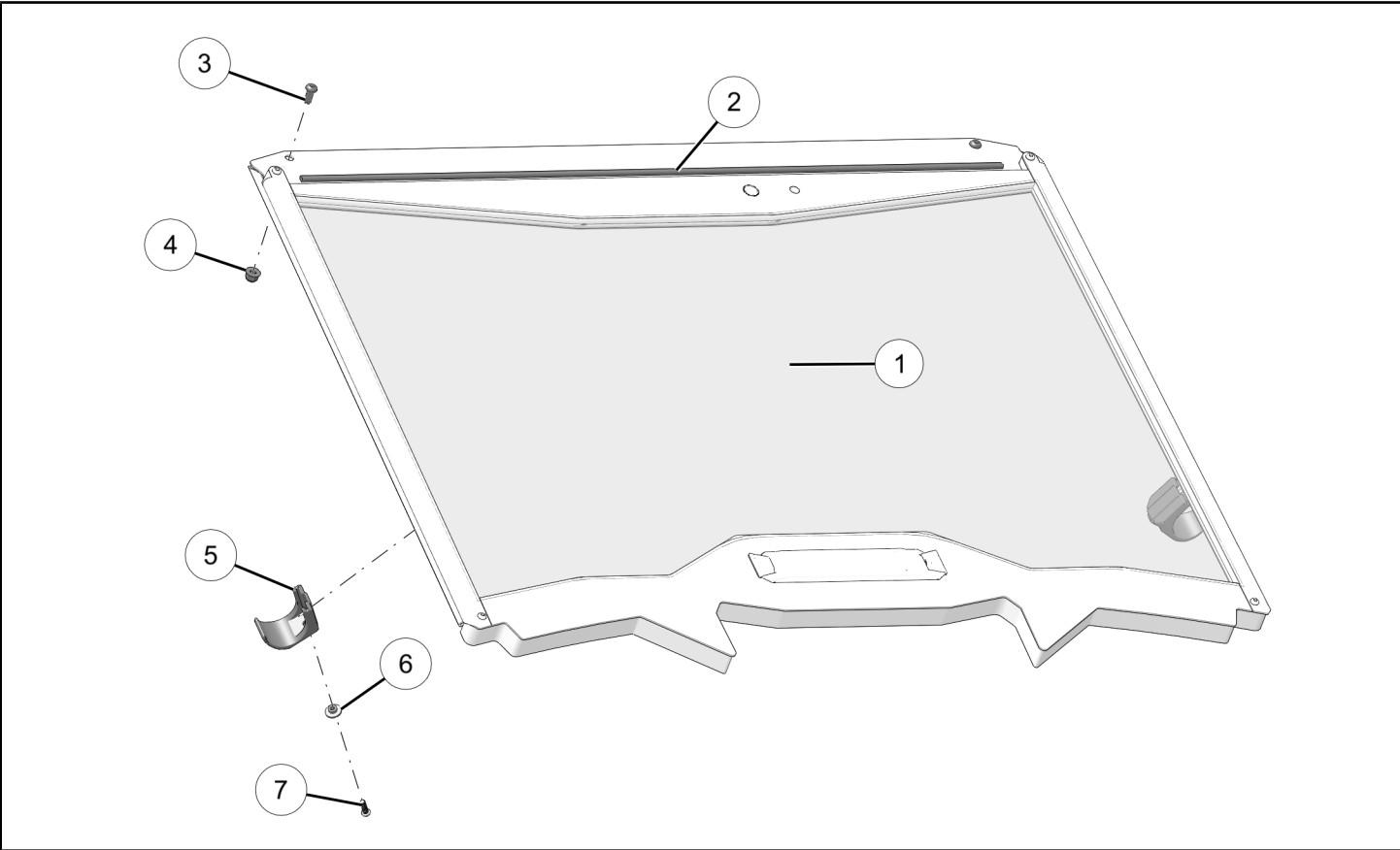

REF	QTY	PART DESCRIPTION	P/N AVAILABLE SEPARATELY	AVAILABLE SERVICE KIT
1	1	Assembly–Windshield, Glass	n/a	n/a
2	1	Seal–Roof	n/a	2208784
3	2	Screw–Cap Hex, M8 x 1.0 x 20 mm	n/a	2208784
4	2	Nut–Hex Flange, M8 x 1.0 mm	n/a	2208784
5	2	Clamp–Windshield	n/a	2208784

REF	QTY	PART DESCRIPTION	P/N AVAILABLE SEPARATELY	AVAILABLE SERVICE KIT
6	2	Sleeve–Flange	n/a	2208784
7	2	Screw–Cap Hex, M6 x 1.0 x 18 mm	n/a	2208784

TOOLS REQUIRED

- Safety Glasses
- Hex Key Set, Metric
- Socket Set, Hex Bit, Metric
- Torque Wrench
- Wrench Set, Metric

IMPORTANT

Your Vented Glass Windshield Kit is exclusively designed for your vehicle. Please read the installation instructions thoroughly before beginning. Installation is easier if the vehicle is clean and free of debris. For your safety, and to ensure a satisfactory installation, perform all installation steps correctly in the sequence shown.

INSTALLATION INSTRUCTIONS

⚠ WARNING

If transporting vehicle in non-enclosed trailer then vehicle must FACE FORWARD, or windshield must be removed.

Failure to comply may allow airflow, vibration, or other factors to separate windshield from vehicle and cause an accident, resulting in serious personal injury or death.

NOTICE

Vented Glass Windshield Kit, P/N 2884350 shown; others similar.

NOTICE

Two installers are recommended for this installation.

2. Turn key to OFF position and remove from vehicle.
3. Aluminum roof-equipped vehicles:
Remove and keep hardware from two front-most locations. Hardware will be used to install windshield instead of kit-supplied hardware.

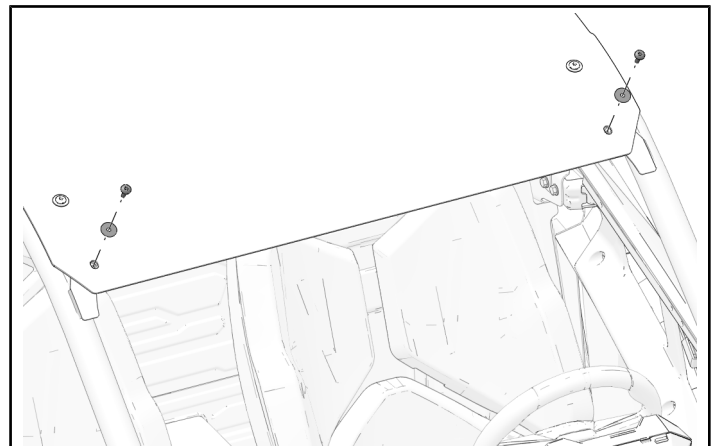

VEHICLE PREPARATION

GENERAL

1. Shift vehicle transmission into PARK.

HOOD REMOVAL

1. Remove and keep two hood fasteners. Move hood backwards to remove.

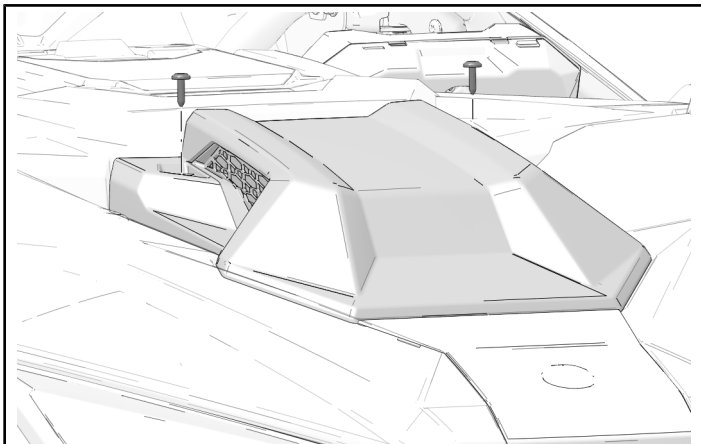

- Install top of windshield with two fasteners ③ and two nuts ④. Counter-hold nuts and torque fasteners to specification.

TORQUE

Windshield Fasteners ③:
16 ft-lbs (22 N·m)

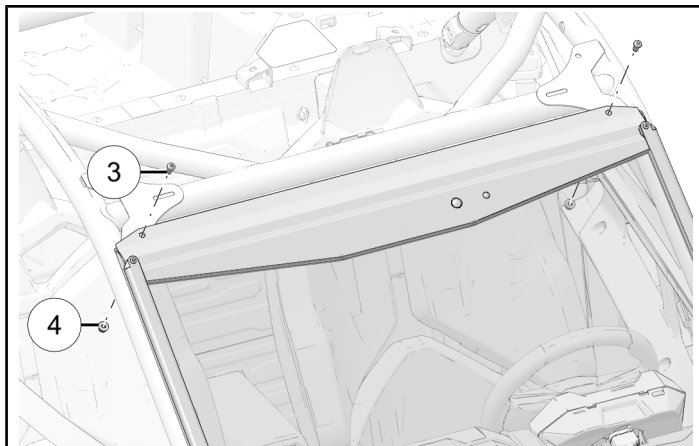

ACCESSORY INSTALLATION

1. Put windshield on top of vehicle and lean against roll-cage.

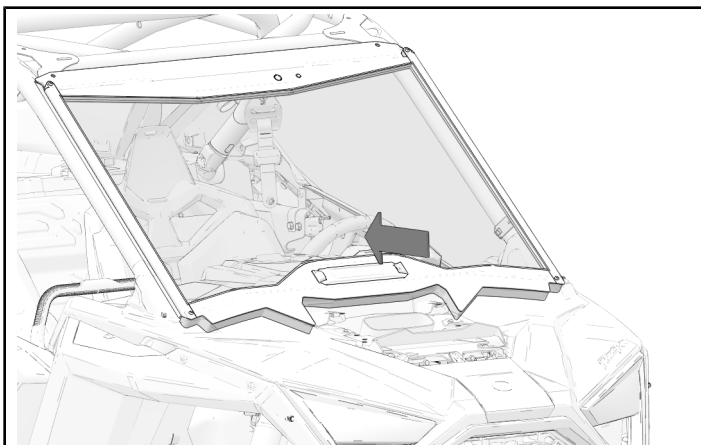

- Aluminum roof-equipped vehicles:
Install top of windshield with retained roof hardware. Torque fasteners to specification.

TORQUE

Aluminum Roof Fasteners:
11 ft-lbs (15 N·m)



2. Install top of windshield.

3. Install clamps ⑤ around roll-cage and install with one sleeve ⑥ and one fastener ⑦ per clamp. Torque fasteners to specification.

TORQUE

Clamp Fasteners ⑦:
8 ft-lbs (11 N·m)

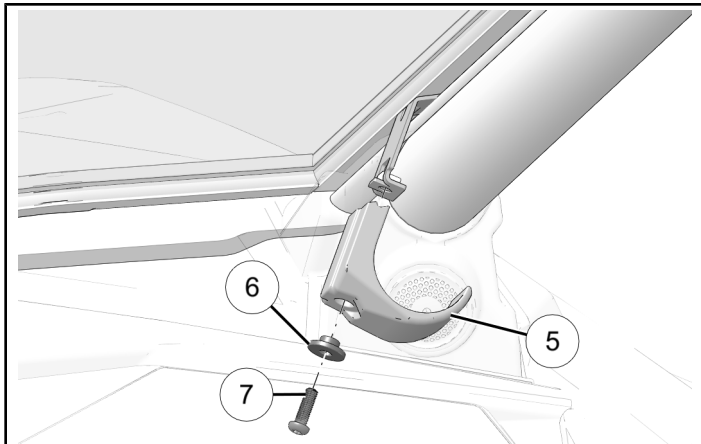

4. Aluminum roof-equipped vehicles:
Install seal ② on front edge of aluminum roof.

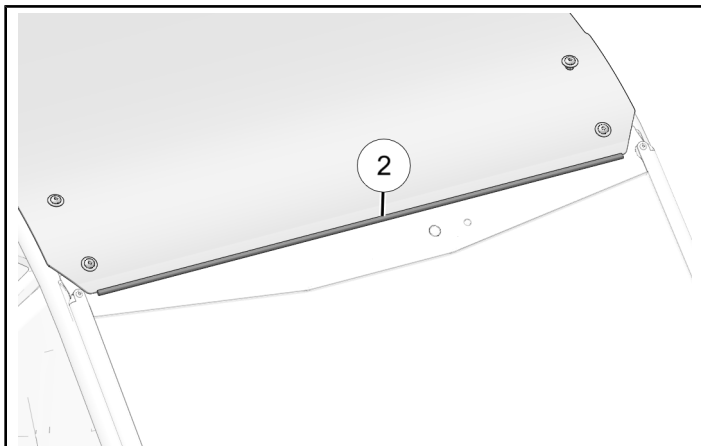

OPERATION

OPENING VENT

Push bottom of vent to open.

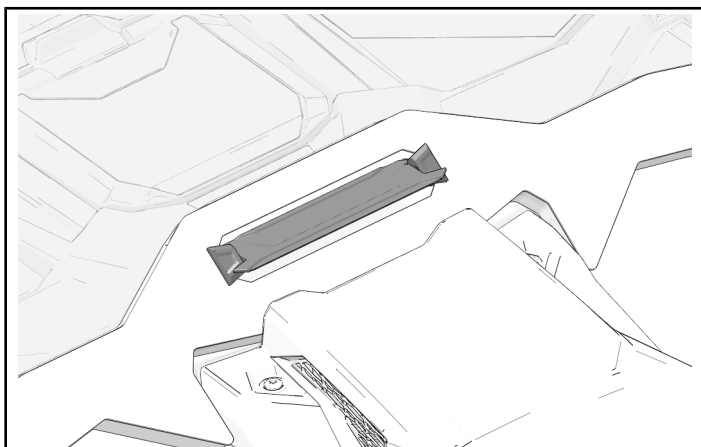

VEHICLE REASSEMBLY

HOOD INSTALLATION

1. Install hood with two retained hood fasteners.

TORQUE

Hood Fasteners:
88 in-lbs (10 N·m)

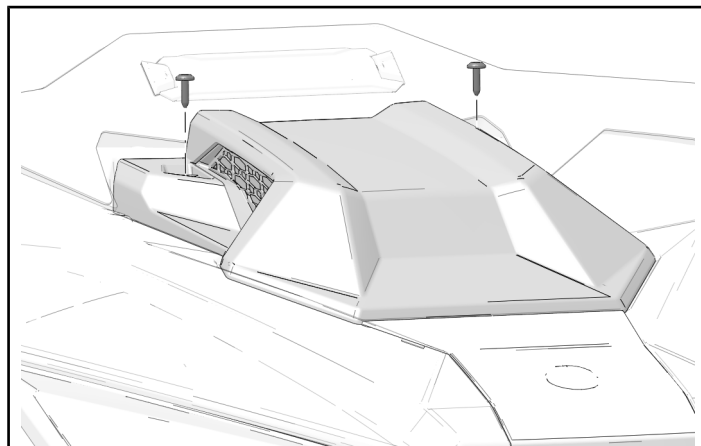

CLOSING VENT

Push top of vent to close.

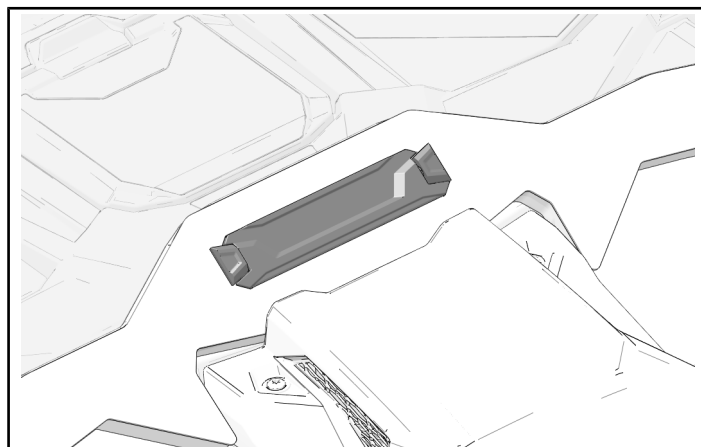

INSTRUCTION FEEDBACK FORM

A feedback form has been created for the installer to provide any comments, questions or concerns about the installation instructions. The form is viewable on mobile devices by scanning the QR code or by clicking [HERE](#) if viewing on a PC.

