

WINDSHIELD KIT



P/N 2884946; 2884845; 2884945; 2889491

BEFORE YOU BEGIN

Read these instructions and check to be sure all parts and tools are accounted for. Please retain these installation instructions for future reference and parts ordering information.

APPLICATION

Verify accessory fitment at www.polaris.com.

KIT CONTENTS

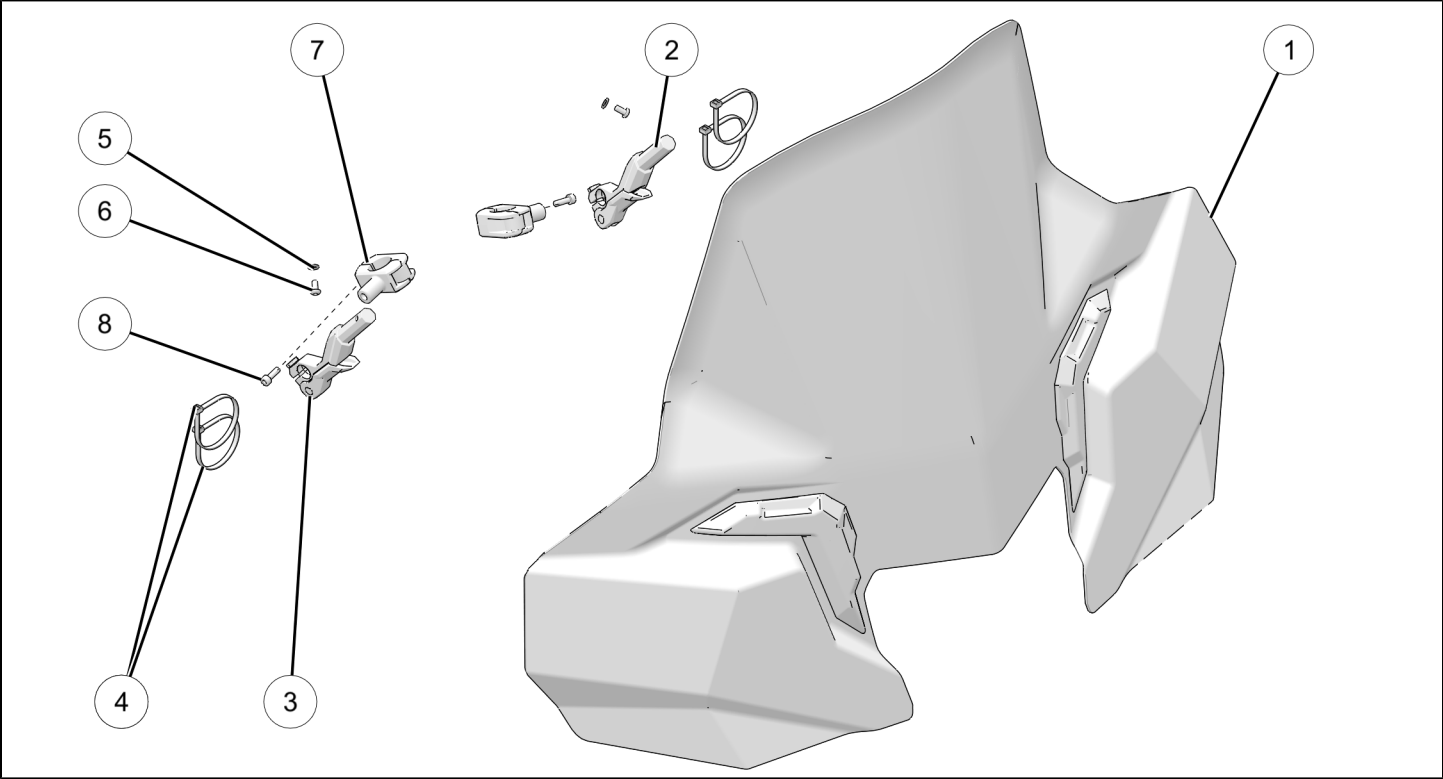

NOTICE

Kit 2884945 shown, other kits similar

REF	QTY	PART DESCRIPTION	P/N AVAILABLE SEPARATELY	AVAILABLE SERVICE KIT
1	1	Windshield	N/A	N/A
2	1	LH Windshield Mounting Arm	N/A	2889197
3	1	RH Windshield Mounting Arm	N/A	2889197
4	4	Cable Tie	7080492	2208774
5	2	Washer	N/A	2889197
6	2	Screw	N/A	2889197
7	2	Windshield Mount Clamp	N/A	2889197
8	2	Screw	N/A	2889197

TOOLS REQUIRED

- Safety Glasses
- Hex Key Set, Metric
- Pliers, Side Cutting
- Socket Set, Hex Bit, Metric
- Socket Set, Torx® Bit
- Torque Wrench

IMPORTANT

Your Windshield Kit is exclusively designed for your vehicle. Please read the installation instructions thoroughly before beginning. Installation is easier if the vehicle is clean and free of debris. For your safety, and to ensure a satisfactory installation, perform all installation steps correctly in the sequence shown.

INSTALLATION INSTRUCTIONS

VEHICLE PREPARATION

GENERAL

1. Park vehicle on a flat surface.
2. Push engine stop switch to the OFF position.
3. Turn key to the OFF position and remove key.
4. Loosen the master cylinder fasteners (A).

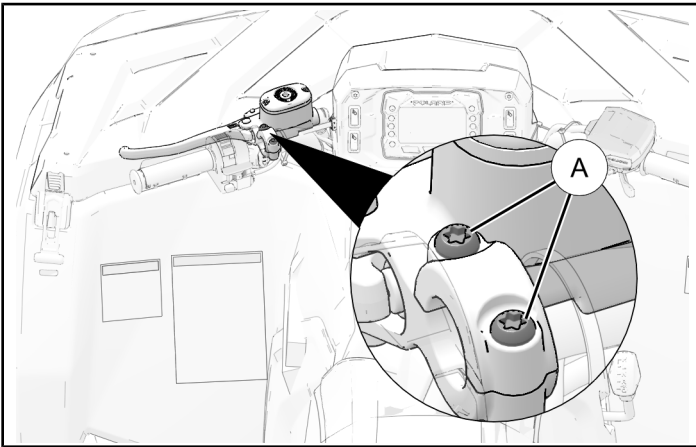

5. Remove the cable ties (B).

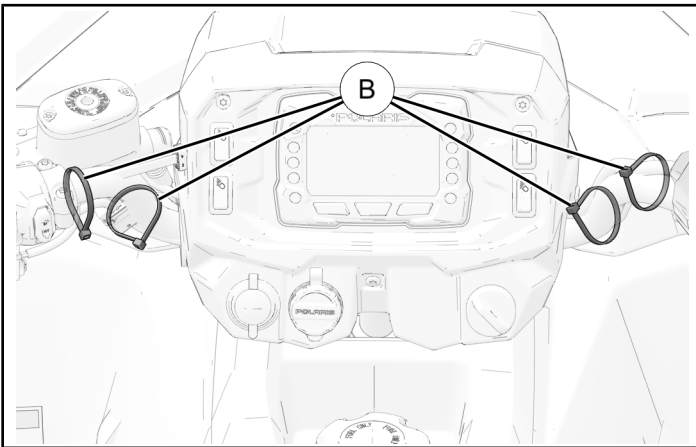

ACCESSORY INSTALLATION

1. Install the left (2) and right (3) windshield mounting arms by sliding them in to the mating part on the windshield (1).

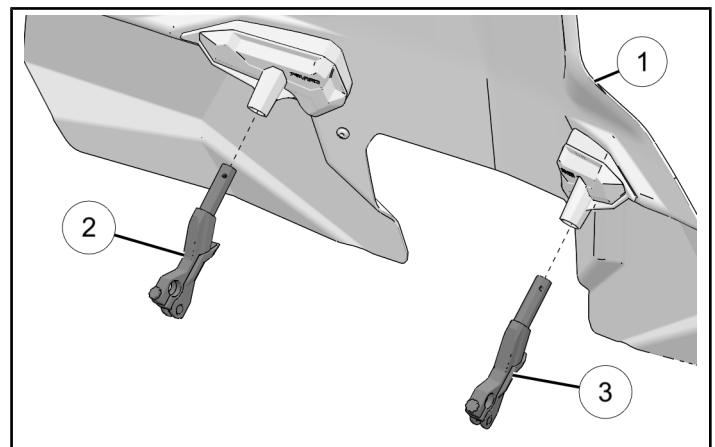

2. Next install the washer (5) and the fastener (6) to secure the mounting arm. Repeat this step on the other mounting arm.

Do NOT tighten fasteners at this time.

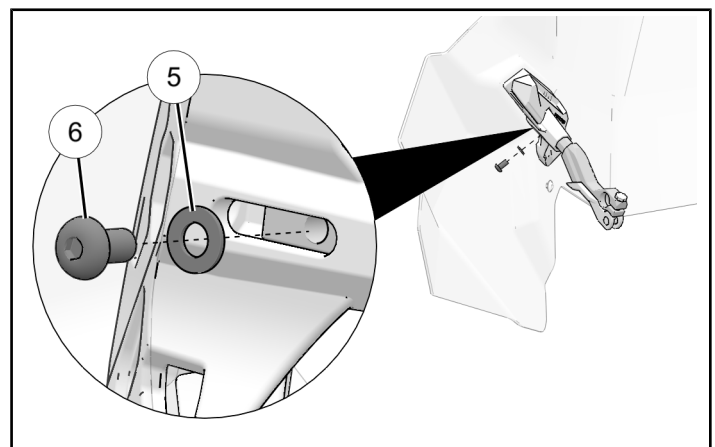

3. Install the windshield mounting clamps ⑦ to the handlebar and install the fasteners ⑧.

Do NOT tighten fasteners at this time.

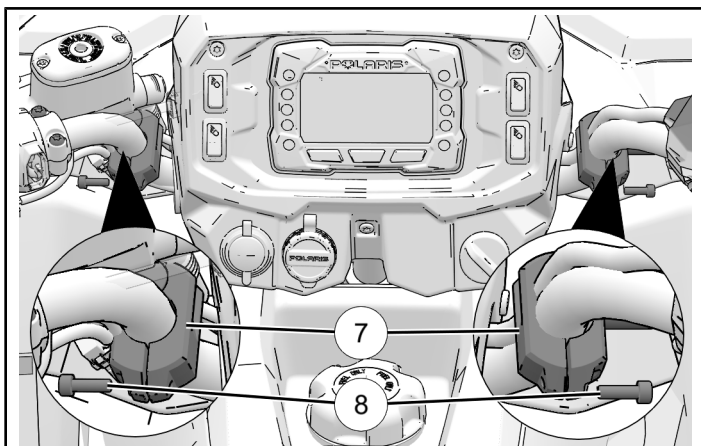

4. Install the windshield assembly onto the mounting clamps and take time to position the mounting clamps and adjust the windshield to the headlight pod. Tighten both windshield mount adjuster screws and torque the mounting arm fasteners ⑥ and mounting clamp fasteners ⑧ to specification once the windshield is in place.

TORQUE

Windshield Mount Fasteners:
16 in-lbs (1.8 N·m)

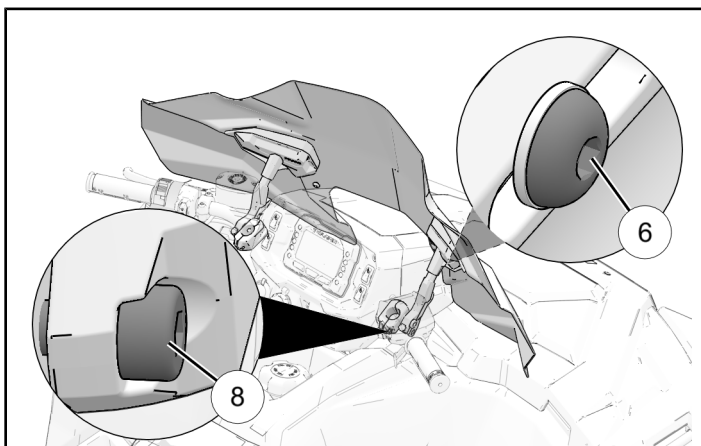

5. Install the cable ties ④ to secure the electrical harness routings.

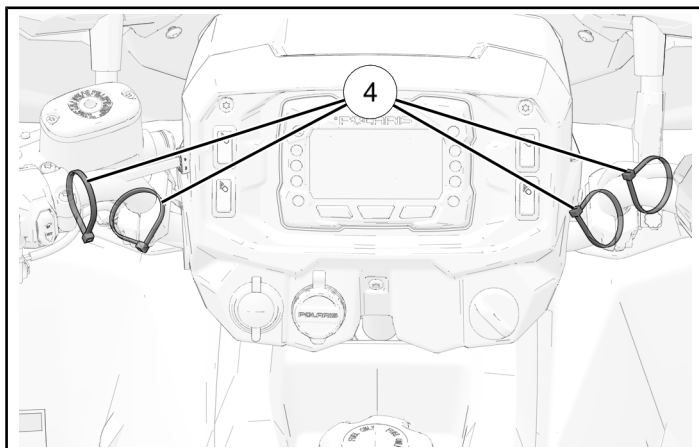

WINDSHIELD ADJUSTMENT

1. To adjust the mounting clamp, turn the adjuster screw on the top of the mount. Adjust as needed and tighten the adjuster screw to secure in place.

NOTICE

Right side shown.

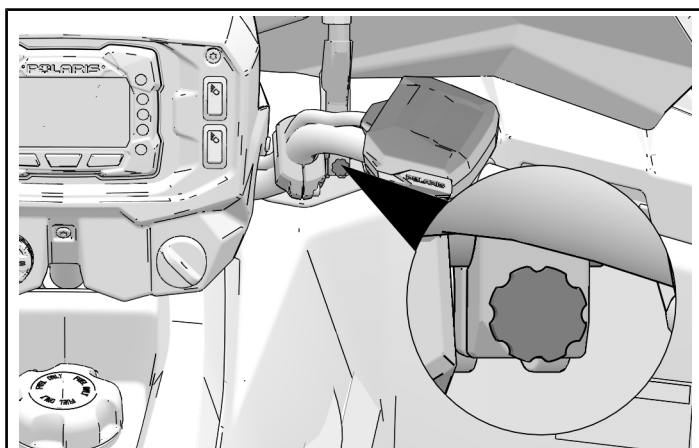

2. To optimize windshield fit, remove the mount covers and loosen fasteners on the inside of the windshield. Adjust as needed and torque fasteners to specification. Reinstall the mount covers.

NOTICE

Right side shown.

TORQUE

Windshield Mount Fasteners:
16 in-lbs (1.8 N·m)

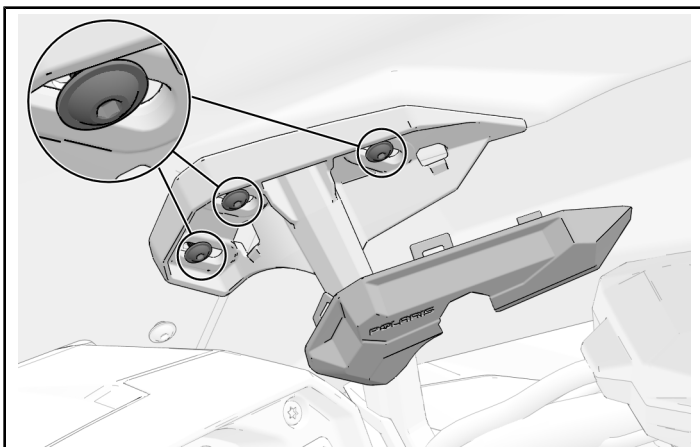

VEHICLE REASSEMBLY

GENERAL

1. Reposition the master cylinder and torque mounting fasteners **A** to specification.

TORQUE

Master Cylinder Mounting Fasteners:
84 in-lbs (9 N·m)

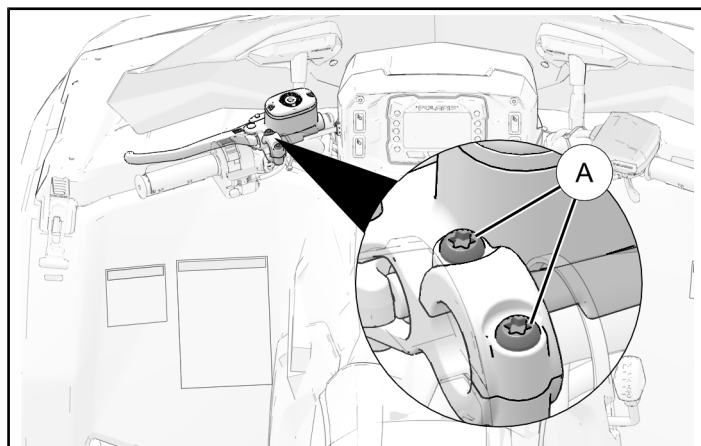

CARE AND CLEANING

Clean the windshield by rinsing with warm water. Dry with a soft clean cloth.

NOTICE

Brake fluid and alcohol will permanently damage the windshield. Do not use glass cleaners, water or soil repellents, and petroleum or alcohol based cleaners on the windshield, as these products can damage the windshield.

INSTRUCTION FEEDBACK FORM

A feedback form has been created for the installer to provide any comments, questions or concerns about the installation instructions. The form is viewable on mobile devices by scanning the QR code or by clicking [HERE](#) if viewing on a PC.

