

ROOF LINER KIT



P/N 2885093

BEFORE YOU BEGIN

Read these instructions and check to be sure all parts and tools are accounted for. Please retain these installation instructions for future reference and parts ordering information.

APPLICATION

Verify accessory fitment at www.polaris.com.

REQUIRED SOLD SEPARATELY

Only parts for installation of the Roof Liner Kit are included. Prior installation of the following additional kits are also required (sold separately):

- *Poly Roof Kit*, P/N 2885077

KIT CONTENTS

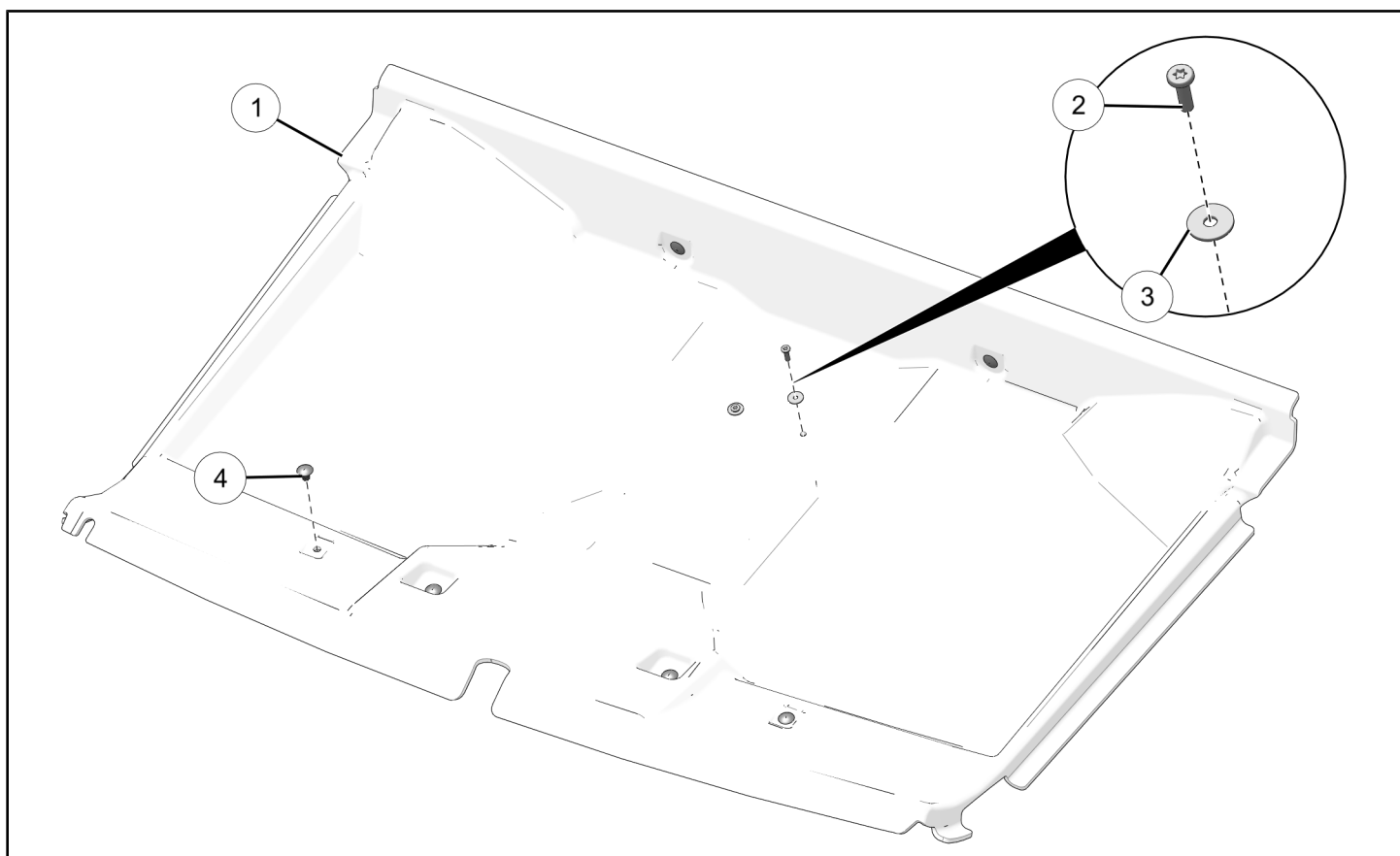

REF	QTY	PART DESCRIPTION	P/N AVAILABLE SEPARATELY
1	1	Liner–Roof	5815064
2	2	Screw–Torx® Pan Head, Hi/Lo, #10 x 5/8 in	7518238
3	2	Washer–0.20 x 0.67 x 0.048 in	7556034
4	6	Dart–Push, Plastic, Nylon	7670088

TOOLS REQUIRED

- Safety Glasses
- Hammer, Soft Face
- Socket Set, Torx® Bit
- Torque Wrench

IMPORTANT

Your Roof Liner Kit is exclusively designed for your vehicle. Please read the installation instructions thoroughly before beginning. Installation is easier if the vehicle is clean and free of debris. For your safety, and to ensure a satisfactory installation, perform all installation steps correctly in the sequence shown.

INSTALLATION INSTRUCTIONS

VEHICLE PREPARATION

GENERAL

1. Park vehicle on a flat surface.
2. Shift vehicle into PARK.
3. Turn key to OFF position and remove key.

ACCESSORY INSTALLATION

1. Put roof liner ① in vehicle and align with roof.

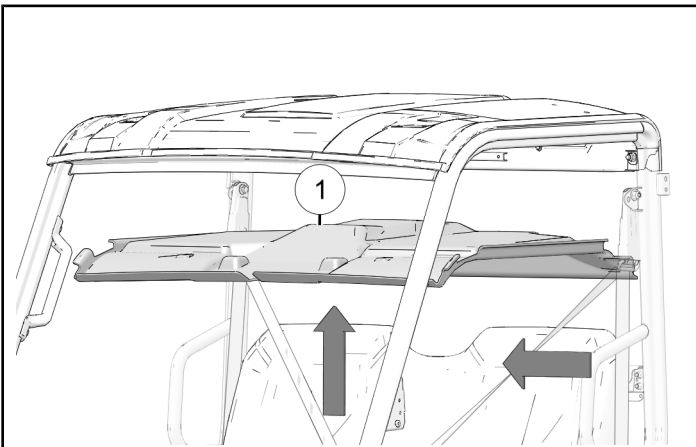

2. Put tabs of roof liner between roof and roll cage.

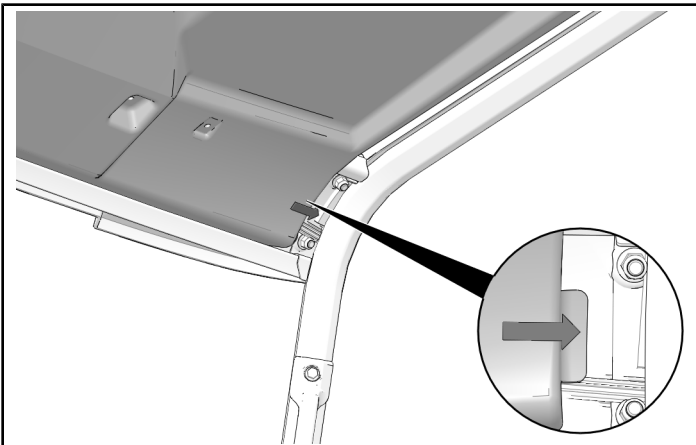

3. Make sure both sides of roof liner are placed between roof and roll cage.

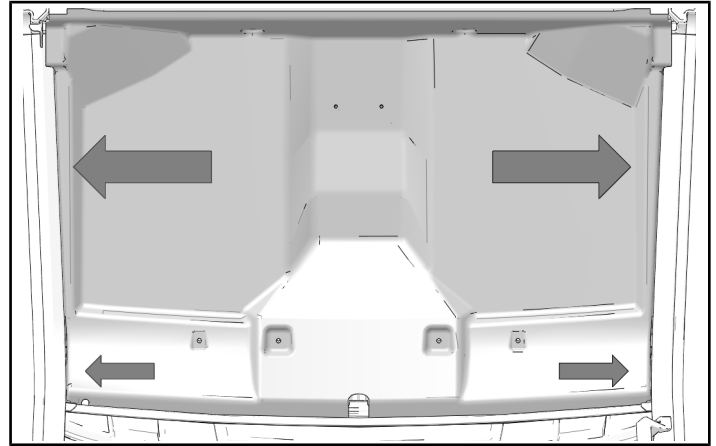

4. Install front of roof liner to windshield mounting plate with four push-darts ④.

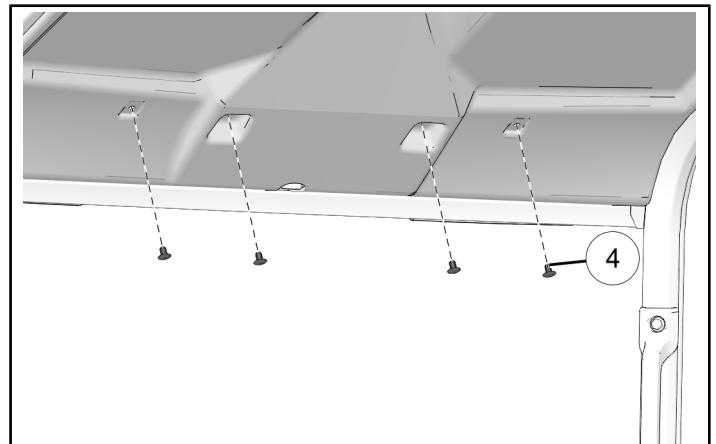

5. Install rear of roof liner to roll cage with two push-darts ④.

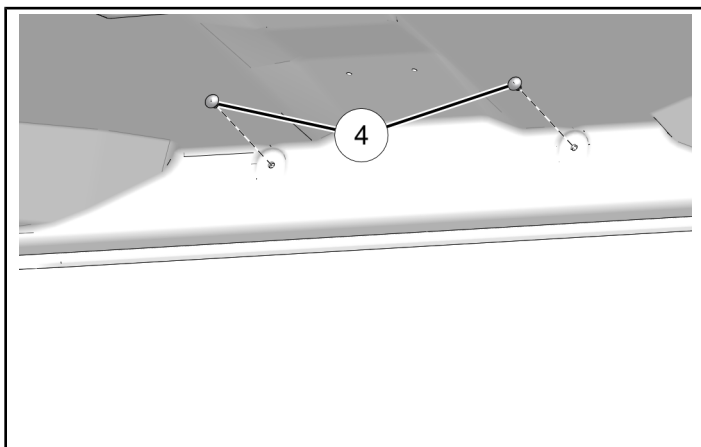

6. Install middle of roof liner to roof with two screws ② and two washers ③. Torque screws to specification.

TORQUE

Roof Liner Screws ②:
42 in-lbs (4.7 N·m)

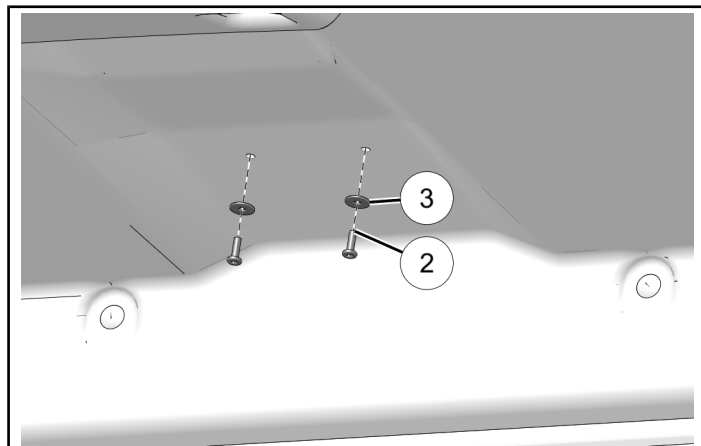

INSTRUCTION FEEDBACK FORM

A feedback form has been created for the installer to provide any comments, questions or concerns about the installation instructions. The form is viewable on mobile devices by scanning the QR code or by clicking [HERE](#) if viewing on a PC.

