

REAR BUMPER KIT



P/N 2885087

BEFORE YOU BEGIN

Read these instructions and check to be sure all parts and tools are accounted for. Please retain these installation instructions for future reference and parts ordering information.

APPLICATION

Verify accessory fitment at www.polaris.com.

KIT CONTENTS

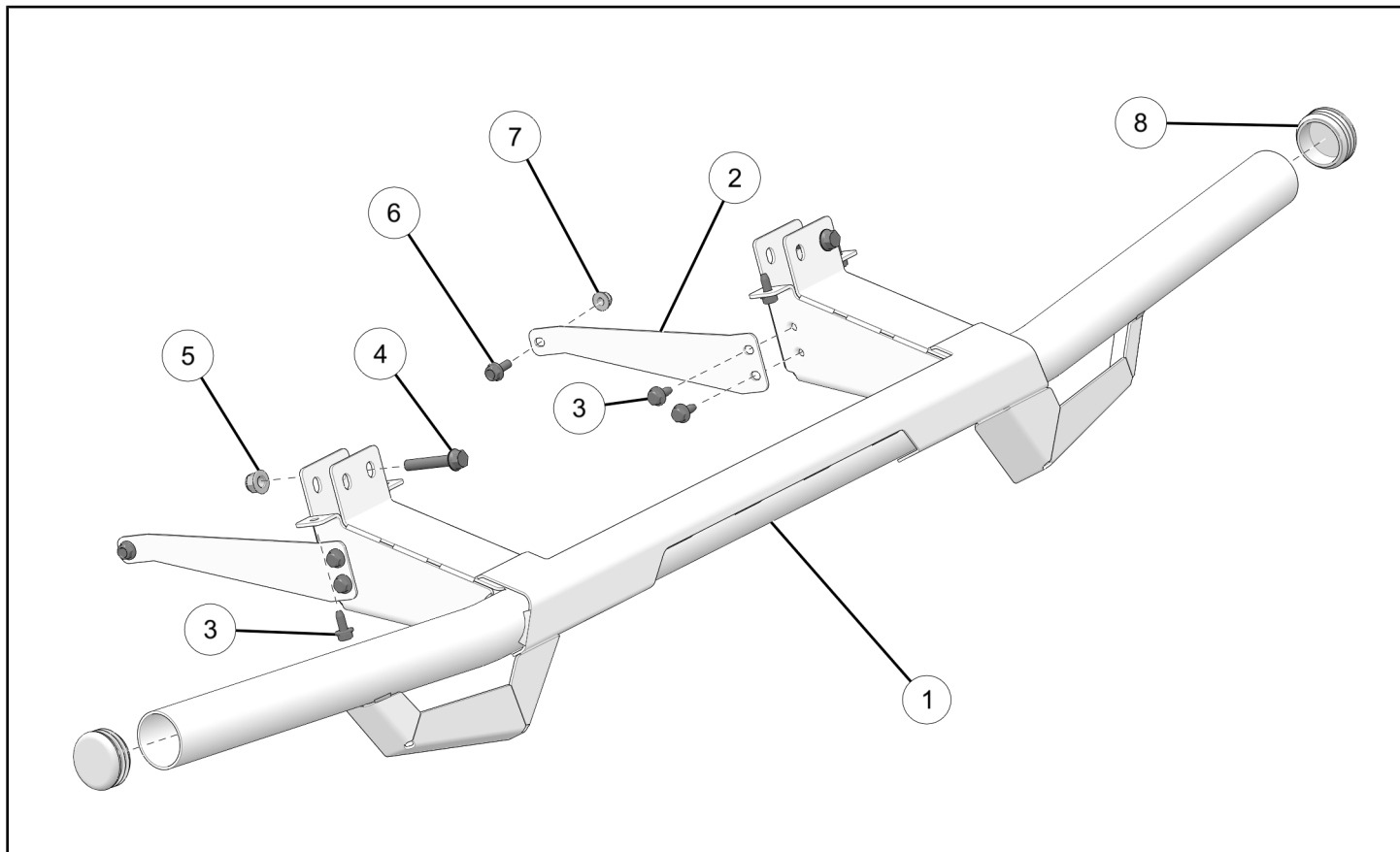

REF	QTY	PART DESCRIPTION	P/N AVAILABLE SEPARATELY
1	1	Weld – Bumper, Main, Rear	1026250
2	2	Bracket – Exterior Bumper, Rear	5272035
3	8	Screw – Hex Flange, M6 x 1.0 x 15 mm	7518513
4	4	Screw – Hex Flange, M8 x 1.25 x 45 mm	7516732
5	4	Nut, M8 x 1.25 mm	7547332
6	2	Screw – Hex Flange, M6 x 1.0 x 16 mm	7518591
7	2	Nut, M6 x 1.0 mm	7547339
8	2	Cap – Bumper	5434191

TOOLS REQUIRED

- Safety Glasses
- Socket Set, Metric
- Torque Wrench
- Wrench Set, Metric

IMPORTANT

Your Rear Bumper Kit is exclusively designed for your vehicle. Please read the installation instructions thoroughly before beginning. Installation is easier if the vehicle is clean and free of debris. For your safety, and to ensure a satisfactory installation, perform all installation steps correctly in the sequence shown.

INSTALLATION INSTRUCTIONS

VEHICLE PREPARATION

GENERAL

1. Park vehicle on a flat surface.
2. Shift vehicle into PARK.
3. Turn key to OFF position and remove key.

CARGO BOX ACCESS

1. Lift handle and fold tailgate down.

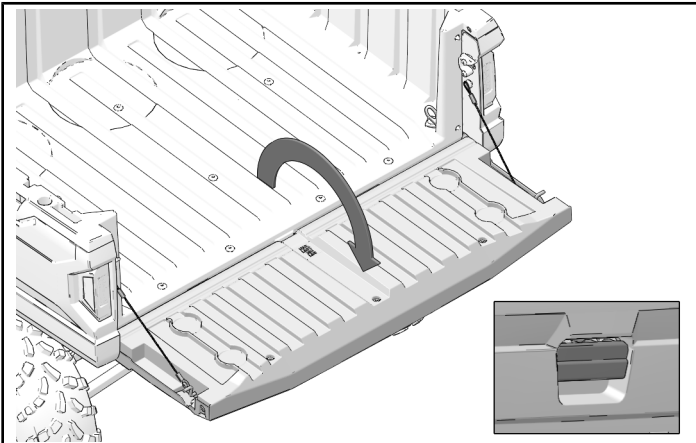

TAILGATE REMOVAL

1. Remove the cables from each side of the cargo box by lifting them off of each screw.

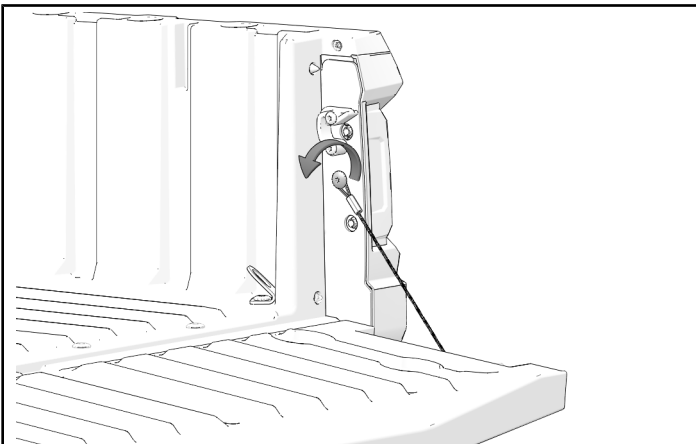

2. Tilt the tailgate downward.

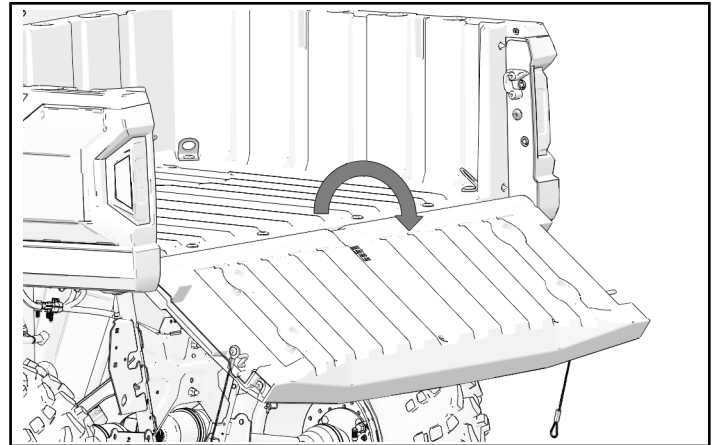

3. Pull left side of tailgate down, then move tailgate off of right side pivot on cargo box.

NOTICE

Left side pivot is slotted to allow tailgate to lift out.

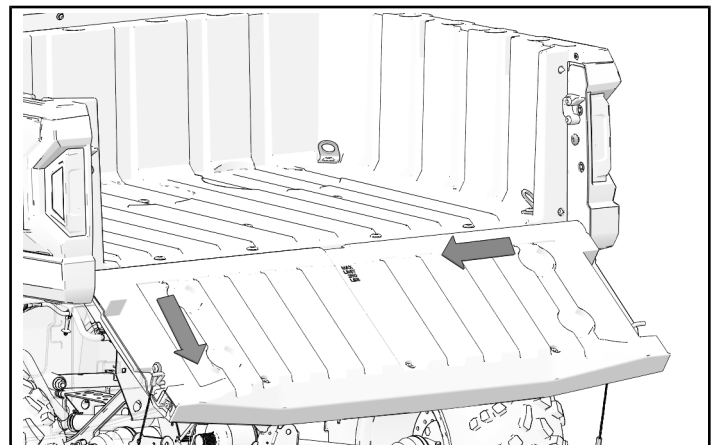

4. Set tailgate aside.

ACCESSORY INSTALLATION

BUMPER BRACKET INSTALLATION

1. Loosely install two bumper brackets ② to rear bumper ① with four screws ③.

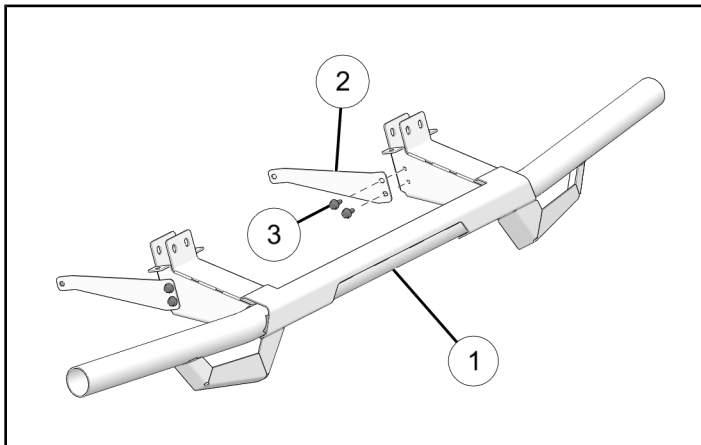

BUMPER INSTALLATION

IMPORTANT

Make sure tail light electrical harness does not become pinched during rear bumper installation.

NOTICE

The design of some bumpers may vary and will not use all of the hardware provided. Some bumpers will only use the right side hardware in the vertical and horizontal positions as shown in the images below. If possible, use extra hardware for left side holes on bumper.

1. Move rear bumper ① up onto chassis bar ④. Align right side holes on bumper with right side holes on chassis bar.

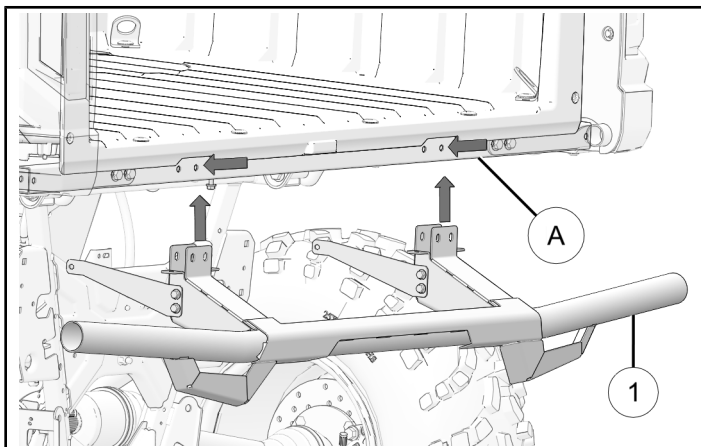

2. Loosely install rear bumper ① to chassis bar with screws ④ and nuts ⑤.

Do not torque hardware at this time.

IMPORTANT

To prevent damage to tail light electrical harness, make sure electrical harness is moved out of the way during hardware installation.

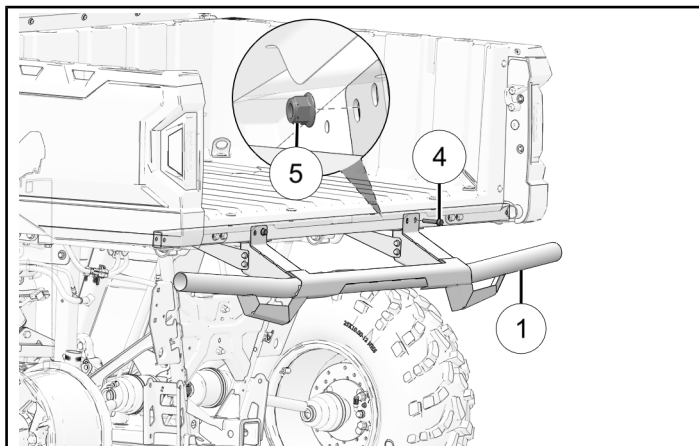

3. Loosely install bumper bracket ② to chassis with two screws ⑥ and two nuts ⑦.

Do not torque hardware at this time.

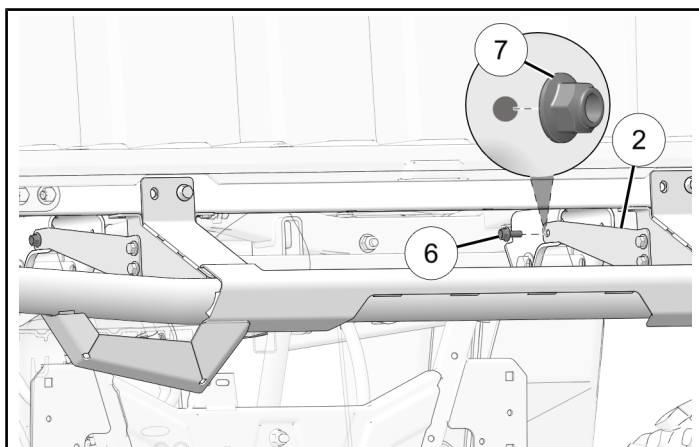

4. Loosely install screws ③ through underside of rear bumper ① and into right side holes on chassis bar ④.

Do not torque hardware at this time.

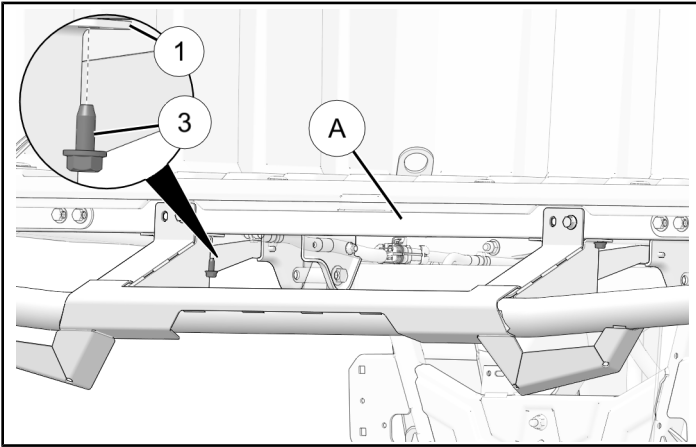

5. Install bumper caps ⑧ into each end of rear bumper.

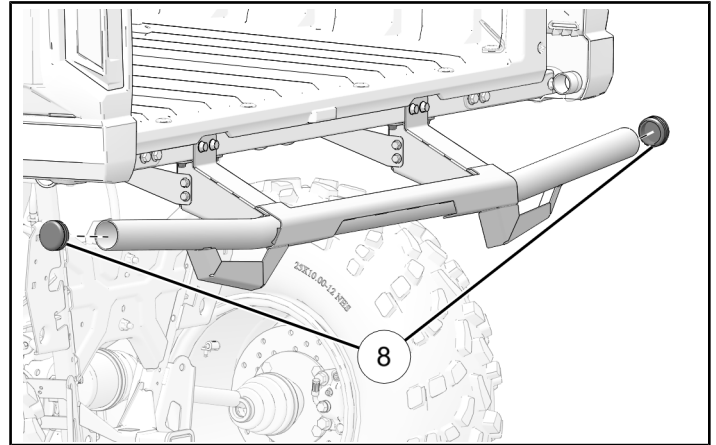

NOTICE

If bumper brackets have wider slots and align with additional chassis holes, install the remaining hardware vertically and horizontally into the bumper and vehicle.

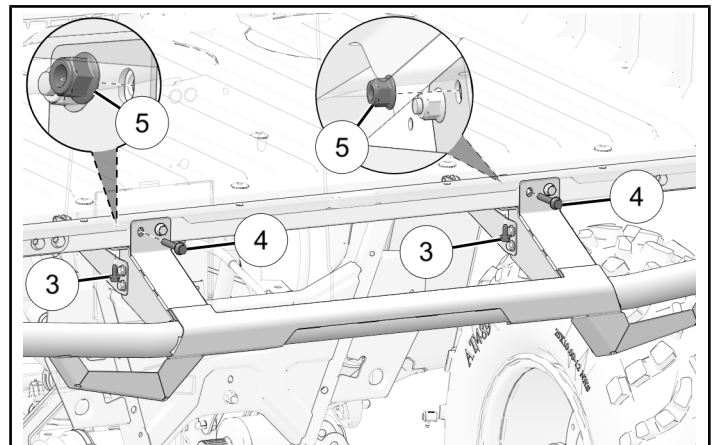

TORQUE REAR BUMPER SCREWS

IMPORTANT

Adjust rear bumper alignment as each screw is torqued, so rear bumper assembly sits correctly on vehicle.

1. Torque screws ③ to specification.

TORQUE

Bumper Chassis Screws ③:
9 ft-lbs (12 N·m)

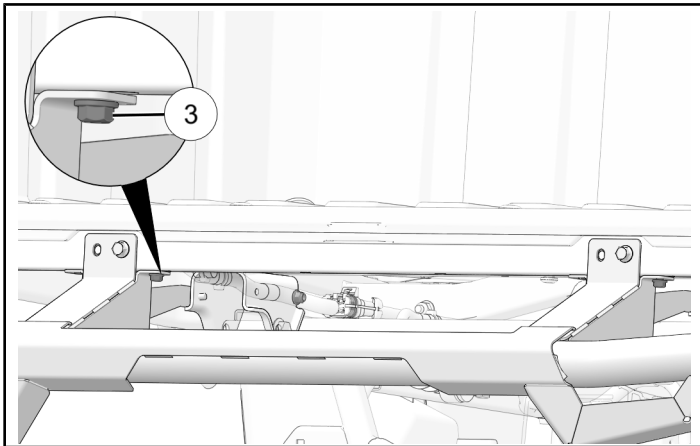

2. Counter hold nuts ⑤ and torque screws ④ to specification.

TORQUE

Rear Bumper Screws ④:
16 ft-lbs (22 N·m)

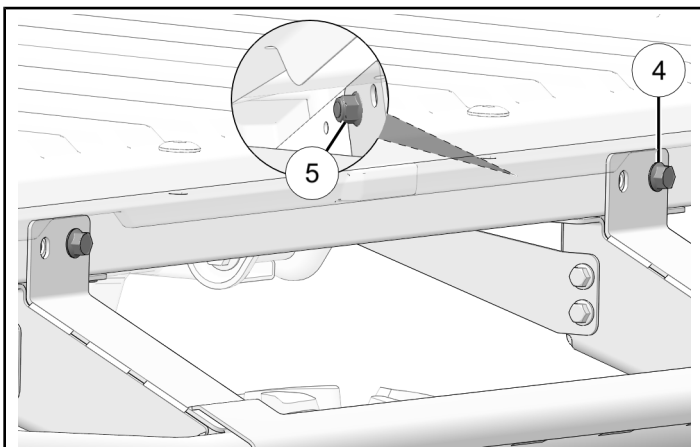

3. Torque four screws ③ to specification.

TORQUE

Bumper Bracket Screws ③:
9 ft-lbs (12 N·m)

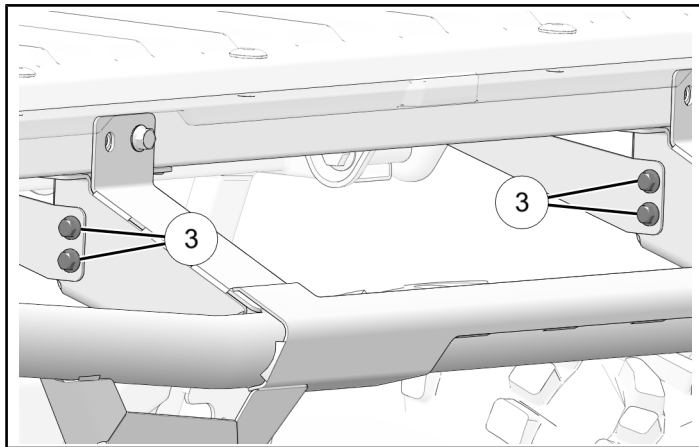

4. Counter hold nuts ⑦ and torque screws ⑥ to specification.

TORQUE

Bumper Bracket Chassis Screws ⑥:
9 ft-lbs (12 N·m)

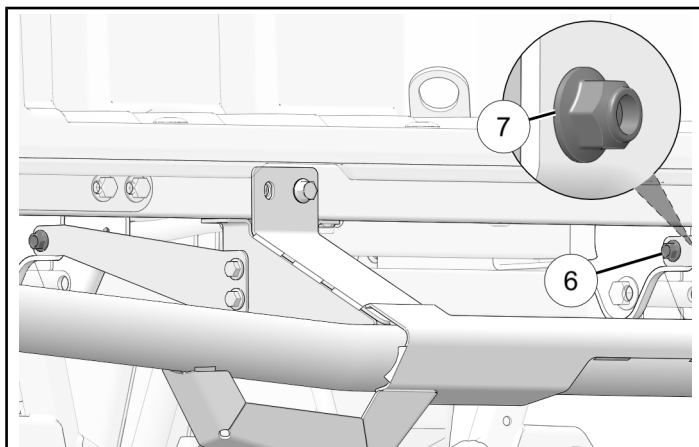

VEHICLE REASSEMBLY

TAILGATE INSTALLATION

1. Install tailgate into slotted pivot on cargo box and move to the right.

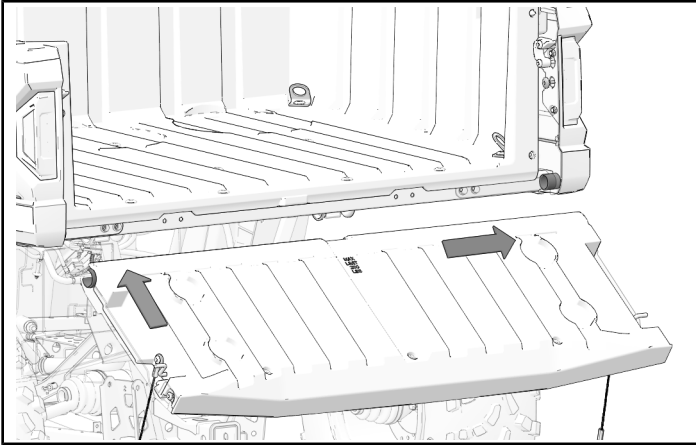

2. Attach cables to screws on cargo box.

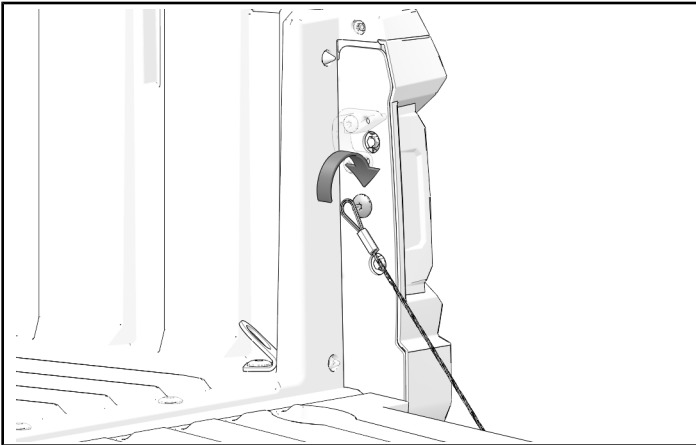

3. Close tailgate.

INSTRUCTION FEEDBACK FORM

A feedback form has been created for the installer to provide any comments, questions or concerns about the installation instructions. The form is viewable on mobile devices by scanning the QR code or by clicking [HERE](#) if viewing on a PC.

