

# WINDSHIELD WIPER KIT



P/N 2885083

## BEFORE YOU BEGIN

Read these instructions and check to be sure all parts and tools are accounted for. Please retain these installation instructions for future reference and parts ordering information.

## APPLICATION

Verify accessory fitment at [www.polaris.com](http://www.polaris.com).

## REQUIRED SOLD SEPARATELY

Only parts for installation of the Windshield Wiper Kit are included. Prior installation of the following additional kits are also required (sold separately):

- *Windshield*, P/N 2885079; P/N 2885080 unless factory installed
- *Polaris Pulse® Bar Kit*, P/N 2889568; P/N 2889185 unless factory installed

## KIT CONTENTS

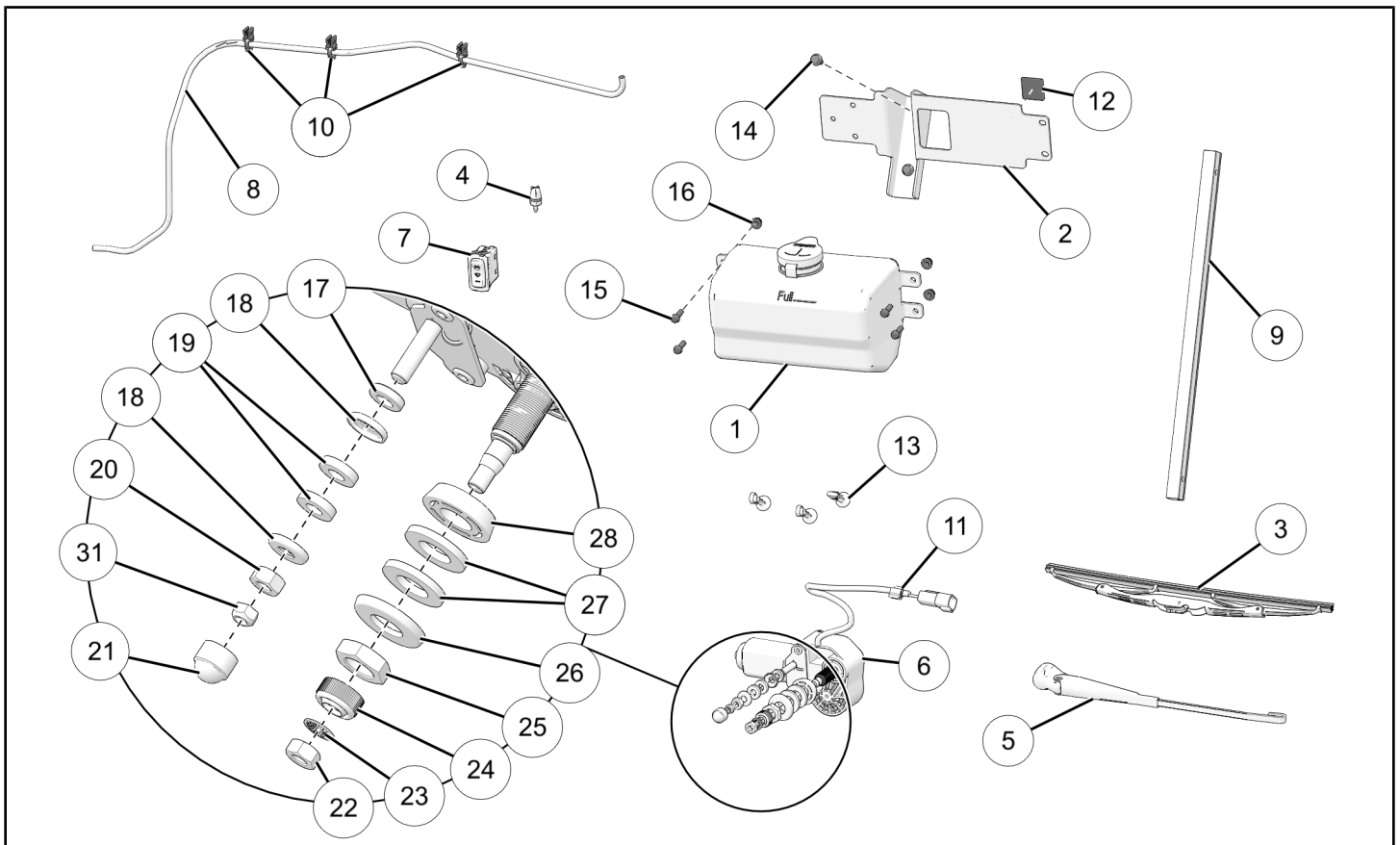

REF	QTY	PART DESCRIPTION	P/N AVAILABLE SEPARATELY	AVAILABLE SERVICE KIT
1	1	Washer Bottle Assembly	2205139	n/a
2	1	Bracket-Washer Bottle	5259475	n/a
3	1	Wiper Blade	2637635	n/a

REF	QTY	PART DESCRIPTION	P/N AVAILABLE SEPARATELY	AVAILABLE SERVICE KIT
4	1	Washer Nozzle	2637660	n/a
5	1	Wiper Arm	2638395	n/a
6	1	Wiper Motor assembly	2638395	n/a
7	1	Switch–Wiper, Washer	4080117	n/a
8	1	Hose–Washer Fluid	5417895	n/a
9	1	Clip–Routing Tube	7081469	n/a
10	3	Clip–Edge, Hose	7081808	n/a
11	1	Clip–Edge, Wiring	7082403	n/a
12	1	Clip Mount–Self Adhesive	7082523	n/a
13	3	Cable Tie– 25 mm	7082772	n/a
14	2	Screw–Hex, M6 x 1.0 x 20 mm	7518529	n/a
15	4	Screw–Hex Flange, M6 x 1.0 x 20 mm	7518576	n/a
16	4	Nut–Hex Flange, M6 x 1.0 mm	7547453	n/a
17	2	Pivot Bushing	n/a	2208226
18	2	Washer–Cupped	n/a	2208226
19	2	Washer–Plastic	n/a	2208226
20	1	Nut–Hex, M6 x 1.0 mm	n/a	2208226
21	1	Cap	n/a	2208226
22	1	Nut–Hex, M8 x 1.25 mm	n/a	2208225
23	1	Washer–Toothed	n/a	2208225
24	1	Cap	n/a	2208225
25	1	Nut–Hex, M14 x 1.75 mm	n/a	2208225
26	1	Washer–Plastic	n/a	2208225
27	2	Washer–Rubber	n/a	2208225
28	1	Spacer	n/a	2208225
29	1	Harness–Accessory, Wiper (see Harness Detail, page 3)	2415967	n/a
30	1	Harness–Accessory, Fuse (see Harness Detail, page 3)	2415968	n/a
31	1	Nut – Hex Head, M6	7547120	n/a

# HARNES DETAIL

## WINDSHIELD WIPER HARNESS (P/N 2415968)<sup>(30)</sup>

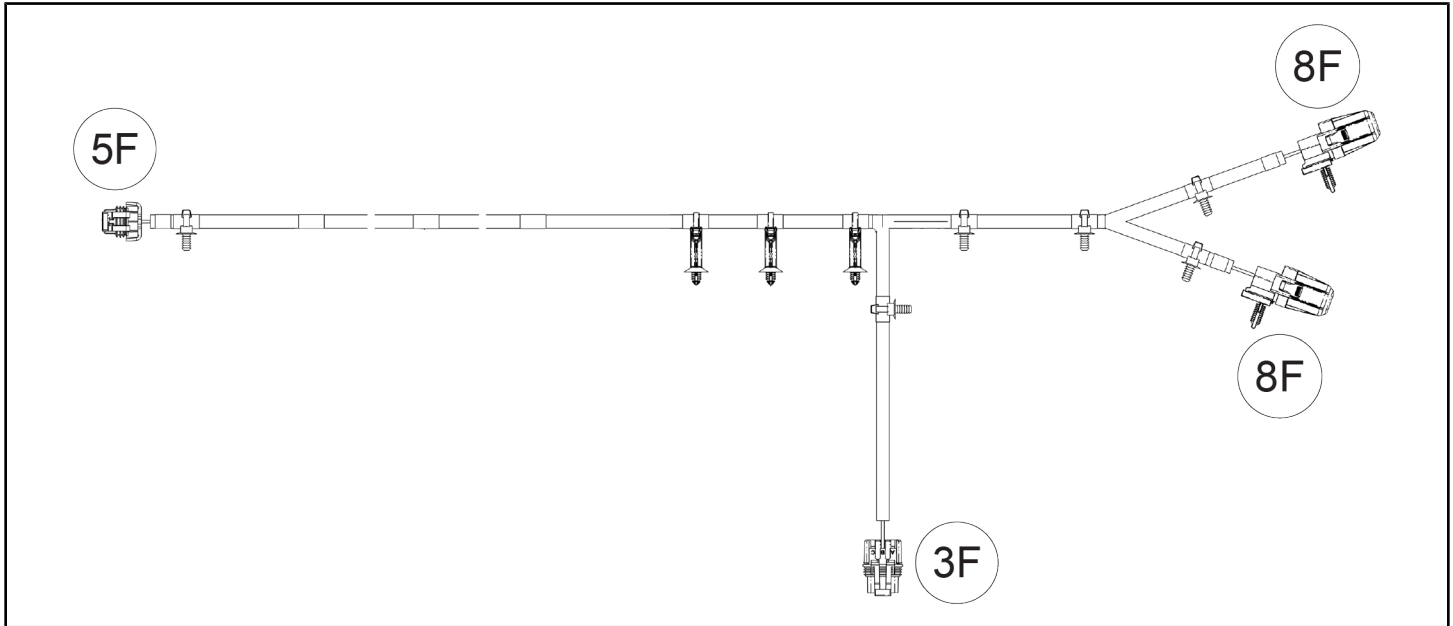

REF	PART DESCRIPTION	CONNECTS TO
5F	Wiper Harness Connector	Wiper Connector
3F	Pulse® Bar Connector	Pulse® Bar
8F	Fuse block 2	n/a
8F	Fuse Block 1	n/a

Example: 16F = 16 pin, Female / 16M = 16 pin, Male (Male terminal fits inside female terminal)

## WINDSHIELD WIPER HARNESS (P/N 2415967)<sup>(29)</sup>

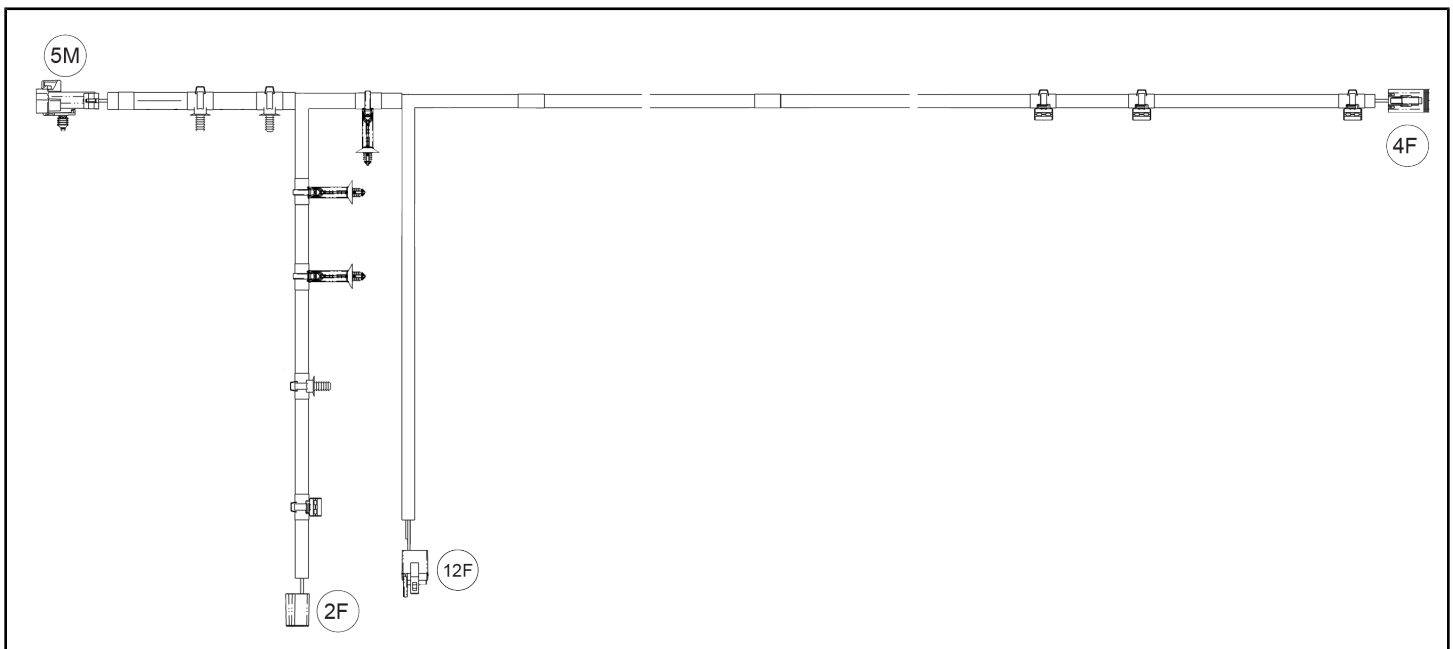

REF	PART DESCRIPTION	CONNECTS TO
5M	Fuse Harness Connector	Fuse harness
2F	Washer Pump Connector	Washer Pump
12F	Switch Wiper Connector	Wiper Switch/Backlight
4F	Wiper Connector	Wiper Power

Example: 16F = 16 pin, Female / 16M = 16 pin, Male (Male terminal fits inside female terminal)

## TOOLS REQUIRED

- Safety Glasses
- Cutting Tool
- Drill
- Drill Bit:
  - 5/16 in (8 mm)
- Push Dart (Panel Clip) Tool
- Ruler
- Socket Set, Metric
- Socket Set, Torx® Bit
- Torque Wrench

## CONSUMABLES REQUIRED

- Tape, Electrical
- Windshield Washer Fluid

## IMPORTANT

Your Windshield Wiper Kit is exclusively designed for your vehicle. Please read the installation instructions thoroughly before beginning. Installation is easier if the vehicle is clean and free of debris. For your safety, and to ensure a satisfactory installation, perform all installation steps correctly in the sequence shown.

## INSTALLATION INSTRUCTIONS

### VEHICLE PREPARATION

#### GENERAL

1. Park vehicle on a flat surface.
2. Shift vehicle into PARK.
3. Turn key to OFF position and remove key.

#### HOOD REMOVAL

1. Turn two quarter-turn fasteners to unlock position to remove hood from vehicle.

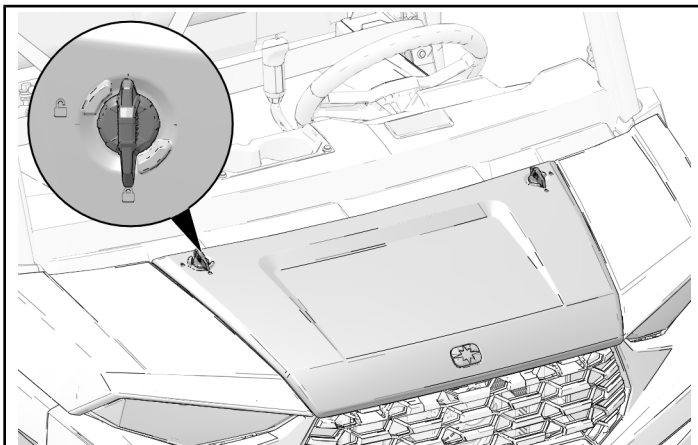

#### LEFT-HAND HOOD REMOVAL

1. Remove and keep one screw from outer hood.

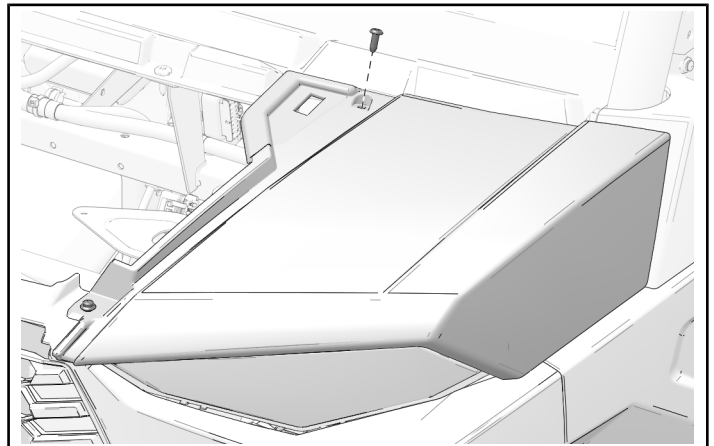

2. Remove and keep one push-pin rivet from outer hood.

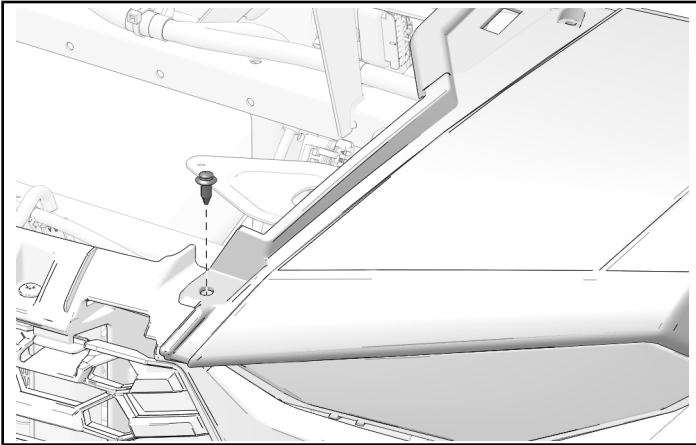

2. Remove and keep one push-pin rivet from outer hood.

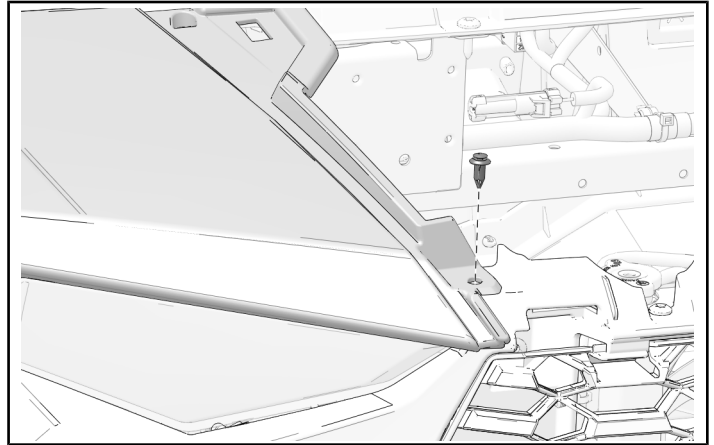

3. Pull outer hood away from vehicle.

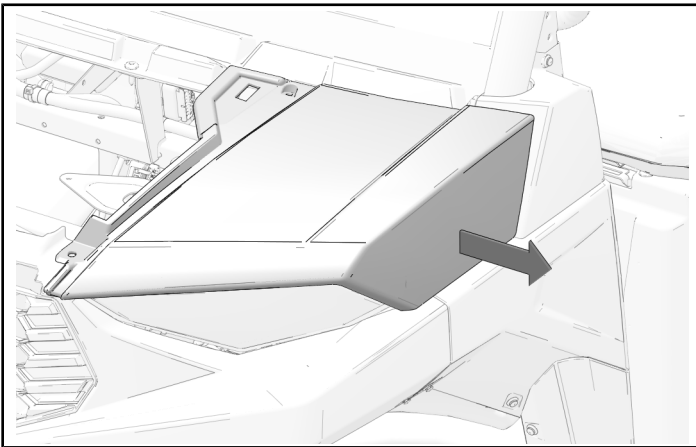

3. Pull outer hood away from vehicle.

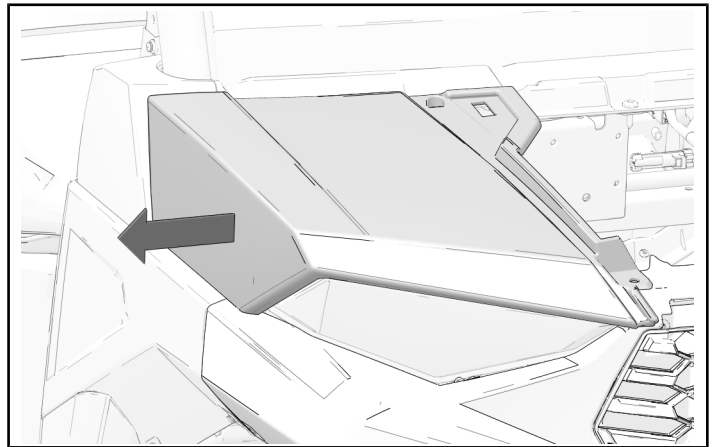

### **RIGHT-HAND HOOD REMOVAL**

1. Remove and keep one screw from outer hood.

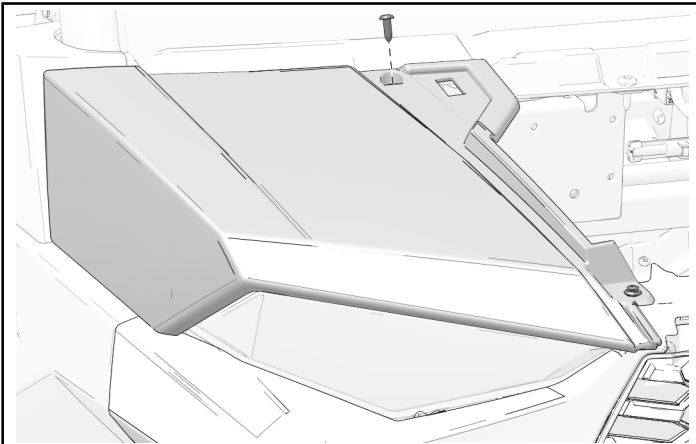

### **ACCESSORY INSTALLATION**

1. Install peel and stick cable tie guide ⑫.

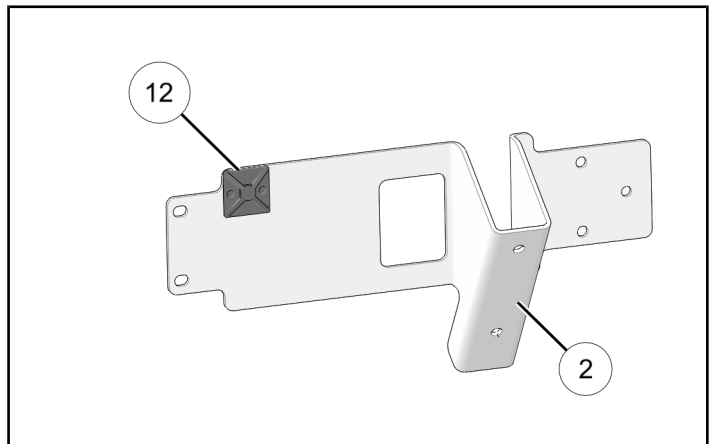

2. Install washer fluid reservoir bracket ② using screws ⑭.

**TORQUE**

Screws ⑭:  
**44 in-lbs (5 N·m)**

**IMPORTANT**

Use care to not over-torque fasteners.

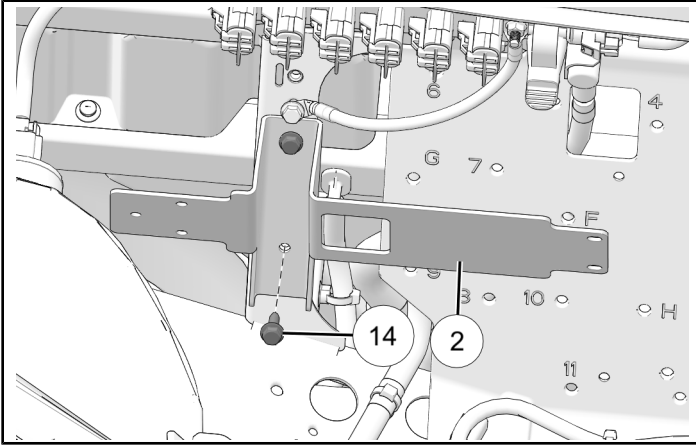

3. Install washer fluid reservoir ① using screws ⑮ and nuts ⑯.

**IMPORTANT**

Use care to not over-torque fasteners.

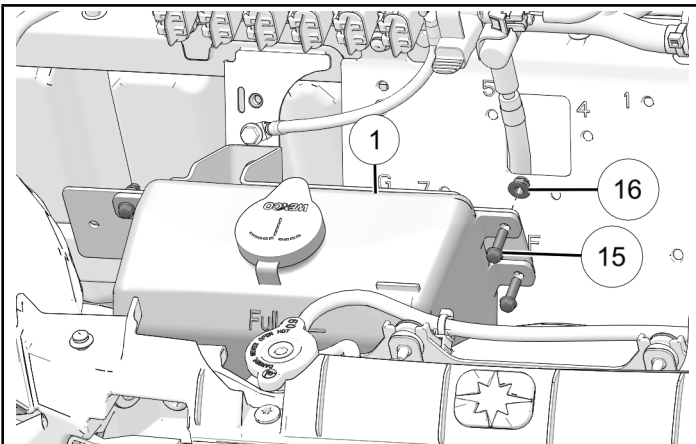

4. Remove two plugs from windshield.

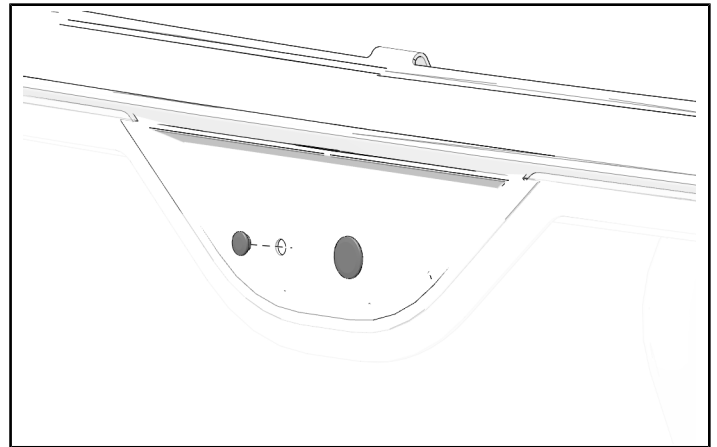

5. Install spacer ⑳, washer ㉑, Bushing ㉒, cupped washer ㉓, and washer ㉔ on to wiper motor ⑥.

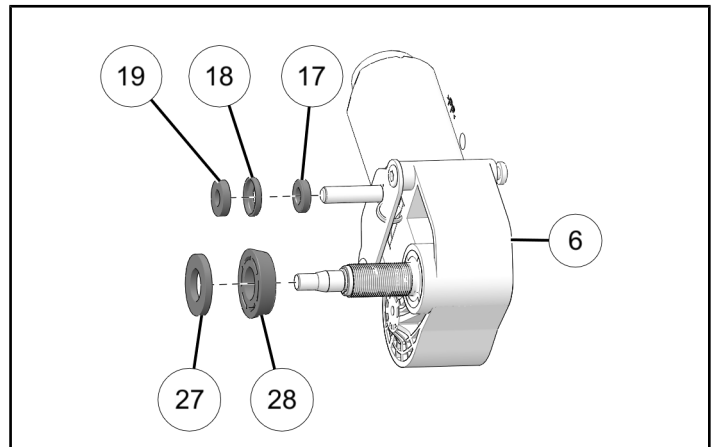

6. Install wiper motor into windshield.

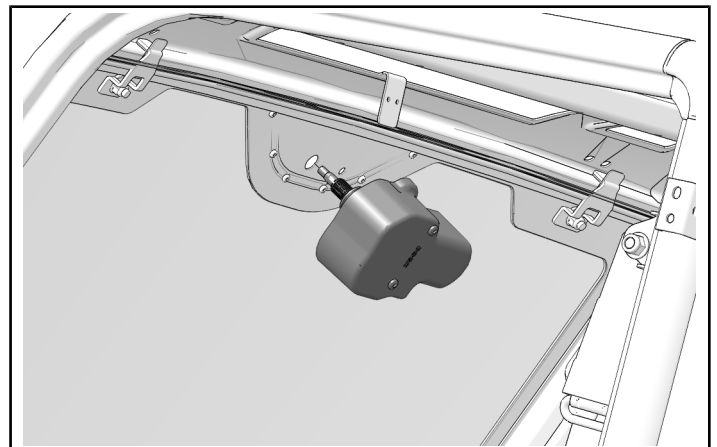

7. Install washer ⑱, washer ⑲ and loosely install nut ⑳ and loosely install nut ㉑.

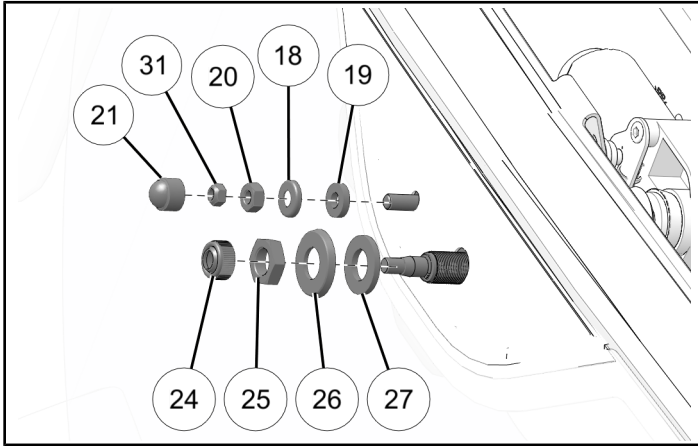

8. Install washer ㉗, washer ㉖ and loosely install nut ㉕.
9. Torque nuts ㉓, ㉒ and ㉑ in order, to specification. Install cap ㉔ and cap ㉑.

**TORQUE**

Nut ㉓:  
**60 in-lbs (7 N·m)**

**TORQUE**

Nut ㉒:  
**60 in-lbs (7 N·m)**

**TORQUE**

Nut ㉑:  
**60 in-lbs (7 N·m)**

10. Install wiper blade ③ on to wiper arm ⑤.

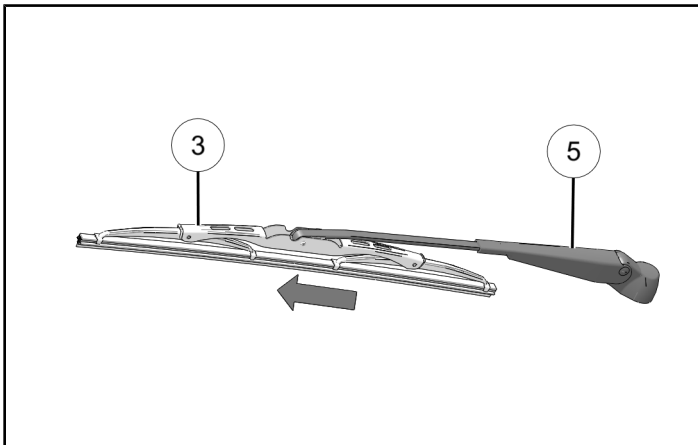

11. Lift wiper arm cap to reveal mounting bracket.

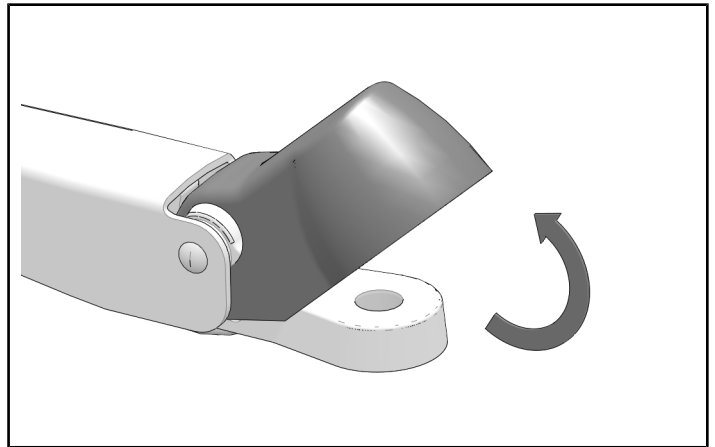

12. Put wiper arm on to wiper arm shaft in a position that will allow wiper blade to fully clean windshield.

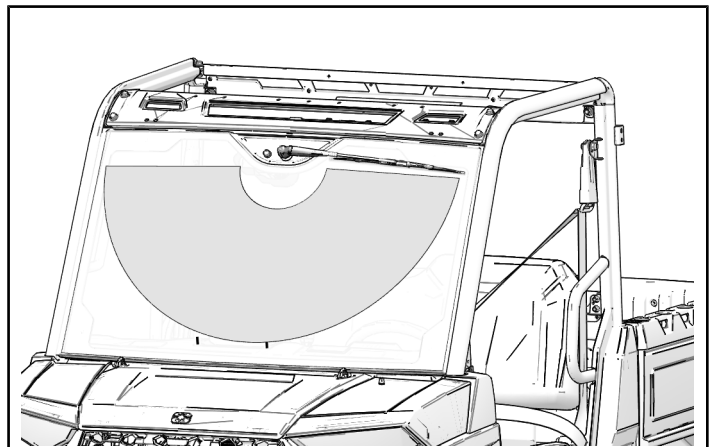

13. Install wiper using washer ㉓ and nut ㉒.

**TORQUE**

Nut ㉒:  
**15 ft-lbs (20 N·m)**

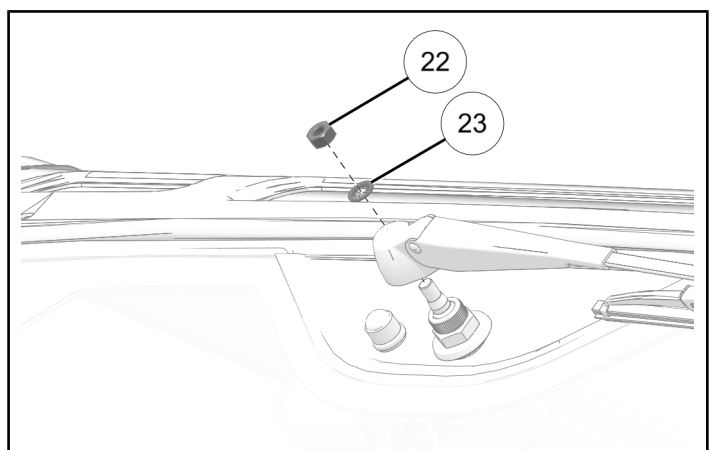

14. Install wiring harness on to electrical mount panel.  
Push connector **12F** under dashboard toward center switch panel. Push connector **4F** underneath dashboard towards left ROPS.

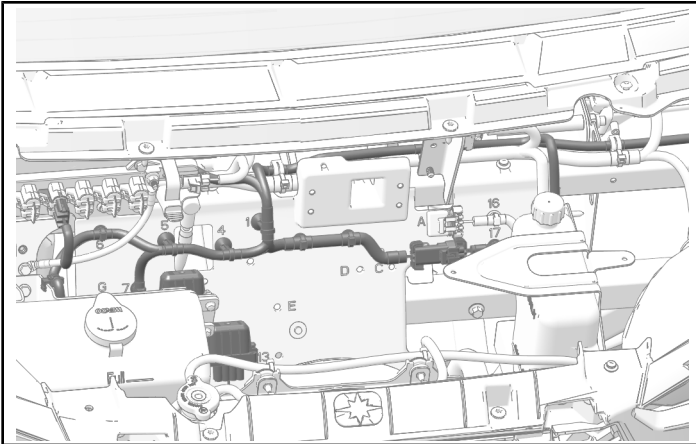

15. Route harness and connect **5M** to **5F**.

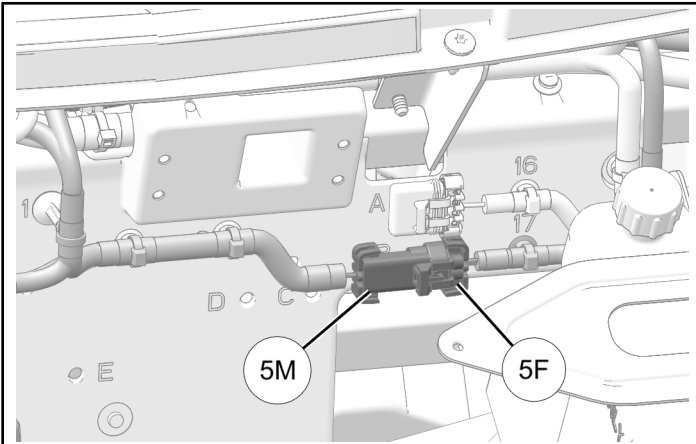

16. Connect **2F** to washer pump.

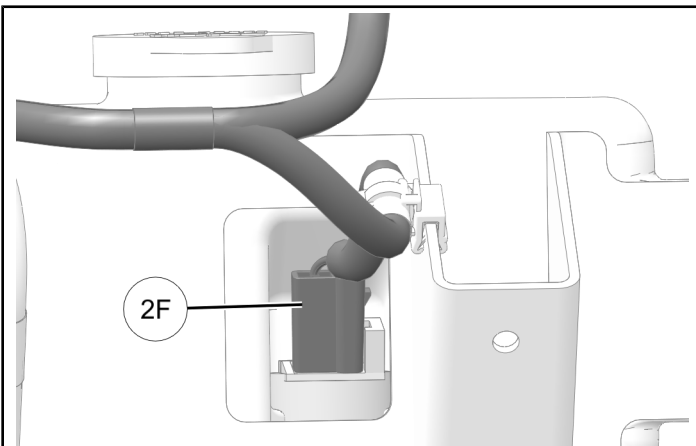

17. Connect **3F** to pulse bar.

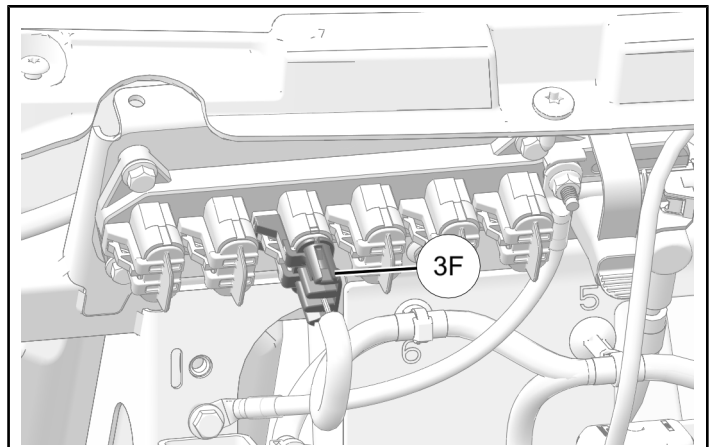

18. Install fuses to electrical mounting panel.

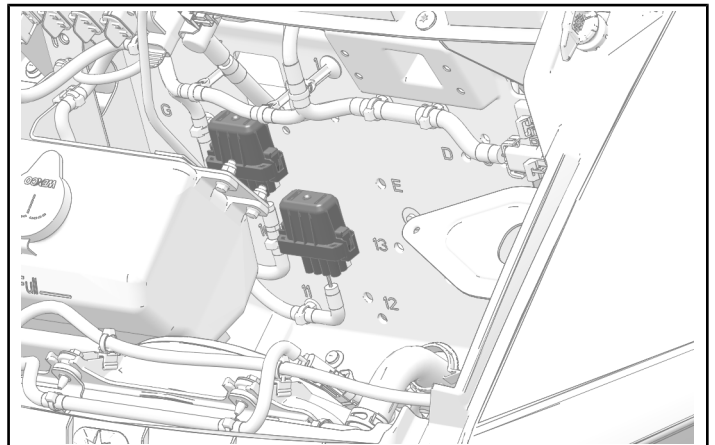

19. Cut out switch blank along indentation.

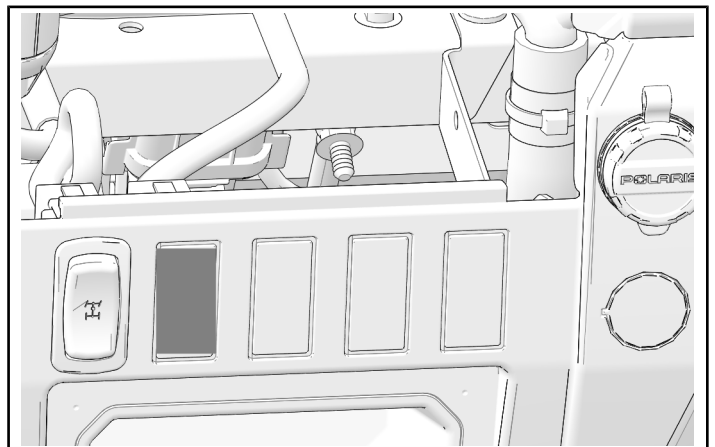



20. Install switch ⑦ to switch connector 12F.

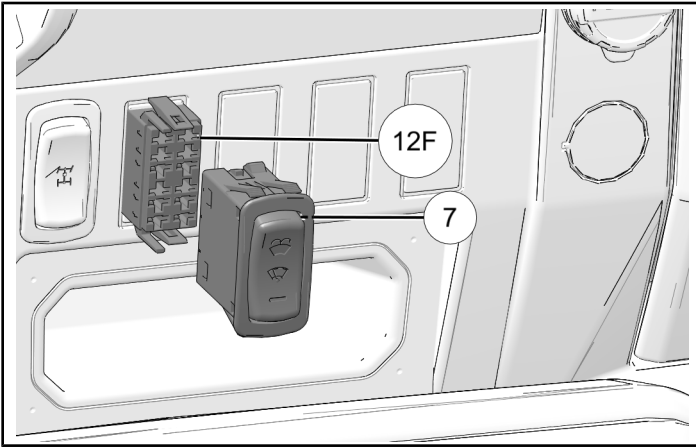

23. Install three retained fasteners.



21. Remove and keep three fasteners.

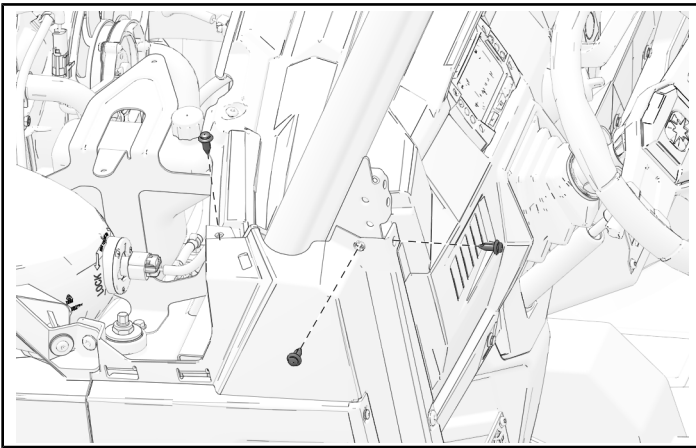

24. Peel backing from routing channel ⑨ and install on ROPS.

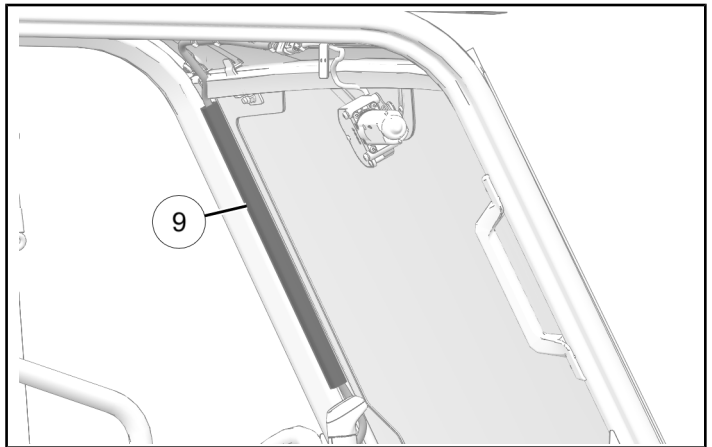

22. Route wiring harness between ROPS and dashboard.

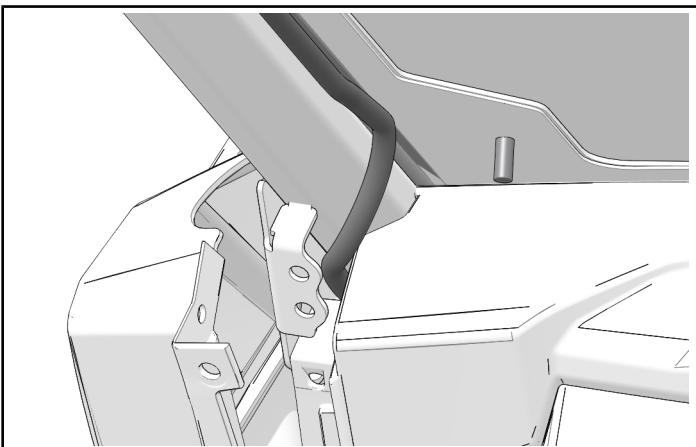

25. Attach harness to ROPS using clips and connect 4F to wiper motor.

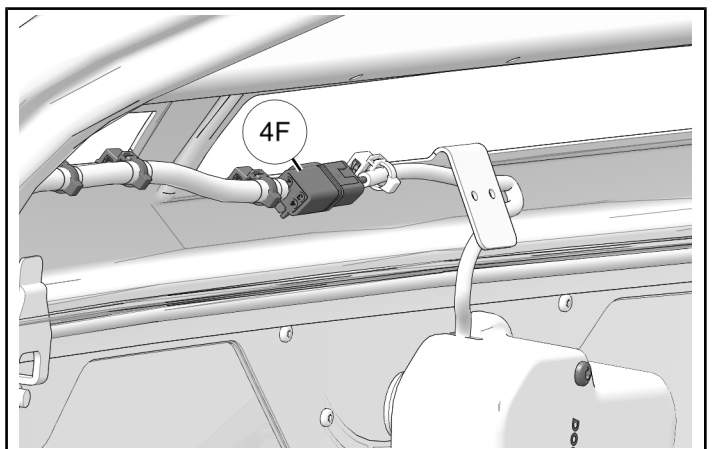

26. Install washer hose ⑧ and secure with cable tie.

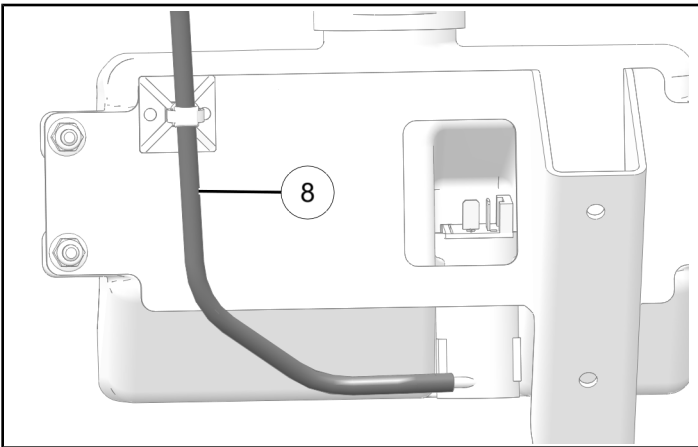

27. Attach washer hose to bottom of upper dash panel with clips ⑩.

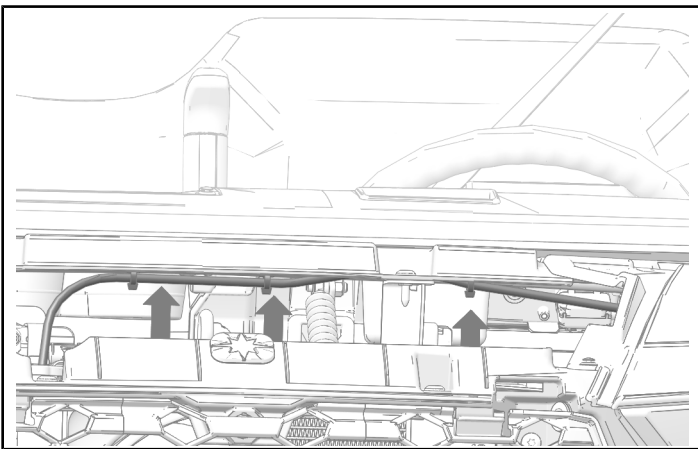

28. Drill a 5/16 in (8 mm) hole 6 1/4 in (16 cm) away from inner edge.

**TIP**

Align measurement with the center of square hole

**MEASUREMENT**

Distance Measurement ①:  
**6 1/4 in (16 cm)**

**MEASUREMENT**

Measurement ②:  
**5/16 in (8 mm)**

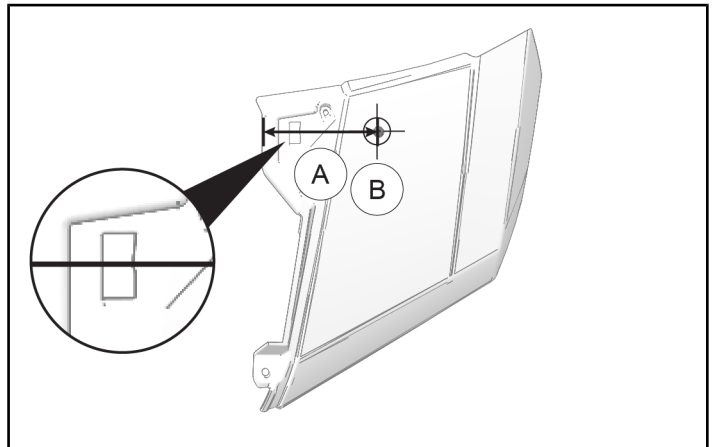

29. Install washer nozzle ④.

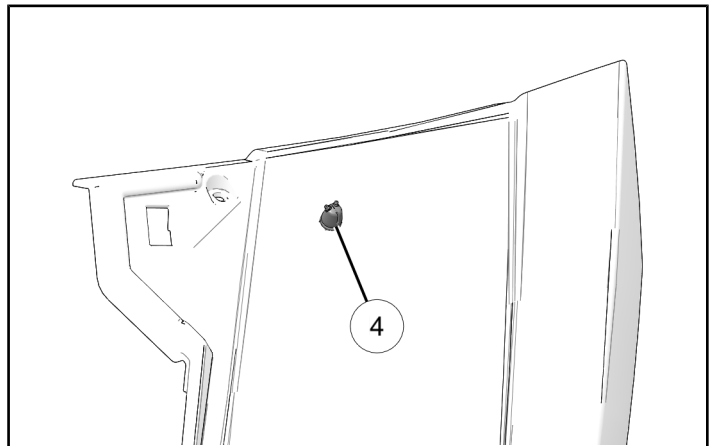

30. Put outer hood in installed position

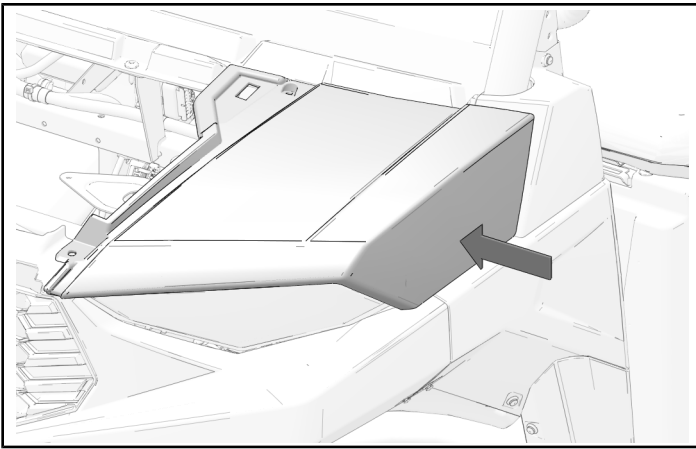

31. Install front of outer hood with one push-pin rivet.

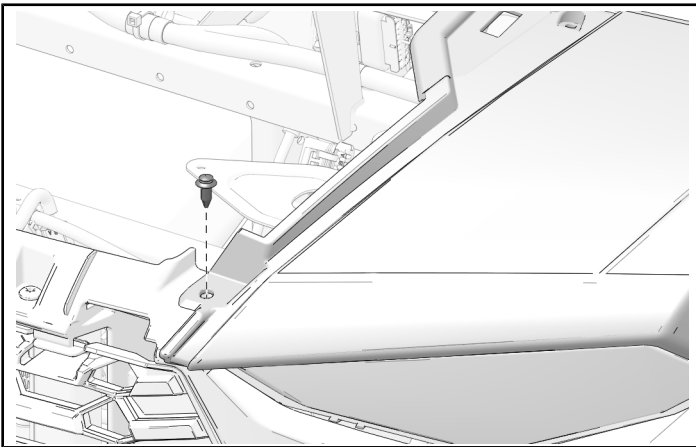

32. Install rear of outer hood with one retained screw.

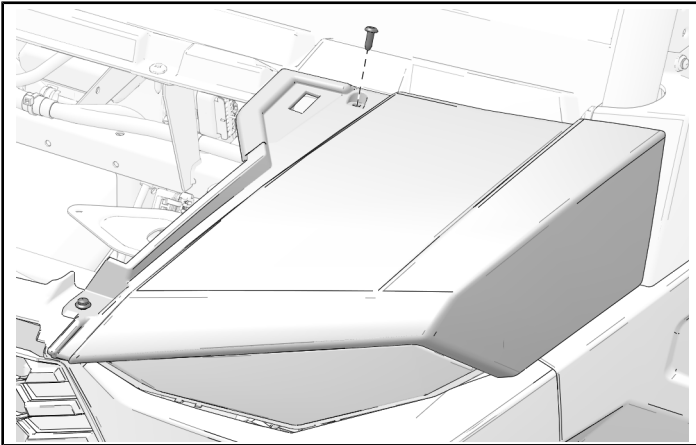

33. Attach washer hose to washer nozzle.

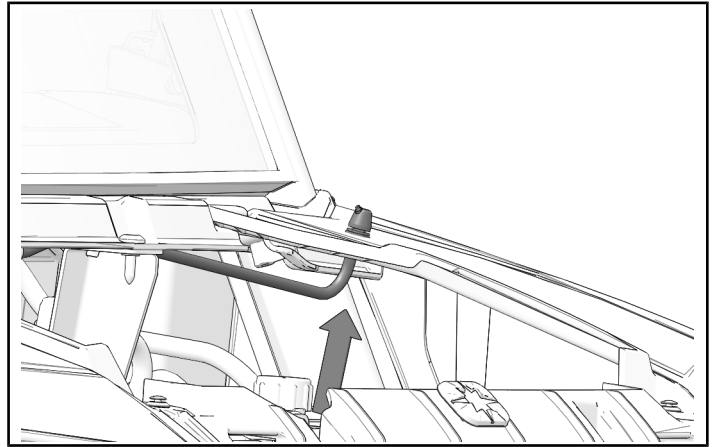

## VEHICLE REASSEMBLY

### CUP HOLDER INSTALLATION

1. Put cup holder in vehicle.

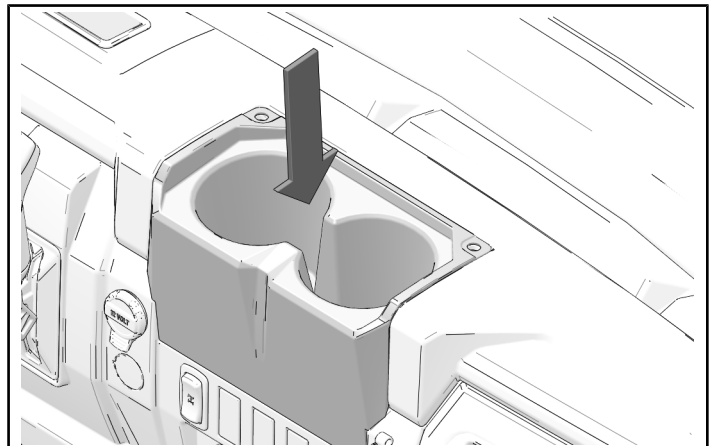

2. Install cup holder with two retained push-pin rivets.

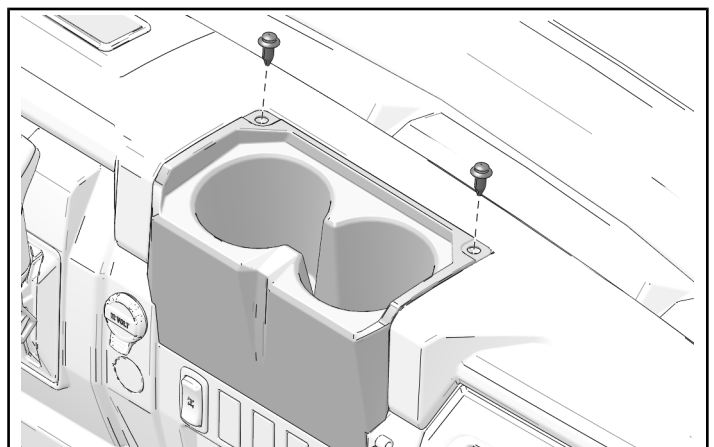

## RIGHT-HAND HOOD INSTALLATION

1. Put outer hood in installed position.

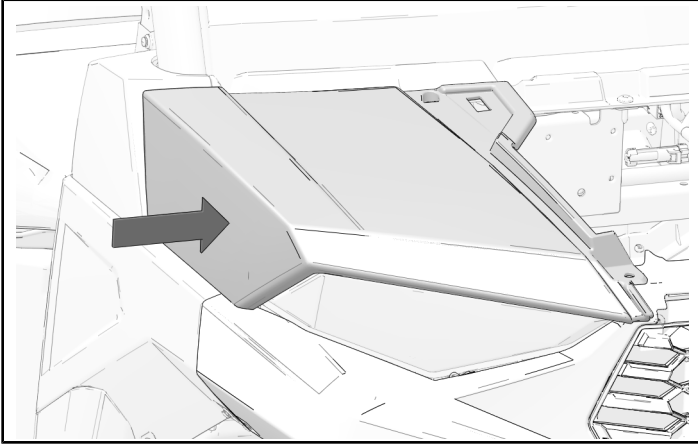

2. Attach front of outer hood with one push-pin rivet.

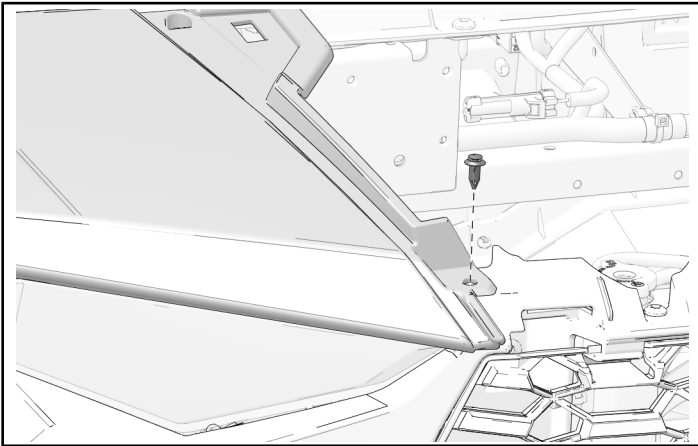

3. Attach rear of outer hood with one retained screw.  
Torque outer hood screws to specification.

### TORQUE

Outer Hood Screw:  
**22 in-lbs (2.5 N·m)**

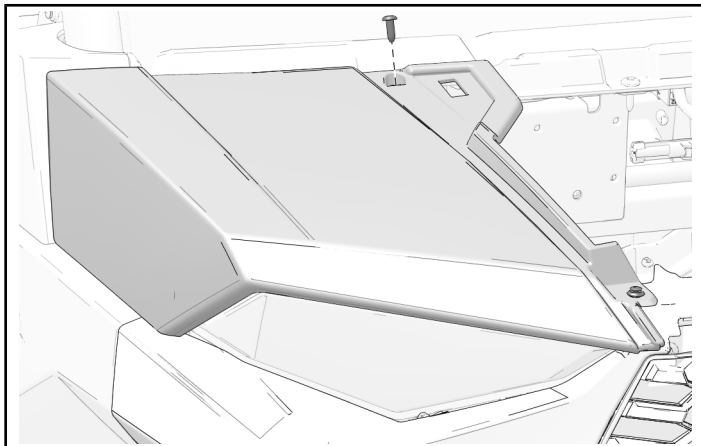

## HOOD INSTALLATION

1. Align hood with vehicle and turn two quarter-turn fasteners to lock position to install hood.

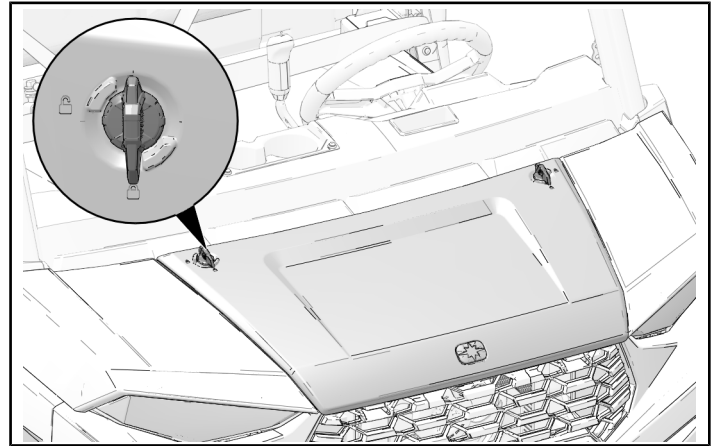

## OPERATION

### POWERING WINDSHIELD WIPER ON/OFF

Vehicle battery must be turned on for windshield wiper to function.

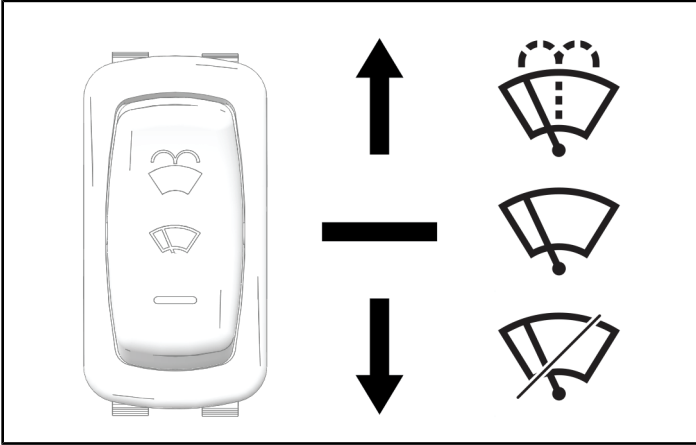

### NOZZLE ADJUSTMENT

Nozzle can be adjusted by pivoting nozzle opening within assembly.

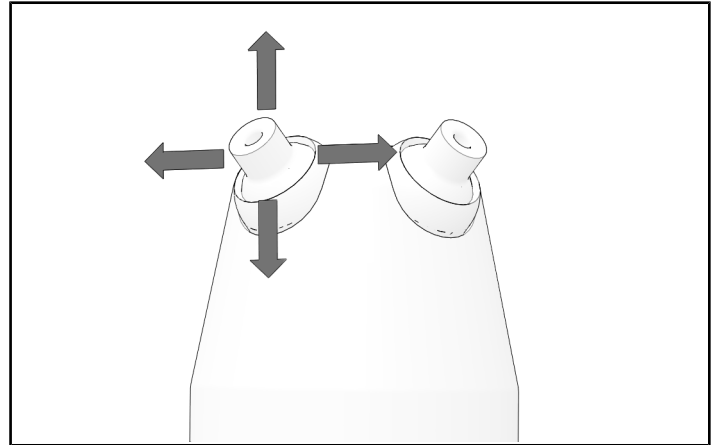

### FILLING WASHER FLUID RESERVOIR

Fill reservoir to line marked "Full." Never fill reservoir past "Full" line.

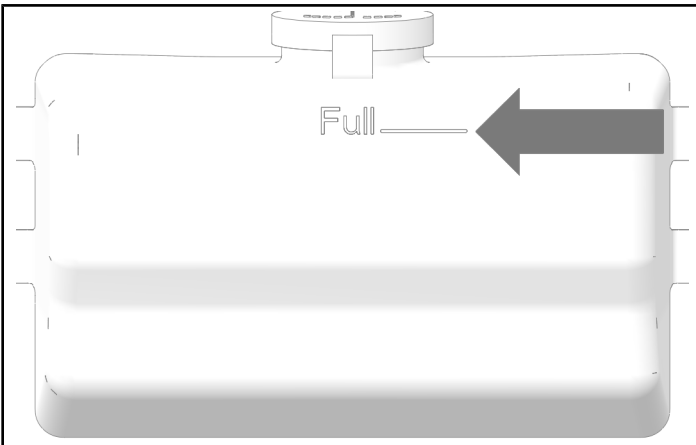

### INSTRUCTION FEEDBACK FORM

A feedback form has been created for the installer to provide any comments, questions or concerns about the installation instructions. The form is viewable on mobile devices by scanning the QR code or by clicking [HERE](#) if viewing on a PC.

