

REAR PREMIUM DOOR KIT

POLARIS

ENGINEERED PARTS
ACCESSORIES & APPAREL

P/N 2885074; 2889482

BEFORE YOU BEGIN

Read these instructions and check to be sure all parts and tools are accounted for. Please retain these installation instructions for future reference and parts ordering information.

APPLICATION

Verify accessory fitment at www.polaris.com.

Compatible with Pro XD mid-sized models.

KIT CONTENTS

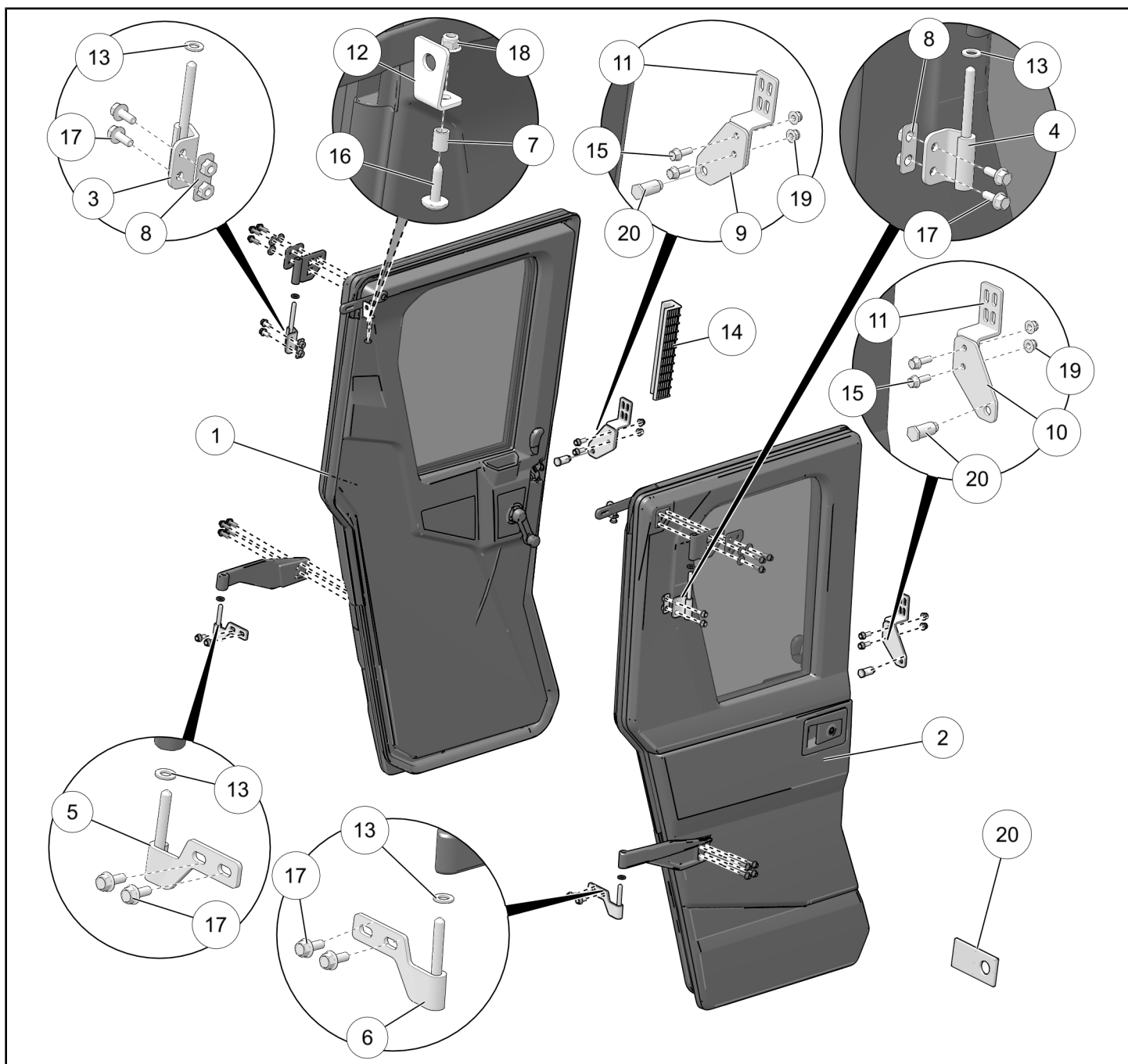

REF	QTY	PART DESCRIPTION	P/N AVAILABLE SEPARATELY	AVAILABLE SERVICE KIT
1	1	Door Assembly, Left	n/a	n/a
2	1	Door Assembly, Right	n/a	n/a
3	1	Hinge, Chassis-Side, Upper Left	1019785	2209269
4	1	Hinge, Chassis-Side, Upper Right	1019786	2209269
5	1	Hinge, Chassis-Side, Lower Left	1026926	2209269
6	1	Hinge, Chassis-Side, Lower Right	1026927	2209269
7	2	Spacer	5139193	2209269
8	2	Nut Plate, Upper Chassis Side Hinge	5256140	2209269
9	1	Striker, Crew, Left	1026985	2209270
10	1	Striker, Crew, Right	1026986	2209270
11	2	Bracket, Striker, Crew	5271972	2209270
12	2	Bracket, Door Limiter	5273307	n/a
13	4	Washer, Nylon – 10.2 x 19.0 x 2.0 mm	5439712	2209269
14	2	Shim – Door, Install A	5459247	n/a
15	4	Screw, Hex Flange – M8 x 1.25 x 25 mm	7517839	2209270
16	2	Screw, Torx® drive Truss Head – M6 x 1.0 x 25 mm	7520748	n/a
17	8	Screw, Hex Flange – M8 x 1.25 x 20 mm	7521168	2209269
18	2	Nut, Hex Flange – M6 x 1.0 mm	7547453	2209269
19	4	Nut, Hex Flange – M8 x 1.25 mm	7547454	2209270
20	1	Shim – Door, Install B	5459246	n/a
21	1	Accessory – Seal, Cab, Crew (not shown)	2889274	n/a

TOOLS REQUIRED

- Safety Glasses
- Cutting Tool
- Pliers, Push Pin Rivet
- Socket Set, Hex Bit, Metric
- Socket Set, Metric
- Socket Set, Torx® Bit
- Torque Wrench
- Wrench Set, Metric

CONSUMABLES REQUIRED

- Cloth, Non-Abrasive, Lint-Free
- Gloves, Chemical Resistant
- Grease, Polaris® All Season (or equivalent)

IMPORTANT

Your Rear Premium Door Kit is exclusively designed for your vehicle. Please read the installation instructions thoroughly before beginning. Installation is easier if the vehicle is clean and free of debris. For your safety, and to ensure a satisfactory installation, perform all installation steps correctly in the sequence shown.

INSTALLATION INSTRUCTIONS

VEHICLE PREPARATION

GENERAL

1. Park vehicle on a flat surface.
2. Shift vehicle into PARK.
3. Turn key to OFF position and remove key.

REAR SIDE NET REMOVAL (IF EQUIPPED)

1. Remove and keep the upper side net fastener from the ROPS. Keep the nut plate for the upper door bracket installation. (Bracket included with kit is used to secure the striker mount if a windshield is not already installed.)

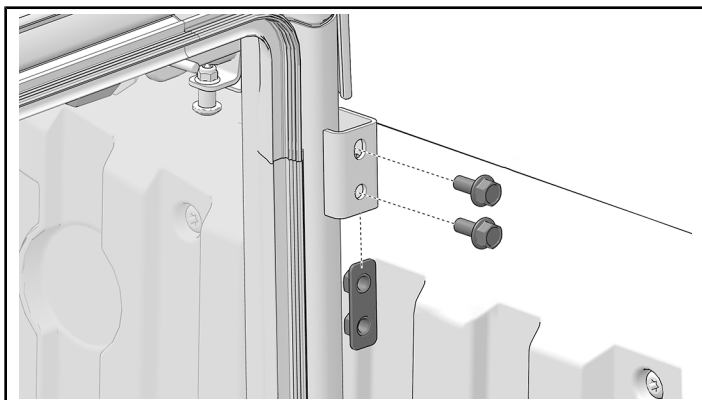

2. Remove the fasteners from the side net latch on the ROPS and remove the latch.

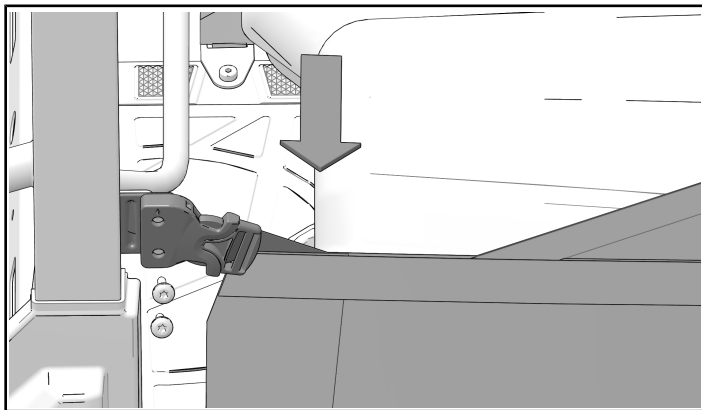

3. Remove and keep the lower side net fastener on the floorboard. Continue by reinstalling the retained lower fastener and torquing to specification.

TORQUE

Lower Side Net Fastener:
44 in-lbs (5 N·m)

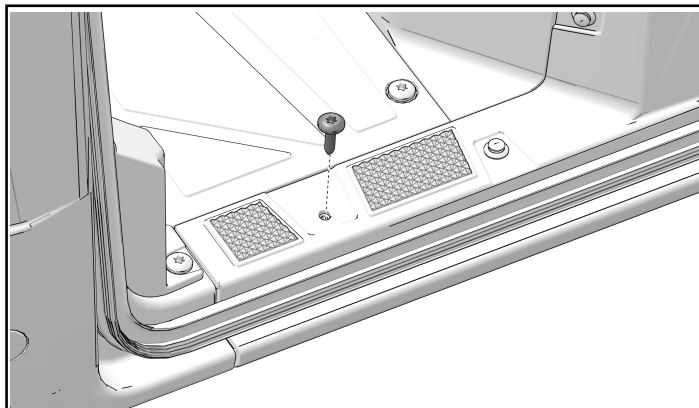

4. Lift the seat by pivoting the rear of the seat up.

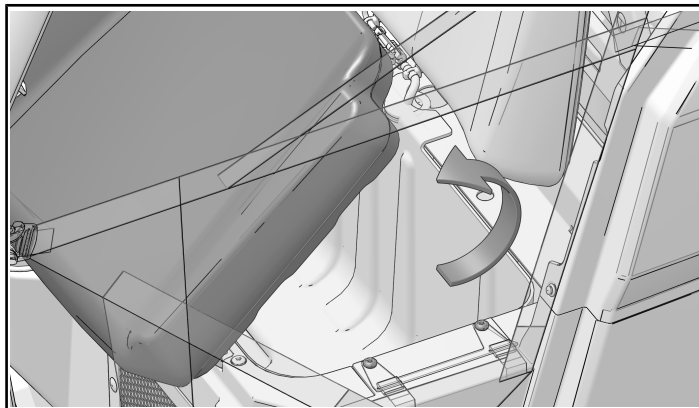

5. Remove and keep two side net fasteners. Remove and discard net.

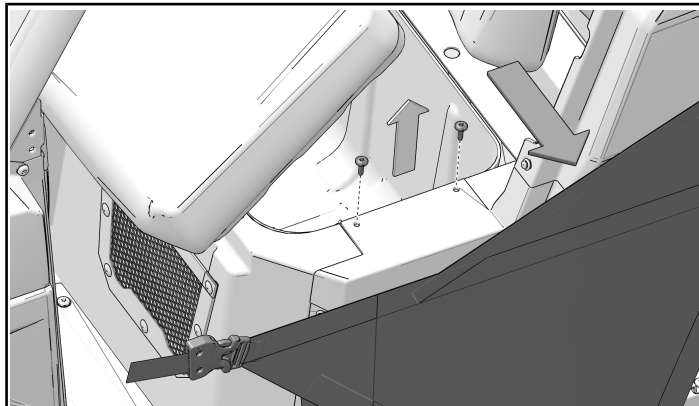

6. Reinstall the retained fasteners and torquing to specifications. Lift up the two seat belt buckles and pivot the seat back down.

TORQUE

Lower Side Net Fastener:
44 in-lbs (5 N·m)

7. If a rear panel is installed, unlock the panel and pivot back. Then undo the net straps and set the net aside.

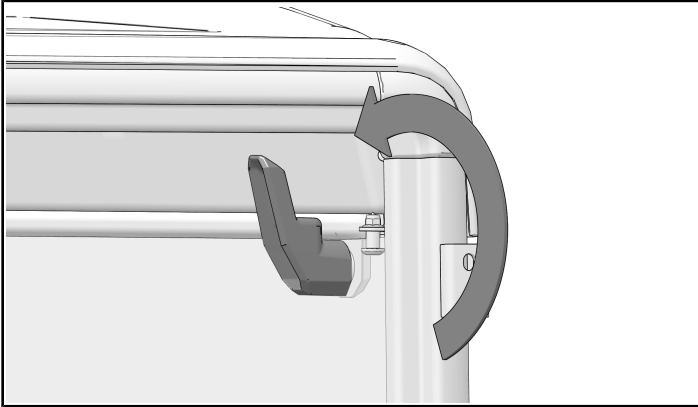

8. Continue by pivoting the rear panel in and locking the panel, if installed.

ACCESSORY INSTALLATION

REAR DOOR INSTALLATION

1. Compare the upper chassis hinges ③, ④, and select ③ for the left door or ④ for the right door.

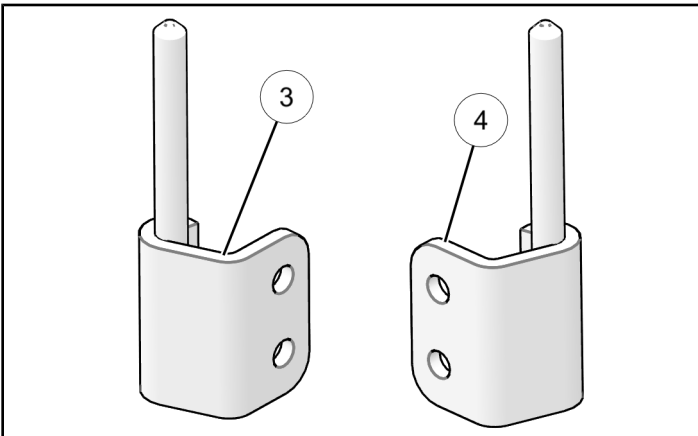

2. Align the upper chassis-hinge with the mounting holes on the ROPS bracket. Install two fasteners ⑰ through the hinge ③, into the plate ⑧. Then square up the chassis-hinge and torque the fasteners to specifications.

TORQUE

Screw, Hex Flange ⑰:
17 ft-lbs (23 N·m)

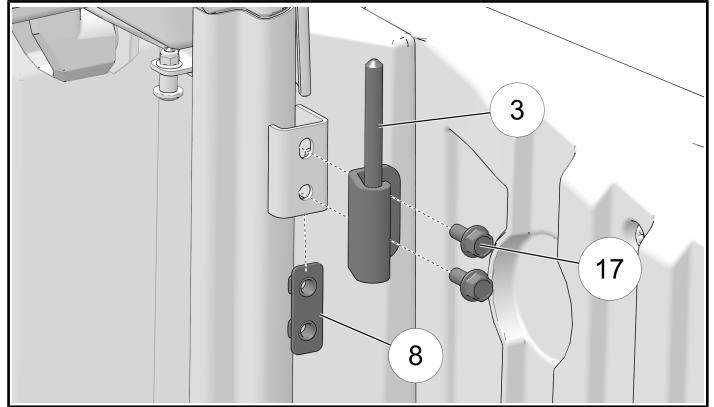

3. Loosen screw and pivot clamp over the grab handle.

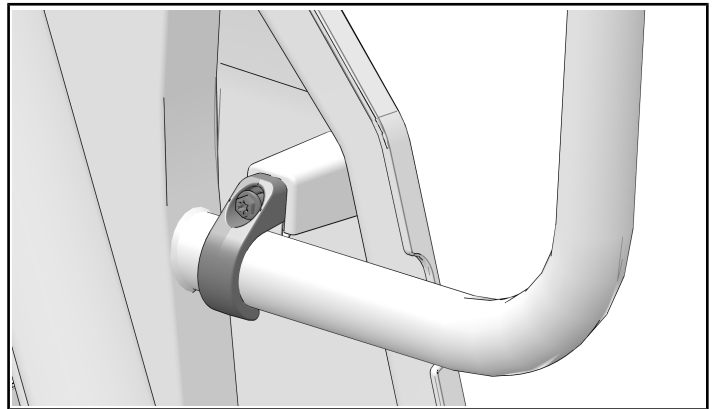

4. Remove and keep three push-pin rivets from the side bezel near the grab handle. Disengage the retention tabs on the bezel and lift out to remove.

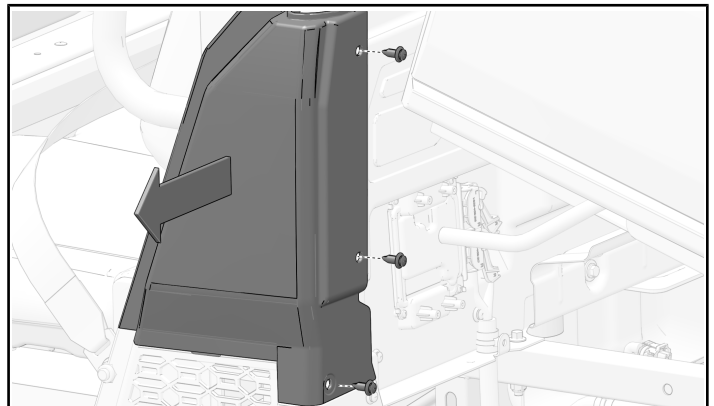

5. Compare the two lower hinges ⑤ and ⑥. Use ⑥ for right door and ⑤ for the left door. The pin should be on the front side of the hinge once installed.

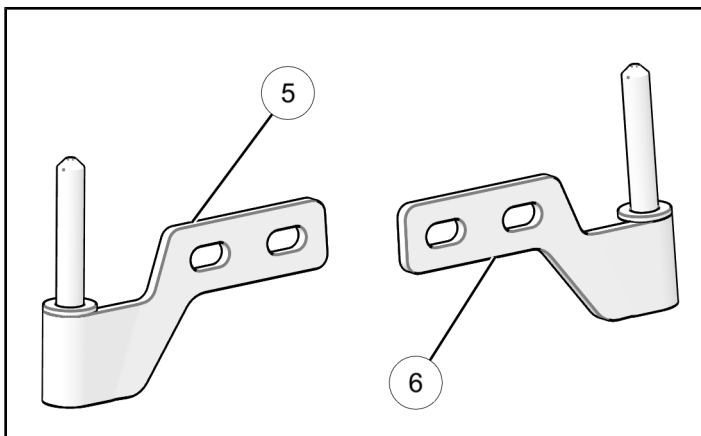

6. Align the lower chassis-hinge ⑤ with the mounting holes on the rear of the cab and install two fasteners. Align the bracket in the middle of the adjustment range and torque the fasteners ⑰ to specification while ensuring the bracket remains level.

TORQUE

17 ft-lbs (23 N·m)

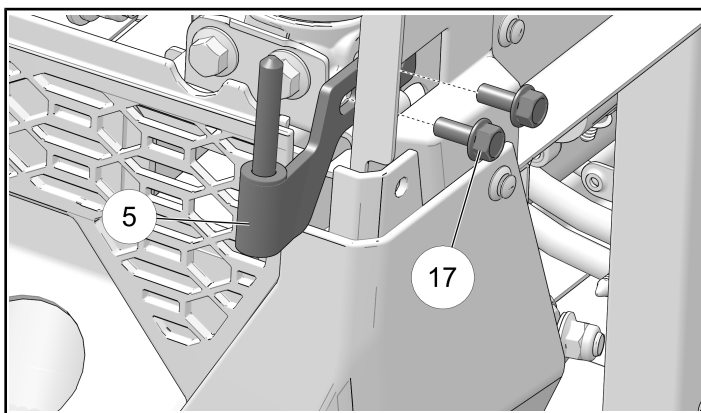

7. Locate the groove on the back of the side bezel, and cut the groove out with a utility knife to create room for the door hinge.

NOTICE

Image shows groove on bezel already cut out.

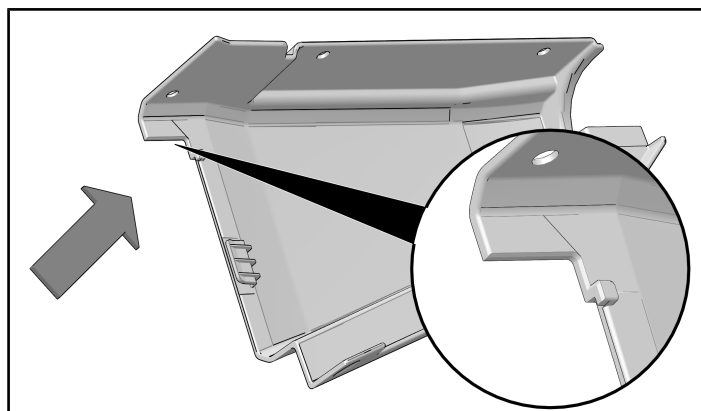

8. Align the side bezel retention tabs with the body of the vehicle, pressing the bezel into place until fully seated. Continue by reinstalling the three push-pin rivets into the side bezel.

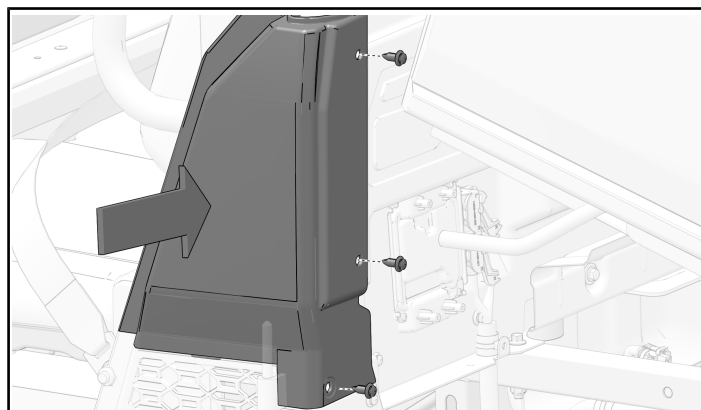

9. Reinstall the retained fastener and clamp over the grab handle into the side bezel and torque the fastener to specification.

TORQUE

Grab Handle Screws:
44 in-lbs (5 N·m)

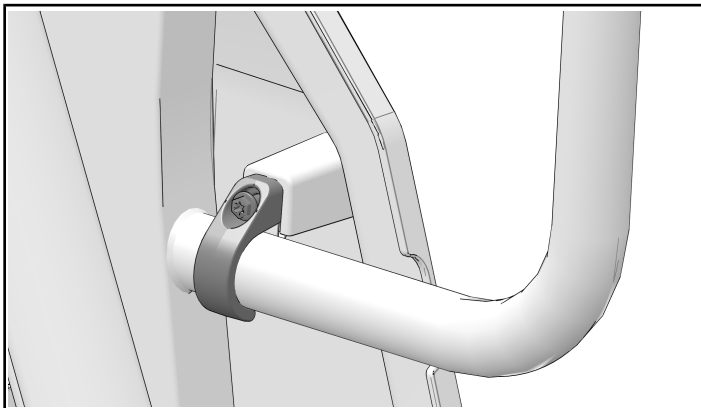

10. Before continuing, lower the box and ensure the latch is secure.

11. Remove the fasteners from the side net latch on the ROPS and remove the latch.

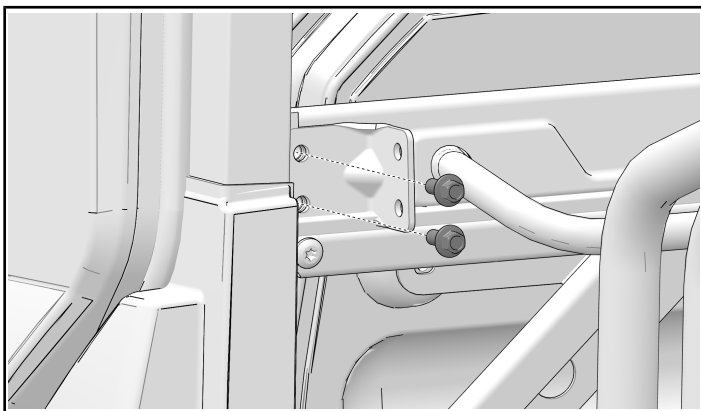

12. Install striker bracket ⑪ using the two retained fasteners. Torque to specification below.

TORQUE

ROPS Screws:
18 ft-lbs (24 N·m)

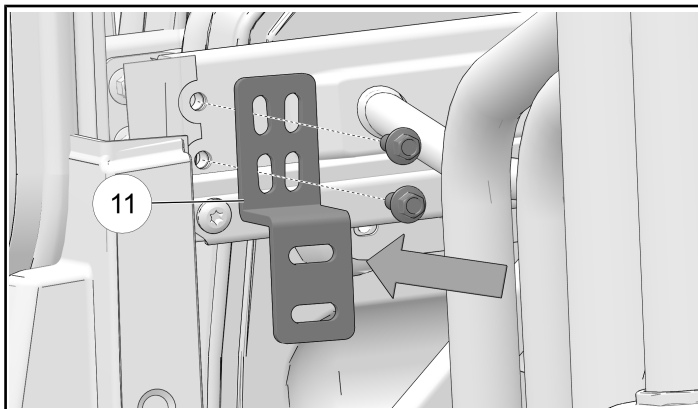

13. Compare the two striker mounts ⑨ and ⑩.

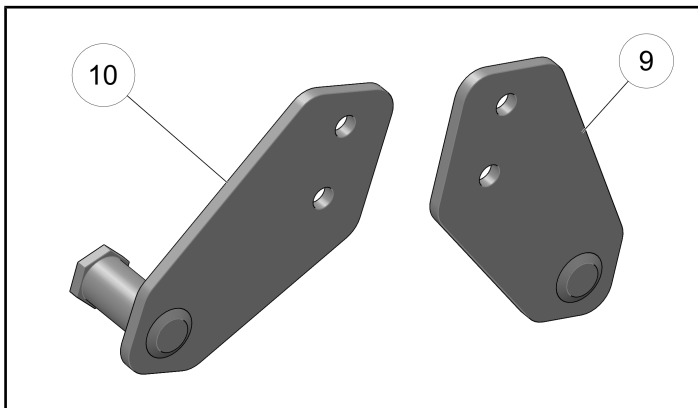

14. Align the striker mount ⑨ with the striker bracket ⑪, and mounting holes on the ROPS. Loosely install two new fasteners ⑮.

DO NOT torque fasteners at this time.

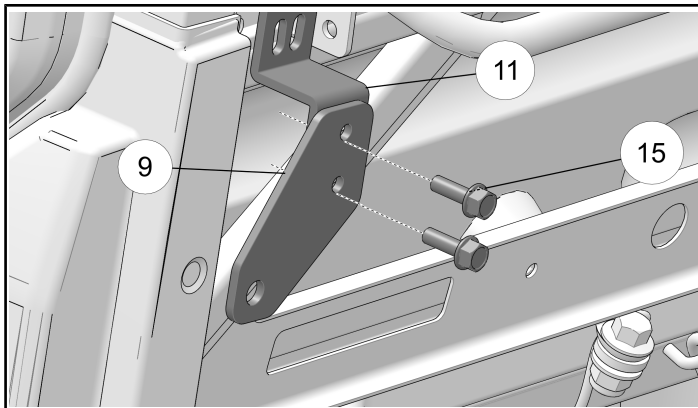

15. Loosely secure with a nut ⑱.

DO NOT torque fasteners at this time.

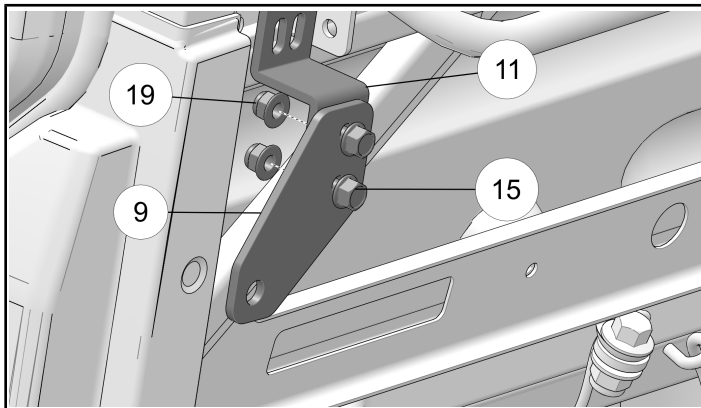

16. Install striker pin ⑳, align with striker mount.

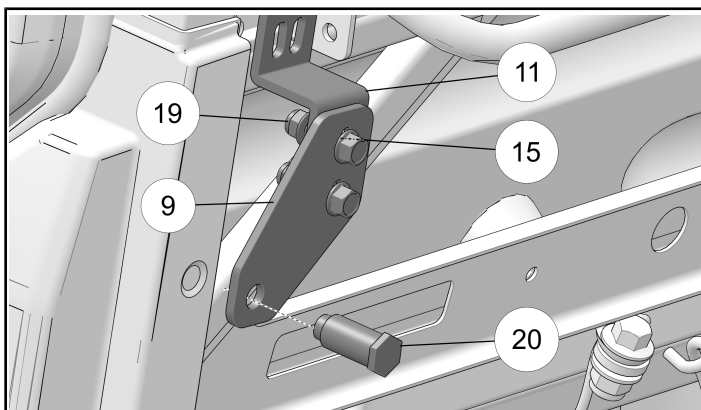

17. Slide a nylon washer ⑬ on the upper and lower chassis-side hinges ⑤ or ⑥. Grease the pins on the upper and lower chassis-side hinges using all season grease.

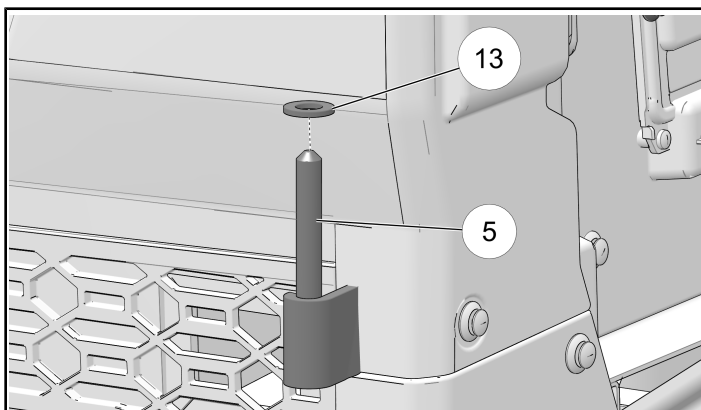

18. With the aid of an assistant, align the upper and lower door hinges with the chassis hinges while door is in the open position. Pivot the door as needed to fully seat the upper and lower hinges.

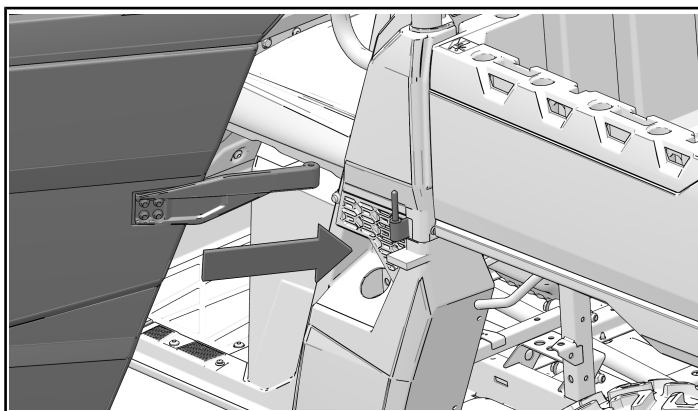

19. Remove and keep the fastener from the lower floor trim piece and remove the two push-pin rivets from the trim piece. Remove the trim.

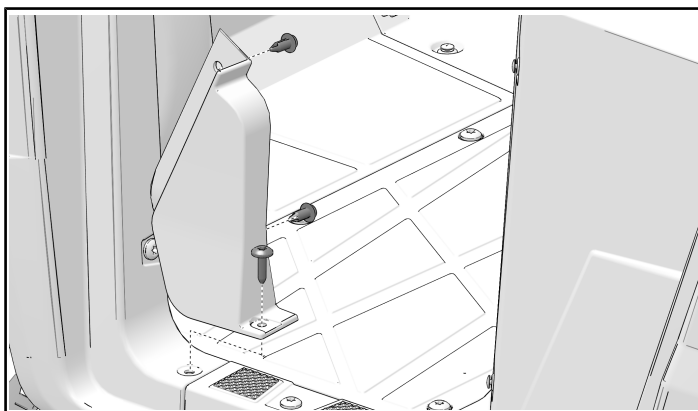

20. Press shim door adjustment tool ⑭ onto the lower door frame.

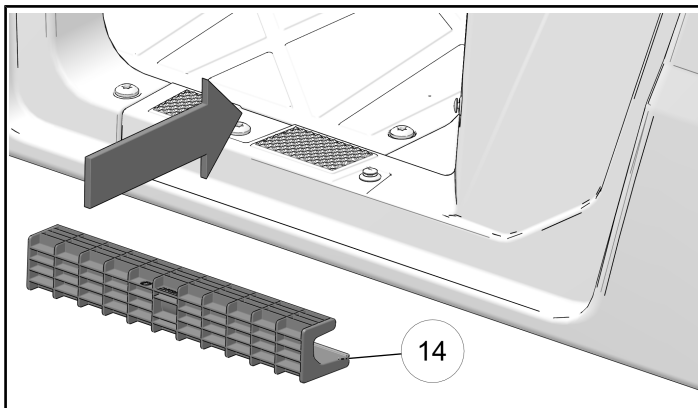

21. Close door, check alignment and all gaps.

22. Put shim door adjustment tool ⑳ into the spaces between forward facing rear door and vehicle frame, as shown.

NOTICE

Use shim in each location to make sure door alignment is even.

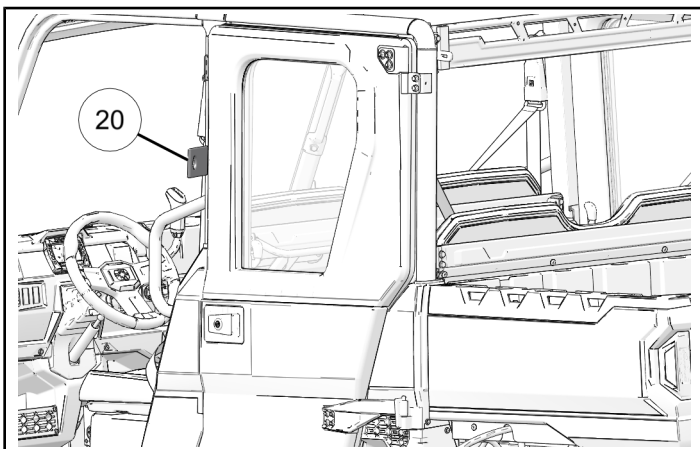
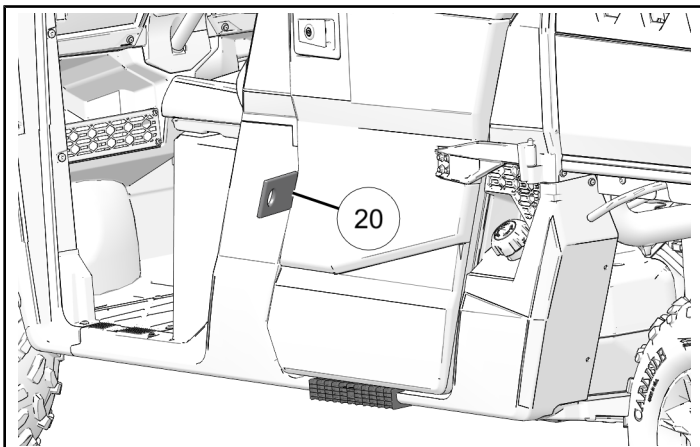

23. Torque the upper door hinge fasteners to specification.

TORQUE

18 ft-lbs (25 N·m)

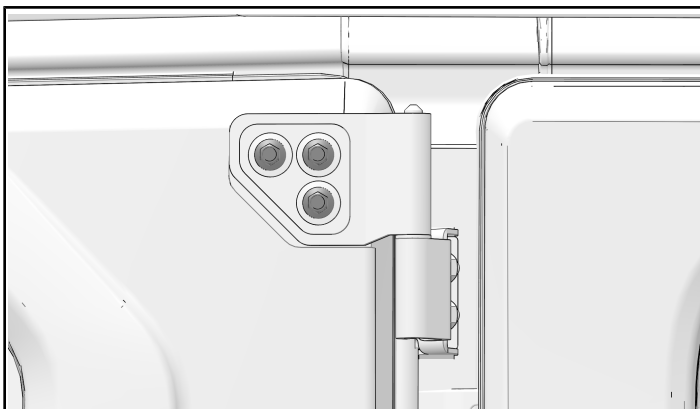

24. Torque the lower door hinge fasteners to specification.

TORQUE

18 ft-lbs (25 N·m)

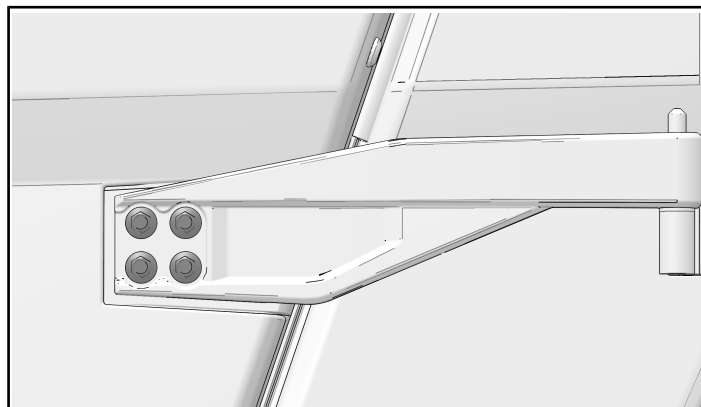

25. Before continuing, open the door and remove the door adjustment tool ⑭.

26. Lift the door up and over the adjustment tool and slowly close the door to observe the striker pin ⑳ entering the latch assembly. Ensure the door double latches and adjust the position as necessary.

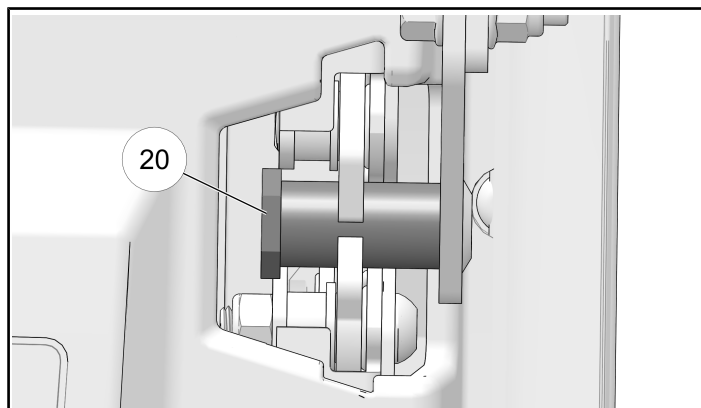

27. Remove and keep the upper seat belt mount fastener and nut.

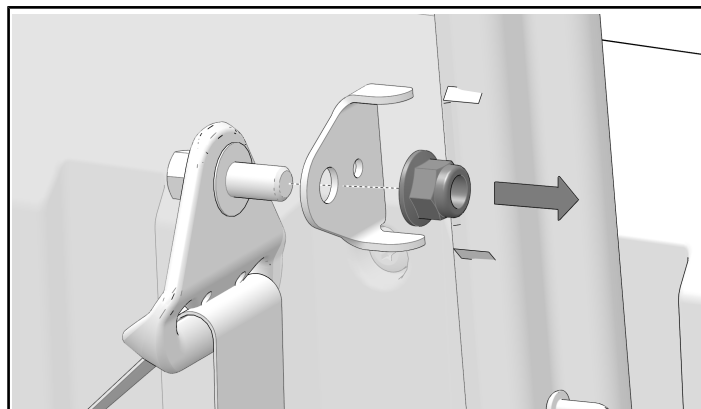

28. Insert the fastener through the seat belt mounting point, washer and the limiter strap post mount ⑫ with the tab up and facing inward. Continue by inserting the assembly into the ROPS bracket and reinstall the nut. Torque the nut to specification.

TORQUE

ROPS Nut:
40 ft-lbs (54 N·m)

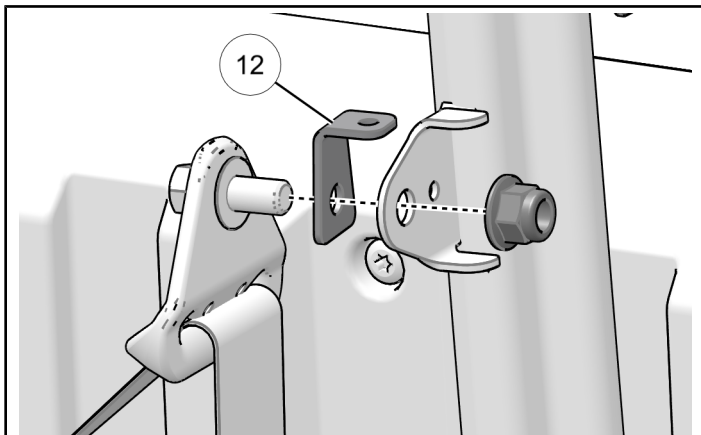

29. Next, install a fastener ⑯ and spacer ⑦ into the top of the limiter strap post mount ⑫ and secure with a nut ⑱. Align the hole in the limiter strap with the limiter strap post and press the strap down around the post. Continue by torquing the fastener to specification.

TORQUE

71 in-lbs (8 N·m)

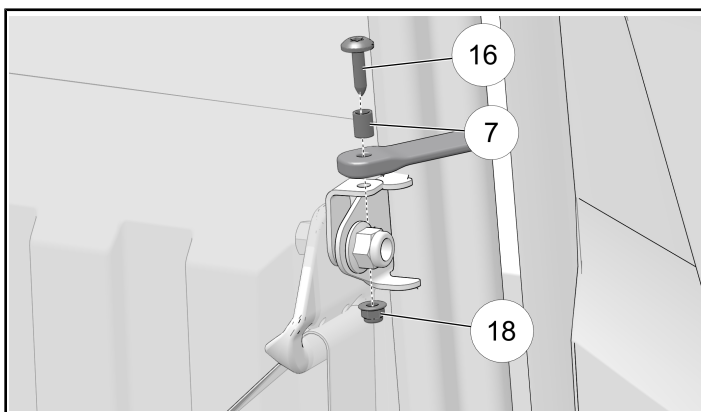

30. Finally repeat this entire process to install the other door.

OPERATION

1. The door can be locked and unlocked using the key provided in the kit.
2. To open the door from the inside, push the lever forward to free the latch.
3. To operate the window, use the manual window crank to open and close the window.
4. To install the storage net, align the net with the mounting holes in the door. Install the seven push-pin rivets to secure the net.

INSTRUCTION FEEDBACK FORM

A feedback form has been created for the installer to provide any comments, questions or concerns about the installation instructions. The form is viewable on mobile devices by scanning the QR code or by clicking [HERE](#) if viewing on a PC.

