

FRONT UPPER BUMPER AND HOOD RACK KIT



P/N 2884872-XXX, 2884878-XXX

MISSING OR DAMAGED PARTS

Before beginning assembly, inspect the kit and its component(s) to be sure all parts and tools are accounted for and not damaged. If missing parts or parts are damaged, please contact your Selling Dealer for assistance.

If your accessory was purchased online, please contact POLARIS® customer service at **1-800-POLARIS** (US & Canada only).

APPLICATION

Verify accessory fitment at www.polaris.com.

KIT CONTENTS

FRONT BUMPER P/N 2884872

NOTICE

XXX = Polaris® color code (For example: 458= Black)

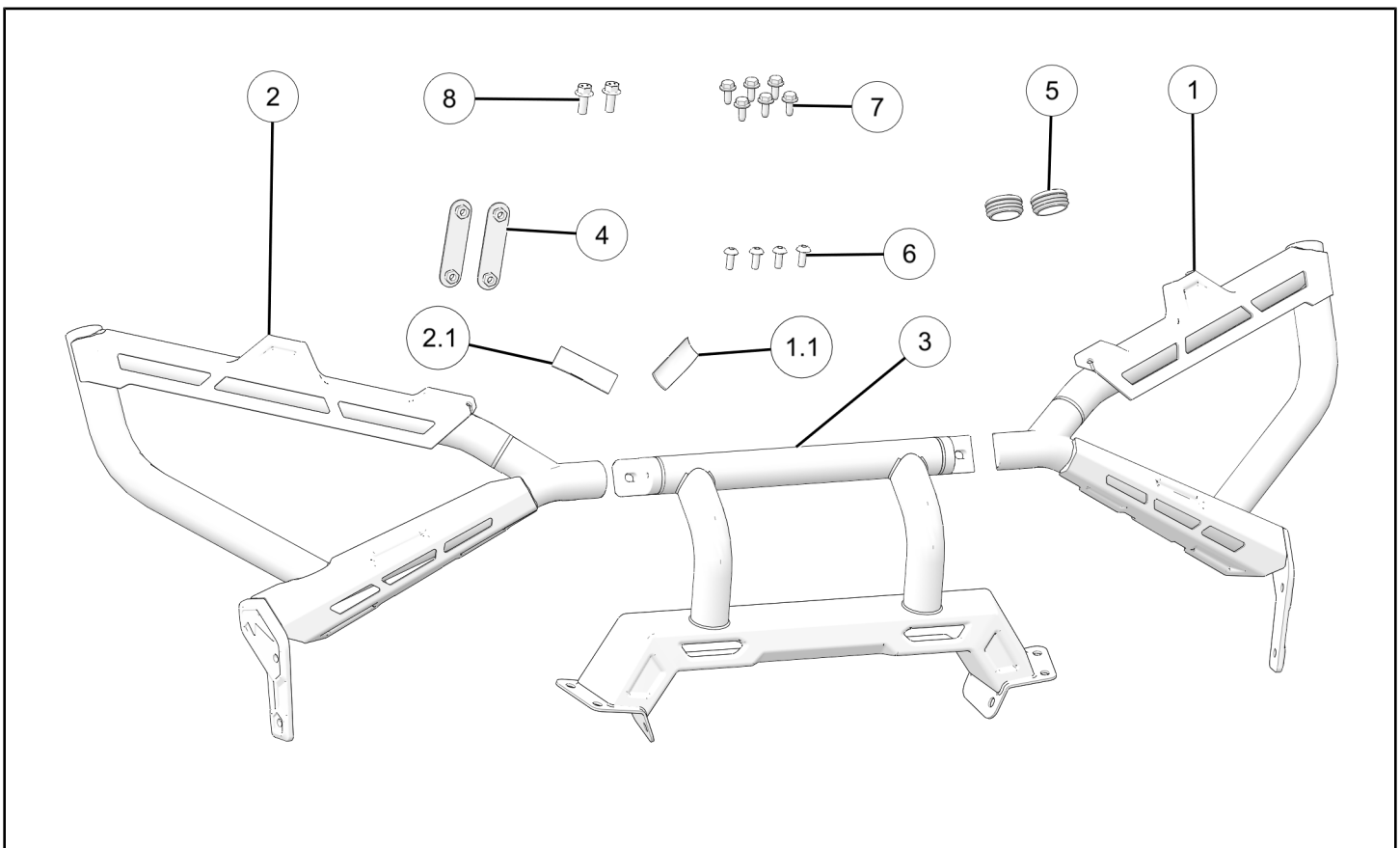

REF	QTY	PART DESCRIPTION	P/N AVAILABLE SEPARATELY	AVAILABLE SERVICE KIT
1	1	Bumper, Left	1027600-458	n/a
1.1	1	Foam Strip, Left	n/a	n/a
2	1	Bumper, Right	1027601-458	n/a

REF	QTY	PART DESCRIPTION	P/N AVAILABLE SEPARATELY	AVAILABLE SERVICE KIT
2.1	1	Foam Strip, Right	n/a	n/a
3	1	Bumper, Middle	1027602-458	n/a
4	2	Backer Plate	1027603-458	n/a
5	2	Bumper Cap	5434191	n/a
6	4	Screw, Torx®, Truss Head, M8 x 1.25 x 20 mm	n/a	2209566
7	6	Screw, Hex-Flange, M8 x 1.25 x 20 mm	n/a	2209566
8	2	Screw, Hex-Flange M10 x 1.5 x 25 mm	n/a	2209566

HOOD RACK P/N 2884878

NOTICE

XXX = Polaris® color code (For example: 458= Black)

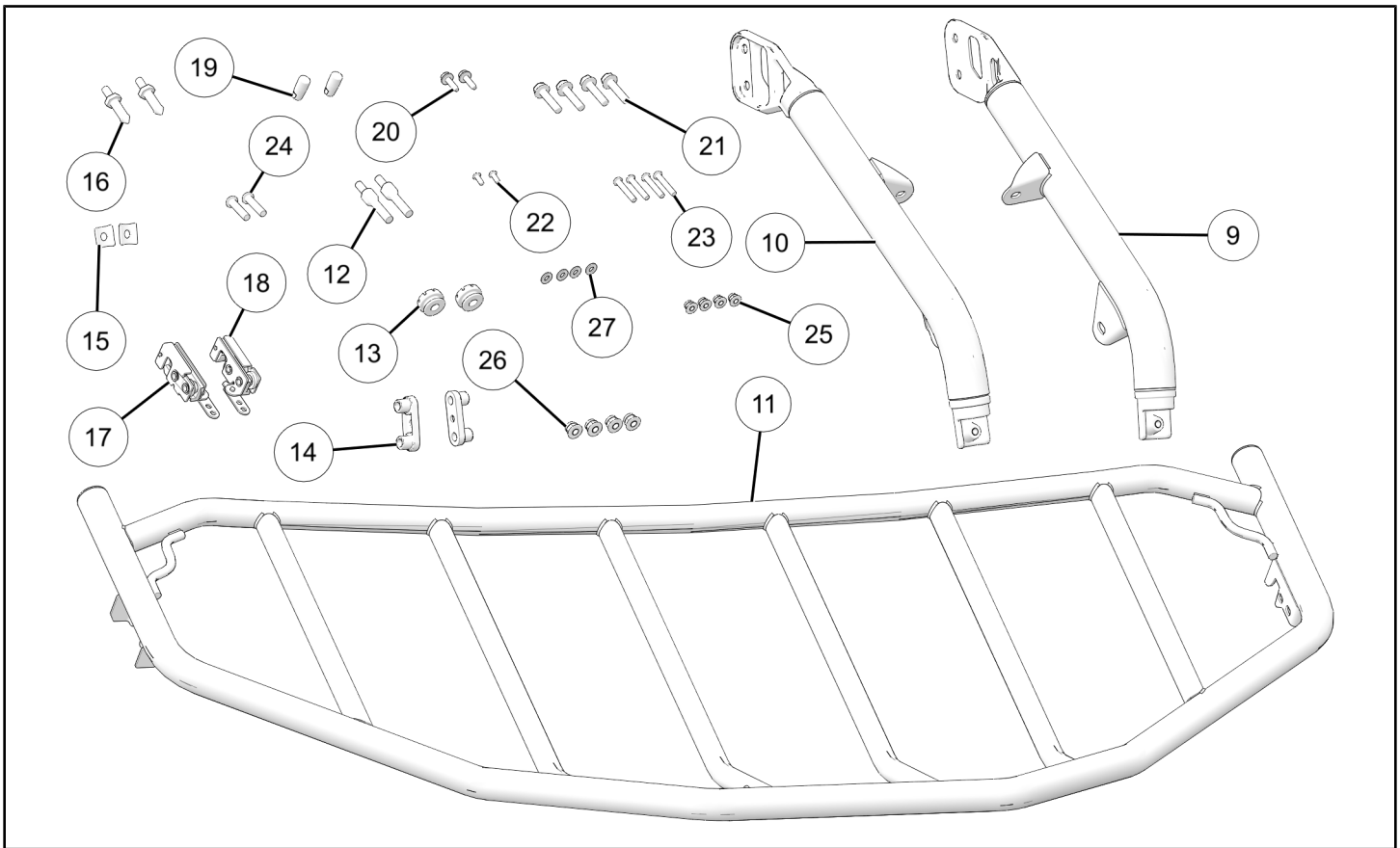

REF	QTY	PART DESCRIPTION	P/N AVAILABLE SEPARATELY	AVAILABLE SERVICE KIT
9	1	Hood Rack, Left Arm	1026012-458	n/a
10	1	Hood Rack, Right Arm	1026013-458	n/a
11	1	Hood Rack, Main Basket	1026014-458	n/a
12	2	Pin, Latch	n/a	2209594
13	2	Grommet-Latch	5415314	2209593

REF	QTY	PART DESCRIPTION	P/N AVAILABLE SEPARATELY	AVAILABLE SERVICE KIT
14	2	Mount, Bracket	n/a	n/a
15	2	Hood Rack, Washer	n/a	2209593
16	2	Pin, Hood Rack Arm	5910404	2209593
17	1	Latch, Left	7082656	2209594
18	1	Latch, Right	7082657	2209594
19	2	Latch, Handle	7082903	2209594
20	2	Screw, M6 x 1.0 x 20 mm	7518529	n/a
21	4	Screw, Hex–Flange, M8 x 1.25 x 35 mm	n/a	2209594
22	2	Screw, Torx® Drive, Button Head, M5 x 0.8 x 12 mm	n/a	2209593 (QTY 2) 2209594 (QTY 2)
23	4	Screw, Torx® Drive, Button Head, M6 x 1.0 x 35 mm	7527947–35	2209594
24	2	Screw, Torx® Drive, Button Head, M8 x 1.25 x 20 mm	n/a	2209593
25	4	Nut, Hex–Flange, M6 x 1.0 mm	7548027	2209594
26	4	Nut, Hex–Flange, M8 x 1.25 mm	7548028	2209593 (QTY 2)
27	4	Washer, Flat, M6 x 14 x 1 mm	7557217	2209594

TOOLS REQUIRED

- Safety Glasses
- Cutting Tool
- Drill
- Drill Bit:
 - 5/8 Bit Size in (15.8 Bit Size mm)
- Hammer, Soft-Faced
- Pliers, Push Pin Rivet
- Socket Set, Metric
- Socket Set, Torx® Bit
- Torque Wrench

CONSUMABLES REQUIRED

- Grease, Polaris® All Season (or equivalent)

IMPORTANT

Your Front Upper Bumper and Hood Rack Kit is exclusively designed for your vehicle. Please read the installation instructions thoroughly before beginning. Installation is easier if the vehicle is clean and free of debris. For your safety, and to ensure a satisfactory installation, perform all installation steps correctly in the sequence shown.

INSTALLATION INSTRUCTIONS

VEHICLE PREPARATION

GENERAL

1. Park vehicle on a flat surface.
2. Shift vehicle into PARK.
3. Turn key to OFF position and remove key.

INNER HOOD REMOVAL

1. Rotate knob upwards.

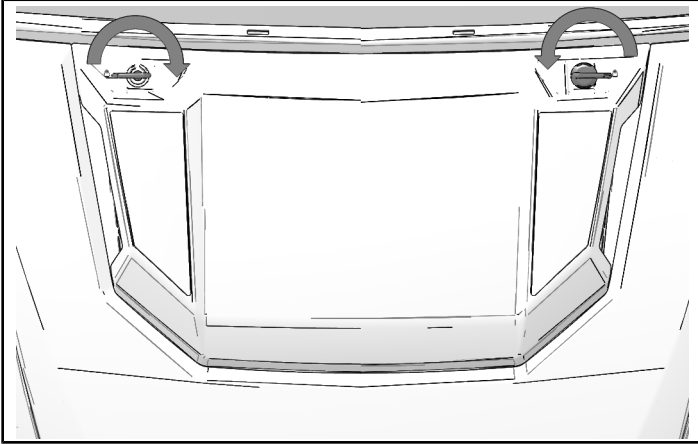

2. Remove hood forward to release front hooks.

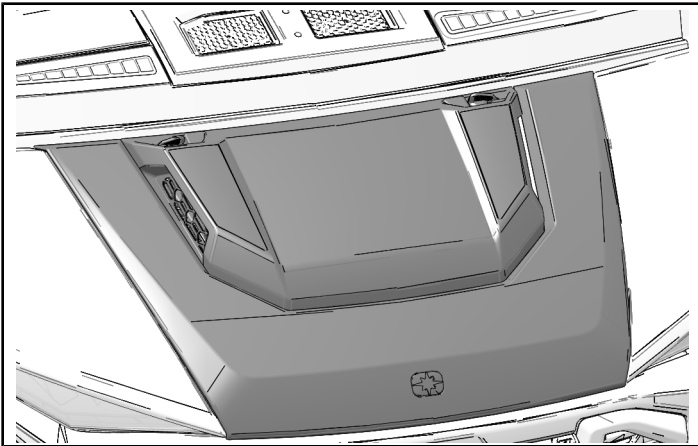

HOOD PREPARATION

1. Locate areas on underside of hood to trim.

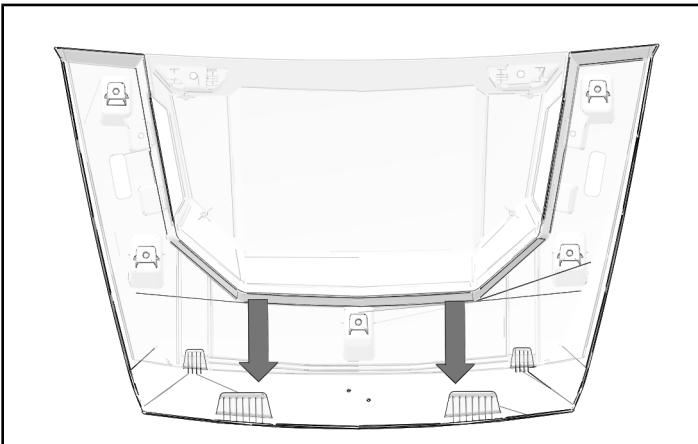

2. Using a cutting tool to trim areas as marked below.

NOTICE

Left side shown; right side similar.

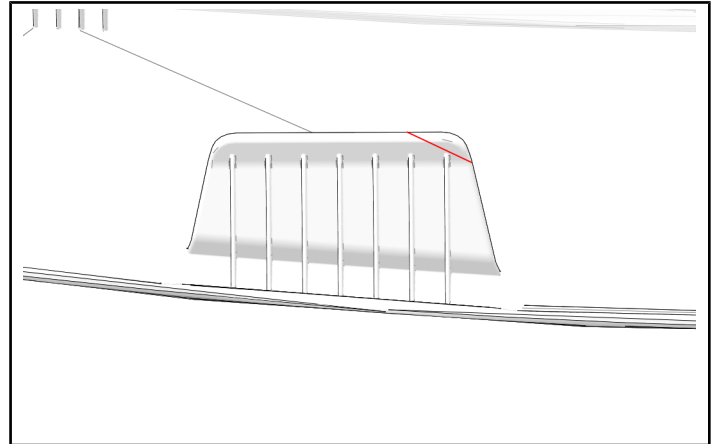

INNER HOOD INSTALLATION

1. Install inner hood onto front of vehicle. Turn knob outwards until it points towards the lock symbol.

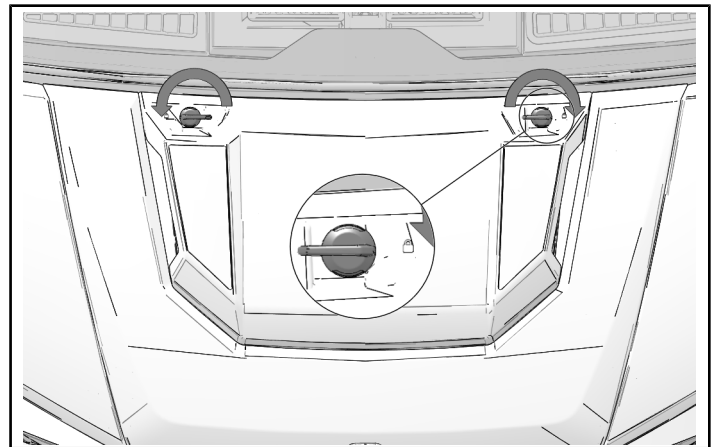

ACCESSORY INSTALLATION

FRONT BUMPER ASSEMBLY

1. Remove and discard eight screws and remove factory hoop.

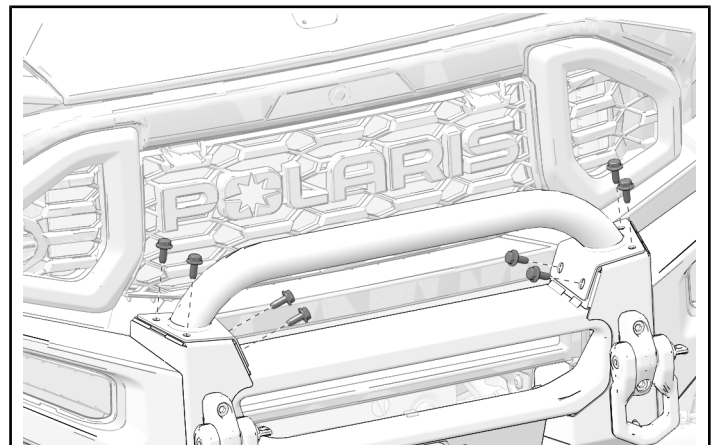

- Loosely attach middle bumper ③ to mounting point on the vehicle using six screws ⑦.

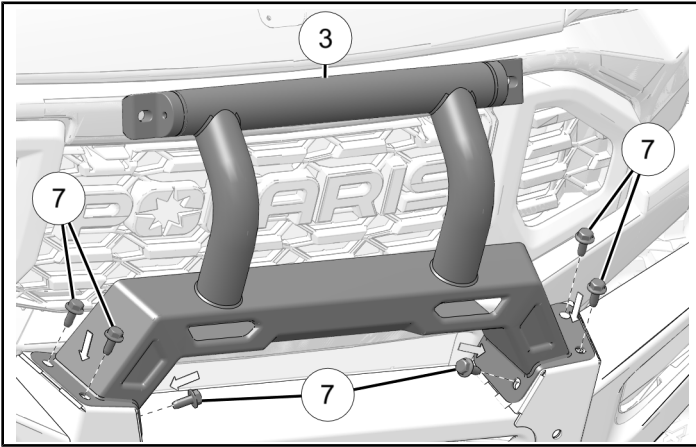

- Loosely attach left ① and right ② bumper pieces to middle bumper assembly using two screws ⑧.

NOTICE

Attach foam strips (1.1, 2.1) if bumper rubs against vehicle frame.

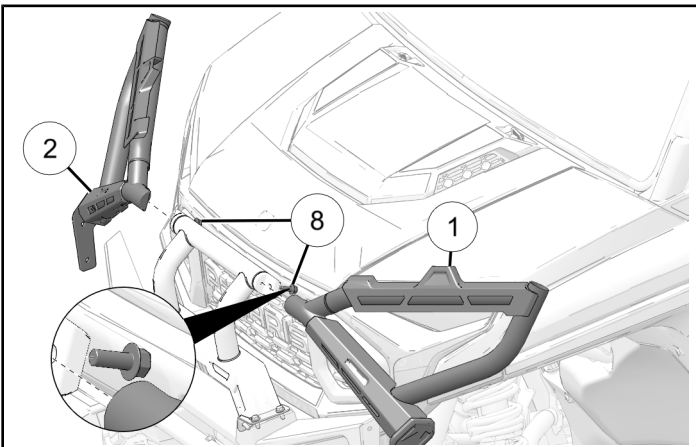

- Loosely attach bumper ① to frame of the vehicle using one bracket ④ and two screws ⑥.

NOTICE

Left side shown; right side similar.

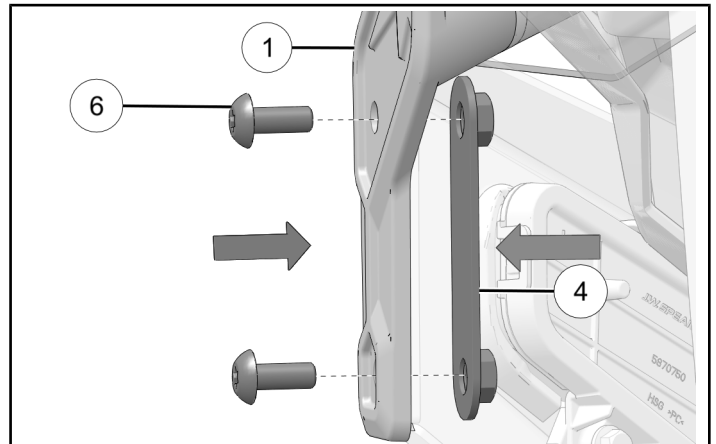
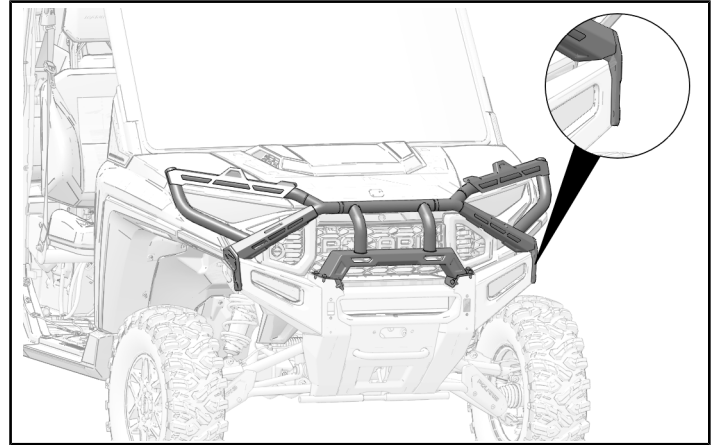

- Torque six lower middle bumper screws ⑦ to specification.

TORQUE

Lower Middle Bumper Screws ⑦:
39 ft-lbs (54 N·m)

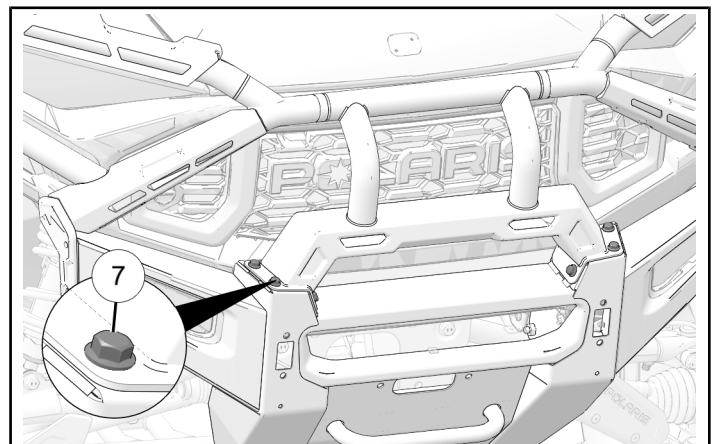

6. Torque two upper middle bumper screws ⑧ to specification.

TORQUE

Upper Middle Bumper Screws ⑧:
39 ft-lbs (54 N·m)

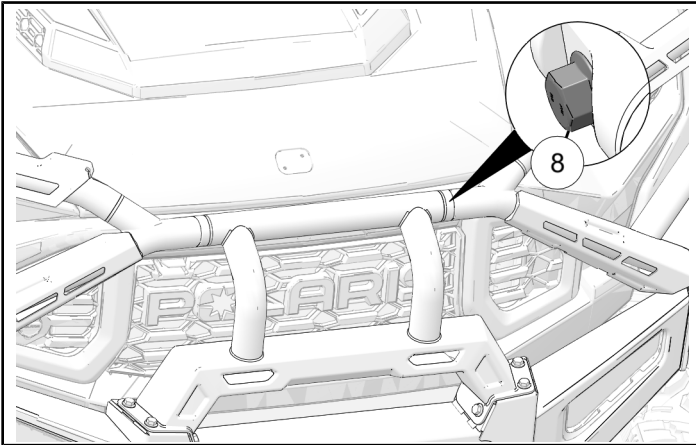

7. Torque two end bumper screws ⑥ to specification.

NOTICE

Left side shown; right side similar.

TORQUE

End Bumper Screws ⑥:
16 ft-lbs (22 N·m)

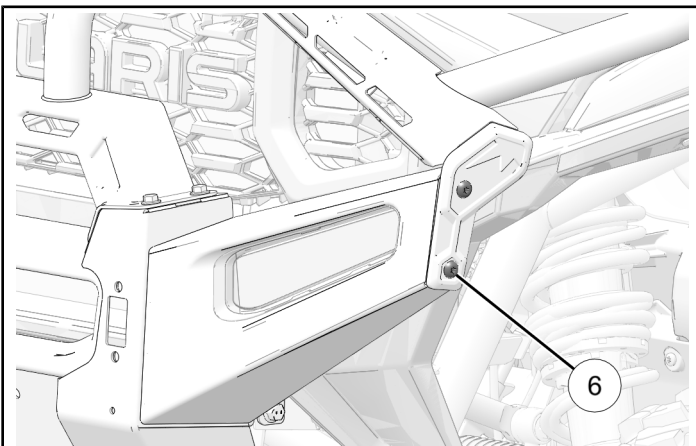

8. Attach end plug ⑤ to bumper assembly ① using a soft-faced hammer.

NOTICE

Left side shown; right side similar.

NOTICE

Do not install end plug if installing hood rack.

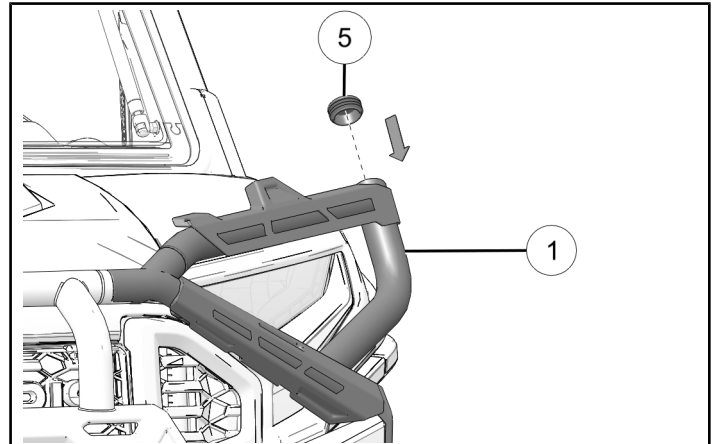

HOOD RACK INSTALLATION

A-PILLAR PREPARATION

1. Remove and keep two a-pillar push-pin rivets.

NOTICE

Right side shown; left side similar.

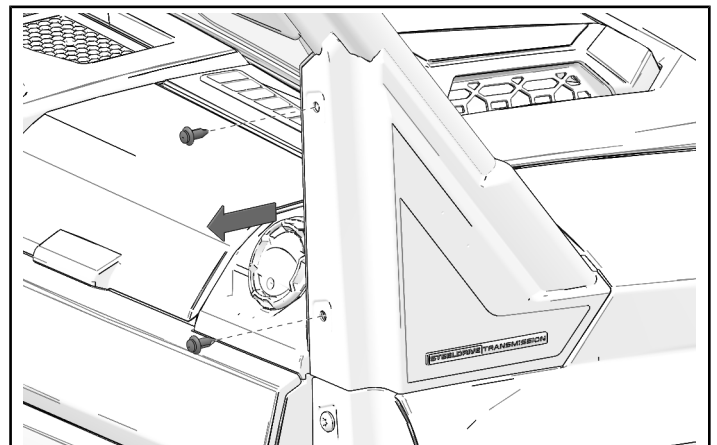

2. Remove and keep a-pillar panel.

NOTICE

Right side shown; left side similar.

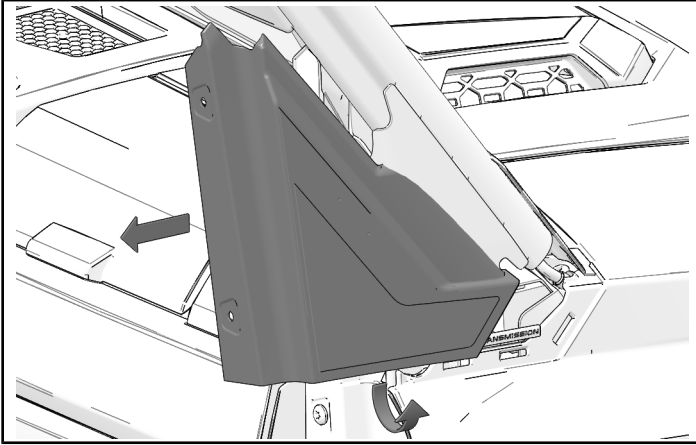

3. Find and mark two drilling point dimples on a-pillar panel.

NOTICE

Right side shown; left side similar.

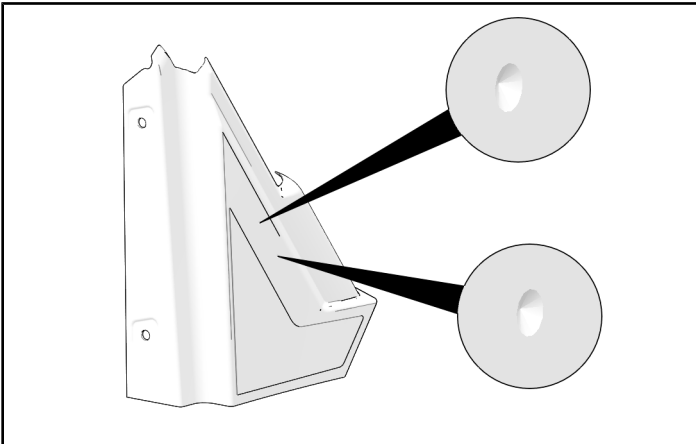

4. Drill two previously marked drilling points on a-pillar panel.

NOTICE

Right side shown; left side similar.

MEASUREMENT

Drill Bit Size: **5/8 inch (16 mm)**

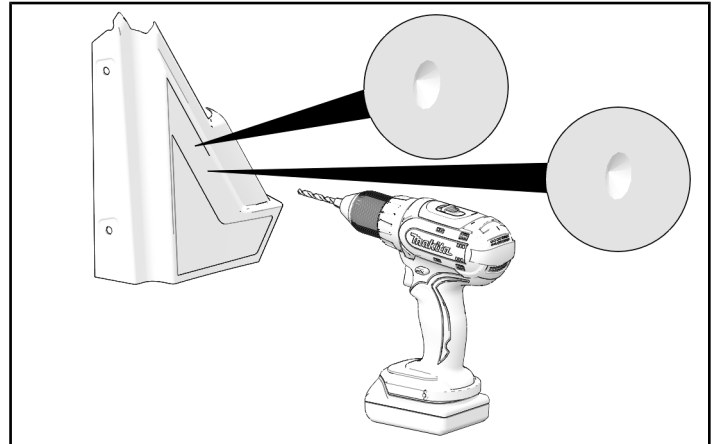

5. Loosely attach mount bracket ⑭ to vehicle frame using two screws ⑰.

NOTICE

Right side shown; left side similar.

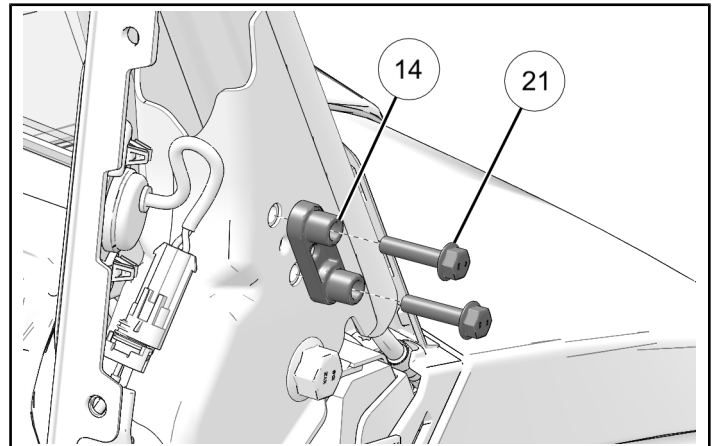

6. Attach mount bracket ⑭ to vehicle frame using screw ⑳.

NOTICE

Right side shown; left side similar.

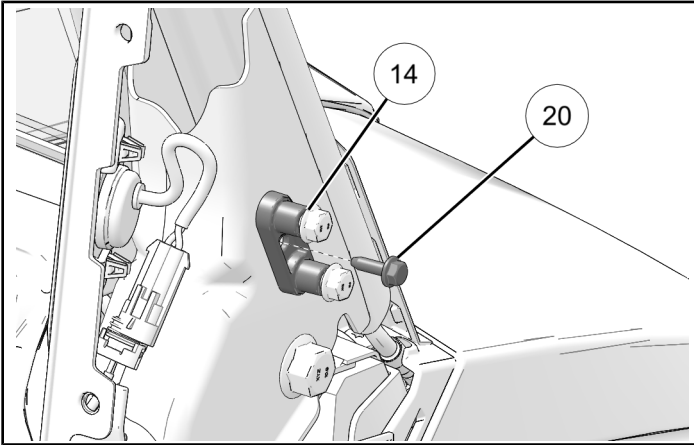

7. Tighten screw ⑳ until fully seated.

NOTICE

Right side shown; left side similar.

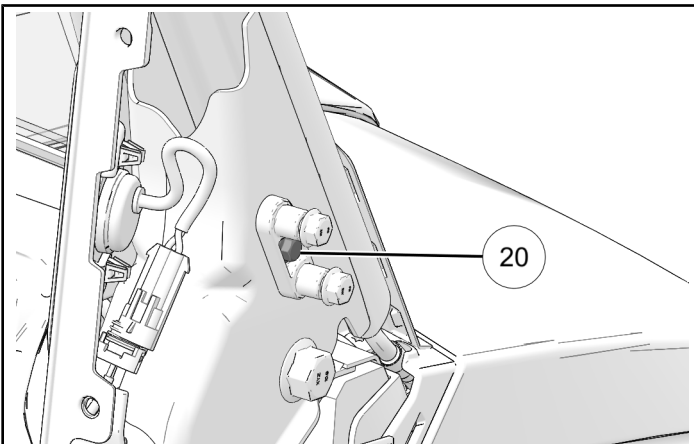

8. Remove and keep two screws ㉑.

NOTICE

Right side shown; left side similar.

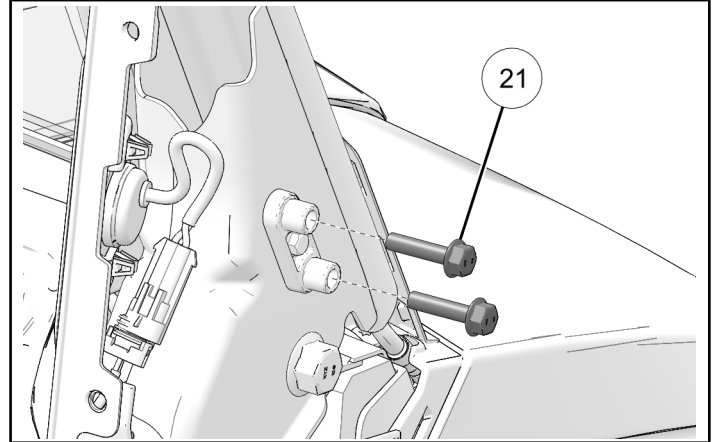

9. Install kept a-pillar panel to vehicle frame using two kept push-pin rivets.

NOTICE

Right side shown; left side similar.

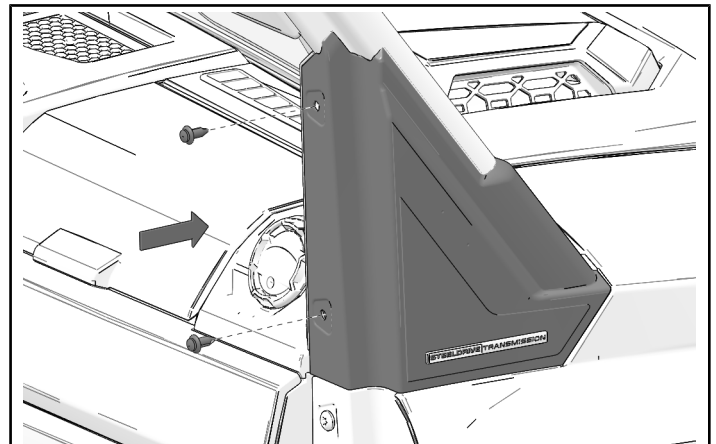

HOOD RACK LATCH ASSEMBLY

1. Put hood rack assembly on flat surface.
2. Loosely install latch **17** to hood rack assembly using two screws **23**, two washers **27**, and two nuts **25**.

NOTICE

Right side shown; left side similar.

DO NOT torque fasteners at this time.

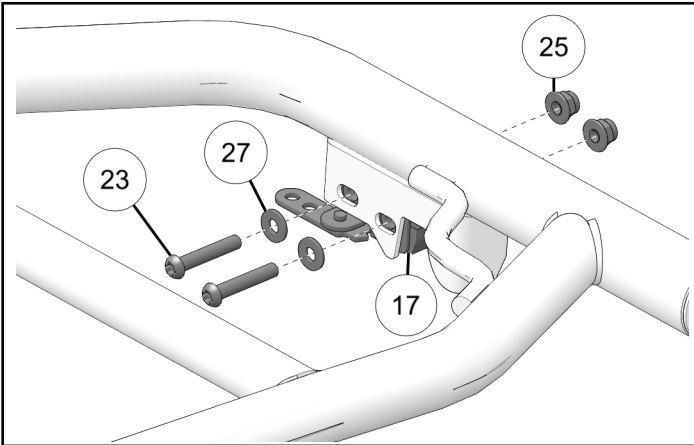

3. Install latch handle **19** to latch assembly using one screw **22**.

NOTICE

Right side shown; left side similar.

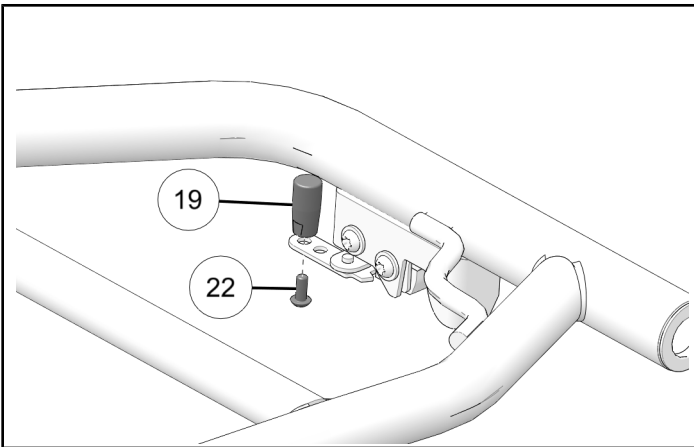

4. Torque screw **22** to specification.

NOTICE

Right side shown; left side similar.

TORQUE

Screw **22**:
106 in-lbs (12 N·m)

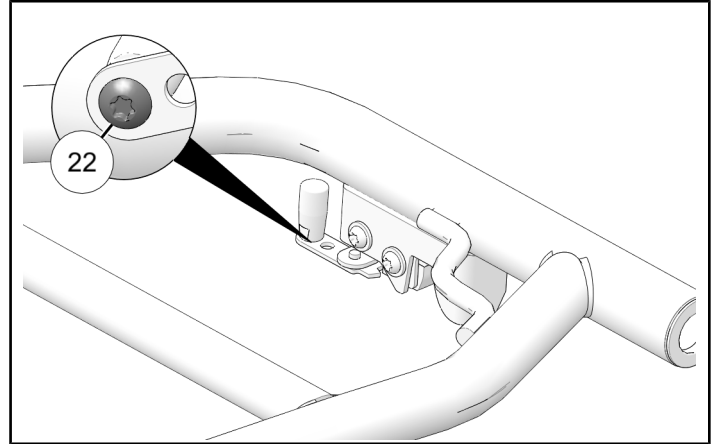

HOOD RACK INSTALLATION

1. If front bumper end caps **5** are installed, remove them.

NOTICE

Left side shown; right side similar.

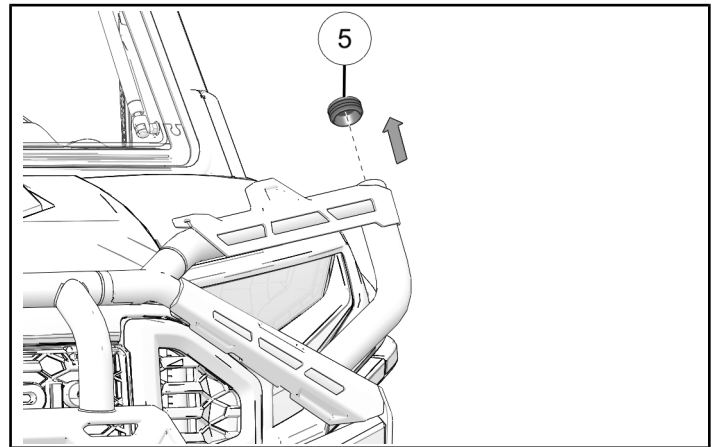

2. Attach hood rack arm to front bumper assembly using one screw (24) and one washer (15).

NOTICE

Right side shown; left side similar.

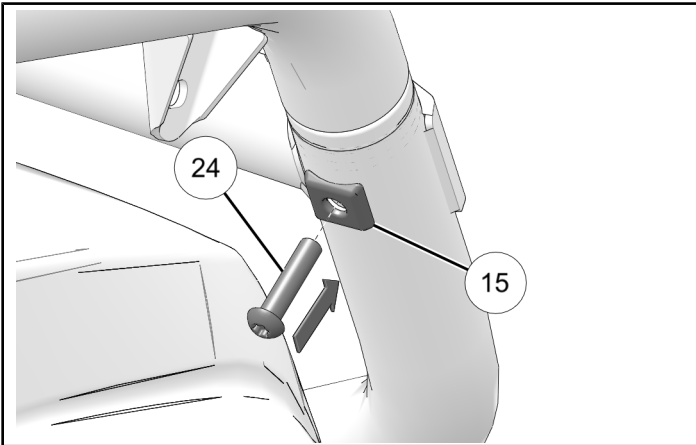

3. Attach hood rack arm (10) to a-pillar panel using two screws (21).

NOTICE

Right side shown; left side similar.

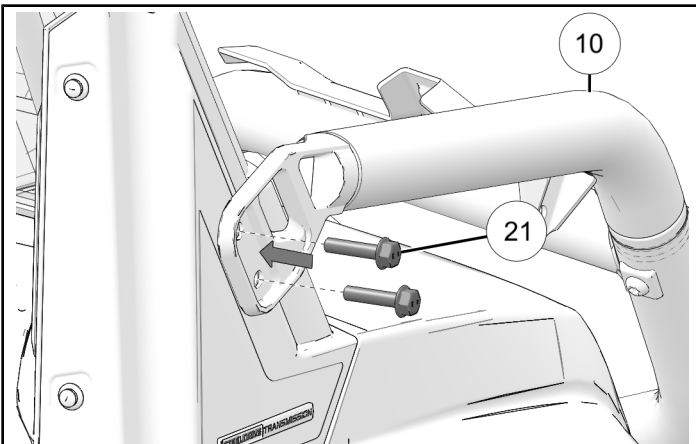

4. Torque two a-pillar screws (21) to specification.

NOTICE

Right side shown; left side similar.

TORQUE

A-Pillar Screws (21):
16 ft-lbs (22 N·m)

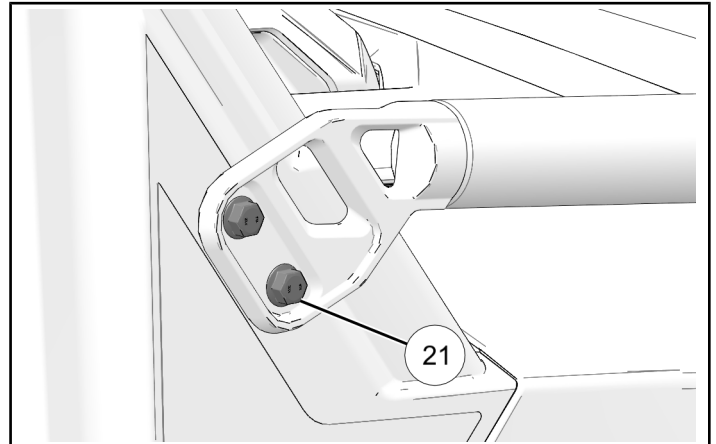

5. Torque screw (24) to specification.

NOTICE

Right side shown; left side similar.

TORQUE

Screw (24):
16 ft-lbs (22 N·m)

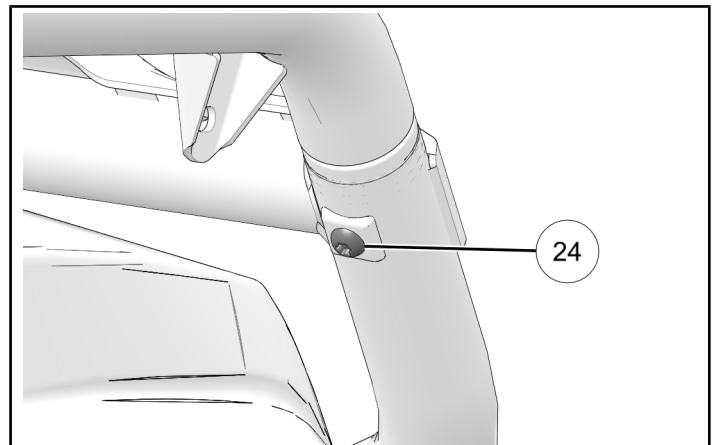

6. Install grommet ⑬ into the end of the hood rack assembly ⑪.

NOTICE

Right side shown; left side similar.

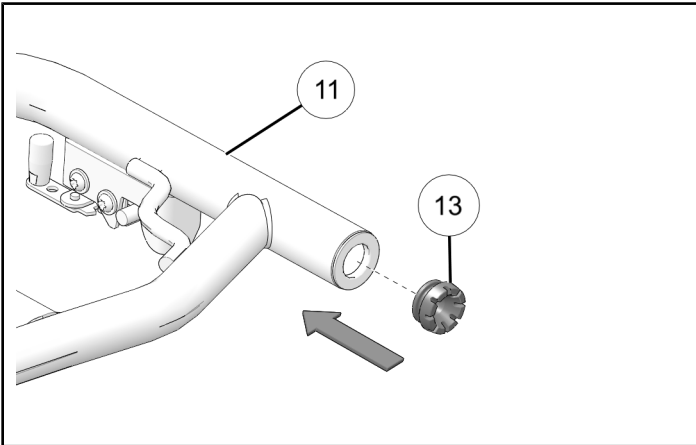

8. Loosely install latch pin ⑫ to hood rack assembly using one nut ⑳.

NOTICE

Right side shown; left side similar.

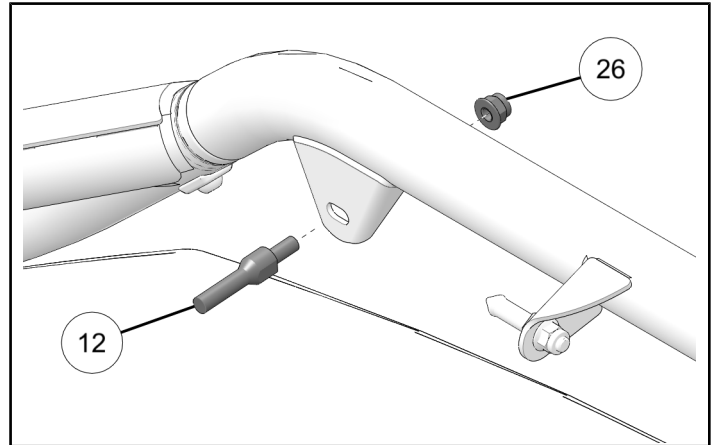

7. Loosely install hood rack arm pin ⑯ to hood rack assembly using one nut ⑳.

NOTICE

Right side shown; left side similar.

IMPORTANT

Apply a small amount of grease to hood rack arm pin ⑯ for easier removal of hood rack from pin.

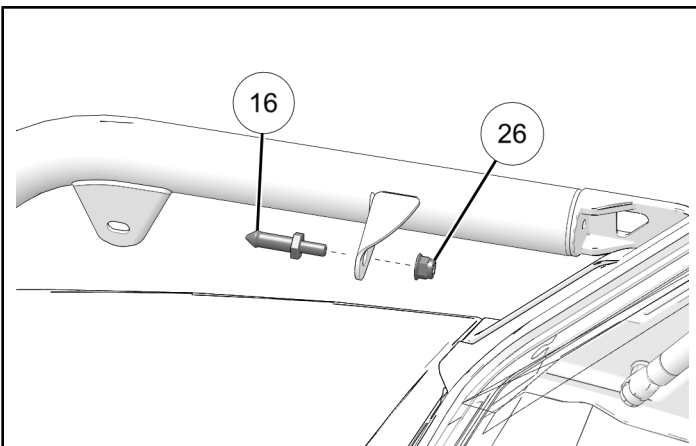

9. Install hood rack assembly ⑪ to hood rack arms by inserting hood rack arm pin ⑯ into grommet ⑬ and lowering assembly onto latch pin ⑫.

NOTICE

Right side shown; left side similar.

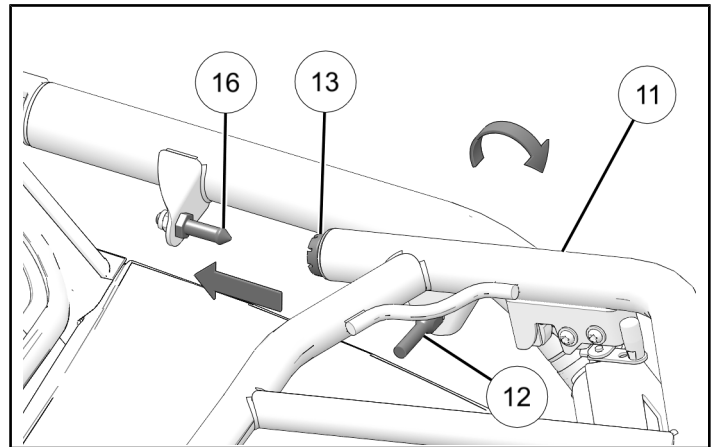

10. Adjust hood rack as necessary until it fits securely.

11. Torque nuts ②⑥ to specification.

NOTICE

Right side shown; left side similar.

TORQUE

Nuts ②⑥:
16 ft-lbs (22 N·m)

