

HIGHLIFTER BUMPER KIT



P/N 2884868-XXX

APPLICATION

Verify accessory fitment at www.polaris.com.

BEFORE YOU BEGIN

Read these instructions and check to be sure all parts and tools are accounted for. Please retain these installation instructions for future reference and parts ordering information.

KIT CONTENTS

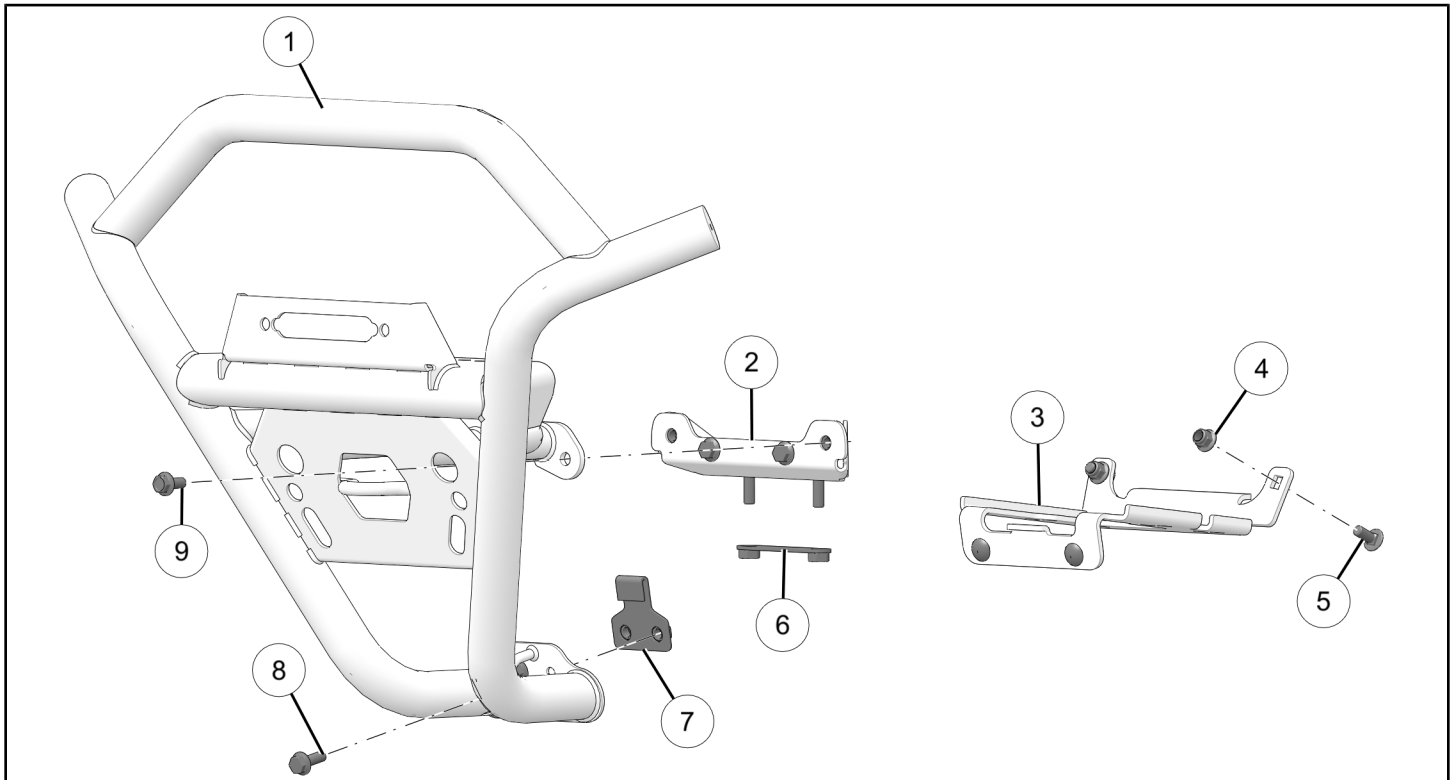

REF	QTY	PART DESCRIPTION	P/N AVAILABLE SEPARATELY
1	1	Weld-Front Bumper	1024689
2	1	Bracket-Front Bumper, Upper Support	n/a
3	1	Bracket-Winch Mount	5257962
4	6	Nut-Hex Flange, M10 x 1.5	7547313
5	4	Screw-Carriage Bolt, M10 x 1.5 x 25	7519372
6	1	Plate-Weldment	n/a
7	1	Plate-Backer, Lower	5260902
8	6	Screw-Hex Flange, M10 x 1.5 x 30	7519764
9	2	Screw-Hex Flange, M10 x 1.5 x 25	7518934

TOOLS REQUIRED

- Safety Glasses
- Socket Set, Metric
- Socket Set, Torx® Bit
- Torque Wrench

IMPORTANT

Your Highlifter Bumper Kit is exclusively designed for your vehicle. Please read the installation instructions thoroughly before beginning. Installation is easier if the vehicle is clean and free of debris. For your safety, and to ensure a satisfactory installation, perform all installation steps correctly in the sequence shown.

INSTALLATION INSTRUCTIONS

VEHICLE PREPARATION

GENERAL

1. Shift vehicle transmission into PARK.
2. Turn key to OFF position and remove from vehicle.

GRILLE REMOVAL

1. Carefully push down on two tabs to disengage grille from front fascia. Tilt top outward to remove from vehicle.

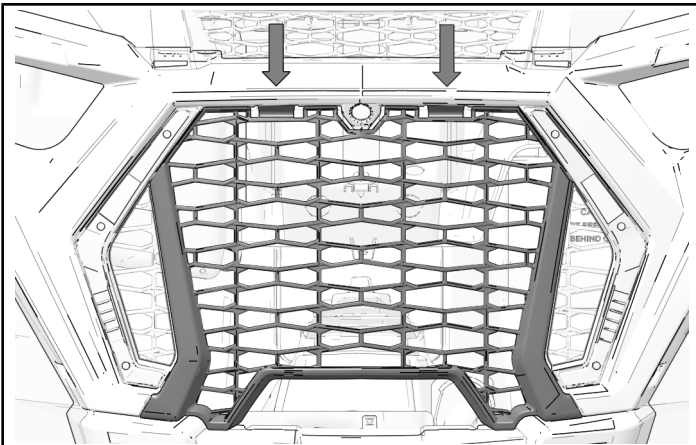

ACCESSORY INSTALLATION

WINCH MOUNT INSTALLATION

IMPORTANT

Winch mount installation is required to maintain vehicle chassis strength when winch is mounted on bumper.

Installed view of winch mount ③.

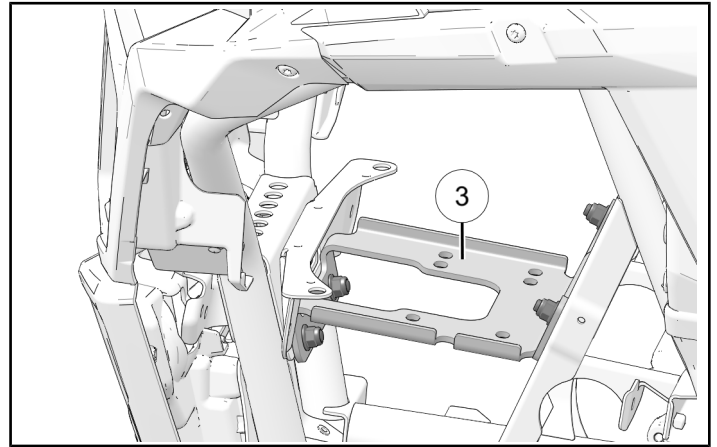

1. Install winch mount ③ on chassis, between front suspension.

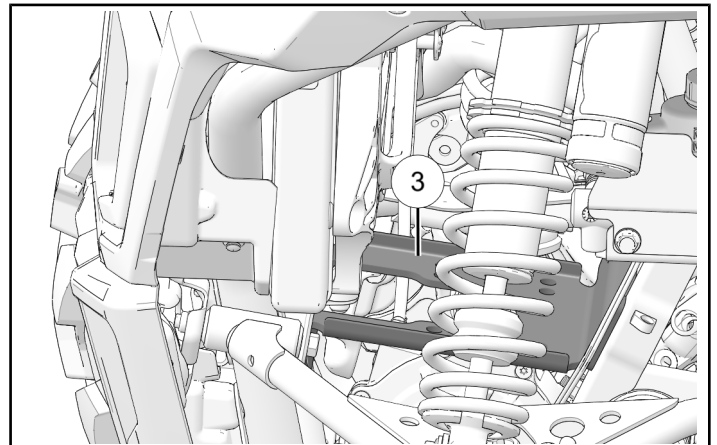

2. Install rear of winch mount with two carriage bolts ⑤ and two nuts ④.

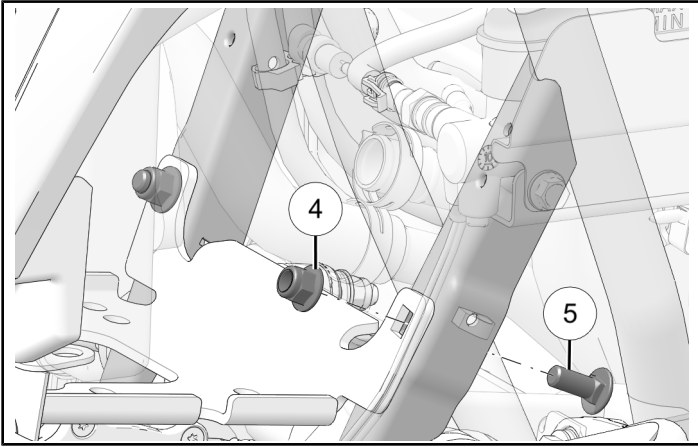

3. Install front of winch mount with two carriage bolts ⑤ and two nuts ④.

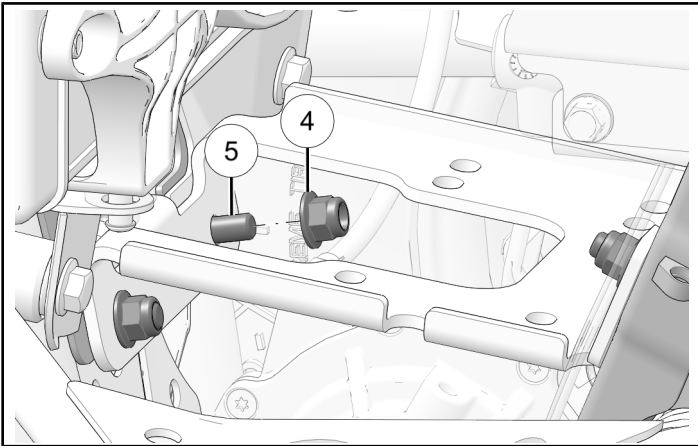

4. Torque four nuts to specification.

TORQUE

Nuts ④:
20 ft-lbs (27 N·m)

FRONT BUMPER INSTALLATION

1. Remove and retain two fasteners to remove front winch cover.

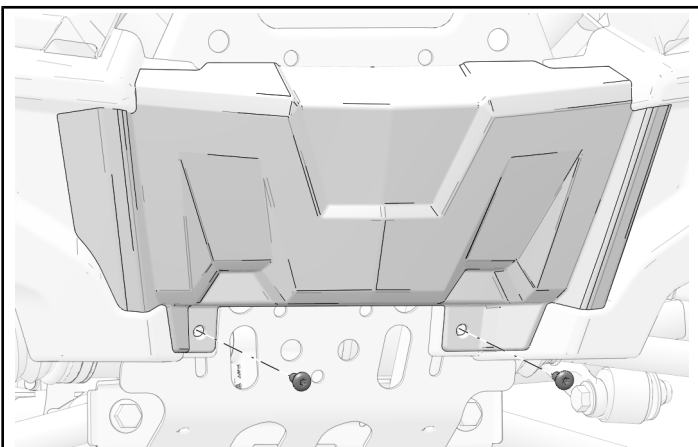

2. Place support bracket ② onto front suspension mount. Pass two fasteners ⑧ through bracket and mount.

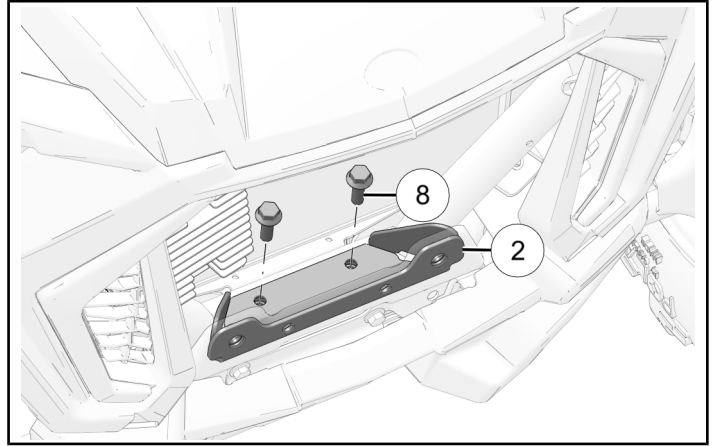

3. Pass nut-plate ⑥ through front suspension mount and align with fasteners installed in previous step.

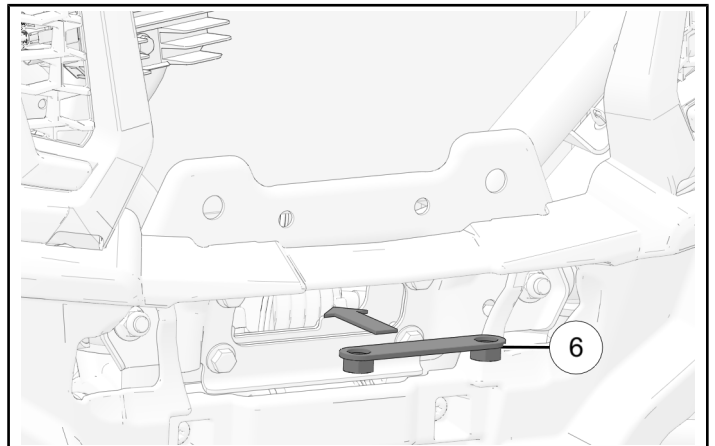

4. Thread two fasteners ⑧ into weld nuts ⑥.

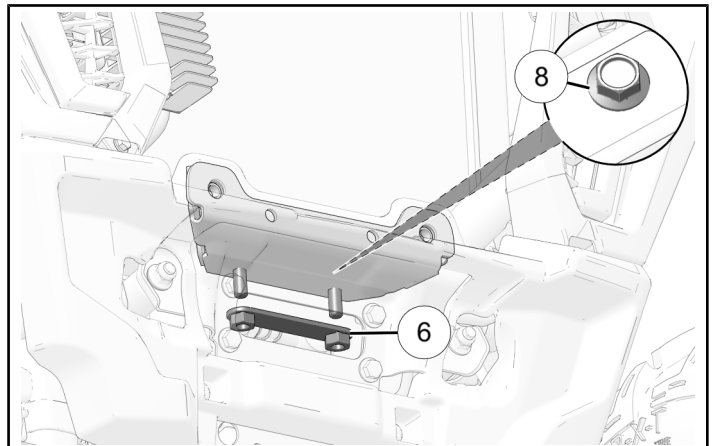

5. Install front of support bracket with two fasteners ⑧ and two nuts ④.

TORQUE

Support Mount Fasteners ⑧:
30 ft-lbs (40 N·m)

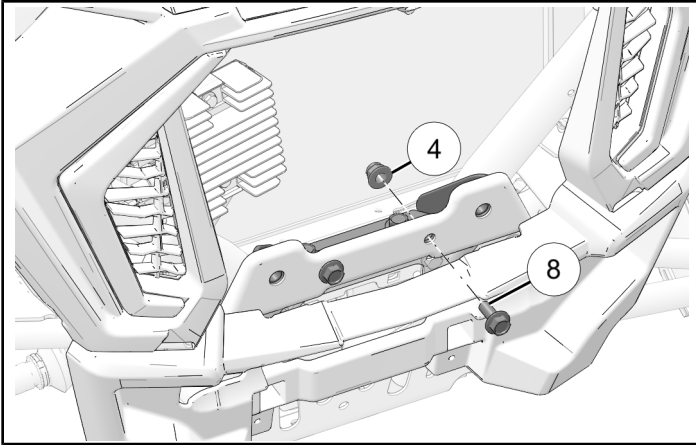

6. Torque two fasteners ⑧ to specification.

TORQUE

Support Mount Fasteners ⑧:
30 ft-lbs (40 N·m)

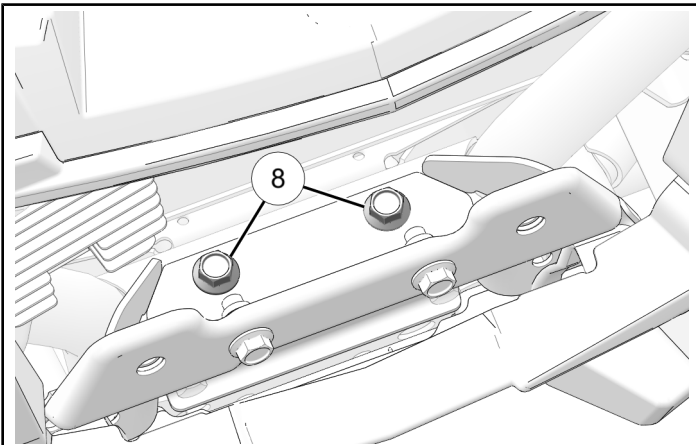

7. Carefully reach through wheel well and hook backer plate ⑦ onto bumper support.

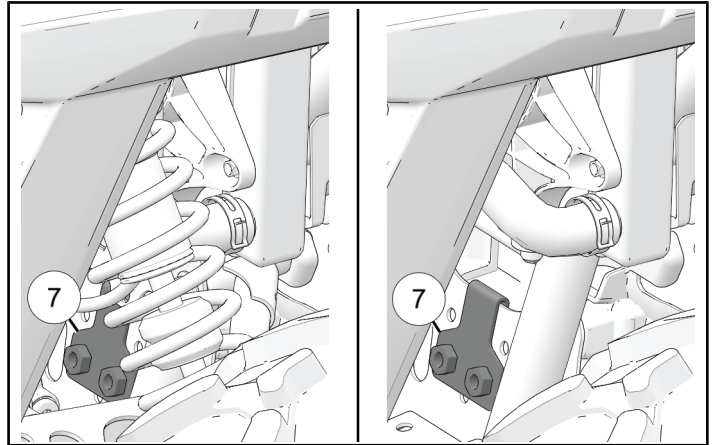

8. Make sure backer plate is aligned with holes in bumper support.

TIP

Tape hook of backer plate to bumper support to prevent movement when installing bumper.

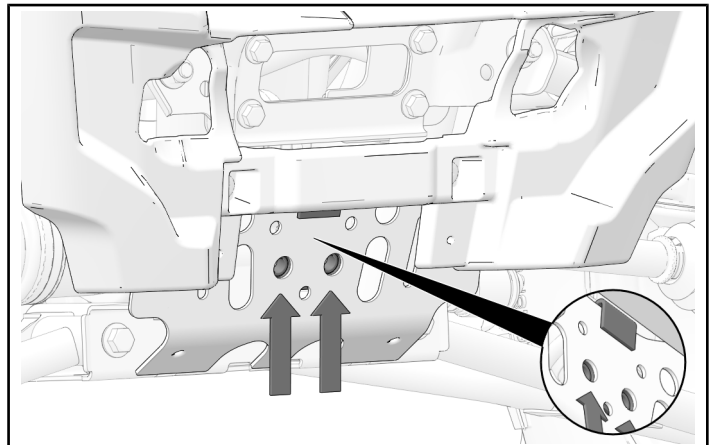

9. Reinstall winch cover with two retained fasteners.

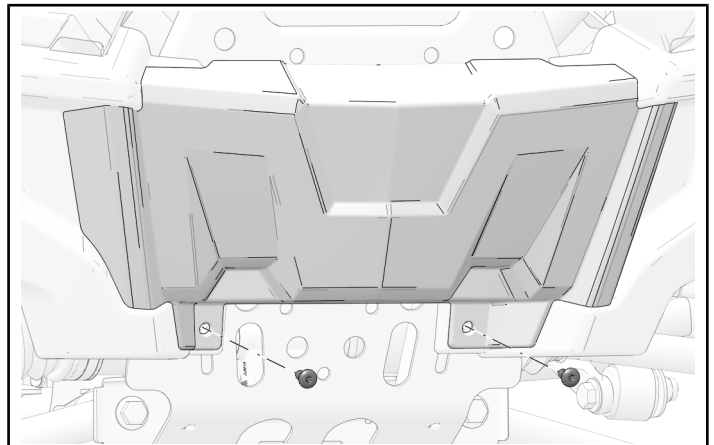

10. Align bumper ① with upper and lower mounts.

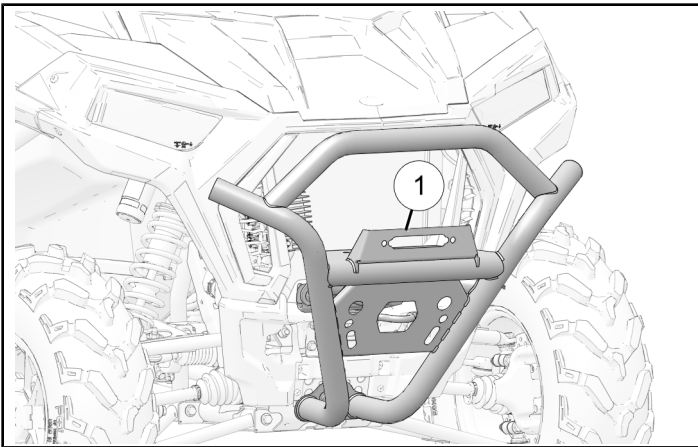

11. Install two fasteners ⑨ through bumper and into bumper support bracket.

Do not torque fasteners at this time.

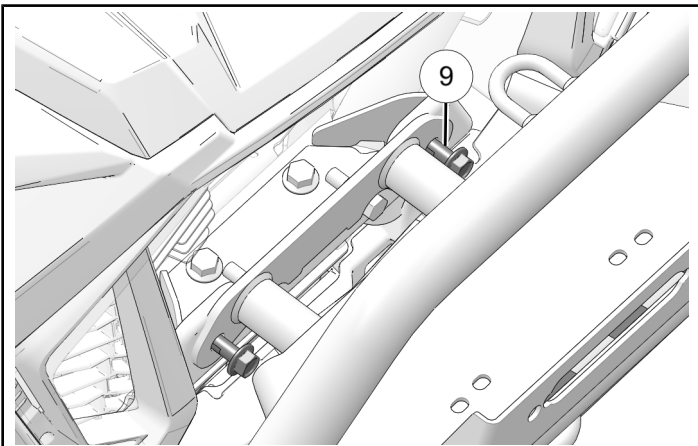

12. Secure lower bumper with two fasteners ⑧.

TORQUE

Lower Bumper Fasteners ⑧:
30 ft-lbs (40 N·m)

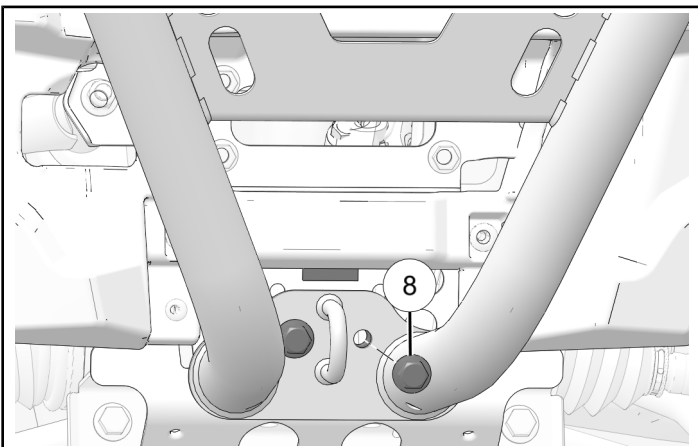

13. Torque two upper bumper fasteners ⑨ to specification.

TORQUE

Upper Bumper Fasteners ⑨:
30 ft-lbs (40 N·m)

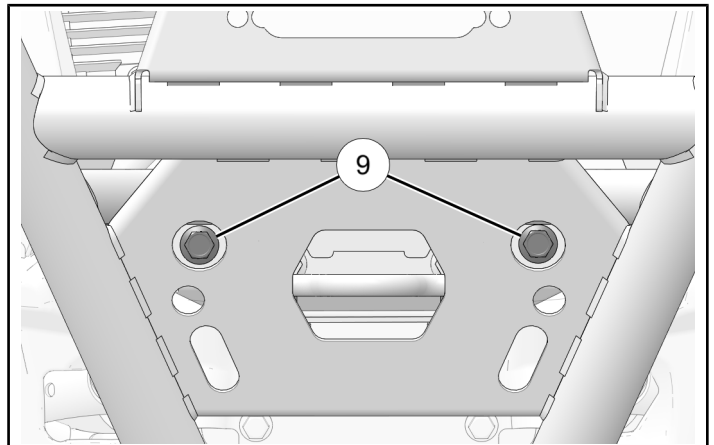

VEHICLE REASSEMBLY

GENERAL

1. Reinstall front grille.

INSTRUCTION FEEDBACK FORM

A feedback form has been created for the installer to provide any comments, questions or concerns about the installation instructions. The form is viewable on mobile devices by scanning the QR code or by clicking [HERE](#) if viewing on a PC.

