

GLASS WINDSHIELD KIT



P/N 2884756

APPLICATION

Verify accessory fitment at www.polaris.com.

BEFORE YOU BEGIN

Read these instructions and check to be sure all parts and tools are accounted for. Please retain these installation instructions for future reference and parts ordering information.

KIT CONTENTS

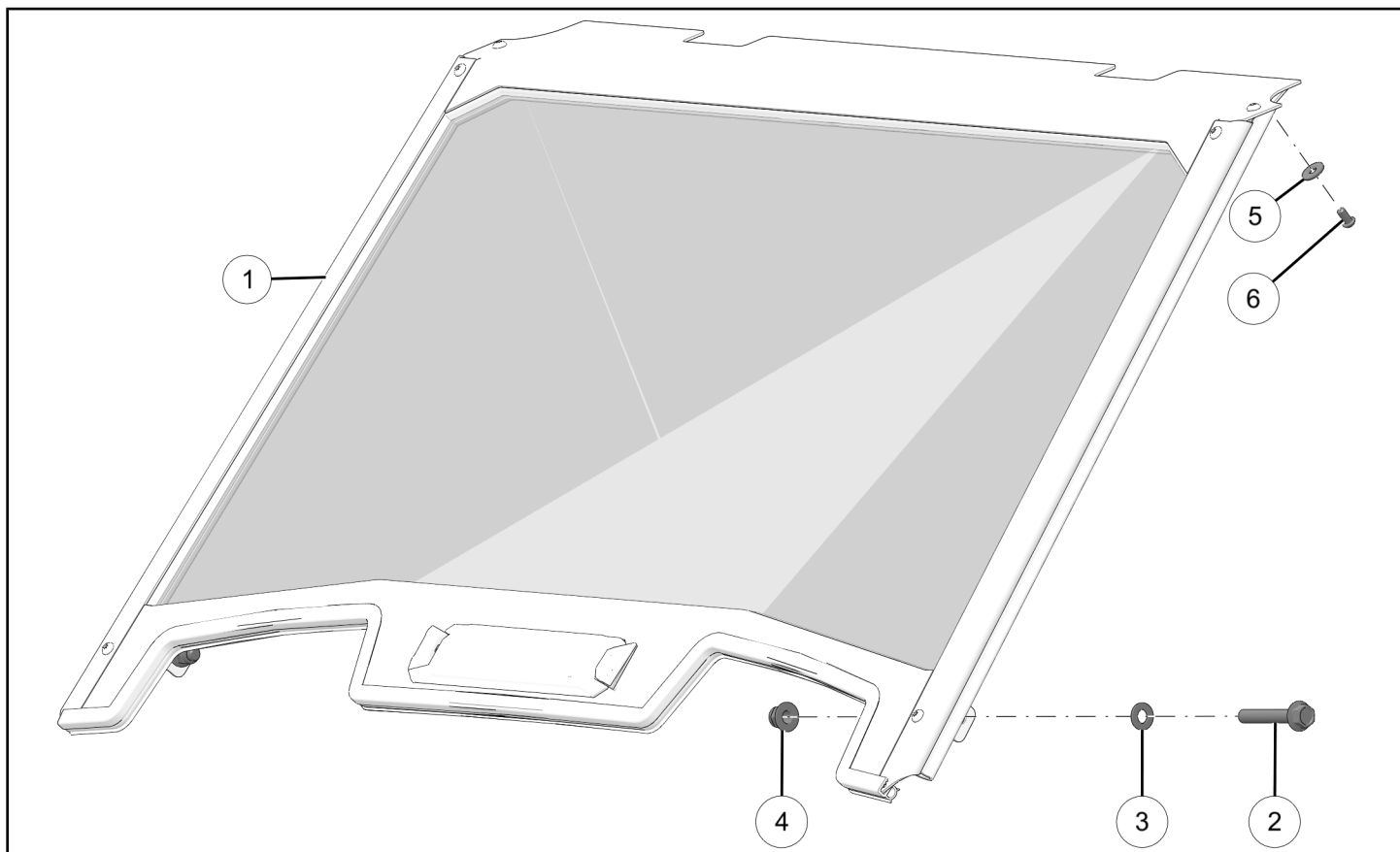

REF	QTY	PART DESCRIPTION	P/N AVAILABLE SEPARATELY	AVAILABLE SERVICE KIT
1	1	Assembly–Windshield, Glass	2638019	n/a
2	2	Screw–Hex Flange, M10 x 1.5 mm x 65 mm	n/a	2208458
3	2	Washer–10.5 mm x 20.0 mm	n/a	2208458
4	2	Nut–Hex Flange, M10 x 1.5 mm	n/a	2208458
5	2	Washer–6.4 mm x 18 mm	n/a	2208458
6	2	Screw–Torx® Button Head, M6 x 1.0 x 12	n/a	2208458

TOOLS REQUIRED

- Safety Glasses
- Socket Set, Metric
- Socket Set, Torx® Bit
- Torque Wrench
- Wrench Set, Metric

IMPORTANT

Your Glass Windshield Kit is exclusively designed for your vehicle. Please read the installation instructions thoroughly before beginning. Installation is easier if the vehicle is clean and free of debris. For your safety, and to ensure a satisfactory installation, perform all installation steps correctly in the sequence shown.

INSTALLATION INSTRUCTIONS

VEHICLE PREPARATION

GENERAL

1. Shift vehicle transmission into PARK. Turn key to OFF position and remove from vehicle.

ACCESSORY INSTALLATION

1. Remove and discard top fastener from right and left A-pillar. Retain nut for accessory installation.

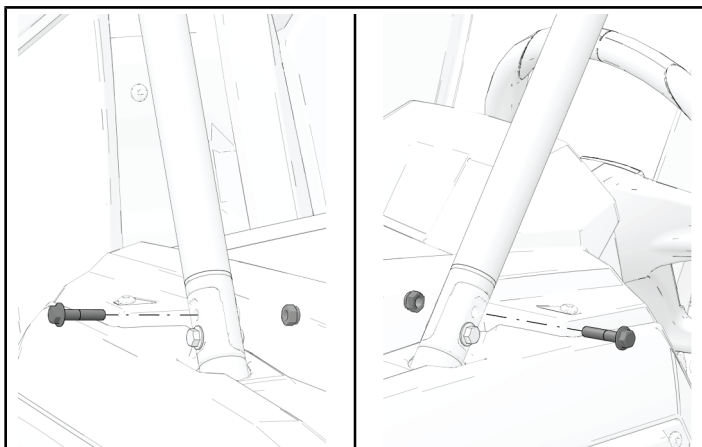

2. Insert accessory fastener ② and partially thread into accessory nut ④. Do not thread fastener past nut.

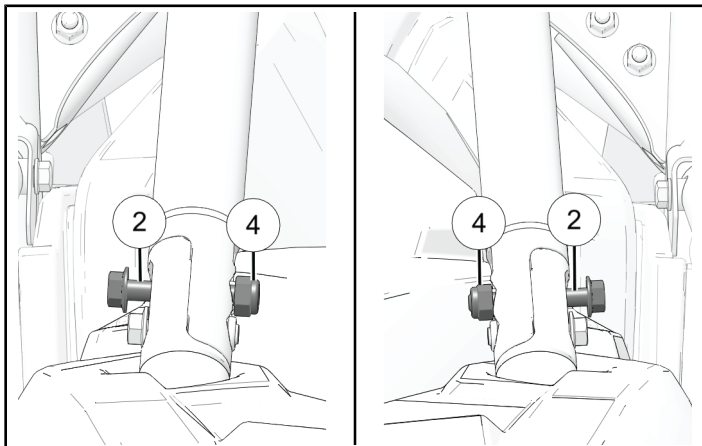

3. With an assistant, lean windshield assembly against vehicle ROPS.

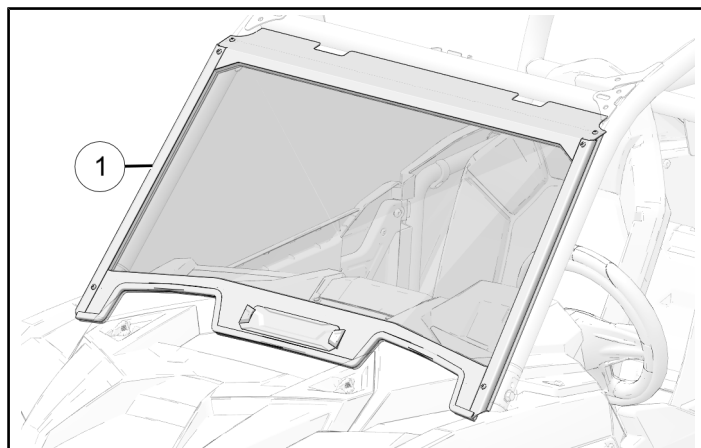

4. Continue to thread fastener ② through accessory nut and into lower mounting bracket. Begin to thread retained nut onto end of fastener ②.

TIP

Use washer ③ between windshield bracket and accessory nut if windshield fitment is loose.

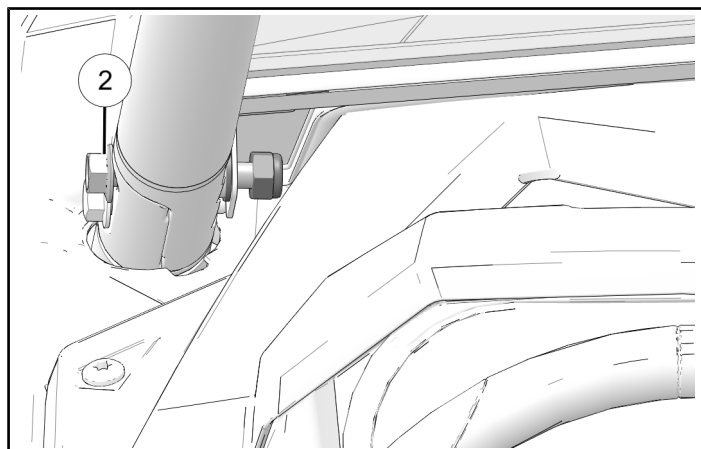

5. Continue to thread fastener ② through accessory nut and into lower mounting bracket. Begin to thread retained nut onto end of fastener ②.

TIP

Use washer ③ between windshield bracket and accessory nut if windshield fitment is loose.

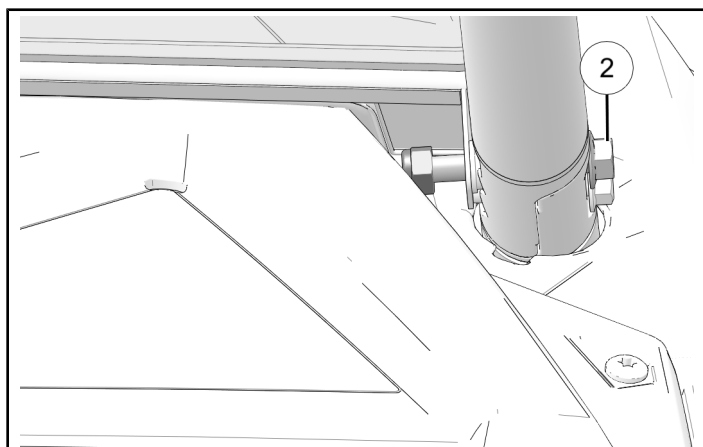

6. Torque two lower mounting fasteners ② to specification. Retained nuts will be tightened at a later time.

⚠ WARNING

Failure to torque fasteners as directed will adversely affect ROPS integrity and may lead to severe injury or death in an accident.

TORQUE

Lower Mounting Fasteners ②:
40 ft-lbs (54 N·m)

7. Secure top of windshield assembly to ROPS brackets with two fasteners ⑤ and two washers ⑥.

TORQUE

Upper Fasteners ⑥:
9 ft-lbs (12 N·m)

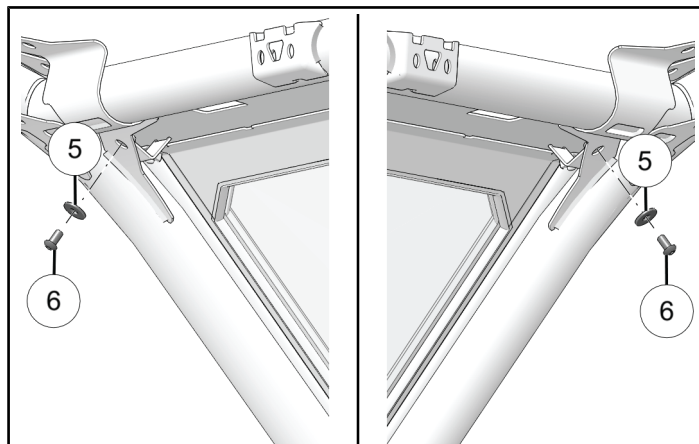

8. Tighten two retained nuts.

NOTICE

Ensure nuts are fully tightened for proper windshield fitment. Access to nuts may be difficult.

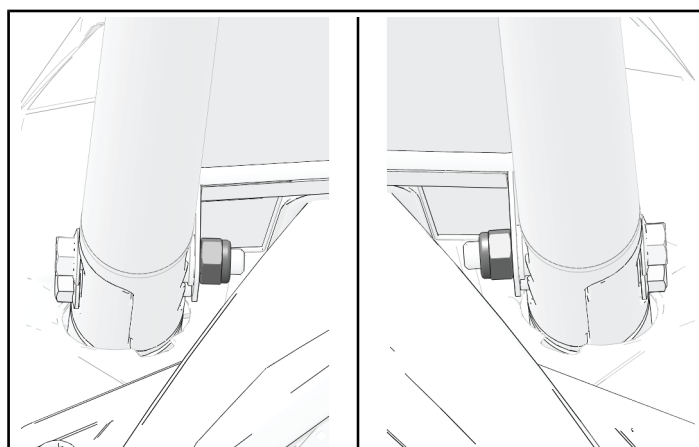

FEEDBACK FORM

A feedback form has been created for the installer to provide any comments, questions or concerns about the installation instructions. The form is viewable on mobile devices by scanning the QR code or by clicking [HERE](#) if viewing on a PC.

