

ALUMINUM ROOF KIT



P/N 2884325-XXX

BEFORE YOU BEGIN

Read these instructions and check to be sure all parts and tools are accounted for. Please retain these installation instructions for future reference and parts ordering information.

APPLICATION

Verify accessory fitment at www.polaris.com.

ACCESSORY WEIGHT

Accessories, passengers, and other factors may negatively affect ride performance. Refer to your vehicle's owner's manual for maximum weight capacity and suspension adjustment procedures.

KIT CONTENTS

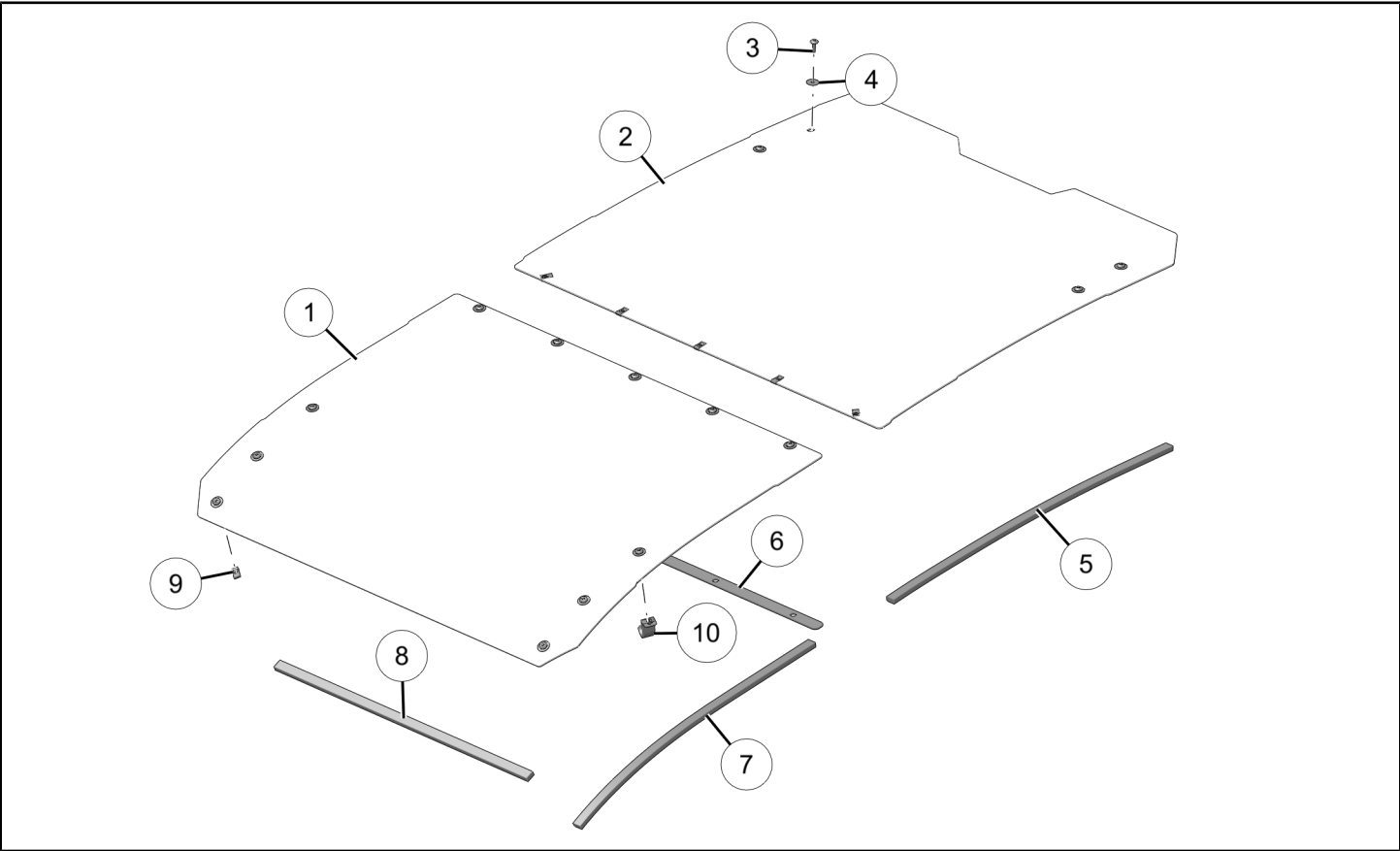

NOTICE				
XXX = Polaris® color code (For example: 458 = Black)				

REF	QTY	PART DESCRIPTION	P/N AVAILABLE SEPARATELY	AVAILABLE SERVICE KIT
1	1	Panel–Main Roof, Aluminum, Front	n/a	n/a
2	1	Panel–Main Roof, Aluminum, Rear	n/a	n/a
3	15	Screw–Torx® Truss Head, M6 x 1.0 x 25 mm	n/a	2208197

REF	QTY	PART DESCRIPTION	P/N AVAILABLE SEPARATELY	AVAILABLE SERVICE KIT
4	15	Washer– 0.281 x 1.00 x 0.051 in	n/a	2208197
5	2	Foam–20 x 10.5 x 844 mm	n/a	n/a
6	1	Tape–Foam, Roof Seal	n/a	n/a
7	2	Foam–20 x 10.5 x 724 mm	n/a	n/a
8	3	Foam–20 x 10.5 x 693 mm	n/a	n/a
9	15	Clip–U, Speed Nut	n/a	2208197
10	2	Bracket–Tube Hook	5271245	n/a

TOOLS REQUIRED

- Safety Glasses
- Screwdriver Set, Torx®
- Socket Set, Torx® Bit
- Torque Wrench

IMPORTANT

Your Aluminum Roof Kit is exclusively designed for your vehicle. Please read the installation instructions thoroughly before beginning. Installation is easier if the vehicle is clean and free of debris. For your safety, and to ensure a satisfactory installation, perform all installation steps correctly in the sequence shown.

INSTALLATION INSTRUCTIONS

VEHICLE PREPARATION

GENERAL

1. Shift vehicle transmission into PARK.
2. Turn key to OFF position and remove from vehicle.

ACCESSORY INSTALLATION

1. Install three U-nuts ⑨ onto rear roof panel.

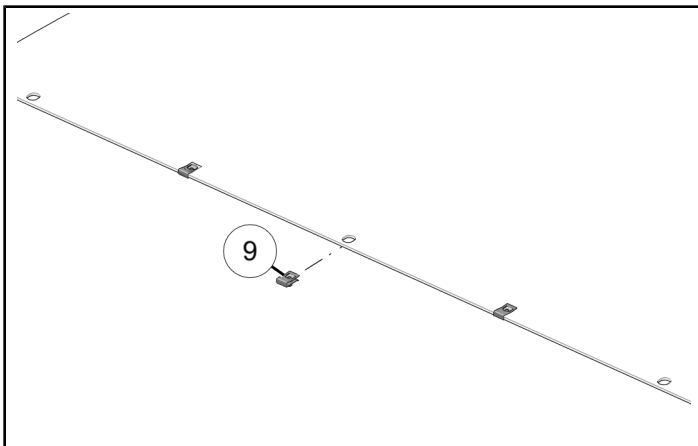

2. Install six U-nuts ⑨ onto middle and rear ROPS brackets.

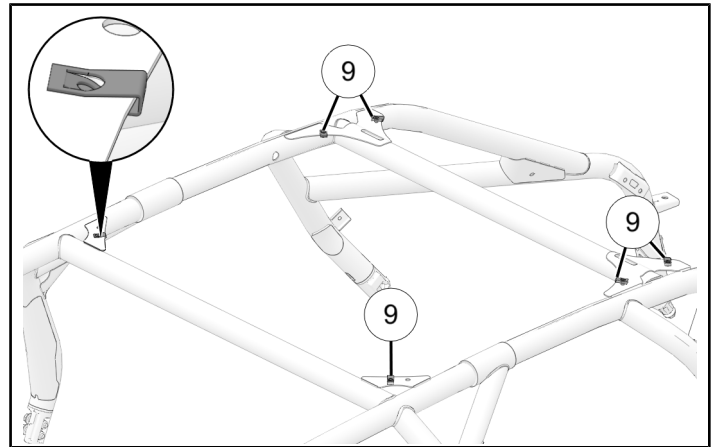

3. Install four U-nuts ⑨ onto front ROPS brackets.

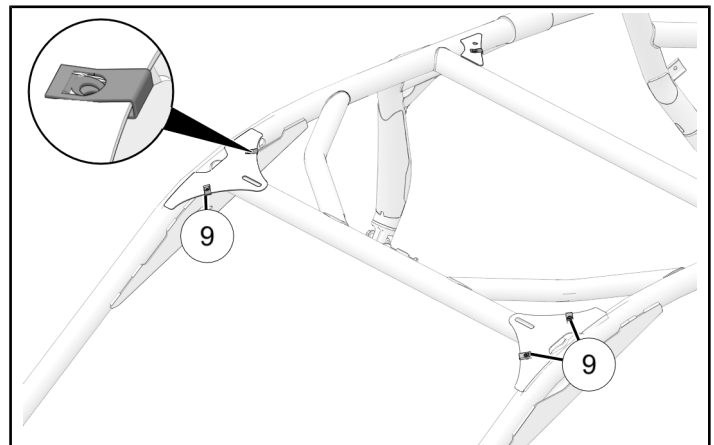

4. Install rear roof panel ② with four fasteners ③ and four washers ④. Hand-tighten fasteners.

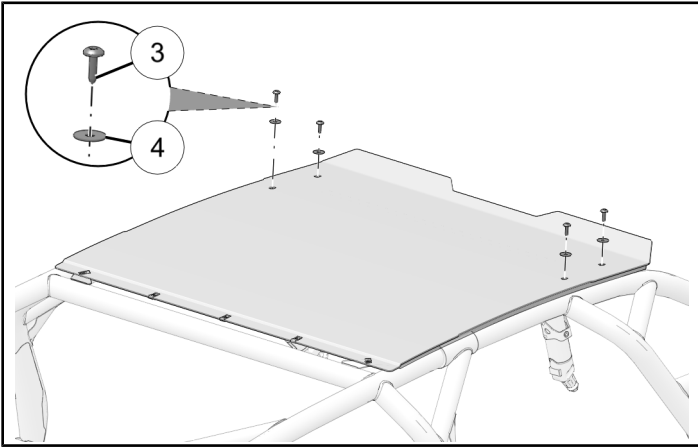

5. Install front roof panel ① with four fasteners ③ and four washers ④.

TORQUE

Roof Fasteners ③:
11 ft-lbs (15 N·m)

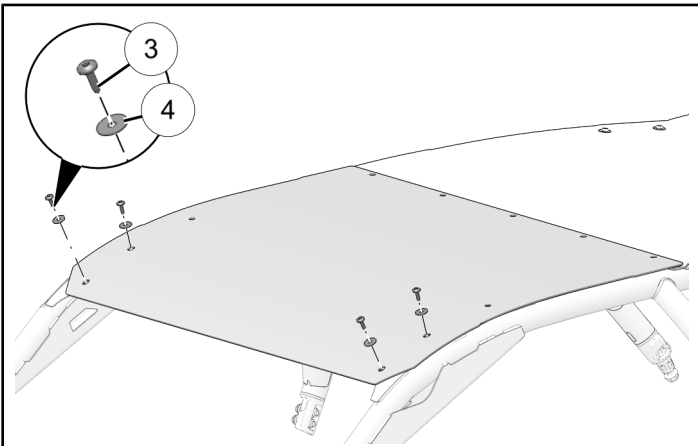

6. With front of roof panel secure to ROPS, begin to slowly pull roof panel back so that it molds to the curvature of the ROPS.

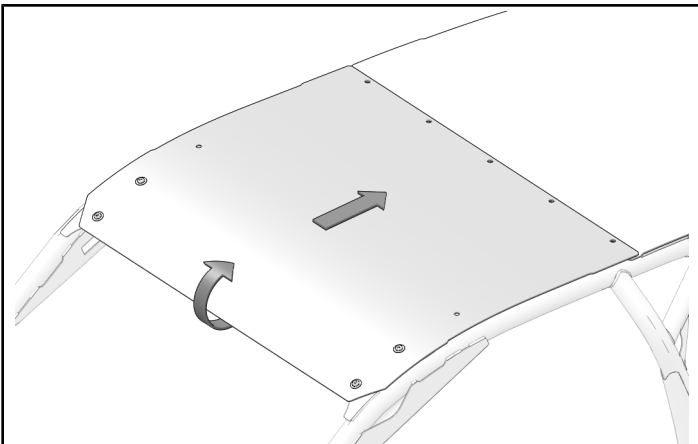

7. Install front roof panel to rear roof panel and middle ROPS brackets with five fasteners ③ and five washers ④.

TORQUE

Roof Fasteners ③:
11 ft-lbs (15 N·m)

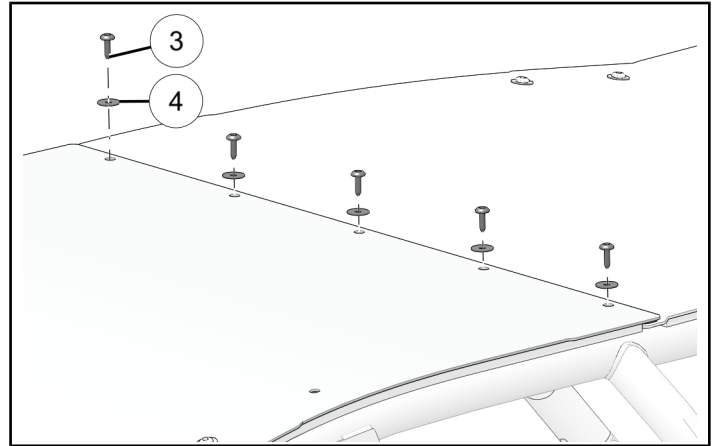

8. Install one U-nut ⑨ onto each bracket ⑩.

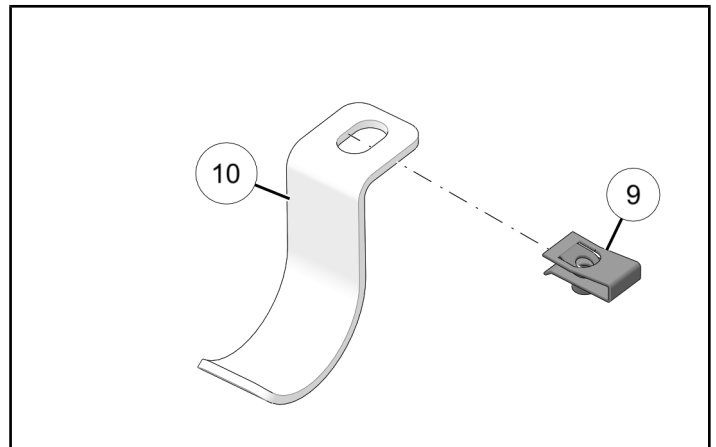

9. Install each tube hook bracket ⑩ with one fastener ③ and one washer ④.

TORQUE

Roof Fasteners ③:
11 ft-lbs (15 N·m)

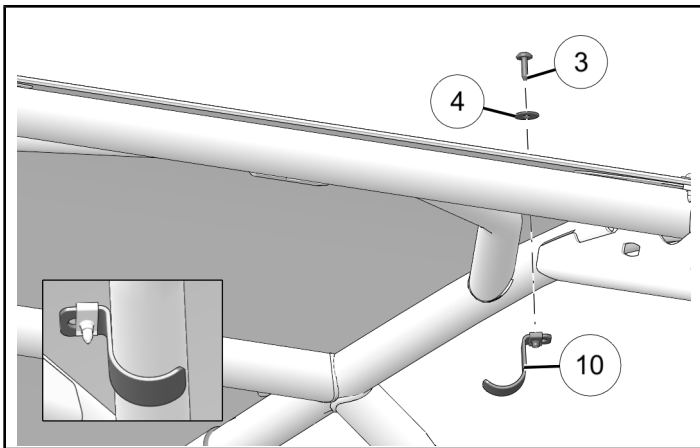

10. Torque rear roof fasteners to specification.

TORQUE

Roof Fasteners ③:
11 ft-lbs (15 N·m)

INSTRUCTION FEEDBACK FORM

A feedback form has been created for the installer to provide any comments, questions or concerns about the installation instructions. The form is viewable on mobile devices by scanning the QR code or by clicking [HERE](#) if viewing on a PC.



11. Verify torque specification of roof fasteners.

TORQUE

Roof Fasteners ③:
11 ft-lbs (15 N·m)

