

FRONT BUMPER KIT



P/N 2884581-XXX

BEFORE YOU BEGIN

Read these instructions and check to be sure all parts and tools are accounted for. Please retain these installation instructions for future reference and parts ordering information.

APPLICATION

Verify accessory fitment at www.polaris.com.

KIT CONTENTS

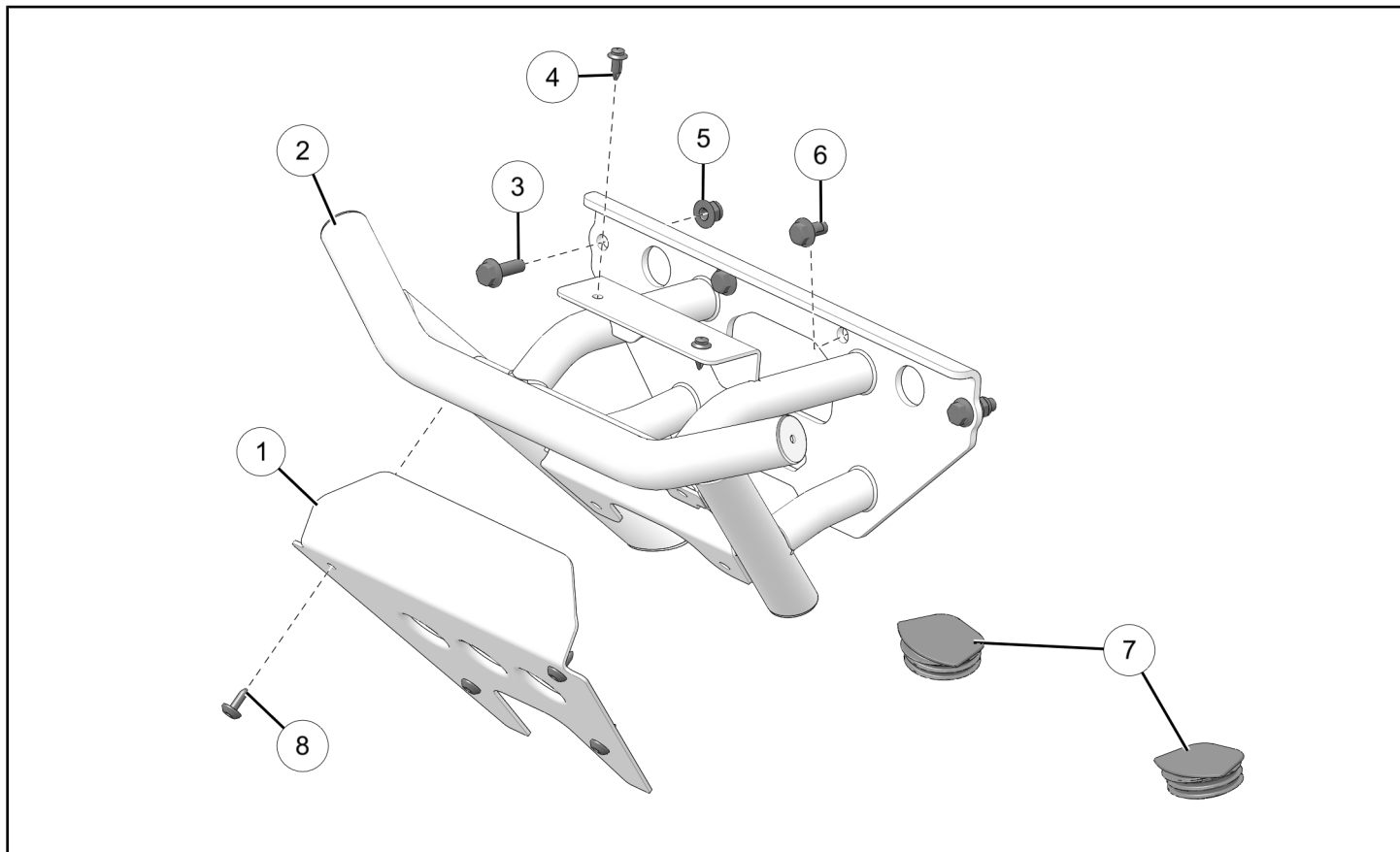

REF	QTY	PART DESCRIPTION	P/N AVAILABLE SEPARATELY	AVAILABLE SERVICE KIT
1	1	Plate-Bumper, Front	5268958	n/a
2	1	Bumper-Front	n/a	n/a
3	2	Screw-Hex Flange, M10 x 1.5 x 30 mm	n/a	2208335
4	2	Rivet-Push-Pin	n/a	2208335
5	2	Nut-Hex Flange, M10 x 1.5 mm	n/a	2208335
6	4	Screw-Hex Flange, M10 x 1.5 x 20 mm	n/a	2208335
7	2	Plug-Fascia	5457295	n/a
8	4	Screw-Torx® Truss Head, M6 x 1.0 x 20 mm	n/a	2208335

TOOLS REQUIRED

- Safety Glasses
- Pliers, Push Pin Rivet
- Socket Set, Metric
- Socket Set, Torx® Bit
- Torque Wrench
- Wrench Set, Metric

IMPORTANT

Your Front Bumper Kit is exclusively designed for your vehicle. Please read the installation instructions thoroughly before beginning. Installation is easier if the vehicle is clean and free of debris. For your safety, and to ensure a satisfactory installation, perform all installation steps correctly in the sequence shown.

INSTALLATION INSTRUCTIONS

VEHICLE PREPARATION

GENERAL

1. Park vehicle on a flat surface.
2. Shift vehicle into PARK.
3. Turn key to OFF position and remove key.

FRONT FASCIA REMOVAL

1. Remove two top mounting fasteners (longer) and two bottom mounting fasteners (shorter) to remove front fascia from vehicle.

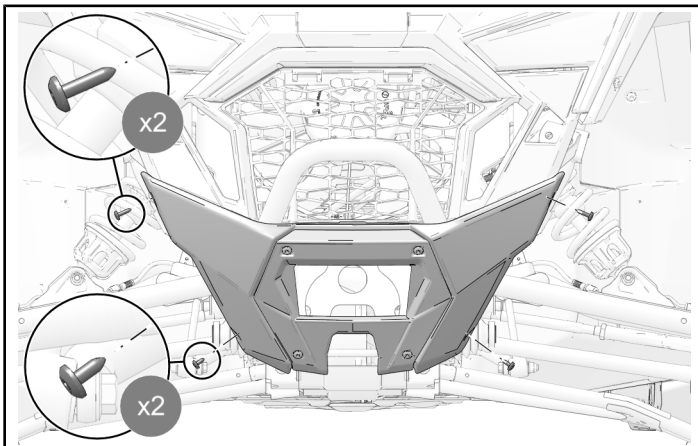

BUMPER ASSEMBLY REMOVAL

TIP

Front fascia is flexible and can be moved to access mounting hardware.

1. Remove and keep two push-pin rivets, holding front fascia to bull bumper.

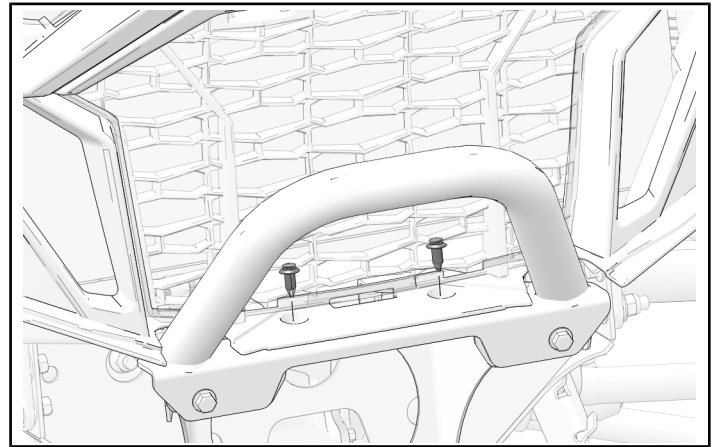

2. Remove four bumper bracket fasteners to remove bumper assembly.

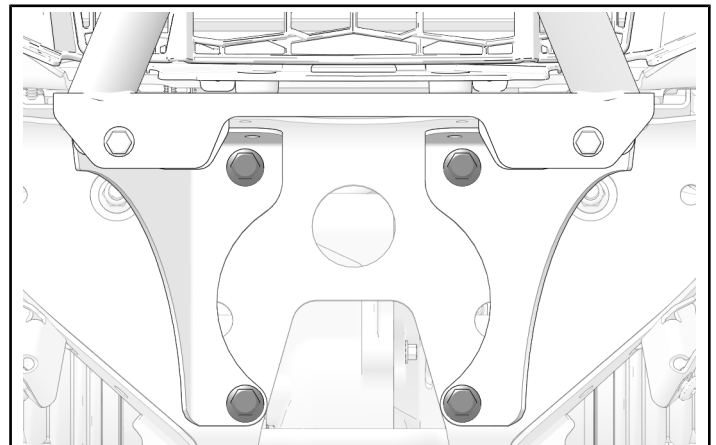

BUMPER COVER REMOVAL

1. Remove four screws to remove bumper cover from front fascia.

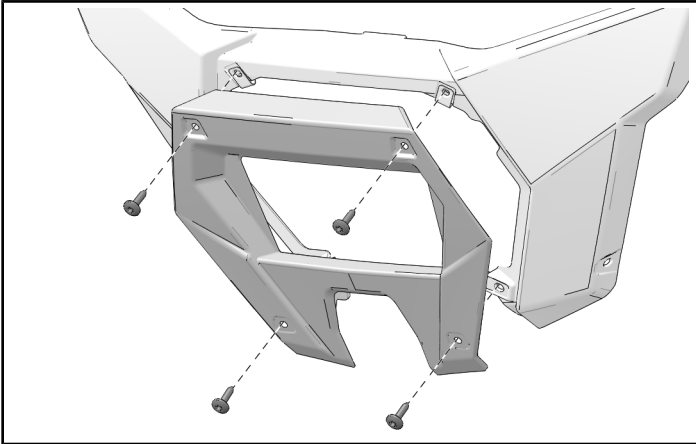

3. Install bumper to chassis with one fastener ③ and one nut ⑤.

Do not torque fasteners at this time.

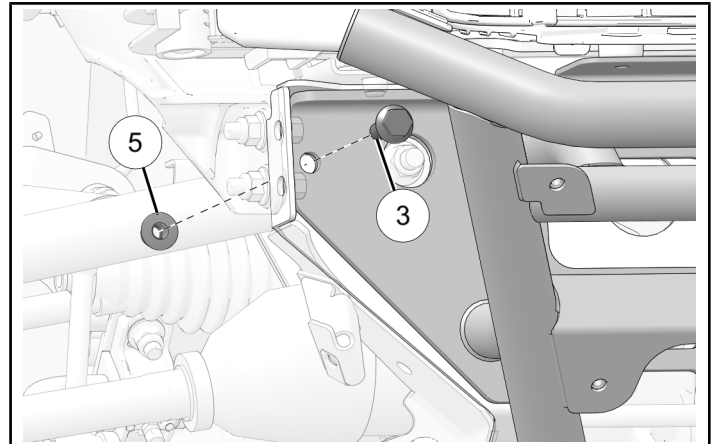

ACCESSORY INSTALLATION

1. Align accessory bumper ② with vehicle and loosely install four fasteners ⑥.

Do not torque fasteners at this time.

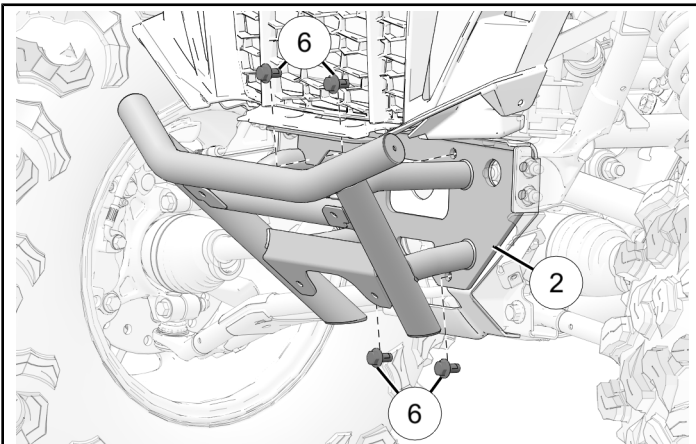

4. Counter-hold nuts and torque two fasteners ③ to specification

TORQUE

Outside Bumper Fasteners ③:
37 ft-lbs (50 N·m)

5. Torque four fasteners ⑥ to specification.

TORQUE

Center Bumper Fasteners ⑥:
37 ft-lbs (50 N·m)

2. Install bumper to chassis with one fastener ③ and one nut ⑤.

Do not torque fasteners at this time.

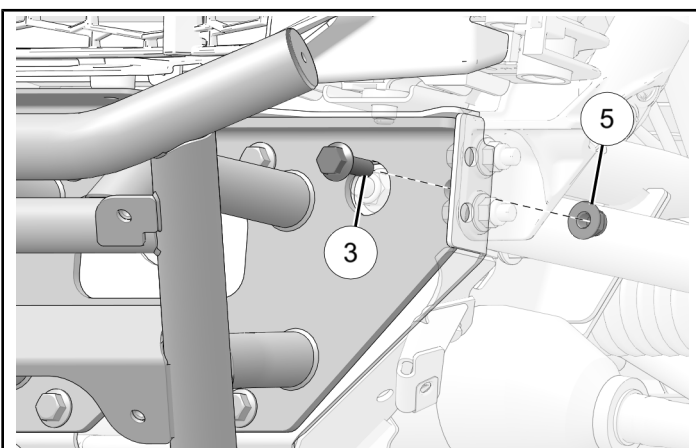

6. Install upper front fascia to accessory bumper with two push-pin rivets ④.

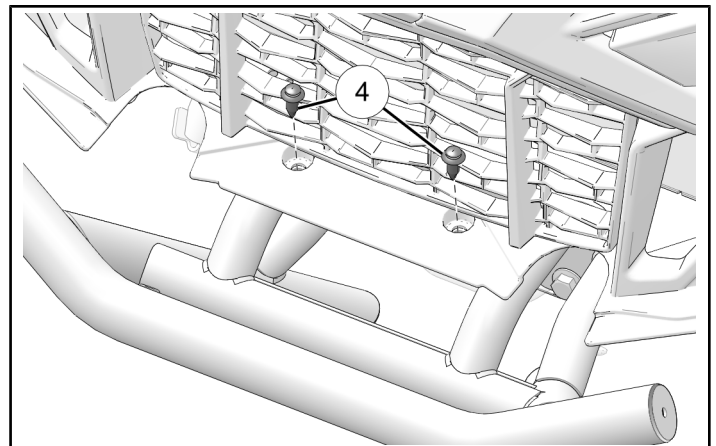

7. Put lower front fascia over accessory bumper and into installed position.

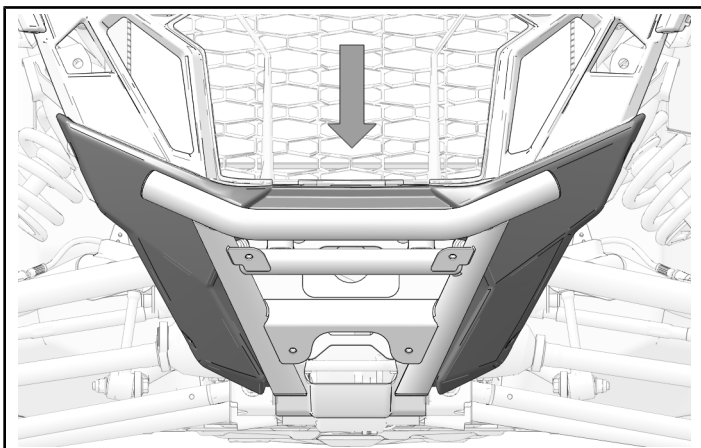

8. Install top front fascia with retained screws (longer).

TORQUE

Top Fascia Screws (longer):
7 ft-lbs (10 N·m)

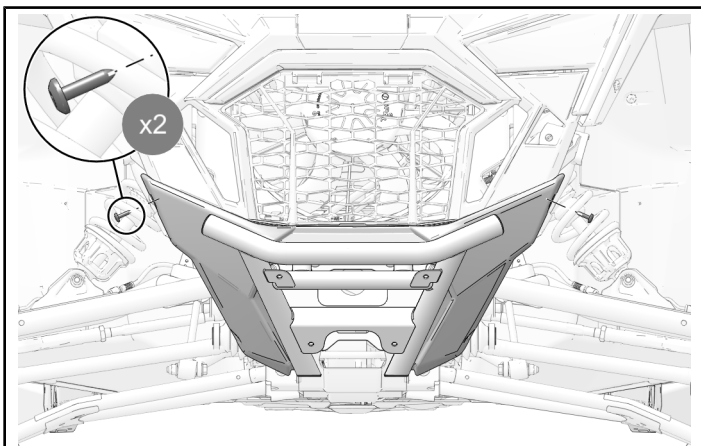

9. Install bottom front fascia with retained screws (shorter).

TORQUE

Bottom Fascia Screws (shorter):
7 ft-lbs (10 N·m)

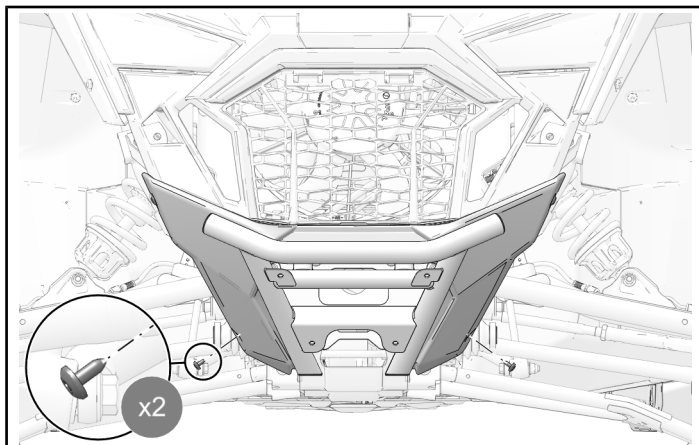

10. Align bumper plate ① with bumper assembly and install with four screws ⑧. Torque four screws to specification.

TORQUE

Bumper Plate Screws ⑧:
88 in-lbs (10 N·m)

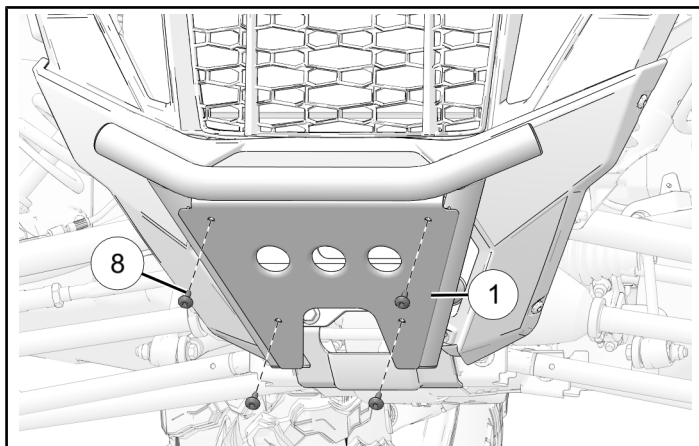

11. Install two plugs ⑦ into fascia where bull bumper was located.

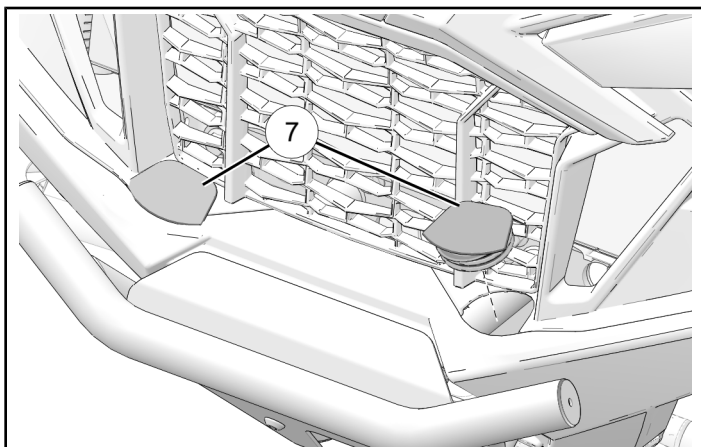

INSTRUCTION FEEDBACK FORM

A feedback form has been created for the installer to provide any comments, questions or concerns about the installation instructions. The form is viewable on mobile devices by scanning the QR code or by clicking [HERE](#) if viewing on a PC.

