

BASIC FRONT BUMPER



P/N 2884354

APPLICATION

Verify accessory fitment at www.polaris.com.

BEFORE YOU BEGIN

Read these instructions and check to be sure all parts and tools are accounted for. Please retain these installation instructions for future reference and parts ordering information.

ACCESSORY WEIGHT

Accessories, passenger, and other factors may negatively affect ride performance. Refer to your vehicle's owner's manual for maximum weight capacity and suspension adjustment procedures.

KIT CONTENTS

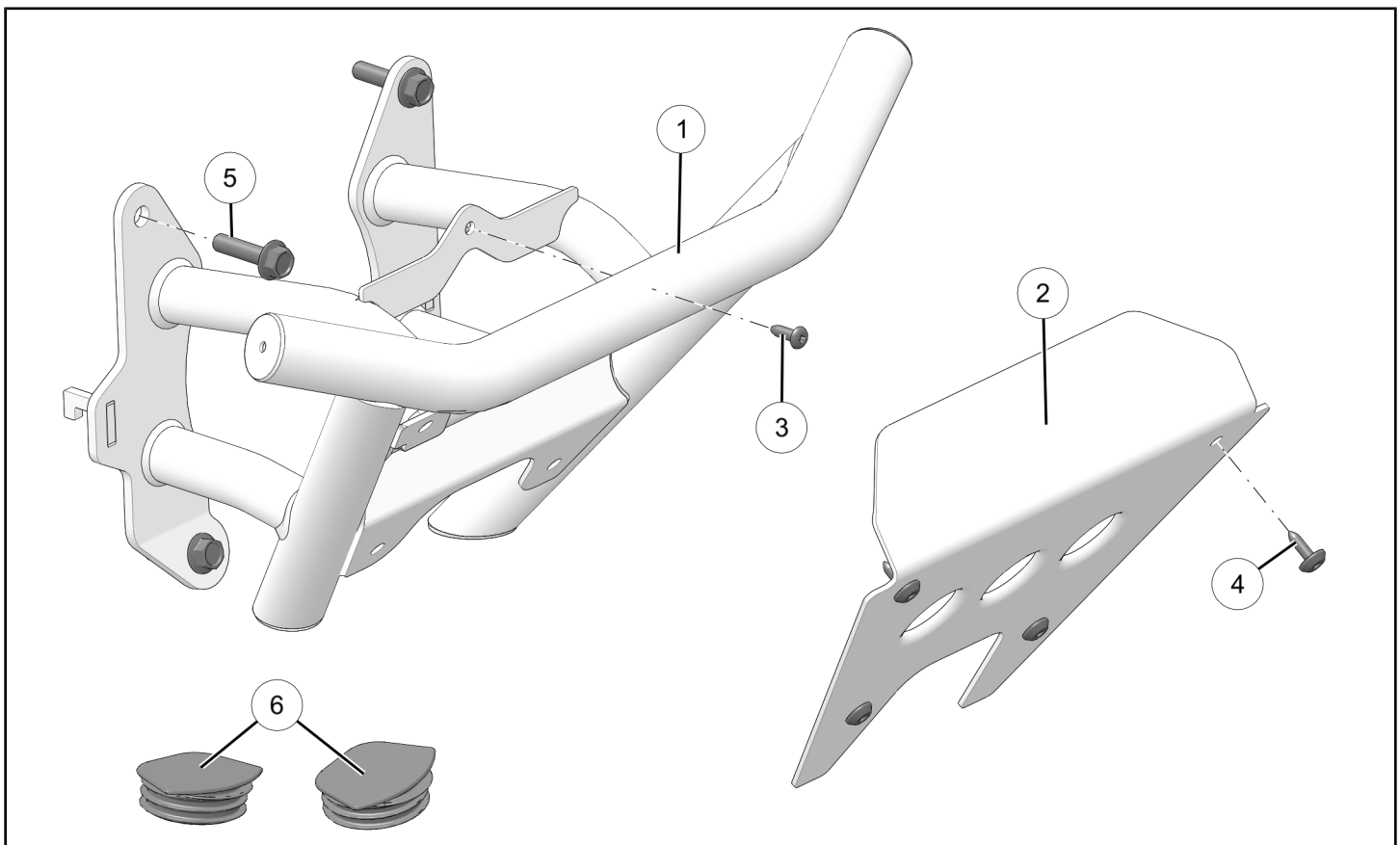

REF	QTY	PART DESCRIPTION	P/N AVAILABLE SEPARATELY	AVAILABLE SERVICE KIT
1	1	Weld-Bumper, Front, Basic	n/a	n/a
2	1	Plate-Bumper, Front, Basic	5268958	n/a
3	1	Screw-Torx® Truss Head, #14 x 3/4, Hi/Lo	n/a	2208324
4	4	Screw-Torx® Truss Head, M6 x 1.0 mm x 20 mm	n/a	2208324
5	4	Screw-Hex Flange, M10 x 1.5 mm x 40 mm	n/a	2208324
6	2	Plug-Fascia	5457295	n/a

TOOLS REQUIRED

- Safety Glasses
- Pliers, Push Pin Rivet
- Screwdriver Set, Torx®
- Socket Set, Metric
- Socket Set, Torx® Bit
- Torque Wrench

IMPORTANT

Your Basic Front Bumper is exclusively designed for your vehicle. Please read the installation instructions thoroughly before beginning. Installation is easier if the vehicle is clean and free of debris. For your safety, and to ensure a satisfactory installation, perform all installation steps correctly in the sequence shown.

INSTALLATION INSTRUCTIONS

VEHICLE PREPARATION

GENERAL

1. Shift vehicle transmission into PARK.
2. Turn key to OFF position and remove from vehicle.

FRONT FASCIA REMOVAL

1. Remove two top mounting fasteners (longer) and two bottom mounting fasteners (shorter) to remove front fascia from vehicle.

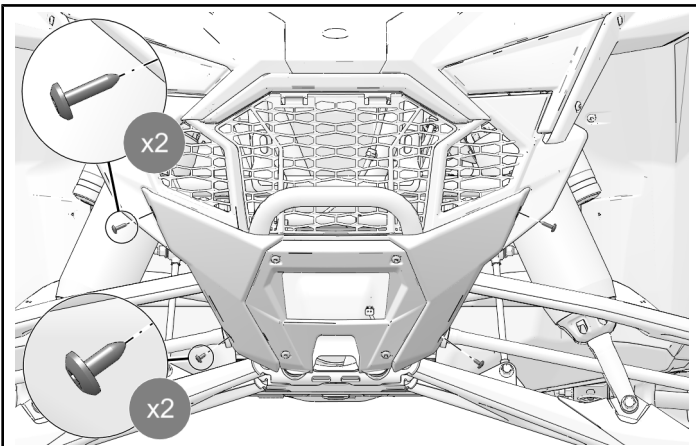

BUMPER COVER REMOVAL

1. Remove four cover fasteners to remove bumper cover from front fascia.

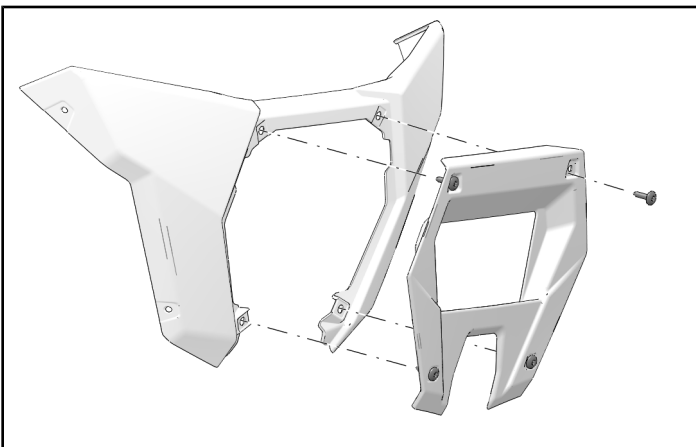

BUMPER REMOVAL

1. Remove two push-pin rivets from front fascia.

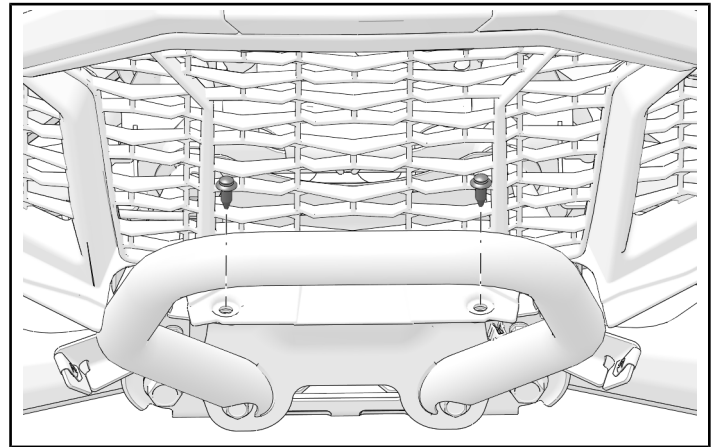

2. Remove four bumper fasteners to remove bumper assembly from chassis.

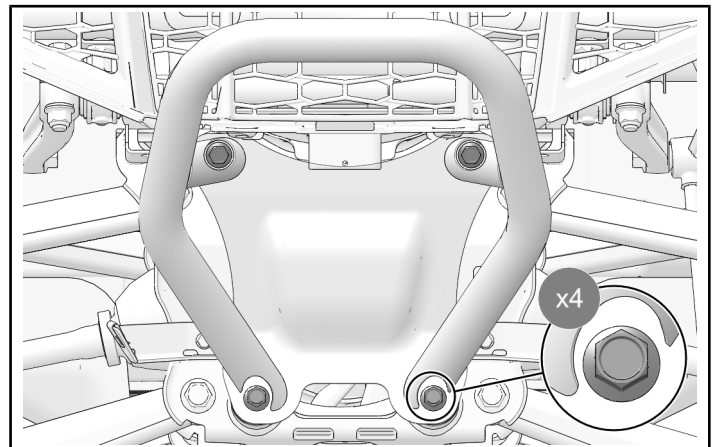

ACCESSORY INSTALLATION

1. Align bumper with slots in front mounting plate. Insert hooks and carefully lower bumper until hooks engage with mounting plate.

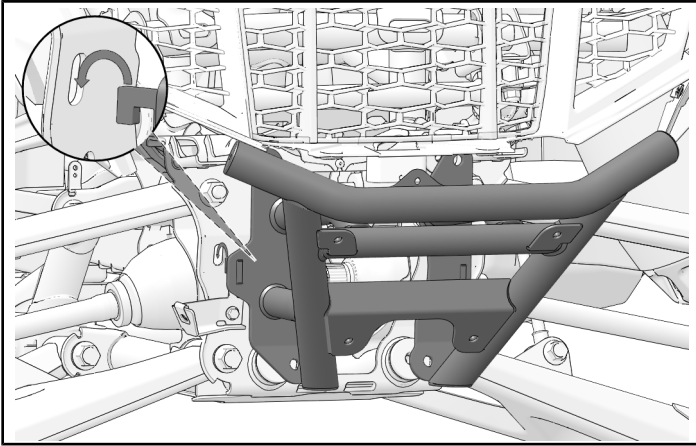

2. Install bumper to mounting plate with four bumper fasteners ⑤.

TORQUE

Bumper Fasteners ⑤:
37 ft-lbs (50 N·m)

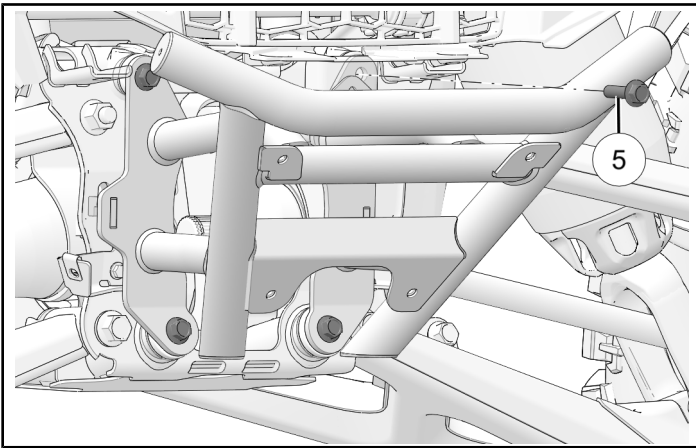

3. Secure front fascia to top of bumper with one fastener ③.

TORQUE

Fascia Fastener ③:
30 in-lbs (3 N·m)

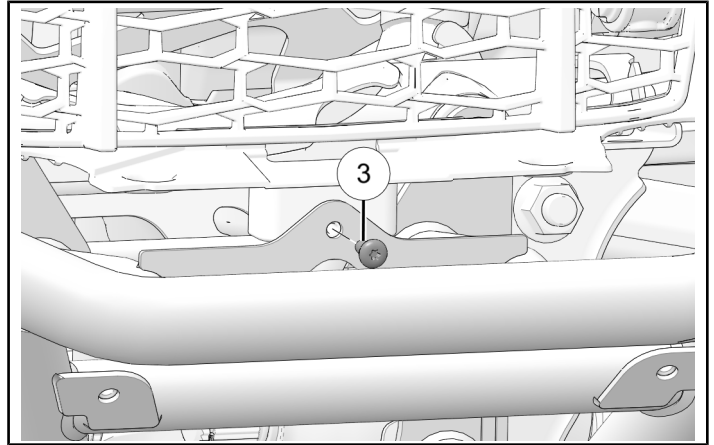

4. Install bumper plate to bumper with four plate fasteners ④.

TORQUE

Bumper Fasteners ⑤:
7 ft-lbs (10 N·m)

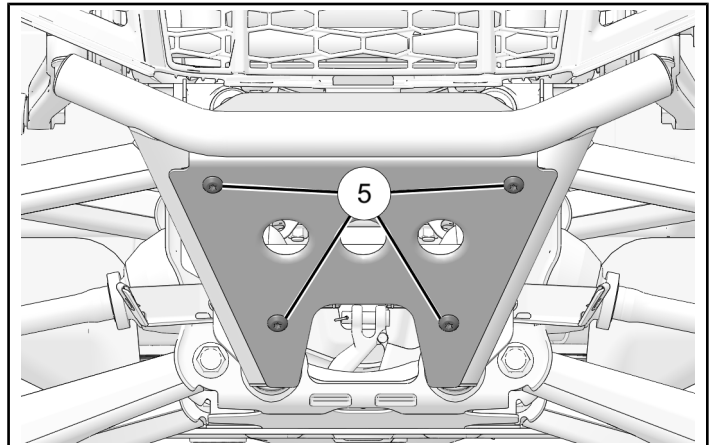

5. Reinstall front fascia panel to installed position.

TIP

Fascia is flexible and can be carefully bent when installing over accessory bumper.

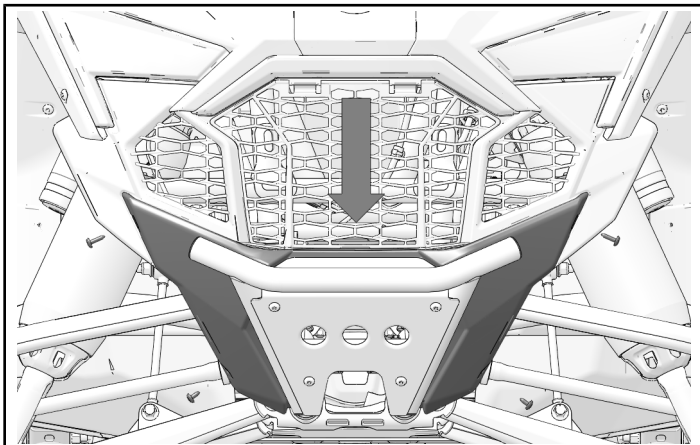

6. Reinstall top front fascia with kept fasteners (longer).

TORQUE

Top Fascia Fasteners (Longer):
7 ft-lbs (10 N·m)

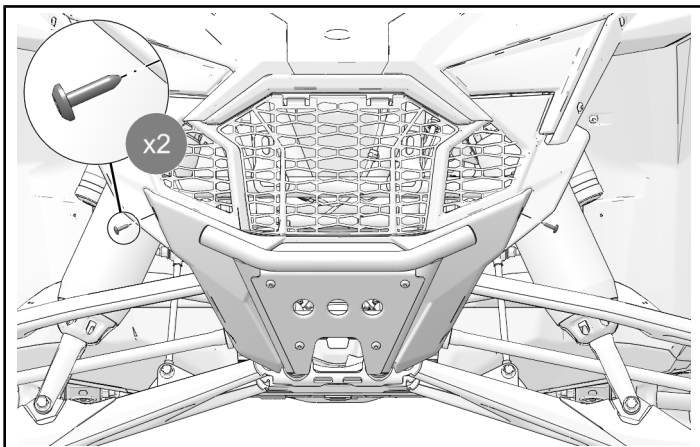

7. Reinstall bottom front fascia with kept fasteners (shorter).

TORQUE

Bottom Fascia Fasteners (Shorter):
7 ft-lbs (10 N·m)

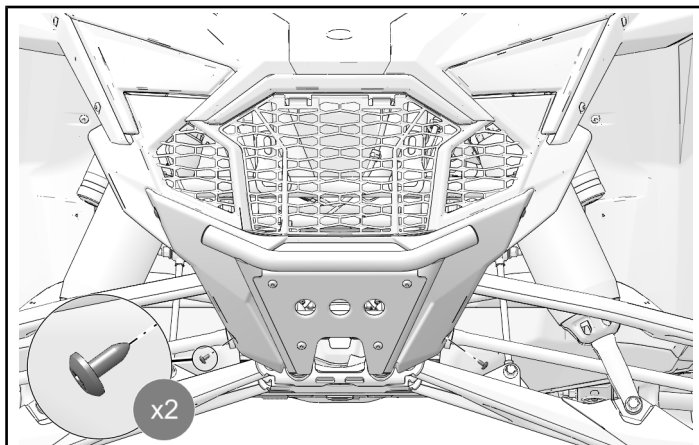

8. Install two fascia plugs (6) where original bumper was located.

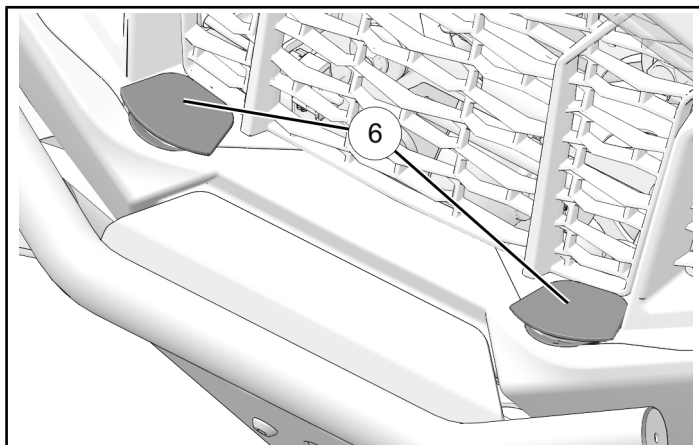

FEEDBACK FORM

A feedback form has been created for the installer to provide any comments, questions or concerns about the installation instructions. The form is viewable on mobile devices by scanning the QR code or by clicking [HERE](#) if viewing on a PC.

