

SPARE TIRE RACK KIT



P/N 2884546

BEFORE YOU BEGIN

Read these instructions and check to be sure all parts and tools are accounted for. Please retain these installation instructions for future reference and parts ordering information.

ACCESSORY WEIGHT

Accessories, passengers, and other factors may negatively affect ride performance. Refer to your vehicle’s owner’s manual for maximum weight capacity and suspension adjustment procedures.

APPLICATION

Verify accessory fitment at www.polaris.com.

KIT CONTENTS

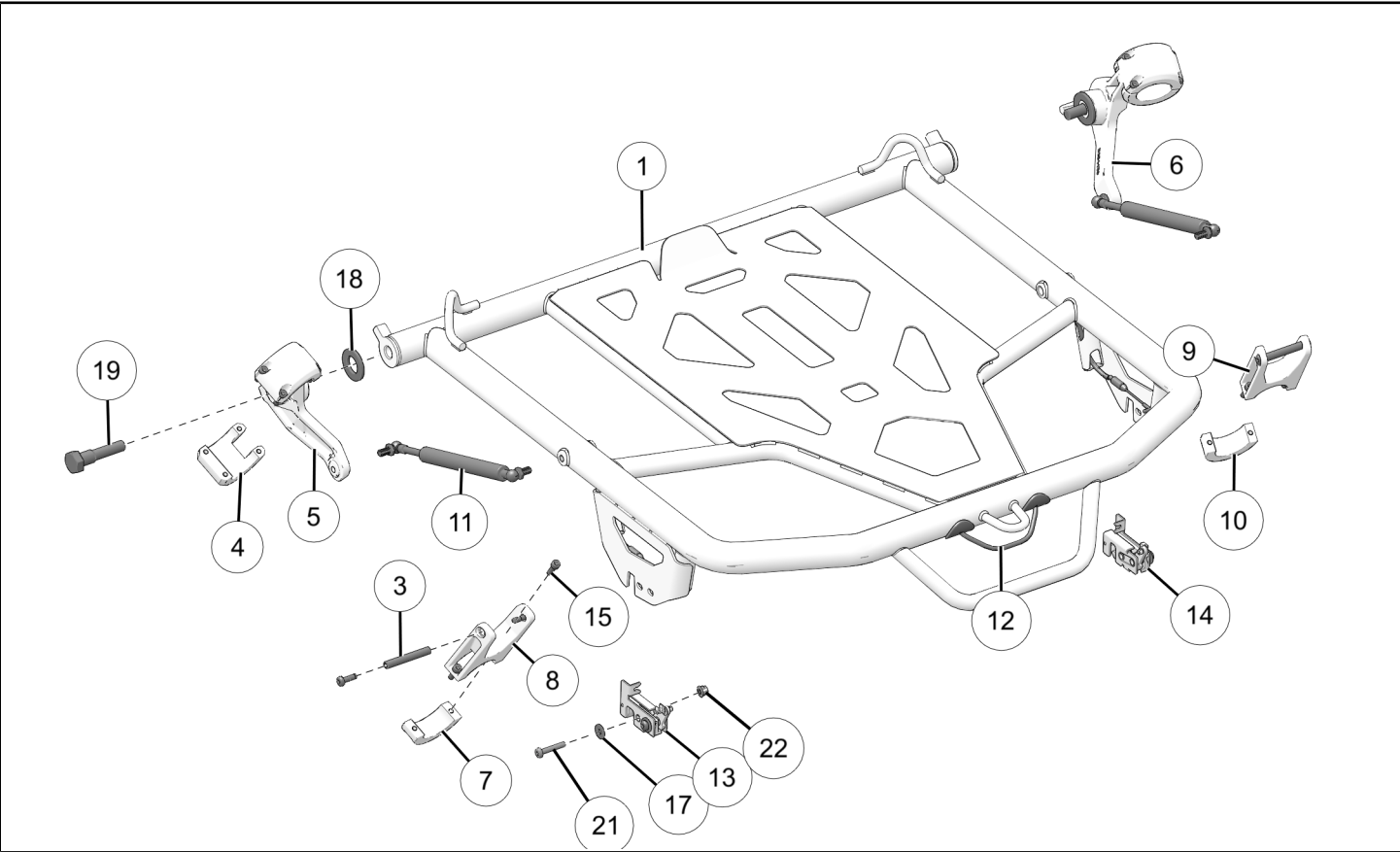

REF	QTY	PART DESCRIPTION	P/N AVAILABLE SEPARATELY	AVAILABLE SERVICE KIT
1	1	Weld–Rack, Spare Tire	n/a	n/a
2	1	Assembly–Strap, Tire (not shown)	2692437	n/a
3	2	Pin–Striker	n/a	2209417
4	2	Clamp–Pivot	n/a	n/a
5	1	Bracket–Pivot, Left-Hand	n/a	n/a
6	1	Bracket–Pivot, Right-Hand	n/a	n/a

REF	QTY	PART DESCRIPTION	P/N AVAILABLE SEPARATELY	AVAILABLE SERVICE KIT
7	1	Clamp–Striker, Lower, Left-Hand	n/a	n/a
8	1	Clamp–Striker, Upper, Left-Hand	n/a	n/a
9	1	Clamp–Striker, Upper, Right-Hand	n/a	n/a
10	1	Clamp–Striker, Lower, Right-Hand	n/a	n/a
11	2	Strut–Gas	7046060	n/a
12	1	Cable–Actuation	7082947	n/a
13	1	Latch–Tire Rack, Left-Hand	n/a	2209417
14	1	Latch–Tire Rack, Right-Hand	n/a	2209417
15	12	Screw–Socket Head, M6 x 1.0 x 20 mm	n/a	2208297
16	4	Screw–Torx® Pan Head, M6 x 1.0 x 20 mm	n/a	2208297
17	4	Washer– 6.4 x 18.0 x 1.6 mm	n/a	2208297
18	2	Bushing–Pivot	n/a	2208297
19	2	Pin–Pivot, M16	n/a	2208297
21	4	Screw – M6 x 1.0 x 35 mm	n/a	2208297
22	4	Nut – M6 x 1.0 mm	n/a	2208297

TOOLS REQUIRED

- Safety Glasses
- Hammer, Soft Face
- Hex Key Set, Metric
- Socket Set, Hex Bit, Metric
- Socket Set, Metric
- Socket Set, Torx® Bit
- Tape Measure
- Torque Wrench

IMPORTANT

Your Spare Tire Rack Kit is exclusively designed for your vehicle. Please read the installation instructions thoroughly before beginning. Installation is easier if the vehicle is clean and free of debris. For your safety, and to ensure a satisfactory installation, perform all installation steps correctly in the sequence shown.

INSTALLATION INSTRUCTIONS

VEHICLE PREPARATION

GENERAL

1. Park vehicle on a flat surface.
2. Shift vehicle into PARK.
3. Turn key to OFF position and remove key.

ACCESSORY INSTALLATION

1. Identify left pivot bracket ⑤, P/N 5634449 and right pivot bracket ⑥, P/N 5634450.

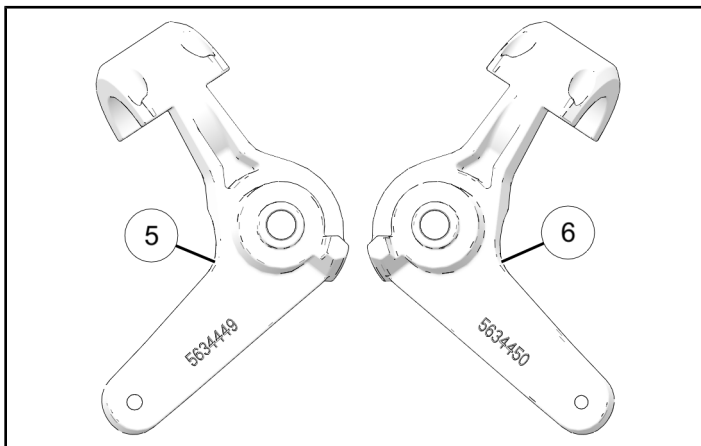

2. Install pivot brackets with pivot clamps ④ and four fasteners ⑮ per clamp assembly.

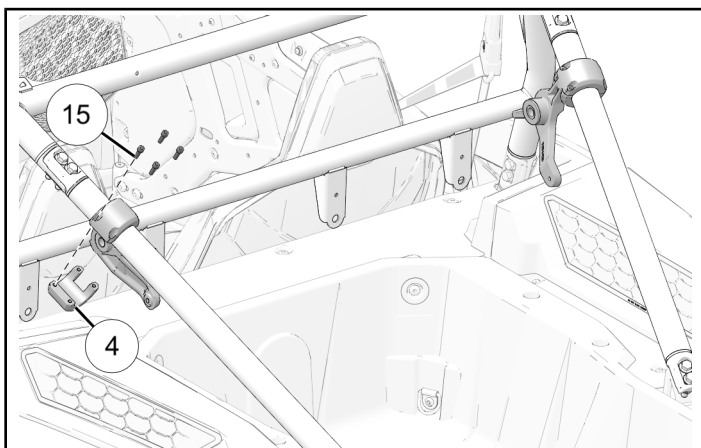

3. Measure distance between clamp assembly and top edge of roll cage joint. Make adjustments as needed.

MEASUREMENT

Measurement ①:
4.9 in (125 mm)

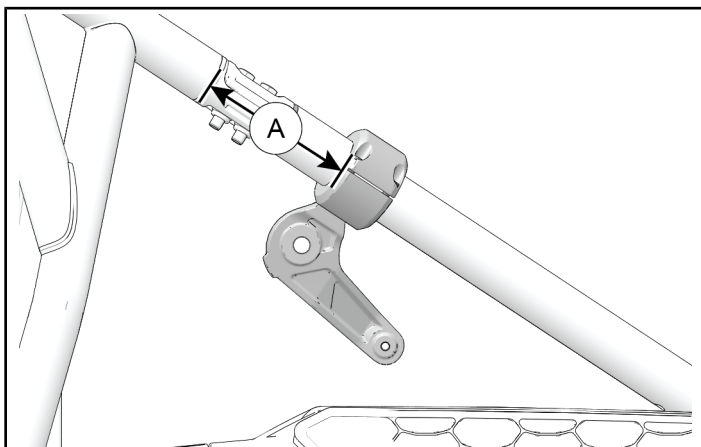

4. Measure distance between left and right clamp assemblies. Make adjustments as needed.

IMPORTANT

Measure from inside face to inside face, as shown in inset.

MEASUREMENT

Measurement ②:
32.3 in (822 mm)

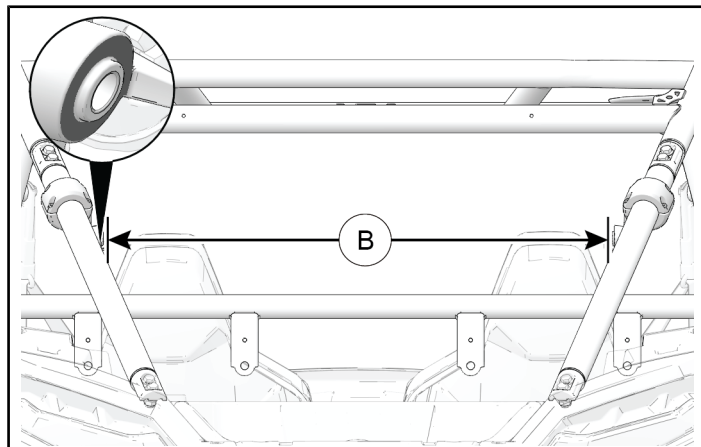

5. Loosely install pivot pin ⑲. Put bushing ⑱ over pin and onto pivot bracket.

NOTICE

Left pivot bracket shown; right pivot bracket similar.

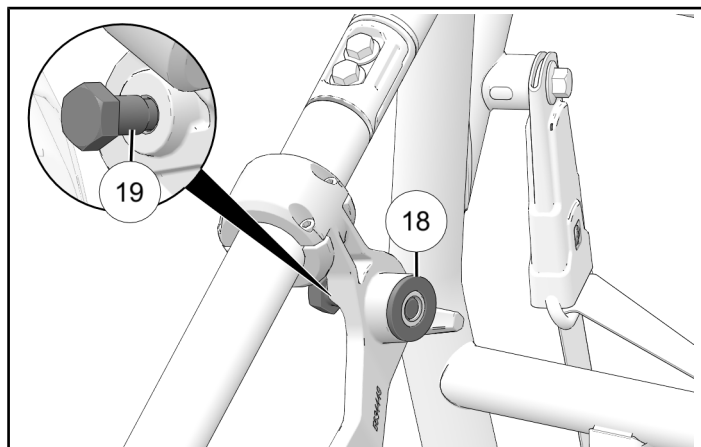

6. Align spare tire rack ① between pivot brackets.

TIP

Two people are recommended for this procedure.

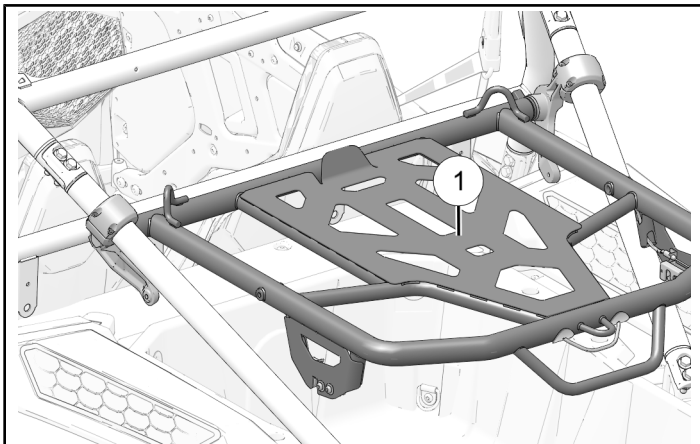

7. Push pivot brackets against tire rack and install pivot pins by hand.

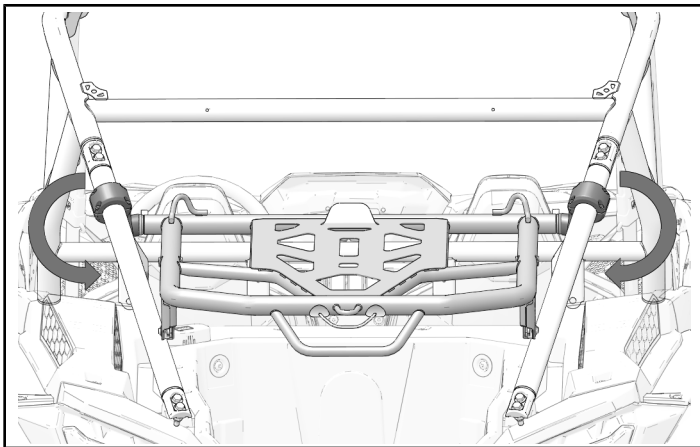

8. Continue to install pivot pins ⑱. Torque pivot pins to specification.

TIP

Make sure there is no gap between bushing and pivot bracket for best fitment.

TORQUE

Pivot Pin ⑱:
60 ft-lbs (81 N·m)

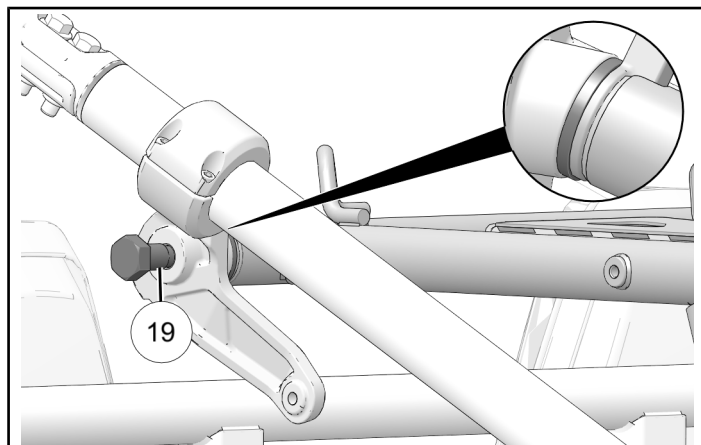

9. Measure distance between clamp assembly and top edge of roll cage joint. Make adjustments as needed.

MEASUREMENT

Measurement ①A:
4.9 in (125 mm)

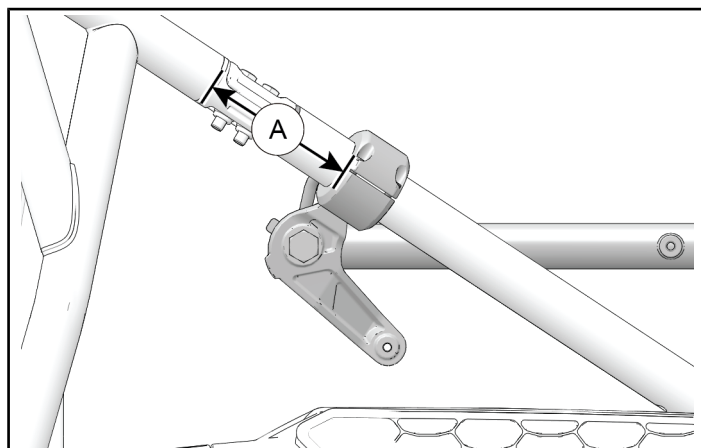

10. Torque all pivot bracket fasteners ⑮ to specification.

TORQUE

Pivot Bracket Fasteners ⑮:
16 ft-lbs (22 N·m)

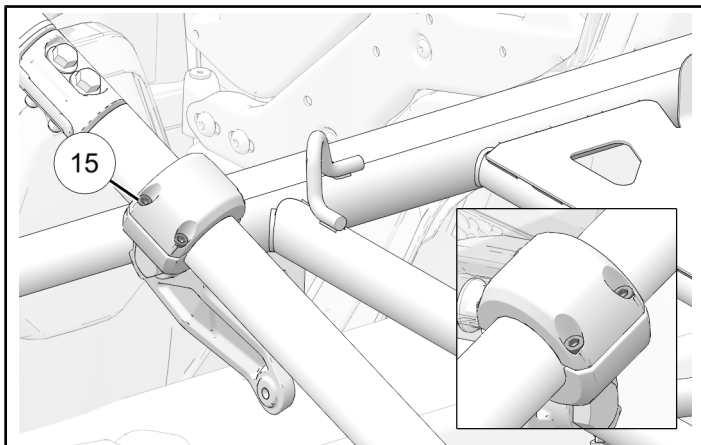

11. Identify left striker bracket ⑧, P/N 5639141 and right striker bracket ⑨, P/N 5639142.

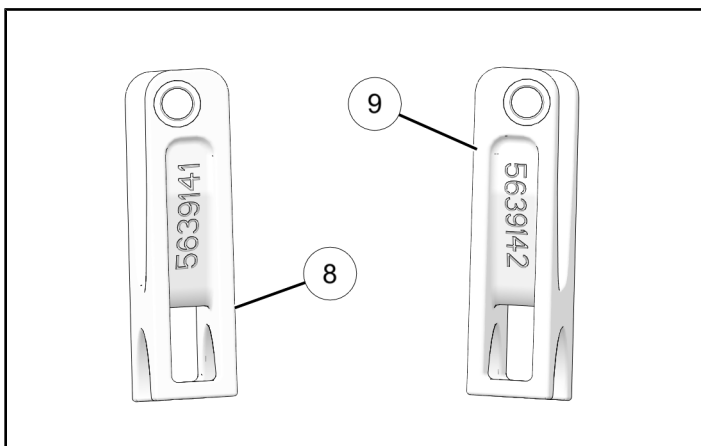

12. Install each striker pin ③ with two screws ⑯. Counter-hold one screw and torque the other to specification.

TORQUE

Striker Pin Screws ⑯:
9 ft-lbs (12 N·m)

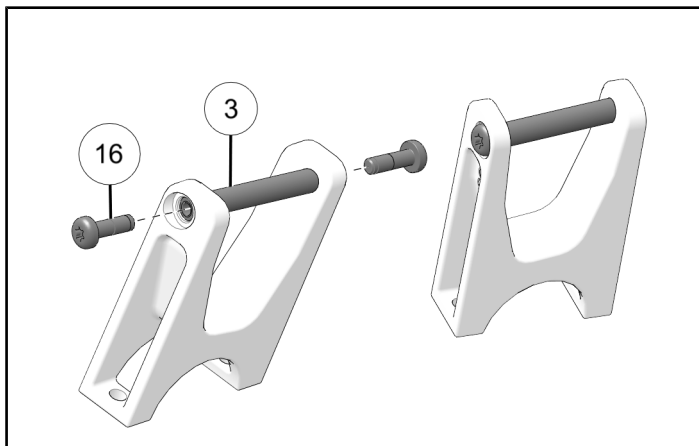

13. Install striker brackets with striker clamps ⑦ and two fasteners ⑮ per clamp assembly.

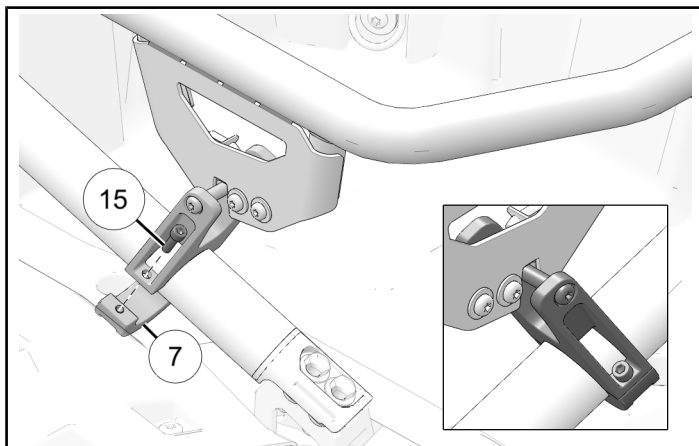

14. Make sure latch is perpendicular to striker. Adjust striker assembly on roll cage as needed.

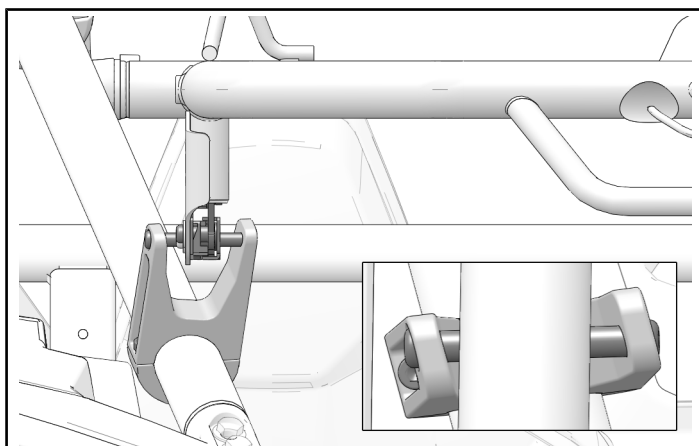

15. Measure distance between pivot clamp assembly and striker clamp assembly. Make adjustments as needed.

MEASUREMENT

Measurement C:
15.3 in (390 mm)

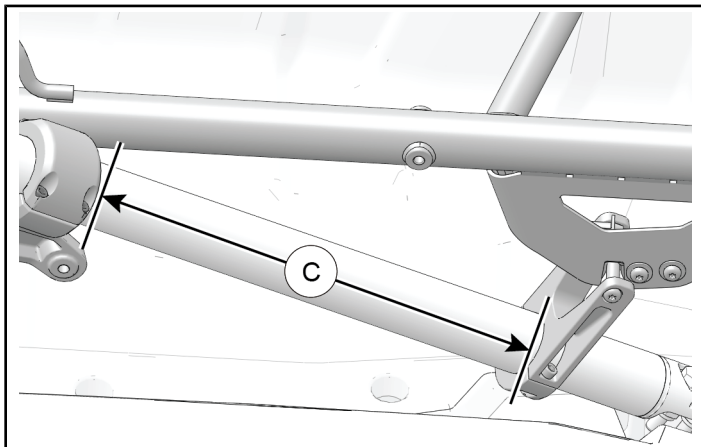

16. Torque striker clamp fasteners ⑮ to specification.

TORQUE

Striker Clamp Fasteners ⑮:
16 ft-lbs (22 N·m)

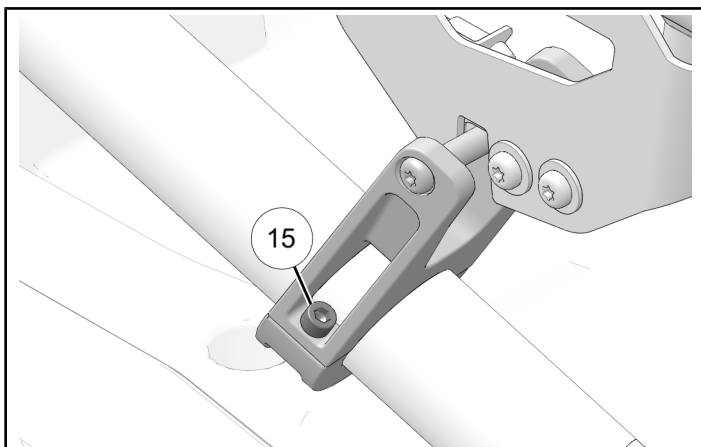

17. Center latch on striker. Torque latch screws and nuts to specification.

TORQUE

Latch Screws ⑯ and nuts:
9 ft-lbs (12 N·m)

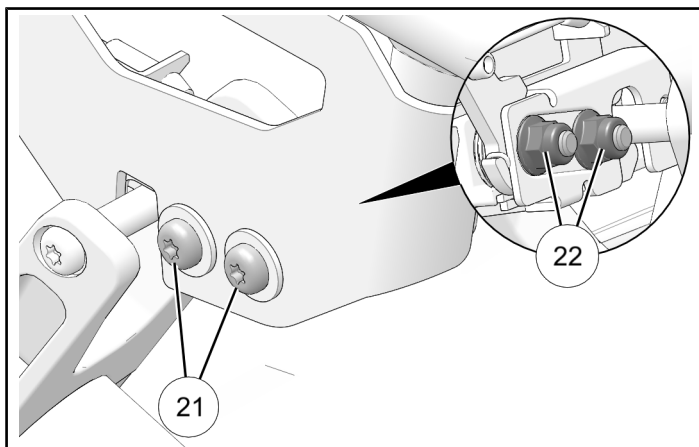

18. Install one strut ⑪, with rod facing down, per side.

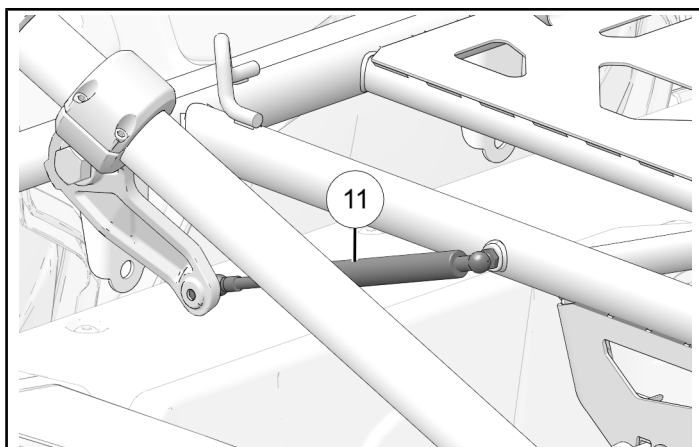

OPERATION

LATCH OPERATION

Pull actuator cable rearward to simultaneously release latches from strikers.

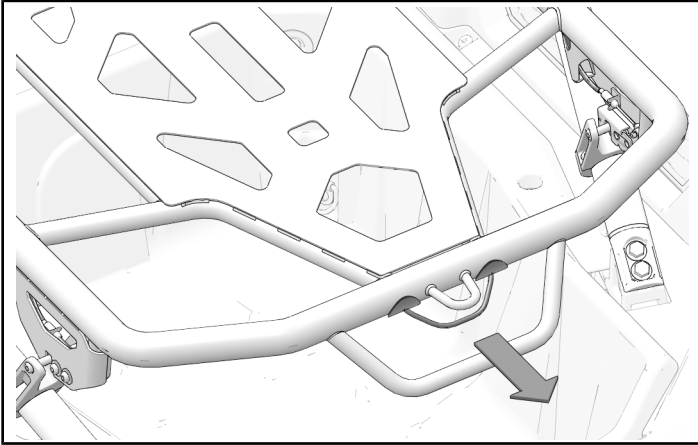

CARRYING A SPARE TIRE

Hold spare tire to rack using 3-point tire strap ②.

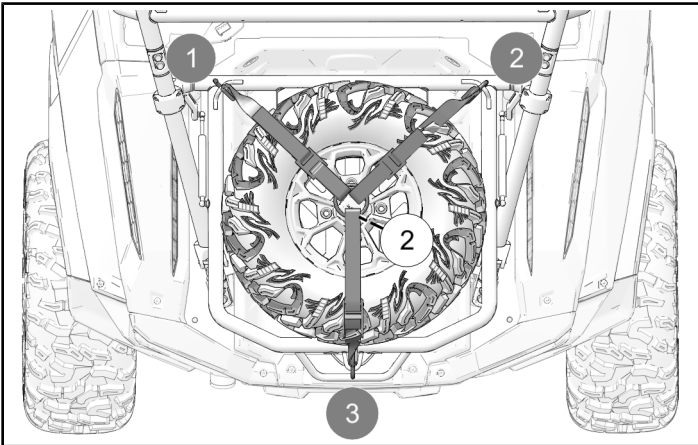

SERVICE

STRIKER REPLACEMENT

Striker wears with use. Reference *Kit Contents* for the appropriate service kit.

1. Unlatch the tire rack to access the strikers.
2. Remove the striker pin fasteners ⑯.

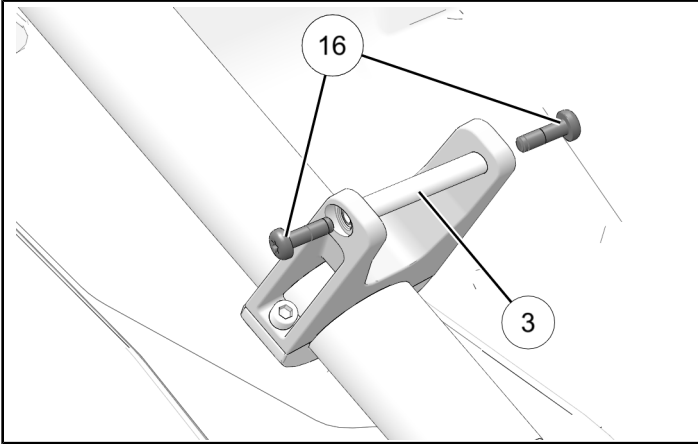

3. Remove old striker pin ③ and replace with a new one.
4. When tire rack is lowered, latches should hit strikers simultaneously.

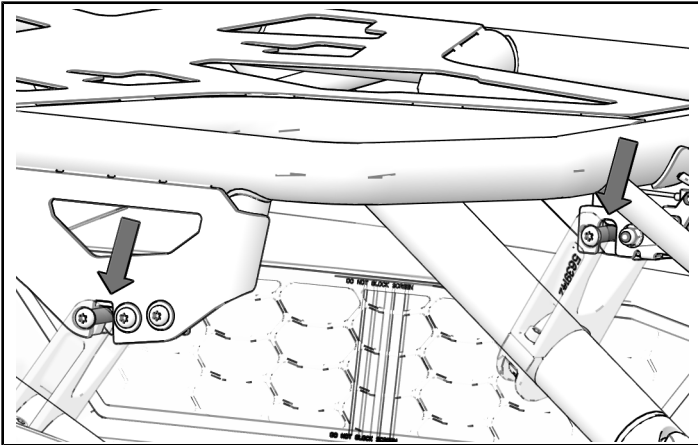

5. If adjustment is required:

- Verify striker brackets are at equal height with one another. If they are not at equal heights, loosen bracket mounting fasteners and slide the bracket up or down.
- Latch must fully engage both striker rods when tire rack is lowered.
- Tighten striker bracket fasteners ⑮ to specification.

TORQUE

Striker Bracket Fasteners ⑮:
16 ft-lbs (22 N·m)

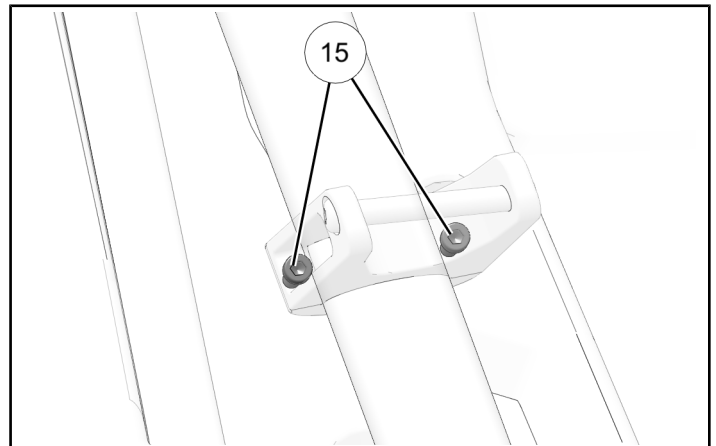

LATCH REPLACEMENT

Latch mechanism wears with use. Reference *Kit Contents* for the appropriate service kit.

LATCH REMOVAL

1. Remove actuator cable from notch in the bracket.

NOTICE

Rack hidden for clarity.

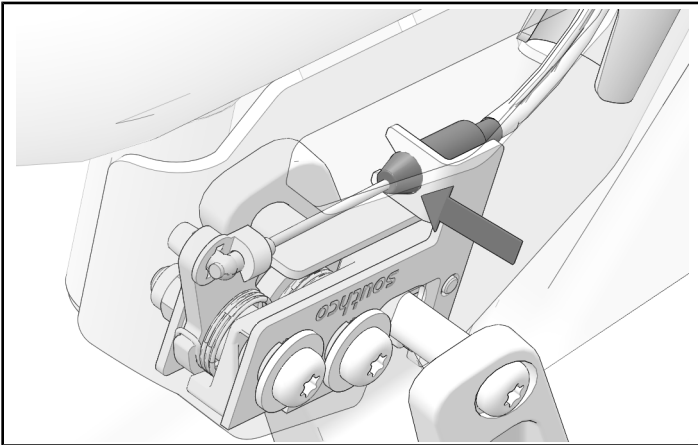

2. Rotate actuator cable out of clip and remove from latch assembly.

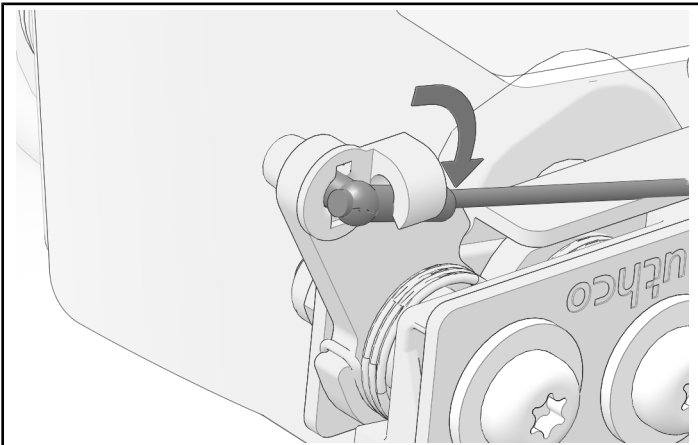

3. Remove and keep two screws, washers and nuts. Discard latch.

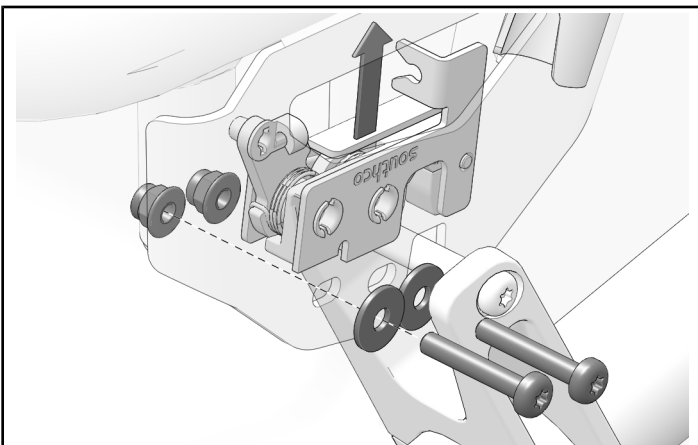

LATCH INSTALLATION

1. Loosely install new latch with two screws, washers and nuts.

Do not torque screws at this time.

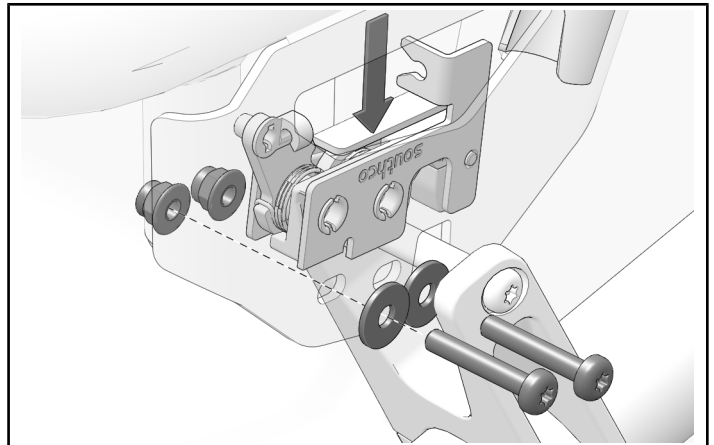

2. Put end of actuator cable into bracket slot and rotate cable into clip.

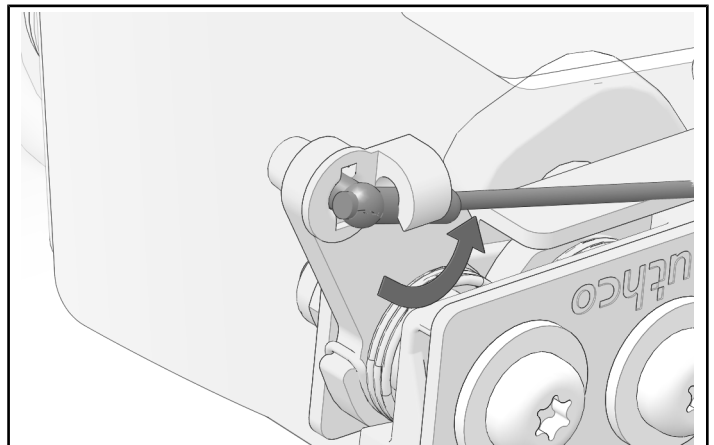

3. Push actuator cable into notch of latch bracket.

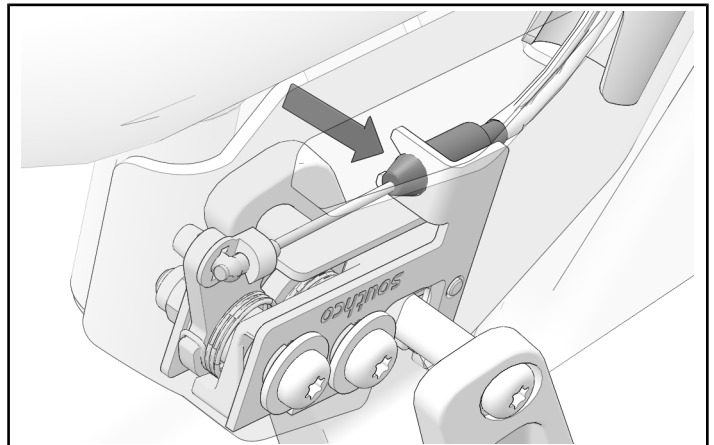

4. When tire rack is lowered, latches should hit strikers simultaneously.

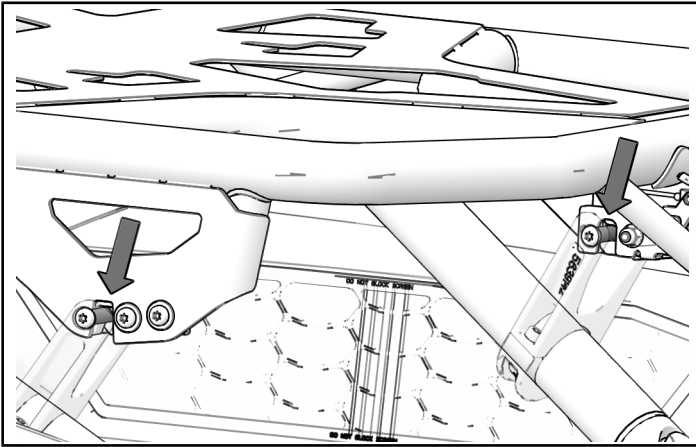

6. After adjustments are made, torque latch fasteners to specification.

TORQUE

Latch fasteners:
9 ft-lbs (12 N·m)

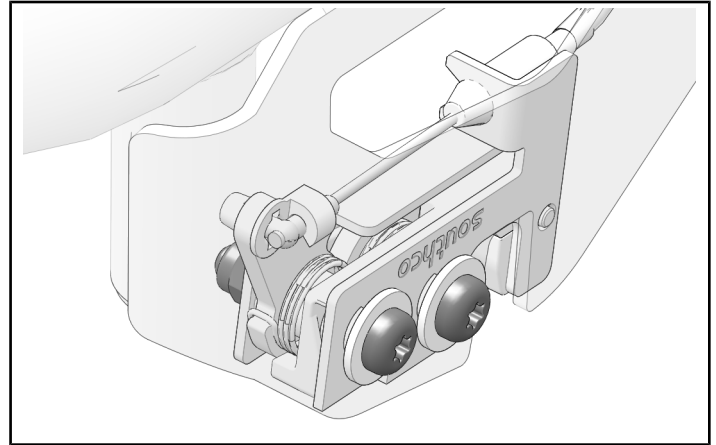

5. If adjustment is required:

- Verify striker brackets are at equal height with one another. If they are not at equal heights, loosen bracket mounting fasteners and slide the bracket up or down.
- Latch must fully engage both striker rods when tire rack is lowered.
- Tighten striker bracket fasteners ⑮ to specification.

TORQUE

Striker Bracket Fasteners ⑮:
16 ft-lbs (22 N·m)

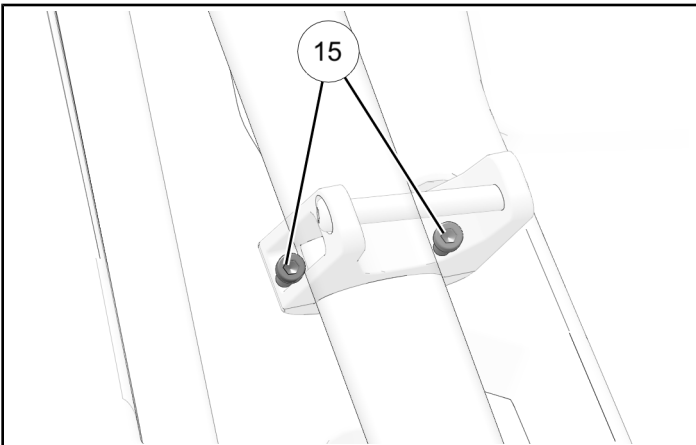

INSTRUCTION FEEDBACK FORM

A feedback form has been created for the installer to provide any comments, questions or concerns about the installation instructions. The form is viewable on mobile devices by scanning the QR code or by clicking [HERE](#) if viewing on a PC.

