

# SOFT CAB DOOR KIT



P/N 2884533; 2884534

## BEFORE YOU BEGIN

Read these instructions and check to be sure all parts and tools are accounted for. Please retain these installation instructions for future reference and parts ordering information.

## APPLICATION

Verify accessory fitment at [www.polaris.com](http://www.polaris.com).

## ACCESSORY WEIGHT

Accessories, passengers, and other factors may negatively affect ride performance. Refer to your vehicle's owner's manual for maximum weight capacity and suspension adjustment procedures.

## REQUIRED SOLD SEPARATELY

Only parts for installation of the Soft Cab Door Kit are included. For ease of accessory use, the following kit is recommended (sold separately):

- *Zipper Lubricant Kit*, P/N 2208916

## KIT CONTENTS

### SOFT CAB UPPER DOOR KIT, TWO PASSENGER, P/N 2884533

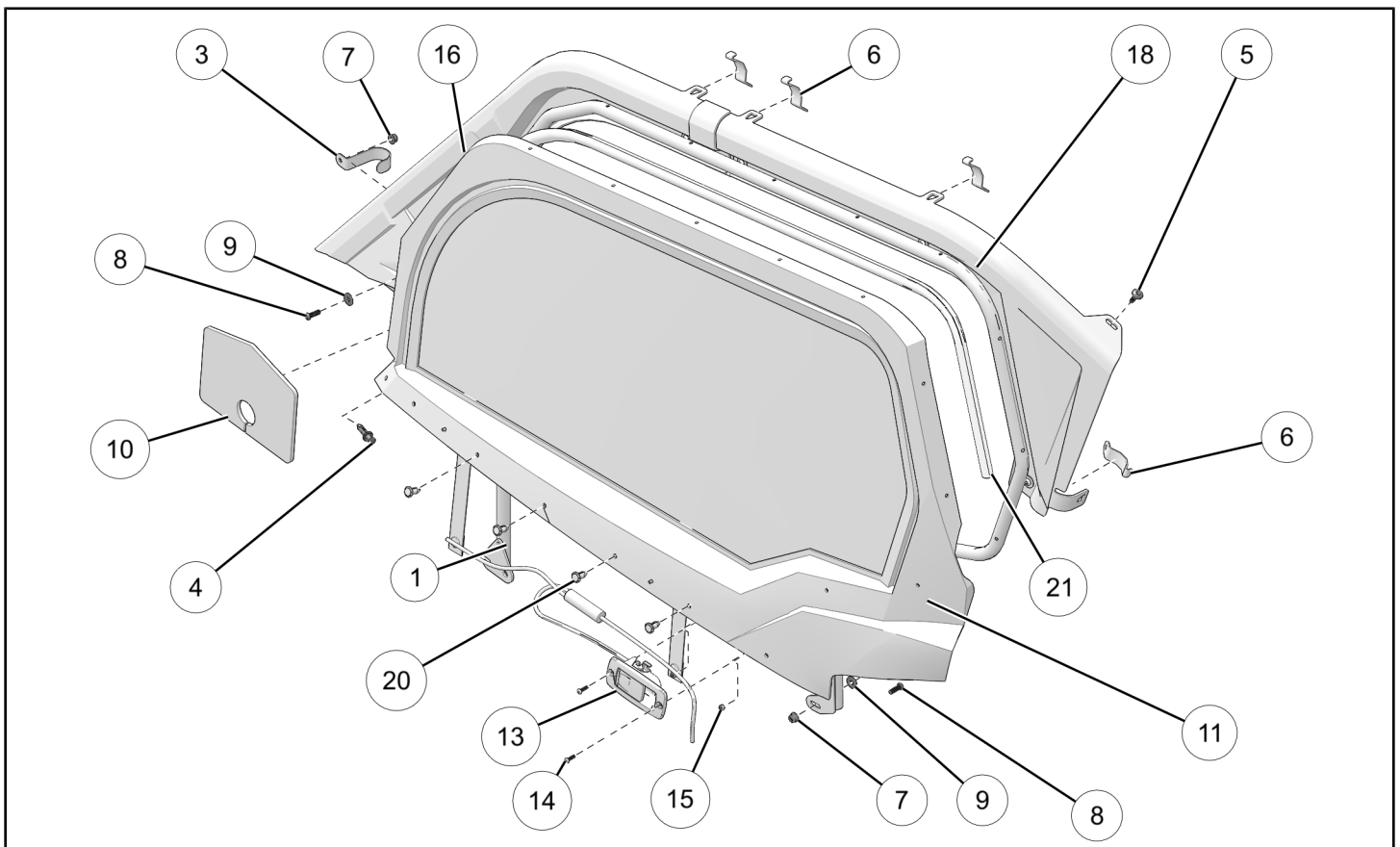

REF	QTY	PART DESCRIPTION	P/N AVAILABLE SEPARATELY	AVAILABLE SERVICE KIT
1	1	Weld-Rod, Left-Hand	n/a	n/a
2	1	Weld-Rod, Right-Hand (not shown)	n/a	n/a
3	2	J-Clip, 1.25 in	n/a	2208293
4	2	Screw–Plastic Push	n/a	2208293
5	2	Screw–Torx® Button Head, M6 x 1.0 x 20 mm	n/a	n/a
6	8	Clamp, 2 in	n/a	2208293
7	18	Nut–Nylon Locking, M6 x 1.0 mm	n/a	2208293
8	18	Screw–Button Head, M6 x 1.0 x 20 mm	n/a	2208293
9	18	Washer, M6 x 18 x 1.6 mm	n/a	2208293
10	2	Closeoff, Front	n/a	2209773
11	1	Softcab-Door, Left-Hand	2637819	n/a
12	1	Softcab-Door, Right-Hand (not shown)	2637820	n/a
13	2	External Latch, 2P	n/a	2889402
14	4	Screw–Hex Button Head, M4 x 0.7 x 16 mm	n/a	2889402
15	4	Nut–Nylon Locking, M4 x 0.7 mm	n/a	2889402
16	1	Front Shroud, Left-Hand	n/a	n/a
17	1	Front Shroud, Right-Hand (not shown)	n/a	n/a
18	1	Rear Shroud, Left-Hand	n/a	n/a
19	1	Rear Shroud, Right-Hand (not shown)	n/a	n/a
20	14	Screw–Plastic Push	n/a	2208293
21	2	Seal	n/a	

## SOFT CAB UPPER DOOR KIT, MULTI-PASSENGER, P/N 2884534

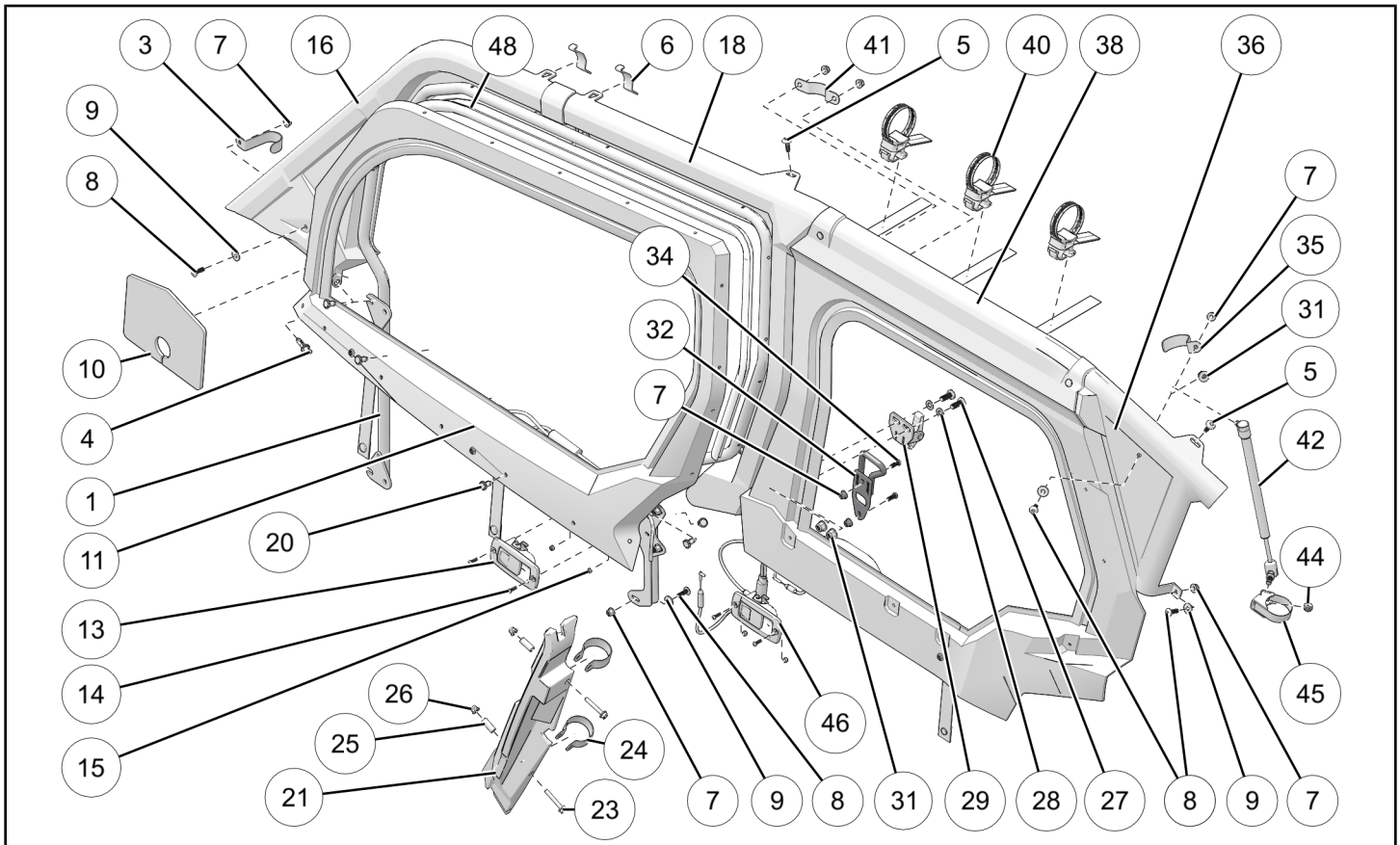

REF	QTY	PART DESCRIPTION	P/N AVAILABLE SEPARATELY	AVAILABLE SERVICE KIT
1	1	Weld-Rod, Left-Hand	n/a	n/a
2	1	Weld-Rod, Right-Hand (not shown)	n/a	n/a
3	2	J-Clip, 1.25 in	n/a	2208294
4	2	Screw-Plastic Push	n/a	2208294
5	2	Screw-Torx® Button Head, M6 x 1.0 x 20 mm	n/a	n/a
6	4	Clamp, 2 in	n/a	2208294
7	26	Nut-Nylon Locking, M6 x 1.0 mm	n/a	2208294
8	26	Screw-Button Head, M6 x 1.0 x 20 mm	n/a	2208294
9	26	Washer, M6 x 18 x 1.6 mm	n/a	2208294
10	2	Closeoff, Front	n/a	2209774
11	1	Softcab-Door, Left-Hand	2637821	n/a
12	1	Softcab-Door, Right-Hand (not shown)	2637822	n/a
13	2	External Latch, Front, MP	n/a	2889403
14	8	Screw-Hex Button Head, M4 x 0.7 x 16 mm	n/a	2889403
15	8	Nut-Nylon Locking, M4 x 0.7 mm	n/a	2889403
16	1	Front Shroud, Left-Hand	n/a	n/a

REF	QTY	PART DESCRIPTION	P/N AVAILABLE SEPARATELY	AVAILABLE SERVICE KIT
17	1	Front Shroud, Right-Hand (not shown)	n/a	n/a
18	1	Middle Shroud, Left-Hand	n/a	n/a
19	1	Middle Shroud, Right-Hand (not shown)	n/a	n/a
20	14	Screw–Plastic Push	n/a	2208294
21	1	Closeoff-Cab, Door, MP, Left-Hand	n/a	2209774
22	1	Closeoff-Cab, Door, MP, Right-Hand (not shown)	n/a	2209774
23	4	Screw–Hex Flange Head, M6 x 1.0 x 40 mm	n/a	2208294
24	4	Clamp-Strap, 1.75 in	n/a	2209774
25	4	Spacer, Closeoff	n/a	2209774
26	4	Nut–Nylon Locking, M6 x 1.0 mm	n/a	2208294
27	4	Screw–Button Head, M8 x 1.0 x 20 mm	n/a	2208294
28	4	Washer, M8 x 18 x 1.8 mm	n/a	2208294
29	1	Rear Gull Winch Door Latch, Left-Hand	n/a	2208294
30	1	Rear Gull Winch Door Latch, Right-Hand	n/a	2208294
31	6	Nut–Nylon Locking, M8	n/a	2208294
32	1	Weld-Striker, Rear Door, Left-Hand	n/a	n/a
33	1	Weld-Striker, Rear Door, Right-Hand	n/a	n/a
34	4	Screw–Hex Button Head, M6 x 1.0 x 18 mm	n/a	2208294
35	2	Clamp, 1.75 in	n/a	2208294
36	1	Rear Shroud, Left-Hand	n/a	n/a
37	1	Rear Shroud, Right-Hand (not shown)	n/a	n/a
38	1	Rear Softcab-Door, Left-Hand	2637823	n/a
39	1	Rear Softcab-Door, Right-Hand (not shown)	2637824	n/a
40	6	Clamp, Upper	n/a	2208294
41	4	Mounting Clip	n/a	2208294
42	1	Gas Strut, Left-Hand	n/a	2208294
43	1	Gas Strut, Right-Hand	n/a	2208294
44	2	Nut–Nylon Locking, M8	n/a	2208294
45	2	Clamp, ROPS	n/a	2208294
46	2	External Latch, Rear, MP	n/a	2889403
47	2	Screw–Hex Button Head, M8 x 1.0 x 20 mm	n/a	2208294
48	2	Seal	n/a	n/a



## TOOLS REQUIRED

- Safety Glasses
- Cutting Tool
- Drill
- Drill Bit:
  - 3/16 in (5 mm)
  - 5/16 in (8 mm)
- Pliers, Push Pin Rivet
- Screwdriver Set, Torx®
- Socket Set, Metric
- Socket Set, Torx® Bit
- Torque Wrench
- Wrench Set, Metric

## CONSUMABLES REQUIRED

- Silicone Sealant

## IMPORTANT

Your Soft Cab Door Kit is exclusively designed for your vehicle. Please read the installation instructions thoroughly before beginning. Installation is easier if the vehicle is clean and free of debris. For your safety, and to ensure a satisfactory installation, perform all installation steps correctly in the sequence shown.

## INSTALLATION INSTRUCTIONS

### VEHICLE PREPARATION

#### GENERAL

1. Park vehicle on a flat surface.
2. Shift vehicle into PARK.
3. Turn key to OFF position and remove key.
4. If installed, remove any accessory windshield.
5. If installed, remove any accessory or factory-installed roof.
6. If installed, remove accessory rear panel.

#### NOTICE

Only the upper portion of the rear panel needs to be removed.

#### DRIVER STORAGE REMOVAL

1. Open driver storage compartment.

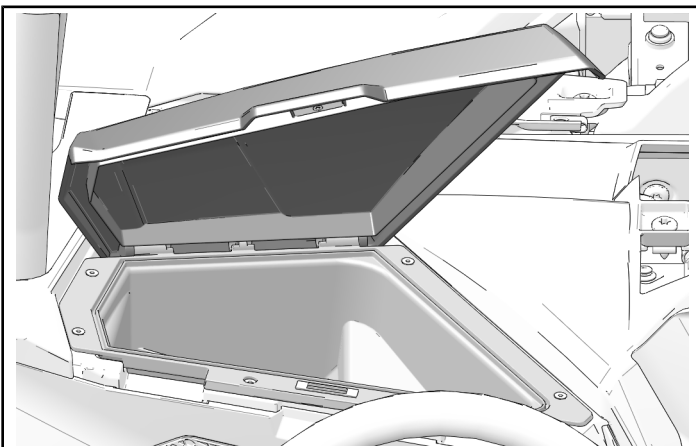

2. Remove six storage compartment fasteners.

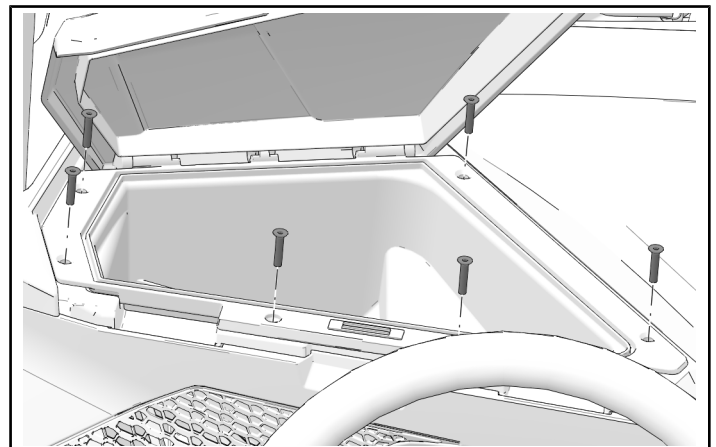

3. Remove storage compartment.

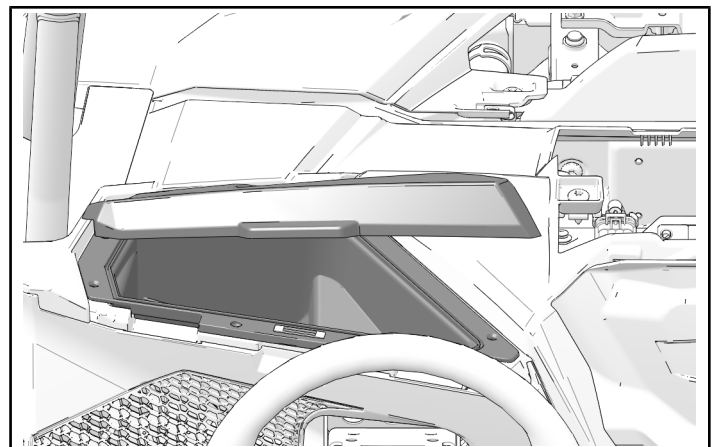

## PASSENGER STORAGE REMOVAL

1. Open passenger storage compartment.

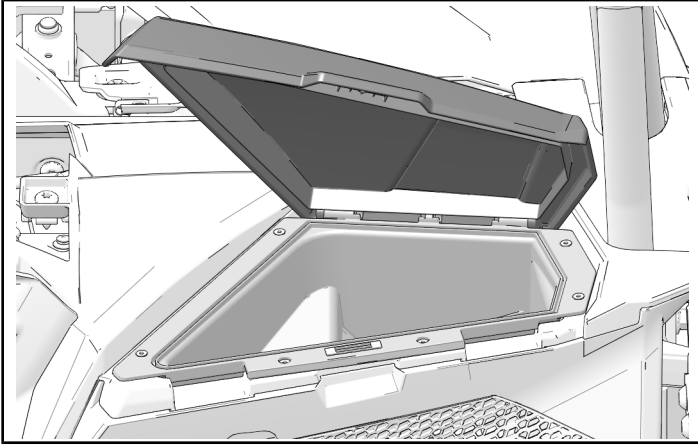

2. Remove six storage compartment fasteners.

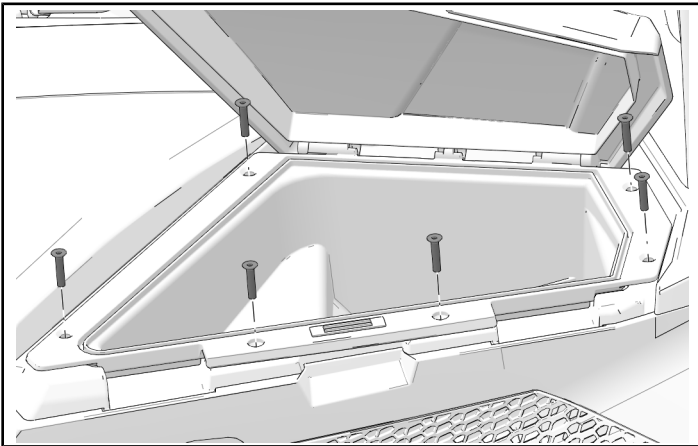

3. Remove storage compartment.

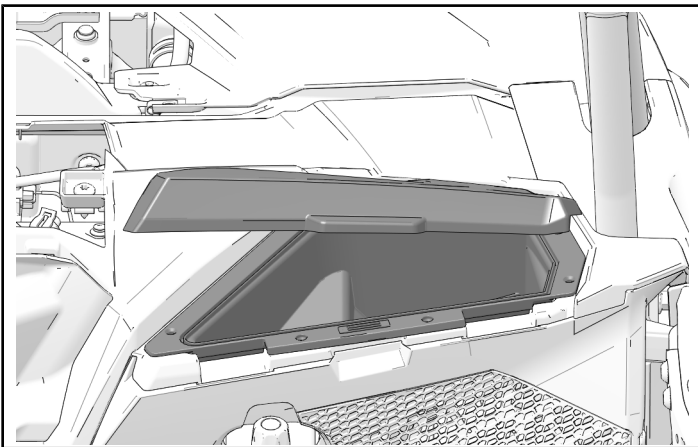

## ACCESSORY INSTALLATION

### ALL VEHICLES

#### CAB CLOSE-OFF INSTALLATION

1. Install cab close-off ⑩ around chassis tube.

#### NOTICE

Left side shown, right side similar.

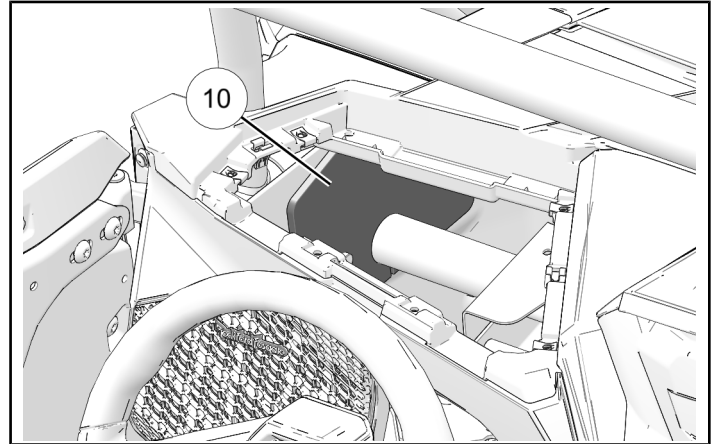

## TWO PASSENGER VEHICLES

### SHROUD INSTALLATION

#### NOTICE

Left side shown, right side similar.

1. Remove and discard plastic push pin rivet from the rear pocket fender.

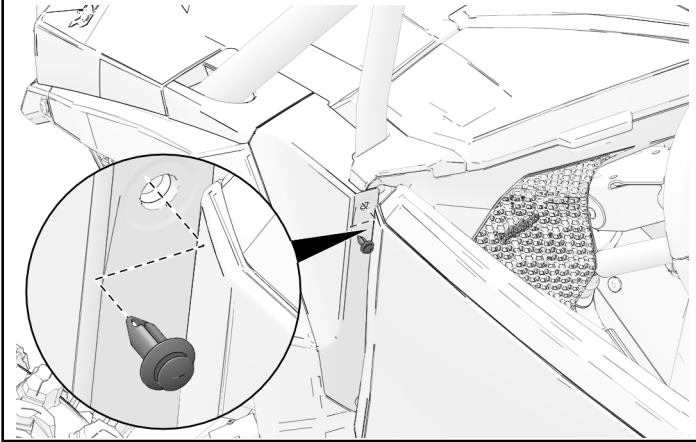

2. Align the rear shroud ⑱ with the Roll Over Protection System (ROPS).

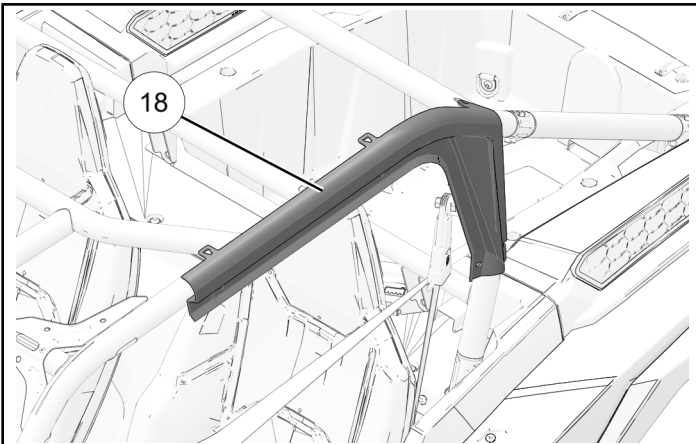

3. Put two fasteners ⑧ through two washers ⑨ and through rear shroud.

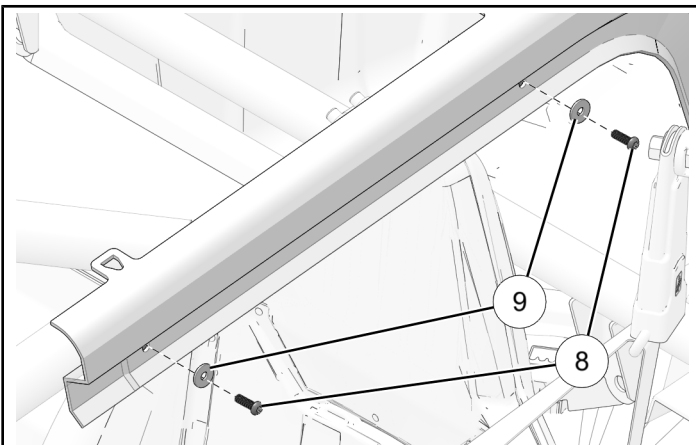

4. Hook clamps ⑥ into the slots of the rear shroud and align with previously installed fasteners. Secure with nuts ⑦.

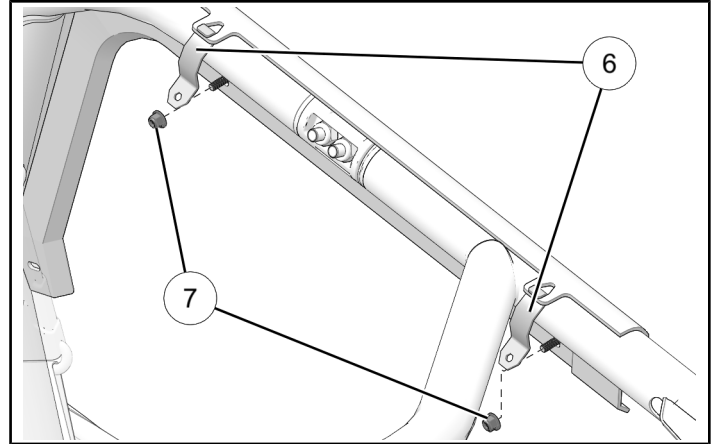

5. Put one fastener ⑧ through one washer ⑨ and through rear shroud.

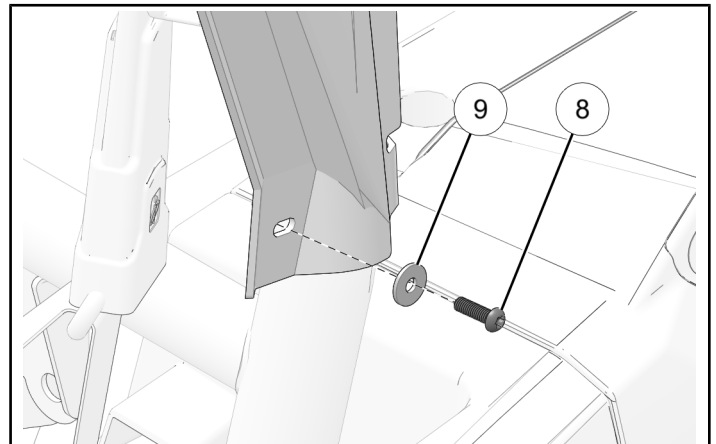

6. Hook clamp ⑥ into the slot of the rear shroud and align with previously installed fastener. Secure with one nut ⑦.

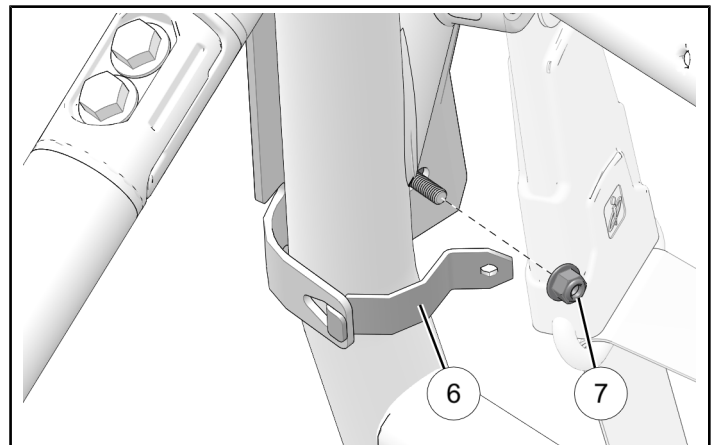

7. Counter-hold nuts ⑦ and torque fasteners ⑧ to specification.

**TORQUE**

Shroud Fasteners ⑧:  
**88 in-lbs (10 N·m)**

8. Align the front shroud ⑯ with the ROPS.

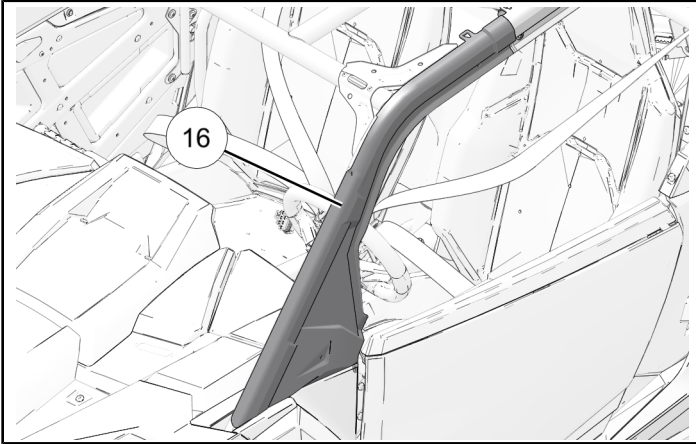

9. Put one fastener ⑧ through one washer ⑨ and through front shroud.

**TIP**

Put silicone sealant where the front and rear shroud meets to aid in water sealing.

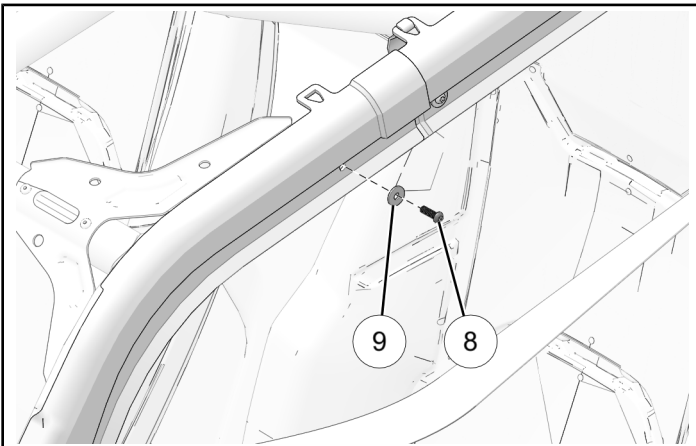

10. Hook clamp ⑥ into the slot of the front shroud and align with previously installed fastener. Secure with one nut ⑦.

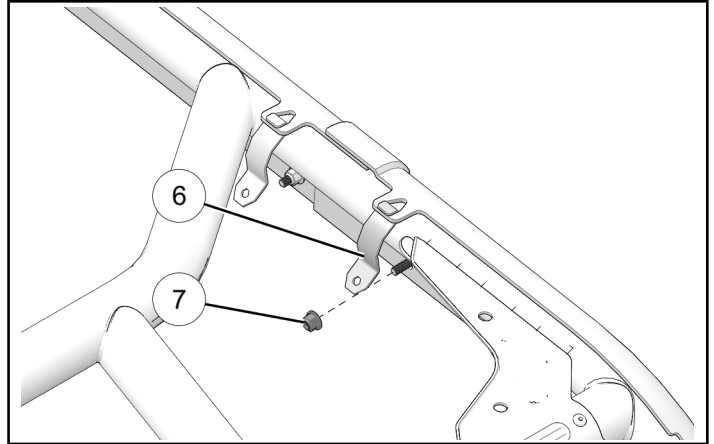

11. Put one fastener ⑧ through one washer ⑨ and through front shroud.

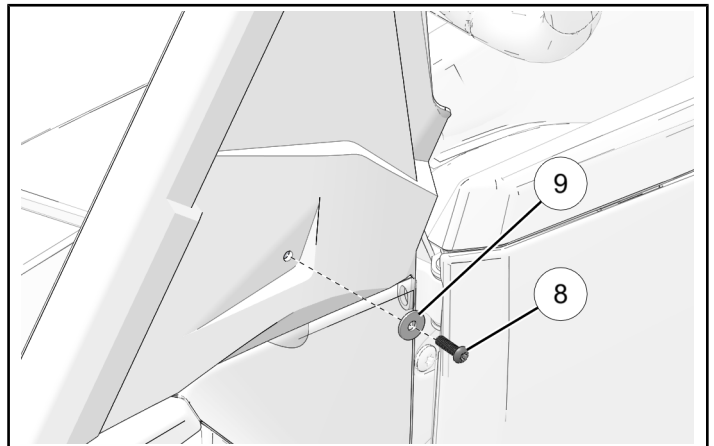

12. Hook J-clip ③ onto ROPS and align with previously installed fastener. Secure with one nut ⑦.

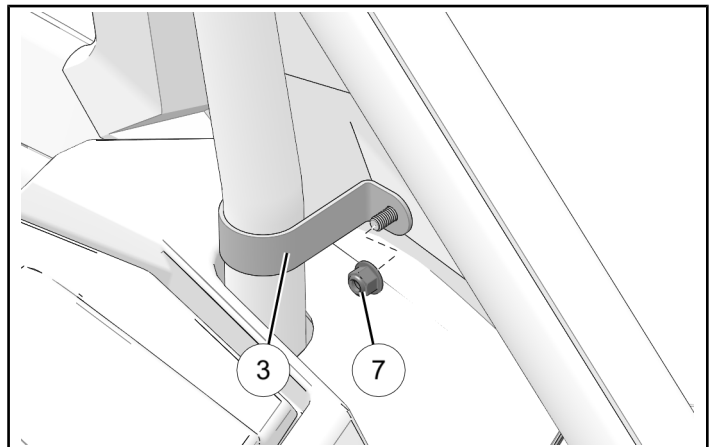



13. Counter-hold nuts ⑦ and torque fasteners ⑧ to specification.

### TORQUE

Shroud Fasteners ⑧:  
**88 in-lbs (10 N·m)**

14. Install the plastic push pin rivet ④.

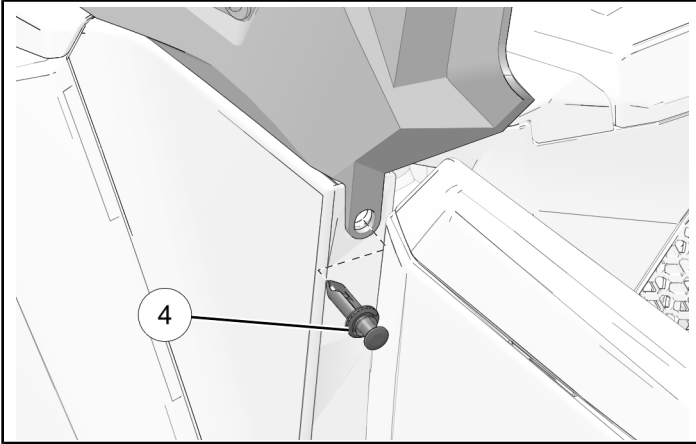

15. Push up seal ⑳ clip onto the shroud. Line up as shown.

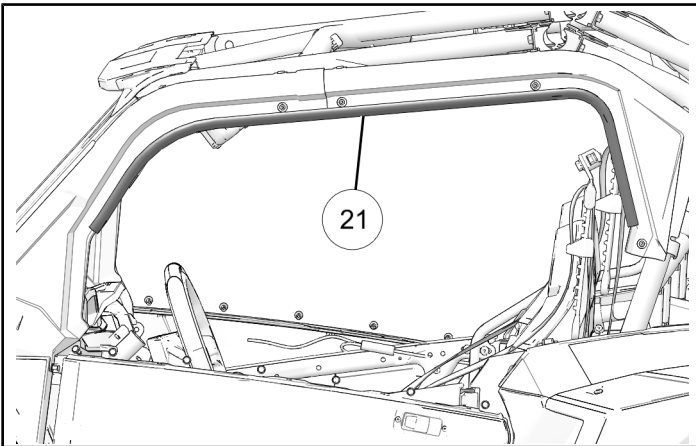

## UPPER DOOR INSTALLATION

### NOTICE

Left side shown, right side similar.

1. Open the door.
2. Remove and keep the nine fasteners from door panel. Remove the door panel from the door frame.

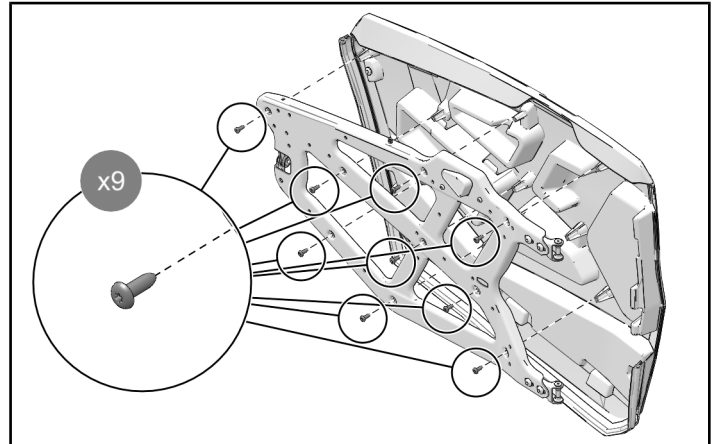

3. Mark door hinge adjustment location prior to removing fasteners. Remove and keep the two rear hinge fasteners. Loosen the two front hinge fasteners but do not remove.

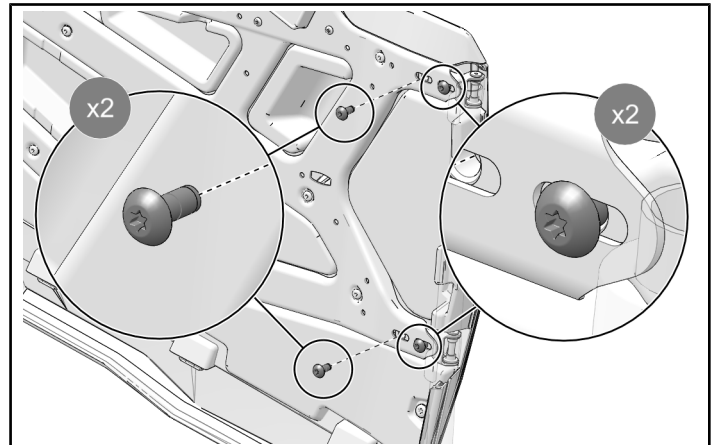

4. Install the upper door frame ① and two rear retained hinge fasteners. Torque all fasteners to specification.

### TORQUE

Door Hinge Fasteners:  
**106 in-lbs (12 N·m)**

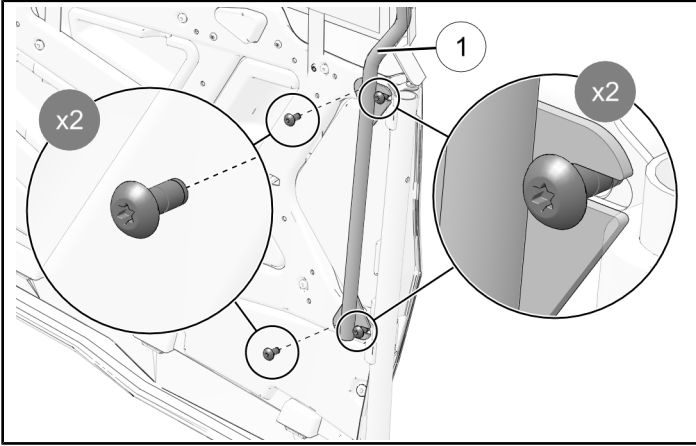

5. Install the four fasteners ⑧, washers ⑨, and nuts ⑦ to attach upper door frame to the door frame. Torque fasteners to specification.

### TORQUE

Upper Door Frame Fasteners ⑧:  
**88 in-lbs (10 N·m)**

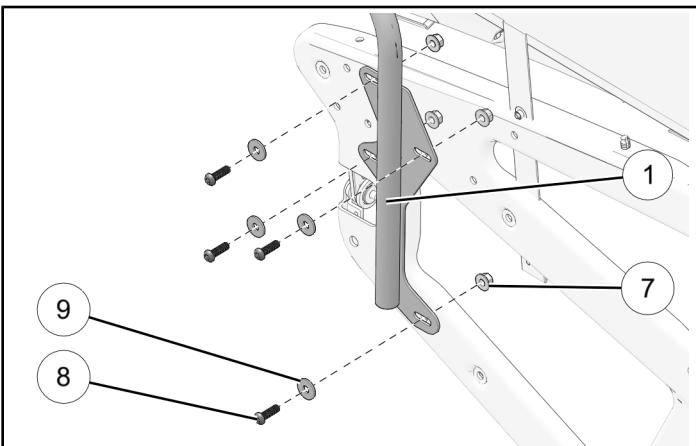

## DOOR HANDLE INSTALLATION

### NOTICE

Left side shown, right side similar.

1. Locate the door panel cutline marks.
2. Drill two holes for fasteners.

### MEASUREMENT

Measurement:  
**3/16 in (5 mm)**

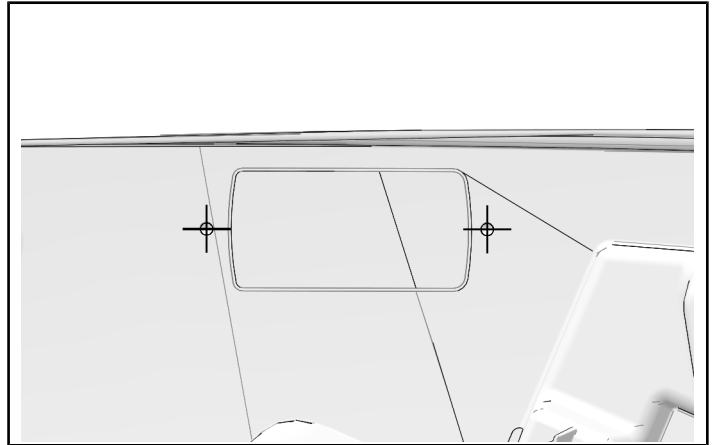

3. Cut plastic within lines of the door handle cutline marks.

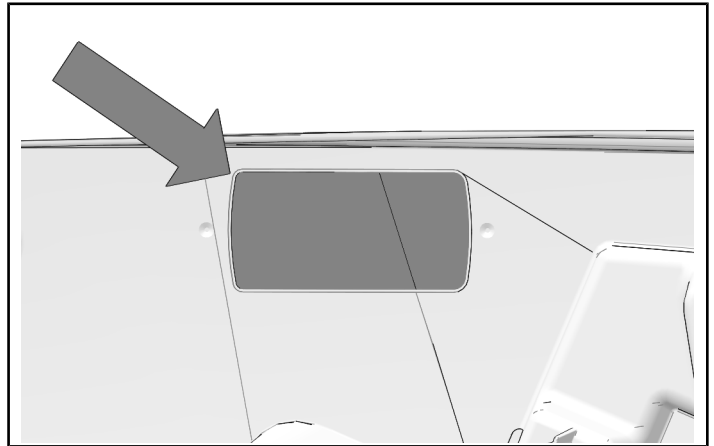

4. Install door handle assembly ⑬ into door panel and attach with two fasteners ⑭ and nuts ⑮. Torque fasteners to specification.

**TORQUE**

Door Handle Fasteners ⑭:  
**18 in-lbs (2 N·m)**

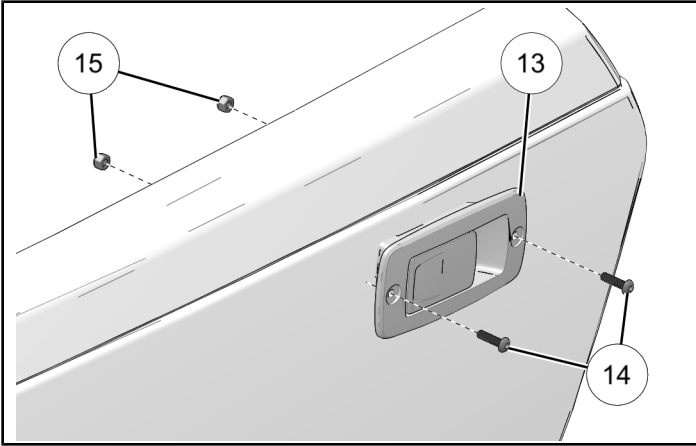

7. Align door panel mounting holes with frame and install the nine retained fasteners. Torque fasteners to specification.

**TORQUE**

Door Panel Fasteners:  
**18 in-lbs (2 N·m)**

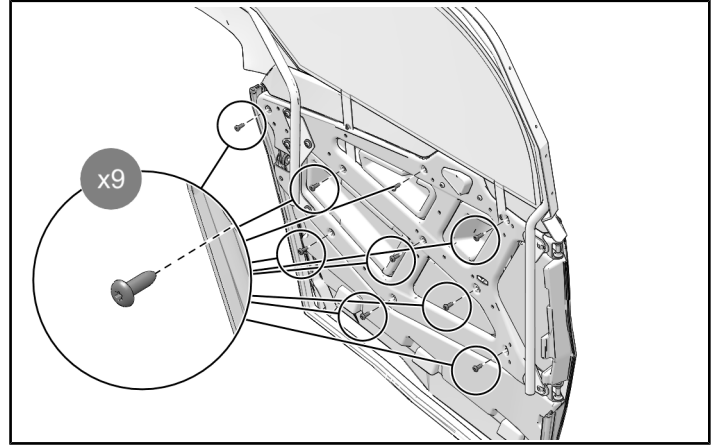

5. Remove and discard door latch cable.

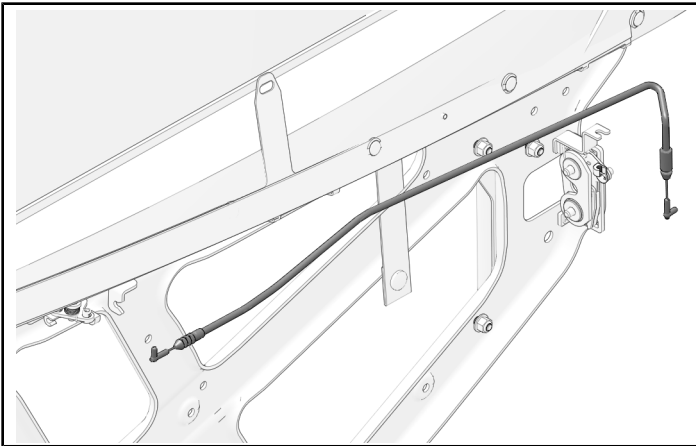

8. Close the door.

6. Place door near door frame and install door latch cable onto inner door actuator and latch.

**NOTICE**

Make sure to secure door latch cable in routing clip.

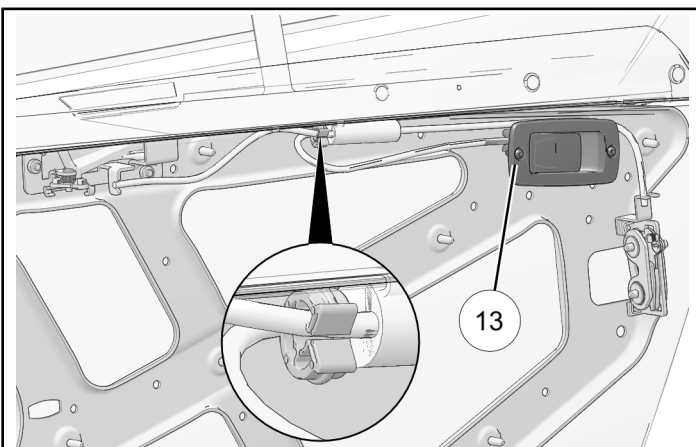

## UPPER DOOR TO LOWER DOOR INSTALLATION

### NOTICE

Left side shown, right side similar.

1. Drill seven holes in lower door using the upper door as a template.

### MEASUREMENT

Measurement:  
**5/16 in (8 mm)**

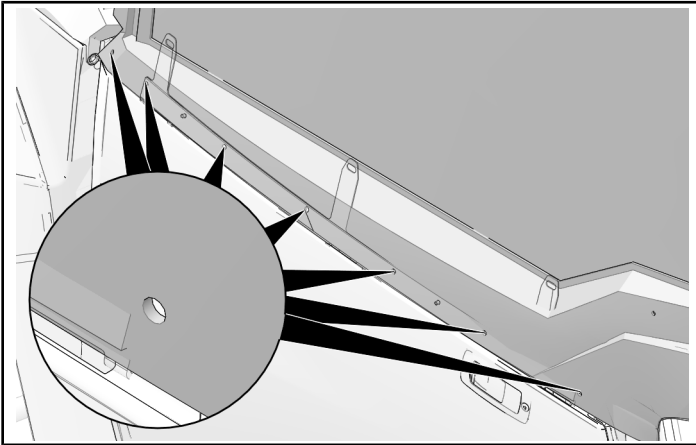

2. Install seven plastic push pin rivets (20) to attach the upper door to the lower door.

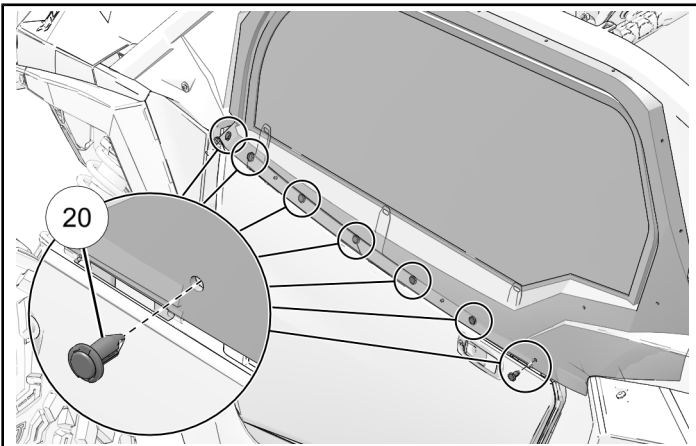

## MULTI-PASSENGER VEHICLES

### DOOR CAB CLOSEOFF INSTALLATION

### NOTICE

Left side shown, right side similar.

1. Open the front and rear doors.
2. Install the door closeoff (21) onto the ROPS tube.

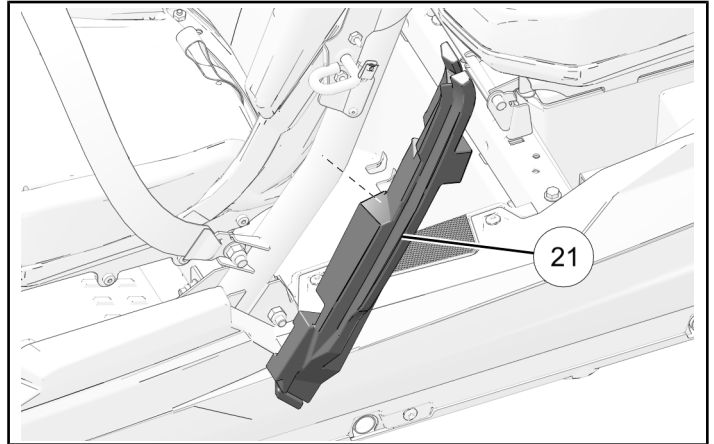

3. Install the two closeoff spacers (25) into the door closeoff.

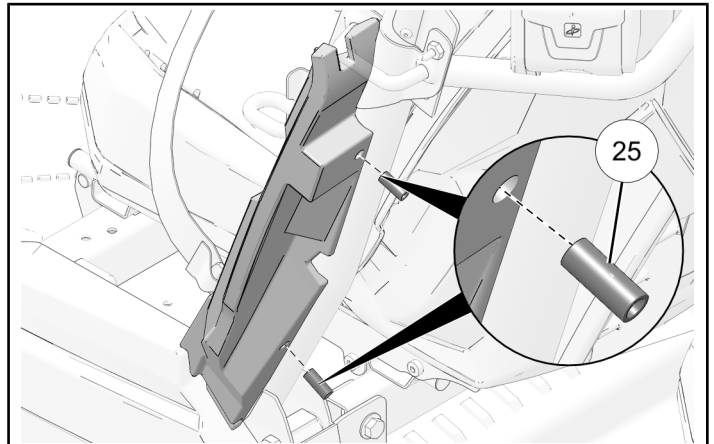



4. Install the two strap clamps (24) around the ROPS tube and align mounting holes with door closeoff. Install the two fasteners (23) through the strap clamps and door closeoff. Secure with two nuts (26) and torque to specification.

### TORQUE

Door Closeoff Fasteners (26):  
88 in-lbs (10 N·m)

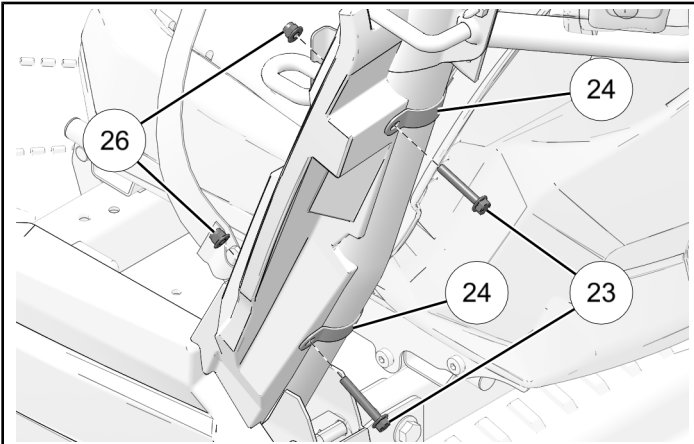

### FRONT SHROUD INSTALLATION

#### NOTICE

Left side shown, right side similar.

1. Remove and discard plastic push pin rivet from the rear pocket fender.

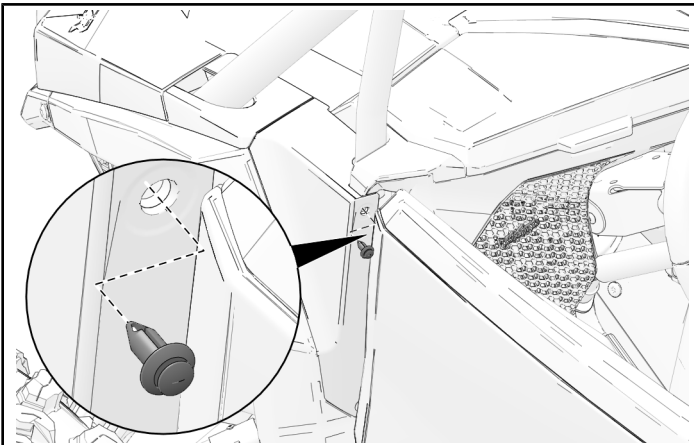

2. Align the middle shroud (18) with the Roll Over Protection System (ROPS).

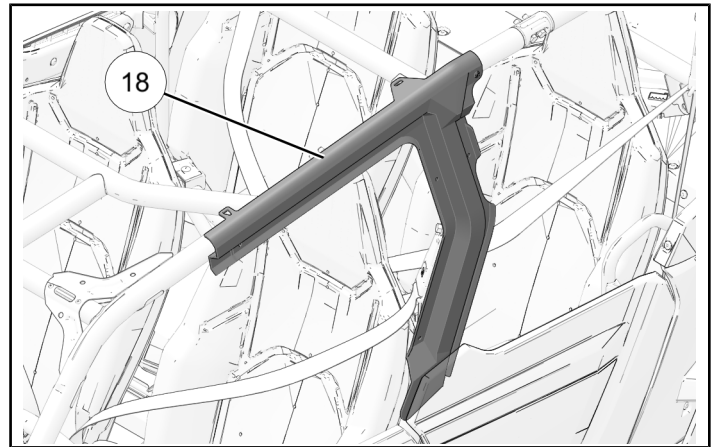

3. Put one fastener (8) through one washer (9) and through middle shroud.

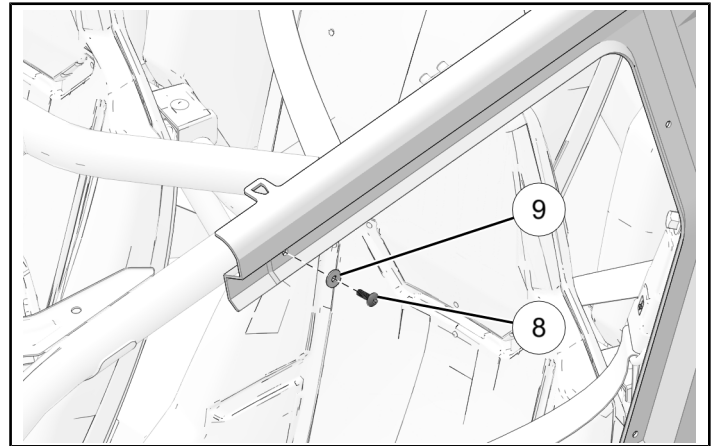

4. Hook clamp (6) into the slot of the middle shroud and align with previously installed fasteners. Secure with nut (7).

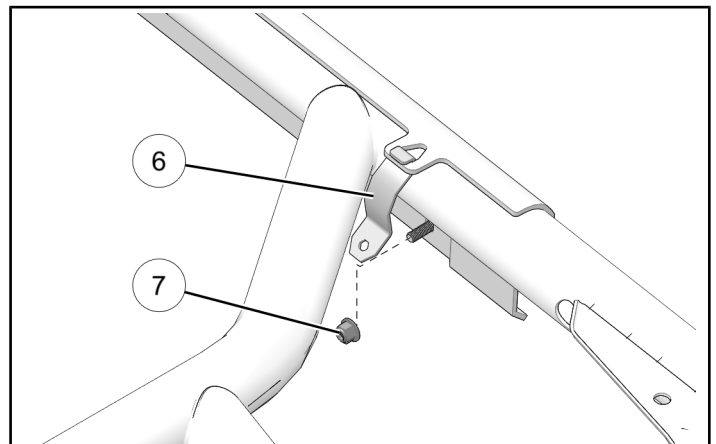

5. Put four fasteners ⑧ through four washers ⑨ and through middle shroud.

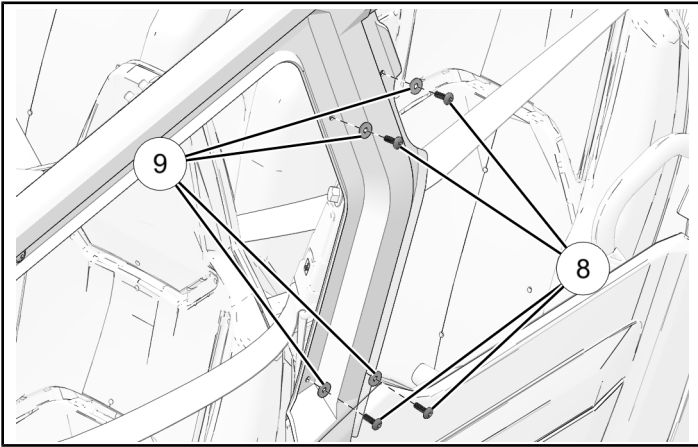

6. Install two mounting clips ③⑨ and align with previously installed fastener. Secure with four nuts ⑦.

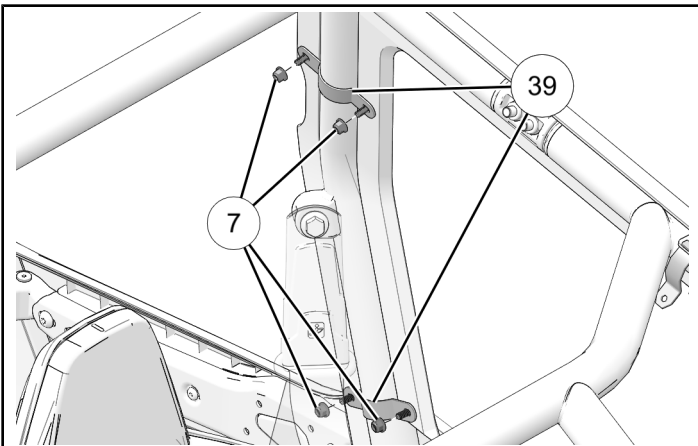

7. Counter-hold nuts ⑦ and torque fasteners ⑧ to specification.

#### TORQUE

Shroud Fasteners ⑧:  
**88 in-lbs (10 N·m)**

8. Align the front shroud ⑩ with the ROPS.

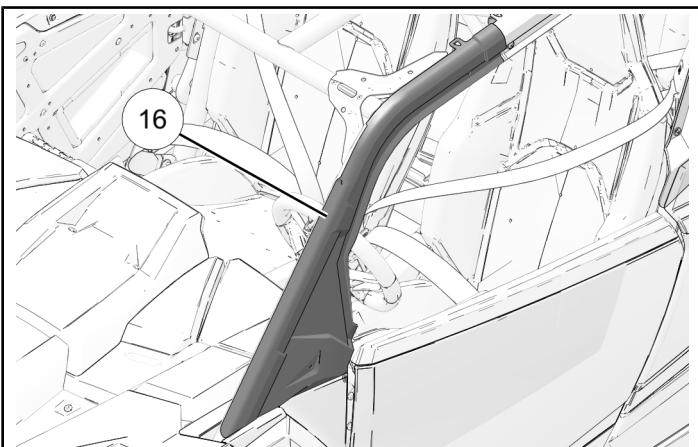

9. Put one fastener ⑧ through one washer ⑨ and through front shroud.

#### TIP

Put silicone sealant where the front and rear shroud meets to aid in water sealing.

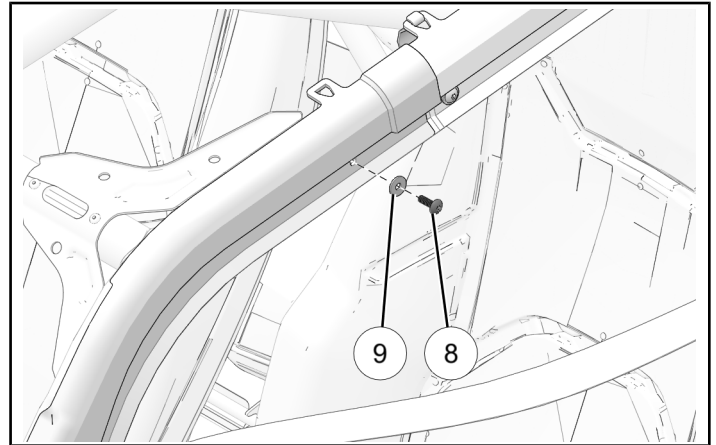

10. Hook clamp ⑥ into the slot of the front shroud and align with previously installed fastener. Secure with one nut ⑦.

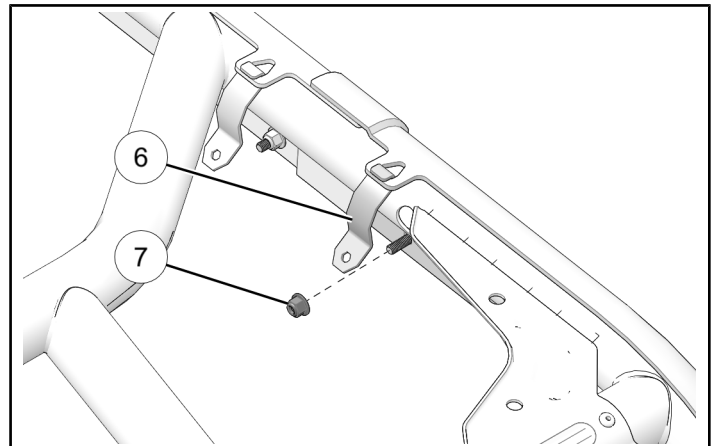

11. Put one fastener ⑧ through one washer ⑨ and through front shroud.

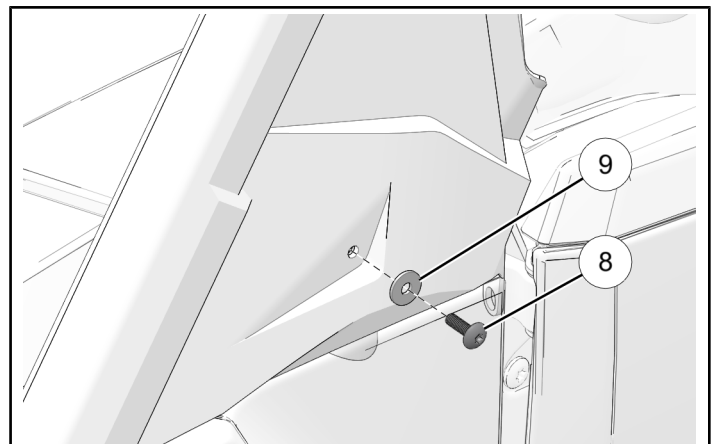

12. Hook J-clip ③ onto ROPS and align with previously installed fastener. Secure with one nut ⑦.

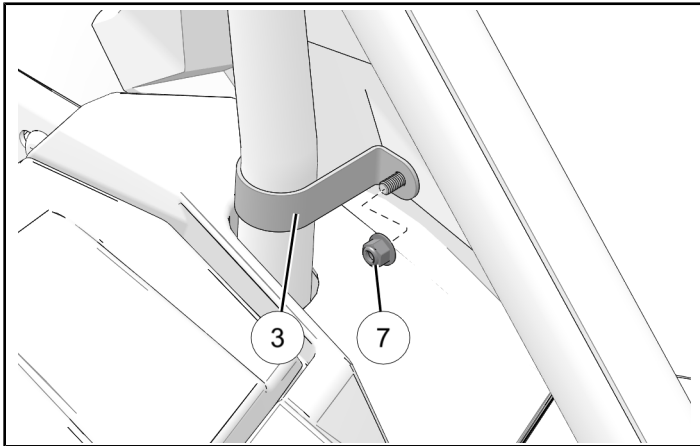

13. Counter-hold nuts ⑦ and torque fasteners ⑧ to specification.

**TORQUE**

Shroud Fasteners ⑧:  
**88 in-lbs (10 N·m)**

14. Install the plastic push pin rivet ④.

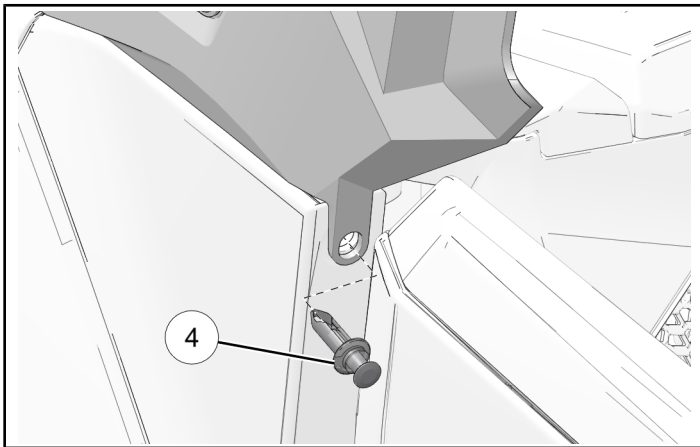

15. Push up seal ④⑧ clip onto the shroud. Line up as shown.

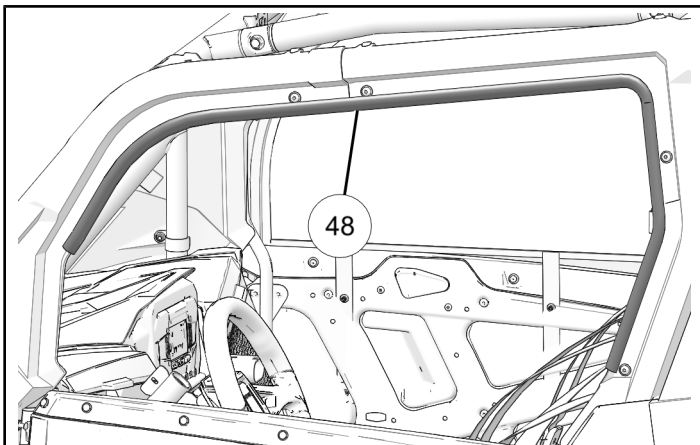

**FRONT UPPER DOOR INSTALLATION**

**NOTICE**

Left side shown, right side similar.

1. Open the door.
2. Remove and keep the nine fasteners from door panel . Remove the door panel from the door frame.

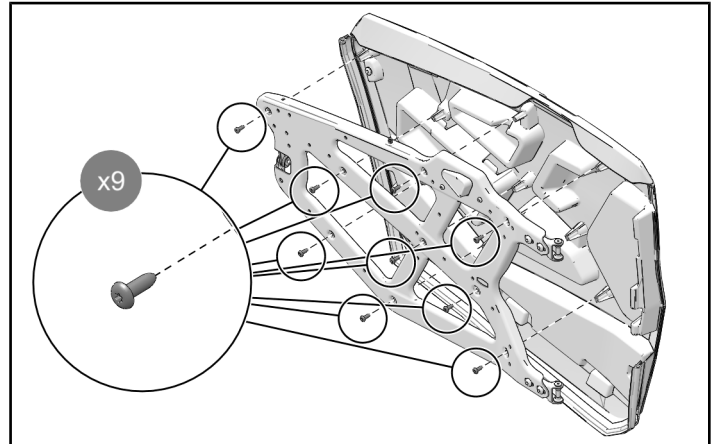

3. Mark door hinge adjustment location prior to removing fasteners. Remove and keep the two rear hinge fasteners. Loosen the two front hinge fasteners but do not remove.

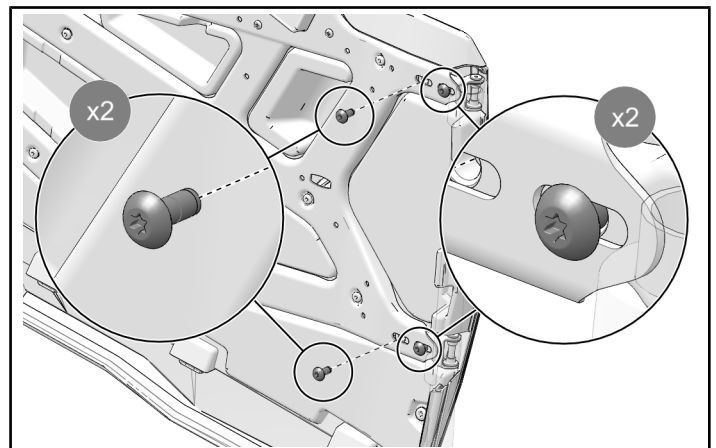

4. Install the upper door frame ① and two rear retained hinge fasteners. Torque all fasteners to specification.

### TORQUE

Door Hinge Fasteners:  
**106 in-lbs (12 N·m)**

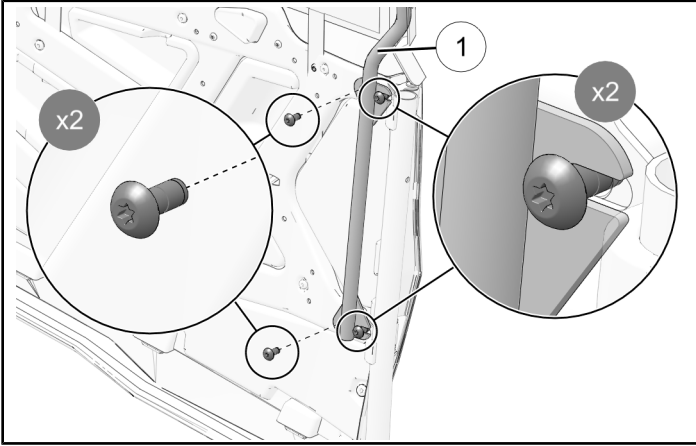

5. Install the four fasteners ⑧, washers ⑨, and nuts ⑦ to attach upper door frame to the door frame. Torque fasteners to specification.

### TORQUE

Upper Door Frame Fasteners ⑧:  
**88 in-lbs (10 N·m)**

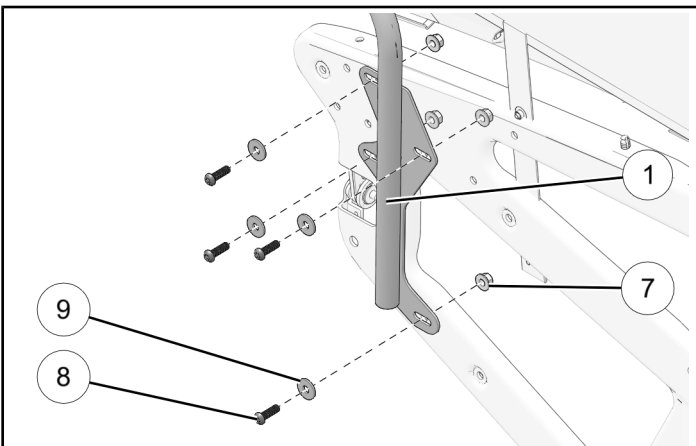

## FRONT DOOR HANDLE INSTALLATION

### NOTICE

Left side shown, right side similar.

1. Locate the door panel cutline marks.
2. Drill two holes for fasteners.

### MEASUREMENT

Measurement:  
**3/16 in (5 mm)**

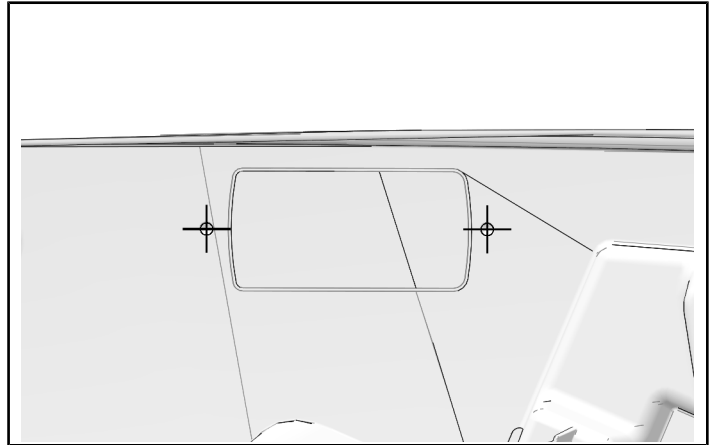

3. Cut plastic within lines of the door handle cutline marks.

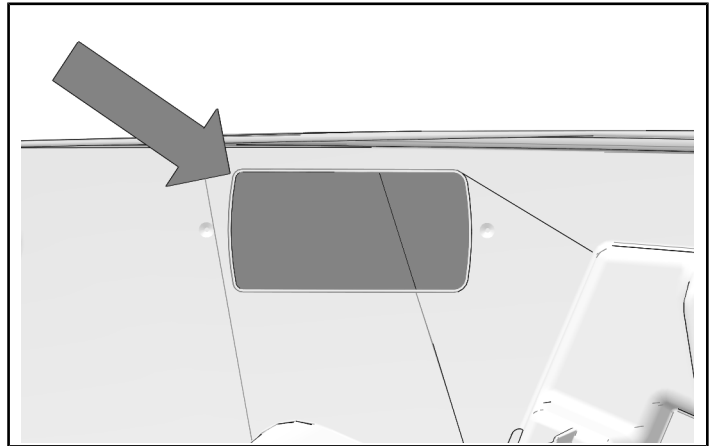



4. Install door handle assembly ⑬ into door panel and attach with two fasteners ⑭ and nuts ⑮. Torque fasteners to specification.

**TORQUE**

Door Handle Fasteners ⑭:  
**18 in-lbs (2 N·m)**

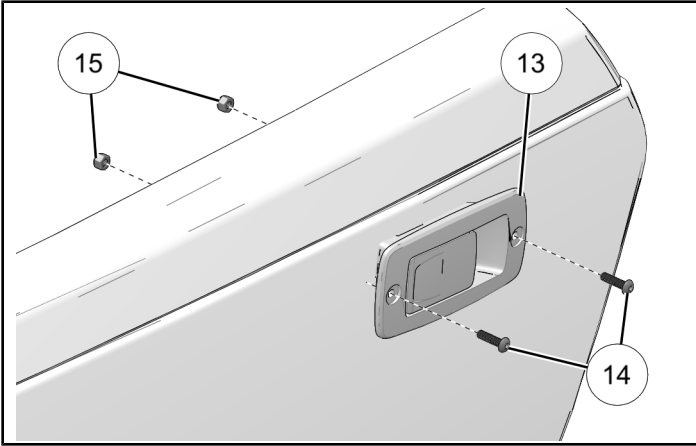

7. Align door panel mounting holes with frame and install the nine retained fasteners. Torque fasteners to specification.

**TORQUE**

Door Panel Fasteners:  
**18 in-lbs (2 N·m)**

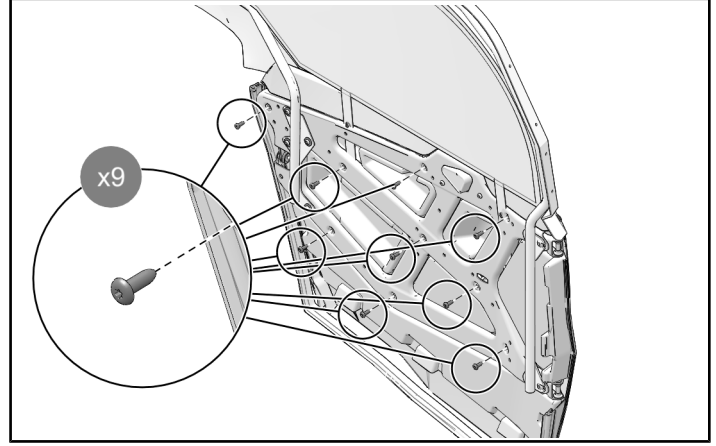

5. Remove and discard door latch cable.

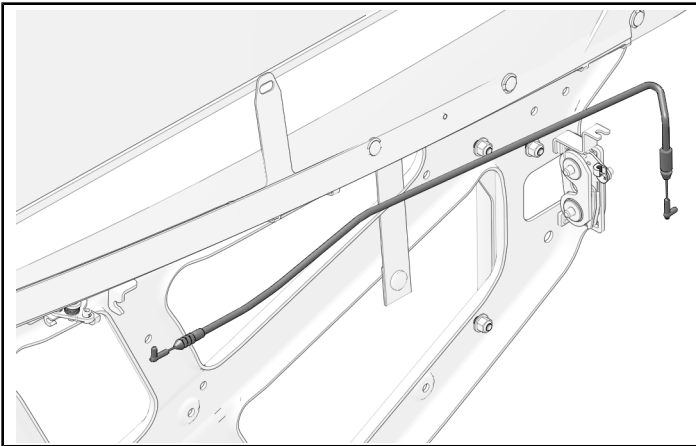

8. Close the door.

6. Place door near door frame and install door latch ⑬ cable onto inner door actuator and latch.

**NOTICE**

Make sure to secure door latch cable in routing clip.

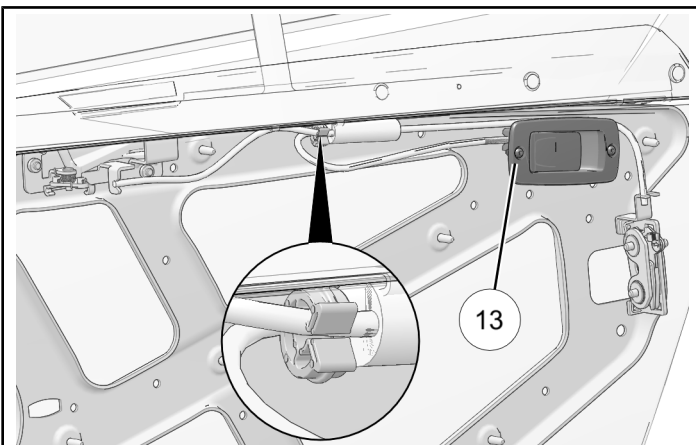

## FRONT UPPER DOOR TO LOWER DOOR INSTALLATION

### NOTICE

Left side shown, right side similar.

1. Drill seven holes in lower door using the upper door as a template.

### MEASUREMENT

Measurement:  
5/16 in (8 mm)

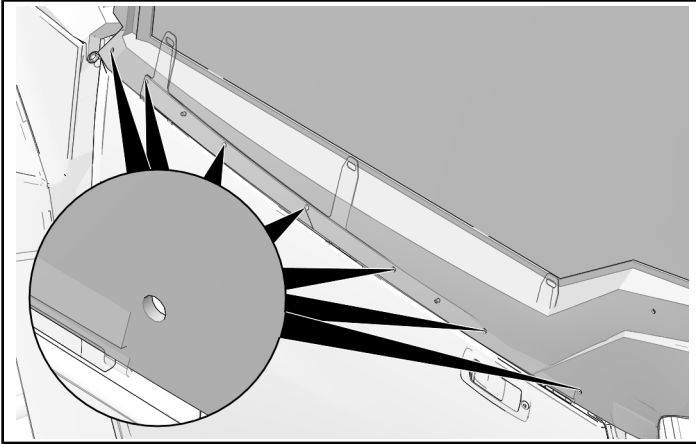

2. Install seven plastic push pin rivets (20) to attach the upper door to the lower door.

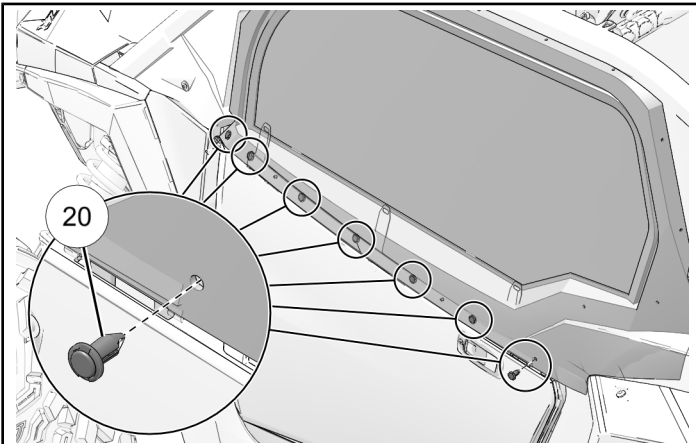

## REAR SHROUD / DOOR INSTALLATION

### NOTICE

Left side shown, right side similar.

1. Align the rear shroud (36) with the Roll Over Protection System (ROPS).

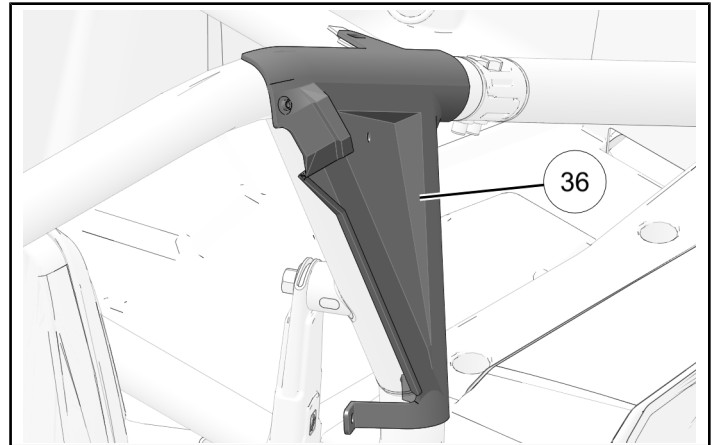

2. Put one fastener (8) through one washer (9) and through rear shroud.

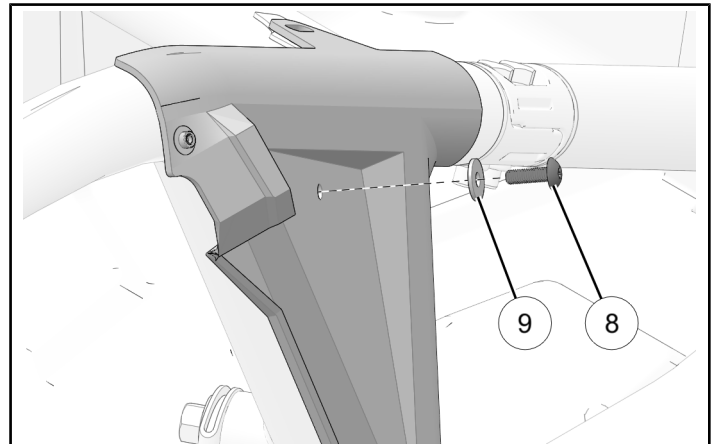

3. Hook clamp (35) onto ROPS and align with previously installed fastener. Secure with one nut (7).

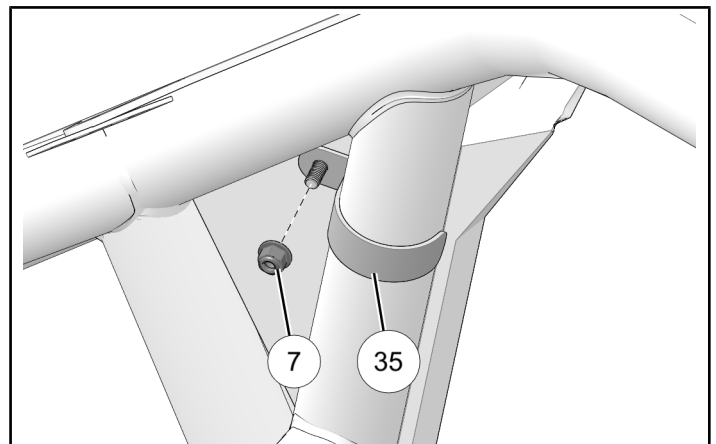

4. Install gas strut ④② onto the rear door frame ③⑧. Secure with one nut ③①.

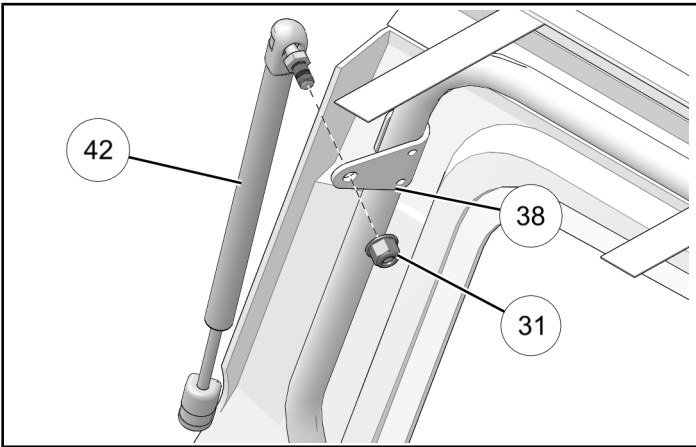

5. Assemble the ROPS clamp base and strap and install ROPS clamp ④⑤ onto ROPS tube. Install fastener ④⑦ and torque fastener to specification.

**NOTICE**

The bottom edge of the ROPS clamp should be 0.78 in (20 mm) from the top of ROPS cross tube.

**TORQUE**

ROPS Clamp Fastener ④⑦:  
**88 in-lbs (10 N·m)**

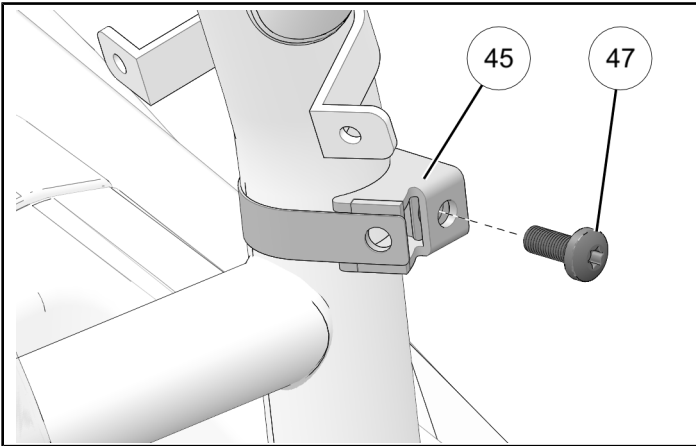

6. Install the gull winch door latch ②⑨ onto the rear door frame ③⑧. Install the two fasteners ②⑦, washers ②⑧, and nuts ③① to attach the gull winch door latch to the door frame. Torque fasteners to specification.

**TORQUE**

Gull Winch Door Latch Fasteners ②⑦:  
**88 in-lbs (10 N·m)**

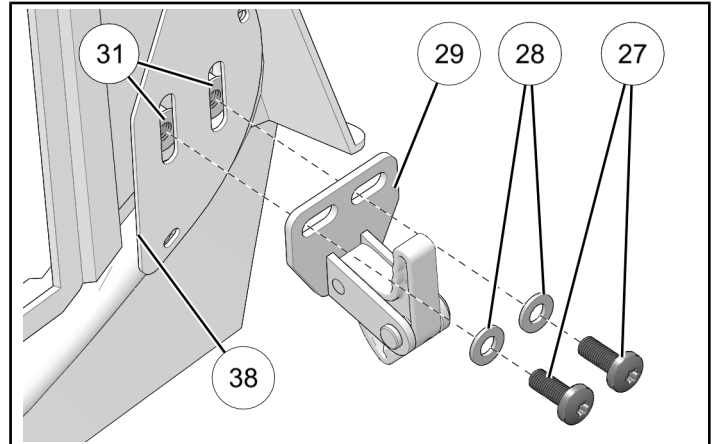

7. Install door hinge worm clamps ④⑩ over the ROPS tube. Snug but do not tighten at this time.

**NOTICE**

Hex on clamp should be facing down on the inside of the bar. Opening of hinge should be facing outward.

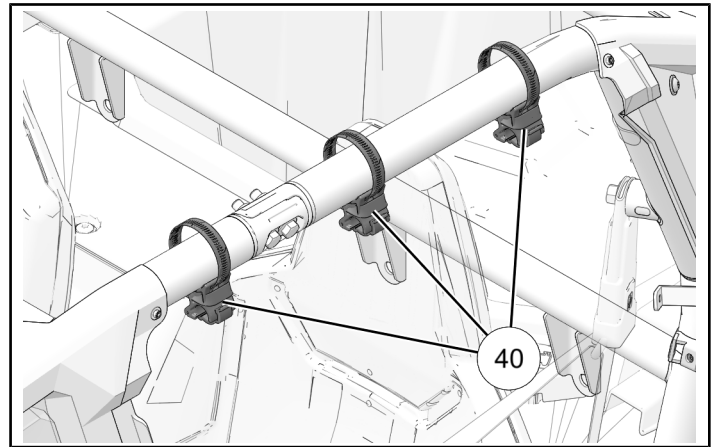

8. Install the hook and loop straps on the door hinge worm clamps before the door is installed.

**NOTICE**

Image for reference only.

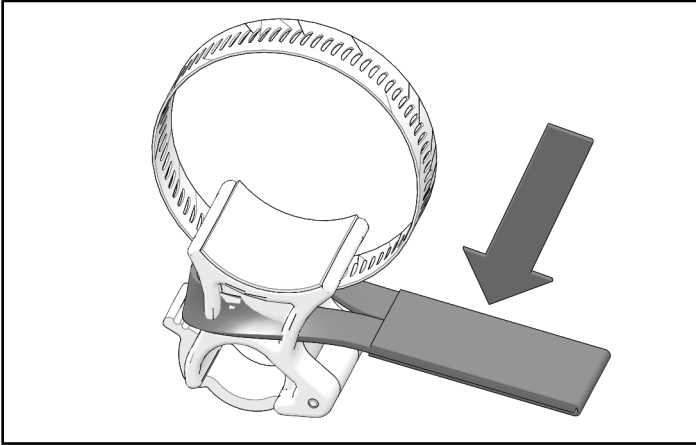

9. Install the rear door/frame (38) into the door hinge worm clamps (40) close the snaps on the hinges and close hook and loop straps.

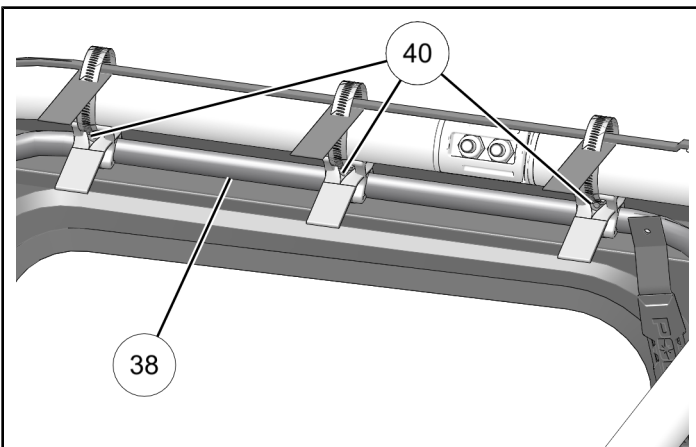

10. Adjust rear door by rotating hinges on ROPS tube so it sits against door jam evenly. Tighten hinge clamps after adjusting.

11. Install nut (44) into ROPS clamp (45) and attach gas strut (42).

**TORQUE**

Gas Strut:  
**88 in-lbs (10 N·m)**

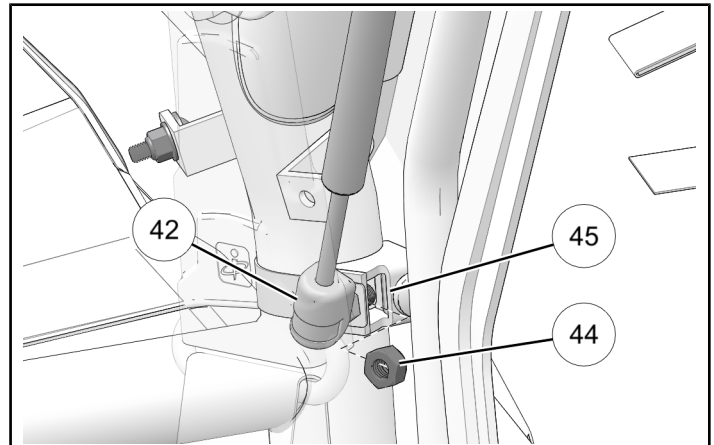



## REAR DOOR HANDLE / UPPER DOOR STRIKER INSTALLATION

### NOTICE

Left side shown, right side similar.

1. Open the rear door.
2. Remove and keep the ten fasteners from door panel. Remove the door panel from the door frame.

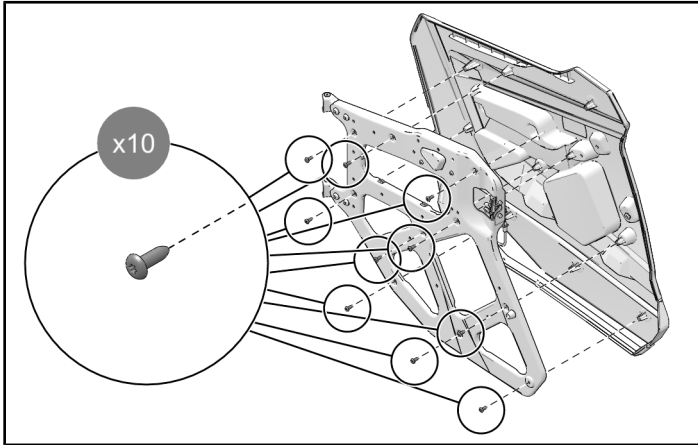

3. Locate the door panel cutline marks.
4. Drill two holes for fasteners.

### MEASUREMENT

Measurement:  
**3/16 in (5 mm)**

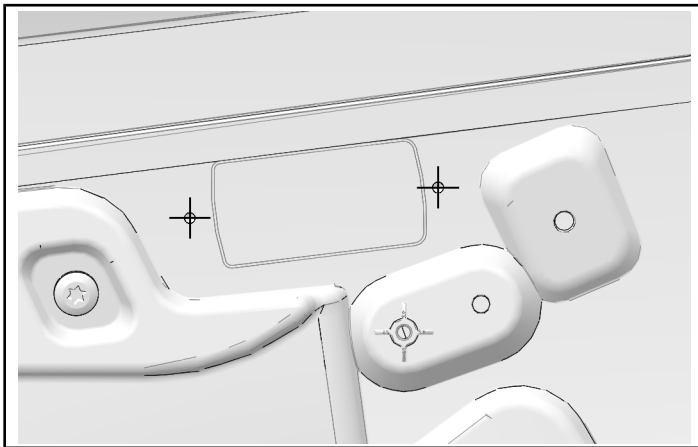

5. Cut plastic within lines of the door handle cutline marks.

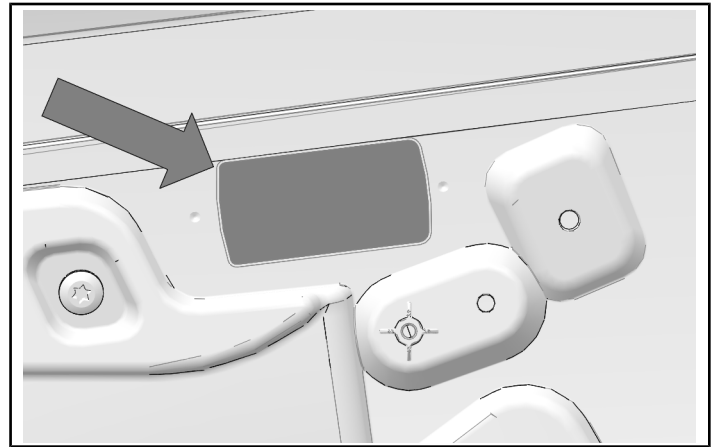

6. Install door handle assembly (46) into door panel and attach with two fasteners (14) and nuts (15). Torque fasteners to specification.

### TORQUE

Door Handle Fasteners (14):  
**18 in-lbs (2 N·m)**

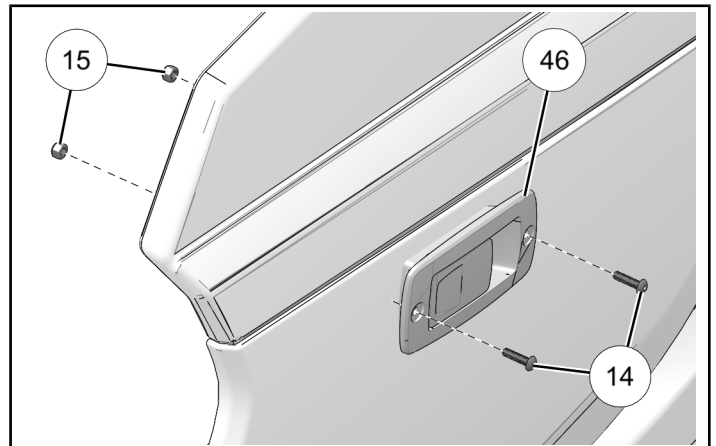

7. Install the rear upper door striker (34) onto the rear lower door frame. Install the two fasteners (32) and nuts (7) to attach the striker to the lower door frame. Torque fasteners to specification.

**TORQUE**

Upper Door Striker Fasteners (32):  
**106 in-lbs (12 N·m)**

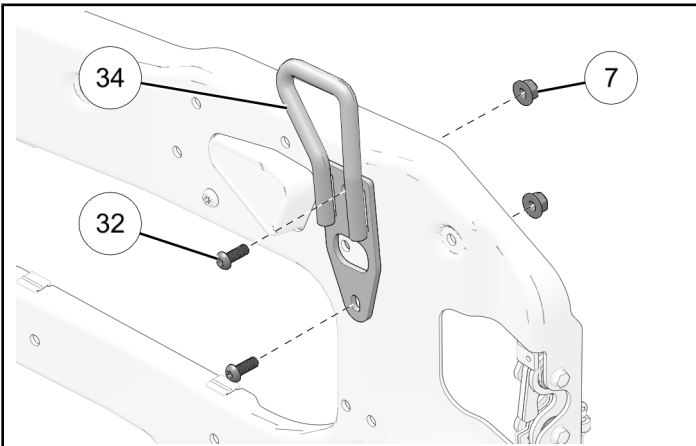

8. Remove and discard door latch cable.

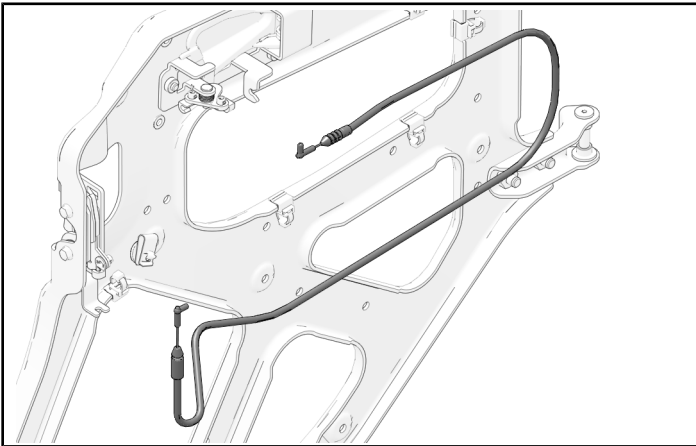

9. Place door near door frame and install door latch (46) cable onto inner door actuator and latch.

**NOTICE**

Make sure to secure door latch cable in routing clip.

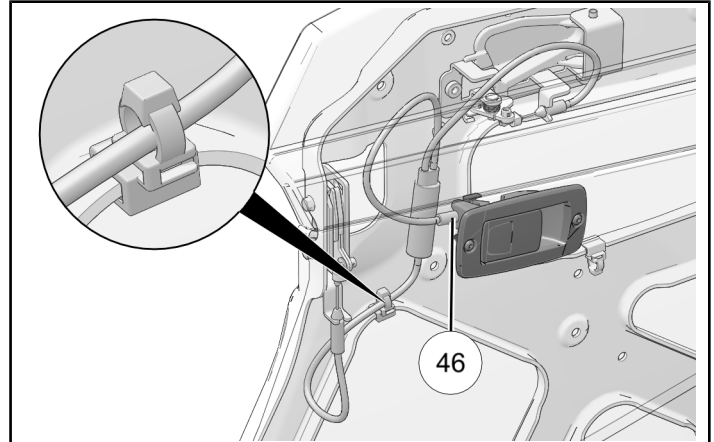

10. Align door panel mounting holes with frame and install the ten retained fasteners. Torque fasteners to specification.

**TORQUE**

Door Panel Fasteners:  
**18 in-lbs (2 N·m)**

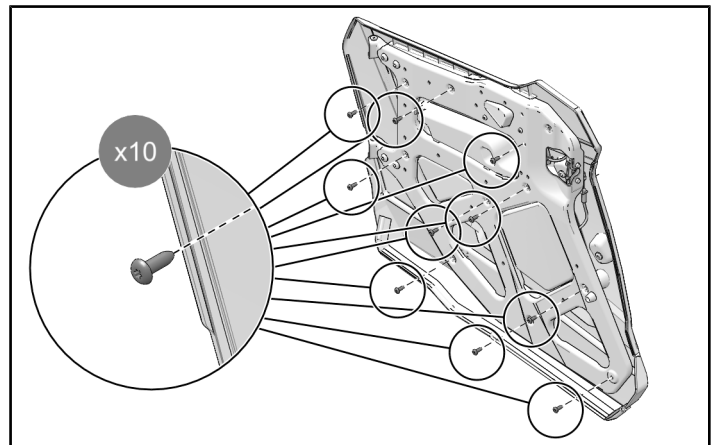

## VEHICLE REASSEMBLY

### PASSENGER STORAGE INSTALLATION

1. Put storage compartment in dashboard.

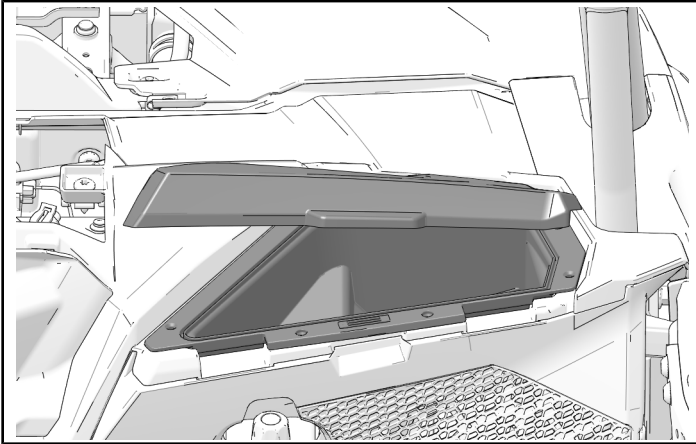

2. Install six storage compartment fasteners. Torque fasteners until fully seated.

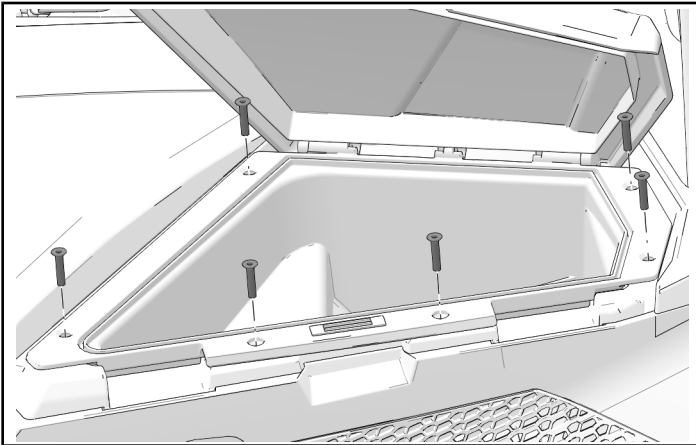

### DRIVER STORAGE INSTALLATION

1. Put storage compartment in dashboard.

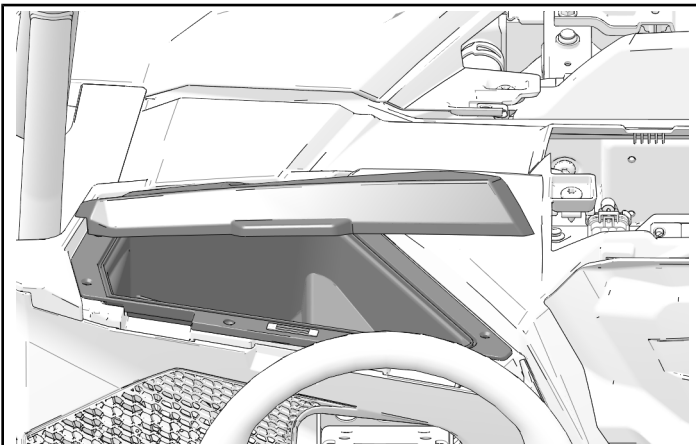

2. Install six storage compartment fasteners. Torque fasteners until fully seated.

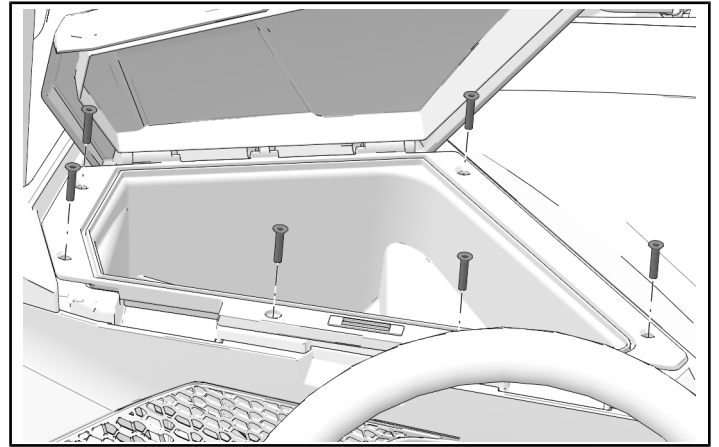

### GENERAL

1. If removed, reinstall accessory upper rear panel.
2. If removed, reinstall accessory or factory-installed roof.

#### IMPORTANT

The top hole of the rear shroud will be used by roof fastener.

3. If removed, reinstall any accessory windshield.

### DOOR ADJUSTMENT

#### FRONT DOORS

The front doors sometimes need some bending at the top to seat to the door shroud correctly. Adjustment is made by placing hand on top of bottom front door to counter hold. Then you can bend the front or rear of the front upper door closer or further away if needed.

REAR DOORS (MULTI-PASSENGER VEHICLES ONLY)

The rear latch has two directions of adjustment, up/down and front/back. Center the rear latch on the striker front to back. The up and down adjustment of the rear latch can be adjusted so it latches as the door seats into the shroud. Make sure latch face is parallel with the striker and not angled.

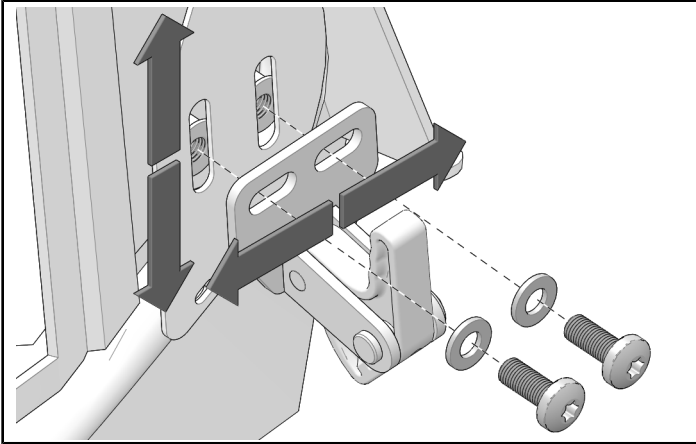

**INSTRUCTION FEEDBACK FORM**

A feedback form has been created for the installer to provide any comments, questions or concerns about the installation instructions. The form is viewable on mobile devices by scanning the QR code or by clicking [HERE](#) if viewing on a PC.

