

# SHOULDER BAG KIT



P/N 2884530

## BEFORE YOU BEGIN

Read these instructions and check to be sure all parts and tools are accounted for. Please retain these installation instructions for future reference and parts ordering information.

## APPLICATION

Verify accessory fitment at [www.polaris.com](http://www.polaris.com).

## KIT CONTENTS

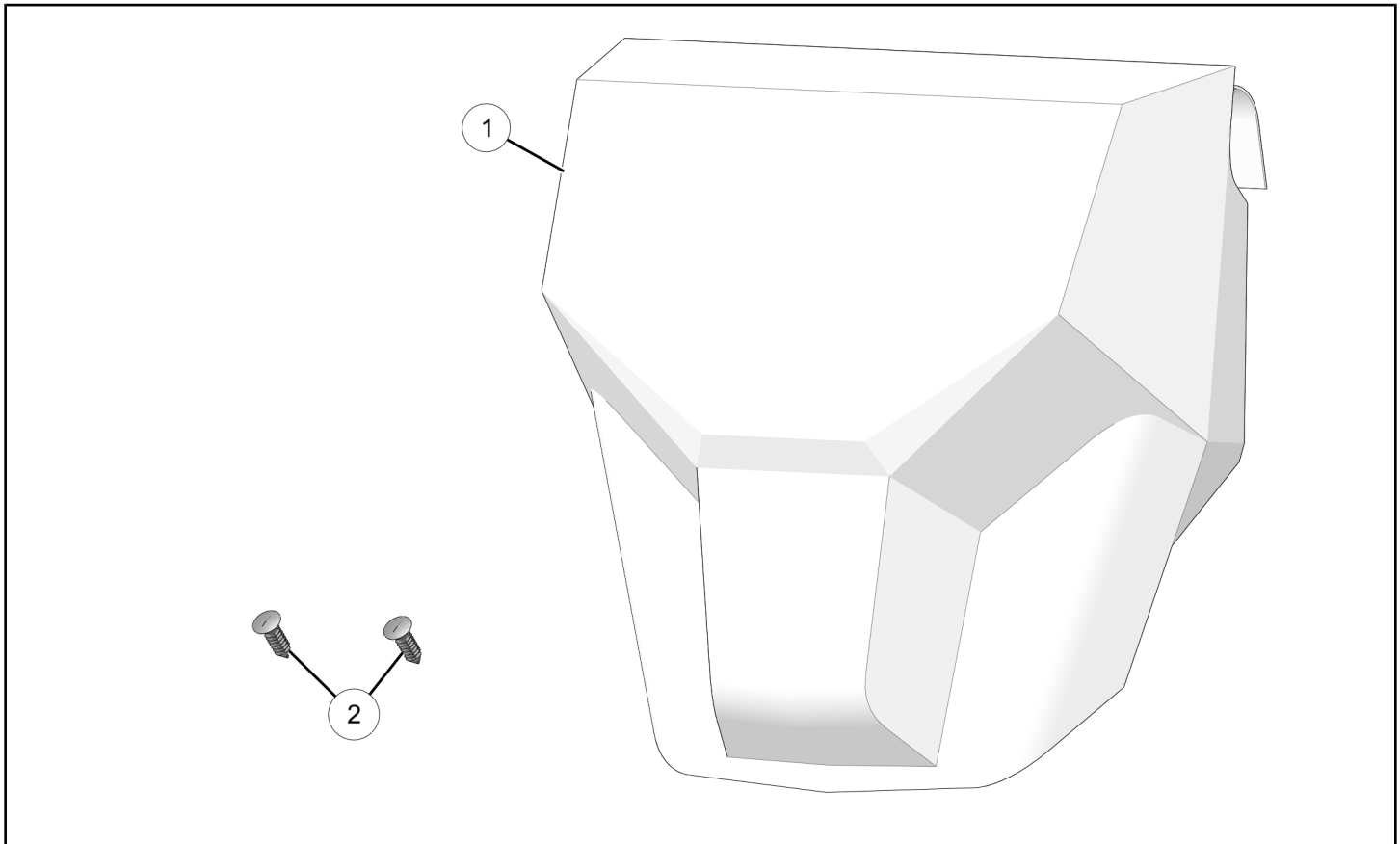

REF	QTY	PART DESCRIPTION	P/N AVAILABLE SEPARATELY
1	1	Bag–Shoulder	n/a
2	2	Clip–Push-Pin	7670141

## TOOLS REQUIRED

- Safety Glasses
- Drill
- Drill Bit:
  - 7 mm

## IMPORTANT

Your Shoulder Bag Kit is exclusively designed for your vehicle. Please read the installation instructions thoroughly before beginning. Installation is easier if the vehicle is clean and free of debris. For your safety, and to ensure a satisfactory installation, perform all installation steps correctly in the sequence shown.

## INSTALLATION INSTRUCTIONS

### VEHICLE PREPARATION

#### GENERAL

1. Park vehicle on a flat surface.
2. Shift vehicle into PARK.
3. Turn key to OFF position and remove key.

### ACCESSORY INSTALLATION

1. Put shoulder bag ① between two front seats.

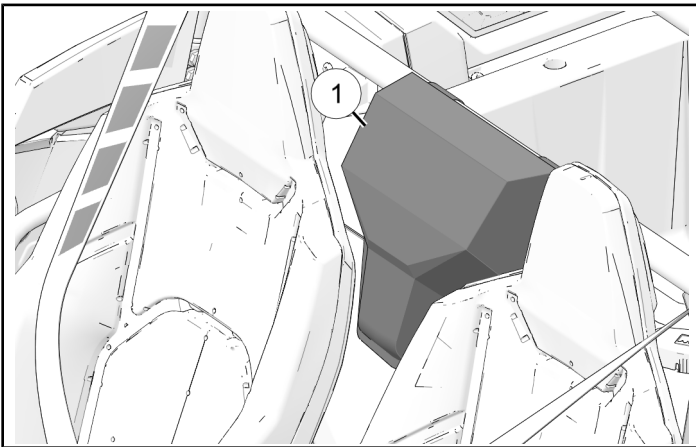

2. Install straps to horizontal roll-cage tube.

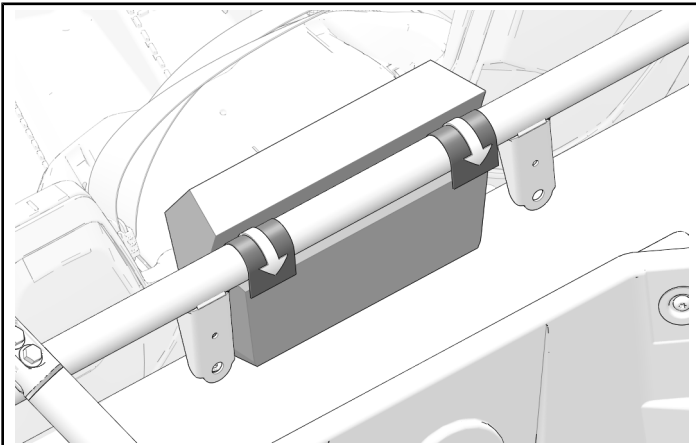

3. Open bag.

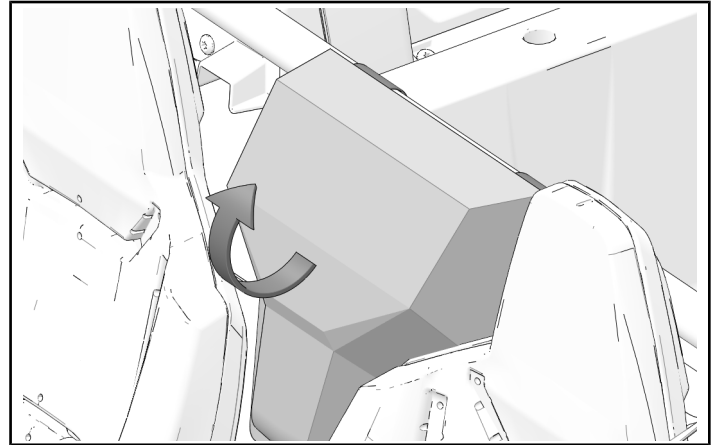

4. Reach in and locate two mounting holes. Mark the rear close-off panel through the two holes.

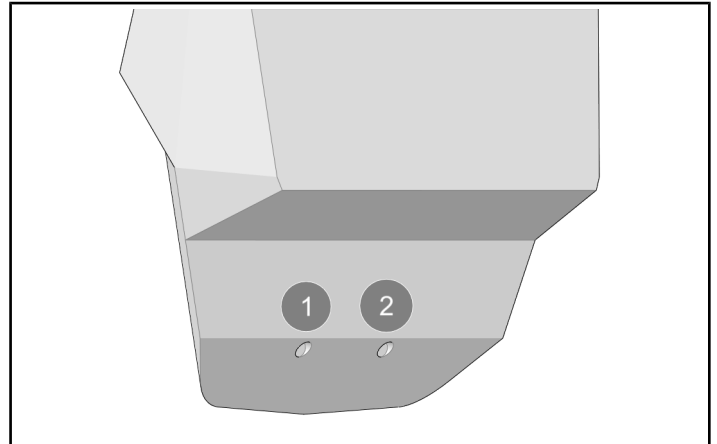

5. Remove bag and set aside.

6. Drill two **7 mm** holes at marked locations.

**IMPORTANT**

Control tool depth. Ensure tool is clear of all other parts and components to prevent damage to vehicle.

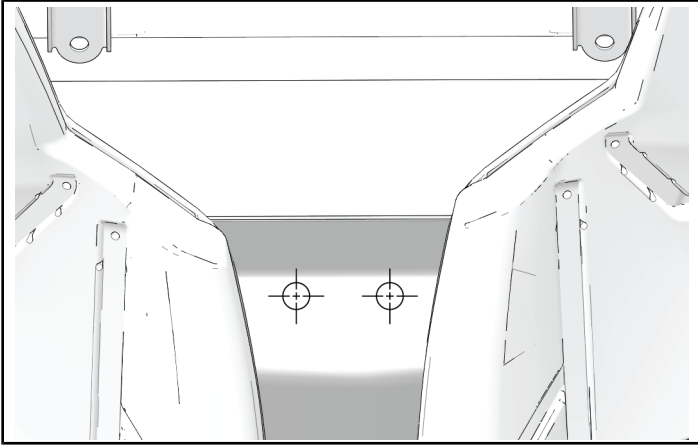

7. Install bag with rear straps and two push-pin clips ② (not shown).

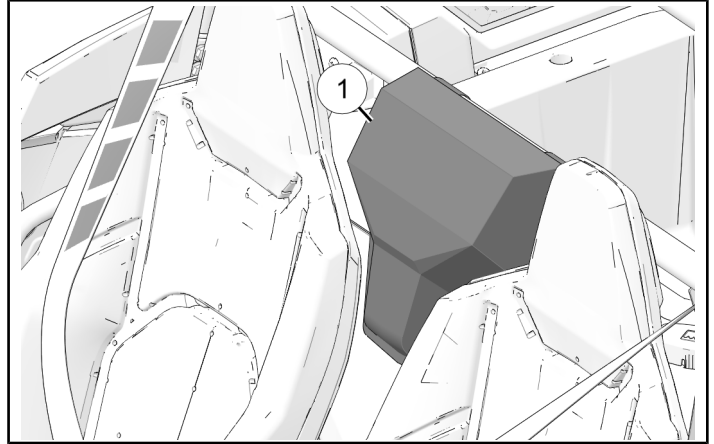

**INSTRUCTION FEEDBACK FORM**

A feedback form has been created for the installer to provide any comments, questions or concerns about the installation instructions. The form is viewable on mobile devices by scanning the QR code or by clicking [HERE](#) if viewing on a PC.

