

HOOD RACK KIT



P/N 2884503; 2889387

MISSING OR DAMAGED PARTS

Before beginning assembly, inspect the kit and its component(s) to be sure all parts and tools are accounted for and not damaged. If missing parts or parts are damaged, please contact your Selling Dealer for assistance.

If your accessory was purchased online, please contact POLARIS® customer service at **1-800-POLARIS** (US & Canada only).

APPLICATION

Verify accessory fitment at www.polaris.com.

REQUIRED SOLD SEPARATELY

Only parts for installation of the Hood Rack Kit are included. Prior installation of the following additional kits are also required (sold separately):

- Hood Rack Kit P/N 2884503 requires *Front Bumper Kit*, P/N 2884494
- Hood Rack Kit P/N 2889387 requires *Bull Bumper Kit*, P/N 2884492

KIT CONTENTS

HOOD RACK P/N 2884503

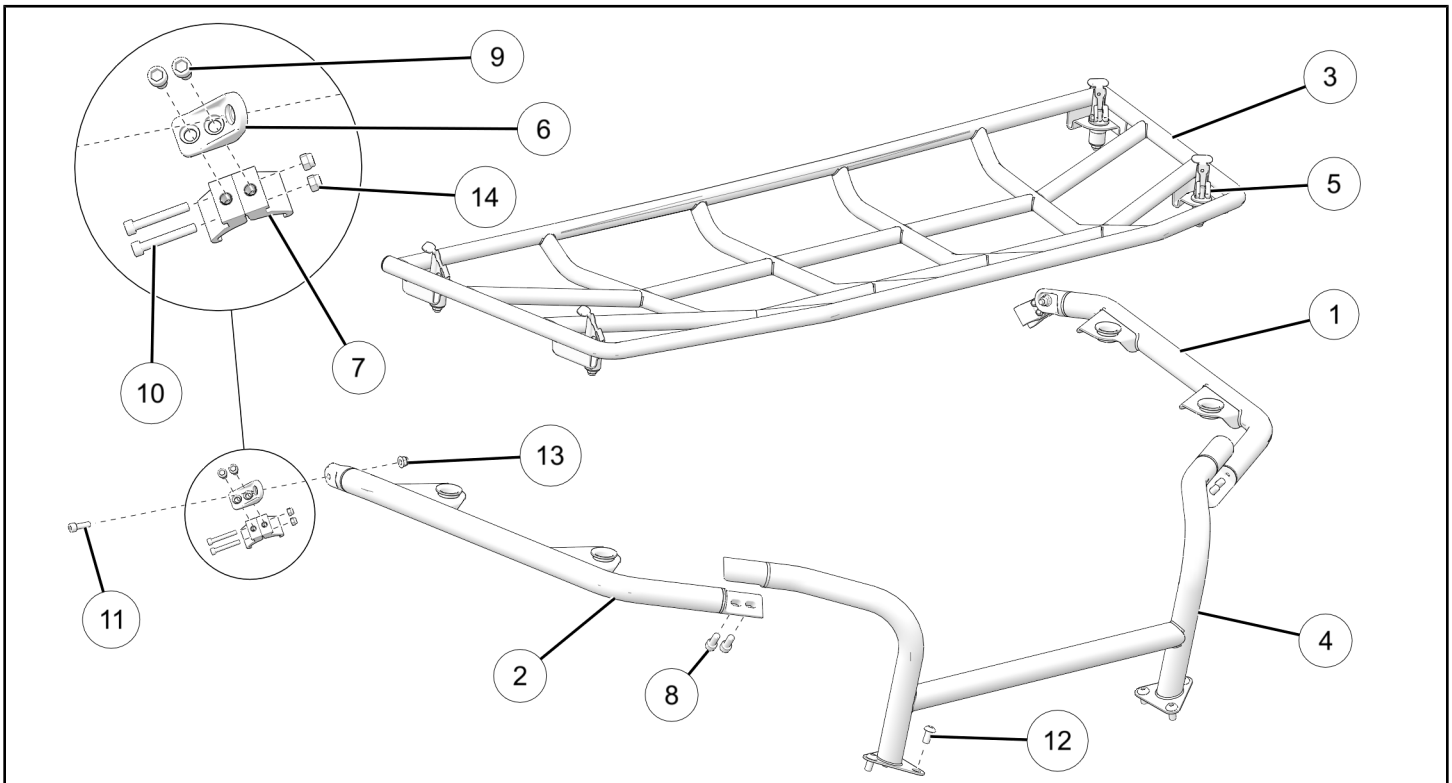

REF	QTY	PART DESCRIPTION	P/N AVAILABLE SEPARATELY	AVAILABLE SERVICE KIT
1	1	Weld – Hood Rack, Left	n/a	n/a
2	1	Weld – Hood Rack, Right	n/a	n/a

REF	QTY	PART DESCRIPTION	P/N AVAILABLE SEPARATELY	AVAILABLE SERVICE KIT
3	1	Weld – Hood Rack, Main	n/a	n/a
4	1	Weld – Hood Rack, HD Bumper	n/a	n/a
5	4	Kit – Lock and Ride® Anchor	2876420	2209167
6	2	Cast – Mount, Hood Rack	5639275	2209167
7	4	Clamp – Mount, Hood Rack	7082814	2209167
8	4	Screw – Socket Head M10 x 1.5 x 25 mm	7517358	2209167
9	4	Screw – Socket Head M8 x 1.25 x 16 mm	7517569	2209167
10	4	Screw – Socket Head M6 x 1.0 x 40 mm	7518780	2209167
11	2	Screw – Socket Head M8 x 1.25 x 25 mm	7520170	2209167
12	6	Screw – Button Head M10 x 1.5 x 20 mm	7520338	2209167
13	2	Nut – Hex Flange M8 x 1.25 mm	7547454	2209167
14	4	Nut – Hex M6 x 1.0 mm	7547505	2209167

HOOD RACK P/N 2889387

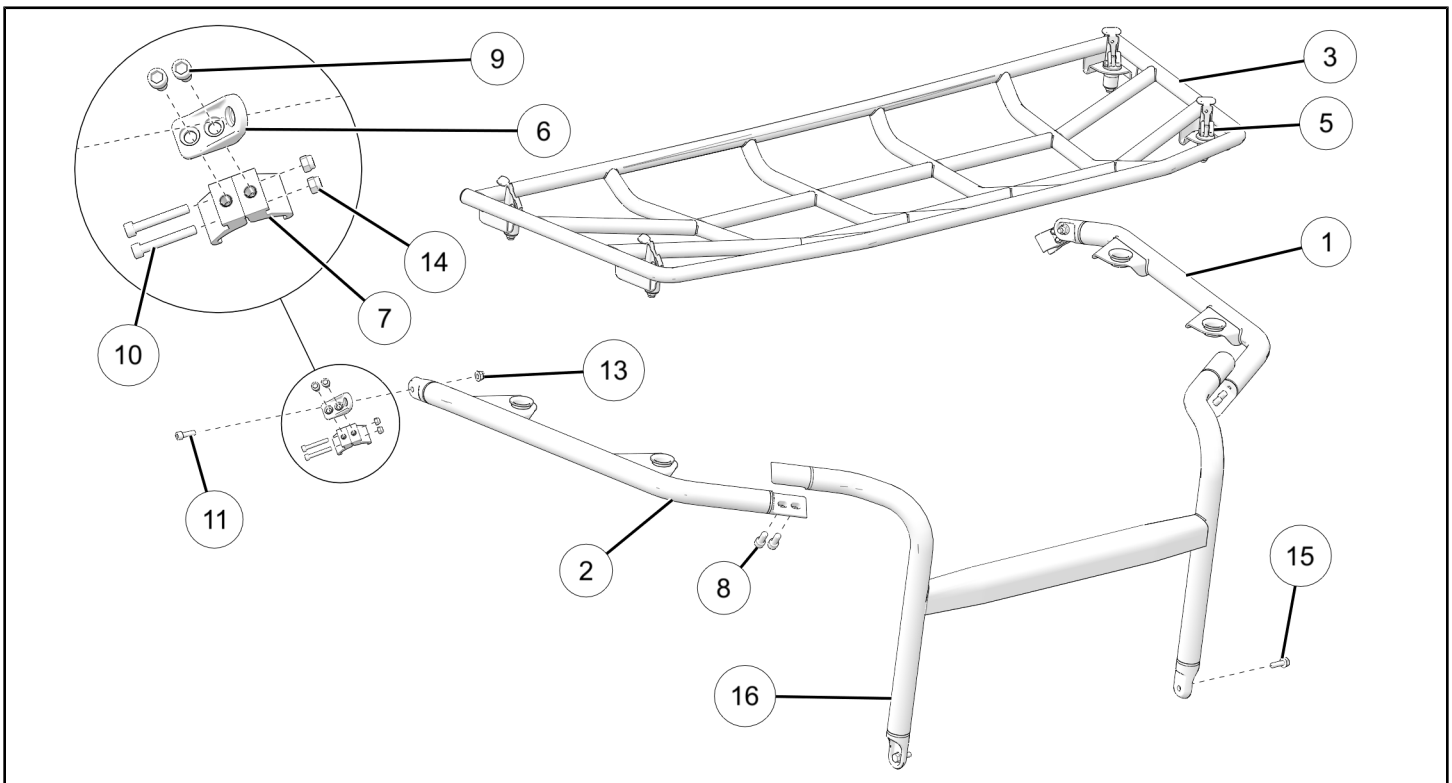

REF	QTY	PART DESCRIPTION	P/N AVAILABLE SEPARATELY	AVAILABLE SERVICE KIT
1	1	Weld – Hood Rack, Left	n/a	n/a
2	1	Weld – Hood Rack, Right	n/a	n/a
3	1	Weld – Hood Rack, Main	n/a	n/a
5	4	Kit – Lock and Ride® Anchor	2876420	2209195
6	2	Cast – Mount, Hood Rack	5639275	2209195

REF	QTY	PART DESCRIPTION	P/N AVAILABLE SEPARATELY	AVAILABLE SERVICE KIT
7	4	Clamp – Mount, Hood Rack	7082814	2209195
8	4	Screw – Socket Head M10 x 1.5 x 25 mm	7517358	2209195
9	4	Screw – Socket Head M8 x 1.25 x 16 mm	7517569	2209195
10	4	Screw – Socket Head M6 x 1.0 x 40 mm	7518780	2209195
11	2	Screw – Socket Head M8 x 1.25 x 25 mm	7520170	2209195
13	2	Nut – Hex Flange M8 x 1.25 mm	7547454	2209195
14	4	Nut – Hex M6 x 1.0 mm	7547505	2209195
15	2	Screw – Hex Flange Head M8 x 1.25 x 25 mm	7516734	2209195
16	1	Weld – Hood Rack, Bull Bumper	n/a	n/a

TOOLS REQUIRED

- Safety Glasses
- File, Flat
- Socket Set, Hex Bit, Metric
- Socket Set, Metric
- Socket Set, Torx® Bit
- Torque Wrench
- Utility Knife/Cutting Tool

IMPORTANT

Your Hood Rack Kit is exclusively designed for your vehicle. Please read the installation instructions thoroughly before beginning. Installation is easier if the vehicle is clean and free of debris. For your safety, and to ensure a satisfactory installation, perform all installation steps correctly in the sequence shown.

INSTALLATION INSTRUCTIONS

VEHICLE PREPARATION

GENERAL

1. Park vehicle on a flat surface.
2. Shift vehicle into PARK.
3. Turn key to OFF position and remove key.

REMOVE LOWER A PILLAR TRIM

NOTICE

If vehicle is equipped with poly windshield, removal of lower mounting hardware may make removal of lower A-pillar trim easier.

1. Remove three screws from lower A-pillar trim panel.

NOTICE

Right side shown; left side similar.

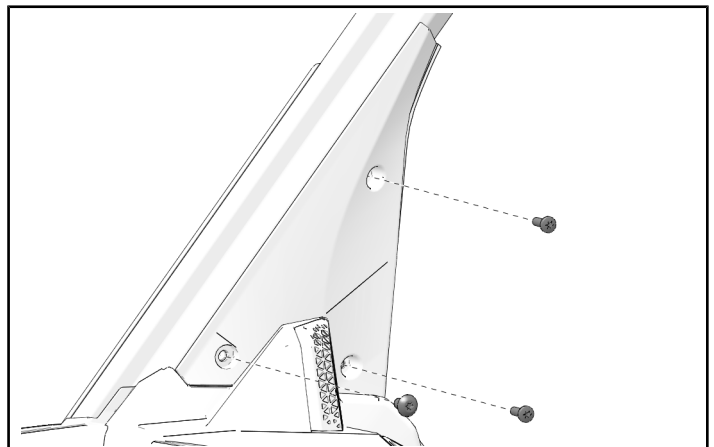

2. Pull A-pillar trim piece away from vehicle.

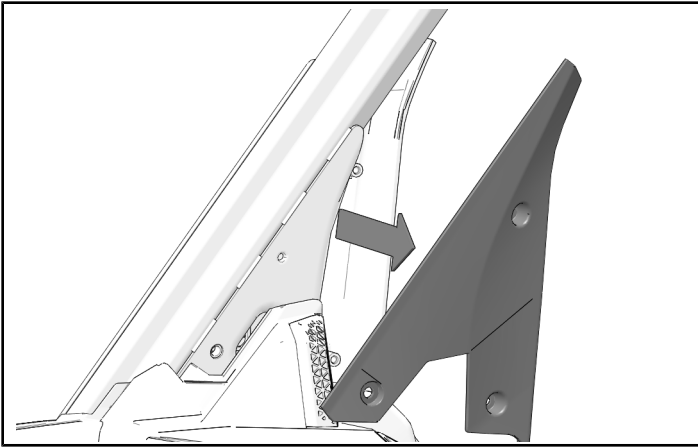

VEHICLES EQUIPPED WITH TIP-OUT WINDSHIELD

NOTICE

Left side shown; Right side similar.

1. Open tip-out windshield. Install a support to hold weight of windshield.
2. Use appropriate tool to release clip at lower end of gas spring.

CAUTION

Use care when releasing the clip. Clip may spring away from fitting, and may strike objects or become lost.

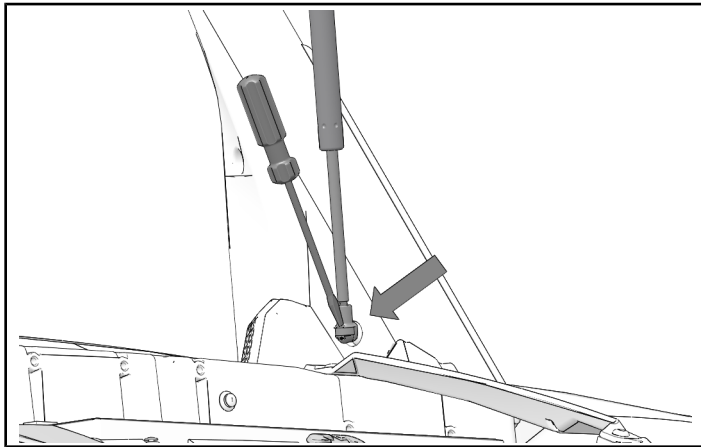

3. Disconnect bottom of gas springs.

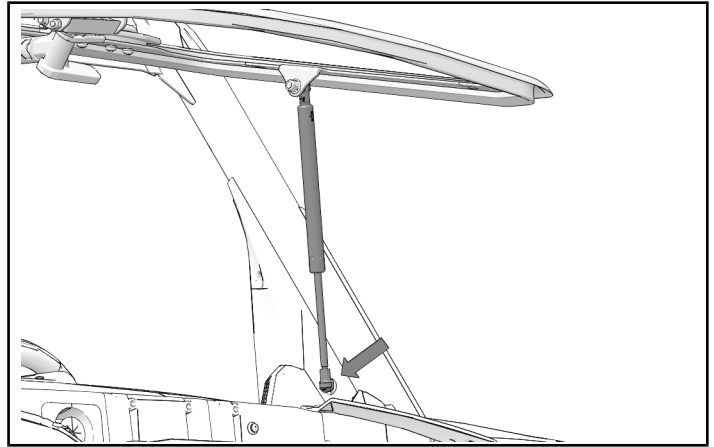

4. Remove two screws and ball stud from lower A-pillar trim panel.

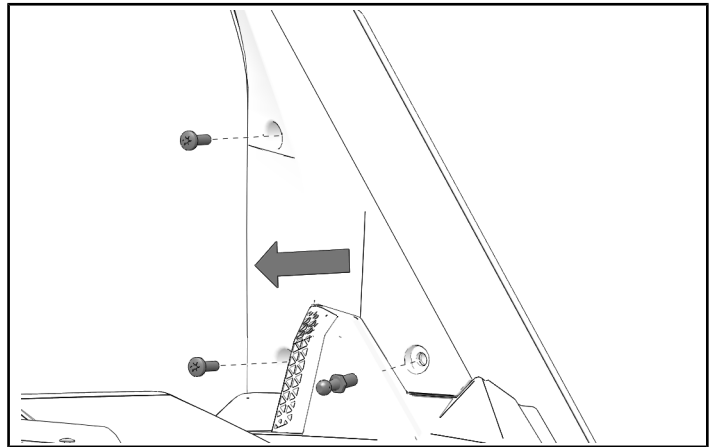

5. Pull A-pillar trim piece away from vehicle.

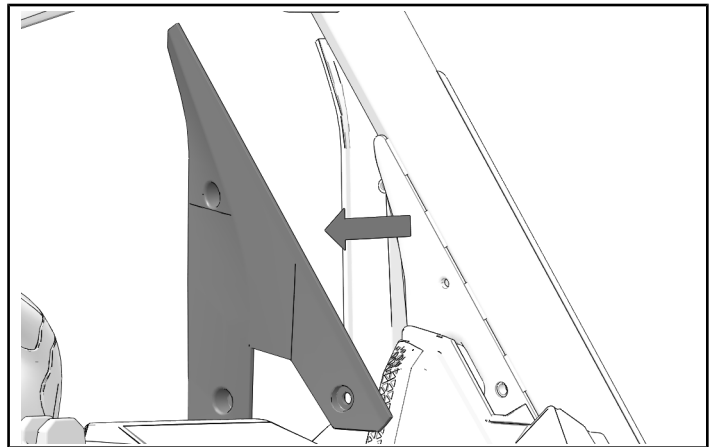

ACCESSORY INSTALLATION

FRONT RACK INSTALLATION (P/N 2884503)

1. Remove screws that hold the tube loop on the top of the HD bumper.

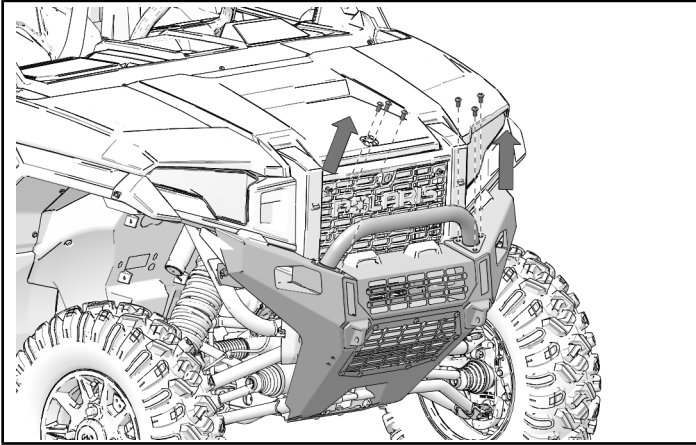

2. Remove the tube loop from the HD bumper.

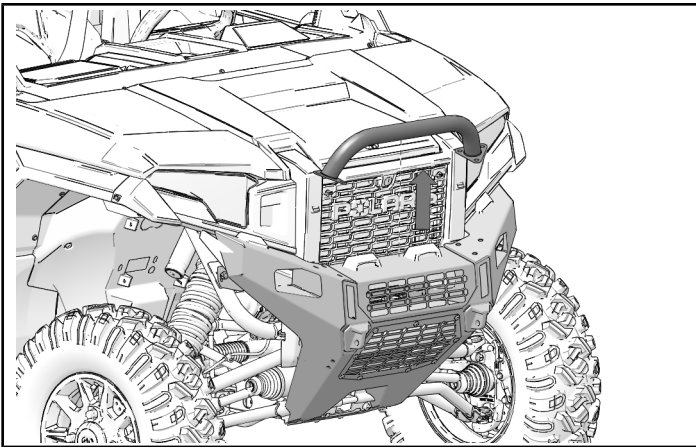

3. Install hood rack ④ on the top of the HD bumper.

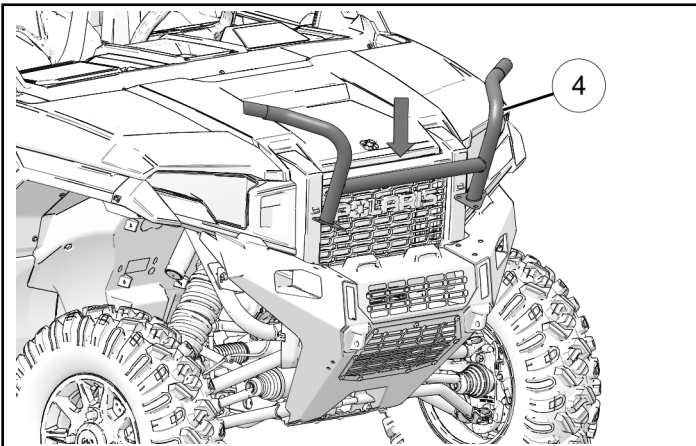

4. Install six screws ⑫ to attach the rack to the bumper.

DO NOT torque fasteners at this time.

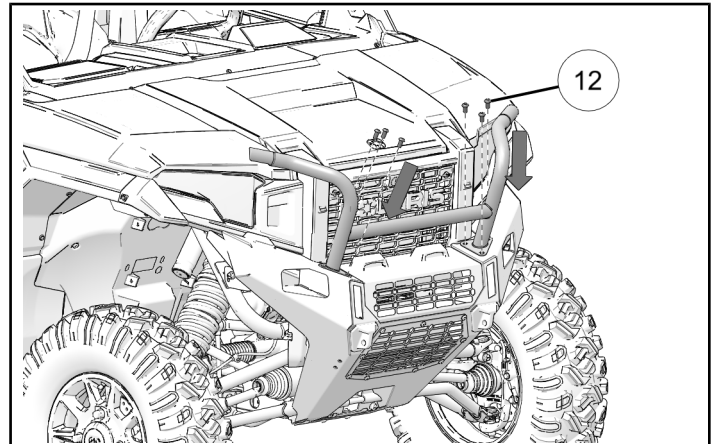

FRONT RACK INSTALLATION (P/N 2889387)

1. Install hood rack ⑯ over the top of the bull bumper.

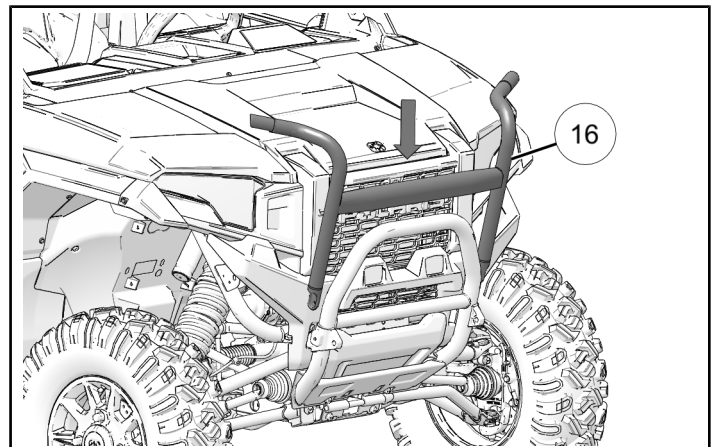

2. Install two screws ⑮ to attach rack to the bull bumper.

DO NOT torque fasteners at this time.

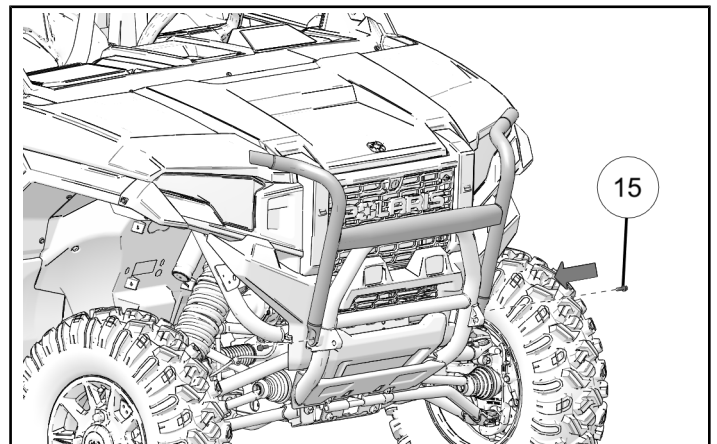

HOOD RACK INSTALLATION

1. Loosely assemble two brackets. Each bracket is assembled from two mounting clamps (7), two socket head screws (10), and two hex nuts (14).

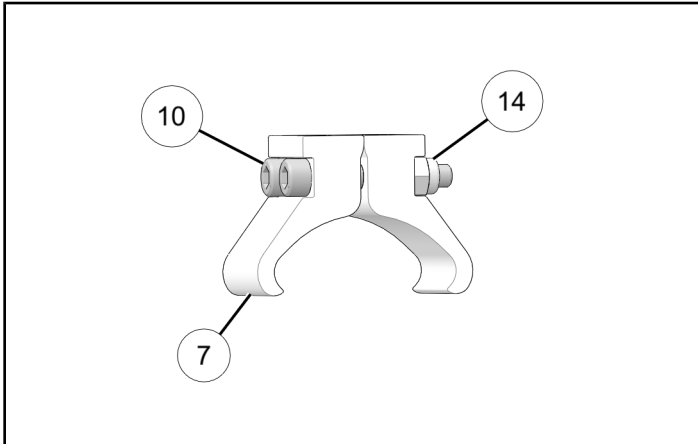

2. Tighten each bracket until the nut engages the locking channel on the clamp.

NOTICE

Make sure that the clamps are loose enough to mount to the ROPS.

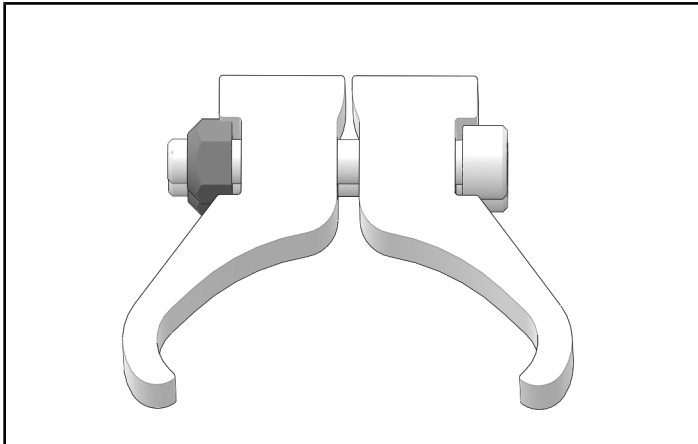

3. Install clamps on the front tube of the ROPS.

NOTICE

Right side shown; left side similar.

TIP

Clamp bolt heads should face toward the outside of the vehicle.

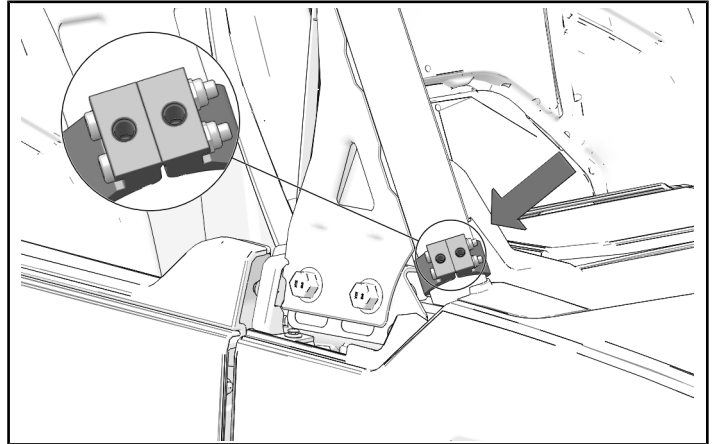

4. Connect left hood rack (1) to front hood rack with two screws (8).

DO NOT torque fasteners at this time.

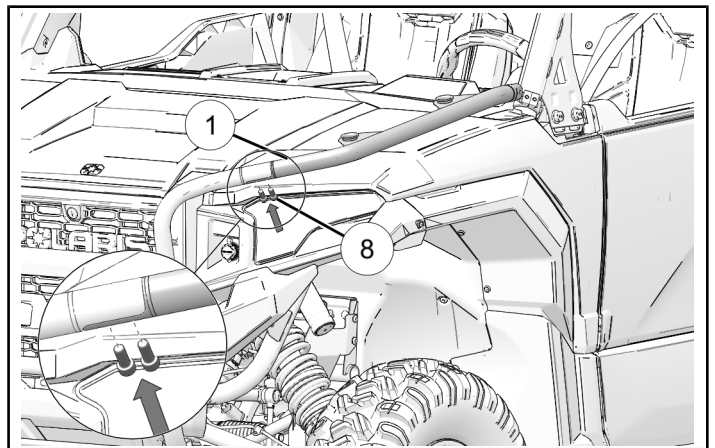

5. Connect right hood rack ② to front hood rack with two screws ⑧.

DO NOT torque fasteners at this time.

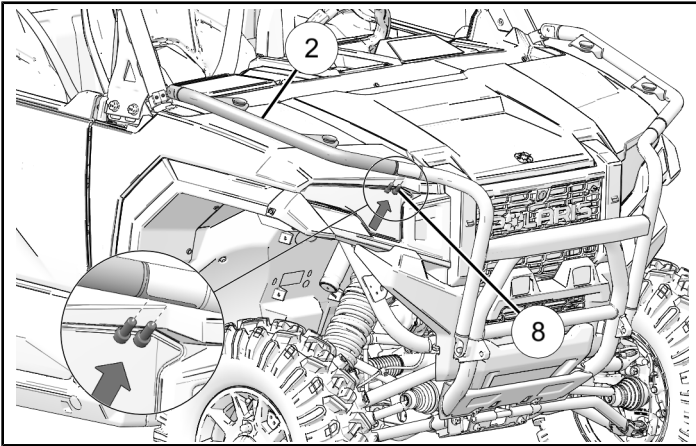

6. Install mount ⑥, screw ⑪, and nut ⑬ on each side of the hood rack.

DO NOT torque fasteners at this time.

NOTICE

Right side shown; left side similar.

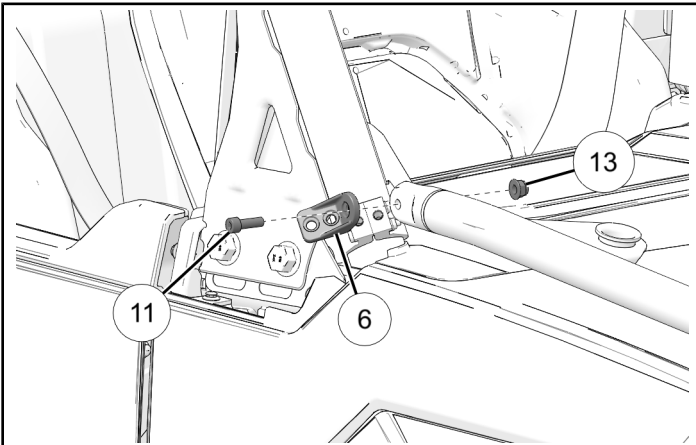

7. Install screws ⑨ to connect mount to clamp.

DO NOT torque fasteners at this time.

NOTICE

Right side shown; left side similar.

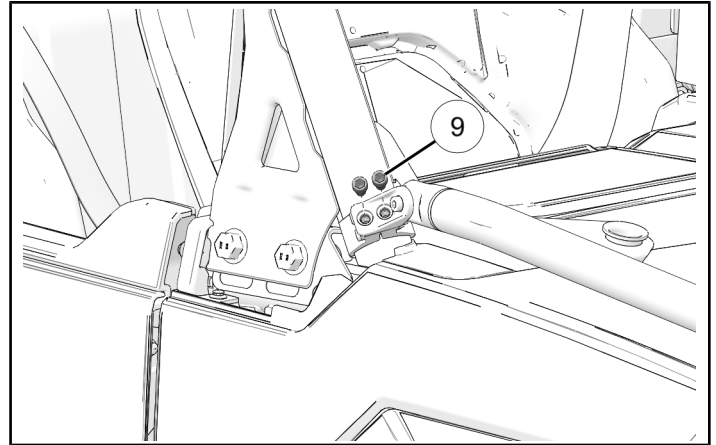

8. Install four Lock and Ride® anchors ⑤ to the main rack ③.

NOTICE

Refer to instructions included with Lock and Ride® anchors.

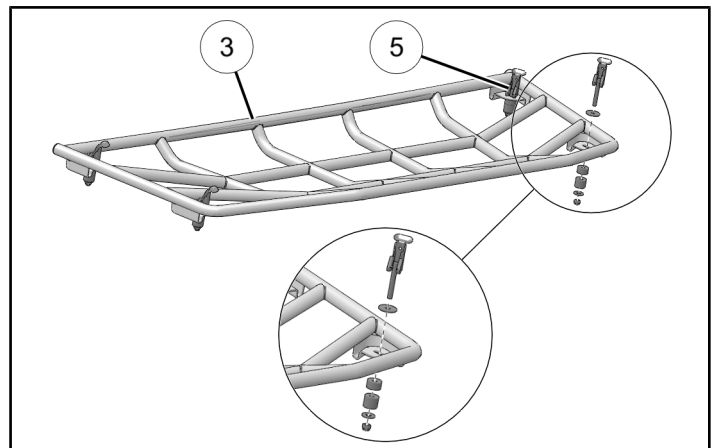

9. Make sure all Lock and Ride® anchors are unlocked.

10. Lower main rack ③ onto the assembled frame and actuate the Lock and Ride® anchors.

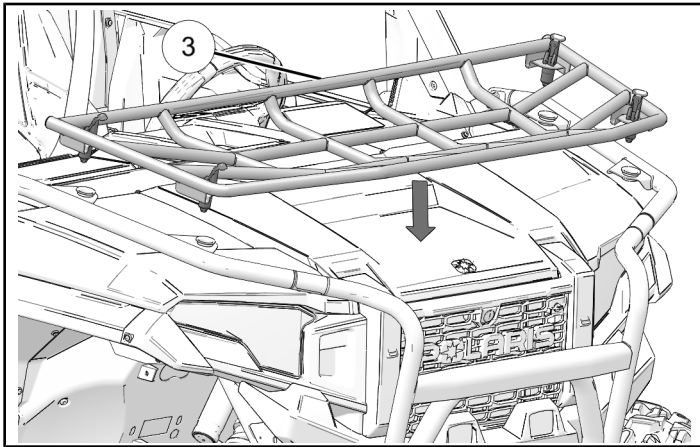

11. Torque four screws ⑧ to specification.

TORQUE

Screws ⑧:
20 ft-lbs (27 N·m)

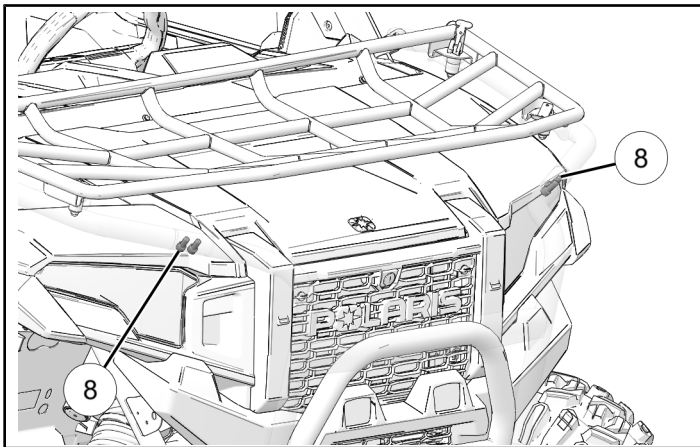

12. Tighten screws ⑨, screws ⑩, and screws ⑪ until fully seated.

DO NOT torque fasteners at this time.

NOTICE

Right side shown; left side similar.

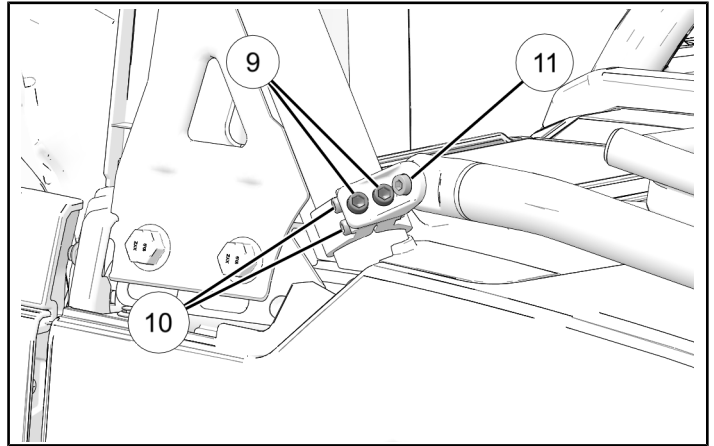

SAIL PANEL TRIM AND INSTALLATION

1. The sail panels must be trimmed to fit around the hood rack clamps. Cut out the darkened area shown below.

NOTICE

Left side shown; right side similar.

MEASUREMENT

Dimension A: 1.4 in (35 mm)

MEASUREMENT

Dimension B: 0.8 in (20 mm)

MEASUREMENT

Dimension C: 0.6 in (15 mm)

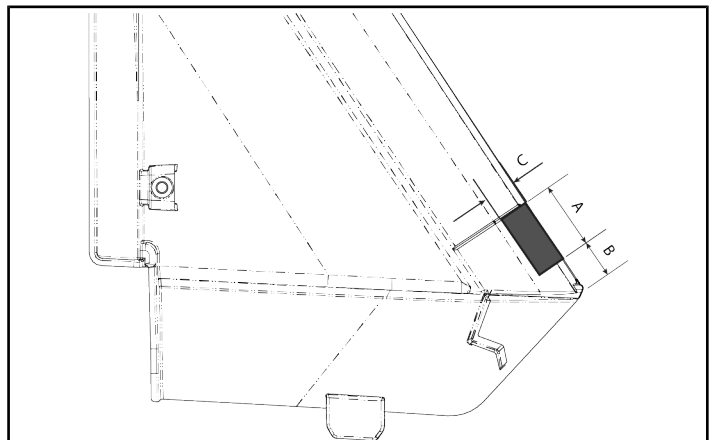

2. Modified sail panel.

NOTICE

Left side shown; right side similar.

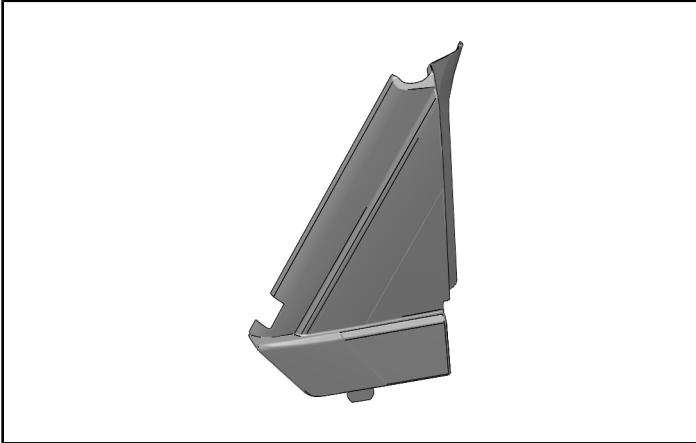

3. Install modified sail panel on vehicle. If needed, remove and re-trim the cutout area to achieve proper fit.

NOTICE

Left side shown; right side similar.

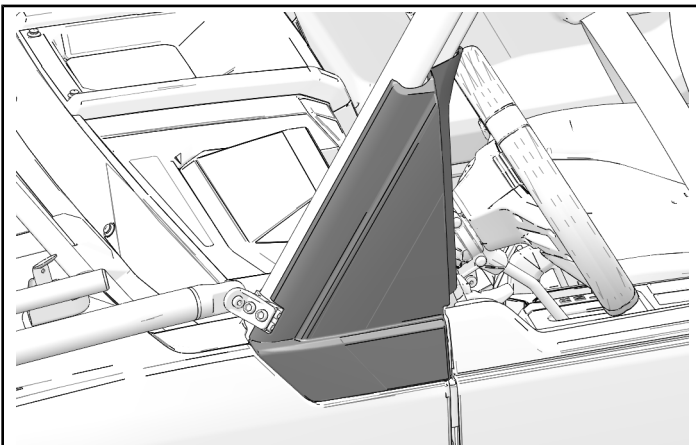

TORQUE SCREWS

1.

NOTICE

If vehicle is equipped with HD Bumper, proceed to Step 2.

Torque two screws ⑮ to specification.

TORQUE

Screws ⑮:
16 ft-lbs (22 N·m)

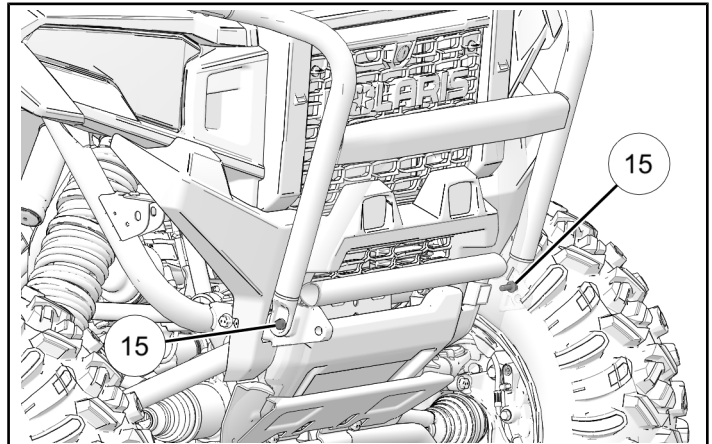

2.

NOTICE

If vehicle is equipped with Bull Bumper, proceed to Step 3.

Torque six screws ⑫ to specification.

TORQUE

Screws ⑫:
20 ft-lbs (27 N·m)

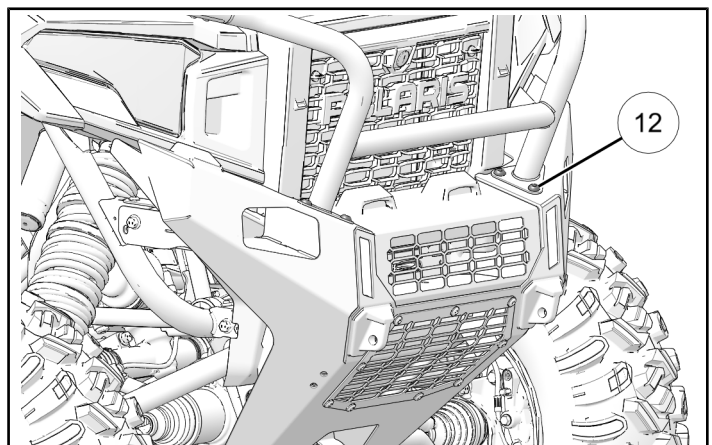

3. Move clamp up or down to position clamp properly.
Tighten screws ⑩ to specification.

TORQUE

Screws ⑩:
9 ft-lbs (12 N·m)

NOTICE

Right side shown; left side similar.

NOTICE

Apply inward pressure on clamp and alternate between two socket head screws ⑩ on each clamp to fully seat and achieve full torque. Alternate between screws 3 - 5 times.

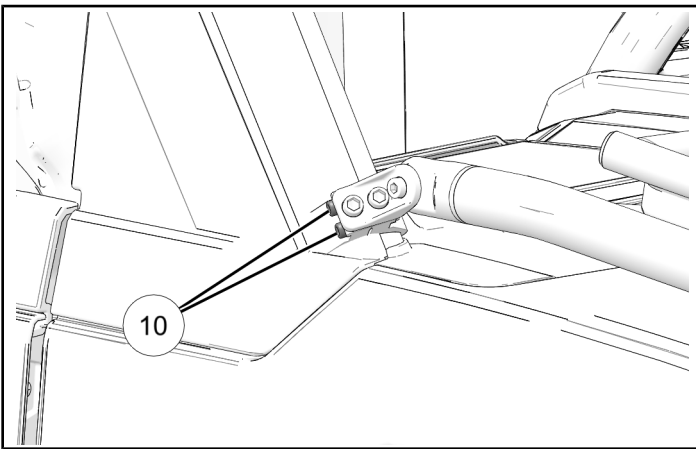

4. Torque screws ⑨ and screws ⑪ to specification.

TORQUE

Screws ⑨ ⑪:
16 ft-lbs (22 N·m)

NOTICE

Right side shown; left side similar.

