

HD FRONT BUMPER KIT



P/N 2884494

IMPORTANT

Due to the technical nature of this kit, Polaris® insists that this installation be performed by a certified Polaris® technician.

MISSING OR DAMAGED PARTS

Before beginning assembly, inspect the kit and its component(s) to be sure all parts and tools are accounted for and not damaged. If missing parts or parts are damaged, please contact your Selling Dealer for assistance.

If your accessory was purchased online, please contact POLARIS® customer service at **1-800-POLARIS** (US & Canada only).

APPLICATION

Verify accessory fitment at www.polaris.com.

KIT CONTENTS

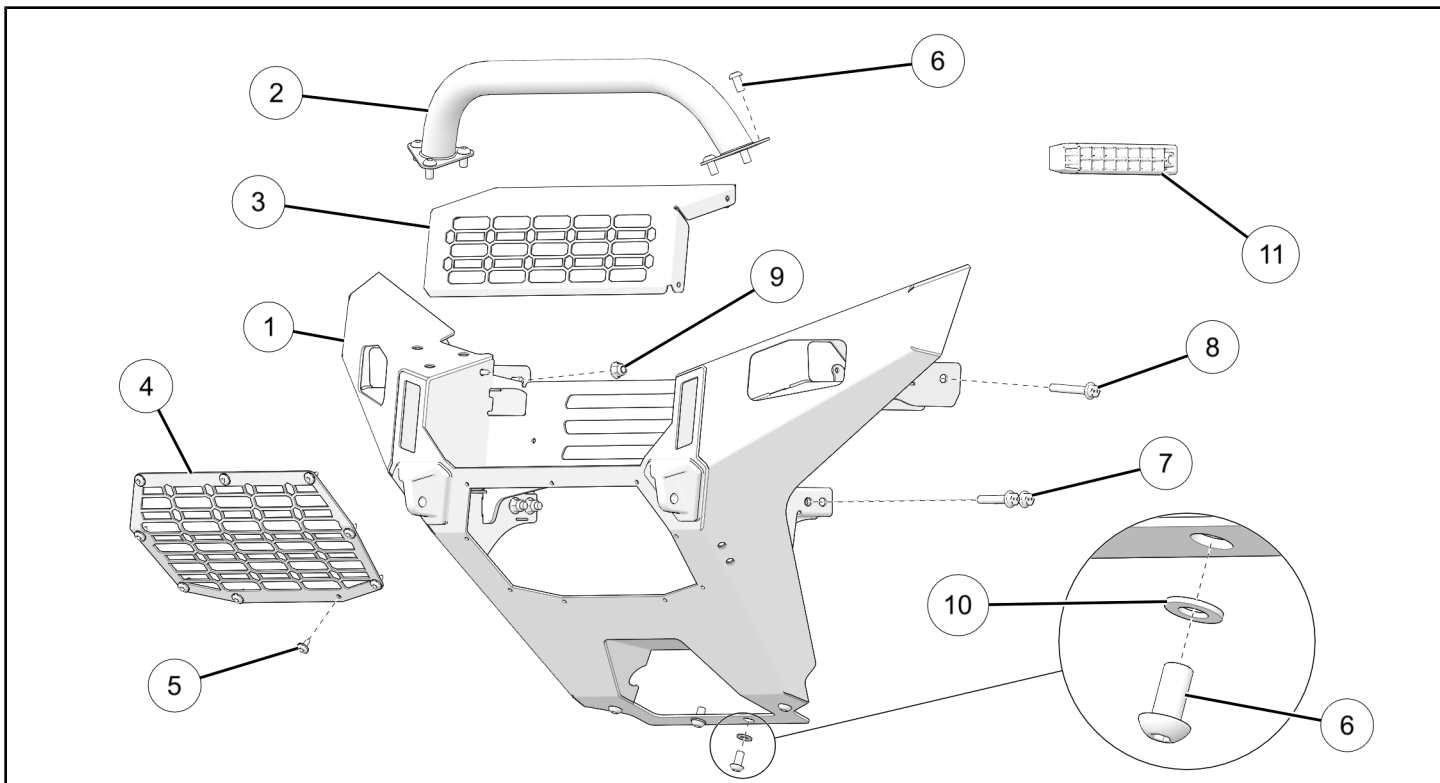

REF	QTY	PART DESCRIPTION	P/N AVAILABLE SEPARATELY	AVAILABLE SERVICE KIT
1	1	HD Front Bumper	n/a	n/a
2	1	Tube Loop	n/a	n/a
3	1	Plate	n/a	n/a
4	1	Grill	n/a	n/a
5	13	Screw, Torx® Truss Head M6 x 1 x 16 mm	7518936	2209149

REF	QTY	PART DESCRIPTION	P/N AVAILABLE SEPARATELY	AVAILABLE SERVICE KIT
6	10	Screw, Hex Button Head M10 x 1.5 x 20 mm	7520338	2209149
7	4	Screw, Hex Flange Head M10 x 1.5 x 55 mm	7521333-55	2209149
8	2	Screw, Hex Flange Head M10 x 1.5 x 70 mm	7521333-70	2209149
9	6	Nut, Hex Flange M10 x 1.5 mm	7548029	2209149
10	2	Flat Washer M10 x 2.0 mm	7557235	2209149
11	1	Chassis Drive Tool	n/a	2211920

TOOLS REQUIRED

- Safety Glasses
- Hammer, Soft Face
- Pry Tool
- Slide Hammer
- Socket Set, Hex Bit, Metric
- Socket Set, Metric
- Socket Set, Torx® Bit
- Torque Wrench
- Wrench Set, Metric

IMPORTANT

Your HD Front Bumper Kit is exclusively designed for your vehicle. Please read the installation instructions thoroughly before beginning. Installation is easier if the vehicle is clean and free of debris. For your safety, and to ensure a satisfactory installation, perform all installation steps correctly in the sequence shown.

INSTALLATION INSTRUCTIONS

VEHICLE PREPARATION

GENERAL

1. Park vehicle on a flat surface.
2. Shift vehicle into PARK.
3. Turn key to OFF position and remove key.

BULL BUMPER REMOVAL

1. Remove two lower screws from bull bumper.

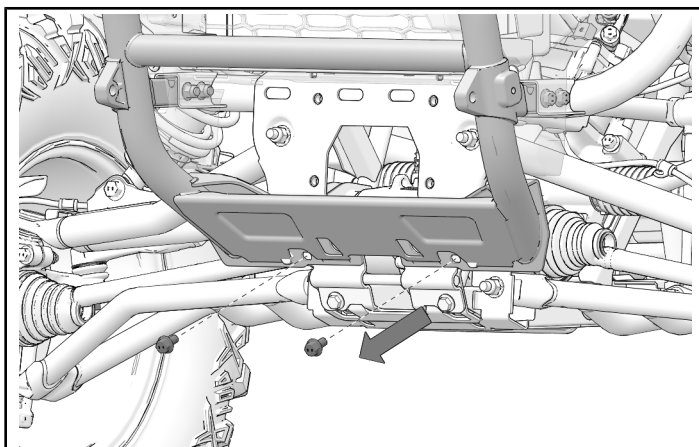

2. Remove four screws and nuts from upper mounting points.

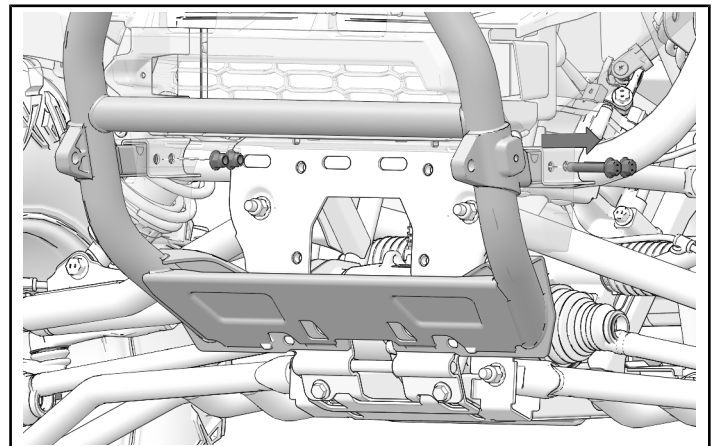

3. Remove bull bumper by pulling forward.

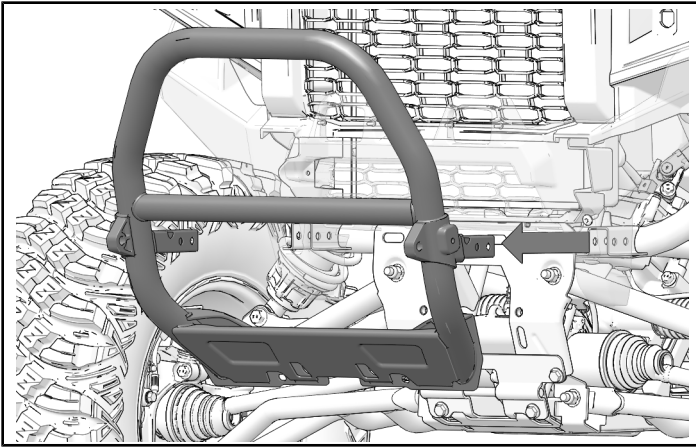

REMOVE WINCH COVER

1. Remove two screws from bottom of winch cover.

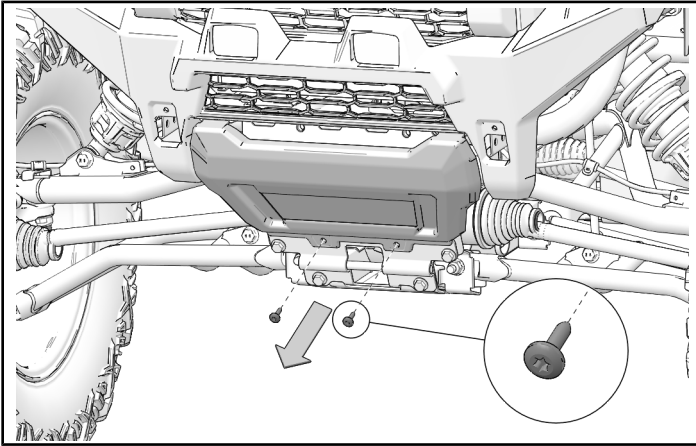

2. Pull bottom of winch cover down to disengage top tabs. Remove winch cover.

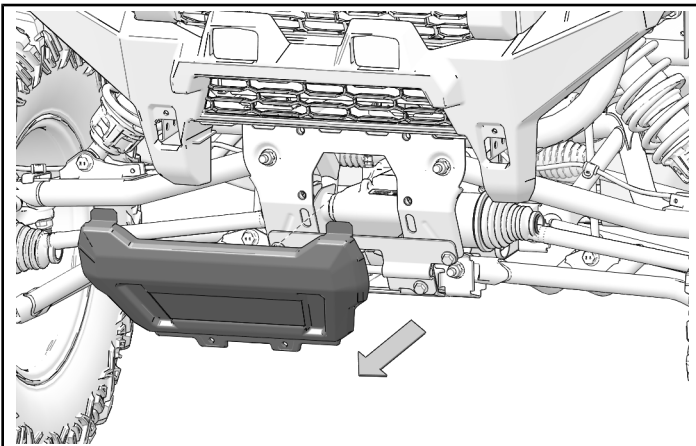

FRONT FASCIA REMOVAL

1. Remove two push-pin rivets from underside of front fascia.

NOTICE

Left side shown; right side similar.

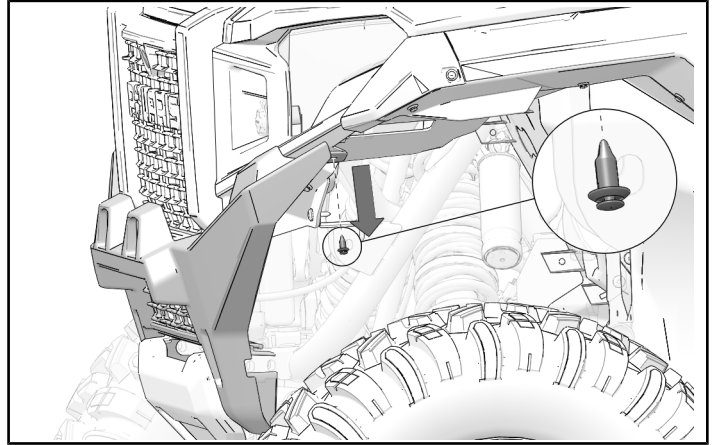

2. Remove two screws from front fascia.

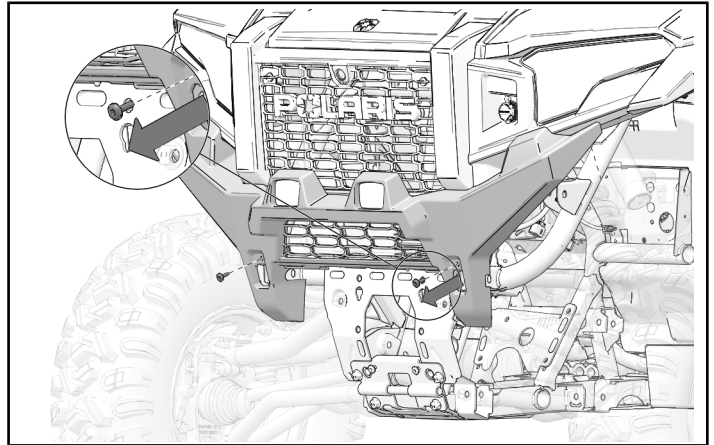

3. Remove front fascia.

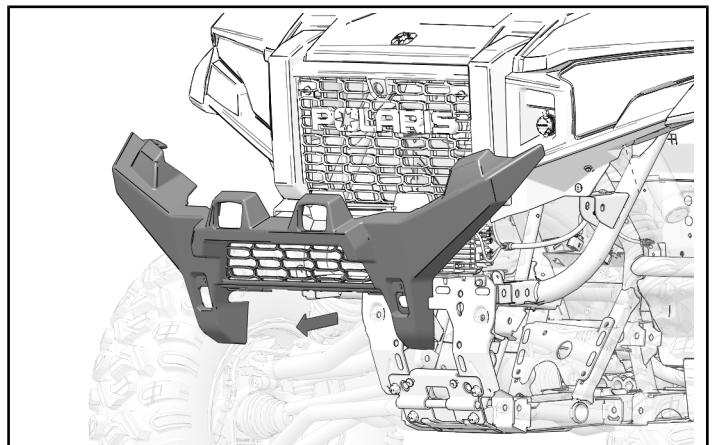

ACCESSORY INSTALLATION

CHASSIS DRIVE TOOL

TIP

To ease installation of HD Bumper, use chassis drive tool to expand mounting brackets on vehicle.

1. Find left and right mounting brackets on vehicle frame. Put chassis drive tool ⑪ into left mounting bracket. Align tool ⑪ as shown in illustration.

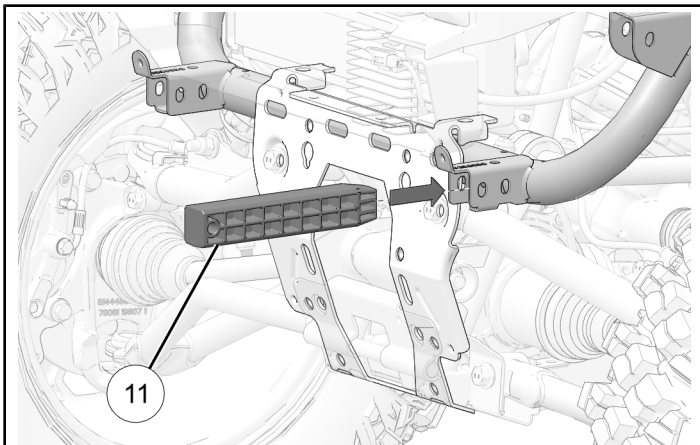

2. Use soft face hammer to drive tool ⑪ into bracket.
3. Use slide hammer with hook, or hammer and punch to remove drive tool ⑪ from bracket.
4. Repeat steps for right side bracket.

PLATE INSTALLATION

1. Install plate ③ onto top of HD bumper ①.

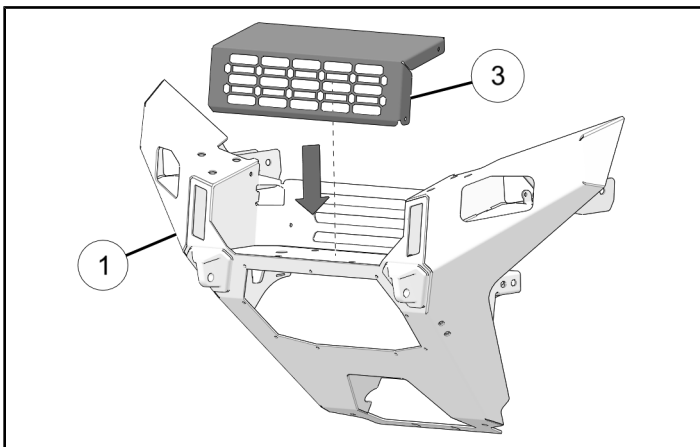

2. Loosely install two screws ⑤ from rear side of bumper ① to hold plate.

DO NOT torque fasteners at this time.

NOTICE

Right side shown; left side similar.

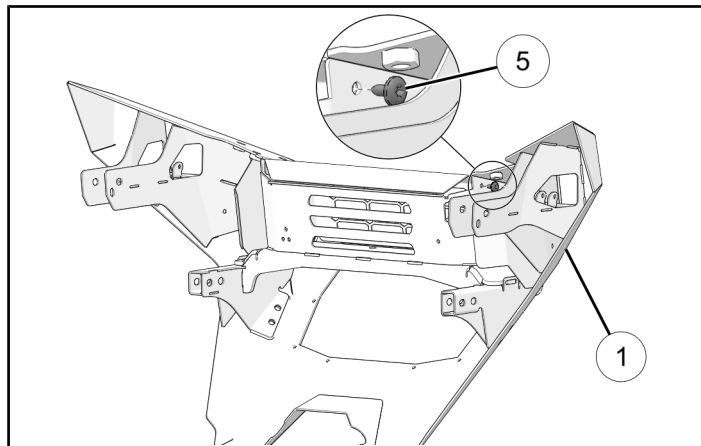

3. Loosely install two screws ⑤ to hold plate, through openings in front of bumper ①. Torque all four screws to specification.

TORQUE

Screws ⑤:
80 in-lbs (9 N·m)

NOTICE

Left side shown; right side similar.

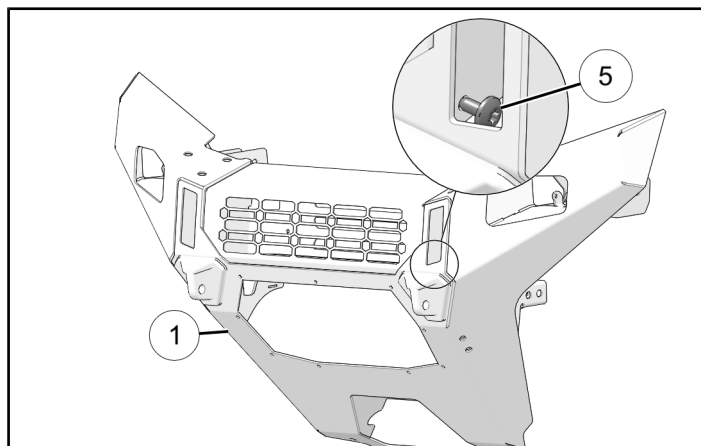

HD FRONT BUMPER INSTALLATION

1. Remove push-pin harness clip from upper left mounting bracket on frame.

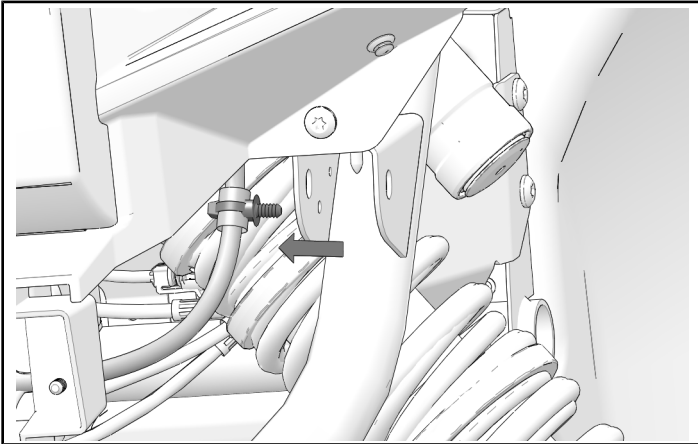

2. Install bumper ① onto vehicle. Align middle and upper mounting points with frame as shown below.

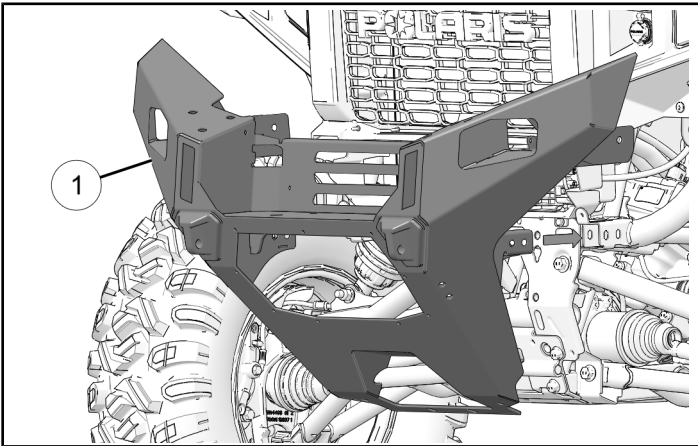

3. Install middle mounting point into bracket in vehicle frame.

NOTICE

Left side shown; right side similar.

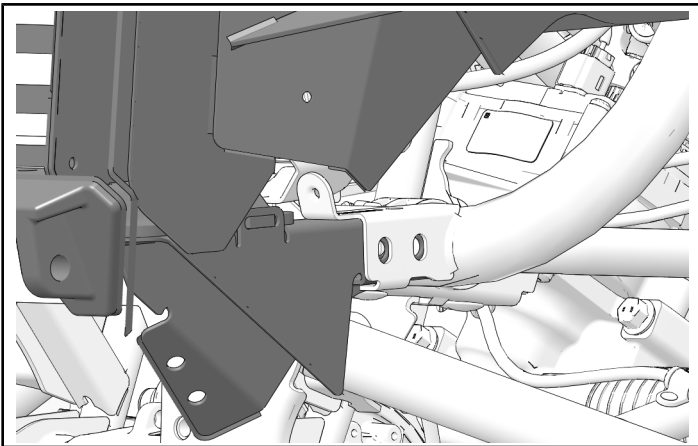

4. Upper mounting point will wrap around left and right side of bracket on vehicle frame.

NOTICE

Left side shown; right side similar.

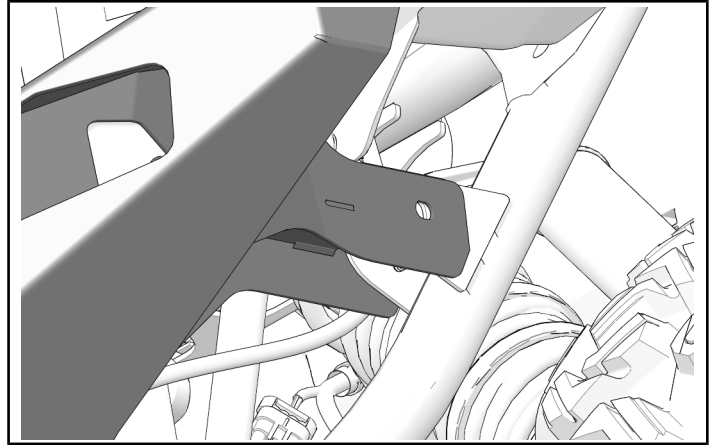

5. Loosely install four screws ⑦ and four nuts ⑨ in middle mounting points.

DO NOT torque fasteners at this time.

NOTICE

Left side shown; right side similar.

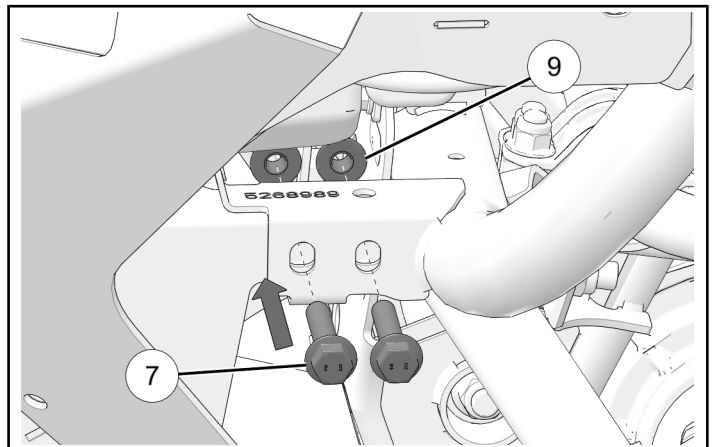

6. Loosely install two screws ⑧ and two nuts ⑨ in upper mounting points.

DO NOT torque fasteners at this time.

NOTICE

Left side shown; right side similar.

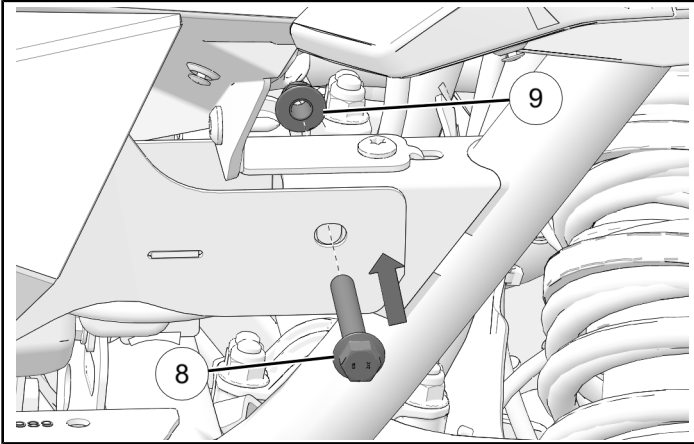

7. Loosely install two washers ⑩ and two screws ⑥ into lower mounting holes.

DO NOT torque fasteners at this time.

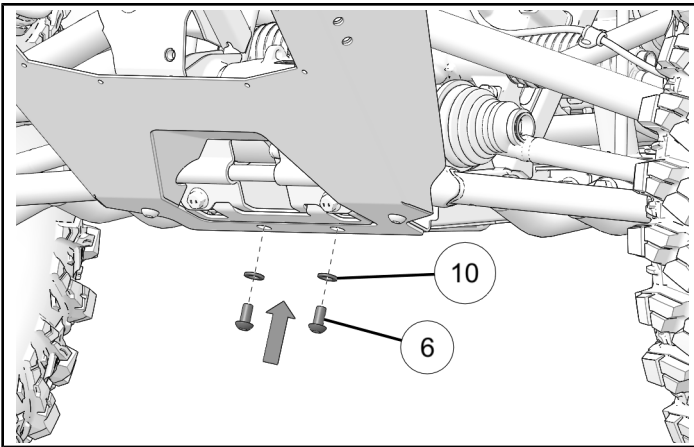

8. If machine is equipped with snowplow mounting plate, loosely install two additional screws ⑥ in lower mounting holes.

DO NOT torque fasteners at this time.

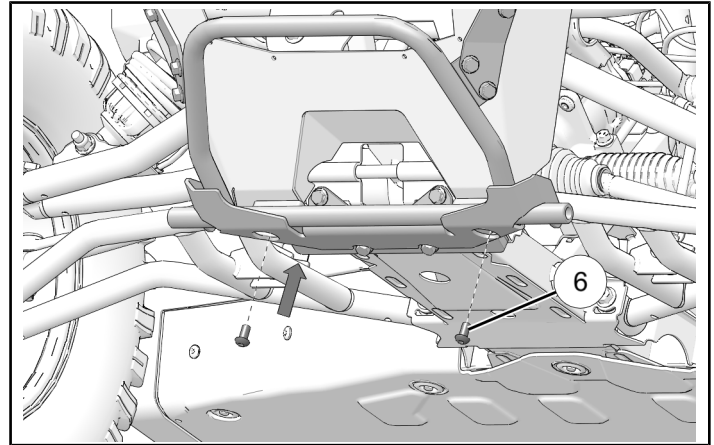

9. Torque middle mounting screws ⑦ to specification.

TORQUE

Middle Mounting Screws ⑦:
30 ft-lbs (40 N·m)

10. Torque lower mounting screws ⑥ to specification.

TORQUE

Lower Mounting Screws ⑥:
30 ft-lbs (40 N·m)

11. Torque upper mounting screws ⑧ to specification.

TORQUE

Upper Mounting Screws ⑧:
30 ft-lbs (40 N·m)

12. Install push-pin harness clip into upper left mounting bracket.

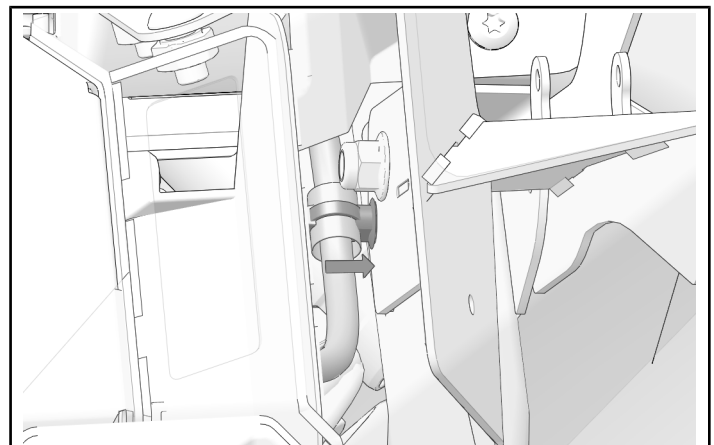

INSTALL GRILL

NOTICE

If vehicle is equipped with 4500 lb winch, do not install grill. Proceed to tube loop installation.

1. Install grill ④ and nine screws ⑤. Torque screws to specification.

TORQUE

Screws ⑤:
80 in-lbs (9 N·m)

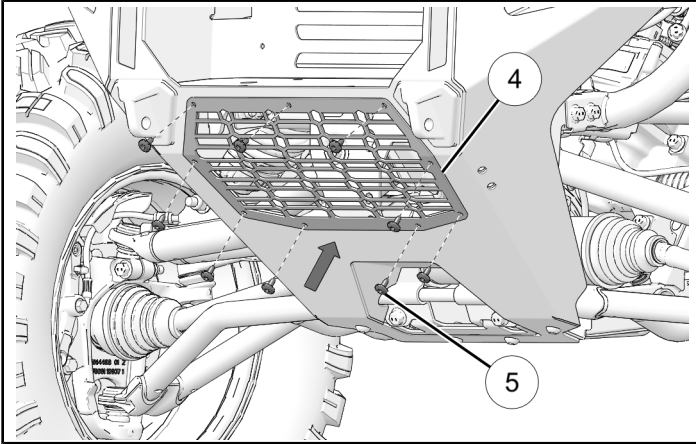

INSTALL TUBE LOOP

1. Install tube loop ② and six screws ⑥ on top of HD bumper. Torque screws to specification.

TORQUE

Screws ⑥:
30 ft-lbs (40 N·m)

