

REAR GLASS LIFTGATE KIT



P/N 2884413

MISSING OR DAMAGED PARTS

Before beginning assembly, inspect the kit and its component(s) to be sure all parts and tools are accounted for and not damaged. If missing parts or parts are damaged, please contact your Selling Dealer for assistance.

If your accessory was purchased online, please contact POLARIS® customer service at **1-800-POLARIS** (US & Canada only).

APPLICATION

Verify accessory fitment at www.polaris.com.

KIT CONTENTS

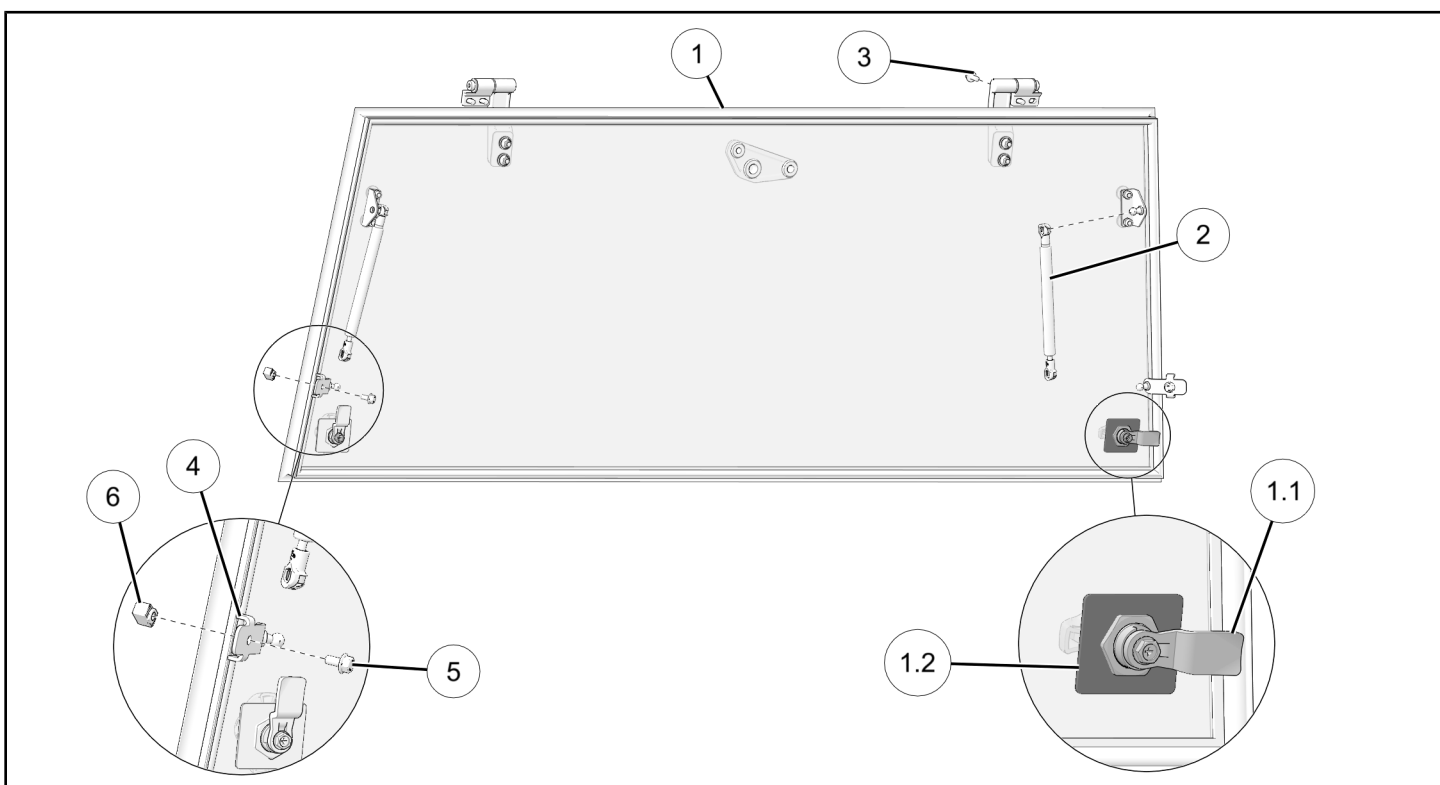

REF	QTY	PART DESCRIPTION	P/N AVAILABLE SEPARATELY	AVAILABLE SERVICE KIT
1	1	Liftgate Assembly	2637900	n/a
1.1	2	– T-Handle, Cam, Latch	7082621	2209683
1.2	2	– Bracket, Liftgate Backing	n/a	2209683
2	2	Gas Shock	7045464	2209682
3	4	Screw, Hex Flange Head M6 x 1.0 x 16 mm	7521331-16	2209681
4	2	Ball Stud, Liftgate	n/a	n/a
5	2	Screw, Hex Flange Head M6 x 1.0 x 12 mm	7521331-12	2209681
6	2	T-Nut	n/a	2209681

TOOLS REQUIRED

- Safety Glasses
- Socket Set, Metric
- Socket Set, Torx® Bit
- Tape Measure
- Torque Wrench
- Wrench Set, Metric

IMPORTANT

Your Rear Glass Liftgate Kit is exclusively designed for your vehicle. Please read the installation instructions thoroughly before beginning. Installation is easier if the vehicle is clean and free of debris. For your safety, and to ensure a satisfactory installation, perform all installation steps correctly in the sequence shown.

INSTALLATION INSTRUCTIONS

VEHICLE PREPARATION

GENERAL

1. Park vehicle on a flat surface.
2. Shift vehicle into PARK.
3. Turn key to OFF position and remove key.

ACCESSORY INSTALLATION

1. Install ball stud ④, screw ⑤, and T-nut ⑥ into channel at the rear of the vehicle. Note orientation of T-nut ⑥.

NOTICE

Right side shown; left side similar.

DO NOT torque fasteners at this time.

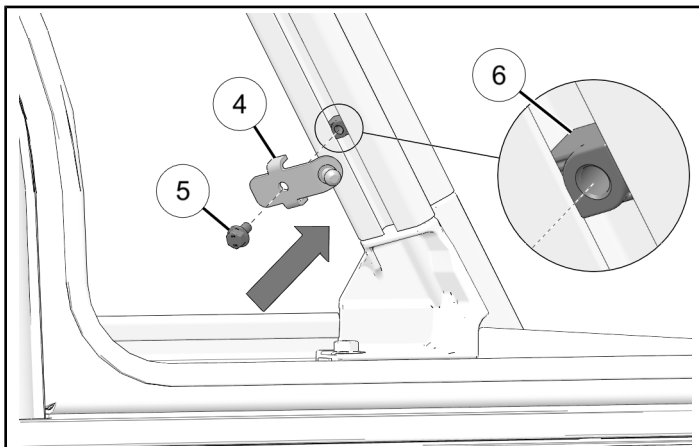

2. Position ball stud so that it is 2 in (50 mm) above the bottom of the channel. Torque screw to specification.

TORQUE

Screw ⑤:
15 ft-lbs (20 N·m)

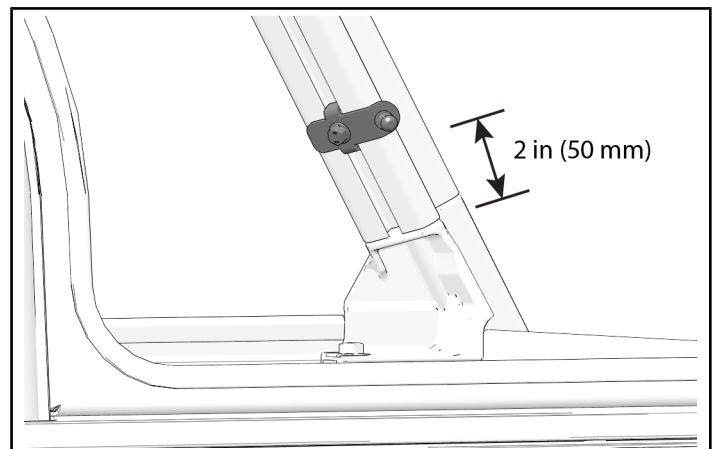

3. Remove two M8 screws at the top rear of the roof.

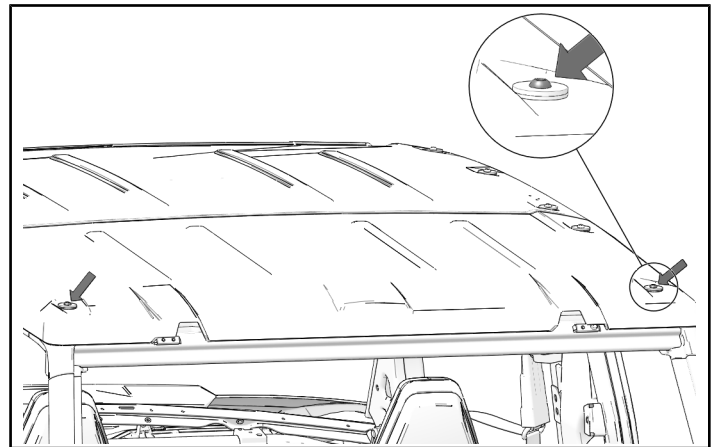

4. Remove two M6 screws and two weld nuts at the rear underside of the roof. This will allow the roof to be lifted slightly so that hinges can be installed.

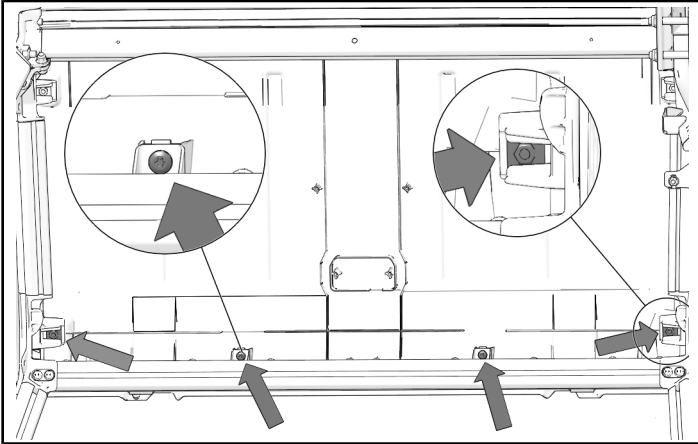

5. With an assistant, position the liftgate at the rear of the vehicle. Install four screws ③. Torque screws to specification.

TORQUE

Screws ③:
15 ft-lbs (20 N·m)

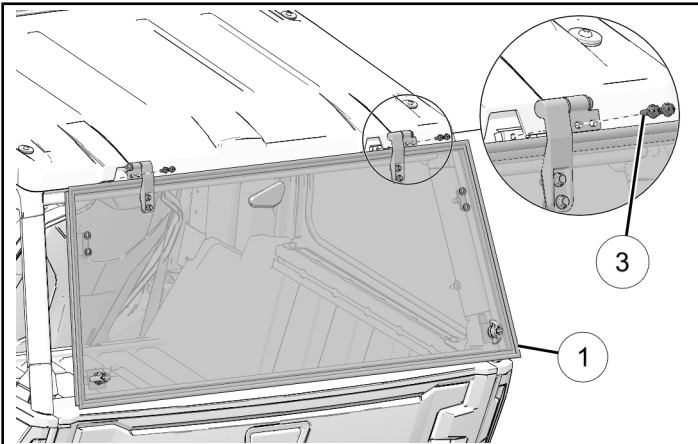

6. Install gas shock ②. The ends of the gas shock snap onto the ball studs on the liftgate and the vehicle. Note orientation of gas shock.

NOTICE

Right side shown; left side similar.

NOTICE

Make sure main body of gas shock is connected to the liftgate. Rod end of the gas shock connects to the vehicle enclosure.

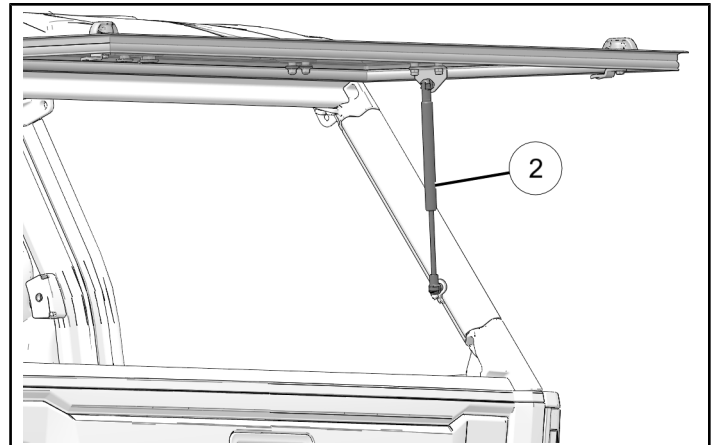

7. If needed, loosen screw ⑤ and adjust ball stud ④ on the vehicle. Make sure that the position of the ball stud allows the liftgate to fully close, and to open to the desired height. When adjustment is complete, torque screw to specification.

NOTICE

Right side shown; left side similar.

TORQUE

Screw ⑤:
15 ft-lbs (20 N·m)

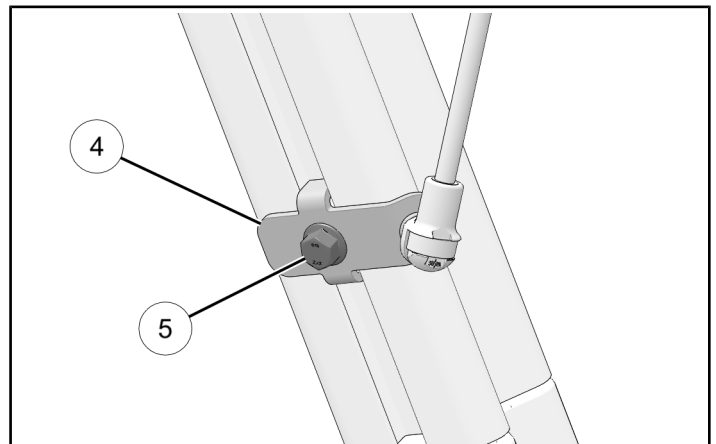

8. Install two M8 screws at the top rear of the roof and the weld nuts on the underside of the roof. Torque screws to specification.

TORQUE

M8 Screws:
18 ft-lbs (25 N·m)

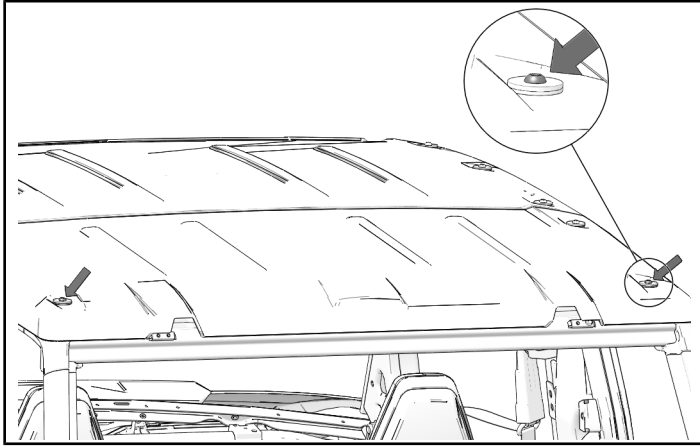

9. Install two M6 screws at the rear underside of the roof. Torque screws to specification

TORQUE

M6 Screws:
44 in-lbs (5 N·m)

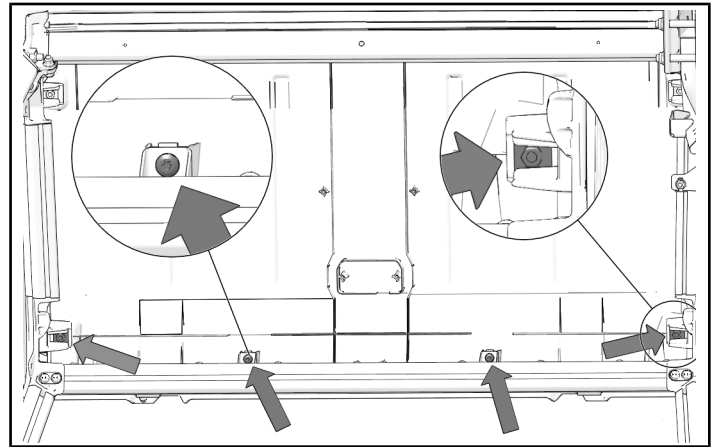

OPERATION

⚠ WARNING

If transporting vehicle in non-enclosed trailer, vehicle must **FACE FORWARD** and liftgate must be **FULLY CLOSED** and **LOCKED**. Otherwise, liftgate must be removed. Failure to comply may allow airflow, vibration, or other factors to separate liftgate from vehicle and cause an accident, resulting in serious personal injury or death.

⚠ WARNING

Do not drive vehicle with the liftgate open. Driving with liftgate open may cause airflow to lift gate and cause a loss of vehicle control resulting in accident or death.

Turn T-handles one-quarter turn to open the liftgate.

