

GLASS WINDSHIELD KIT



P/N 2884331

APPLICATION

Verify accessory fitment at www.polaris.com.

BEFORE YOU BEGIN

Read these instructions and check to be sure all parts and tools are accounted for. Please retain these installation instructions for future reference and parts ordering information.

KIT CONTENTS

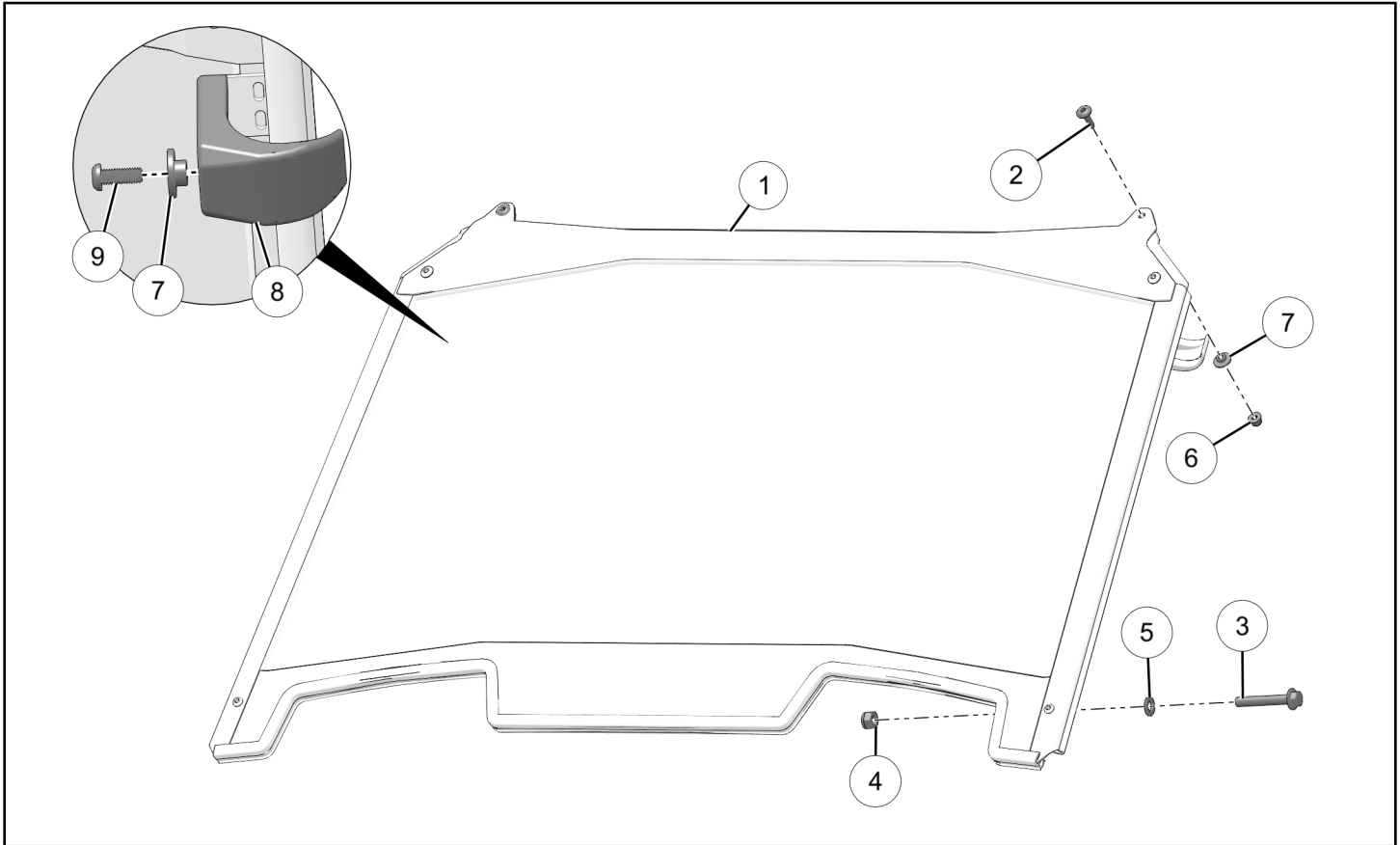

REF	QTY	PART DESCRIPTION	P/N AVAILABLE SEPARATELY	AVAILABLE SERVICE KIT
1	1	Assembly–Glass	n/a	n/a
2	2	Screw–Torx® Truss Head, M6 x 1.0 x 25	7519650	2208206
3	2	Screw–Hex Flange, M10 x 1.5 x 65	7519903	2208206
4	2	Nut–Hex, Nylon Locking, M10 x 1.5	7547746	2208206
5	2	Washer–10.5 x 20.0 x 2.0	n/a	2208206
6	2	Nut–Flange, M6	n/a	2208206
7	4	Sleeve–M6	n/a	2208206

REF	QTY	PART DESCRIPTION	P/N AVAILABLE SEPARATELY	AVAILABLE SERVICE KIT
8	2	Clamp–Windshield	n/a	2208206
9	2	Fastener–Clamp, M6	n/a	2208206

TOOLS REQUIRED

- Safety Glasses
- Drill
- Drill Bit:
 - 1/2 in (13 mm)
- Screwdriver Set, Torx®
- Socket Set, Metric
- Socket Set, Torx® Bit
- Torque Wrench

IMPORTANT

Your Glass Windshield Kit is exclusively designed for your vehicle. Please read the installation instructions thoroughly before beginning. Installation is easier if the vehicle is clean and free of debris. For your safety, and to ensure a satisfactory installation, perform all installation steps correctly in the sequence shown.

INSTALLATION INSTRUCTIONS

NOTE

Polaris® recommends two people install this kit.

⚠ WARNING

If transporting vehicle in non-enclosed trailer then vehicle must **FACE FORWARD**, or windshield must be removed.

Failure to comply may allow airflow, vibration, or other factors to separate windshield from vehicle and cause an accident, resulting in serious personal injury or death.

VEHICLE PREPARATION

GENERAL

1. Shift vehicle transmission into PARK. Turn ignition switch to OFF position and remove key.
2. If equipped with roof: Remove roof and set aside for reinstallation.

ACCESSORY INSTALLATION

VISOR PREPARATION

1. Remove four visor fasteners and visor from ROPS.

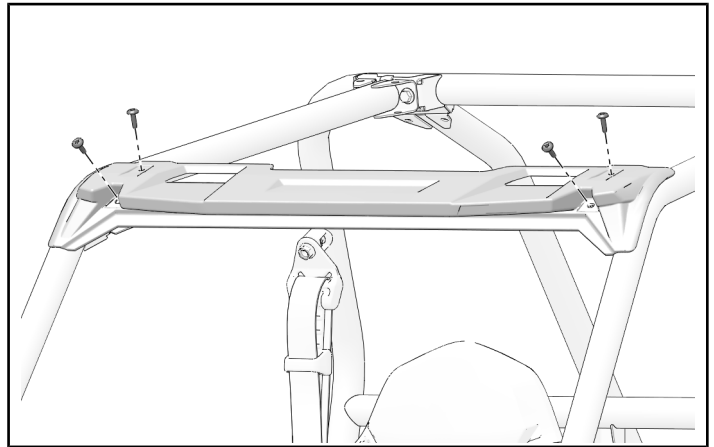

2. Remove and discard two front U-clip nuts.

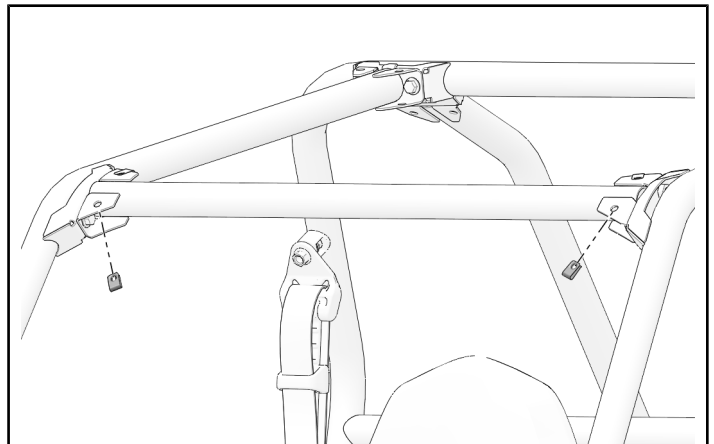

3. Enlarge front-most holes in visor with a **1/2 in (13 mm)** drill bit. Do not enlarge rear holes.

MEASUREMENT

Measurement **(A)**:
1/2 in (13 mm)

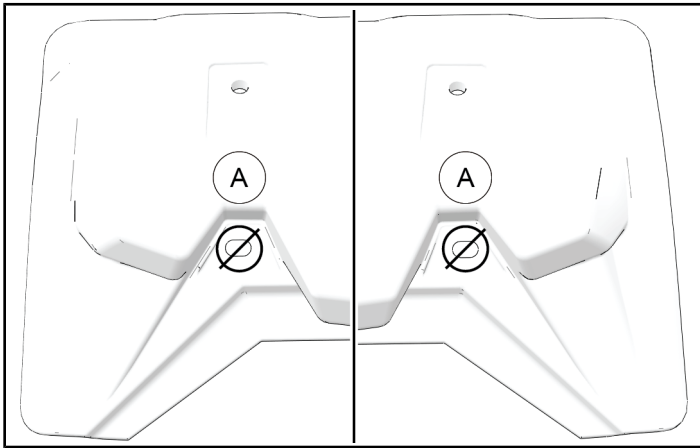

4. Insert two sleeves **(6)**, from underside, into front-most visor holes.

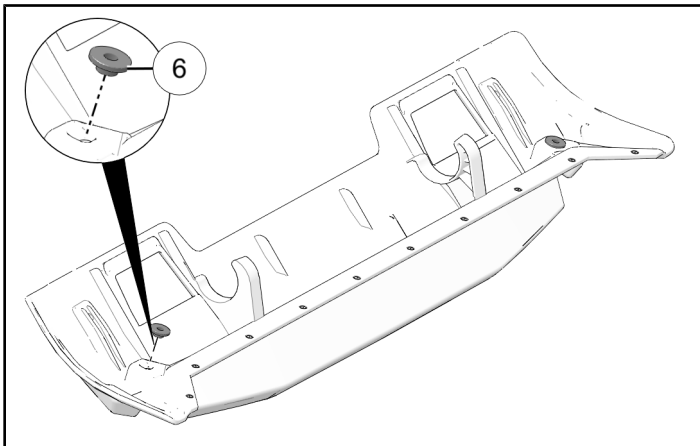

5. Place visor in installed position and loosely install back portion of visor with two retained visor fasteners.

Do not torque fasteners at this time.

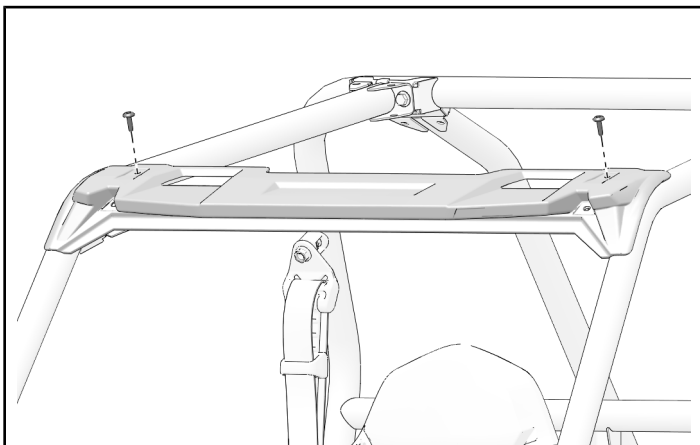

ROPS PREPARATION

1. Remove top fastener and nut from each side of front ROPS.

IMPORTANT

DO NOT loosen or remove lower screw and nut from ROPS fitting.

• Driver Side

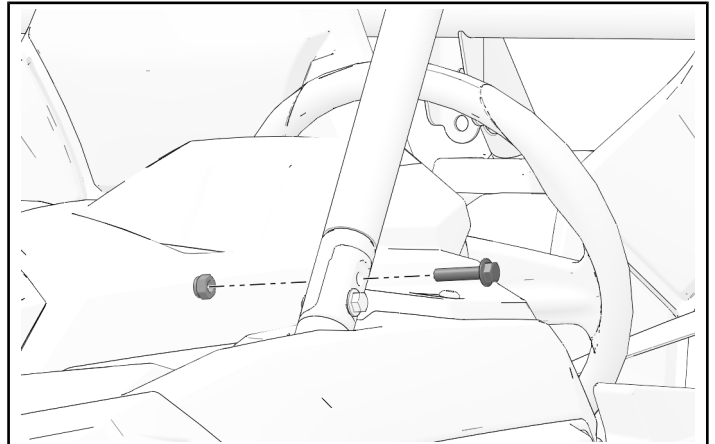

• Passenger Side

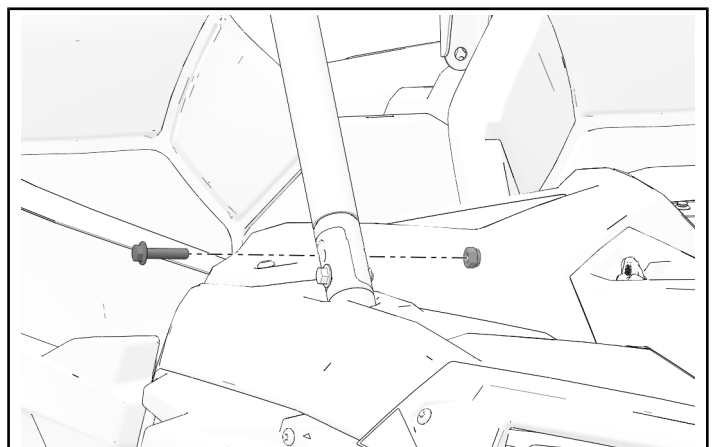

2. Install fasteners **(3)** in vacated ROPS holes. Use retained nuts, but do not fully install fastener **(3)**. Install approximately 1/4 in (6 mm) past nut.

• Driver Side

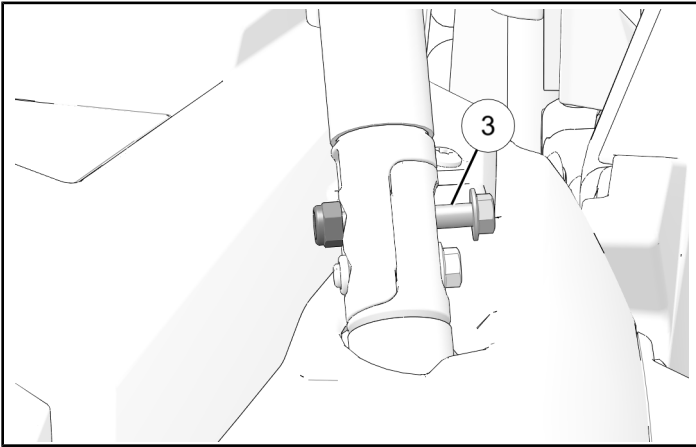

• Passenger Side

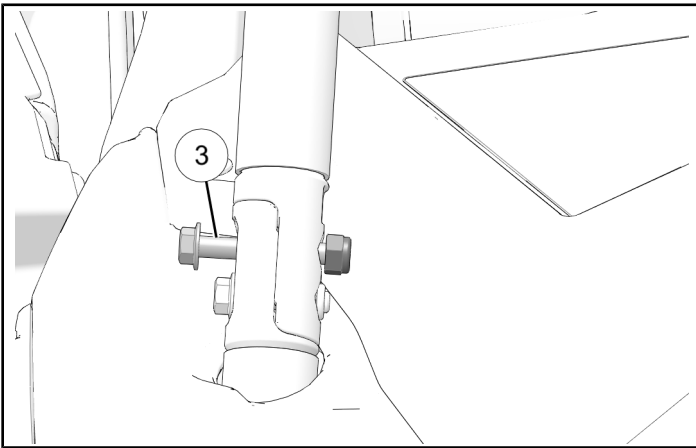

2. Align windshield with visor and pass fastener ② through windshield and visor. Secure with nut ⑥.

Do not torque fasteners at this time.

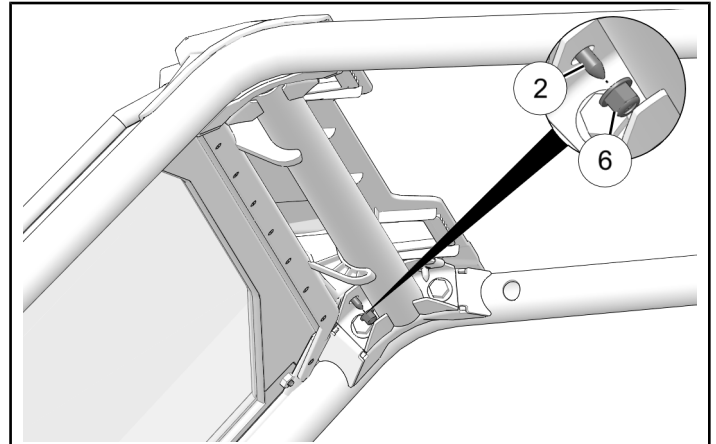

3. Thread ROPS fasteners into windshield mount and secure with nut ④. Once both nuts are hand-tighten, torque fasteners to specification. Use washers ⑤ between ROPS fitting and windshield bracket, if needed, to help center windshield between ROPS.

TORQUE

ROPS Fasteners:
40 ft-lbs (54 N·m)

WARNING

Failure to torque fasteners as directed will adversely affect ROPS integrity and may lead to severe injury or death in the event of an accident. Ensure ROPS fastenes are torqued to specification.

WINDSHIELD INSTALLATION

1. With an assistant, lean windshield assembly against vehicle ROPS.

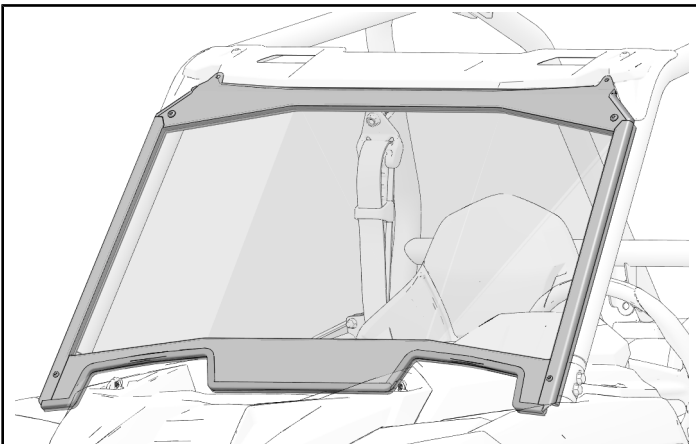

• Driver Side

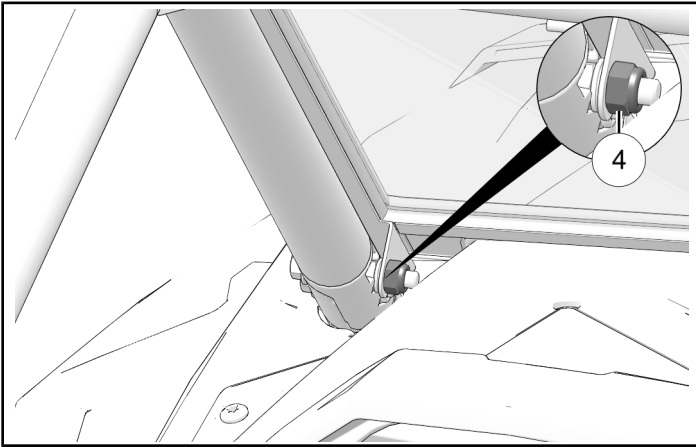

• Passenger Side

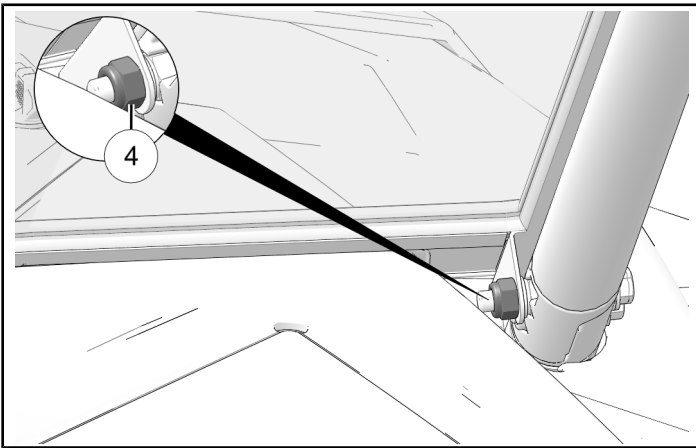

5. Slide one clamp ⑧ onto each windshield bracket and secure with one clamp fastener ⑨ and one sleeve ⑦.

TORQUE

Clamp Fasteners ⑨:
9 ft-lbs (12 N·m)

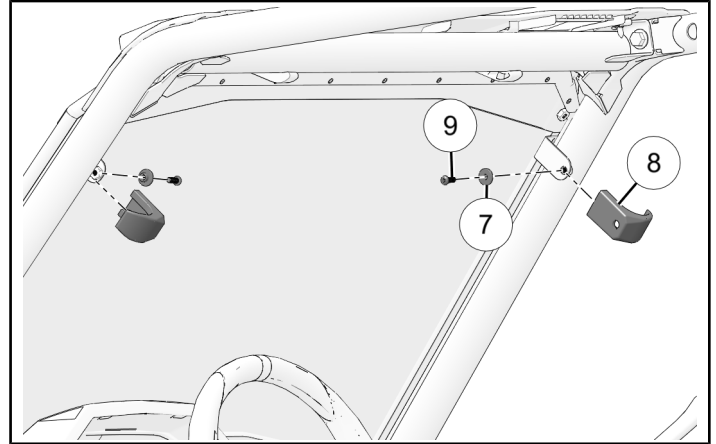

VEHICLE REASSEMBLY

GENERAL

1. If equipped with roof:
Follow installation instructions provided with roof to reinstall.

4. Torque visor fasteners to specification.

TORQUE

Visor Fasteners:
9 ft-lbs (12 N·m)

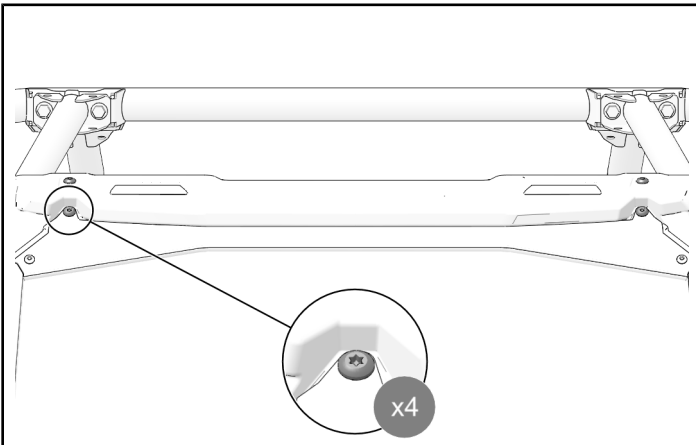

FEEDBACK FORM

A feedback form has been created for the installer to provide any comments, questions or concerns about the installation instructions. The form is viewable on mobile devices by scanning the QR code or by clicking [HERE](#) if viewing on a PC.

