

ALUMINUM ROOF KIT

POLARISENGINEERED PARTS
ACCESSORIES & APPAREL**P/N 2884086**

APPLICATION

Verify accessory fitment at [Polaris.com](https://www.polaris.com).

BEFORE YOU BEGIN

Read these instructions and check to be sure all parts and tools are accounted for. Please retain these installation instructions for future reference and parts ordering information.

KIT CONTENTS

This Kit includes:

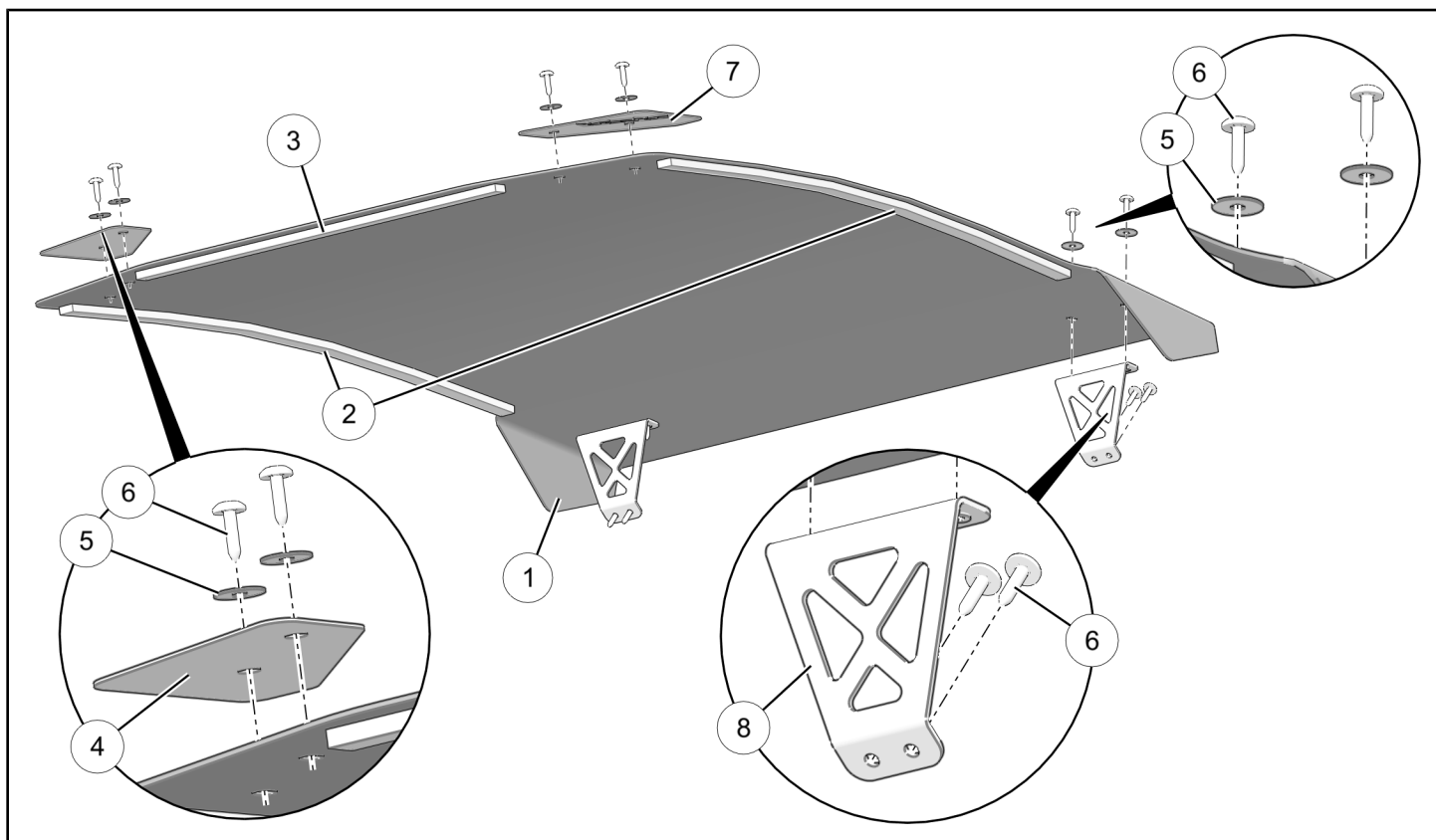

REF	QTY	PART DESCRIPTION	PART NUMBER
1	1	Roof, Aluminum	5267753-458
2	2	Seal, Foam, Side - 838 X 20 X 10 thick	5814798
3	1	Seal, Foam, Front - 533 X 20 X 10 thick	5814853
4	1	Plate, RH	5267874-458
5	8	Washer - 0.281 X 1.00 X 0.051	7556329
6	12	Screw, Torx® Truss Head - M6 X 1.0 X 25	7519650
7	1	Plate, LH	5267873-458
8	2	Bracket	5267751-458
	1	Instructions	9929446

TOOLS REQUIRED

- Safety Glasses
- Screwdriver Set, Torx®
- Socket Set, Torx® Bit
- Torque Wrench

IMPORTANT

Your Aluminum Roof Kit is exclusively designed for your vehicle. Please read the installation instructions thoroughly before beginning. Installation is easier if the vehicle is clean and free of debris. For your safety, and to ensure a satisfactory installation, perform all installation steps correctly in the sequence shown.

INSTALLATION INSTRUCTIONS

1. Shift vehicle transmission into “PARK”. Turn ignition switch to “OFF” position and remove key.
2. Install roof bracket ⑧ to ROPS B-pillar bracket using two screws ⑥. Repeat for opposite side. Torque screws to specification.

TORQUE

8 ft. lbs. (11 Nm) \pm 10%

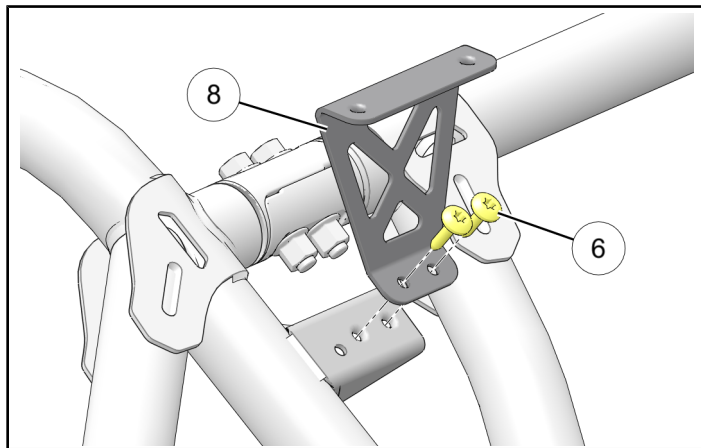

3. Lay roof ① upside down on protective surface.
4. Install foam tape at locations where roof ① will contact ROPS.
 - a. Clean underside of roof along front and side edges to ensure proper foam tape adhesion.

- b. **WITH ADHESIVE BACKING STILL IN PLACE** lay LONG foam tape ② along one side of roof, centering tape between ALL THREE pairs of alignment marks ① (left to right, and front to rear).

NOTE

Tape will extend approximately 7/8 inch (20 mm) beyond front and rear pairs of alignment marks.

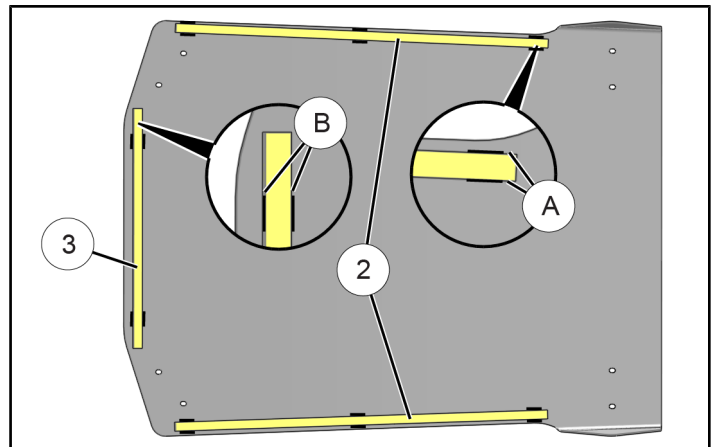

- c. Starting at one end, peel adhesive backing from tape and lightly tack to roof. Continue working towards opposite end, peeling and tacking tape until end is reached. Press tape firmly into place. Repeat for opposite side.
- d. **WITH ADHESIVE BACKING STILL IN PLACE** lay short foam tape ③ along front of roof, centering tape between BOTH pairs of alignment marks ① (left to right, and front to rear).

NOTE

Tape will extend approximately 2 inches (50 mm) beyond left and right pairs of alignment marks.

- e. Starting at one side, peel adhesive backing from tape and lightly tack to roof. Continue working towards opposite side, peeling and tacking tape until end is reached. Press tape firmly into place.

5. Loosely install LH plate ⑦ (with **RZR®** stamping) and left front corner of roof to ROPS A-pillar cross-member using two each screws ⑥ and washers ⑤.

Repeat for right front corner of roof using RH plate ④.

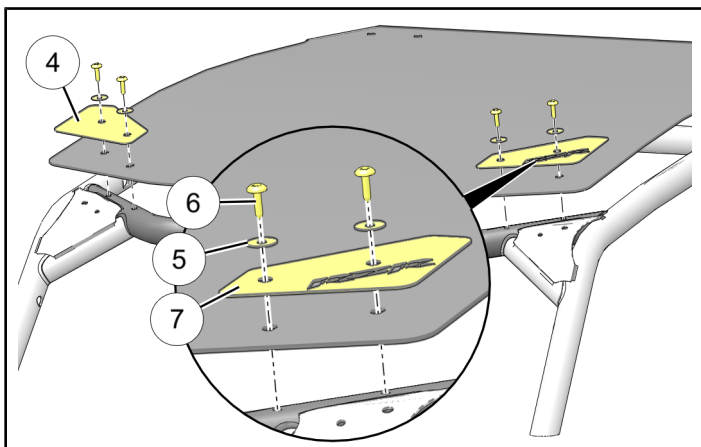

6. Loosely install rear of roof to brackets ⑧ using four each screws ⑥ and washers ⑤.

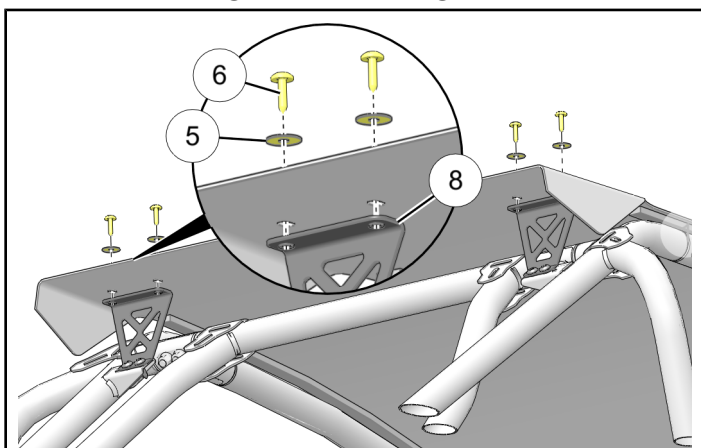

7. Torque all eight screws ⑥ to specification.

TORQUE

8 ft. lbs. (11 Nm) \pm 10%

⚠ WARNING

If transporting vehicle in non-enclosed trailer then vehicle must **FACE FORWARD**, or roof must be removed.

Failure to comply may allow airflow, vibration, or other factors to separate roof from vehicle and cause an accident, resulting in serious personal injury or death.

FEEDBACK FORM

A feedback form has been created for the installer to provide any comments, questions or concerns about the installation instructions. The form is viewable on mobile devices by scanning the QR code or by clicking [HERE](#) if viewing on a PC.

FEEDBACK FORM

