

MULTI-POINT REAR HARNESS KIT



P/N 2884079, 2884080

APPLICATION

Verify accessory fitment at [Polaris.com](https://www.polaris.com).

BEFORE YOU BEGIN

Read these instructions and check to be sure all parts and tools are accounted for. Please retain these installation instructions for future reference and parts ordering information.

KIT CONTENTS

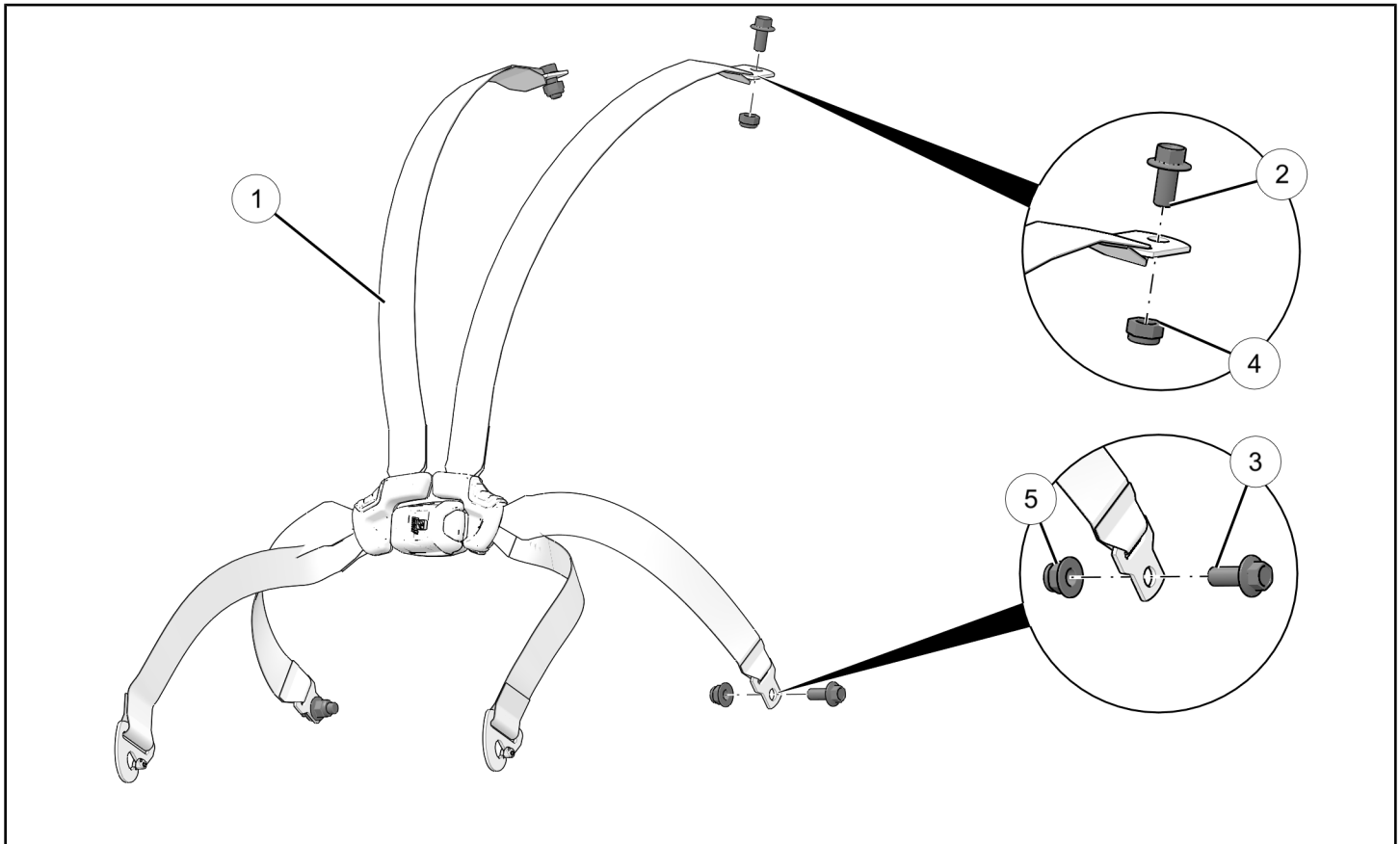

REF	QTY	PART DESCRIPTION	P/N AVAILABLE SEPARATELY
1	1	Assembly–Seat Belt, 6 point, Passenger, Rear	2637702
2	2	Screw–Hex Flange, M12 x 1.75 mm x 25 mm	7519072
3	2	Screw–Hex Flange, M12 x 1.75 mm x 30 mm	7520054
4	2	Nut–Nylon Locking, M12 X 1.75 mm	7540000
5	2	Nut–Hex Flange, M12 x 1.75 mm	7547441
6	2	Pin–Retaining (not shown)	n/a

TOOLS REQUIRED

- Safety Glasses
- Socket Set, Metric
- Torque Wrench
- Wrench Set, Metric

IMPORTANT

Your Multi-Point Rear Harness Kit is exclusively designed for your vehicle. Please read the installation instructions thoroughly before beginning. Installation is easier if the vehicle is clean and free of debris. For your safety, and to ensure a satisfactory installation, perform all installation steps correctly in the sequence shown.

INSTALLATION INSTRUCTIONS

VEHICLE PREPARATION

GENERAL

1. Shift vehicle transmission into PARK. Turn key to OFF position and remove from vehicle.
2. Open rear doors to access seats.

REAR SEAT BELT REMOVAL

NOTE

Left-rear seat shown; right-rear similar.

1. Push lever on back of headrest to disengage from receiver tube. Remove backrest of seat from vehicle.

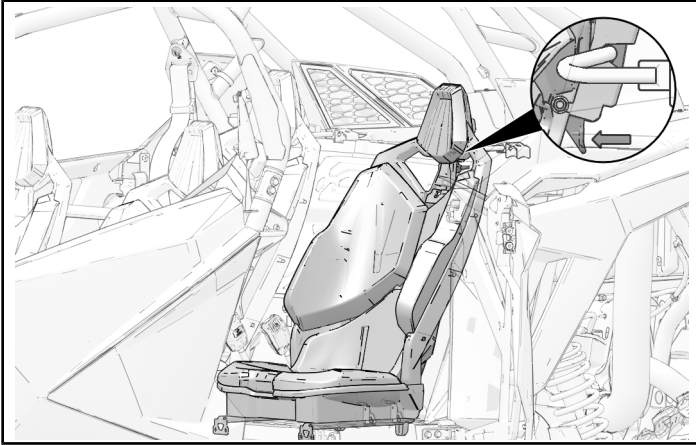

2. Remove one nut from seat belt retractor assembly.

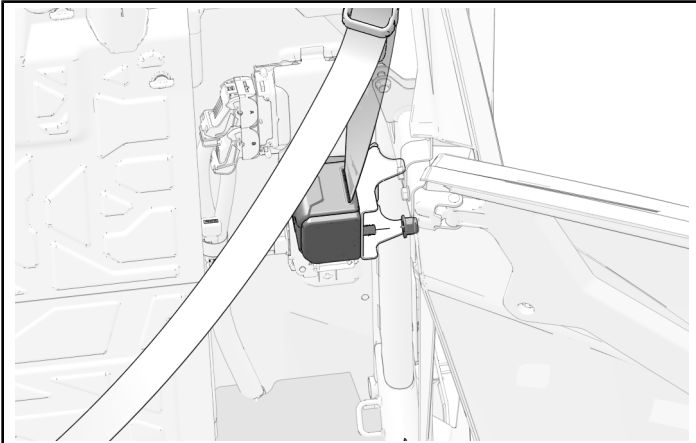

3. Remove one bolt and one nut from lower mount location.

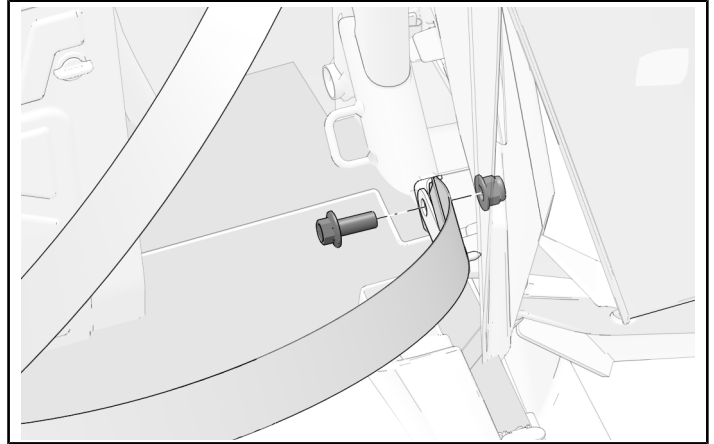

4. Remove one bolt and nut from upper mount location.

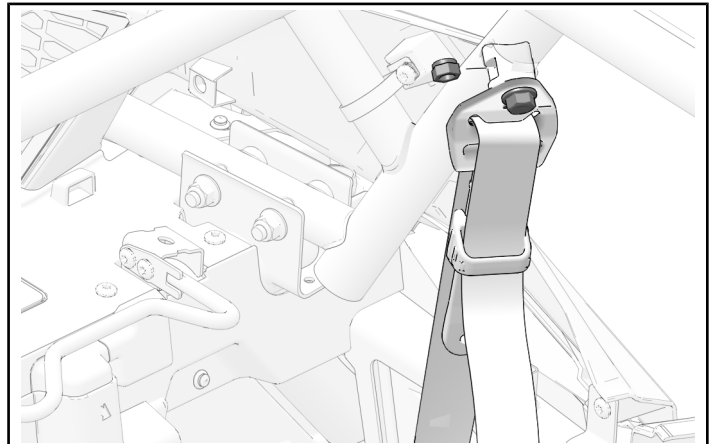

5. Remove seat belt assembly from vehicle.

- Remove one bolt and nut to remove seat belt buckle from vehicle.

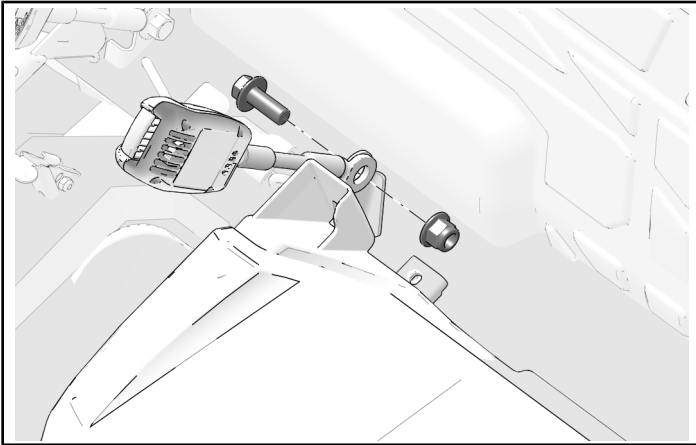

ACCESSORY INSTALLATION

NOTE

Left-rear seat shown; right-rear similar.

- Place one nut ④ inside each upper harness bracket and pass one fastener ② through harness and upper harness bracket to install to nut. Ensure harness assembly sits atop upper harness bracket.

TORQUE

Harness Fasteners ② (Upper Mounting Location):
44 ft-lbs (60 N·m)

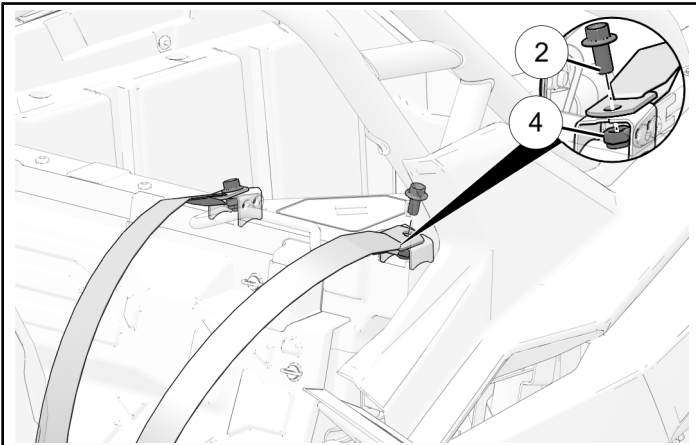

- Rest harness on outside of each lower harness bracket and pass one fastener ④ through harness and lower harness bracket to install to nut.

TORQUE

Harness Fasteners ③ (Lower Mounting Location):
44 ft-lbs (60 N·m)

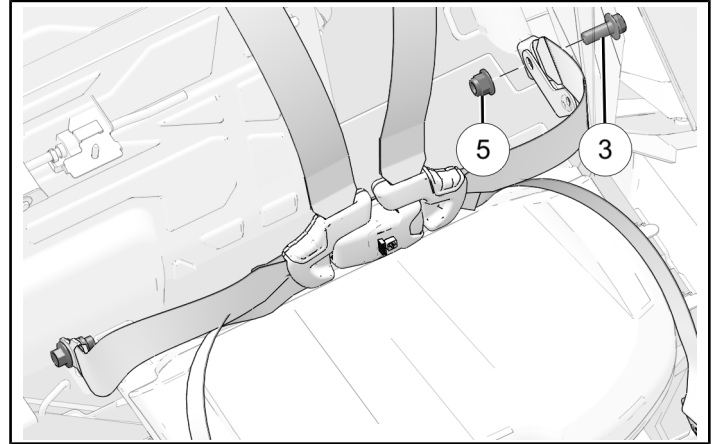

- Clip front of harness to seat belt hooks.

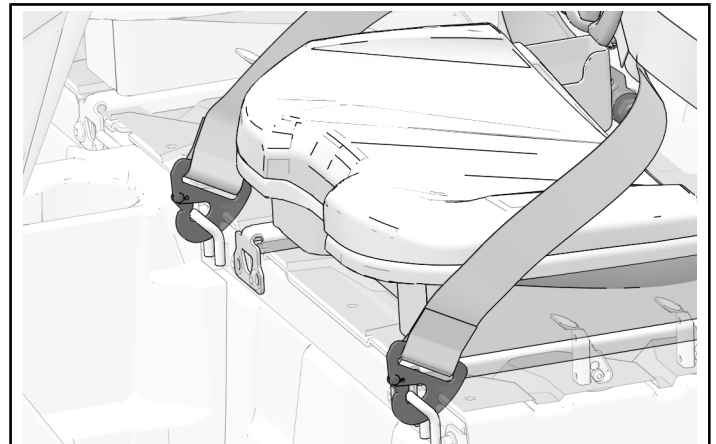

- Secure seat belt hooks with one retaining pin ⑥ per hook.

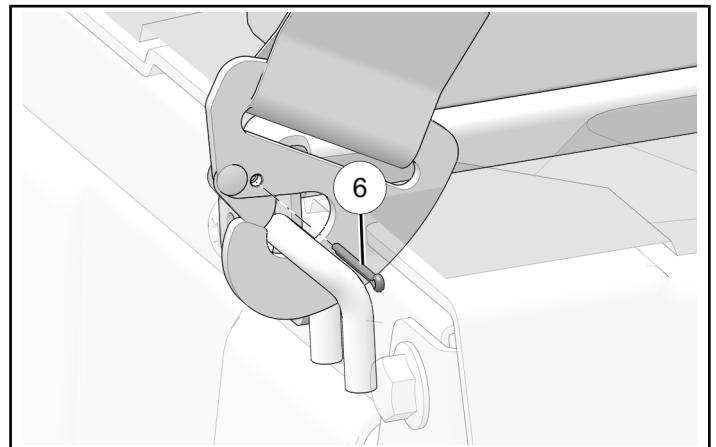

5. Position backrest assembly into seat base and lean back until headrest engages with receiver tube.

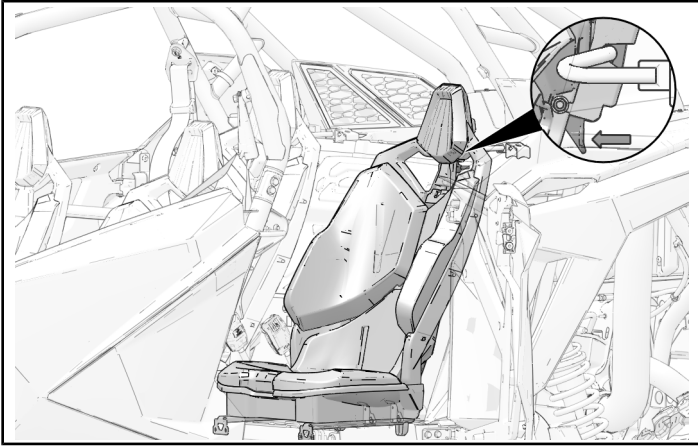

FEEDBACK FORM

A feedback form has been created for the installer to provide any comments, questions or concerns about the installation instructions. The form is viewable on mobile devices by scanning the QR code or by clicking [HERE](#) if viewing on a PC.

